



US00D659217S

(12) **United States Design Patent**  
**ReDavid, III**

(10) **Patent No.:** **US D659,217 S**

(45) **Date of Patent:** **\*\* May 8, 2012**

(54) **ARROW HEAD**

(76) **Inventor:** **Paul J. ReDavid, III**, Lithia Springs, GA  
(US)

(\*\*) **Term:** **14 Years**

(21) **Appl. No.:** **29/391,289**

(22) **Filed:** **May 5, 2011**

(51) **LOC (9) Cl.** ..... **22-01**

(52) **U.S. Cl.** ..... **D22/107**

(58) **Field of Classification Search** ..... D22/107,  
D22/115-116, 199; 124/16-29, 86-92; D8/300,  
D8/31, 401, 402, 499, DIG. 1, DIG. 27; 16/414,  
16/417, 433, 441

See application file for complete search history.

(56) **References Cited**

**U.S. PATENT DOCUMENTS**

735,336	A *	8/1903	Bowles	.....	411/166
1,691,923	A *	11/1928	Eklund	.....	16/441
3,978,758	A *	9/1976	Bright	.....	411/397
D244,448	S	5/1977	Bonine et al.		
4,396,196	A	8/1983	Drennan		
4,462,598	A	7/1984	Chalin et al.		
D279,813	S	7/1985	Palizzolo		
4,616,835	A	10/1986	Trotter		
4,993,397	A *	2/1991	Cryar et al.	.....	124/23.1
5,114,156	A	5/1992	Saunders		
5,161,851	A *	11/1992	Rafi-Zadeh	.....	296/26.07
D363,878	S *	11/1995	Hayabusa	.....	D8/387
5,522,375	A *	6/1996	Simo et al.	.....	124/86
5,735,053	A *	4/1998	McGunigal	.....	33/265

6,343,600	B1 *	2/2002	Steinman	.....	124/91
D462,600	S	9/2002	Gilbert et al.		
D466,001	S	11/2002	Monson		
D480,951	S	10/2003	Robinson		
6,732,410	B1 *	5/2004	Nedderman, Jr.	.....	16/374
D538,375	S	3/2007	Reitz		
D590,704	S	4/2009	Brunsteter		
7,900,391	B1 *	3/2011	Mihelish	.....	42/116
8,006,350	B2 *	8/2011	Chen	.....	16/422
8,070,405	B2 *	12/2011	Hazout	.....	411/387.2
2004/0034969	A1 *	2/2004	Wegman	.....	16/389
2008/0282469	A1 *	11/2008	Hayes et al.	.....	5/174

\* cited by examiner

*Primary Examiner* — Michael Pratt

(74) *Attorney, Agent, or Firm* — QuickPatents, Inc.; Kevin Prince

(57) **CLAIM**

I claim the ornamental design for an arrow head, as shown and described.

**DESCRIPTION**

FIG. 1 is a perspective view of an arrow head, showing my new design;  
FIG. 2 is a front elevational view thereof;  
FIG. 3 is a rear elevational view thereof;  
FIG. 4 is a left-side elevational view thereof;  
FIG. 5 is a right-side elevational view thereof;  
FIG. 6 is a top plan view thereof; and,  
FIG. 7 is a bottom plan view thereof.

The broken lines showing an arrow shaft in FIG. 1 depict environmental matter and form no part of the claimed design.

**1 Claim, 3 Drawing Sheets**

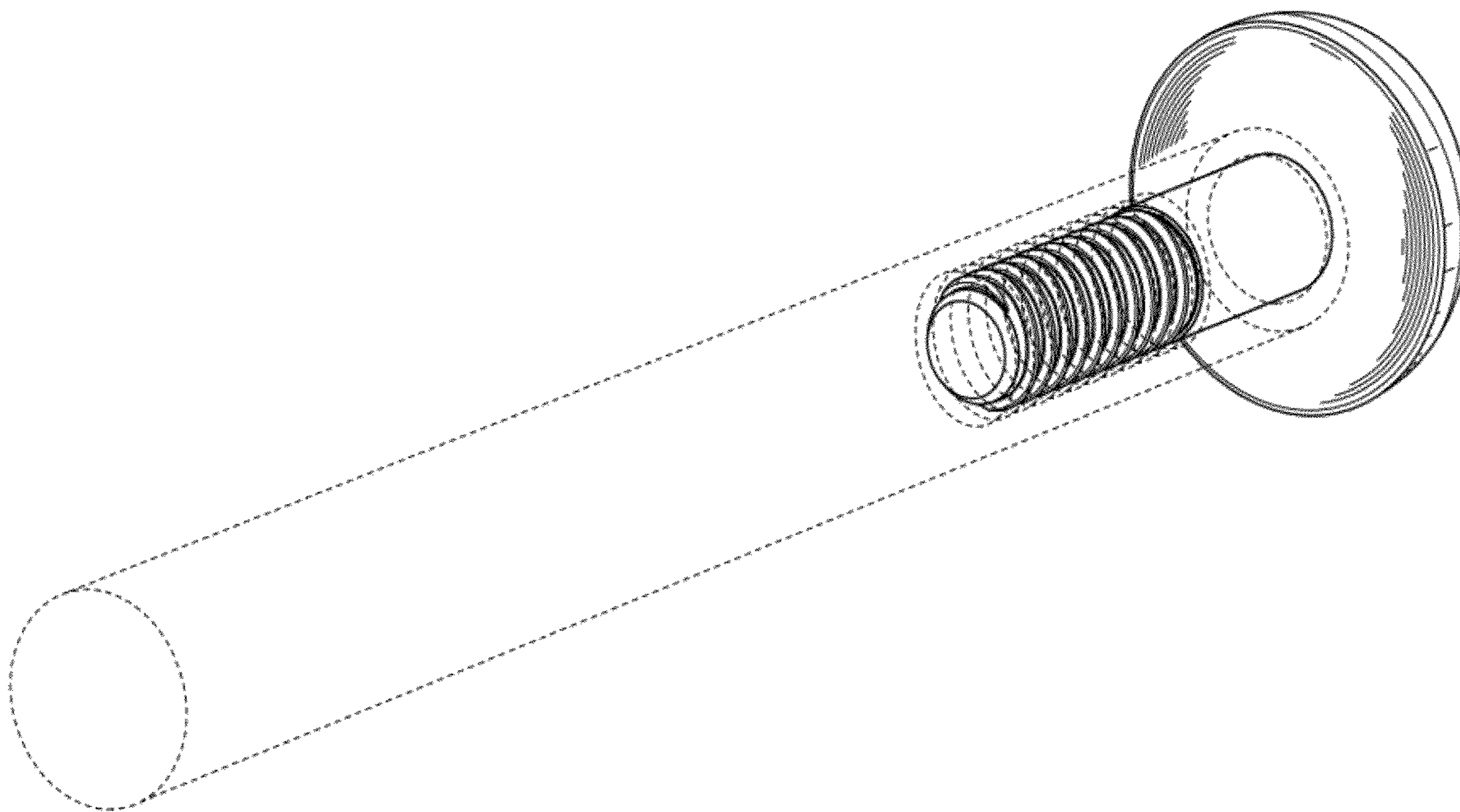

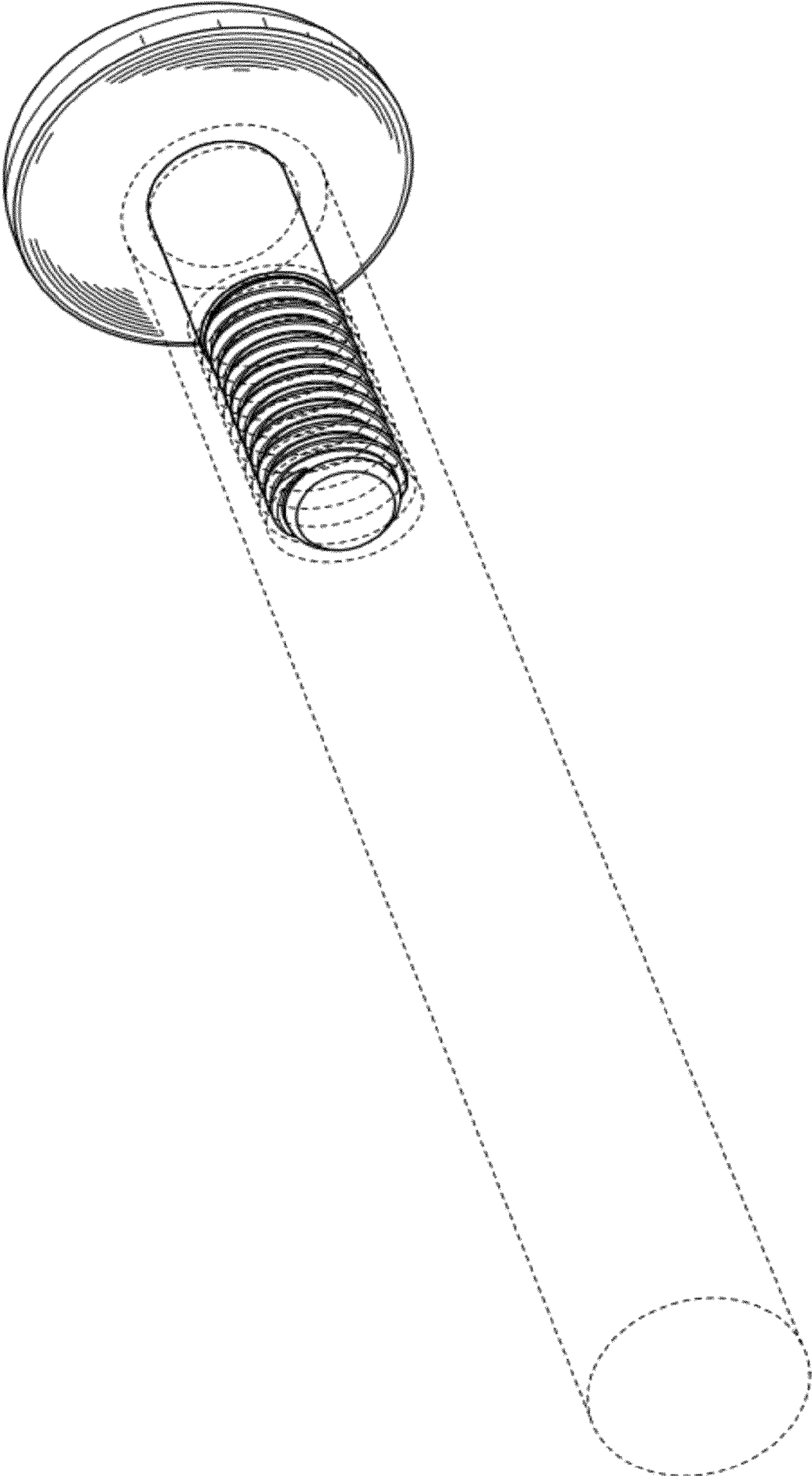

FIG. 1

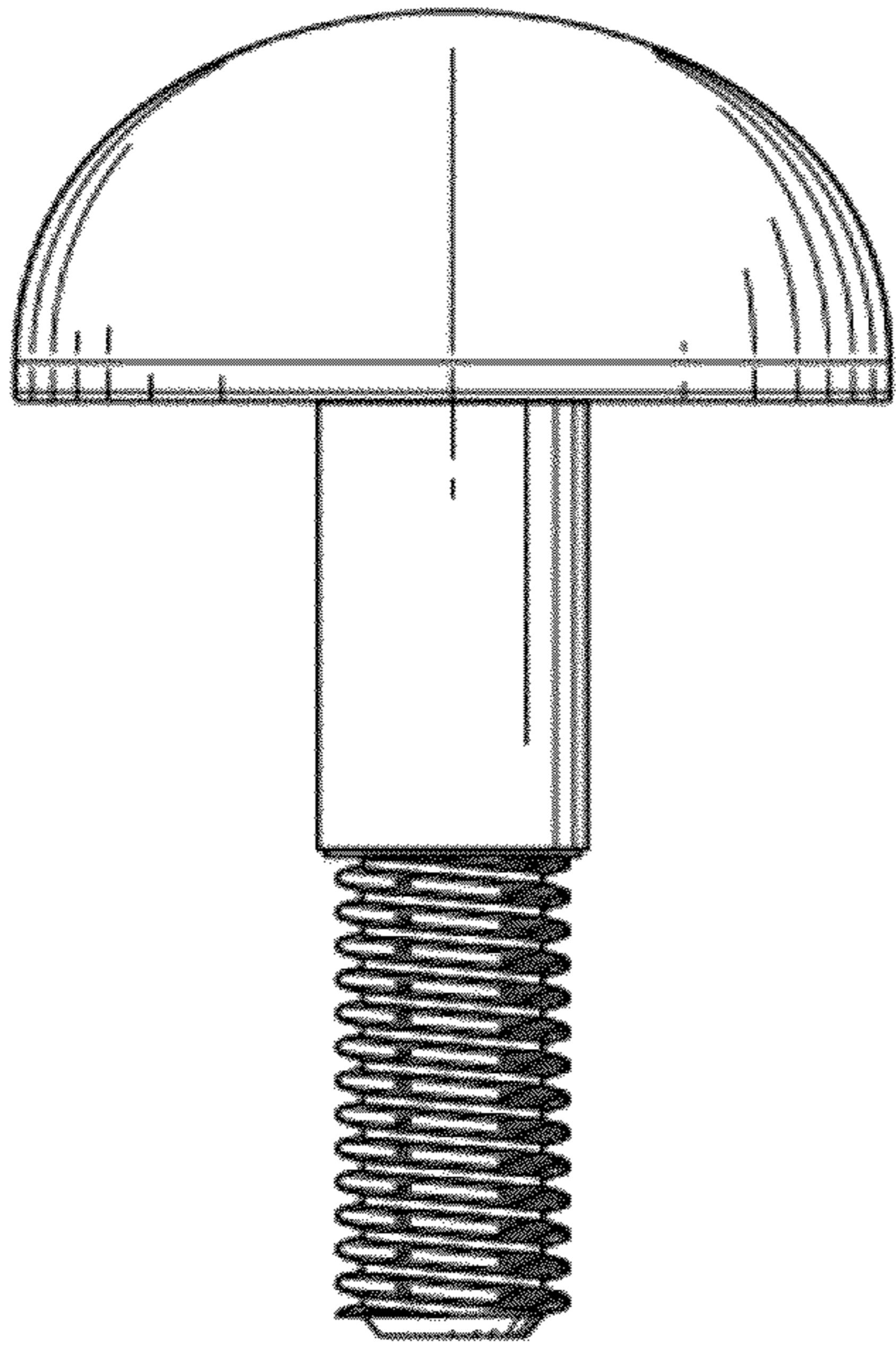

FIG. 2

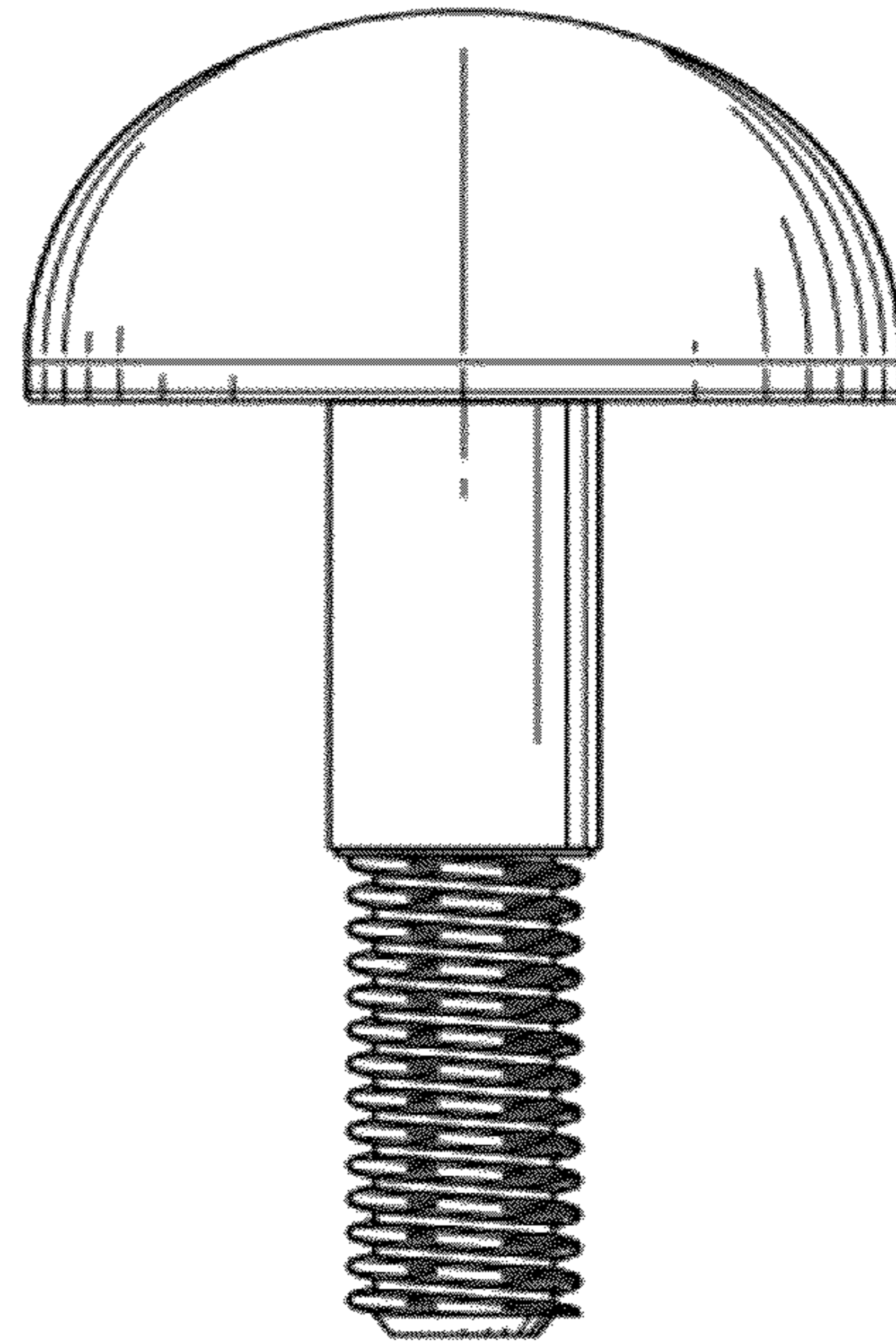

FIG. 3

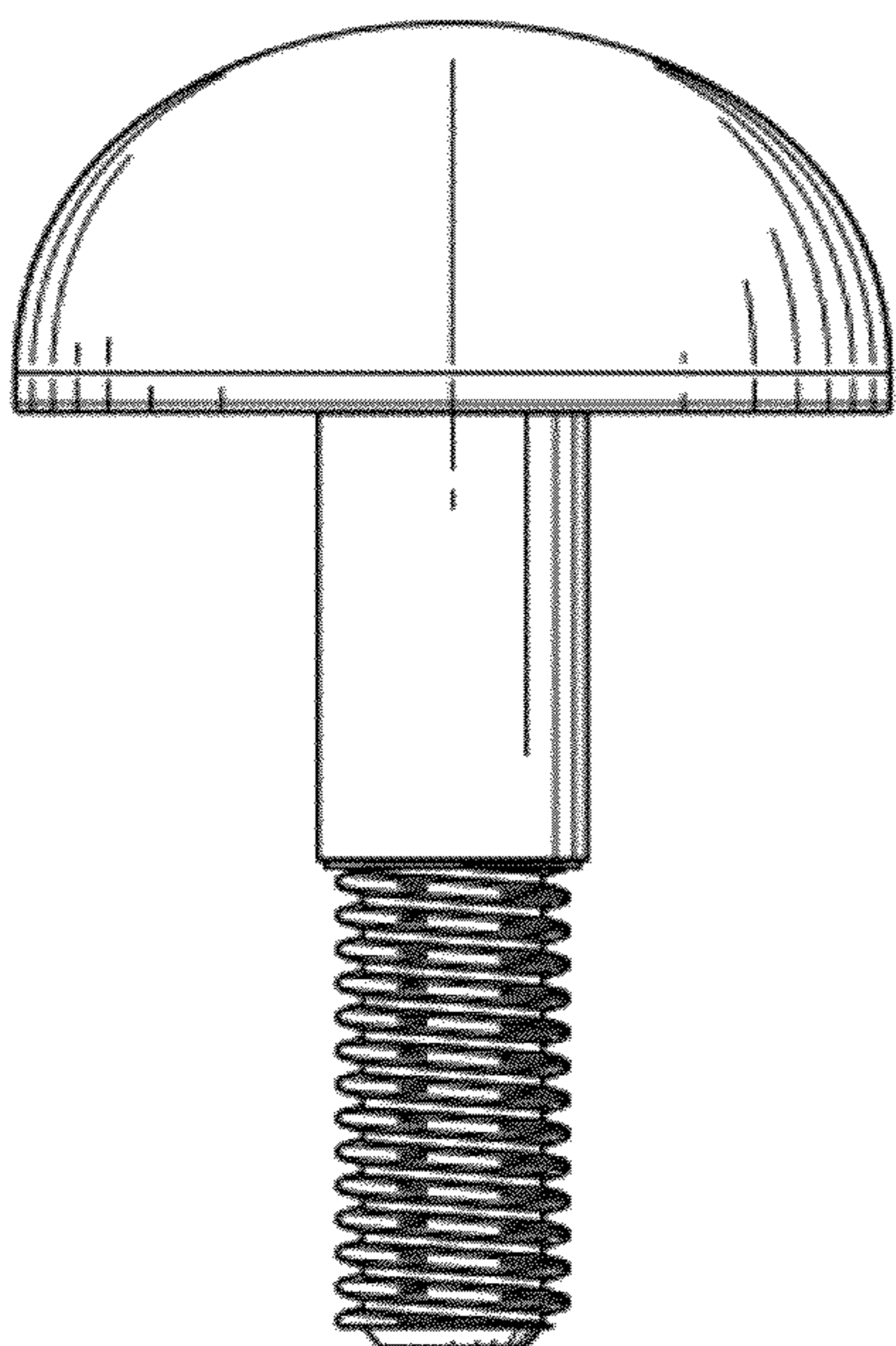

FIG. 4

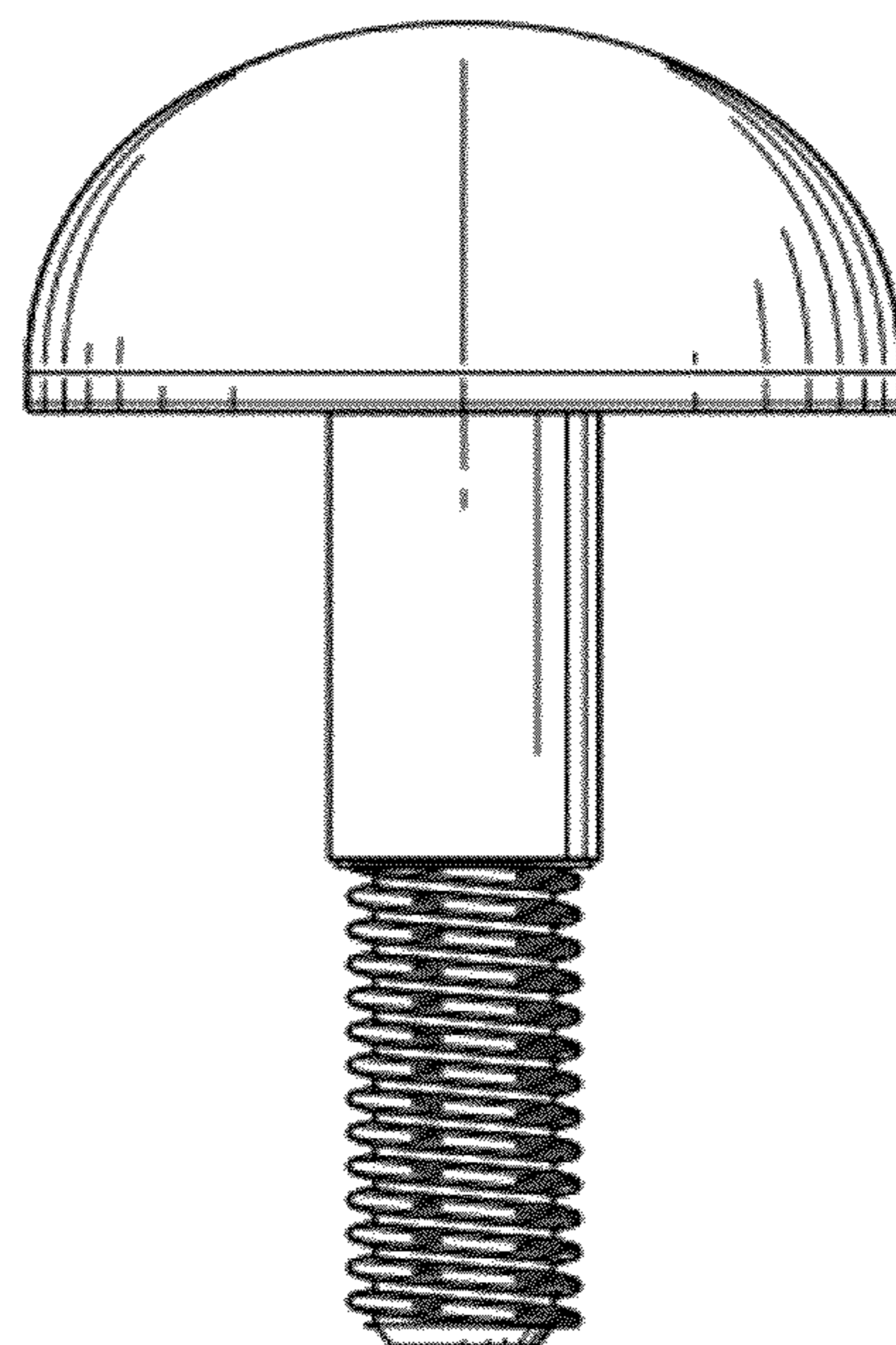

FIG. 5

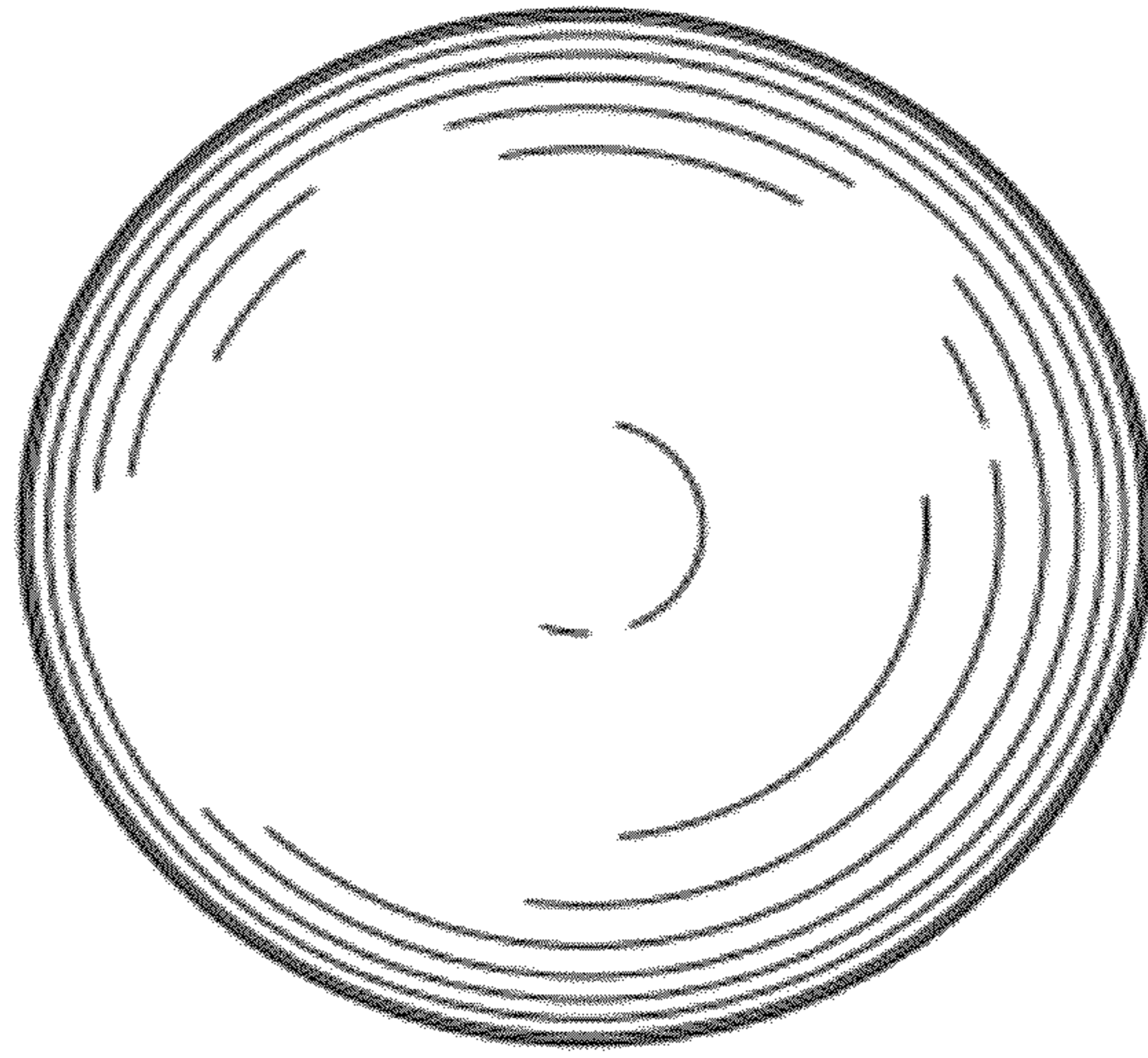

FIG. 6

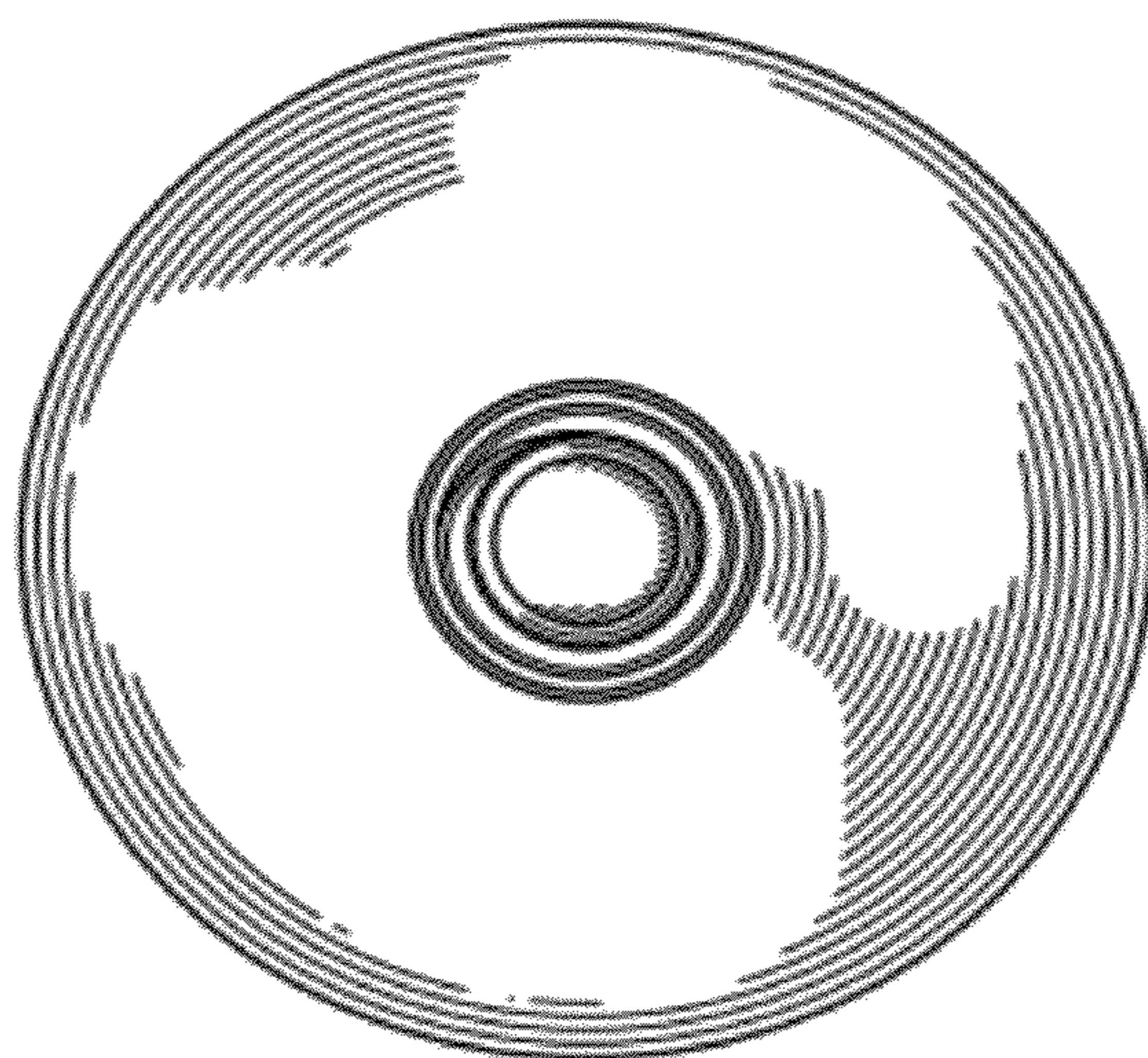

FIG. 7