



US00D658684S

(12) **United States Design Patent**  
**Roman**

(10) **Patent No.:** **US D658,684 S**

(45) **Date of Patent:** **\*\* May 1, 2012**

(54) **COMPRESSOR FRAME**

(75) Inventor: **Alisson Luiz Roman**, Joinville (BR)

(73) Assignee: **Whirlpool S.A.**, São Paulo (BR)

(\*\*) Term: **14 Years**

(21) Appl. No.: **29/396,191**

(22) Filed: **Jun. 27, 2011**

(30) **Foreign Application Priority Data**

Dec. 27, 2010 (BR) ..... DI7005546-7

(51) **LOC (9) Cl.** ..... **15-02**

(52) **U.S. Cl.** ..... **D15/9**

(58) **Field of Classification Search** ..... D15/7-9;  
D23/231, 232, 225; 417/60, 235, 265, 321,  
417/355, 358, 363, 359, 410.1, 415-416,  
417/405, 900; 60/408, 412; 184/26-37;  
415/140-147; 123/495, 509

See application file for complete search history.

(56) **References Cited**

**U.S. PATENT DOCUMENTS**

D332,101 S \* 12/1992 Aizawa ..... D15/7  
D345,420 S \* 3/1994 Stewart, Sr. .... D24/143  
D441,768 S \* 5/2001 Nagai et al. .... D15/7  
D461,827 S \* 8/2002 Koebbe ..... D15/7

D472,558 S \* 4/2003 MacPherson et al. .... D15/7  
D506,210 S \* 6/2005 Selic et al. .... D15/7  
D520,521 S \* 5/2006 Angeletta ..... D15/7  
D583,389 S \* 12/2008 Bilger ..... D15/7  
D610,166 S \* 2/2010 Foreman ..... D15/7  
D623,200 S \* 9/2010 Fulkerson et al. .... D15/7  
D623,664 S \* 9/2010 Fulkerson et al. .... D15/7  
D624,561 S \* 9/2010 Yu ..... D15/7  
D641,382 S \* 7/2011 Hawes et al. .... D15/7  
D643,442 S \* 8/2011 Sato et al. .... D15/9  
D643,855 S \* 8/2011 Taniguchi et al. .... D15/7

\* cited by examiner

*Primary Examiner* — Ralf Seifert

(74) *Attorney, Agent, or Firm* — Holland & Knight LLP;  
Brian J. Colandreo, Esq.; Elizabeth R. Burkhard, Esq.

(57) **CLAIM**

The ornamental design for a compressor frame, as shown and described.

**DESCRIPTION**

FIG. 1 is a front perspective view of a compressor frame;  
FIG. 2 is a front elevational view thereof, the back elevational view being a mirror image;  
FIG. 3 is a left side elevational view thereof, the right side elevational view being a mirror image;  
FIG. 4 is a top plan view thereof; and,  
FIG. 5 is a bottom plan view thereof.

**1 Claim, 2 Drawing Sheets**

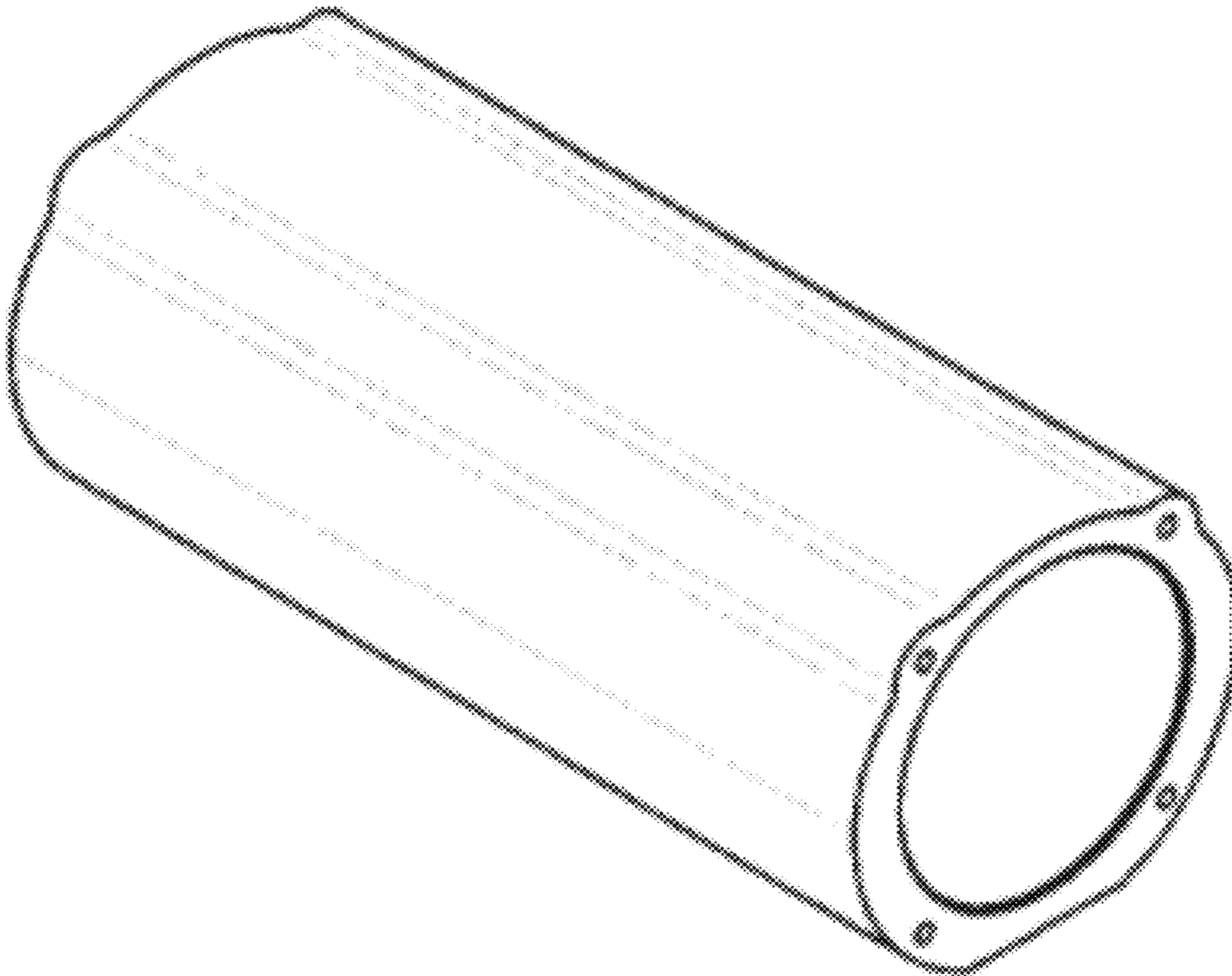

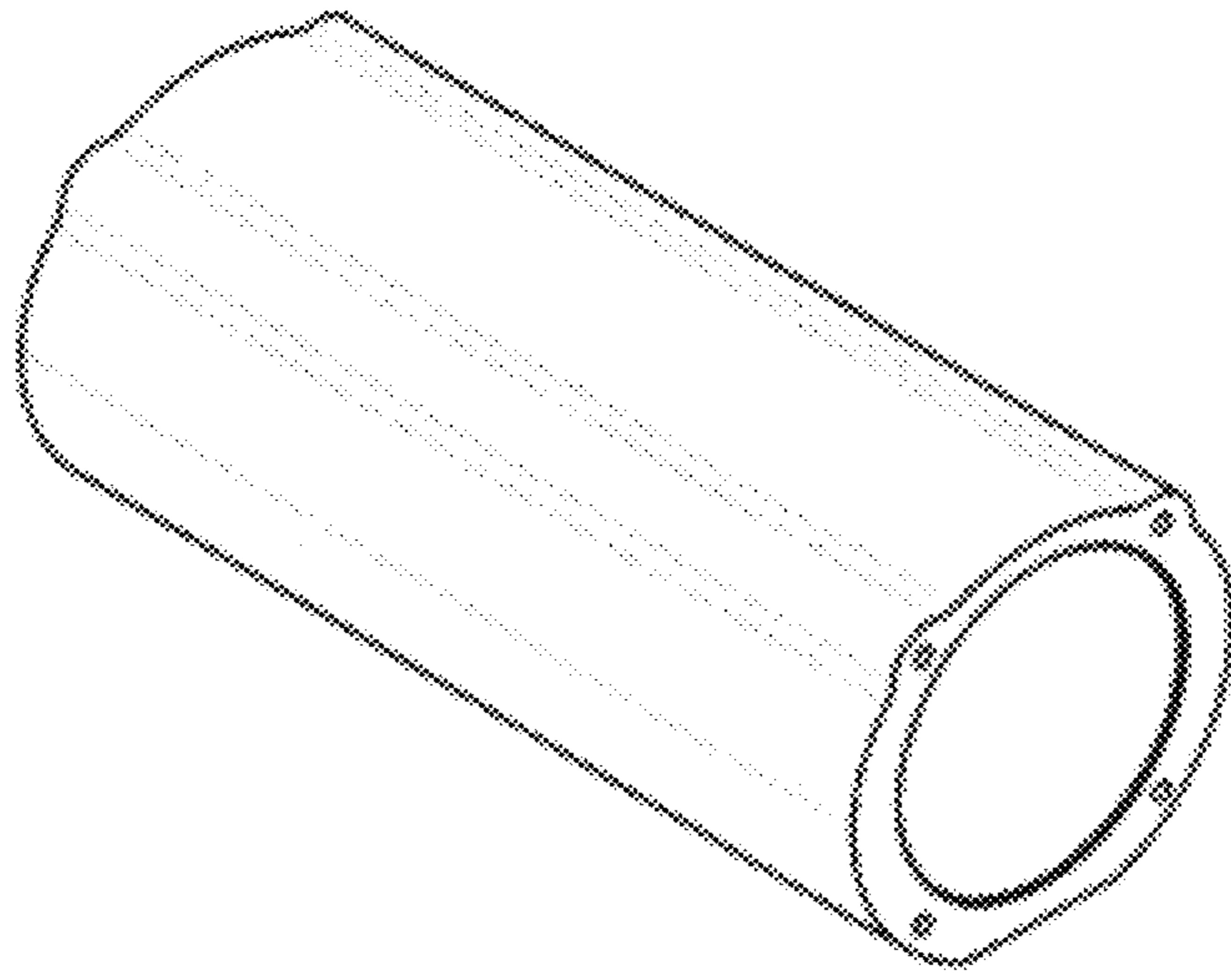

FIG. 1

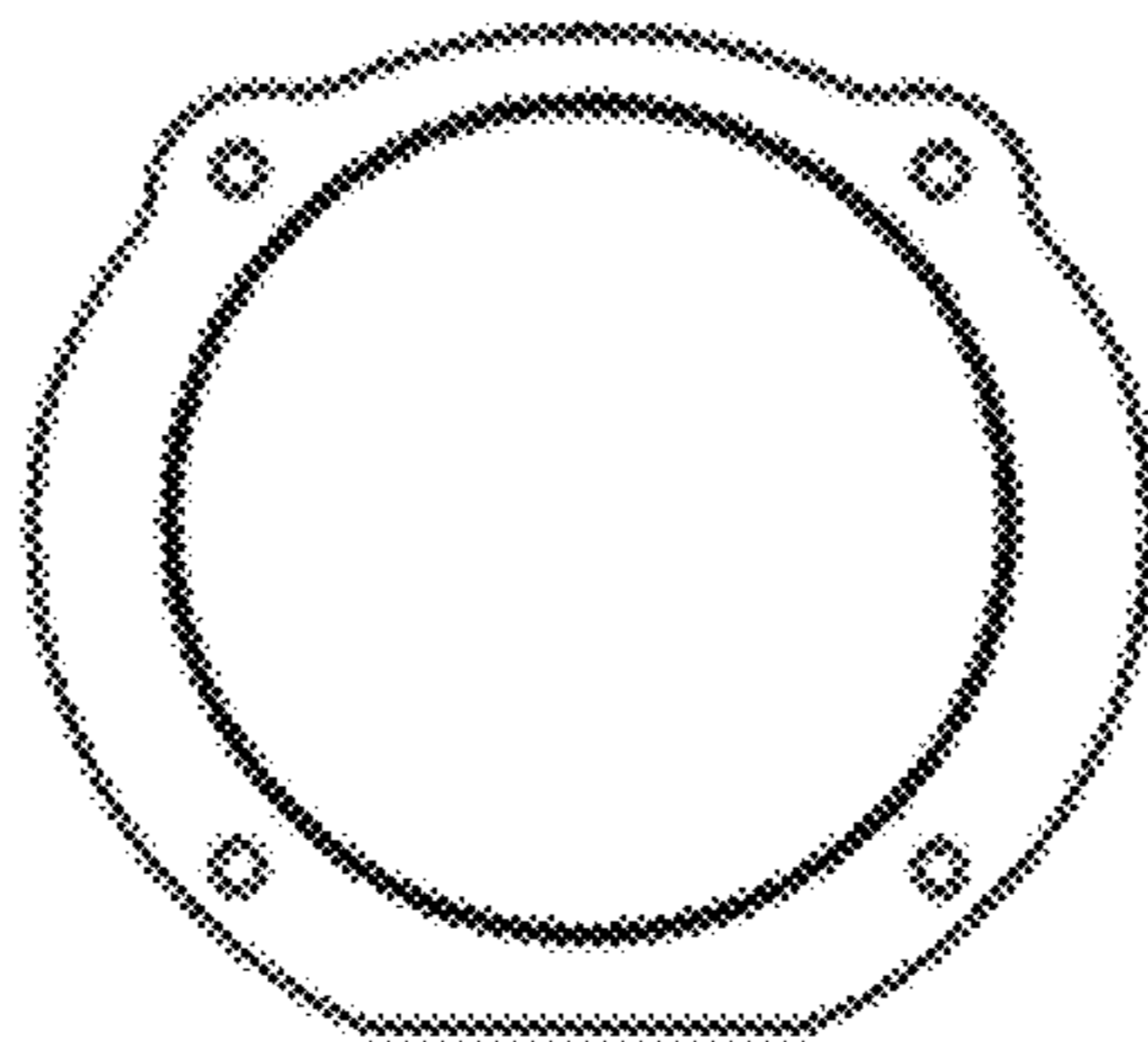

FIG. 2



FIG. 3

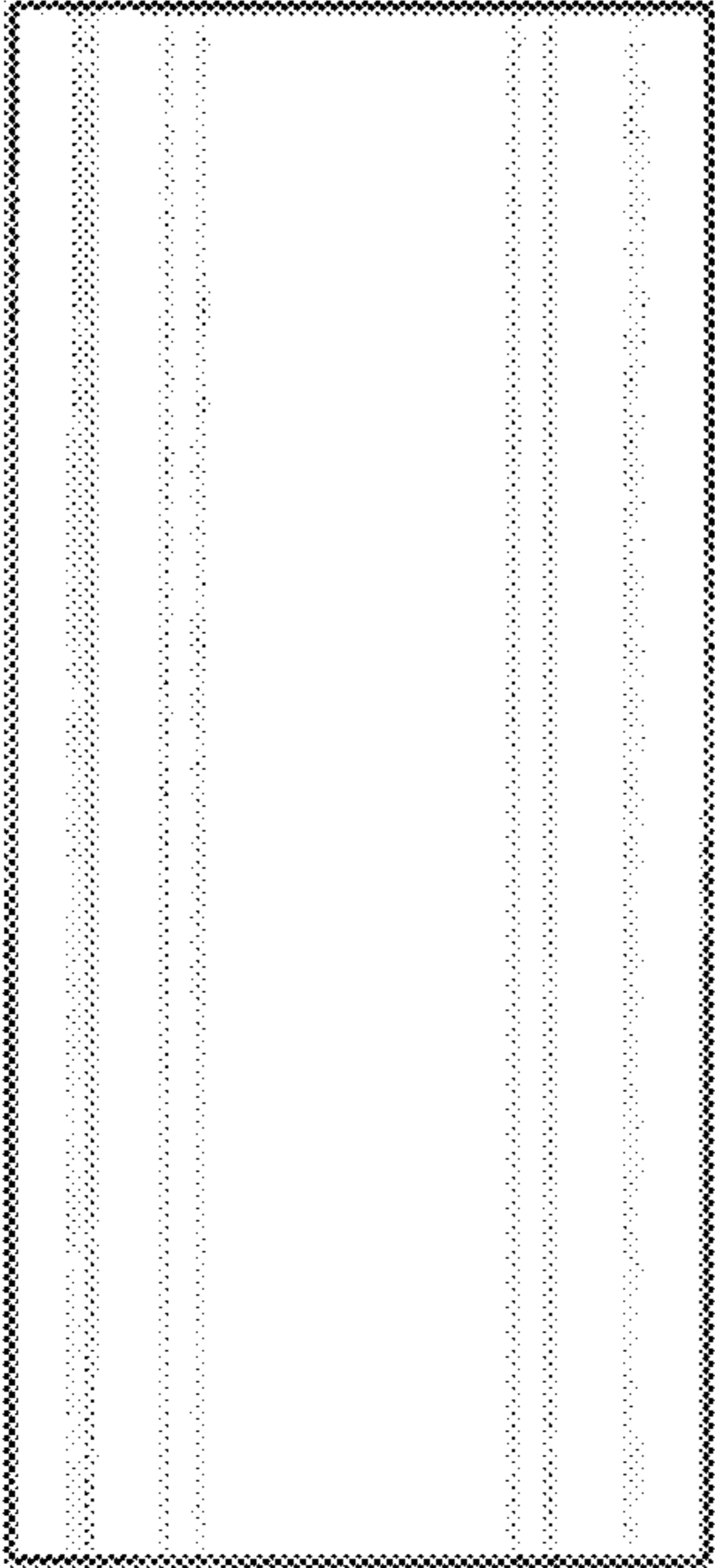

FIG. 4

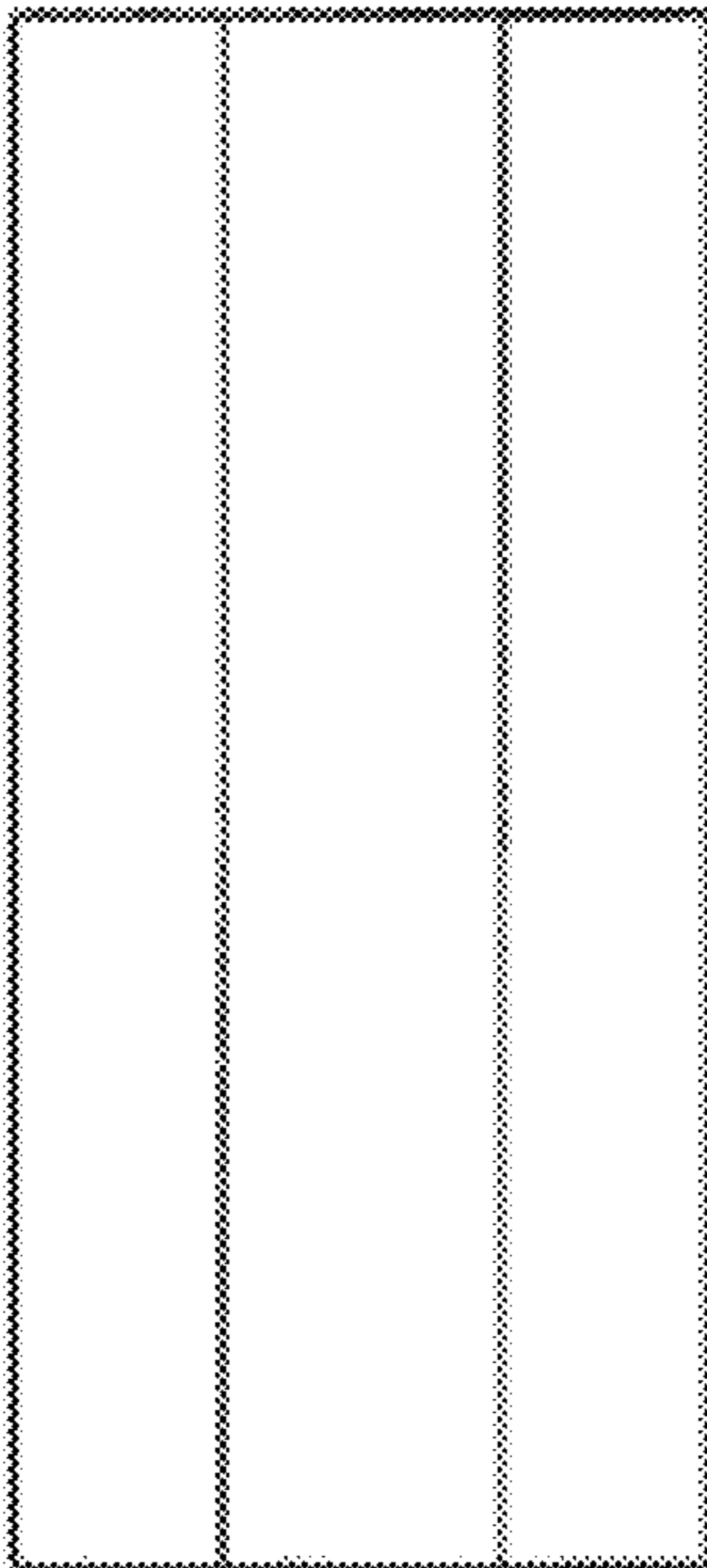

FIG. 5