



US00D658100S

(12) **United States Design Patent**  
**Kubo et al.**

(10) **Patent No.:** **US D658,100 S**  
(45) **Date of Patent:** **\*\* Apr. 24, 2012**

(54) **BODY PANEL FOR AN AUTOMOBILE**

(75) Inventors: **Kosuke Kubo**, Toyota (JP); **Mineo Imaiida**, Kariya (JP)

(73) Assignee: **Toyota Jidosha Kabushiki Kaisha**, Toyota-shi (JP)

(\*\*) Term: **14 Years**

(21) Appl. No.: **29/382,694**

(22) Filed: **Jan. 6, 2011**

(51) **LOC (9) Cl.** ..... **12-16**

(52) **U.S. Cl.** ..... **D12/196; D12/184**

(58) **Field of Classification Search** ..... D12/184,  
D12/196, 90-92; 280/152.1, 847-849, 851;  
296/181.1, 181.5

See application file for complete search history.

(56) **References Cited**

**U.S. PATENT DOCUMENTS**

D507,514 S \* 7/2005 Nagura et al. .... D12/196  
D600,614 S \* 9/2009 Lamm ..... D12/184  
D604,681 S \* 11/2009 Nakamura ..... D12/184

\* cited by examiner

*Primary Examiner* — Melody N Brown

(74) *Attorney, Agent, or Firm* — Finnegan, Henderson, Farabow, Garrett & Dunner, LLP

(57) **CLAIM**

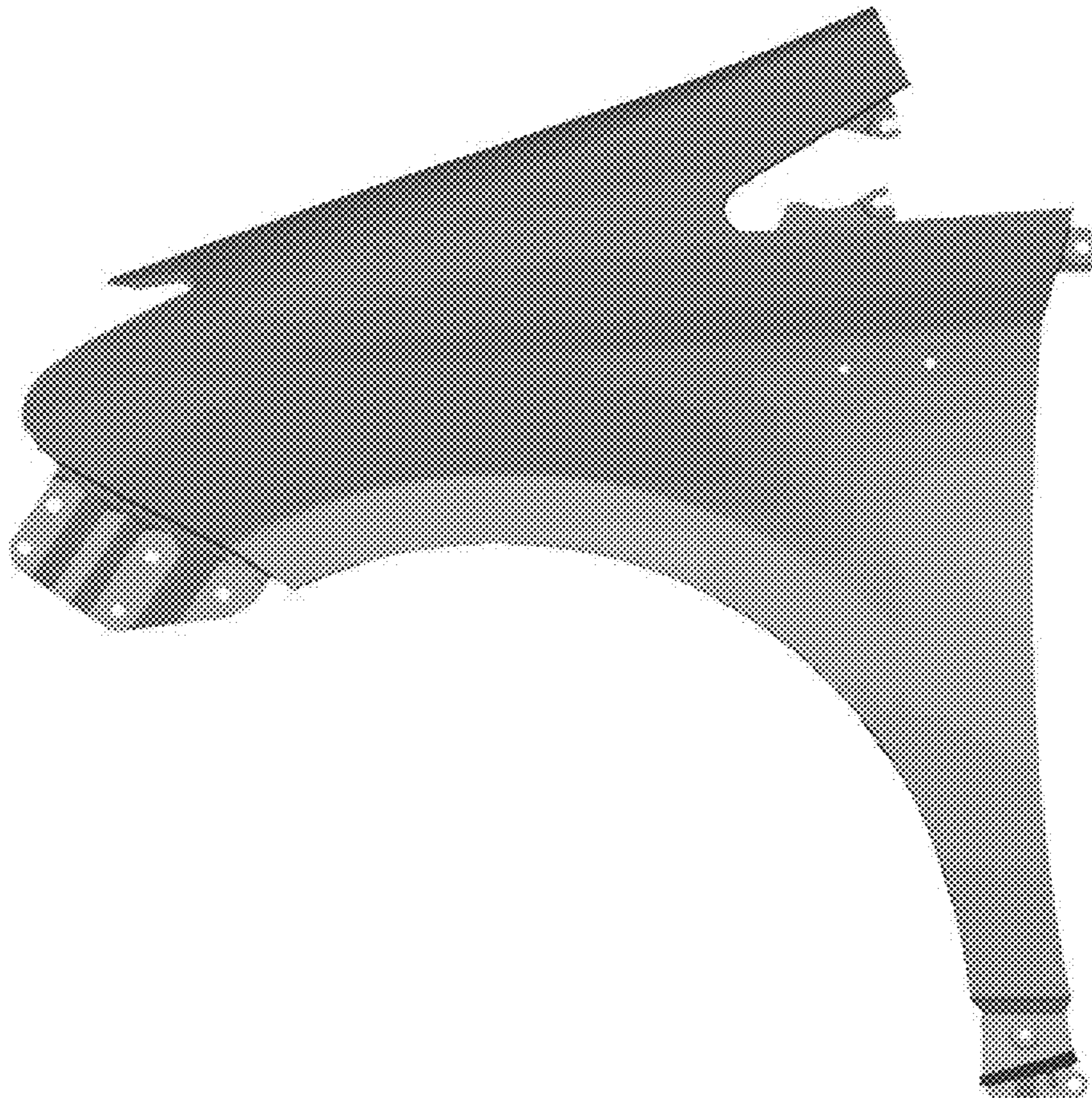
The ornamental design for a body panel for an automobile, as shown and described.

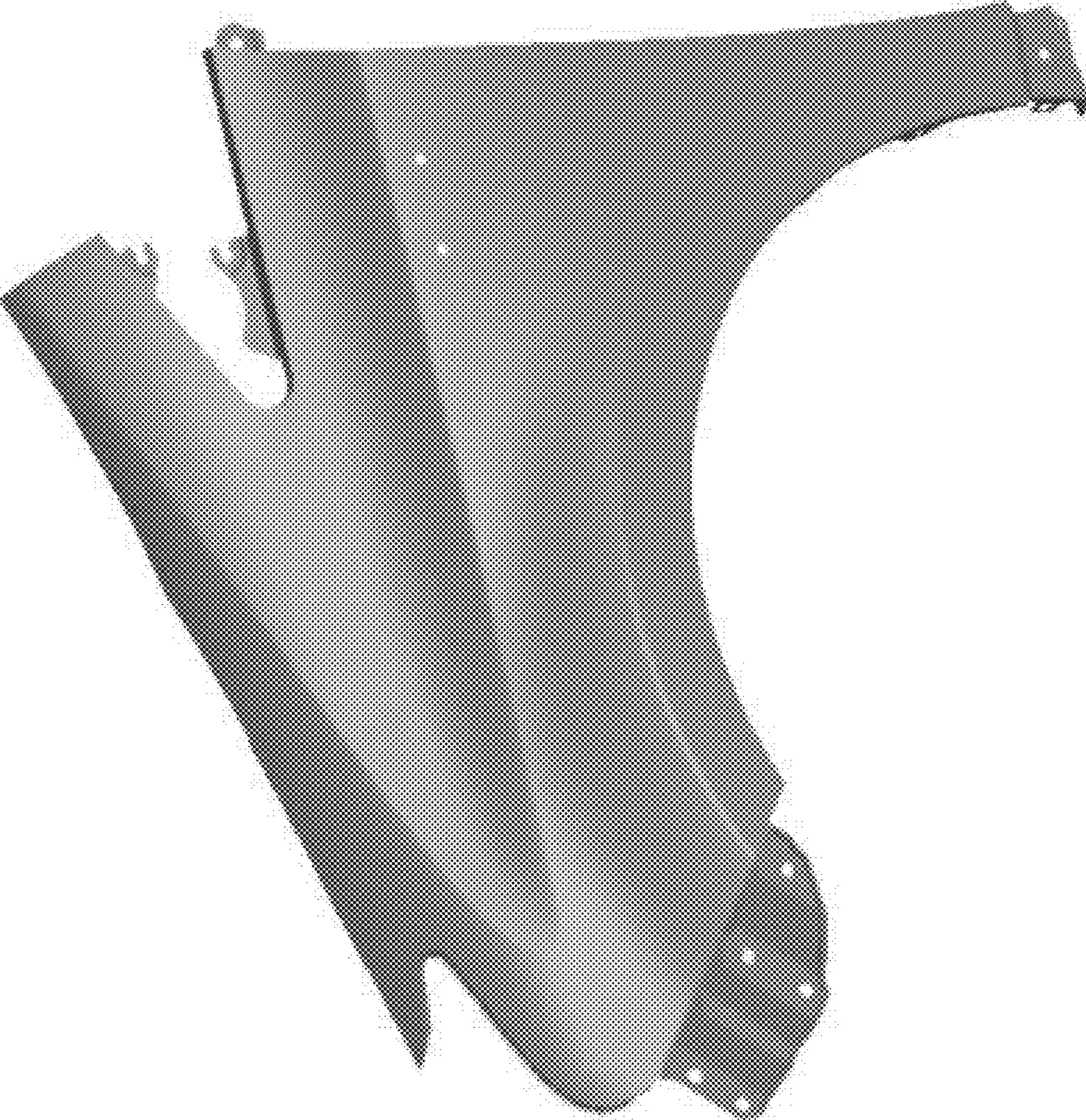
**DESCRIPTION**

FIG. 1 is a front perspective view of a body panel for an automobile of our new design;  
FIG. 2 is a rear perspective view thereof;  
FIG. 3 is a front view thereof;  
FIG. 4 is a rear view thereof;  
FIG. 5 is a left side view thereof;  
FIG. 6 is a right side view thereof;  
FIG. 7 is a top plan view thereof; and,  
FIG. 8 is a bottom view thereof.

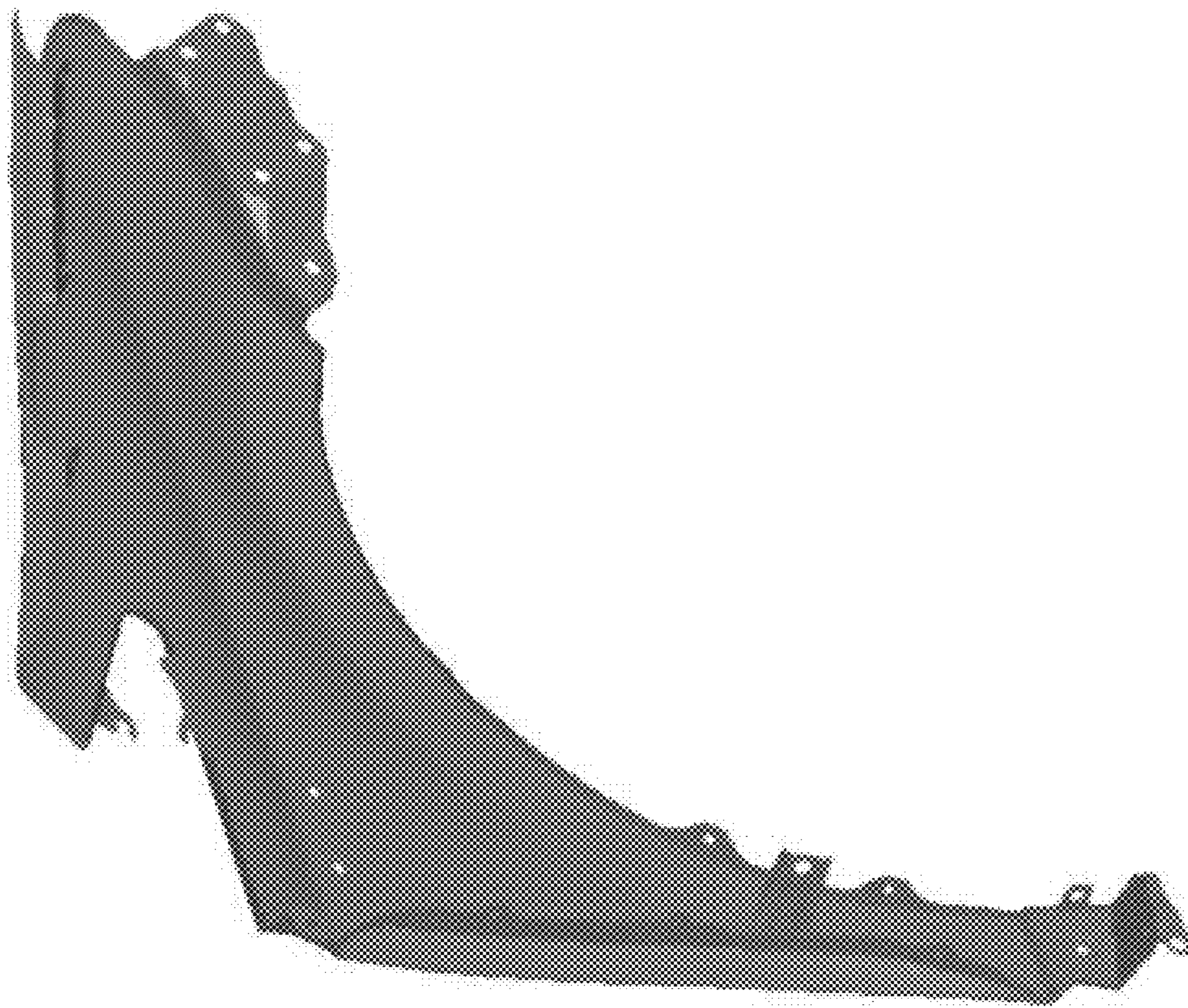
Our design includes a mirror image of the embodiment depicted.

**1 Claim, 6 Drawing Sheets**

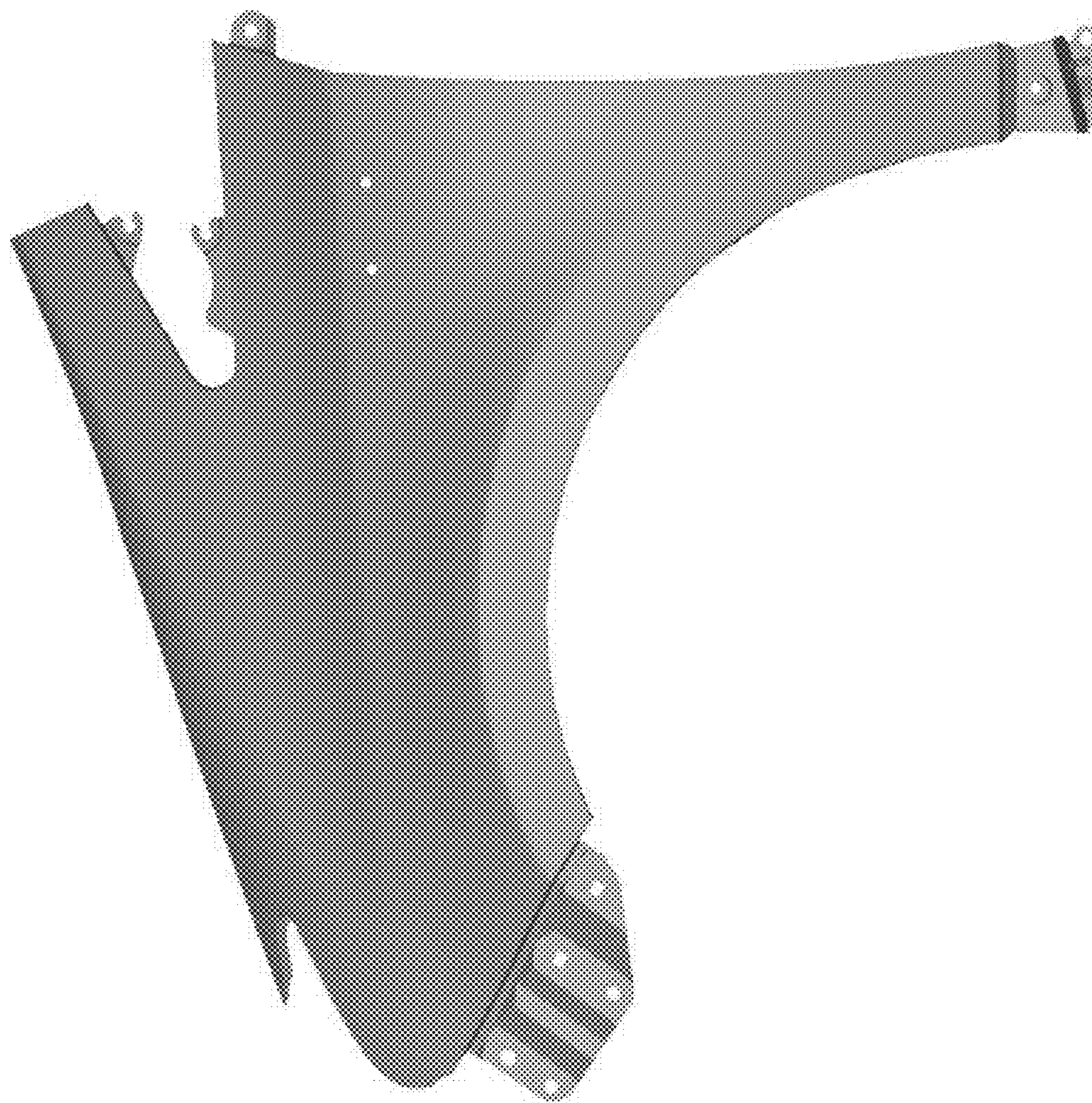




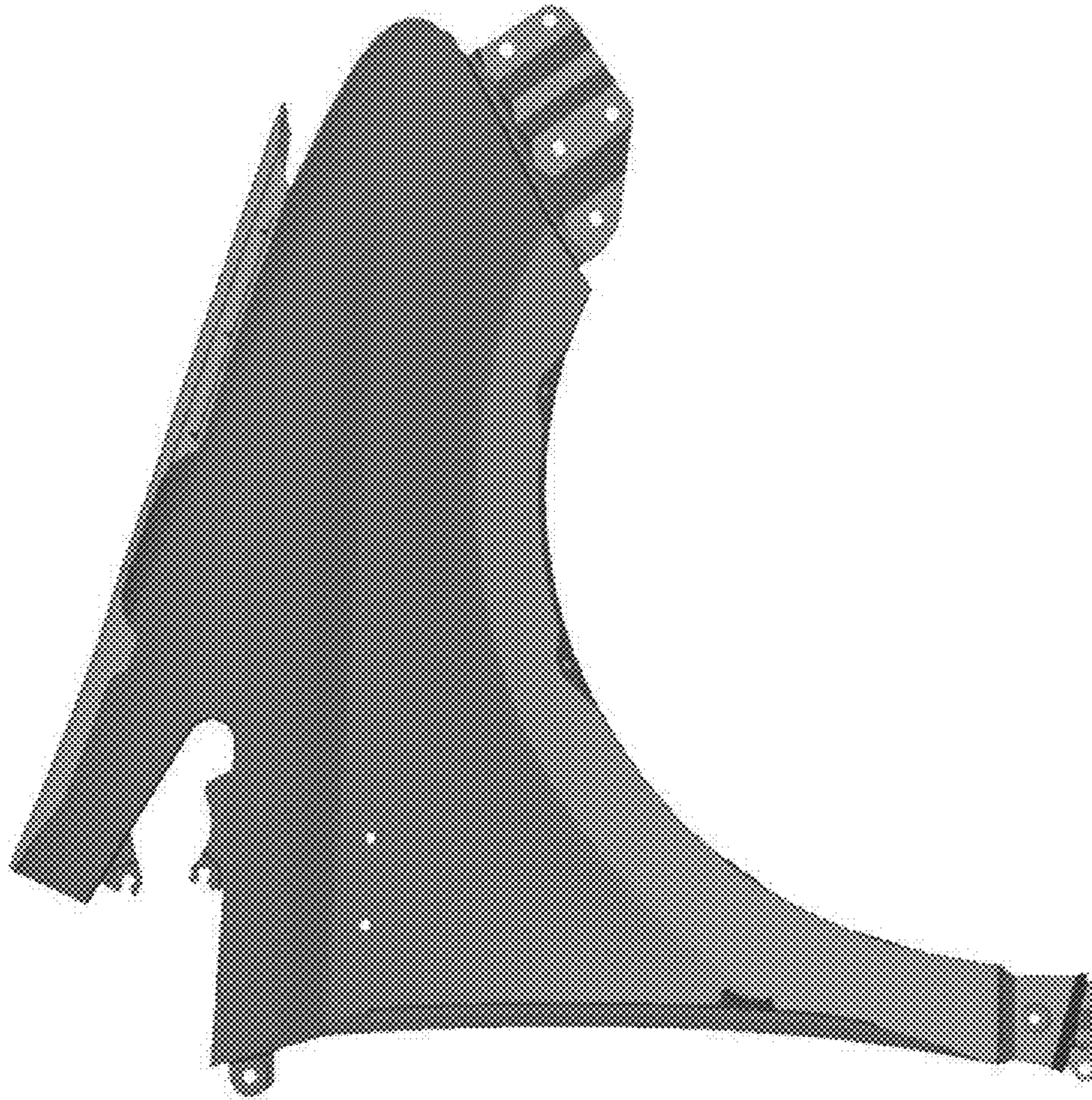
**FIG. 1**



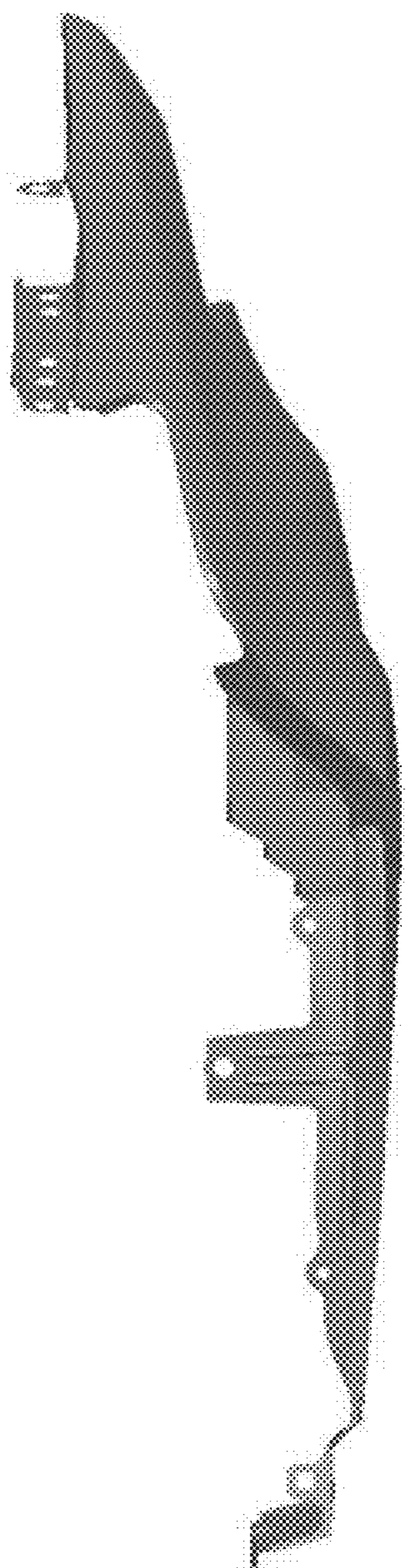
**FIG. 2**



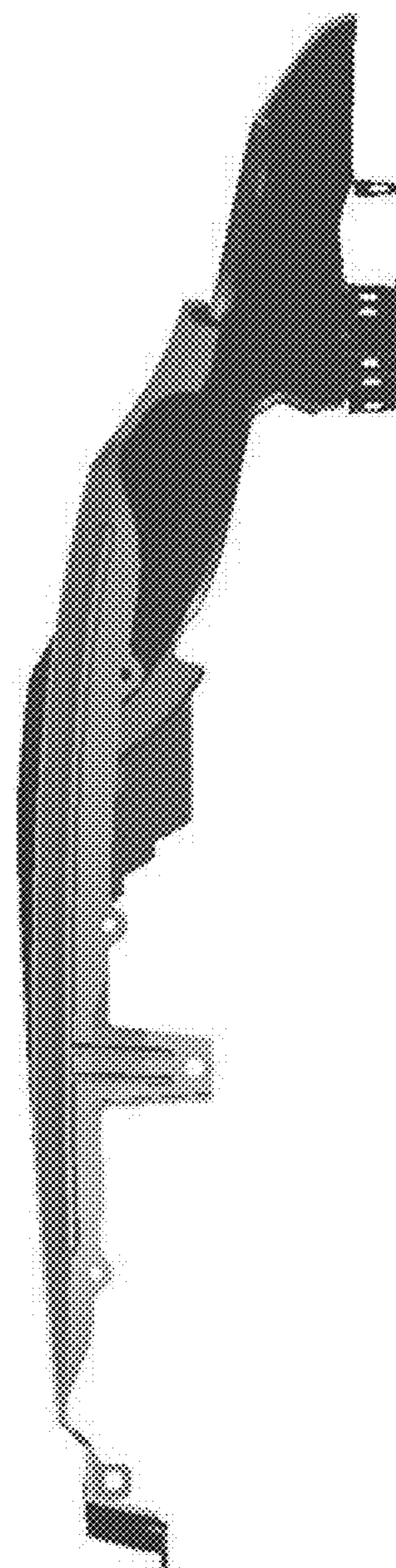
**FIG. 3**



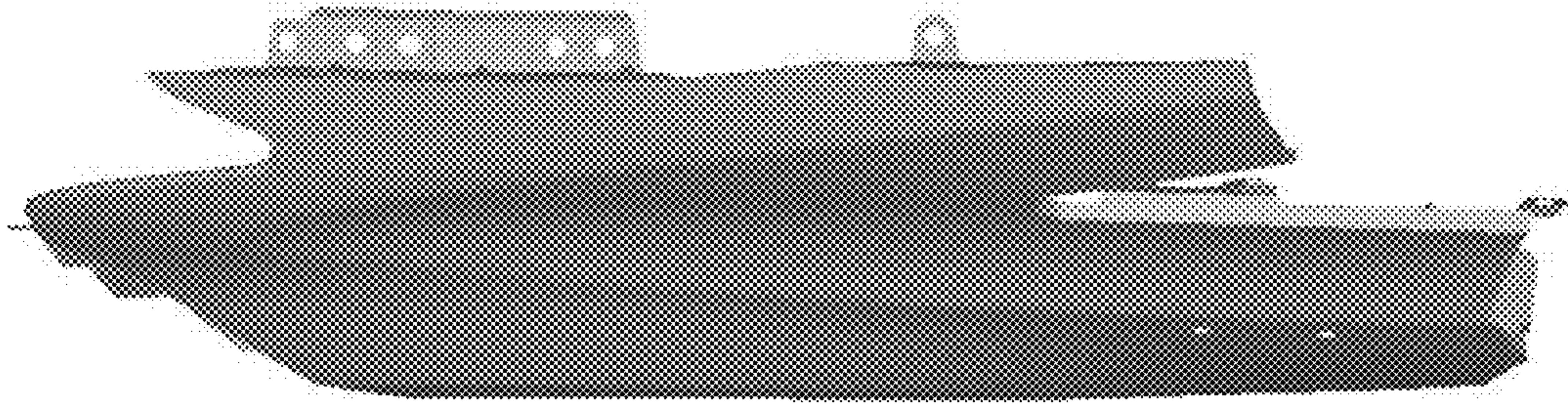
**FIG. 4**



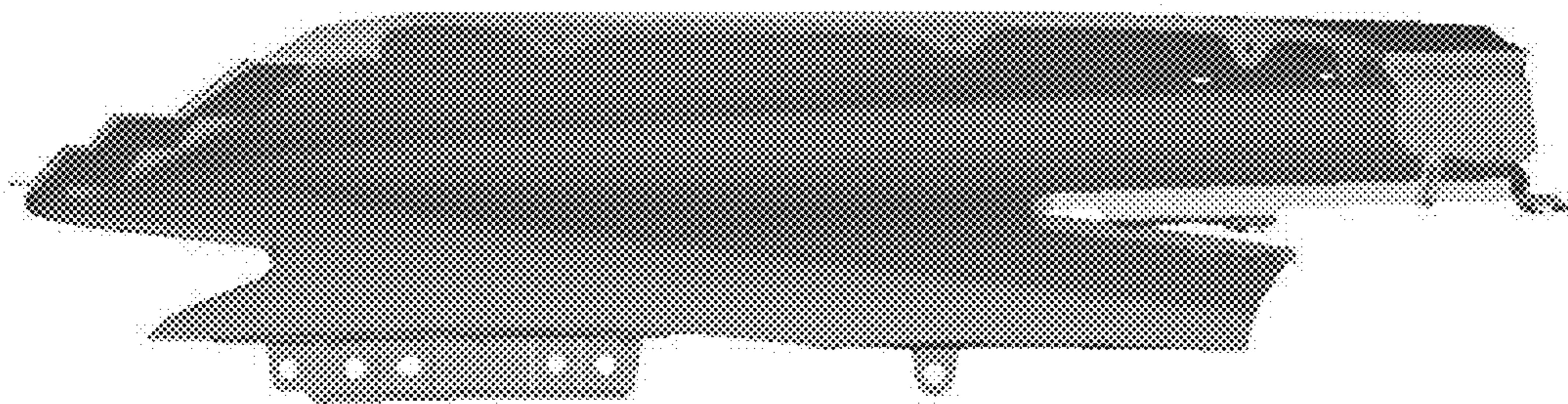
**FIG. 5**



**FIG. 6**



**FIG. 7**



**FIG. 8**