



US00D654826S

(12) **United States Design Patent**  
**Klinker**

(10) **Patent No.:** **US D654,826 S**

(45) **Date of Patent:** **\*\* Feb. 28, 2012**

(54) **RELIGIOUS ORNAMENT**

(76) Inventor: **Joseph Klinker**, Underwood, MN (US)

(\*\*) Term: **14 Years**

(21) Appl. No.: **29/401,635**

(22) Filed: **Sep. 13, 2011**

(51) **LOC (9) Cl.** ..... **11-03**

(52) **U.S. Cl.** ..... **D11/96**

(58) **Field of Classification Search** ..... D11/95-99,  
D11/116, 184, 1, 86, 40, 79, 81-82, 162,  
D11/157-158, 131, 66, 100, 103-104, 107,  
D11/13, 133, 172, 25, 41, 43, 48, 50, 58,  
D11/11; 63/1.11, 1.12, 1.13, 1.14, 1.16,  
63/1.18, 13, 14.1, 35, 39; D8/356

See application file for complete search history.

|              |         |                   |         |
|--------------|---------|-------------------|---------|
| D436,329 S   | 1/2001  | Sheridan          |         |
| D436,552 S * | 1/2001  | Sheridan          | D11/158 |
| D437,568 S * | 2/2001  | De Clerico et al. | D11/158 |
| D448,276 S * | 9/2001  | Kelleghan         | D8/356  |
| D484,433 S   | 12/2003 | Moody             |         |
| D527,303 S * | 8/2006  | Cavness           | D11/157 |
| D527,677 S * | 9/2006  | Cavness           | D11/158 |
| D570,242 S * | 6/2008  | Howle, III        | D11/50  |
| D586,686 S * | 2/2009  | Bell              | D11/82  |
| D599,246 S * | 9/2009  | Rudes             | D11/103 |
| D605,546 S * | 12/2009 | Castaline et al.  | D11/82  |
| D626,880 S * | 11/2010 | Castaline et al.  | D11/82  |
| D631,781 S * | 2/2011  | Mogren            | D11/96  |

\* cited by examiner

*Primary Examiner* — T. Chase Nelson

*Assistant Examiner* — Mark Cavanna

(74) *Attorney, Agent, or Firm* — Daniel Boudwin;  
Alexander Boyer

(56) **References Cited**

U.S. PATENT DOCUMENTS

|              |         |               |         |
|--------------|---------|---------------|---------|
| D200,870 S * | 4/1965  | Simpson       | D11/82  |
| D220,701 S * | 5/1971  | Honzik        | D11/81  |
| D238,811 S * | 2/1976  | Ziglar et al. | D11/48  |
| D252,387 S * | 7/1979  | Lawrence      | D11/131 |
| D314,728 S * | 2/1991  | Wick          | D11/50  |
| D382,226 S * | 8/1997  | Howard        | D11/100 |
| D391,192 S   | 2/1998  | Speedling     |         |
| D392,917 S * | 3/1998  | Cliff         | D11/131 |
| D401,883 S * | 12/1998 | Madhvani      | D11/81  |
| D415,715 S * | 10/1999 | Cliff         | D11/162 |
| D420,177 S   | 2/2000  | Jones         |         |
| D432,458 S * | 10/2000 | Cliff         | D11/162 |

(57) **CLAIM**

The ornamental design for religious ornament, as shown and described.

**DESCRIPTION**

FIG. 1 is a front view of a religious ornament showing my new design;  
FIG. 2 is an end view thereof; and,  
FIG. 3 is an underside perspective view thereof.

**1 Claim, 2 Drawing Sheets**

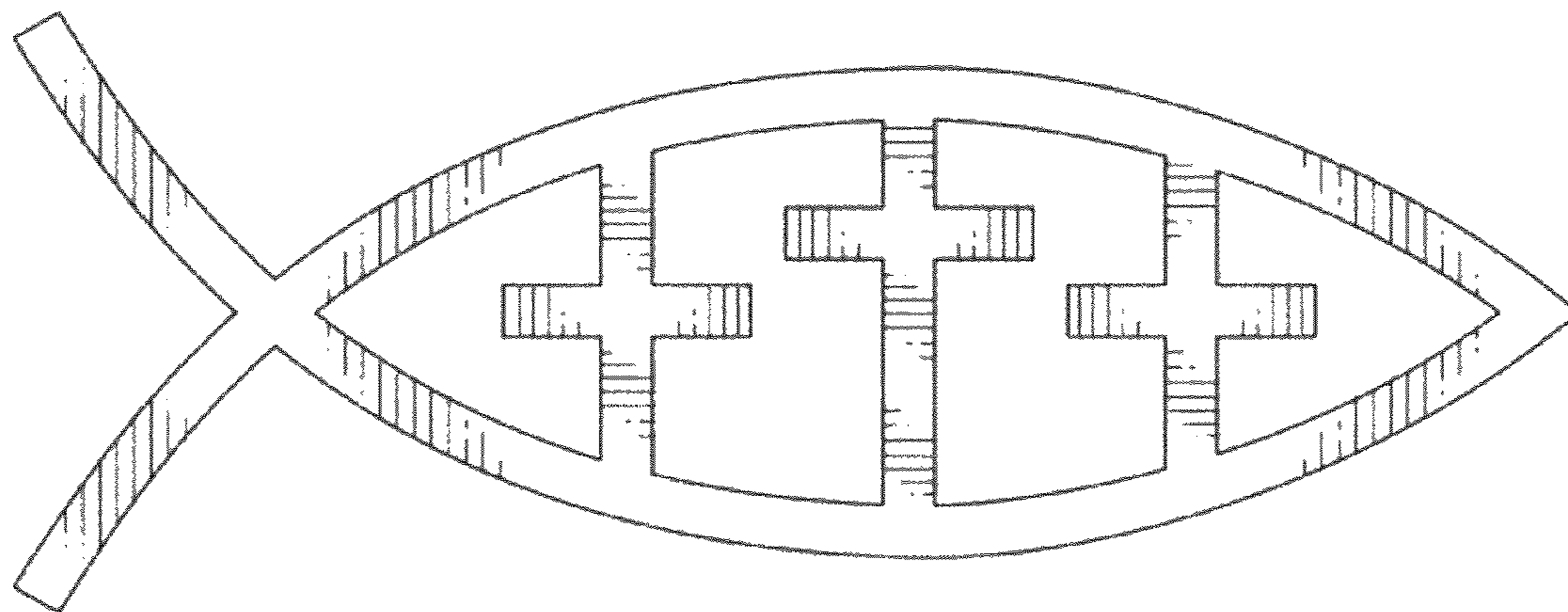

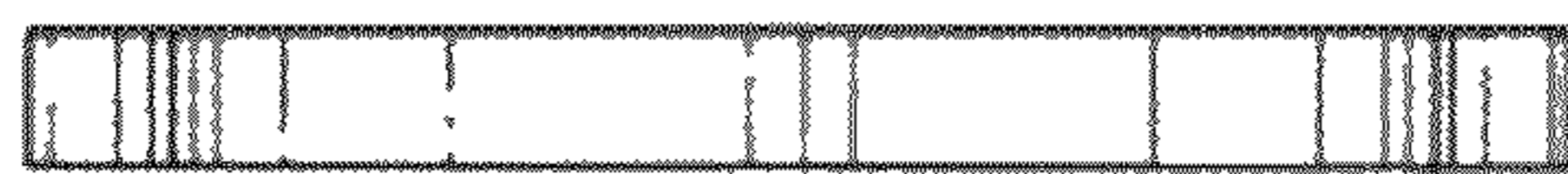

FIG. 2

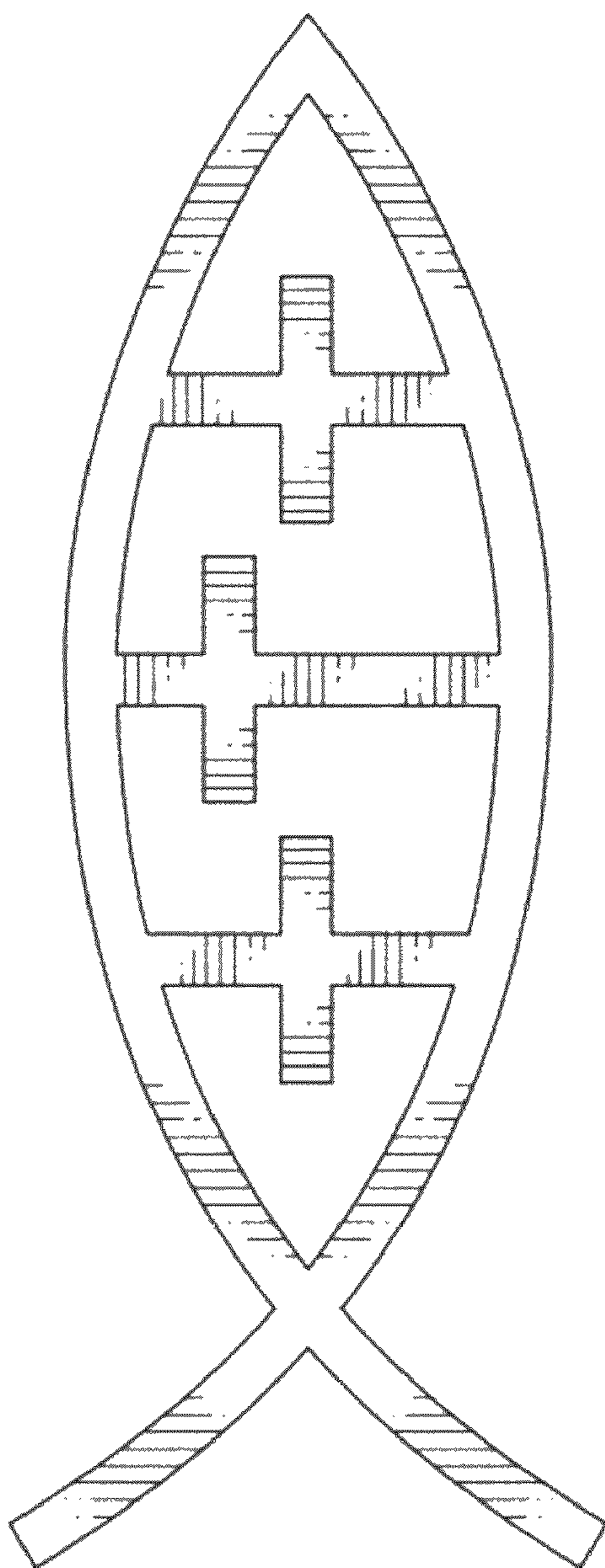

FIG. 1

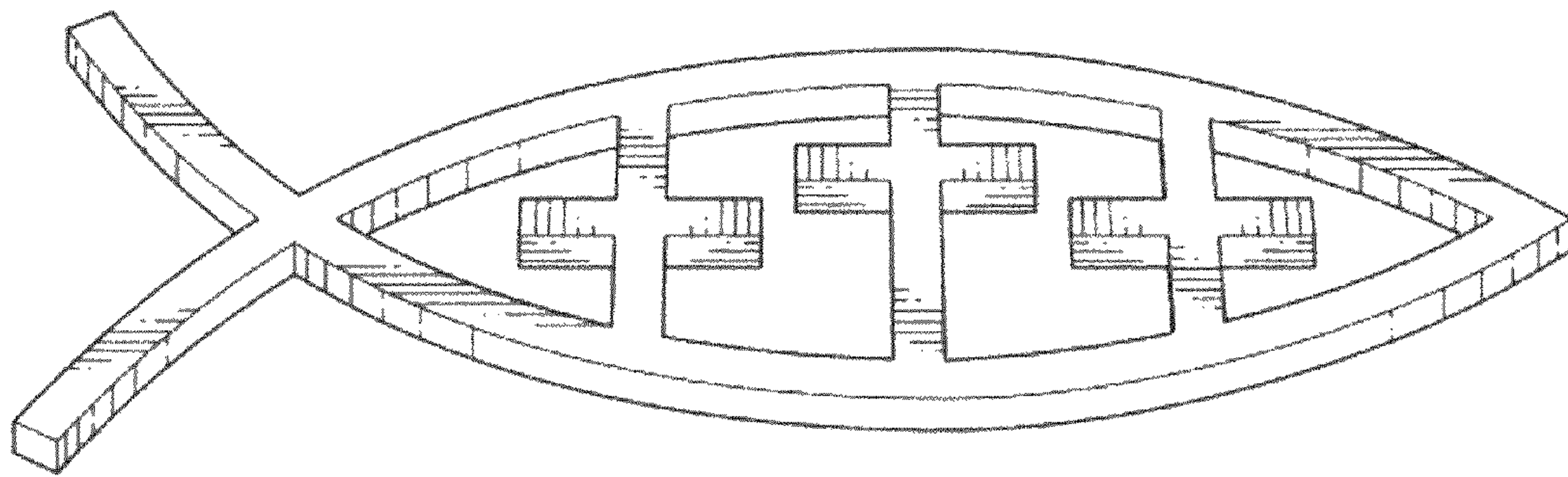

FIG. 3