



US00D654400S

(12) **United States Design Patent**  
**Dolesh**

(10) **Patent No.:** **US D654,400 S**

(45) **Date of Patent:** **\*\* Feb. 21, 2012**

(54) **TRUCK CAB**

(75) Inventor: **William L. Dolesh**, Richmond, IN (US)

(73) Assignee: **Autocar Industries, LLC**, Hagerstown, IN (US)

(\*\*) Term: **14 Years**

(21) Appl. No.: **29/343,710**

(22) Filed: **Sep. 17, 2009**

(51) **LOC (9) Cl.** ..... **12-16**

(52) **U.S. Cl.** ..... **D12/96; D15/30**

(58) **Field of Classification Search** ..... D12/93,  
D12/96, 97, 99; D15/10, 28, 23, 30; 180/89.16,  
180/89.18, 89.19, 89.1, 89.12, 89.13; 296/183.1,  
296/190.1, 190.01; 187/237, 238, 414; 414/680,  
414/685-688, 694

See application file for complete search history.

(56) **References Cited**

**U.S. PATENT DOCUMENTS**

5,330,222	A	7/1994	Halverson	
5,579,860	A	12/1996	Halverson	
D389,984	S	1/1998	Johansson	
D502,296	S	* 2/2005	Cunningham	..... D12/96
D529,411	S	* 10/2006	Fairbairn	..... D12/96
D570,381	S	* 6/2008	Kato	..... D15/30
D571,074	S	* 6/2008	Buchmann et al.	..... D34/35
D594,480	S	* 6/2009	Gicquel et al.	..... D15/30

D598,032	S	* 8/2009	Nakanishi et al.	..... D15/30
D607,904	S	* 1/2010	Reisenauer et al.	..... D15/30
D607,905	S	* 1/2010	Reisenauer et al.	..... D15/30

\* cited by examiner

*Primary Examiner* — Melody N Brown

(74) *Attorney, Agent, or Firm* — Banner & Witcoff, Ltd.

(57) **CLAIM**

We claim the ornamental design for a truck cab, as shown and described.

**DESCRIPTION**

FIG. 1 is a front perspective view of a truck cab showing our new design;

FIG. 2 is another perspective view of a truck cab shown in FIGS. 1 and 2;

FIG. 3 is a front view of the truck cab shown in FIGS. 1 and 2;

FIG. 4 is a right side view of the truck cab shown in FIGS. 1 and 2;

FIG. 5 is a left side view of the truck cab shown in FIGS. 1 and 2;

FIG. 6 is a rear view of the truck cab shown in FIGS. 1 and 2; and,

FIG. 7 is a top view of the truck cab shown in FIGS. 1 and 2. The bottom view is plain and unornamented.

The truck vehicle portions shown in broken lines are for illustrative purposes only and form no part of the claimed design.

**1 Claim, 4 Drawing Sheets**

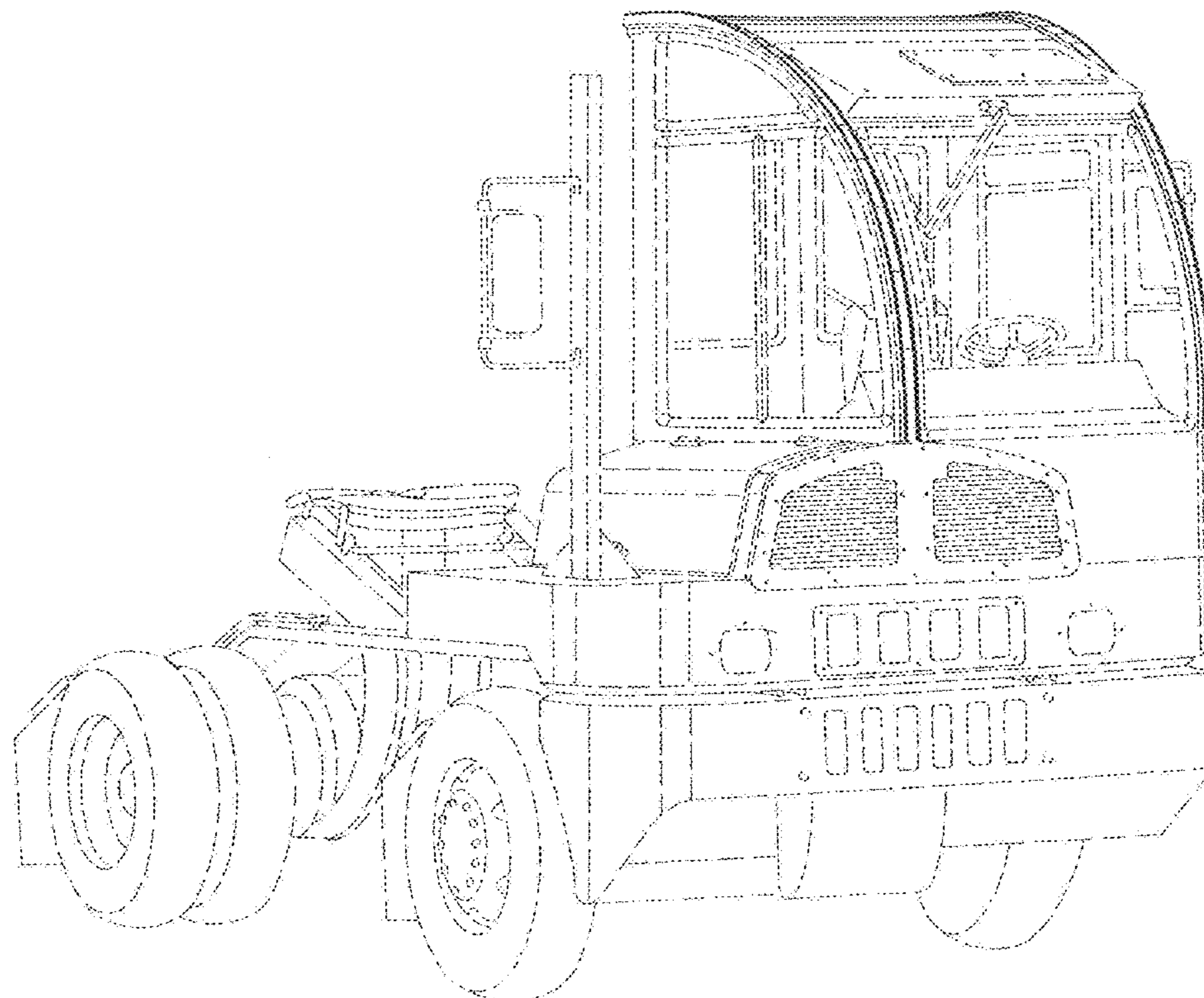

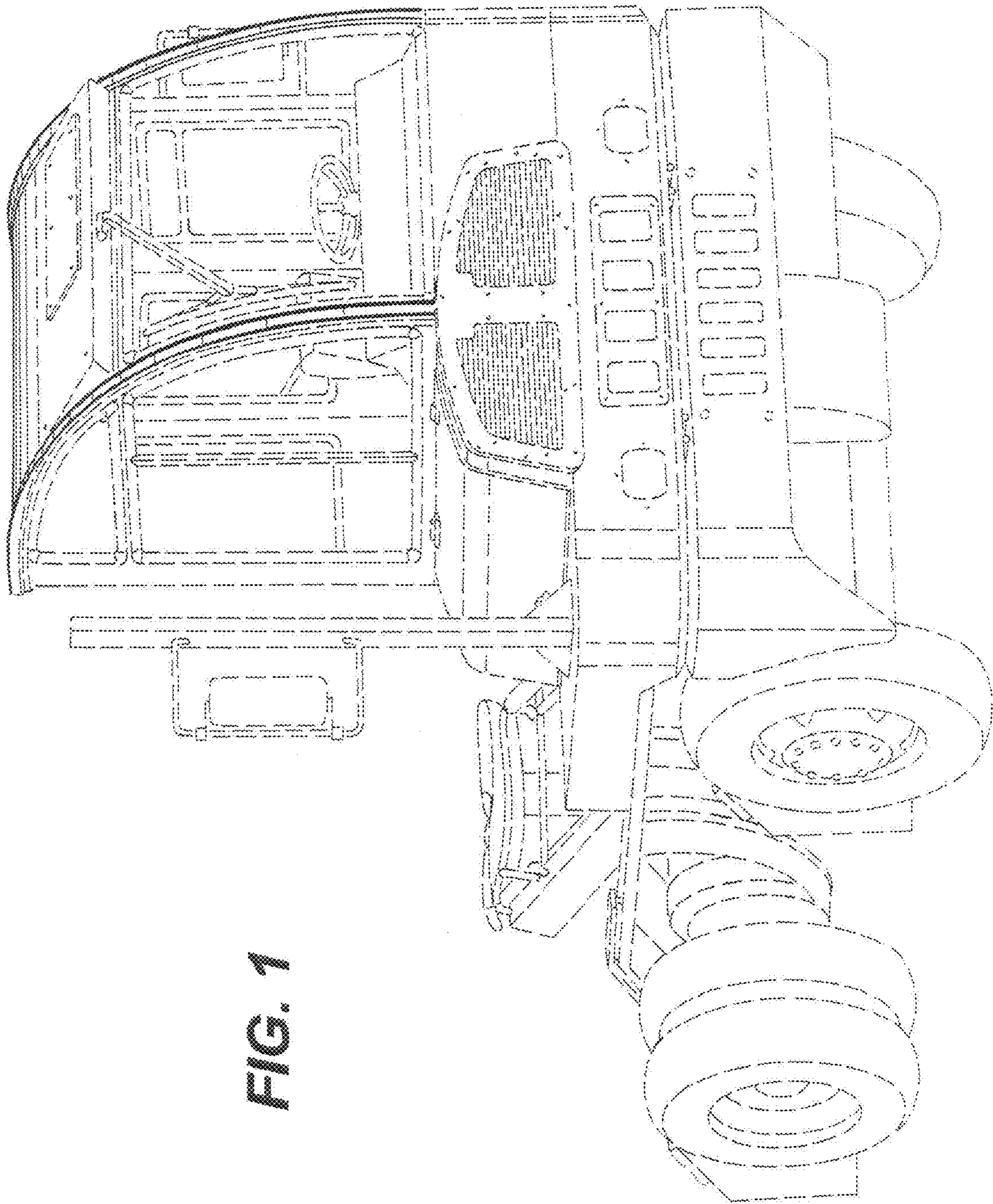

**FIG. 1**



FIG. 3

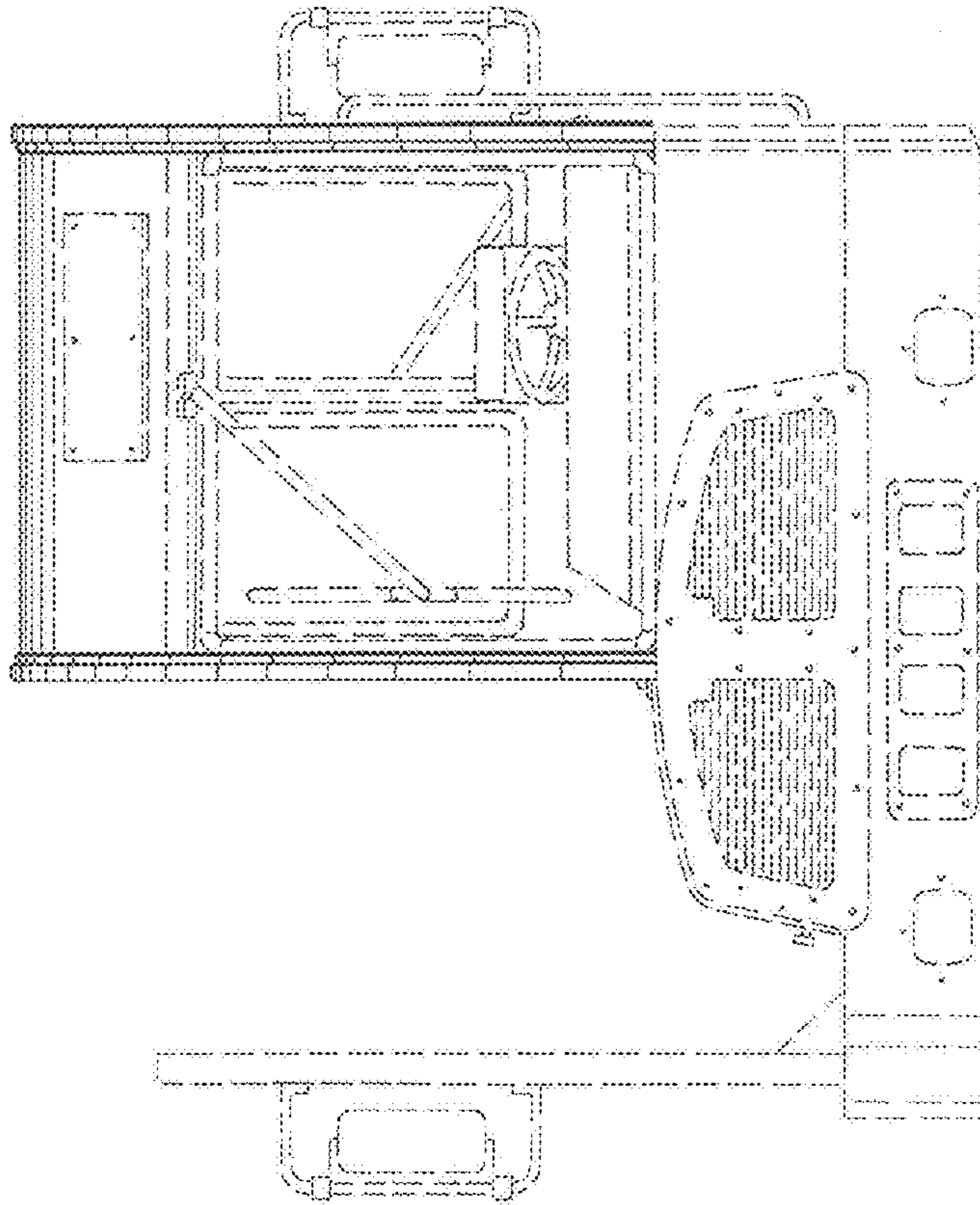
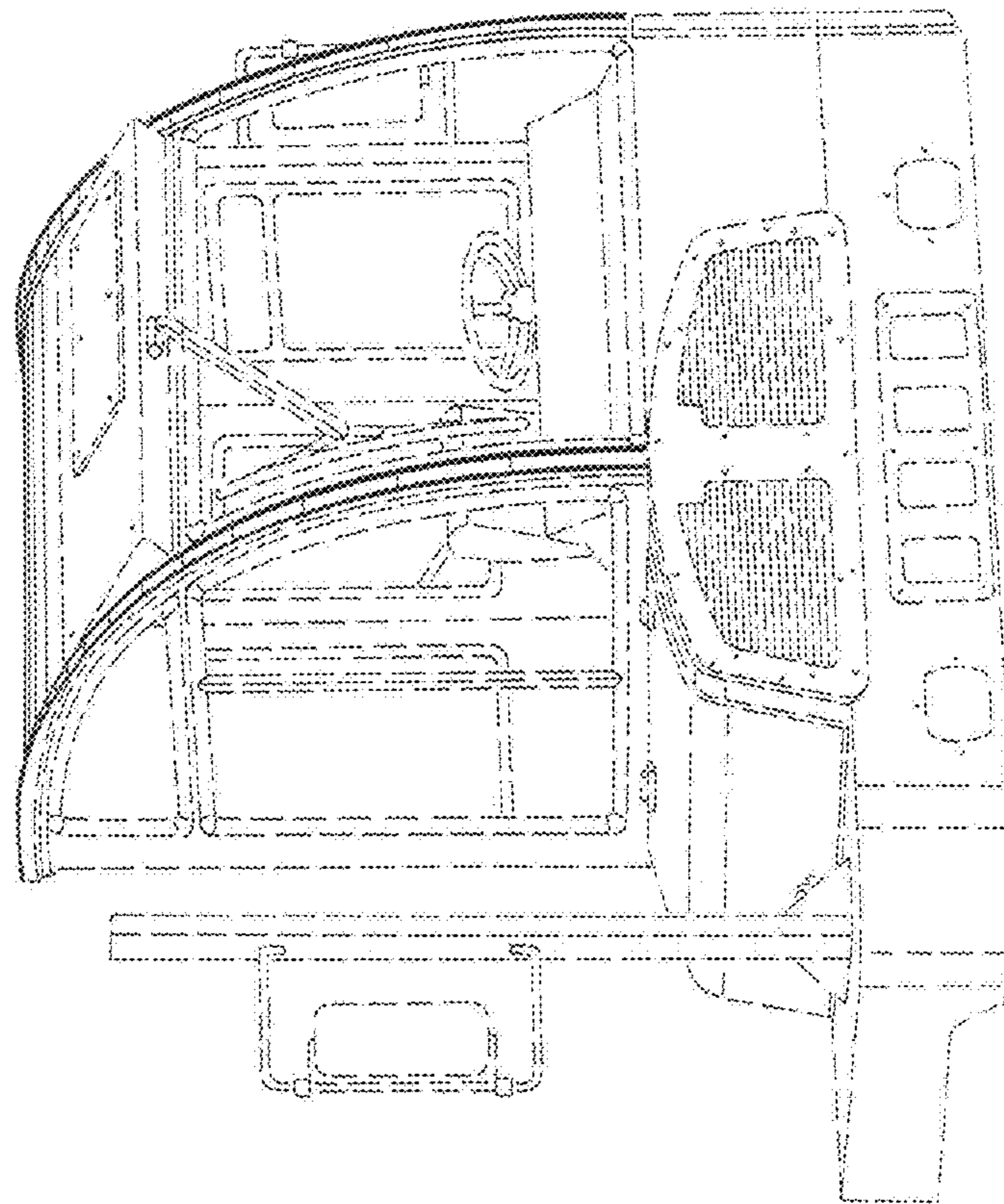
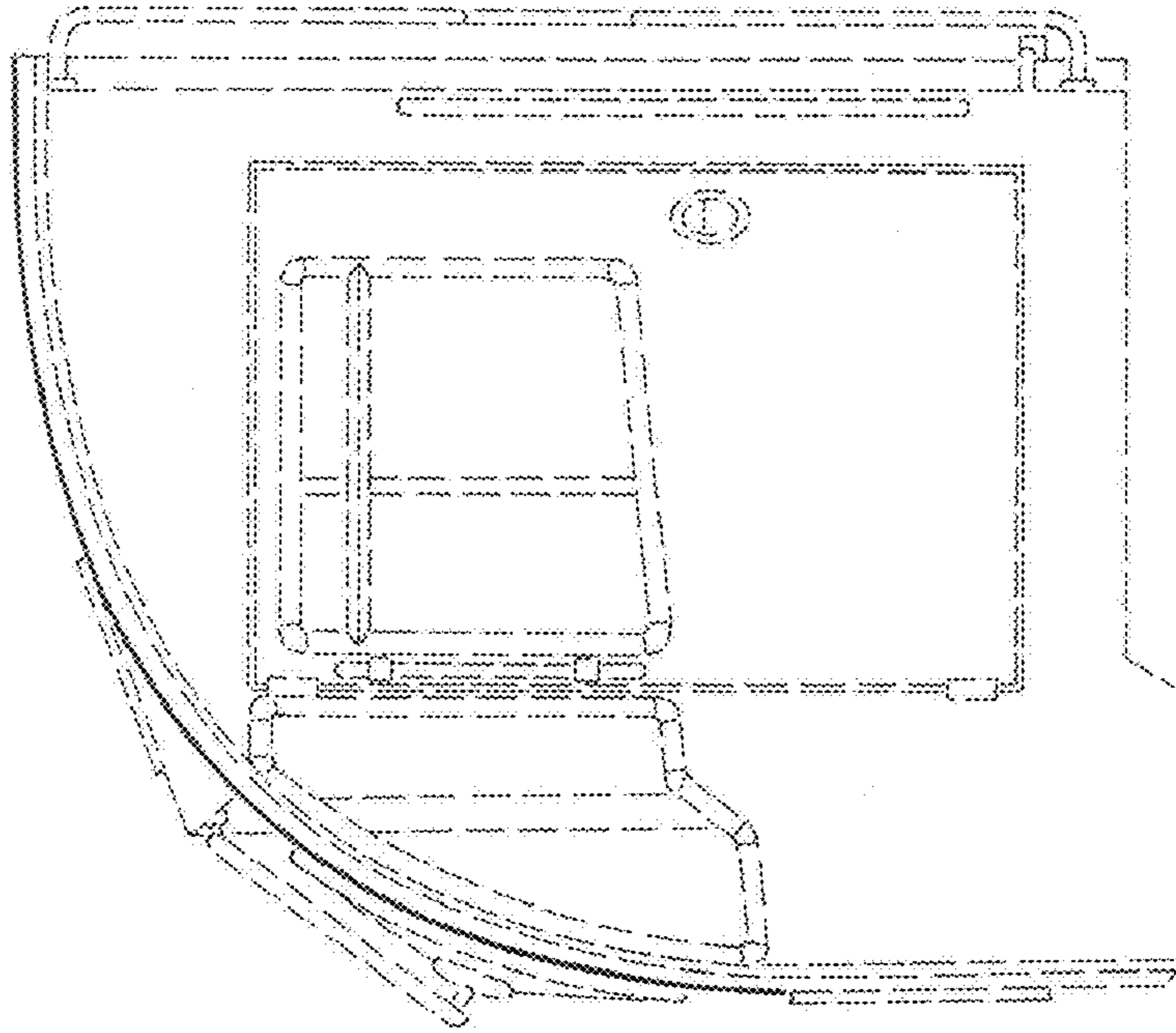

FIG. 2



**FIG. 5**



**FIG. 4**

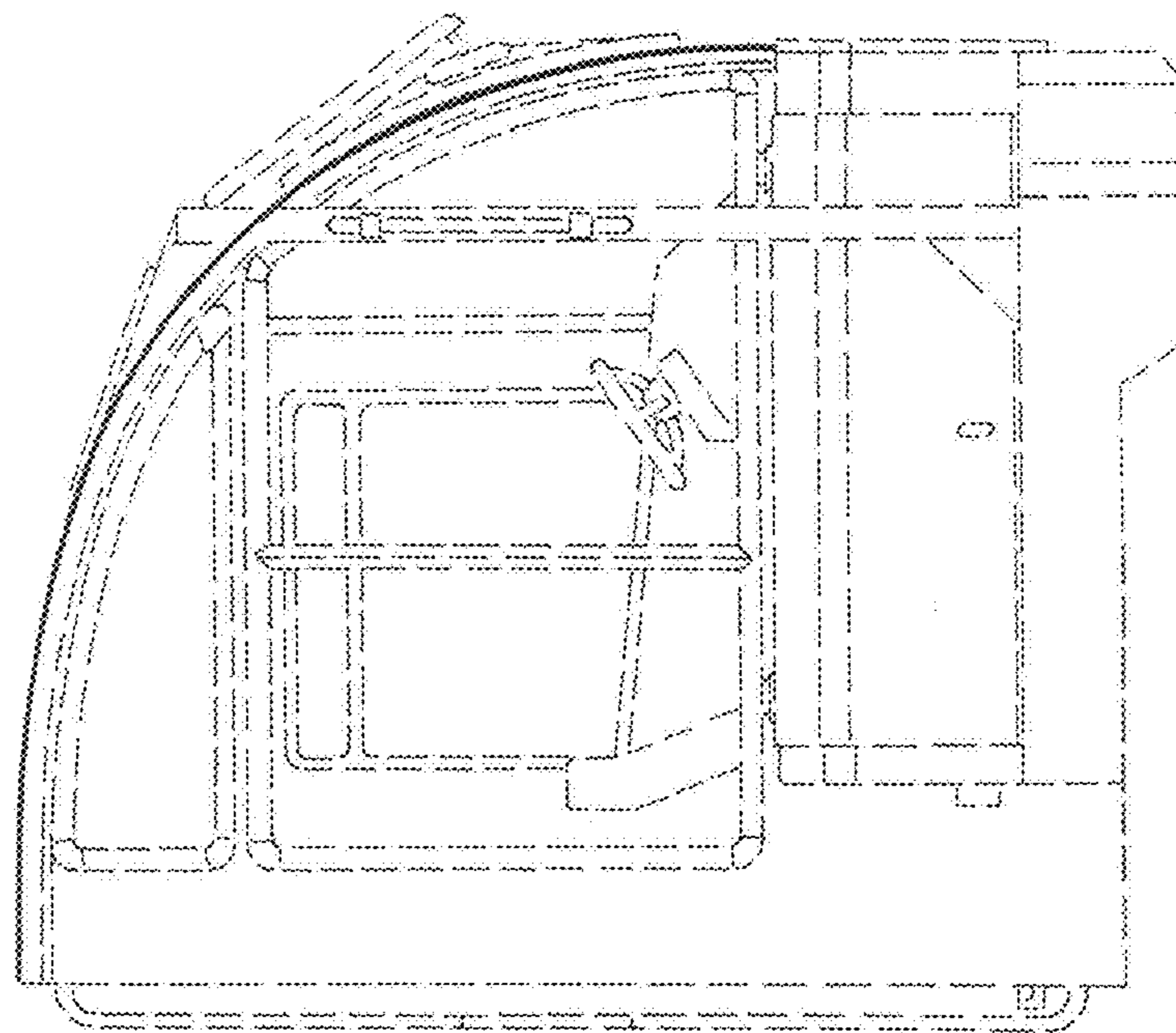

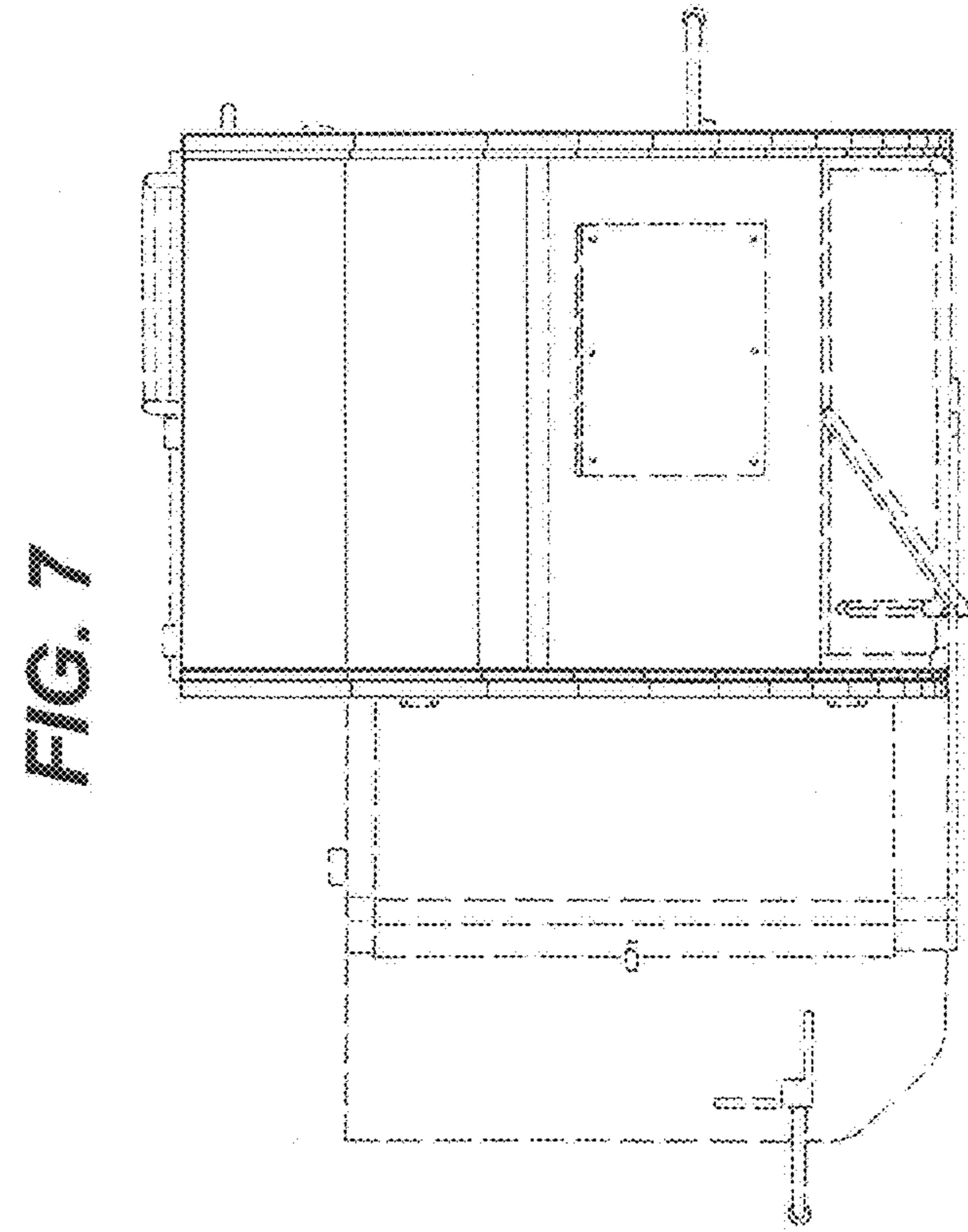

FIG. 7

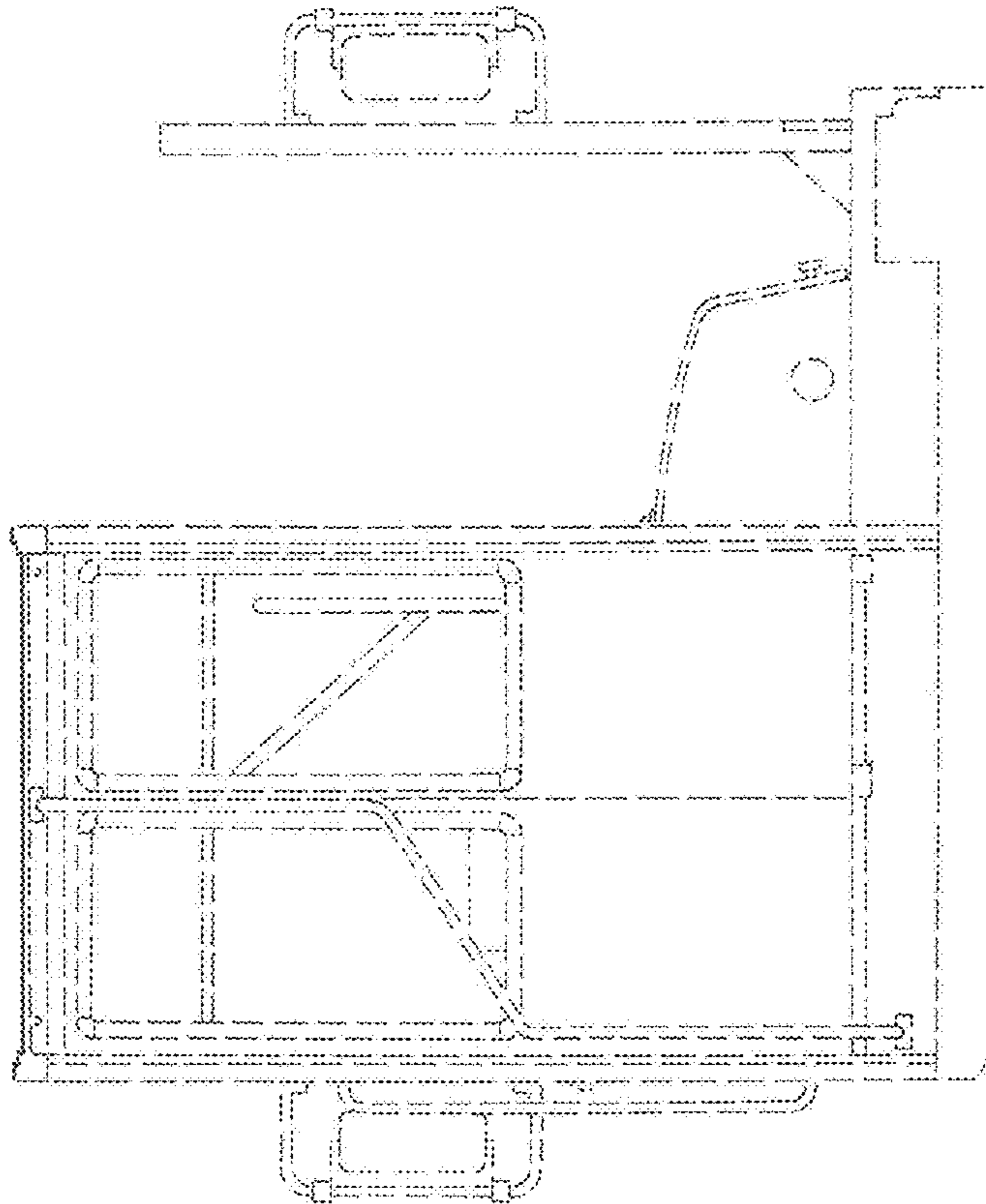

FIG. 6