



US00D654167S

(12) **United States Design Patent**  
**Fisher et al.**

(10) **Patent No.:** **US D654,167 S**  
(45) **Date of Patent:** **\*\* Feb. 14, 2012**

- (54) **SURGICAL SAW DEVICE**
- (75) Inventors: **Michael G. Fisher**, Reno, NV (US);  
**John Anes**, Reno, NV (US)
- (73) Assignee: **Sevika Holding AG**, Baar (CH)
- (\*\*) Term: **14 Years**
- (21) Appl. No.: **29/355,170**
- (22) Filed: **Feb. 3, 2010**

6,770,071	B2 *	8/2004	Woloszko et al.	606/41
6,857,192	B1	2/2005	Summers et al.	30/294
7,060,072	B2	6/2006	Wolff et al.	606/84
D525,707	S	7/2006	Kullmer et al.	D24/146
D552,239	S	10/2007	Wolff	D24/147
7,322,985	B2	1/2008	Lee	606/71
D576,729	S	9/2008	Tanaka et al.	D24/144
D586,633	S	2/2009	Taylor et al.	D8/20
D622,383	S *	8/2010	Fisher et al.	D24/146
7,901,424	B2 *	3/2011	Fletcher et al.	606/176
2003/0014067	A1	1/2003	Kullmer et al.	606/172
2005/0245935	A1	11/2005	Casey et al.	606/82

\* cited by examiner

**Related U.S. Application Data**

- (63) Continuation-in-part of application No. 29/340,589, filed on Jul. 21, 2009, now Pat. No. Des. 622,383.

*Primary Examiner* — Freda S Nunn

(74) *Attorney, Agent, or Firm* — Knobbe, Martens, Olson & Bear LLP

(30) **Foreign Application Priority Data**

Jan. 21, 2010 (EM) ..... 1001190698

- (51) **LOC (9) Cl.** ..... **24-02**
- (52) **U.S. Cl.** ..... **D24/146**
- (58) **Field of Classification Search** ..... D8/20,  
D8/26, 64; D24/146, 147; 30/151, 162,  
30/163, 166.3, 335; 606/82, 85, 176-179  
See application file for complete search history.

(57) **CLAIM**

The ornamental design for a surgical saw device, as shown and described.

**DESCRIPTION**

FIG. 1 is a perspective view of a second embodiment of a surgical saw device showing our new design;  
 FIG. 2 is a right side elevational view thereof, the opposite side elevational view being identical thereto;  
 FIG. 3 is a top plan view thereof;  
 FIG. 4 is a bottom plan view thereof;  
 FIG. 5 is a rear elevational view thereof; and  
 FIG. 6 is a front elevational view thereof.  
 FIG. 7 is a perspective view of a fourth embodiment of a surgical saw device showing our new design;  
 FIG. 8 is a right side elevational view thereof, the opposite side elevational view being identical thereto;  
 FIG. 9 is a top plan view thereof;  
 FIG. 10 is a bottom plan view thereof;  
 FIG. 11 is a rear elevational view thereof; and  
 FIG. 12 is a front elevational view thereof.  
 FIG. 13 is a perspective view of a sixth embodiment of a surgical saw device showing our new design;  
 FIG. 14 is a right side elevational view thereof, the opposite side elevational view being identical thereto;  
 FIG. 15 is a top plan view thereof;  
 FIG. 16 is a bottom plan view thereof;

(56) **References Cited**

**U.S. PATENT DOCUMENTS**

D3,994	S	4/1870	Moore	D8/20
D4,255	S	7/1870	Rhodes	D8/20
D4,497	S	11/1870	Rhodes	D8/20
D4,706	S	3/1871	Kidd	D8/20
D5,226	S	8/1871	Miller	D8/20
3,016,932	A	1/1962	Jacobson	30/369
3,905,374	A *	9/1975	Winter	606/178
4,584,999	A *	4/1986	Arnegger	606/178
4,934,056	A	6/1990	Leini	30/369
5,306,285	A	4/1994	Miller et al.	606/177
5,681,314	A	10/1997	Derouin et al.	606/79
5,725,530	A	3/1998	Popken	606/82
5,735,866	A *	4/1998	Adams et al.	606/178
5,916,218	A *	6/1999	Hagen et al.	606/82
6,007,541	A *	12/1999	Scott	606/82
6,063,083	A	5/2000	Duong-Van	606/45
6,503,253	B1 *	1/2003	Fletcher et al.	606/79

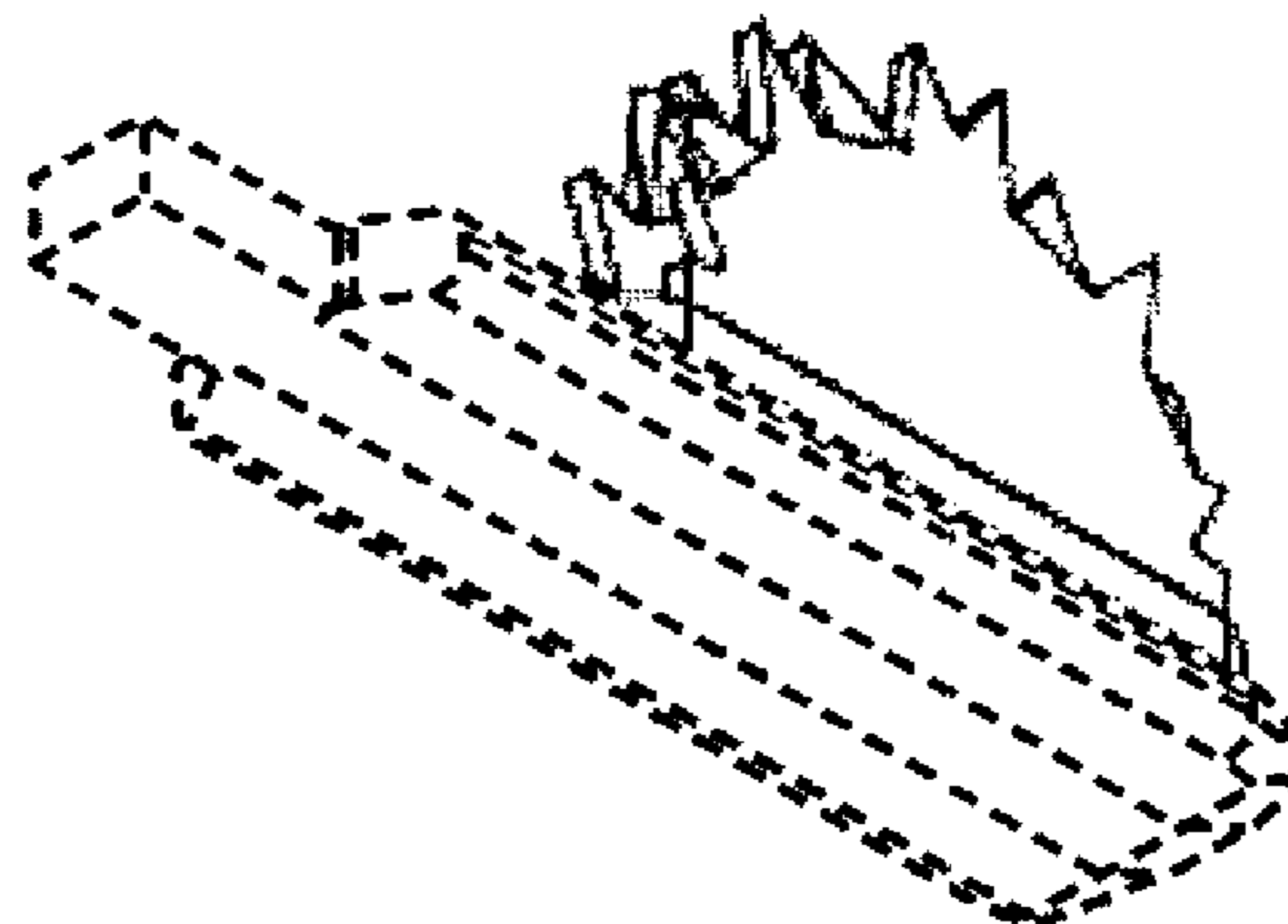

FIG. 17 is a rear elevational view thereof; and  
FIG. 18 is a front elevational view thereof.  
FIG. 19 is a perspective view of an eighth embodiment of a surgical saw device showing our new design;  
FIG. 20 is a right side elevational view thereof, the opposite side elevational view being identical thereto;  
FIG. 21 is a top plan view thereof;  
FIG. 22 is a bottom plan view thereof;  
FIG. 23 is a rear elevational view thereof; and  
FIG. 24 is a front elevational view thereof.  
FIG. 25 is a perspective view of a tenth embodiment of a surgical saw device showing our new design;  
FIG. 26 is a right side elevational view thereof, the opposite side elevational view being identical thereto;  
FIG. 27 is a top plan view thereof;  
FIG. 28 is a bottom plan view thereof;  
FIG. 29 is a rear elevational view thereof; and,  
FIG. 30 is a front elevational view thereof.

FIG. 31 is a perspective view of a twelfth embodiment of a surgical saw device showing our new design;  
FIG. 32 is a right side elevational view thereof, the opposite side elevational view being identical thereto;  
FIG. 33 is a top plan view thereof;  
FIG. 34 is a bottom plan view thereof;  
FIG. 35 is a rear elevational view thereof; and  
FIG. 36 is a front elevational view thereof.  
FIG. 37 is a perspective view of a fourteenth embodiment of a surgical saw device showing our new design;  
FIG. 38 is a right side elevational view thereof, the opposite side elevational view being identical thereto;  
FIG. 39 is a top plan view thereof;  
FIG. 40 is a bottom plan view thereof;  
FIG. 41 is a rear elevational view thereof; and,  
FIG. 42 is a front elevational view thereof.  
Broken lines shown in the drawings illustrate portions of the surgical saw device, and form no part of the claimed design.

**1 Claim, 7 Drawing Sheets**

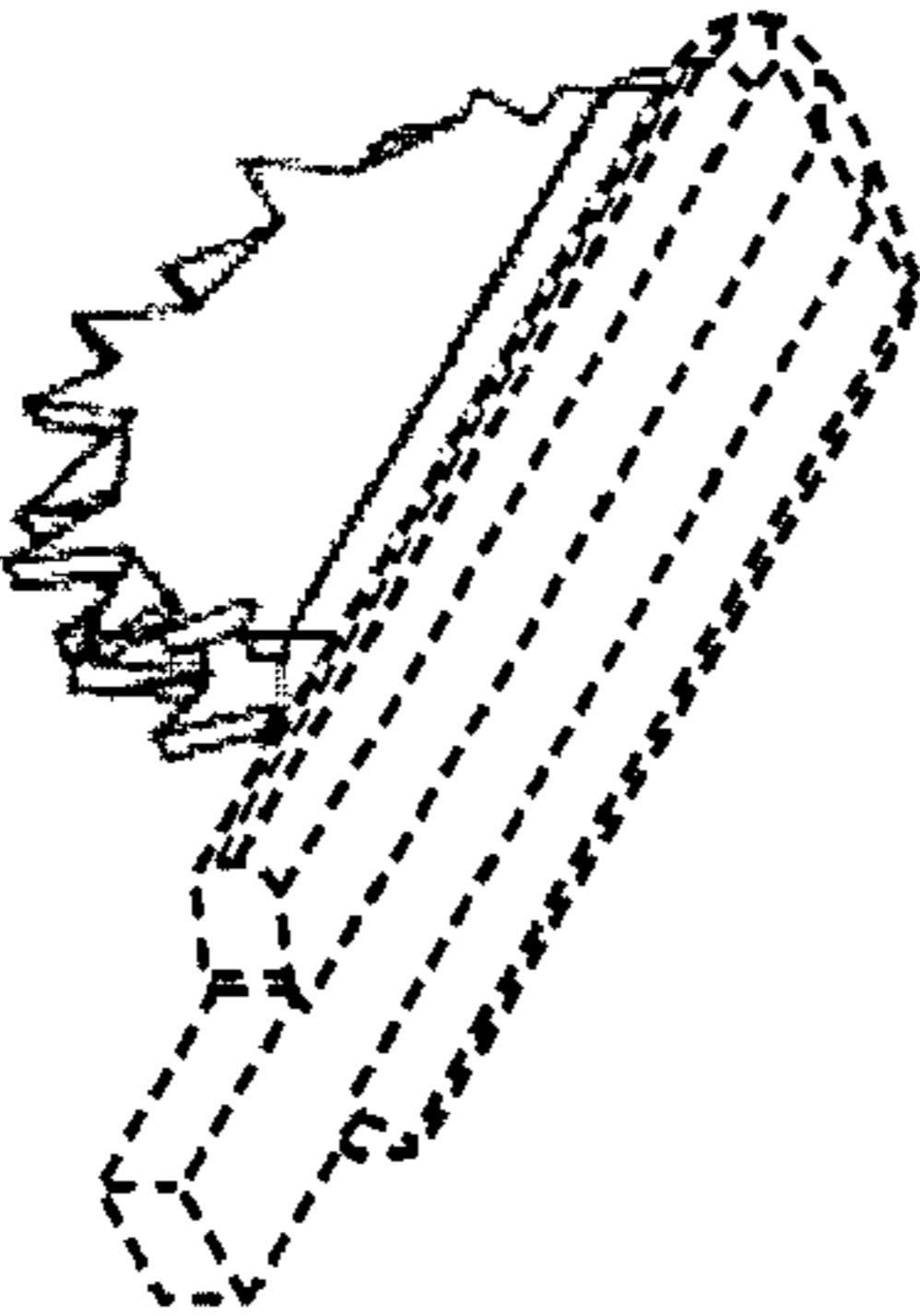

FIG. 1

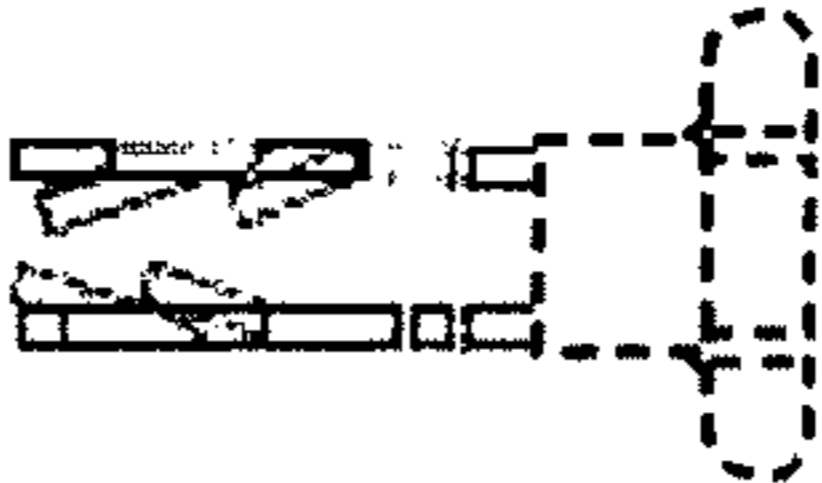

FIG. 6

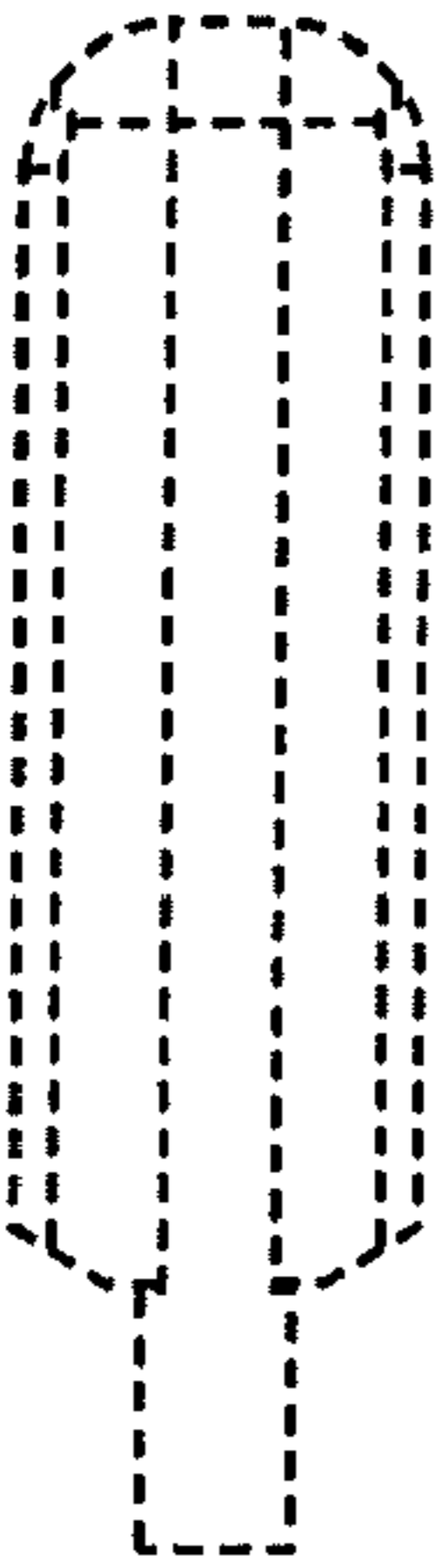

FIG. 3

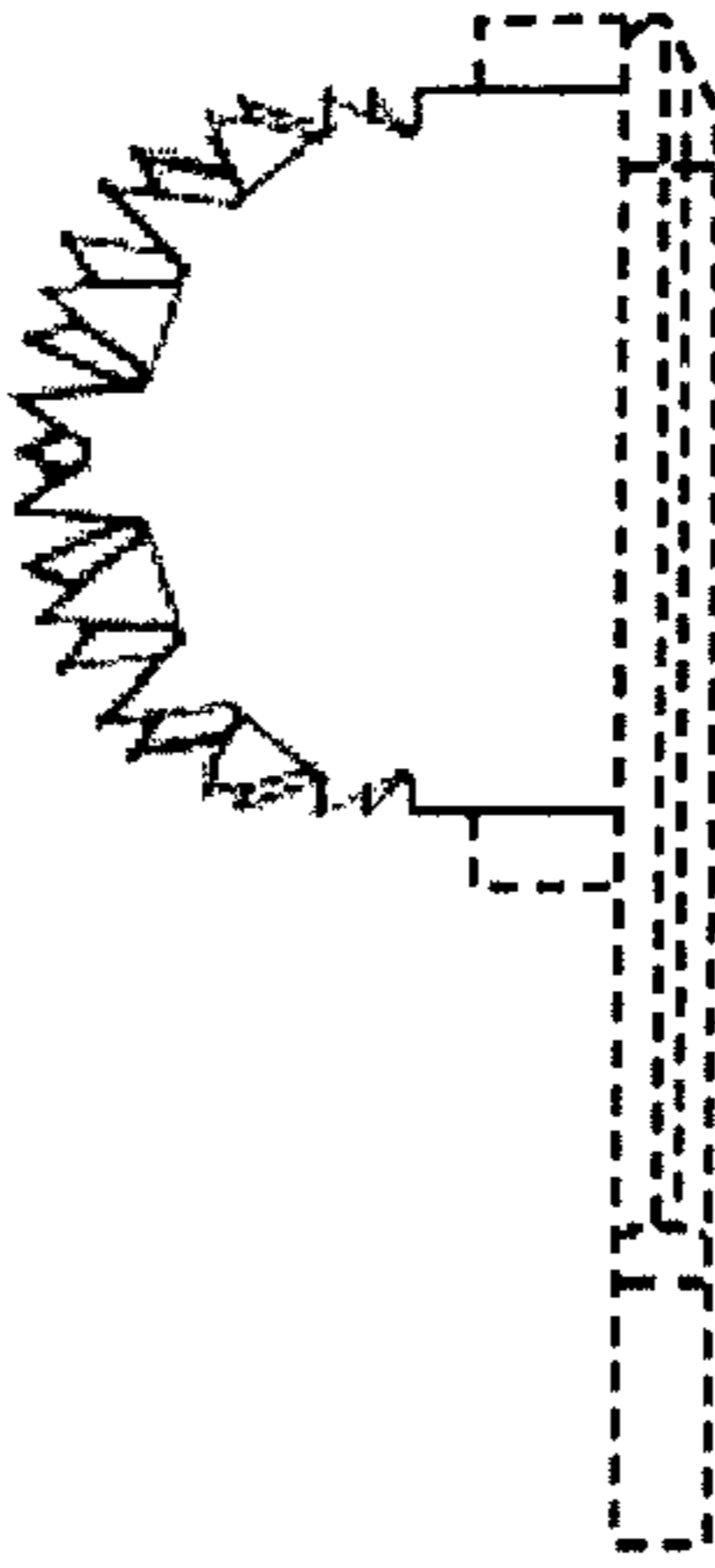

FIG. 2



FIG. 4

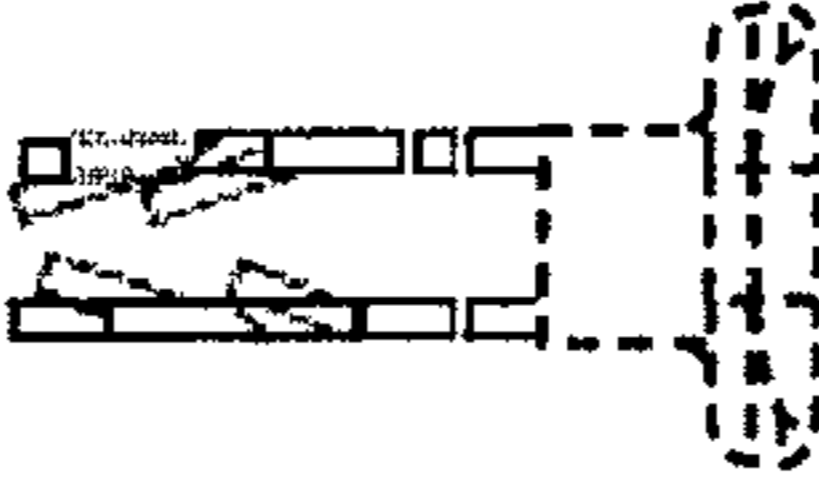

FIG. 5

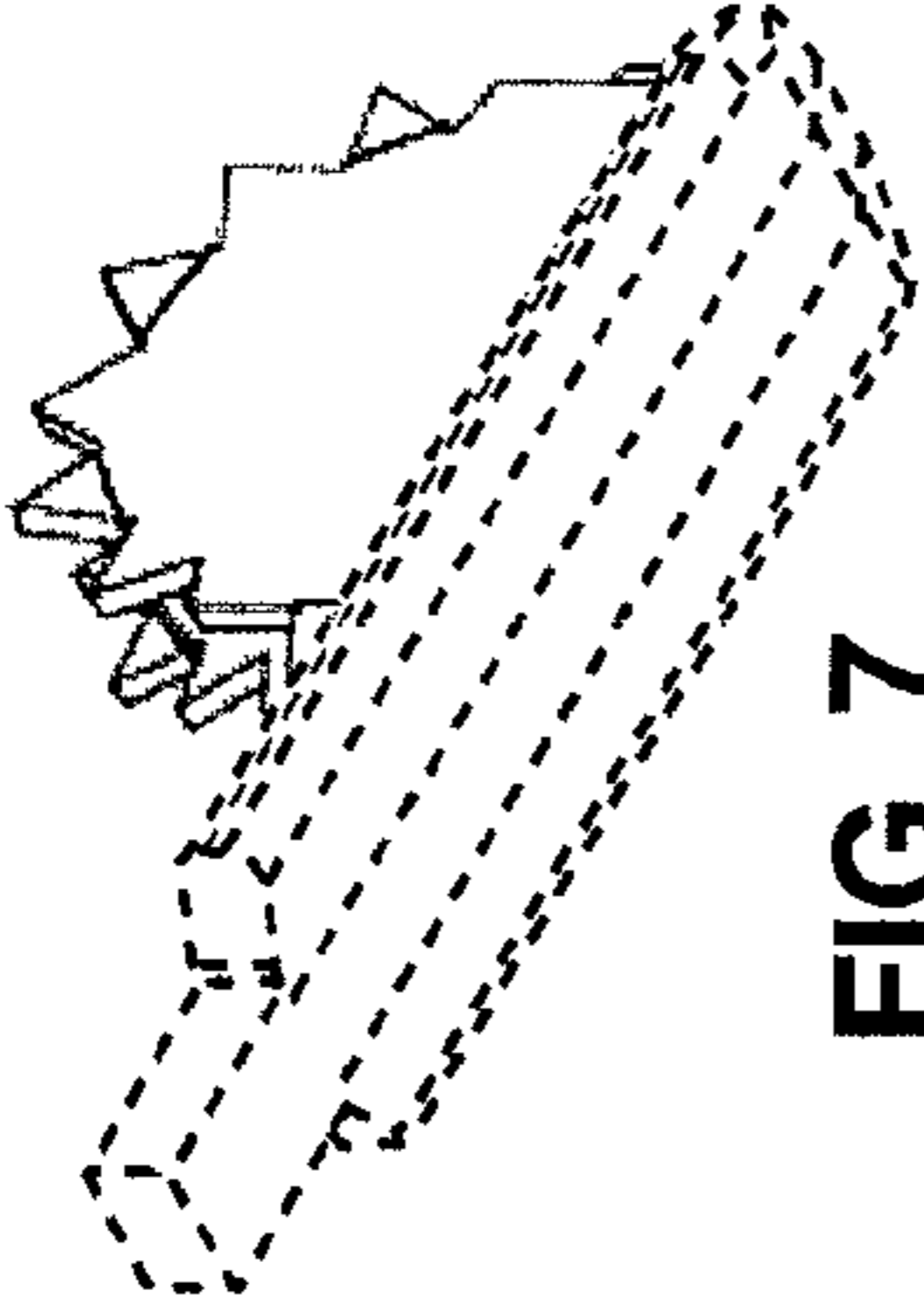

FIG. 7

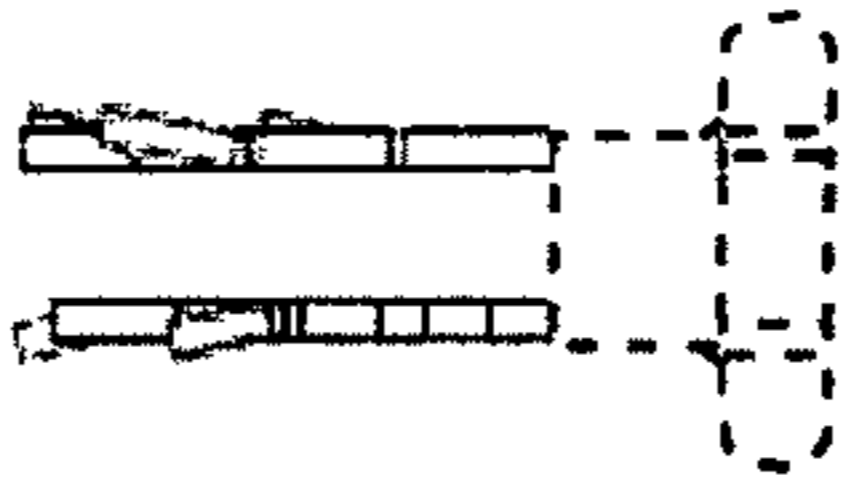

FIG. 12

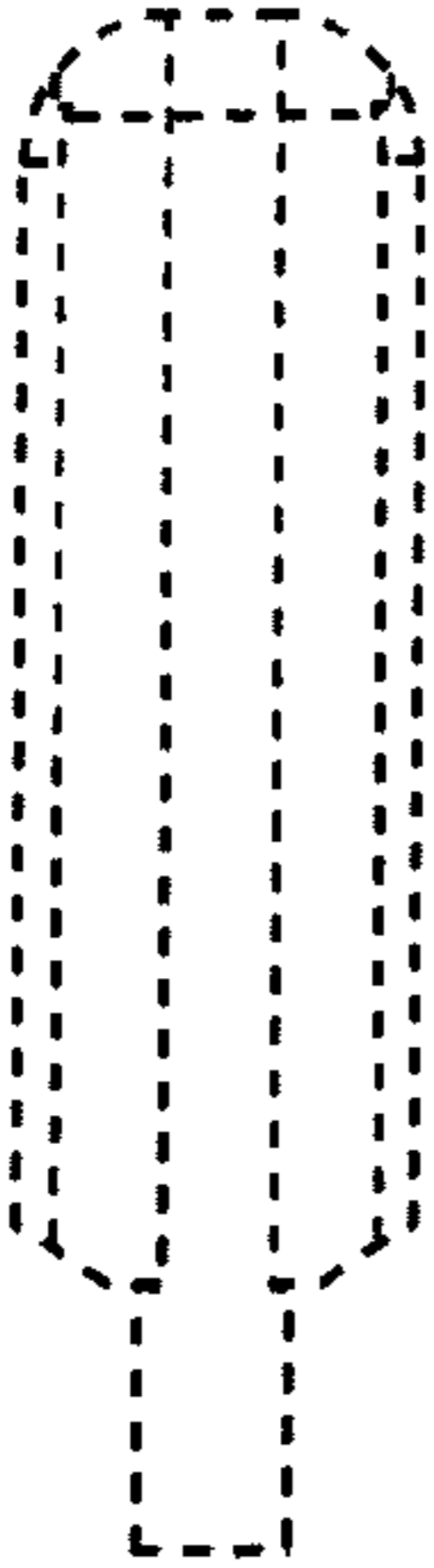

FIG. 9

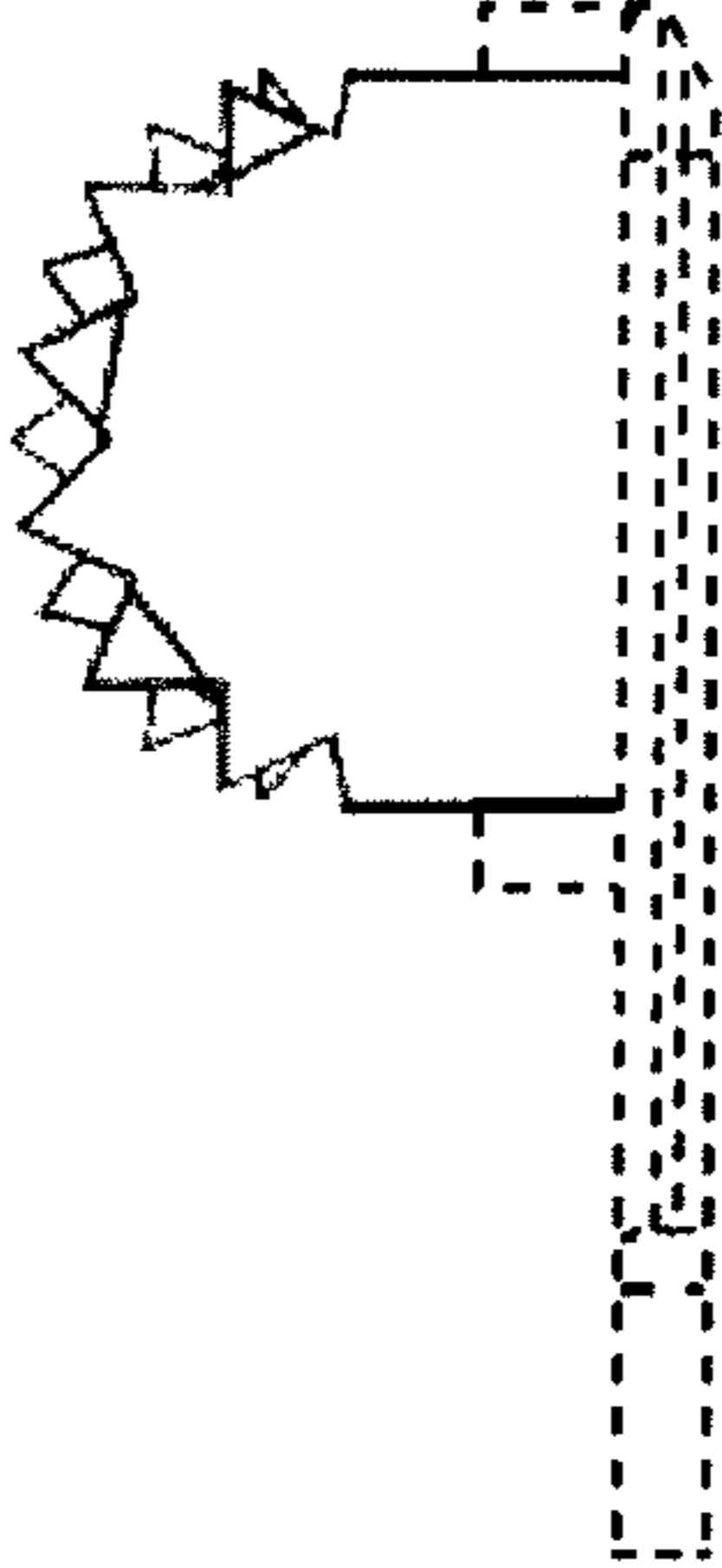

FIG. 8

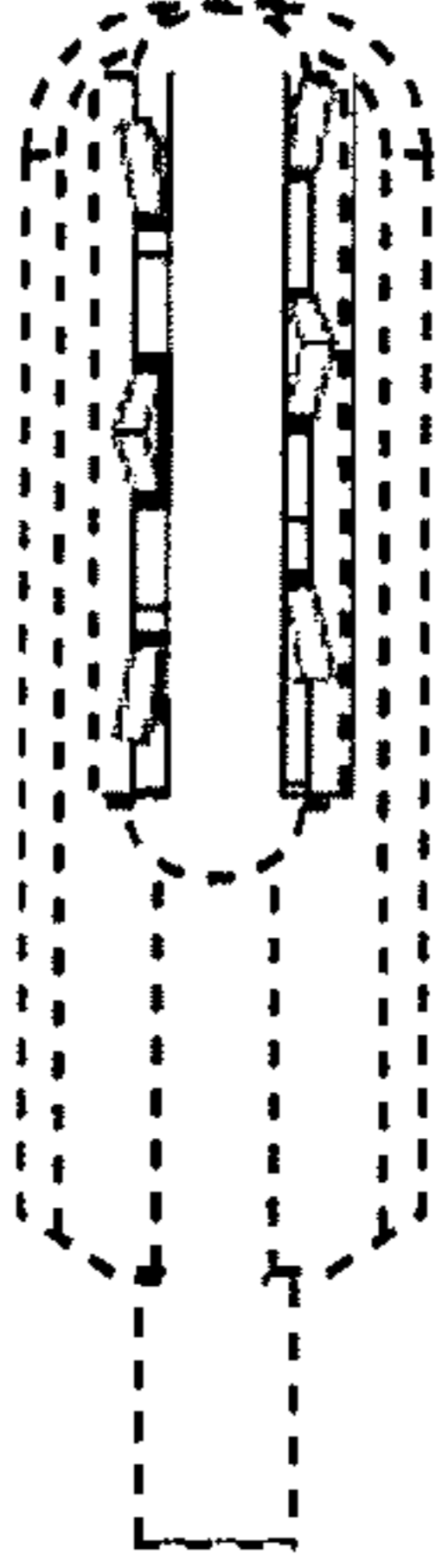

FIG. 10

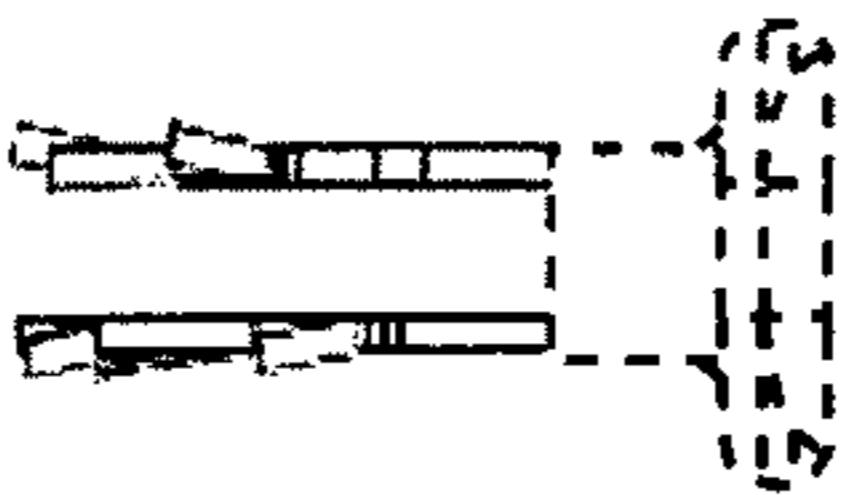

FIG. 11

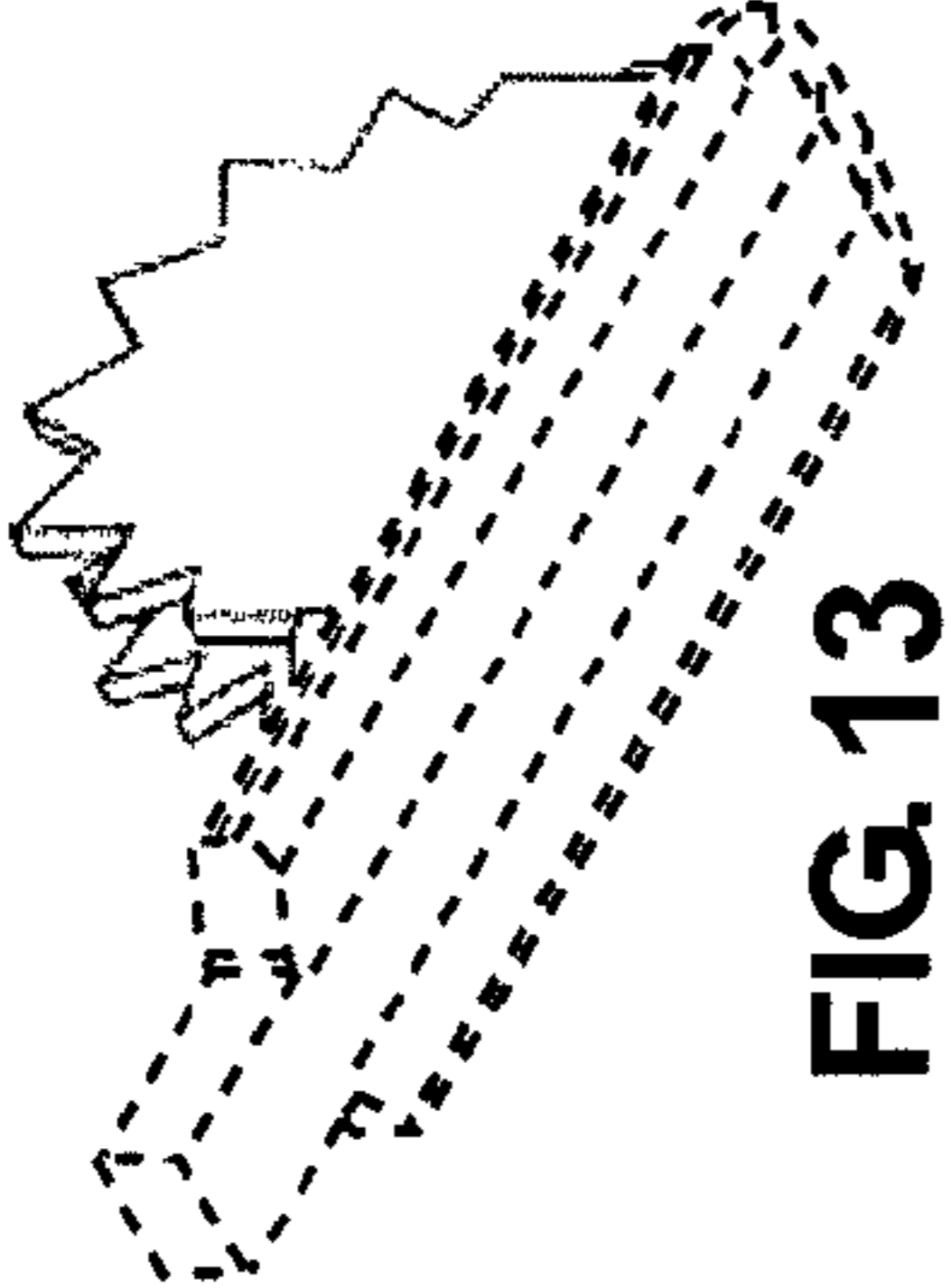

FIG. 13

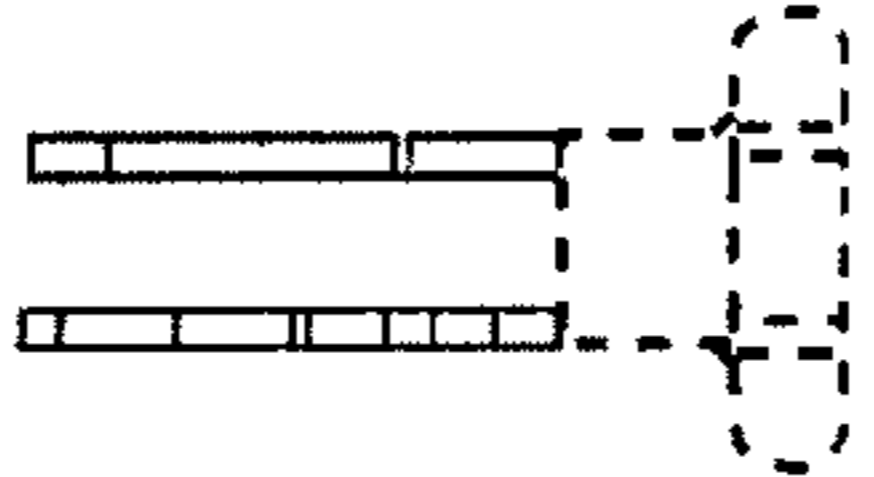

FIG. 18

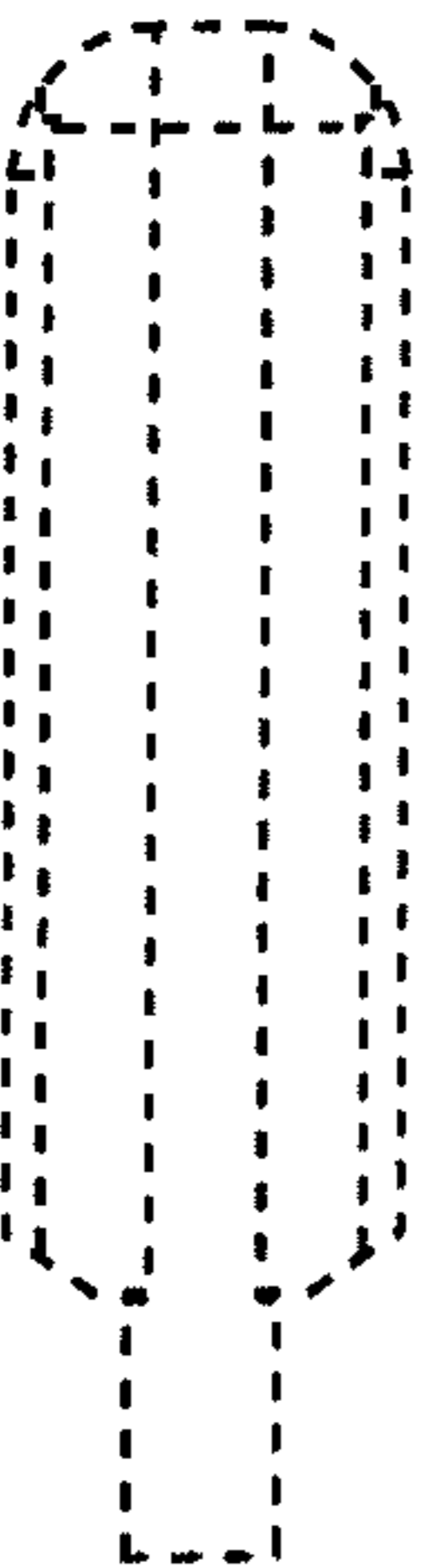

FIG. 15

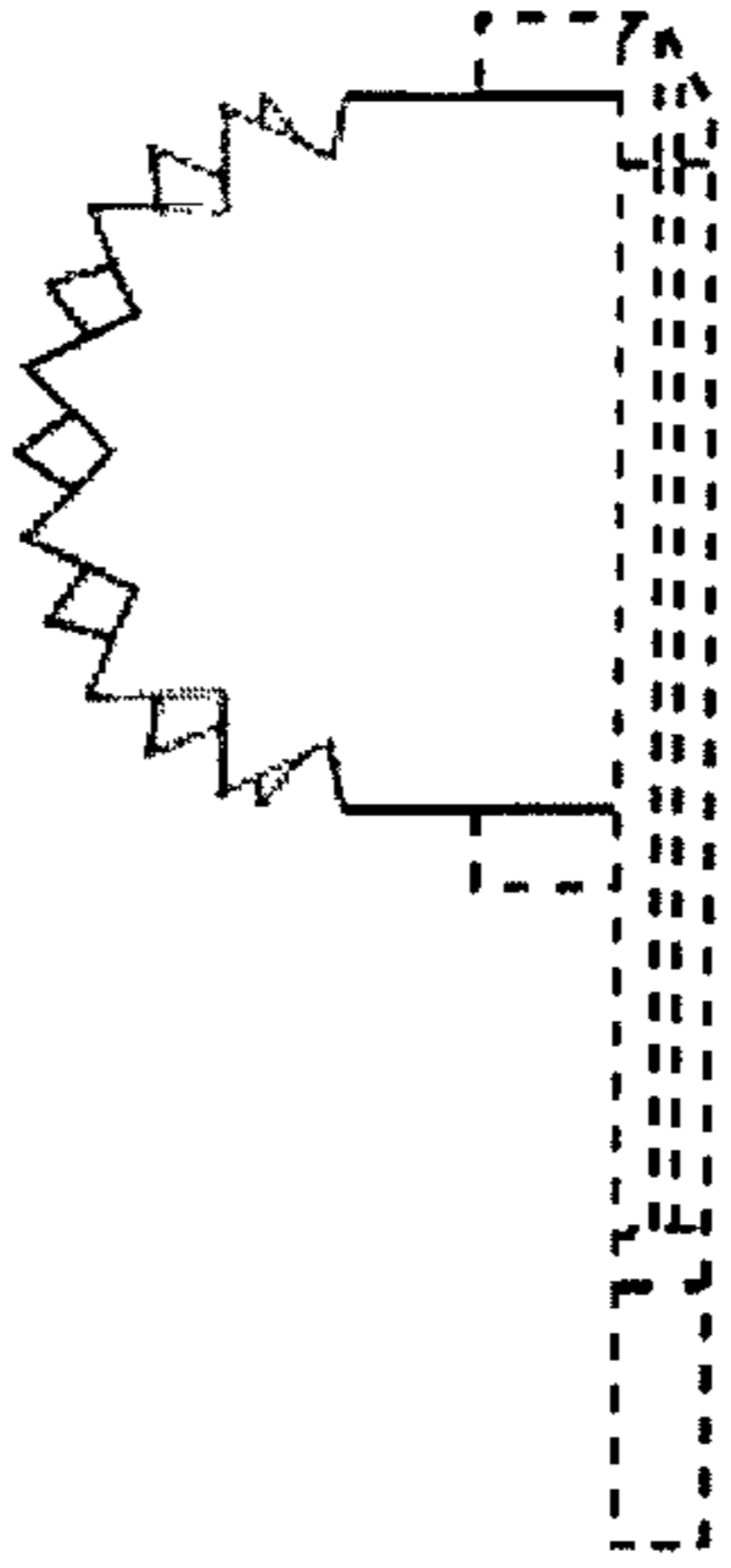

FIG. 14

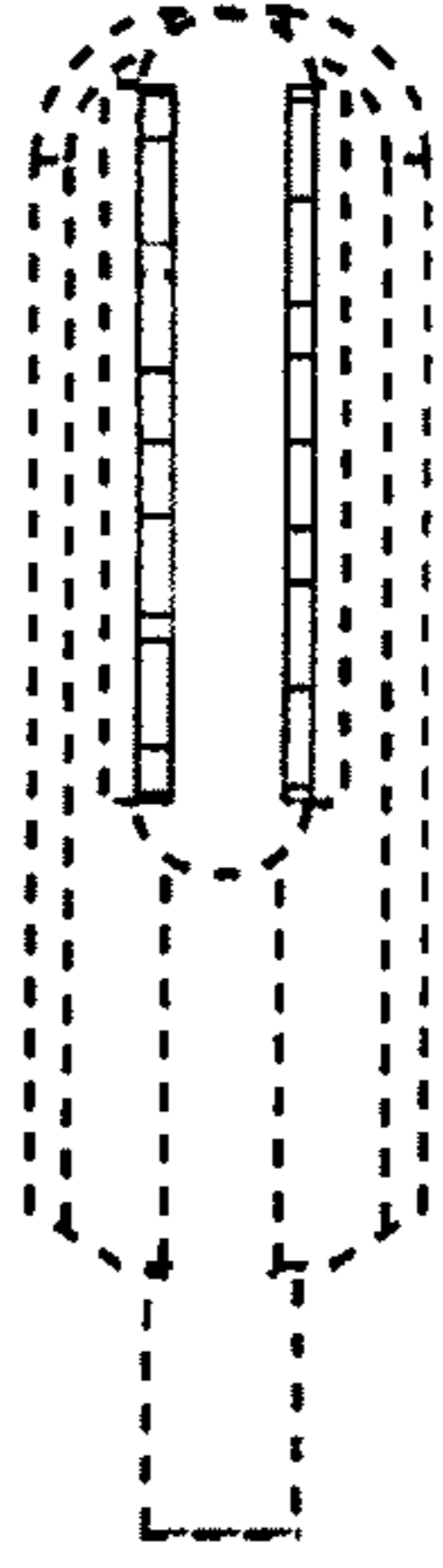

FIG. 16

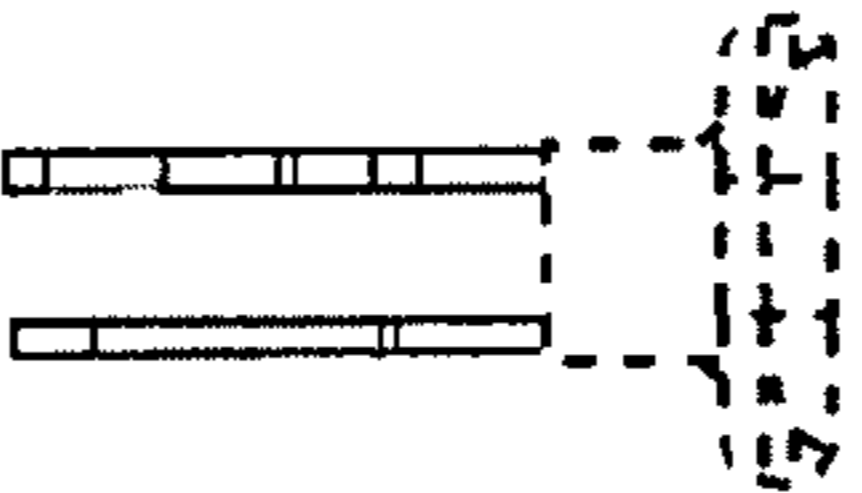

FIG. 17

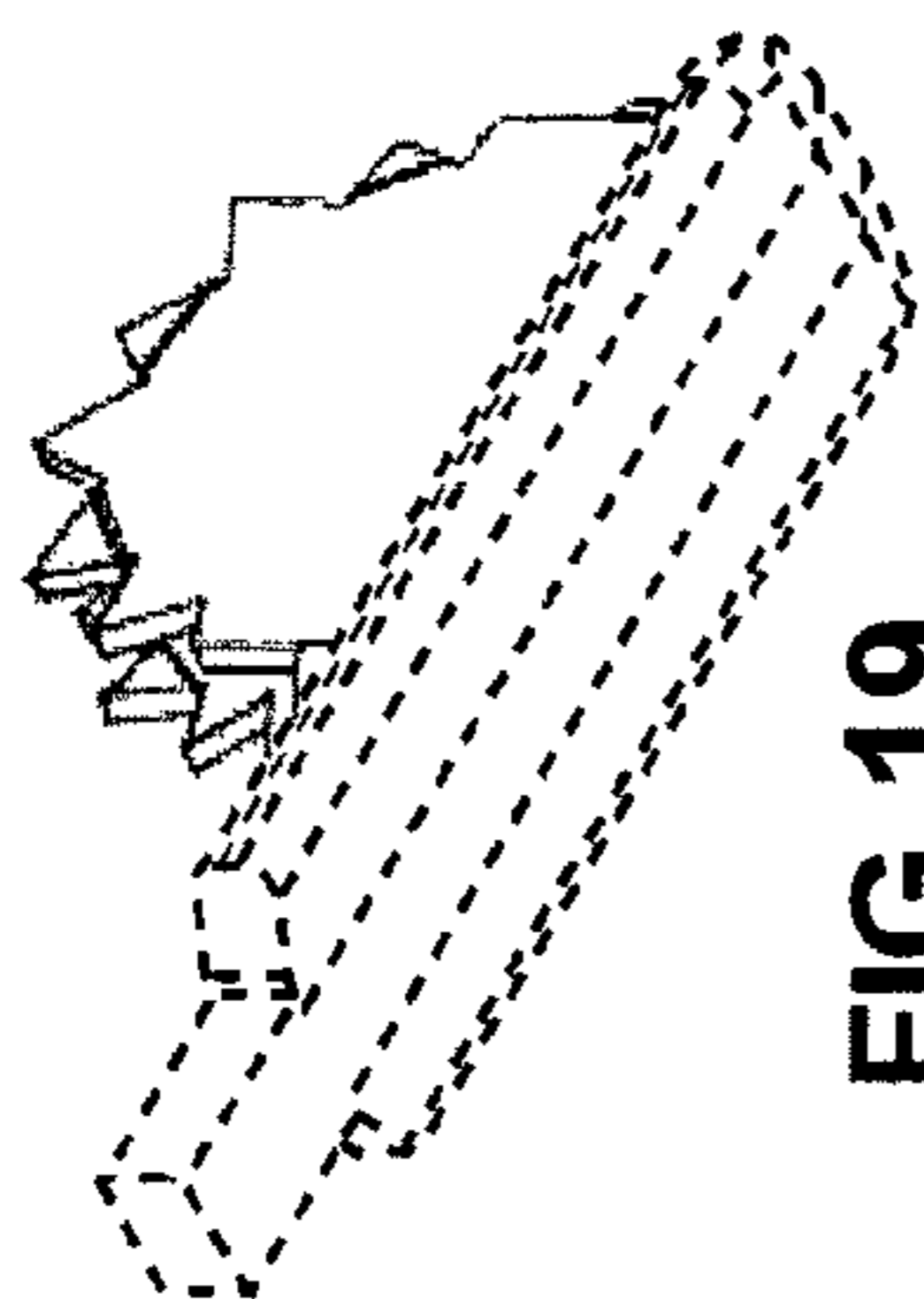

FIG. 19

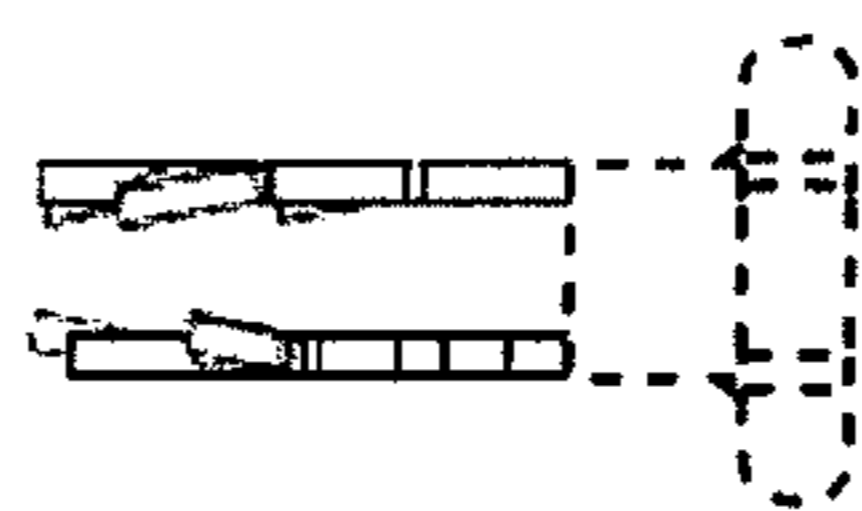

FIG. 24

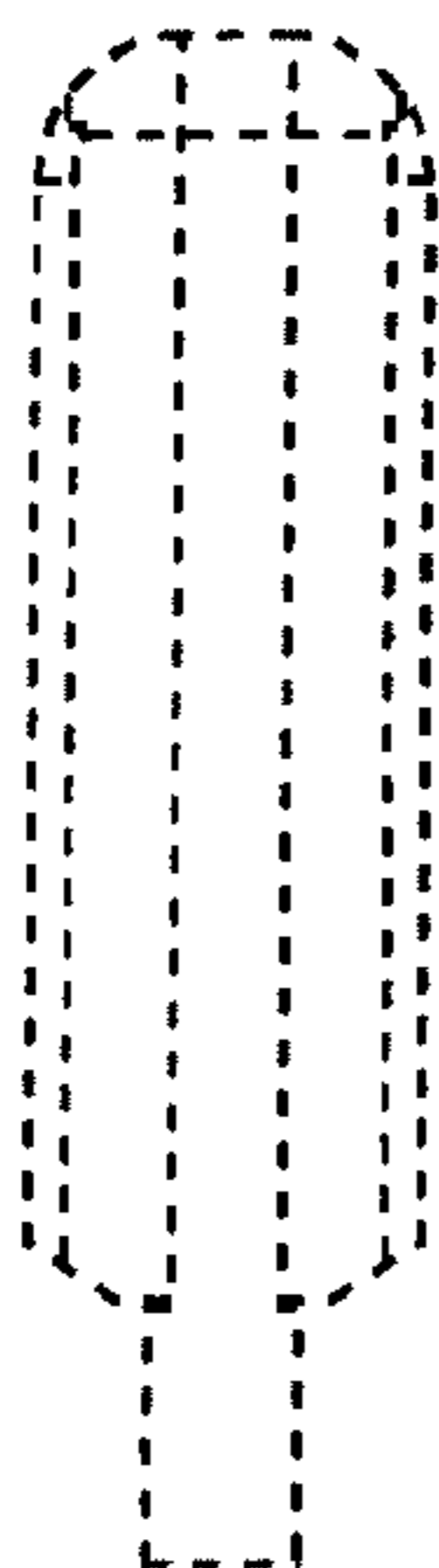

FIG. 21

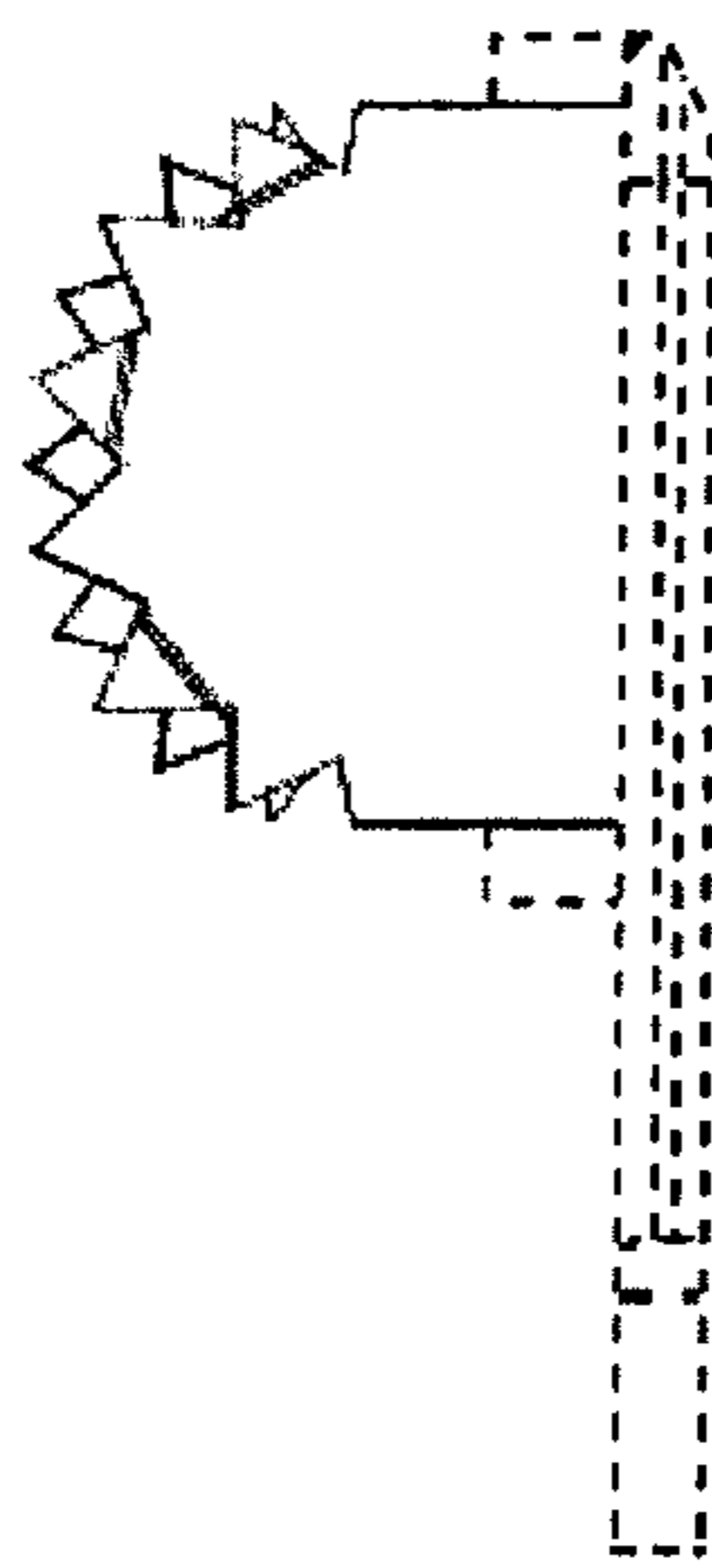

FIG. 20

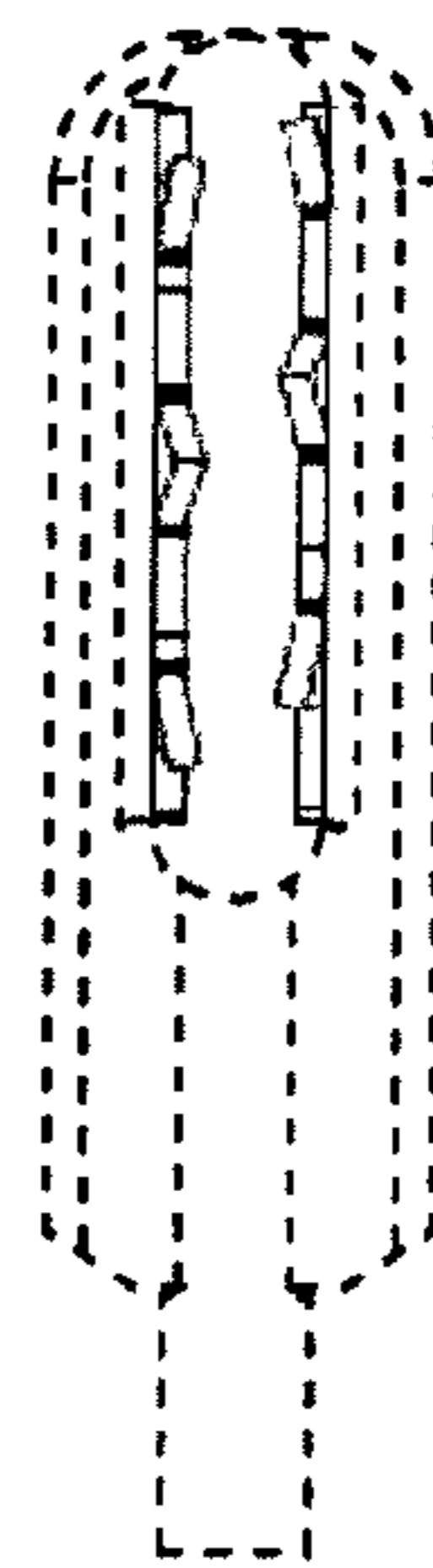

FIG. 22

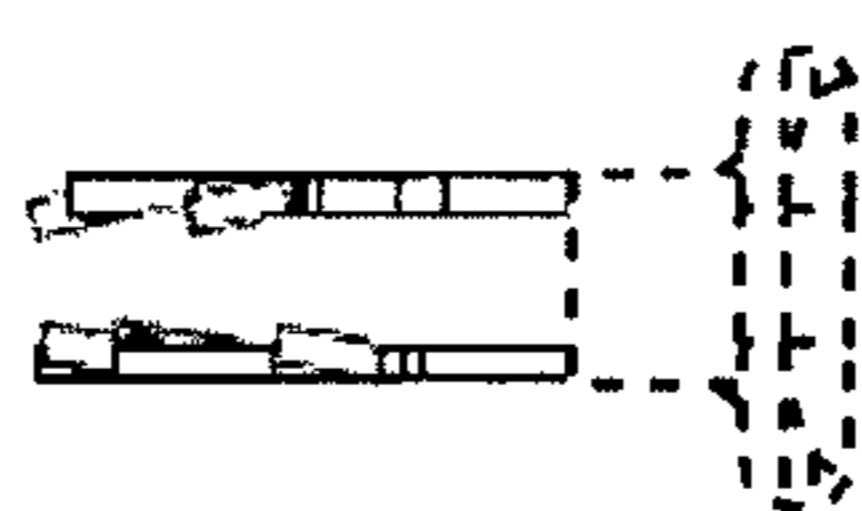

FIG. 23

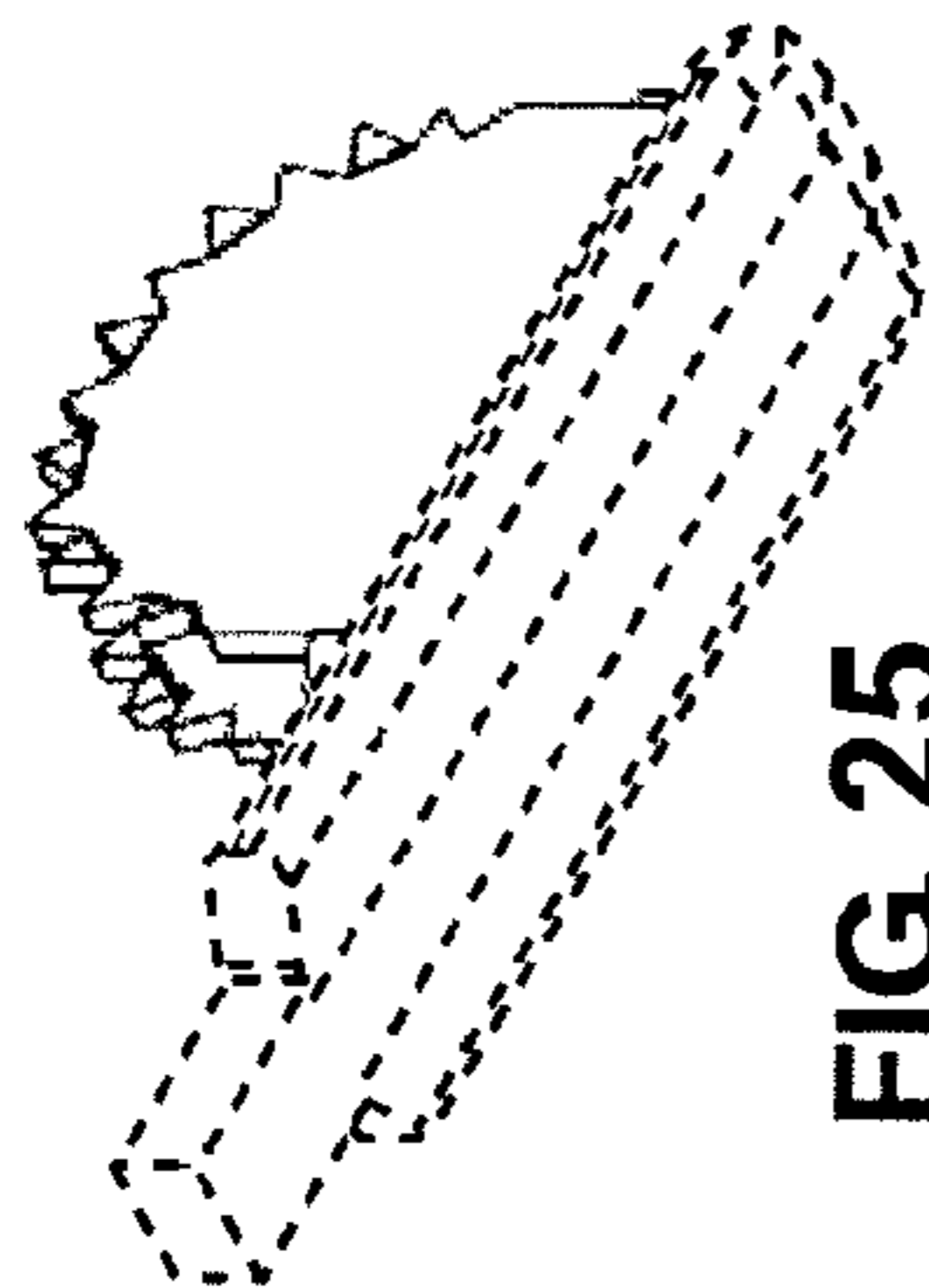

FIG. 25

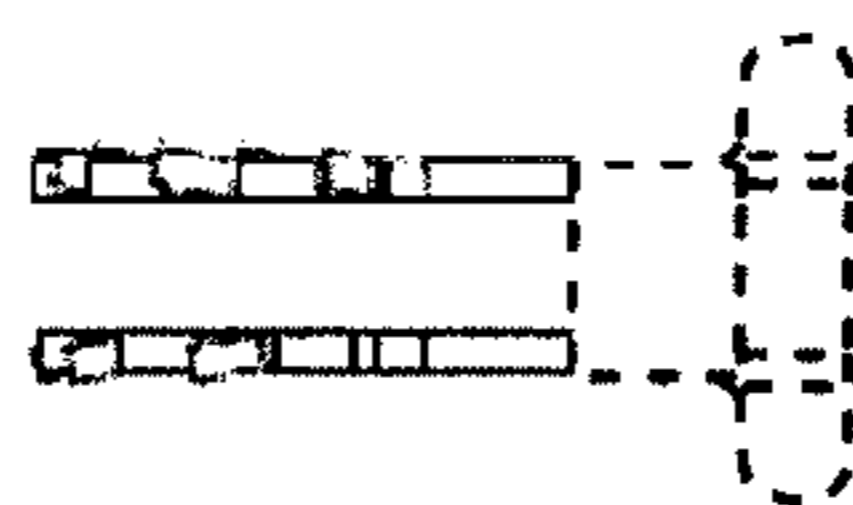

FIG. 30

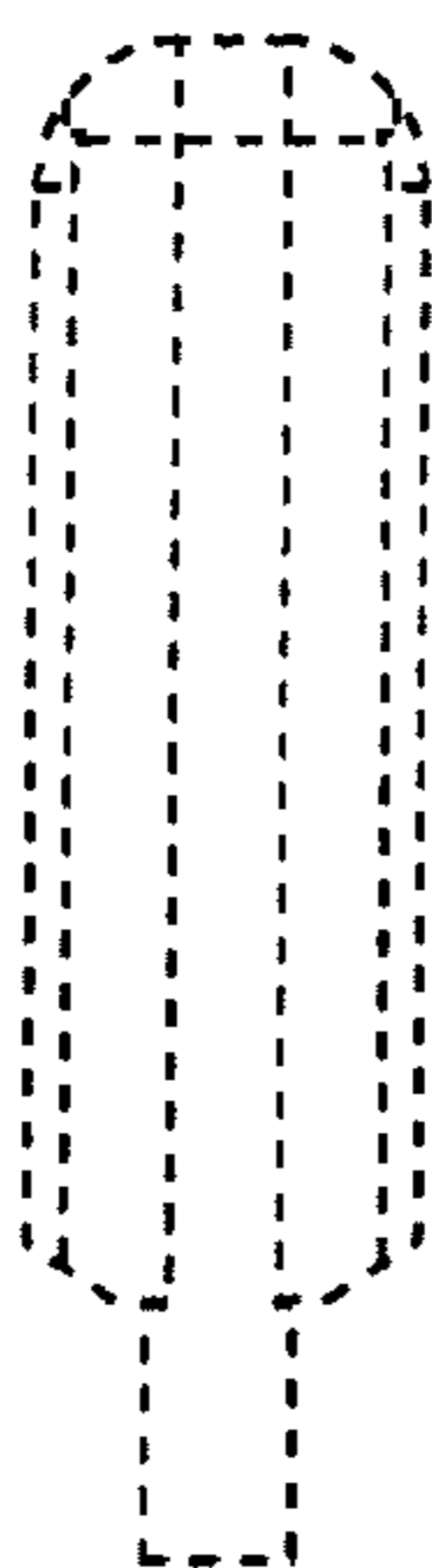

FIG. 27

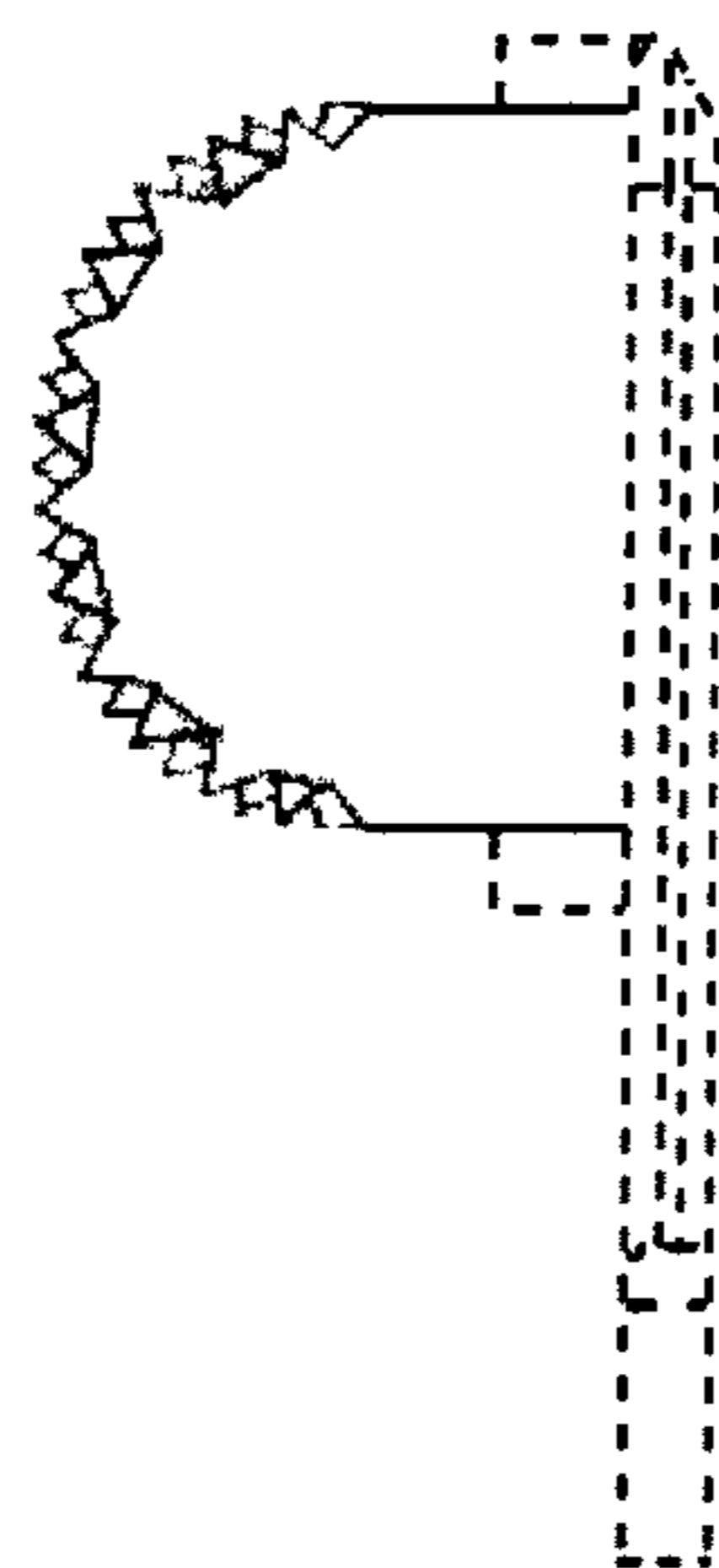

FIG. 26

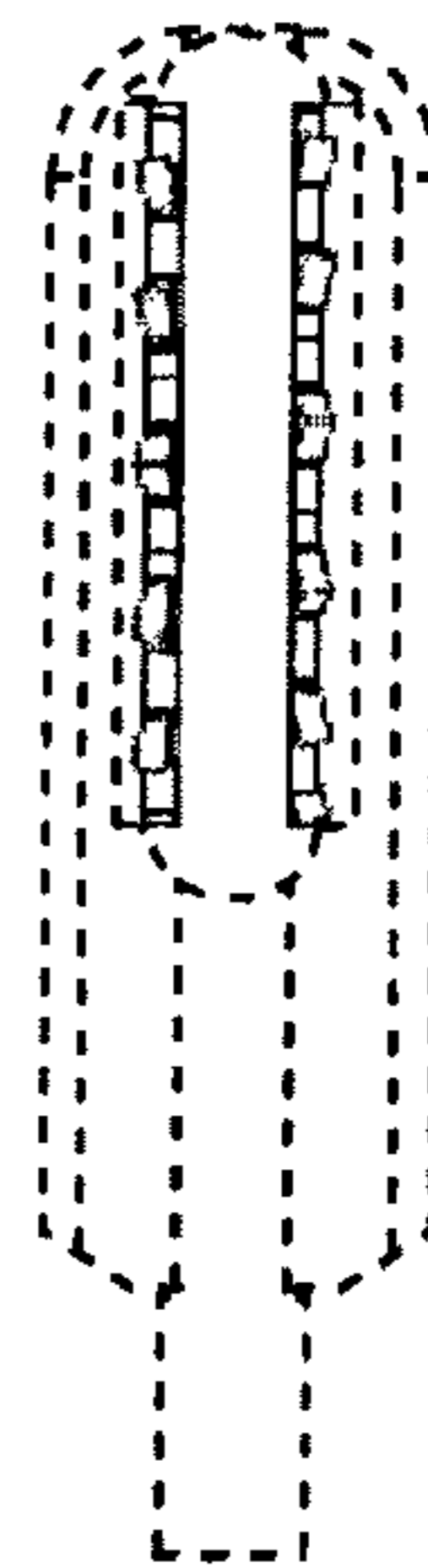

FIG. 28

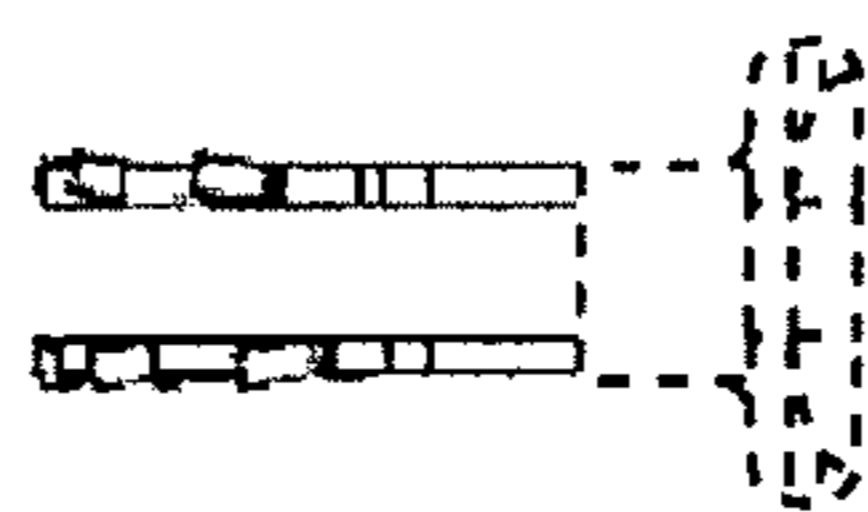

FIG. 29

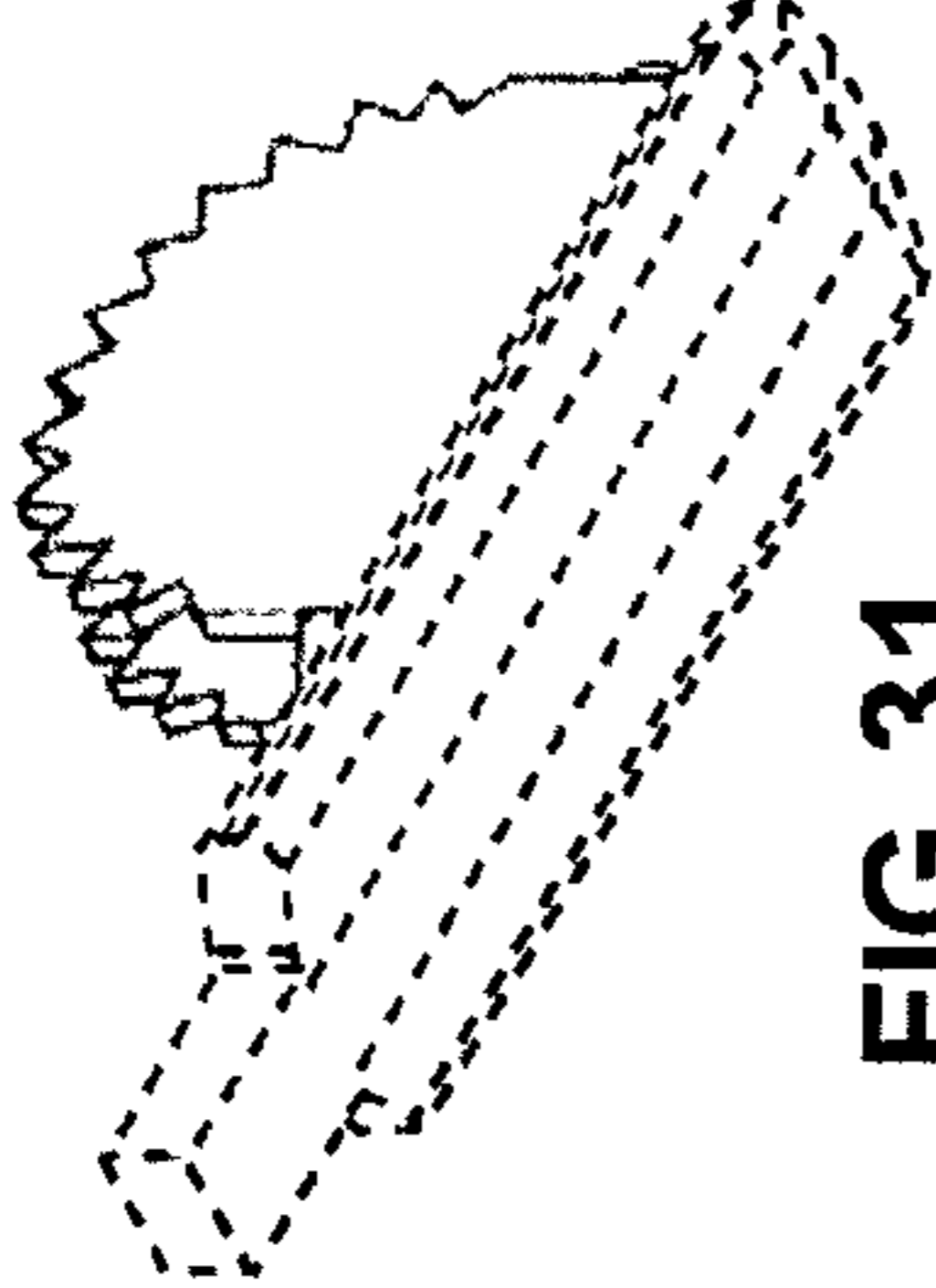

FIG. 31

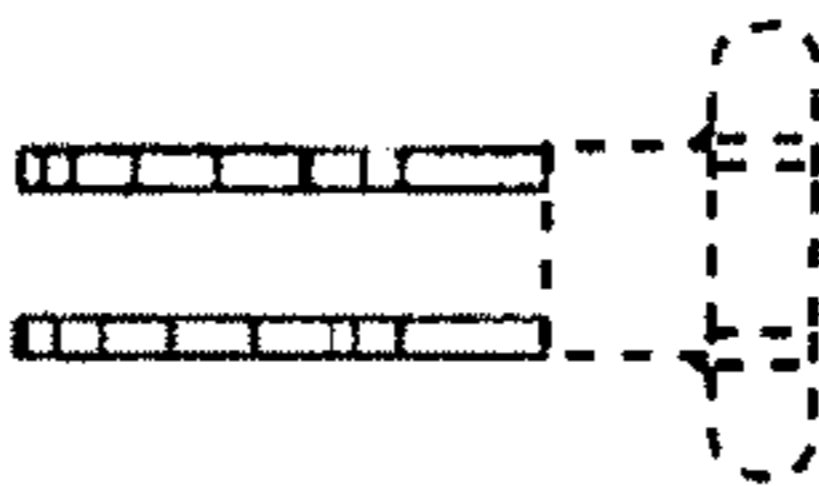

FIG. 36

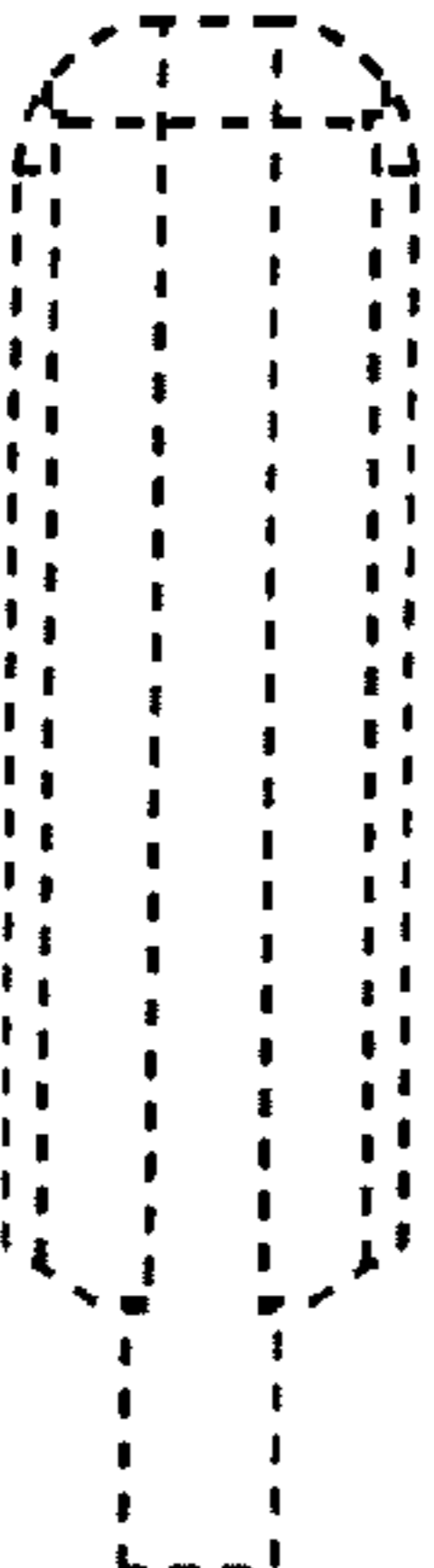

FIG. 33

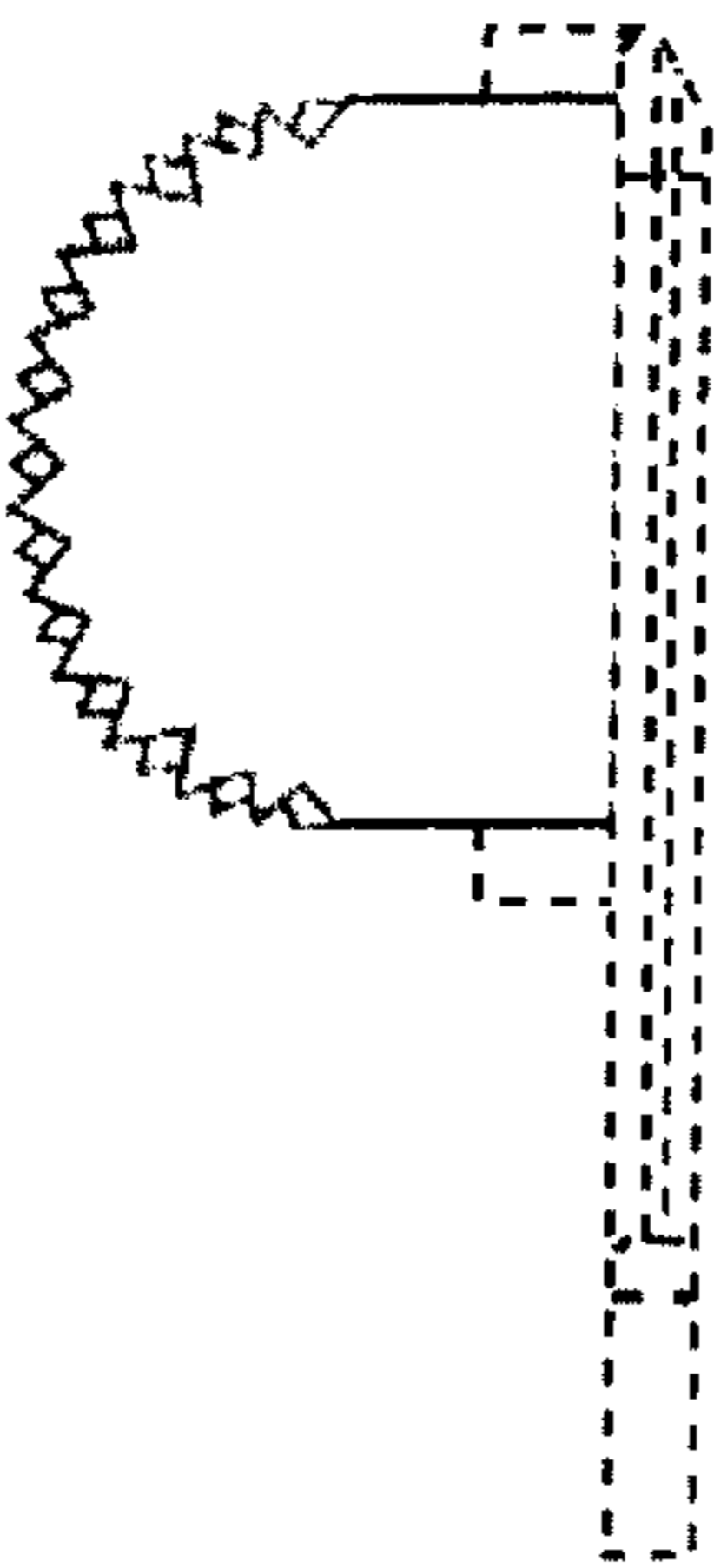

FIG. 32

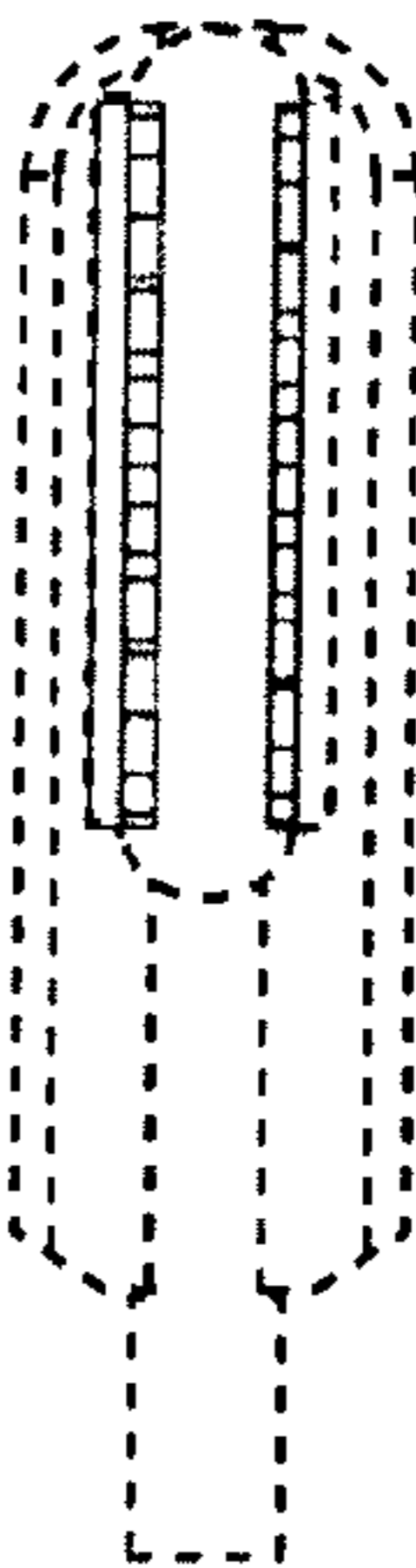

FIG. 34

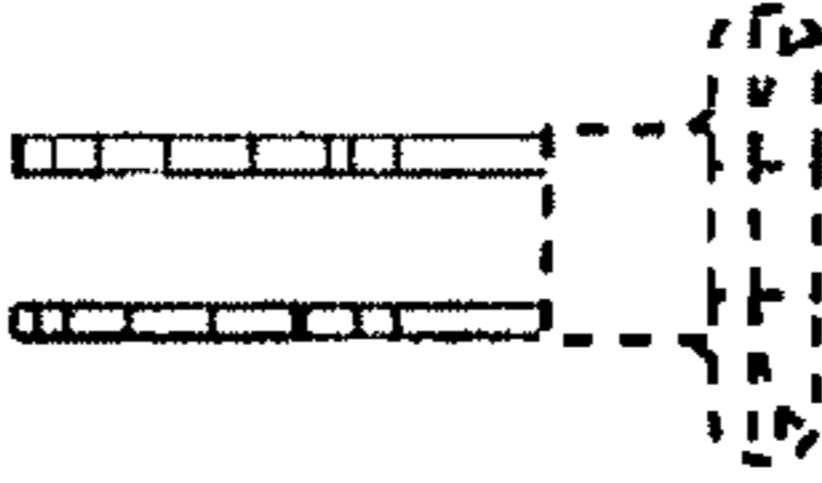

FIG. 35



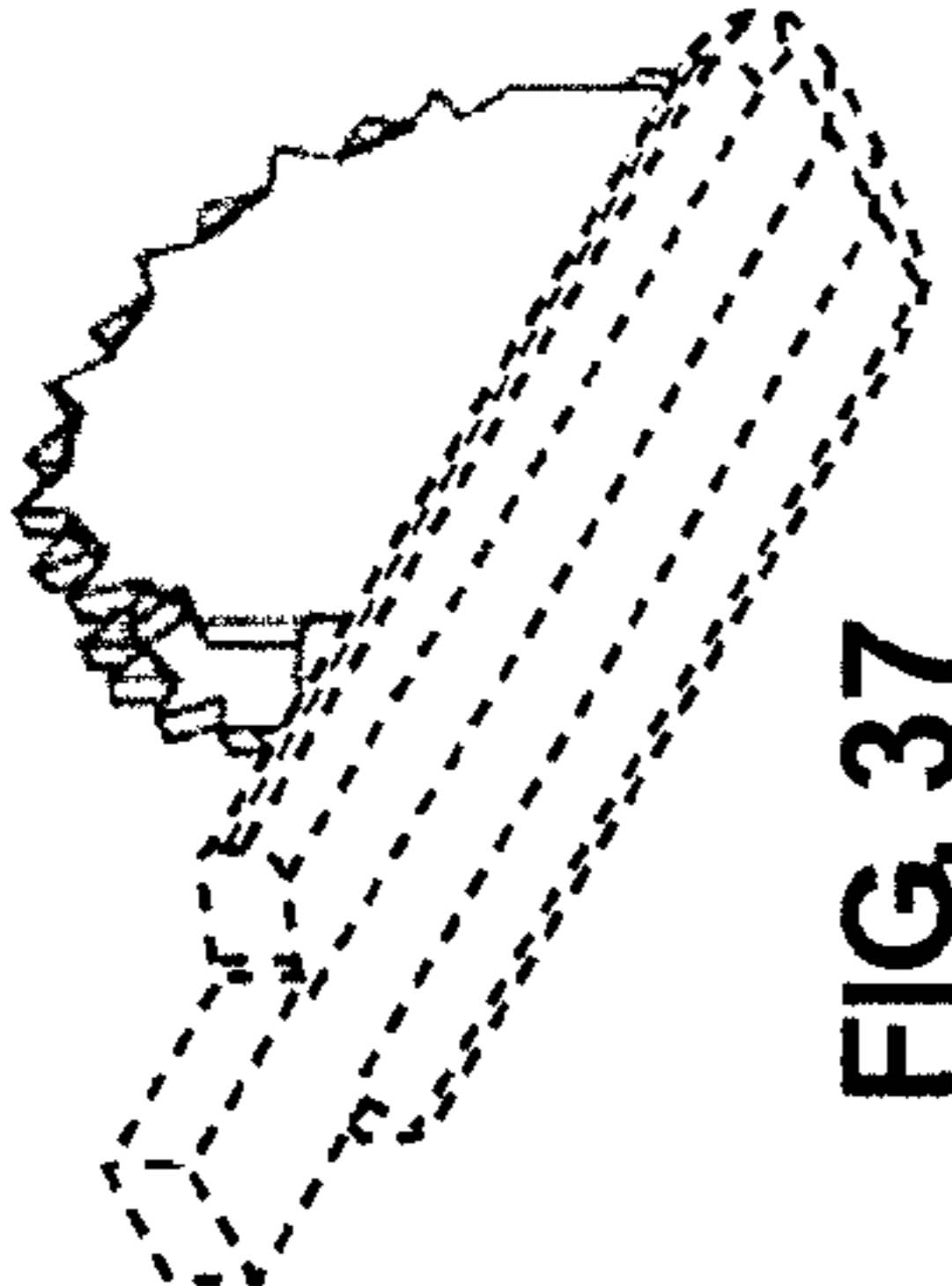

FIG. 37

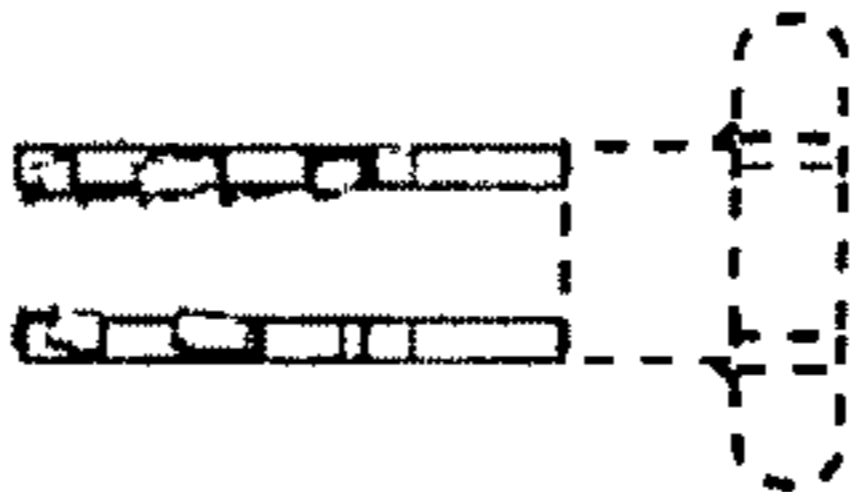

FIG. 42

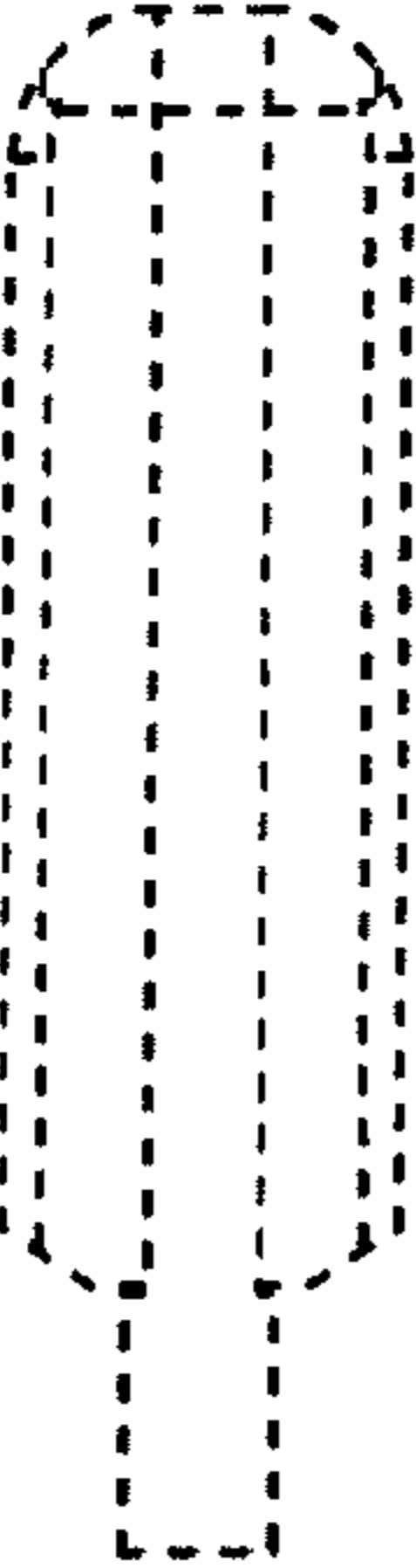

FIG. 39

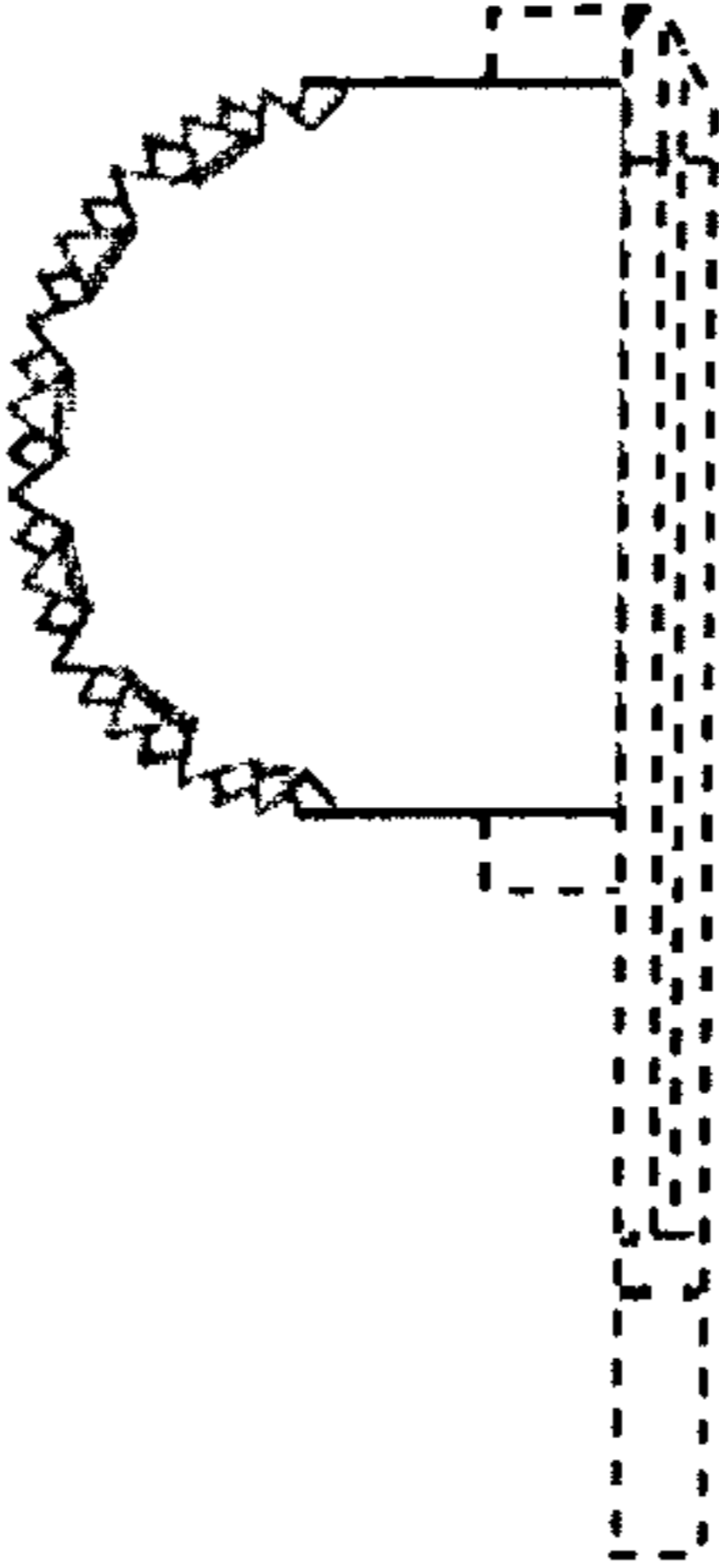

FIG. 38



FIG. 40

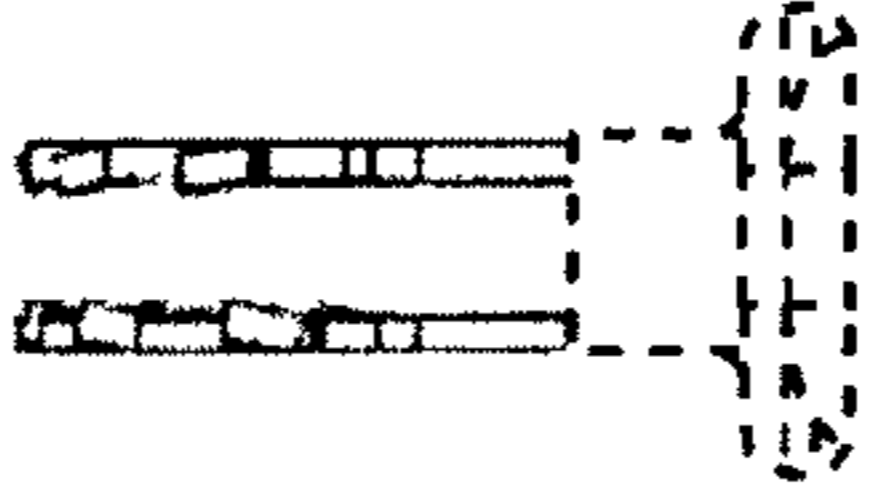

FIG. 41

UNITED STATES PATENT AND TRADEMARK OFFICE  
**CERTIFICATE OF CORRECTION**

PATENT NO. : D654,167 S  
APPLICATION NO. : 29/355170  
DATED : February 14, 2012  
INVENTOR(S) : Michael G. Fisher and John Anes

Page 1 of 1

It is certified that error appears in the above-identified patent and that said Letters Patent is hereby corrected as shown below:

On the Title page, Item 73, at line 3, under Assignee, delete "SEVIKA HOLDING AG., Schochenmuhlestr.4, CH-6340 Baar, Switzerland" and insert --**SYNVASIVE TECHNOLOGY, INC., EL DORADO HILLS, CALIFORNIA**--, therefor.

Signed and Sealed this  
Seventeenth Day of July, 2012

A handwritten signature in black ink that reads "David J. Kappos". The signature is written in a cursive, slightly slanted style.

David J. Kappos  
*Director of the United States Patent and Trademark Office*