



US00D653768S

(12) **United States Design Patent**
Jones

(10) **Patent No.:** **US D653,768 S**

(45) **Date of Patent:** **** Feb. 7, 2012**

(54) **BUILDING MOCK-UP FOR TRAINING PURPOSES**

(76) Inventor: **Steven Gerard Jones**, Mulliken, MI (US)

(**) Term: **14 Years**

(21) Appl. No.: **29/352,333**

(22) Filed: **Dec. 18, 2009**

(51) **LOC (9) Cl.** **25-03**

(52) **U.S. Cl.** **D25/1**

(58) **Field of Classification Search** D25/1, D25/3-34, 199; 52/36.1, 36.2, 79.5, 79.9
See application file for complete search history.

(56) **References Cited**

U.S. PATENT DOCUMENTS

| | | | | |
|--------------|------|---------|------------------|---------|
| 5,957,698 | A * | 9/1999 | Dean et al. | 434/350 |
| D450,132 | S * | 11/2001 | Garner et al. | D25/1 |
| 2007/0062126 | A1 * | 3/2007 | Zeilinger et al. | 52/36.1 |
| 2008/0282620 | A1 * | 11/2008 | Deloney | 52/36.1 |

* cited by examiner

Primary Examiner — T. Chase Nelson

Assistant Examiner — Kathleen M Sims

(74) *Attorney, Agent, or Firm* — QuickPatents, Inc.; Kevin Prince

(57) **CLAIM**

What is claimed is the ornamental design for a building mock-up for training purposes, as shown and described.

DESCRIPTION

FIG. 1 is a perspective view of a building mock-up for training purposes, showing the new design; FIG. 2 is a front elevational view thereof; FIG. 3 is a rear elevational view thereof; FIG. 4 is a left-side elevational view thereof; FIG. 5 is a right-side elevational view being a mirror image thereof; FIG. 6 is a top plan view thereof; and, FIG. 7 is a bottom plan view thereof.

The broken lines showing elements in FIGS. 1, 2, and 4-6 depict portions of the building mock-up for training purposes that form no part of the claimed design.

1 Claim, 5 Drawing Sheets

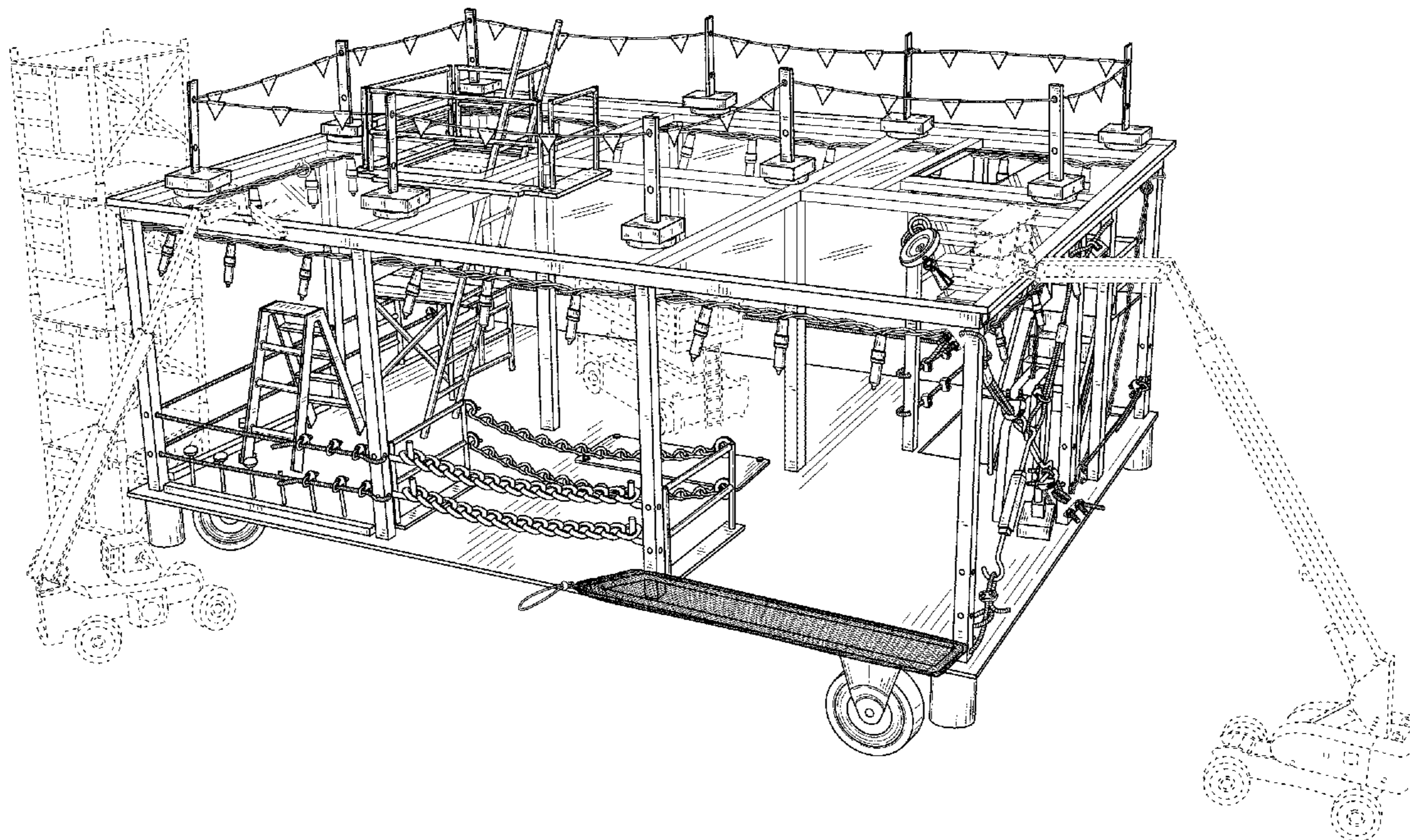

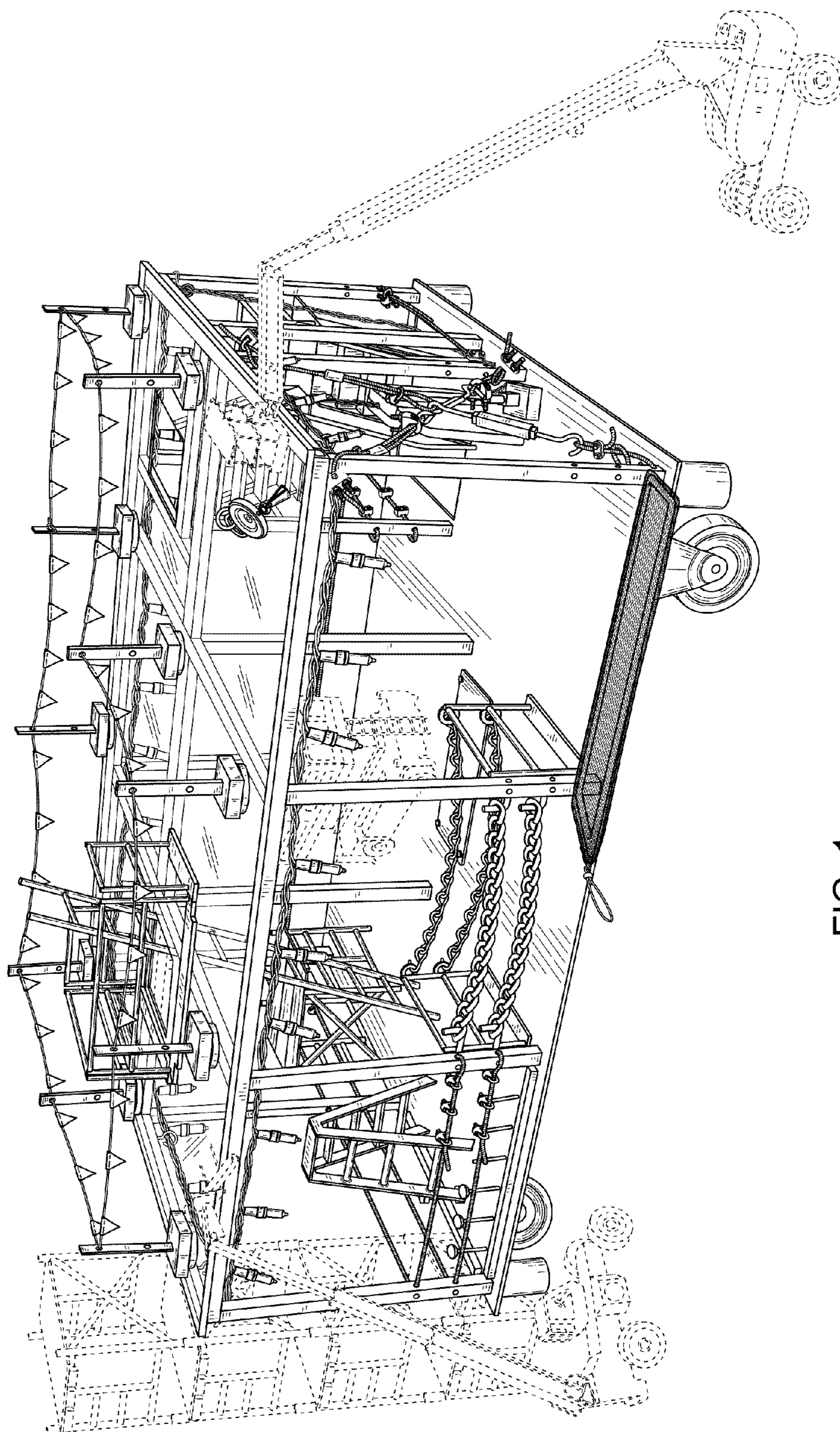

FIG. 1

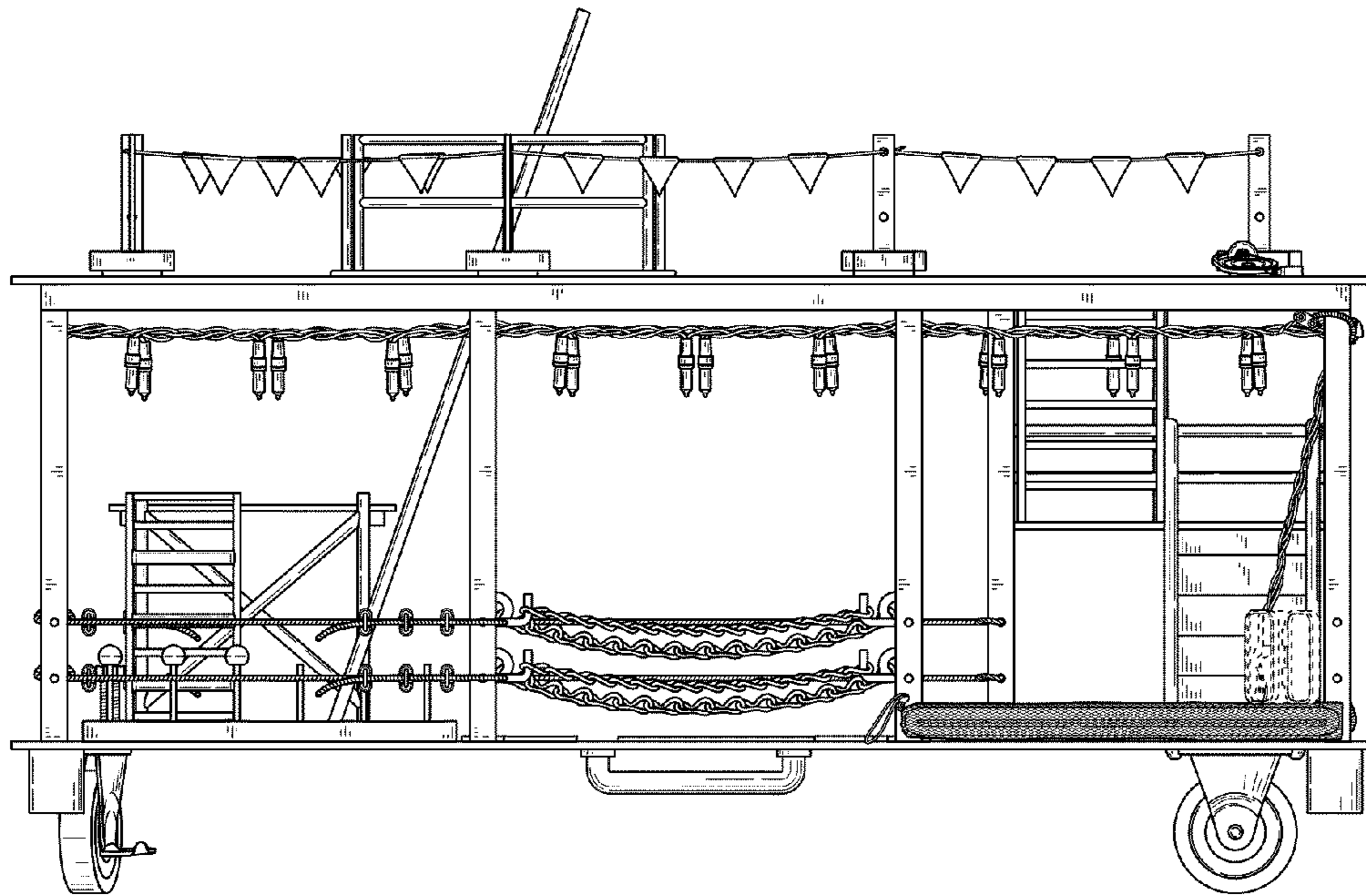

FIG. 2

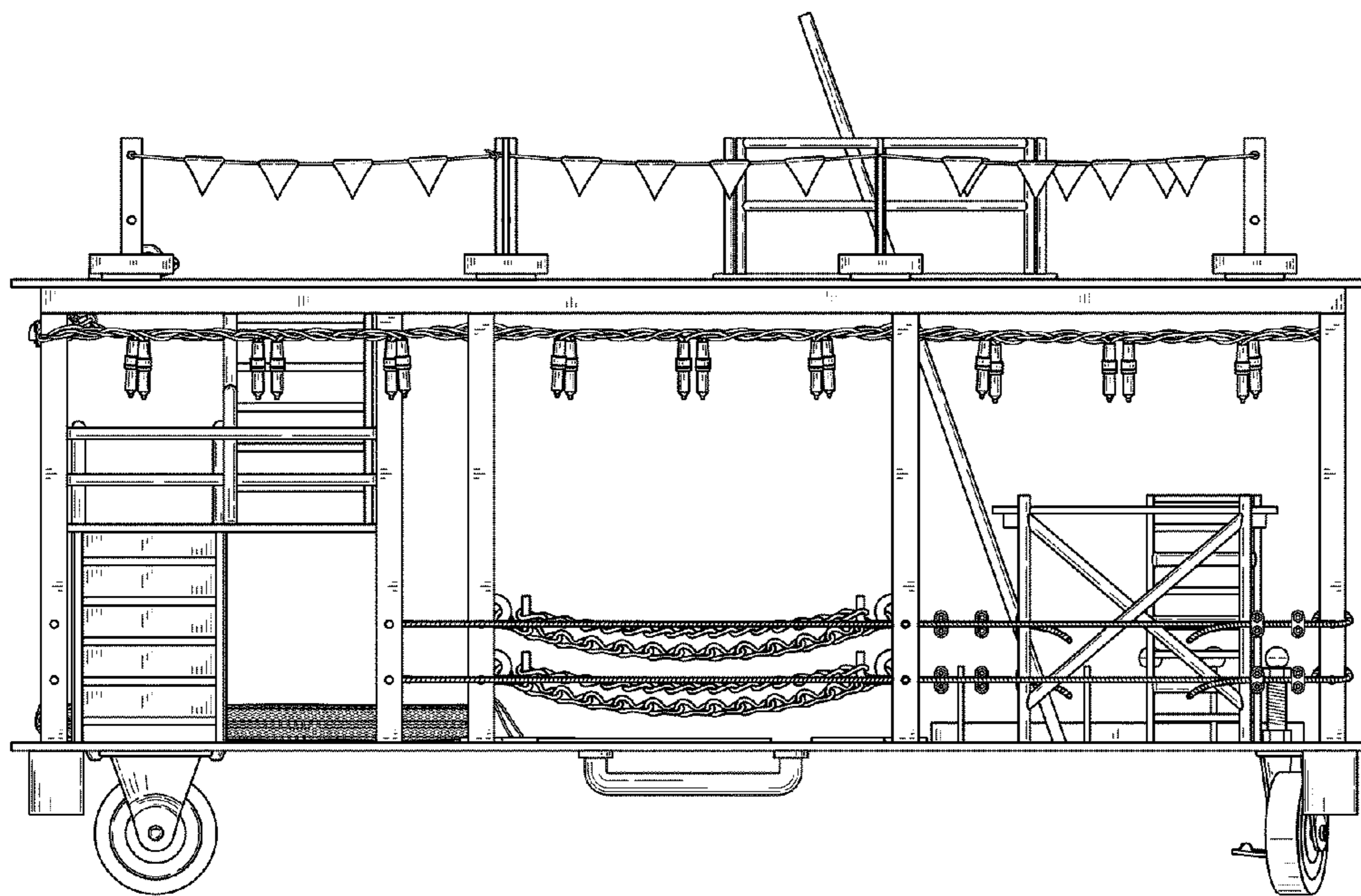

FIG. 3

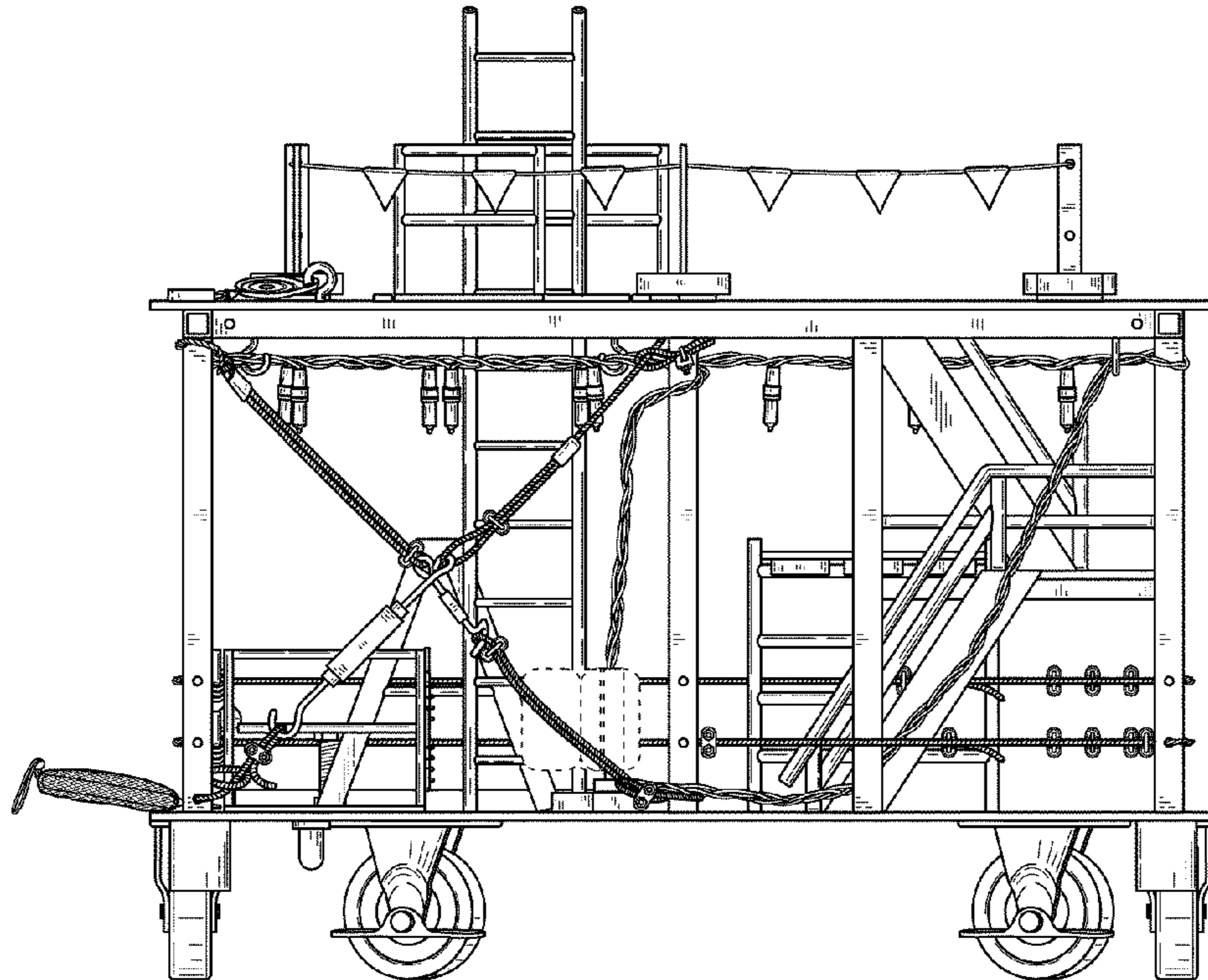

FIG. 4

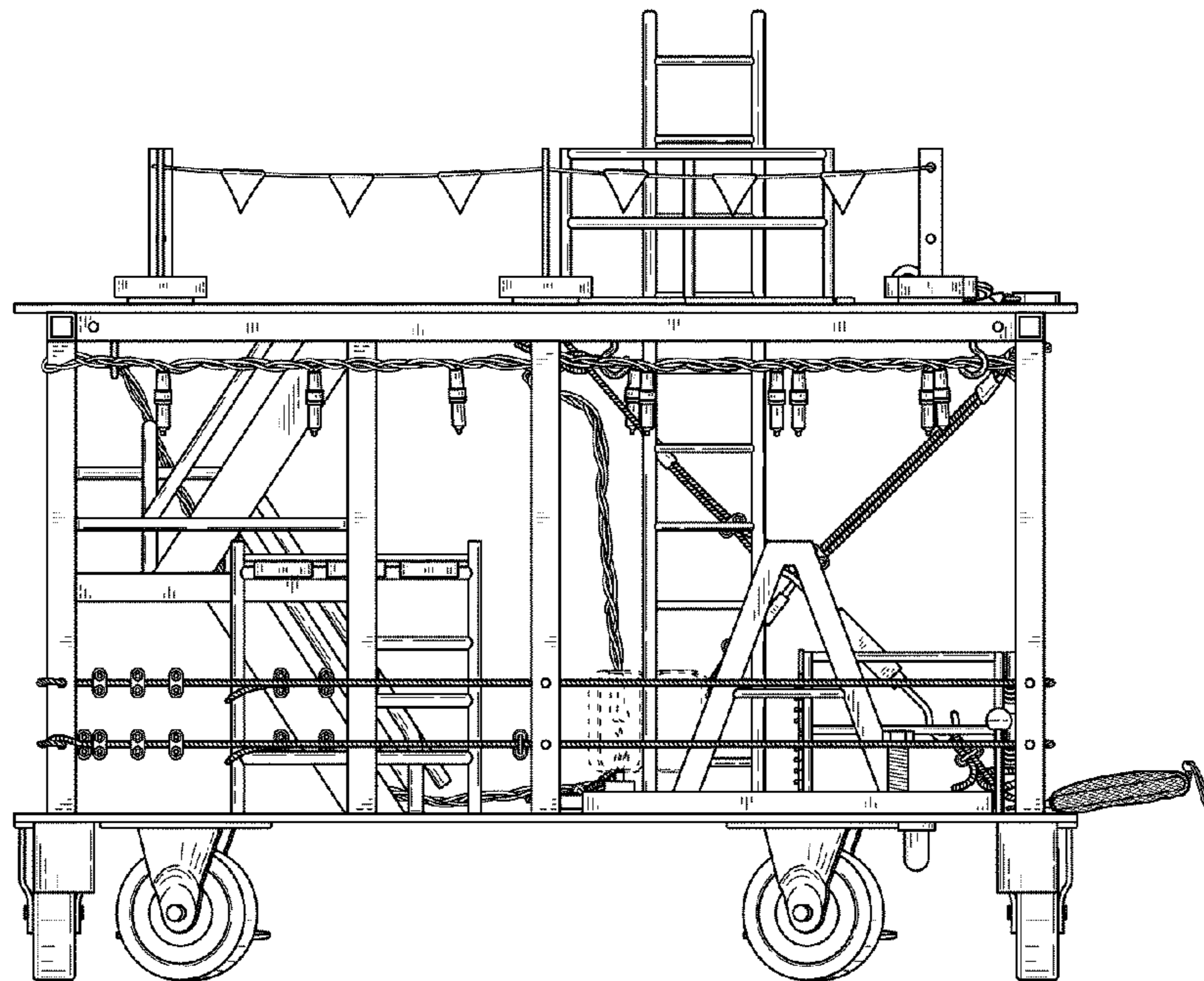

FIG. 5

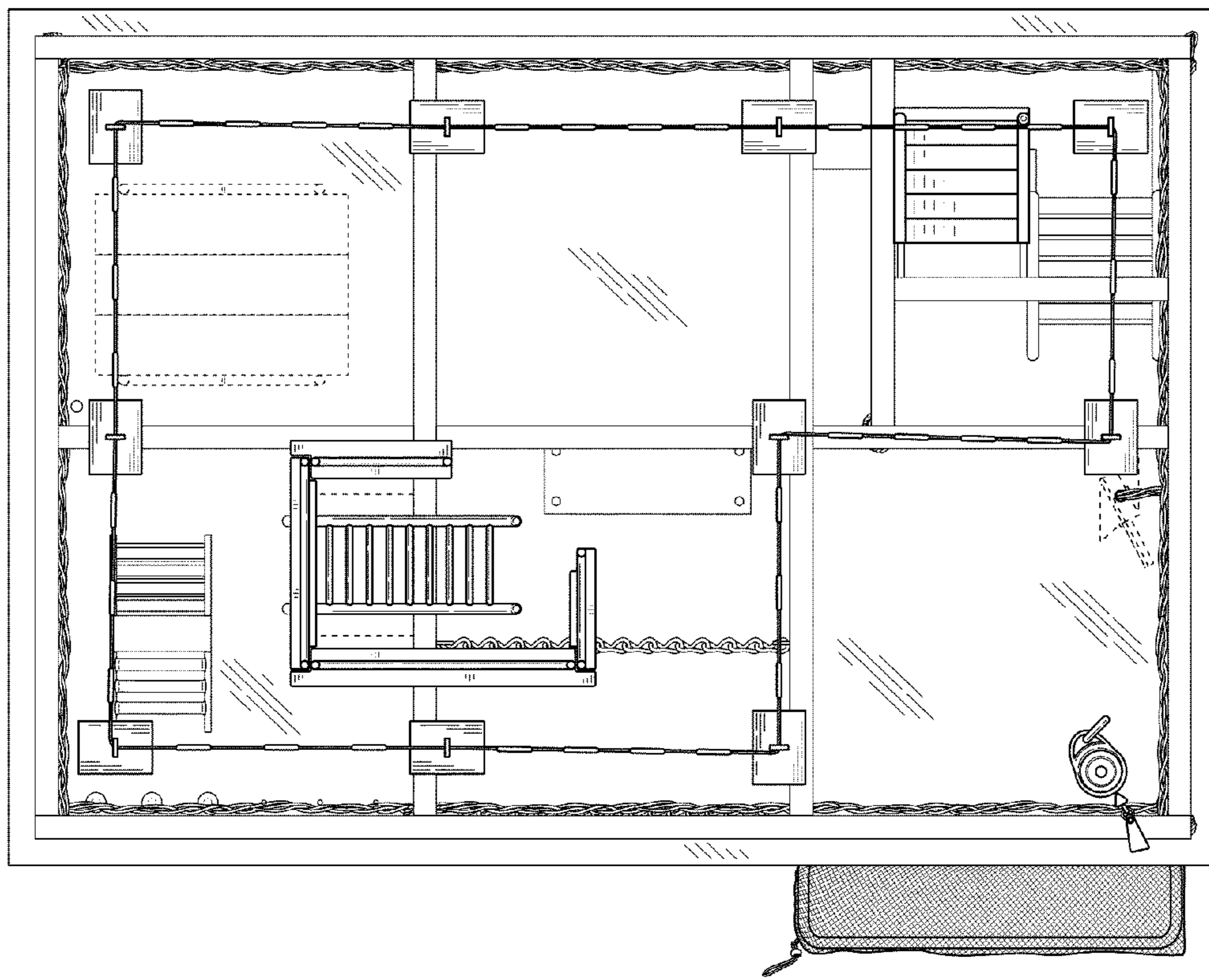

FIG. 6

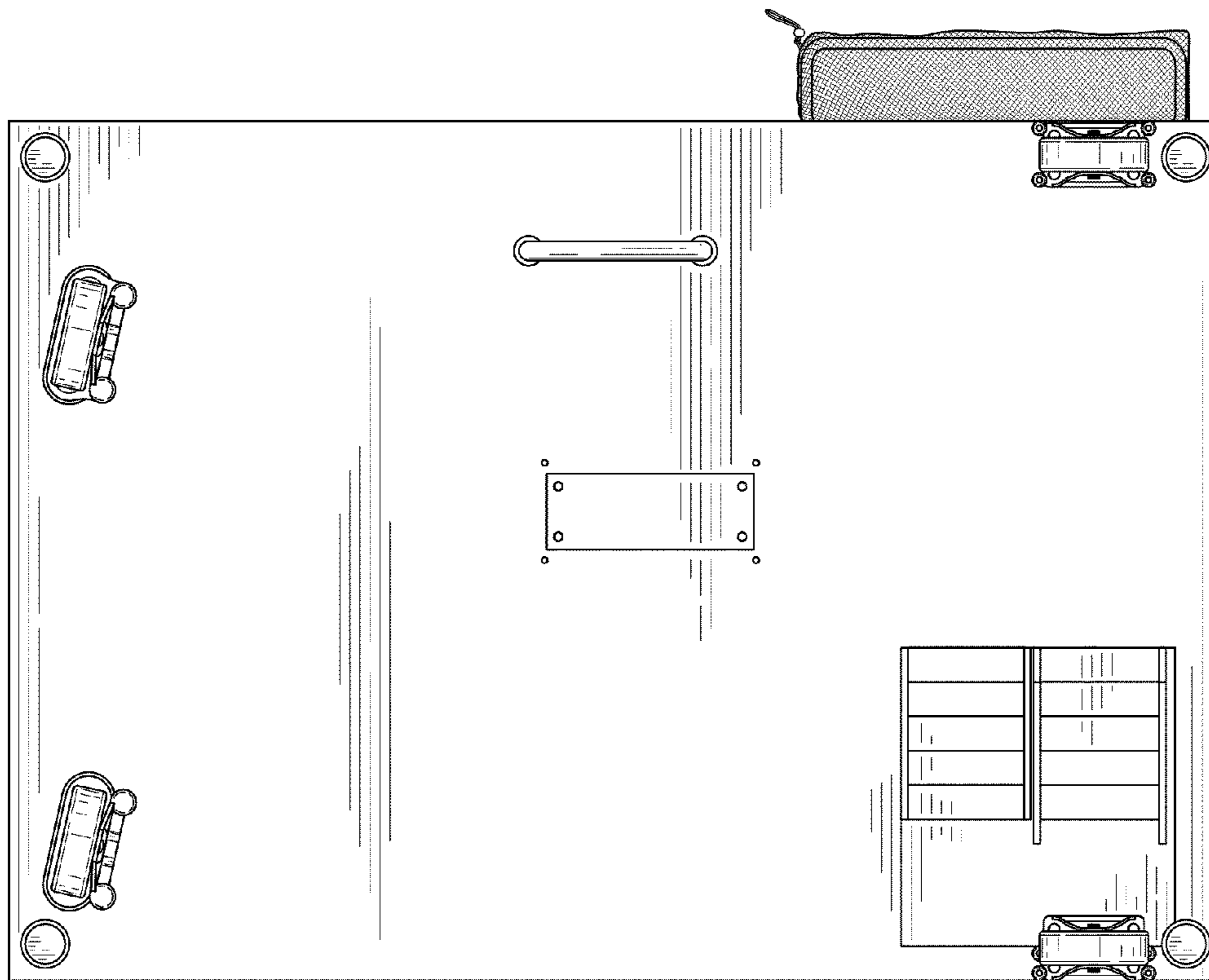

FIG. 7