



US00D651684S

(12) **United States Design Patent**
Rogers et al.

(10) **Patent No.:** **US D651,684 S**
(45) **Date of Patent:** **** Jan. 3, 2012**

(54) **BORE CLEANING TOOL**

(74) *Attorney, Agent, or Firm* — Arthur G. Yeager, Esq.

(76) Inventors: **William H. Rogers**, St. Augustine, FL (US); **Matthew E. McKendrick**, Jacksonville, FL (US)

(57) **CLAIM**
The ornamental design for a bore cleaning tool, as shown and described.

(**) Term: **14 Years**

DESCRIPTION

(21) Appl. No.: **29/364,487**

FIG. 1 is a perspective view of a longitudinal side and front axial end, according to a first embodiment thereof;
FIG. 2 is a perspective view of a longitudinal side and rear axial end, according to the first embodiment thereof;
FIG. 3 is a longitudinal side view thereof, according to the first embodiment thereof;
FIG. 4 is a front axial end view thereof, according to the first embodiment thereof;
FIG. 5 is a rear axial end view thereof according to the first embodiment thereof;
FIG. 6 is a perspective view of a longitudinal side and front axial end, according to a second embodiment thereof;
FIG. 7 is a perspective view of a longitudinal side and rear axial end, according to the second embodiment thereof;
FIG. 8 is a longitudinal side view thereof, according to the second embodiment thereof;
FIG. 9 is a front axial end view thereof, according to the second embodiment thereof; and,
FIG. 10 is a rear axial end view thereof according to the second embodiment thereof.
Except for the threads in the second embodiment, the bore squeegee is substantially symmetrical about its longitudinal axis. In the first embodiment, large broken lines illustrate a boundary of the claimed invention, and small broken lines illustrate environment, which forms no part of the claimed invention.

(22) Filed: **Jun. 24, 2010**

(51) **LOC (9) Cl.** **22-99**

(52) **U.S. Cl.** **D22/199**

(58) **Field of Classification Search** D22/108,
D22/199; D21/572-574; 42/95;
15/104.001-104.05

See application file for complete search history.

(56) **References Cited**

U.S. PATENT DOCUMENTS

| | | | | |
|--------------|------|---------|----------------|------------|
| 1,264,290 | A * | 4/1918 | Fletcher | 15/104.2 |
| 1,296,719 | A * | 3/1919 | Veeck | 15/179 |
| 1,532,222 | A * | 4/1925 | Belding | 15/104.16 |
| D247,936 | S * | 5/1978 | Wortley et al. | D4/120 |
| D393,115 | S * | 3/1998 | Bell et al. | D32/35 |
| 6,276,017 | B1 * | 8/2001 | Lino et al. | 15/104.061 |
| 7,380,570 | B1 * | 6/2008 | Orr | 137/625.25 |
| 7,454,812 | B1 * | 11/2008 | Lyle | 15/104.05 |
| 2007/0266610 | A1 * | 11/2007 | Coffield | 42/95 |
| 2009/0283115 | A1 * | 11/2009 | Dentico | 134/22.1 |
| 2010/0017980 | A1 * | 1/2010 | Filippovitch | 15/104.05 |
| 2011/0047853 | A1 * | 3/2011 | Williams | 42/95 |

* cited by examiner

Primary Examiner — T. Chase Nelson

Assistant Examiner — Michael Pratt

1 Claim, 4 Drawing Sheets

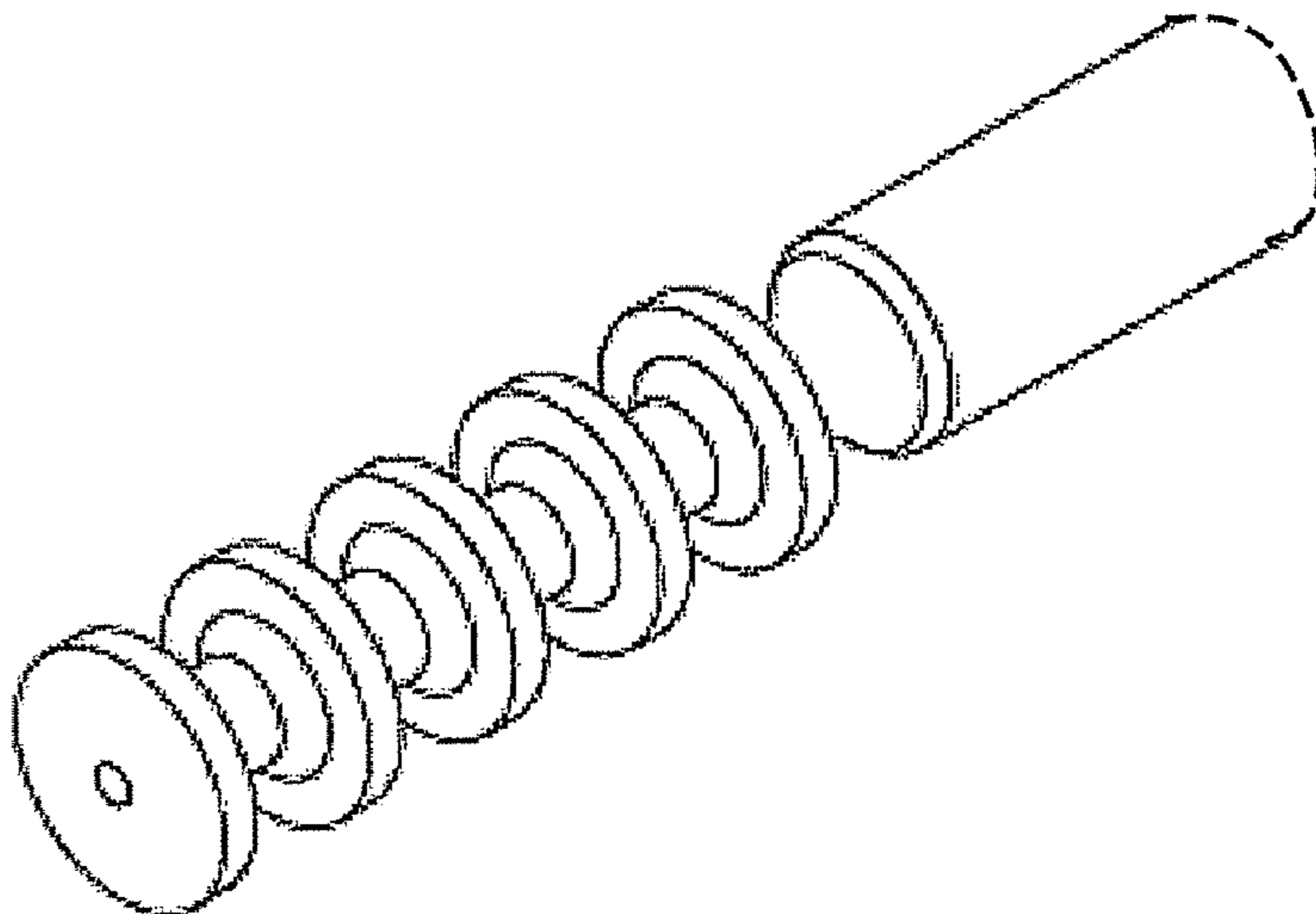

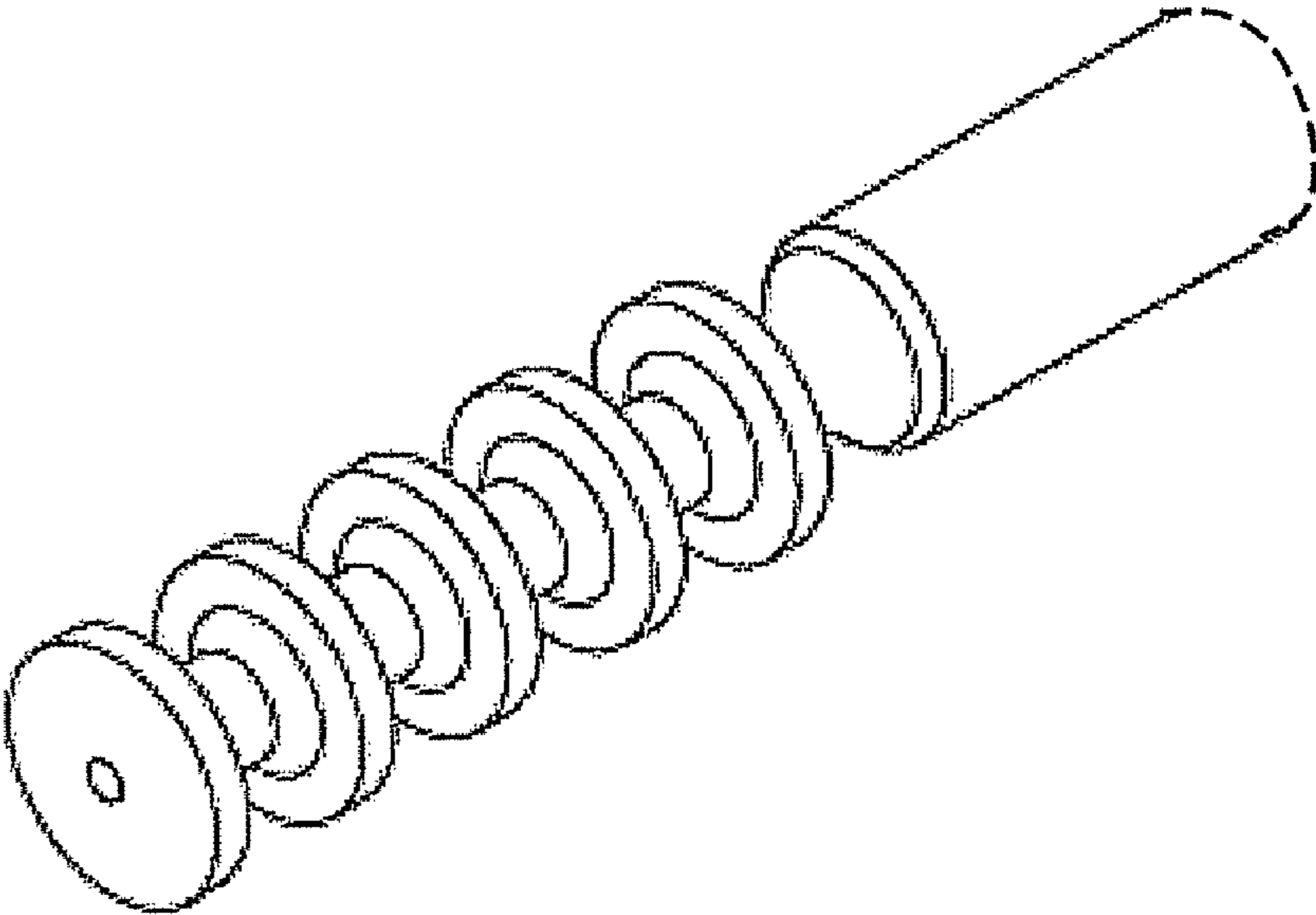

FIG. 1

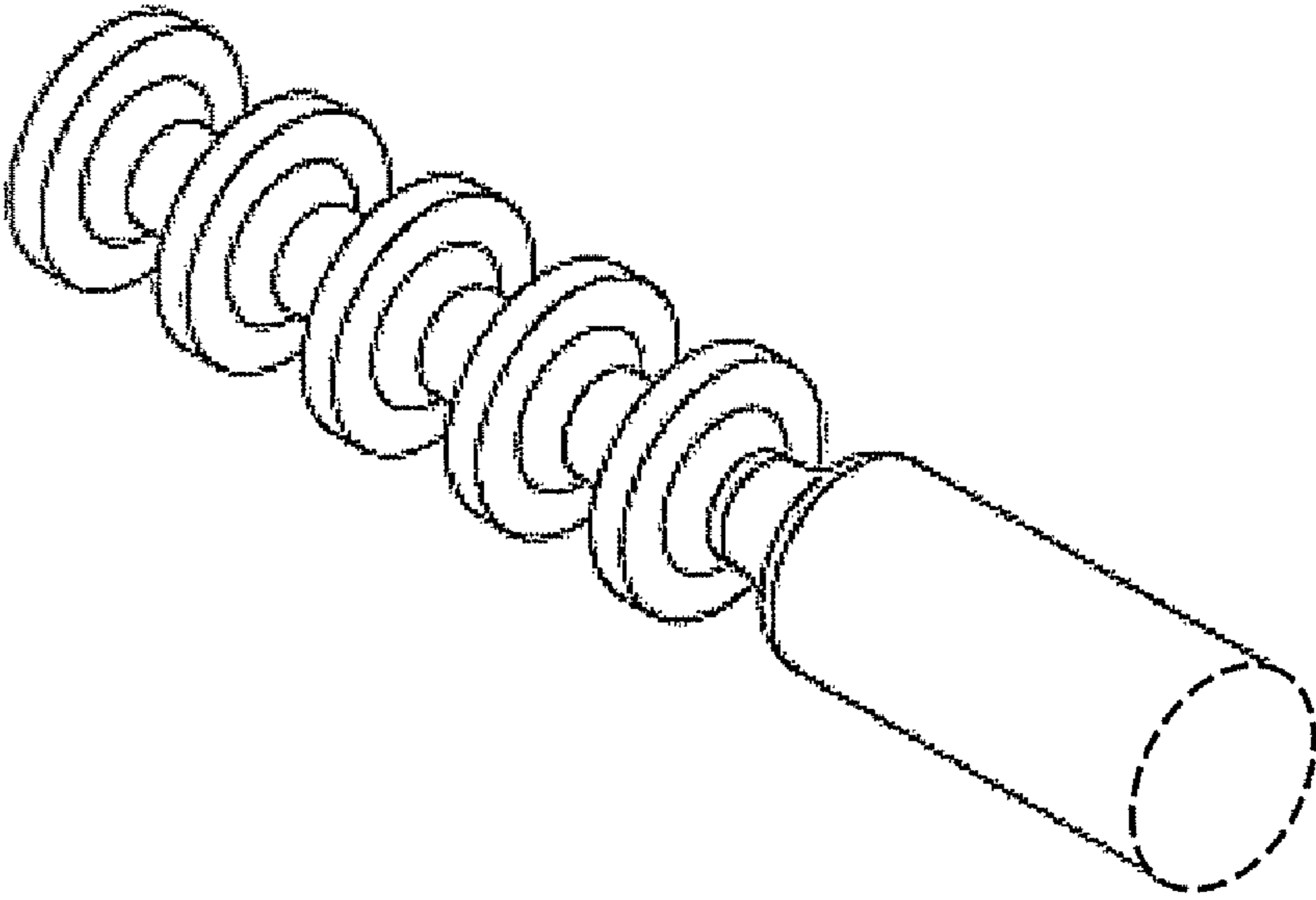

FIG. 2

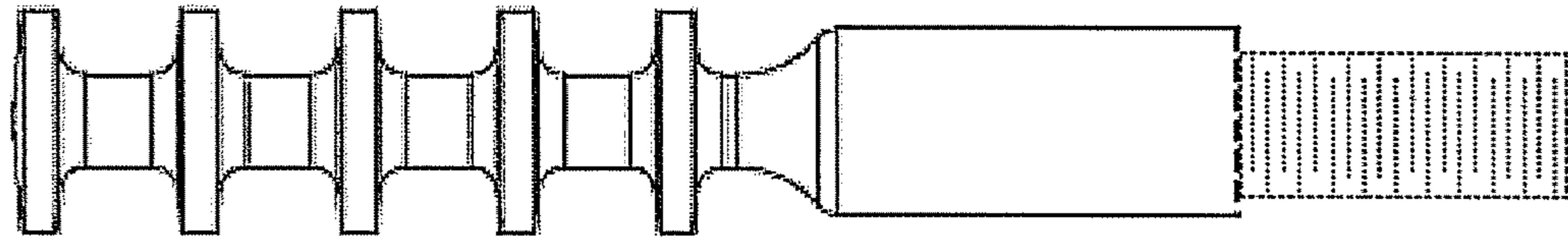

FIG. 3

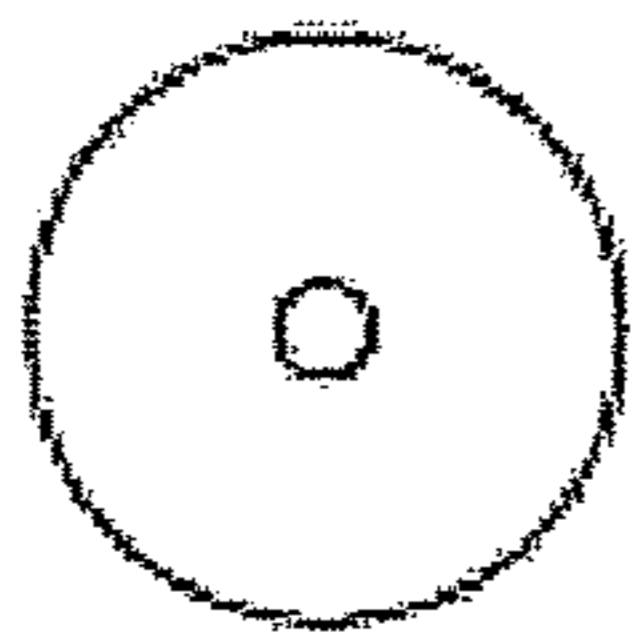

FIG. 4

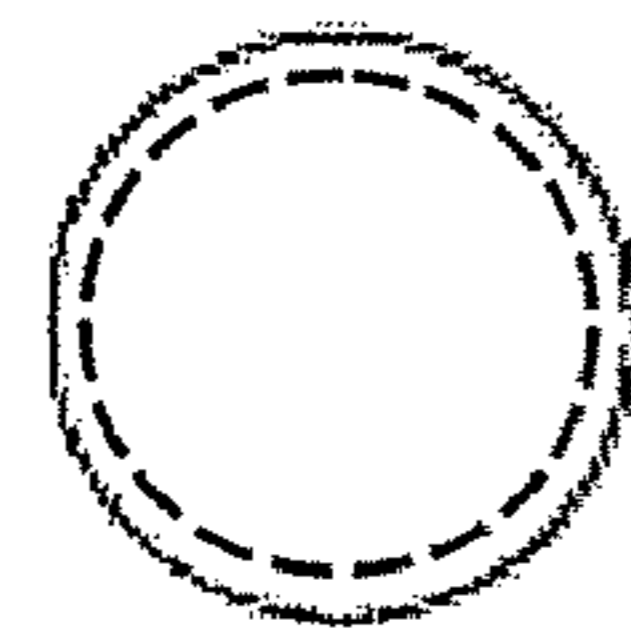

FIG. 5

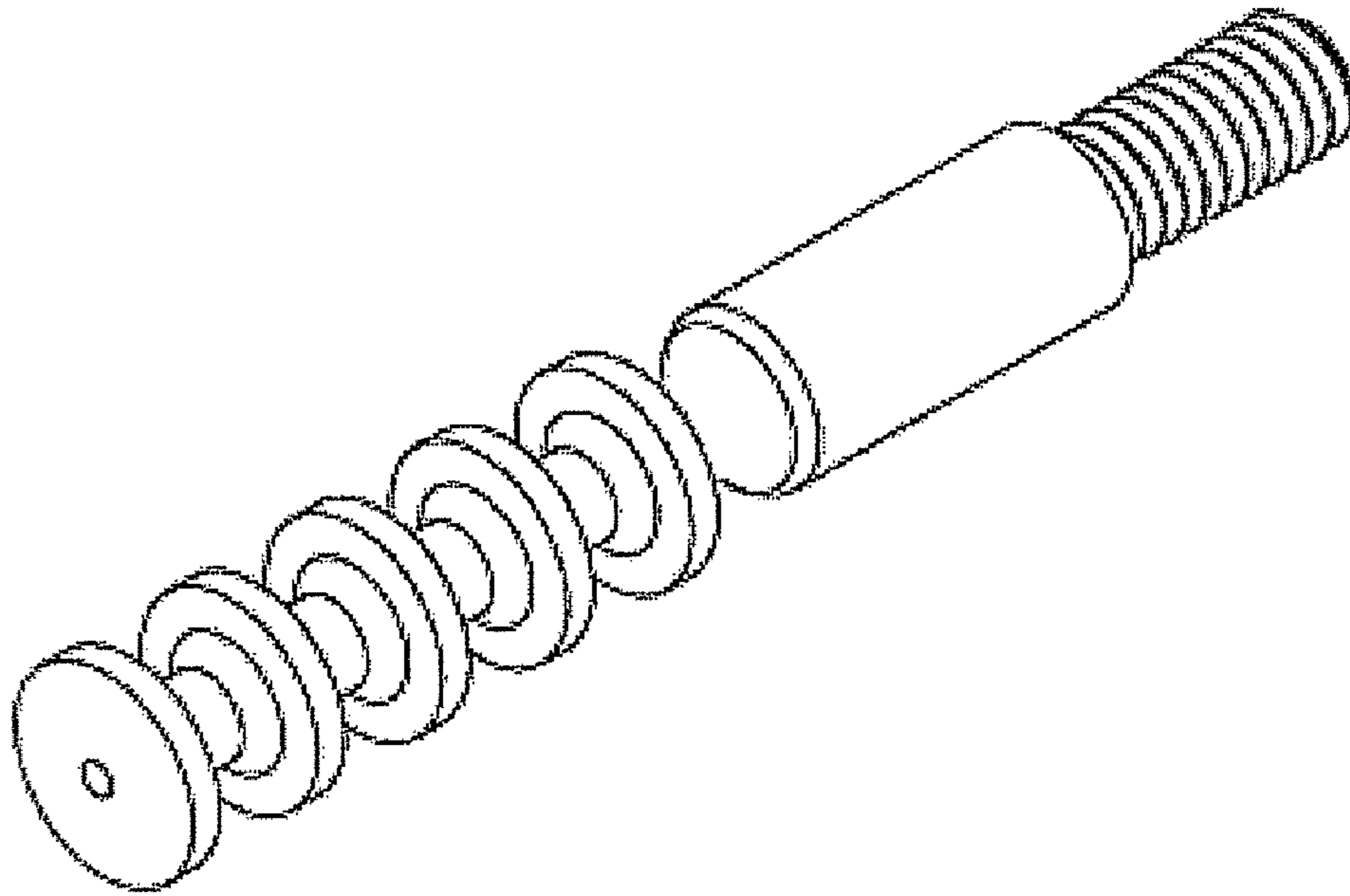

FIG. 6

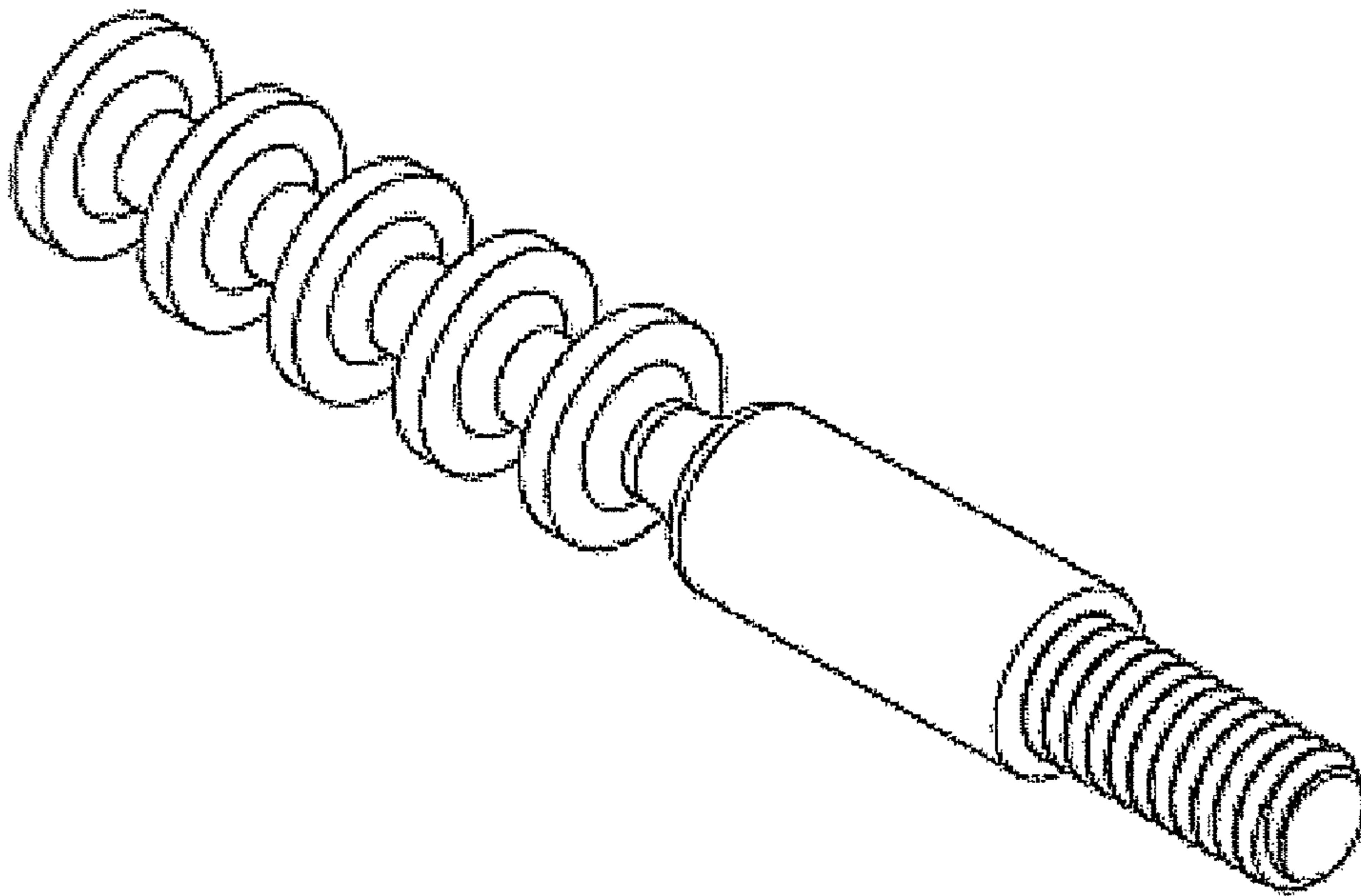

FIG. 7

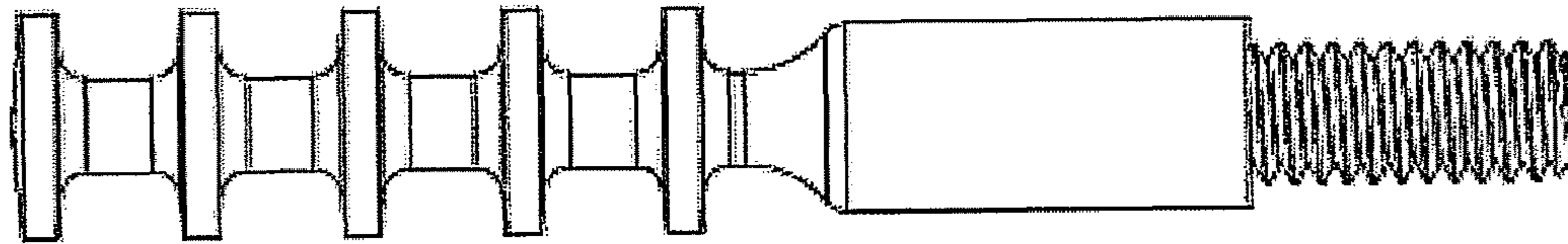

FIG. 8

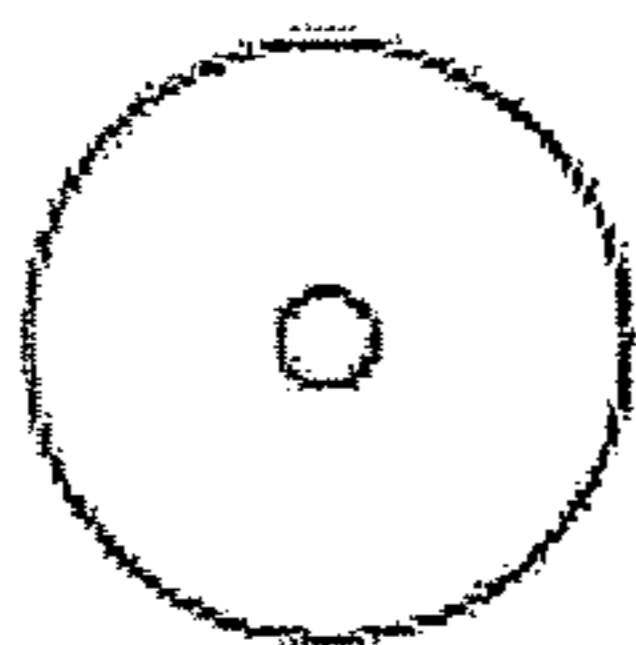

FIG. 9

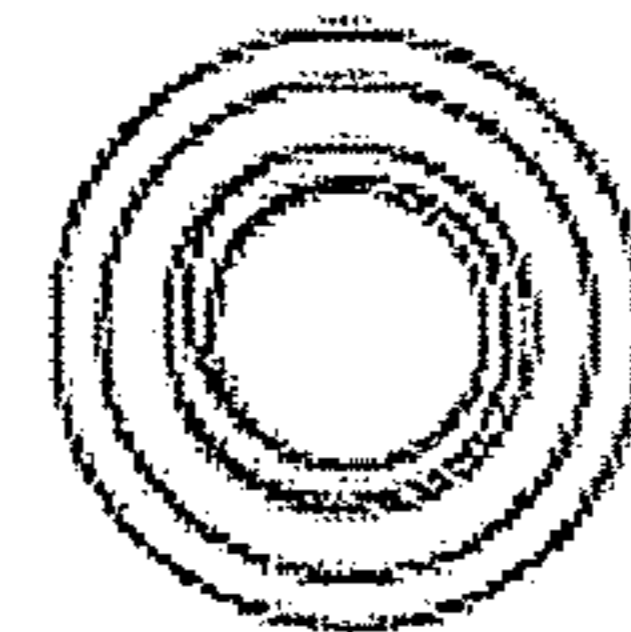

FIG. 10