



US00D651620S

(12) **United States Design Patent**
Schindler et al.

(10) **Patent No.:** **US D651,620 S**

(45) **Date of Patent:** **** *Jan. 3, 2012**

(54) **MACHINE TOOL**

(75) Inventors: **Dominic Schindler**, Lauter (AT);
Reinhold Seitz, Hopferau (DE)

(73) Assignee: **Gildemeister AG**, Bielefeld (DE)

(**) Term: **14 Years**

(21) Appl. No.: **29/368,961**

(22) Filed: **Aug. 31, 2010**

Related U.S. Application Data

(62) Division of application No. 29/304,673, filed on Mar. 5, 2008, now Pat. No. Des. 638,449.

(30) **Foreign Application Priority Data**

Sep. 5, 2007 (DE) 40704516

(51) **LOC (9) Cl.** **15-09**

(52) **U.S. Cl.** **D15/122**

(58) **Field of Classification Search** D15/122,
D15/127, 130, 131; 74/608; 82/117, 118,
82/133, 134, 138, 149, 152; 198/860.3; 210/400;
714/48

See application file for complete search history.

(56) **References Cited**

U.S. PATENT DOCUMENTS

D241,160	S	*	8/1976	Gurian et al.	D15/122
D301,585	S		6/1989	Linn	
D319,834	S		9/1991	Rutschle	
5,392,501	A	*	2/1995	Sonnek	29/27 C
D422,289	S		4/2000	Mariotta et al.	
D424,584	S	*	5/2000	Kawahara et al.	D15/122
D445,807	S		7/2001	Baulk	
D472,250	S		3/2003	Mariotta et al.	
D489,077	S		4/2004	Bloch	
6,758,798	B2	*	7/2004	Fioroni	483/14
D614,211	S	*	4/2010	De Vries et al.	D15/122
2008/0168860	A1	*	7/2008	Nishi et al.	74/616

* cited by examiner

Primary Examiner — Patricia Palasik

(74) *Attorney, Agent, or Firm* — The Maxham Firm

(57) **CLAIM**

The ornamental design for a machine tool, as shown and described.

DESCRIPTION

FIG. 1 is a front view of the machine tool according to the invention;

FIG. 2 is a back view thereof;

FIG. 3 is a left side view thereof;

FIG. 4 is a right side view thereof;

FIG. 5 is a top view thereof;

FIG. 6 is a bottom view thereof; and,

FIG. 7 is a perspective view thereof.

1 Claim, 7 Drawing Sheets

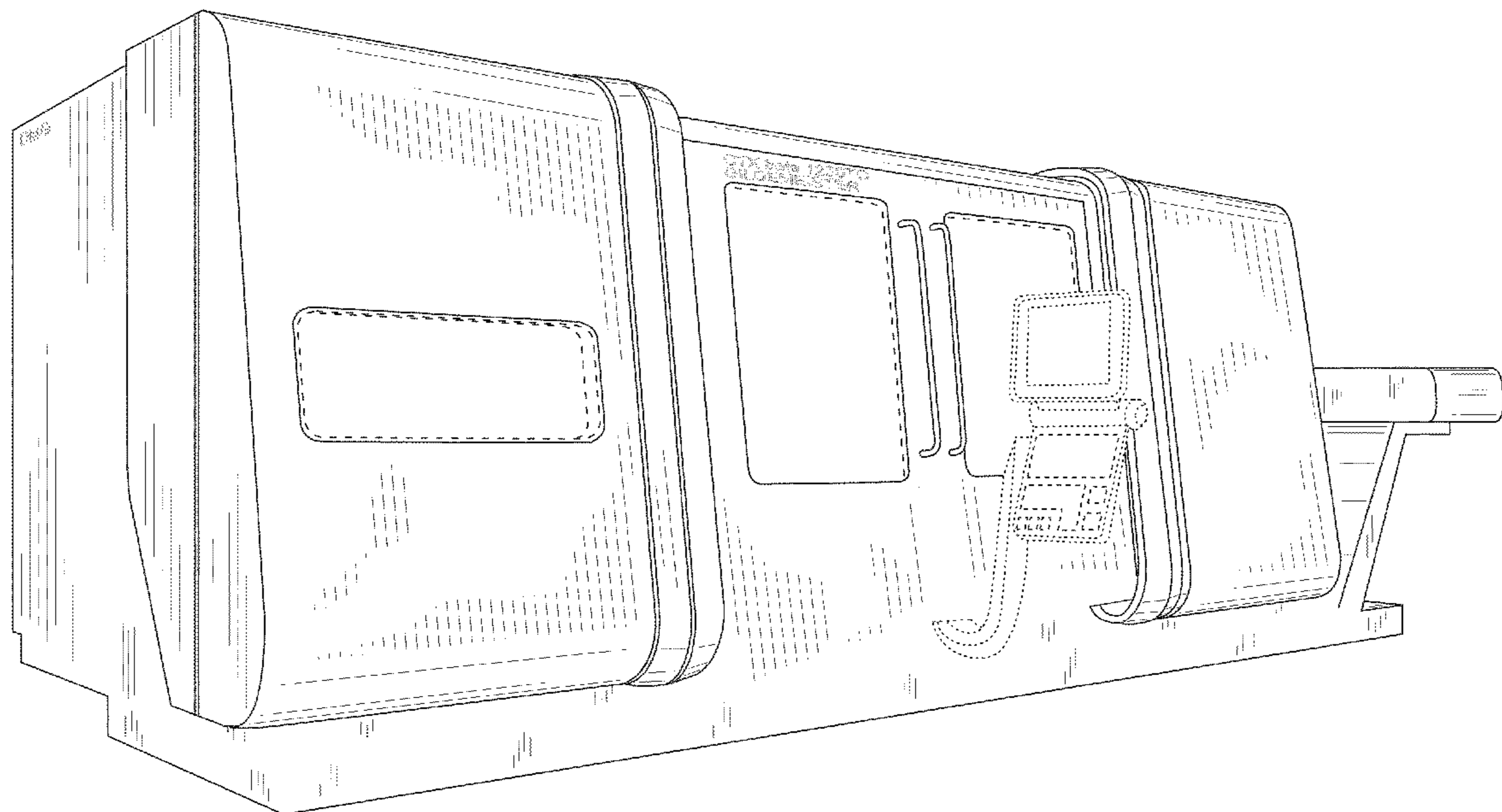

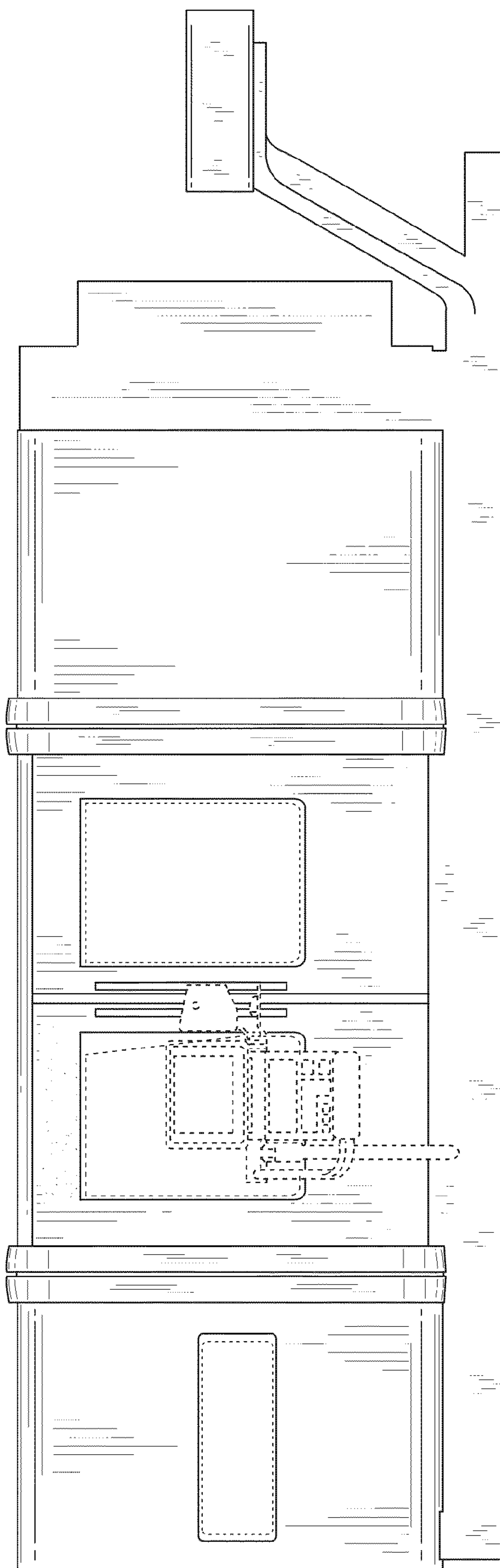

FIG. 1

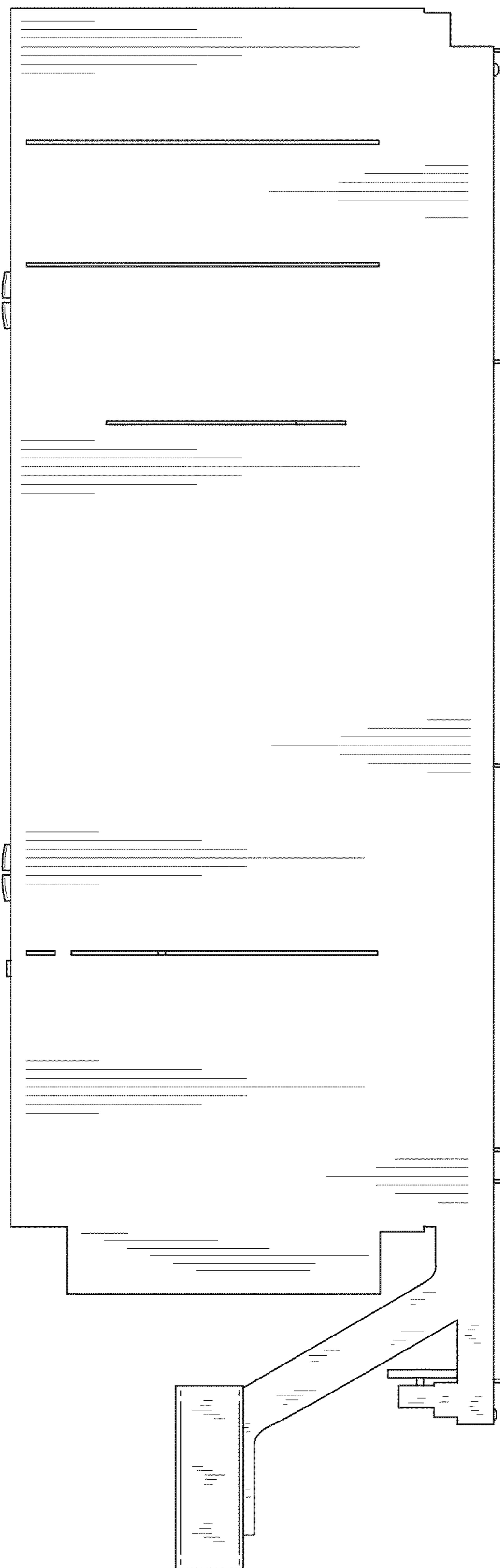

FIG. 2

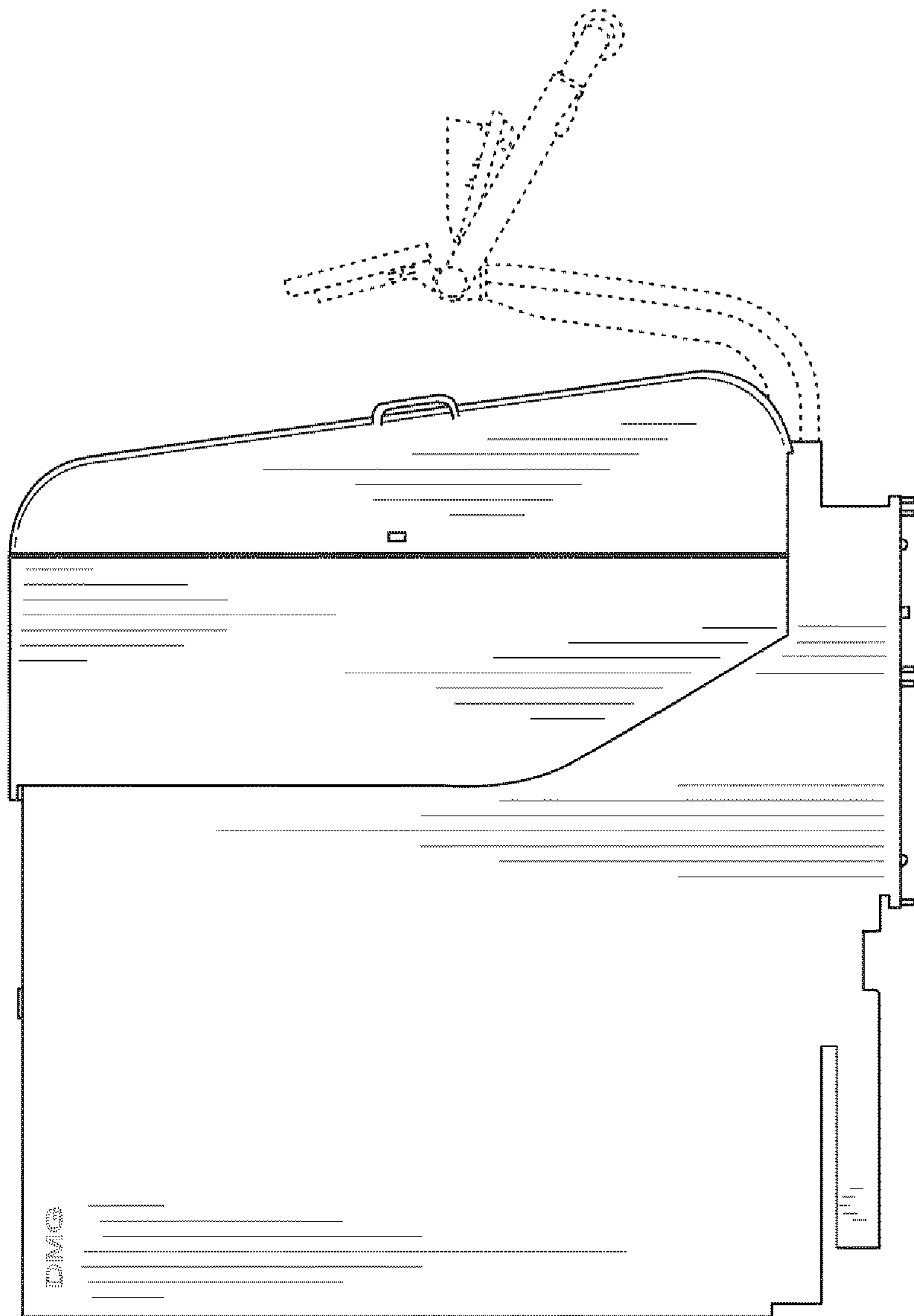

FIG. 3

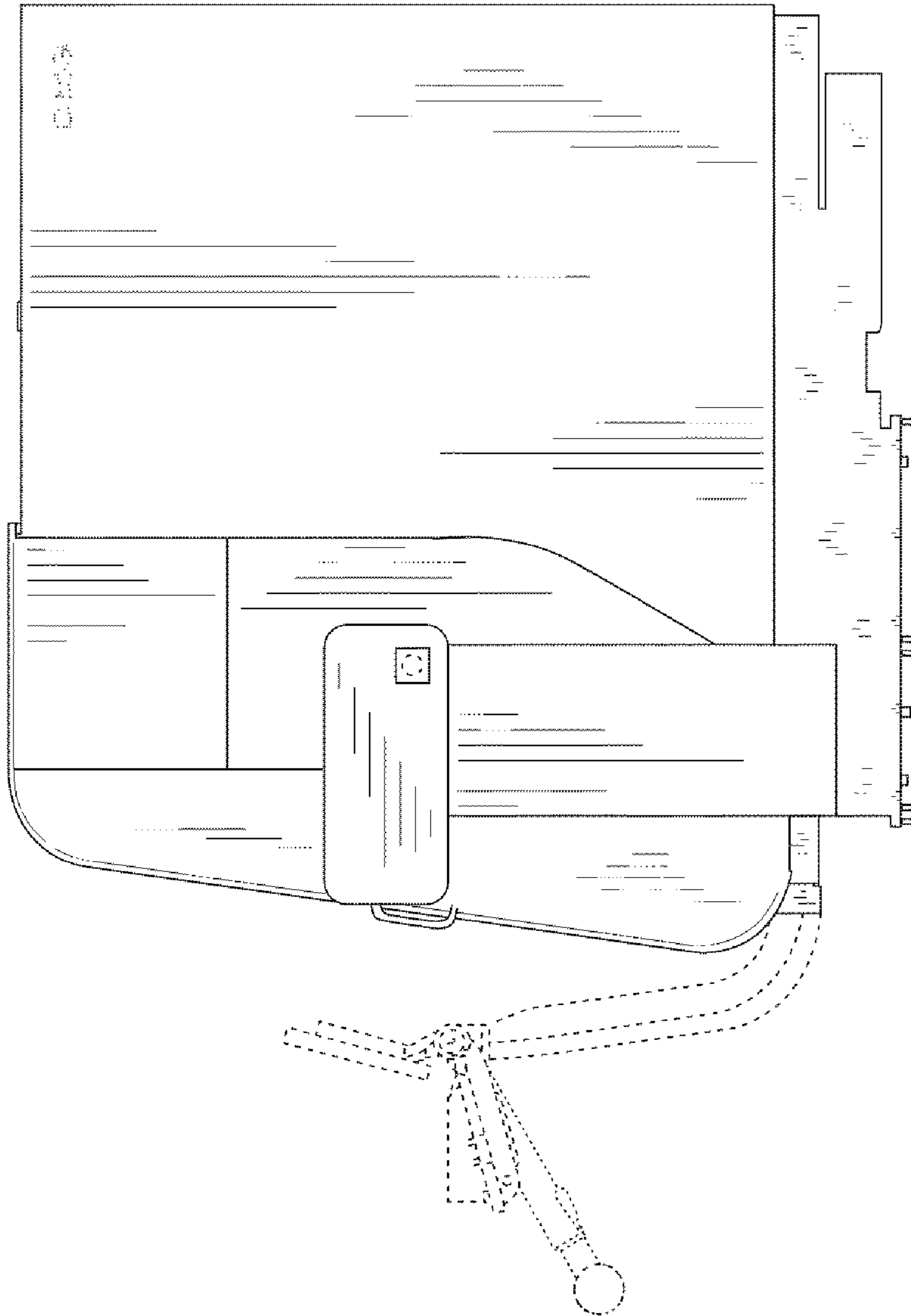

FIG. 4

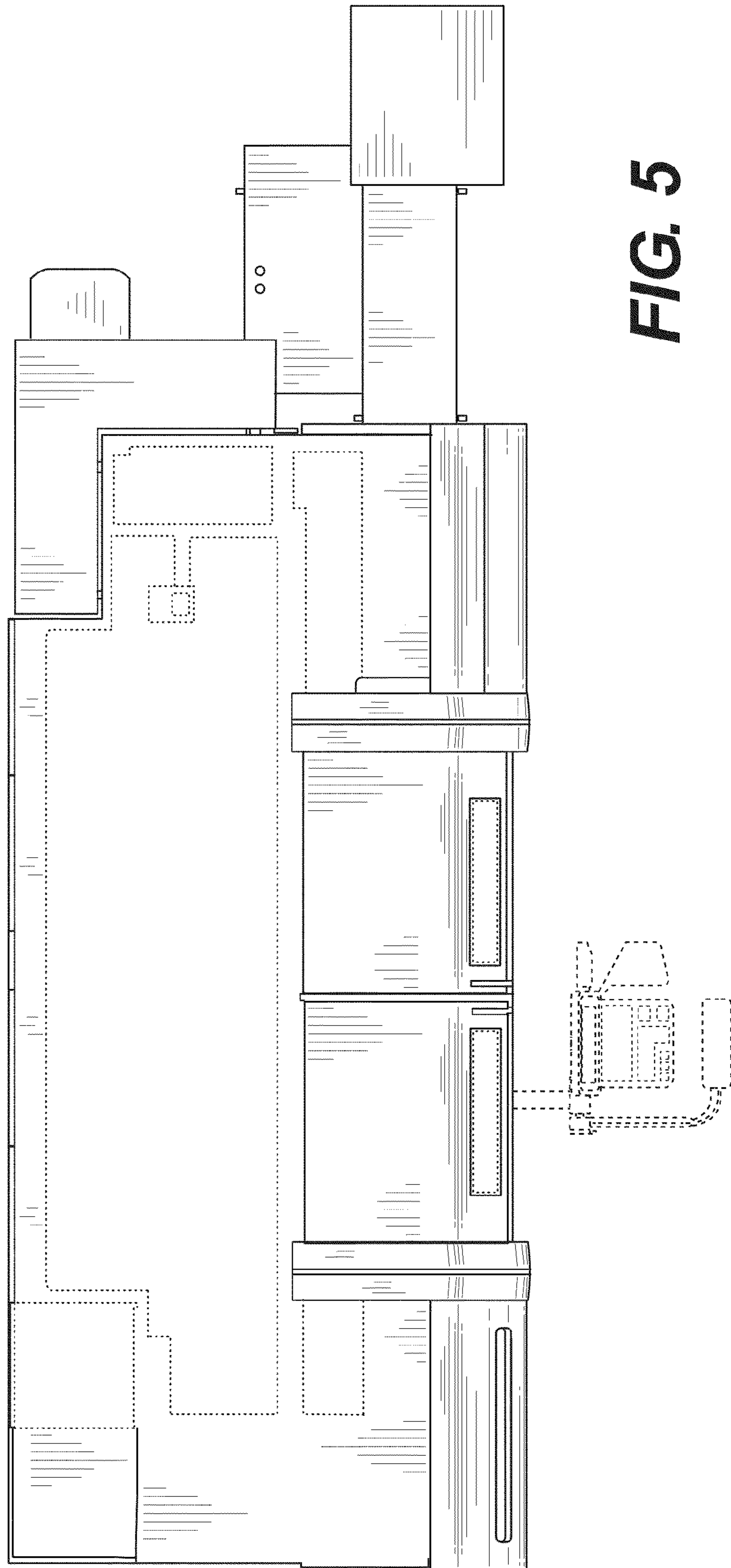

FIG. 5

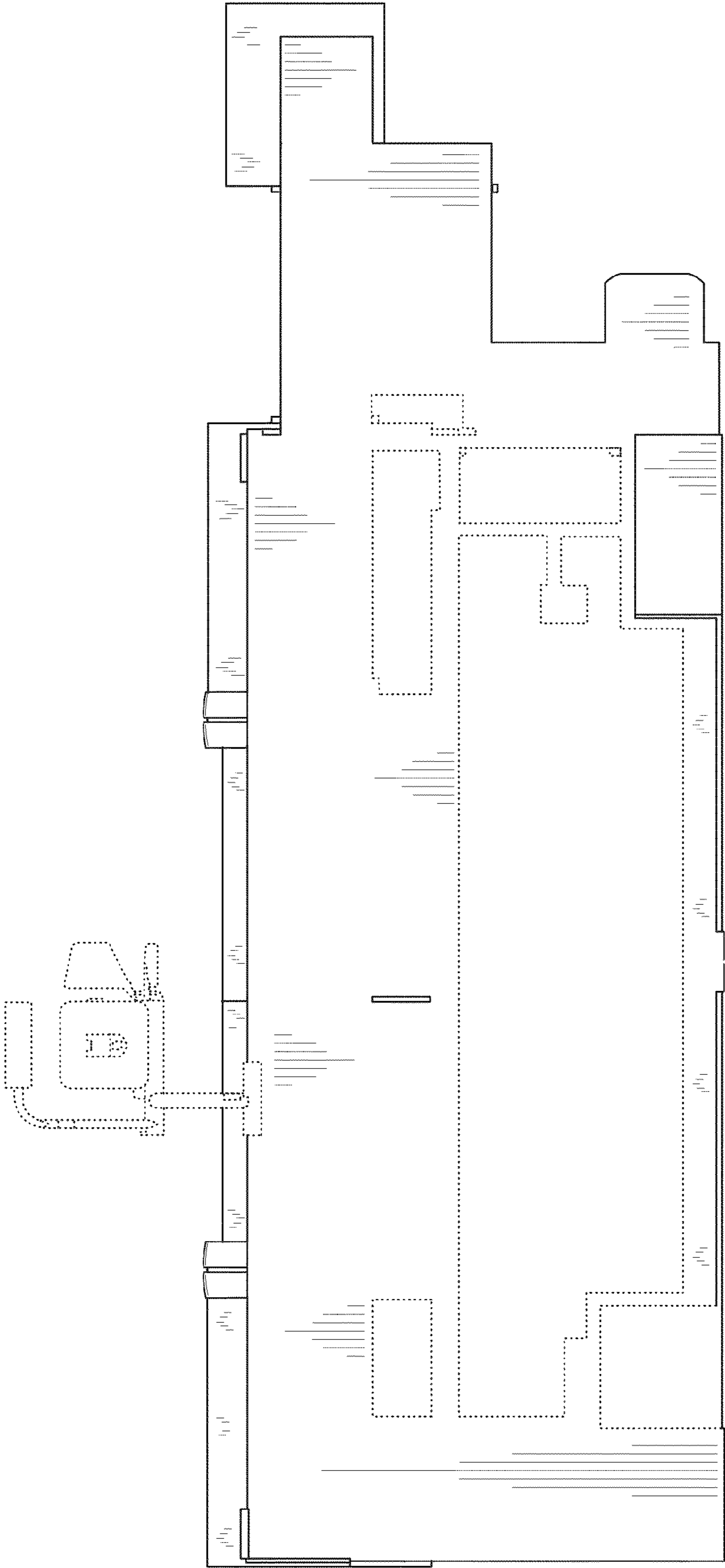

FIG. 6

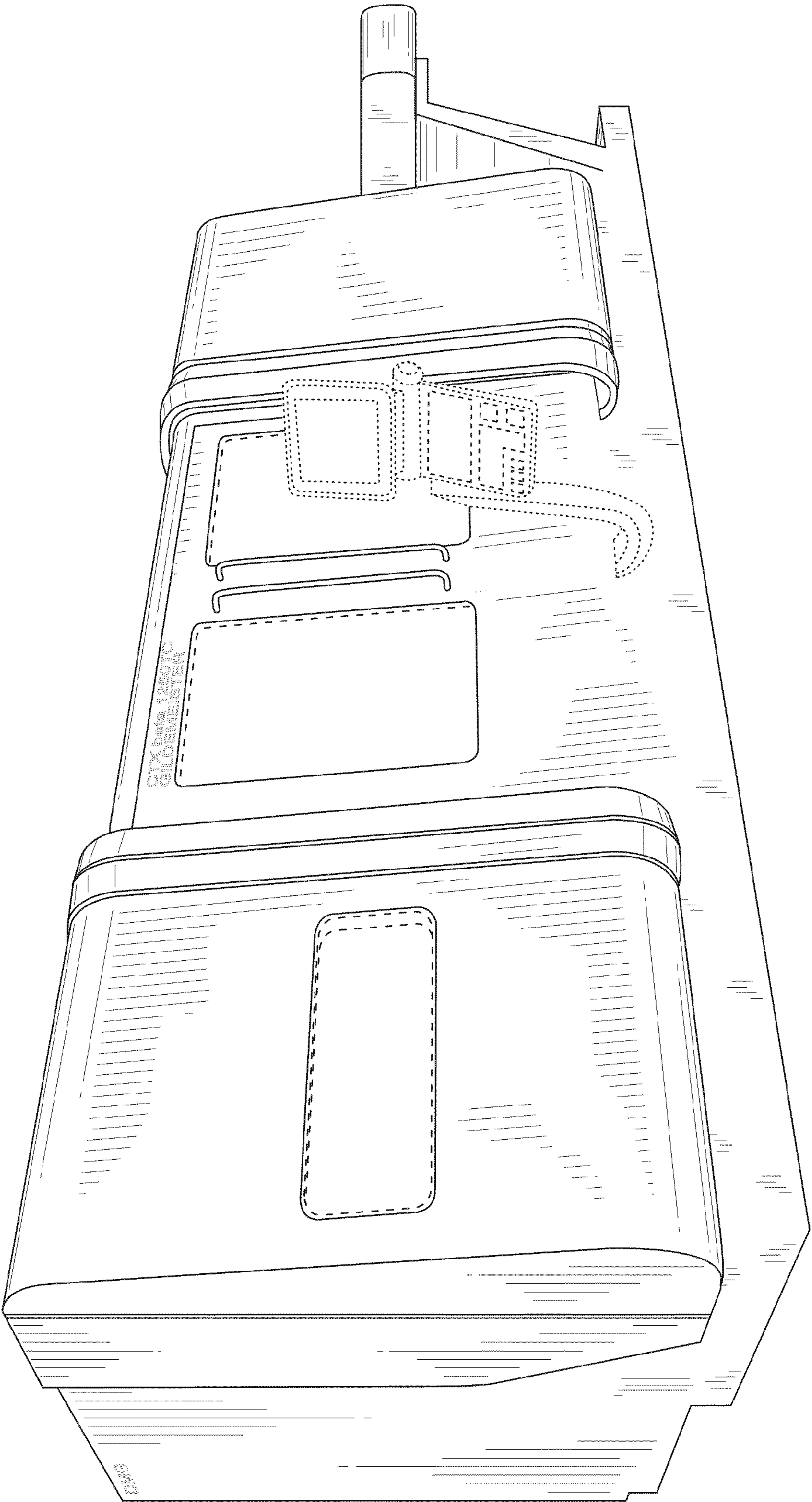

FIG. 7