



US00D651427S

(12) **United States Design Patent**
Cox

(10) **Patent No.:** **US D651,427 S**
(45) **Date of Patent:** **** Jan. 3, 2012**

(54) **CHAIR**

(76) Inventor: **Emily Cox**, Cary, IL (US)

(**) Term: **14 Years**

(21) Appl. No.: **29/387,094**

(22) Filed: **Mar. 9, 2011**

(51) **LOC (9) Cl.** **06-01**

(52) **U.S. Cl.** **D6/375**

(58) **Field of Classification Search** D6/310,
D6/334-336, 348, 349, 358-381, 500-502;
5/12.1, 633; 297/31, 118, 129, 239, 271.6,
297/11.2, 411.27, 411.28, 440.12, 440.13,
297/440.15, 440.19, 440.23, 445.1, 452.17,
297/452.19, 452.63

See application file for complete search history.

(56) **References Cited**

U.S. PATENT DOCUMENTS

3,642,323	A *	2/1972	Taylor	297/452.17
3,695,703	A *	10/1972	Notko	297/440.12
3,717,377	A *	2/1973	Johnson	297/440.12
3,742,526	A *	7/1973	Lillard	5/12.1
D240,311	S *	6/1976	Owens	D6/375
D240,575	S *	7/1976	Rinaldi	D6/372
4,052,104	A *	10/1977	Noss	297/452.63
4,092,049	A *	5/1978	Schoblom	297/440.23
D248,802	S *	8/1978	Iselin	D6/364
4,230,365	A *	10/1980	Messinger	297/452.19
4,235,473	A *	11/1980	Aginar	297/440.19
D266,044	S *	9/1982	Blanchard	D6/375
D273,156	S *	3/1984	Dubbin et al.	D6/334
D286,586	S *	11/1986	Radford	D6/334
4,970,742	A *	11/1990	Keener	5/633
D332,530	S *	1/1993	Nguyen	D6/370

D364,749	S *	12/1995	McKnight	D6/375
D372,805	S *	8/1996	Bonaddio et al.	D6/375
D399,660	S *	10/1998	Smith	D6/334
D443,769	S *	6/2001	Tiffany et al.	D6/370
D498,068	S *	11/2004	Kuo	D6/368
D518,301	S *	4/2006	Ng et al.	D6/335
7,287,816	B1 *	10/2007	Karl	297/452.17
D573,380	S *	7/2008	Lentin	D6/502
D602,274	S *	10/2009	Peng et al.	D6/369
D621,628	S *	8/2010	Saul	D6/335

* cited by examiner

Primary Examiner — Ricky Pham

(74) *Attorney, Agent, or Firm* — Invention Protection Associates, LLC

(57) **CLAIM**

I claim an ornamental design for a chair, as shown and described.

DESCRIPTION

FIG. 1 is a left side elevational view showing my new design for a chair;

FIG. 2 is a right side elevational view thereof;

FIG. 3 is a front elevational view thereof;

FIG. 4 a rear elevational view thereof;

FIG. 5 is a bottom plan view thereof;

FIG. 6 is a top plan view thereof;

FIG. 7 is a top, right side perspective view thereof;

FIG. 8 is a bottom, left side perspective view thereof; and,

FIG. 9 is a top, left side perspective view thereof, shown with a person seated thereupon.

In FIG. 9, the person depicted in phantom is shown for illustrative purposes only and forms no part of the claimed design.

1 Claim, 5 Drawing Sheets

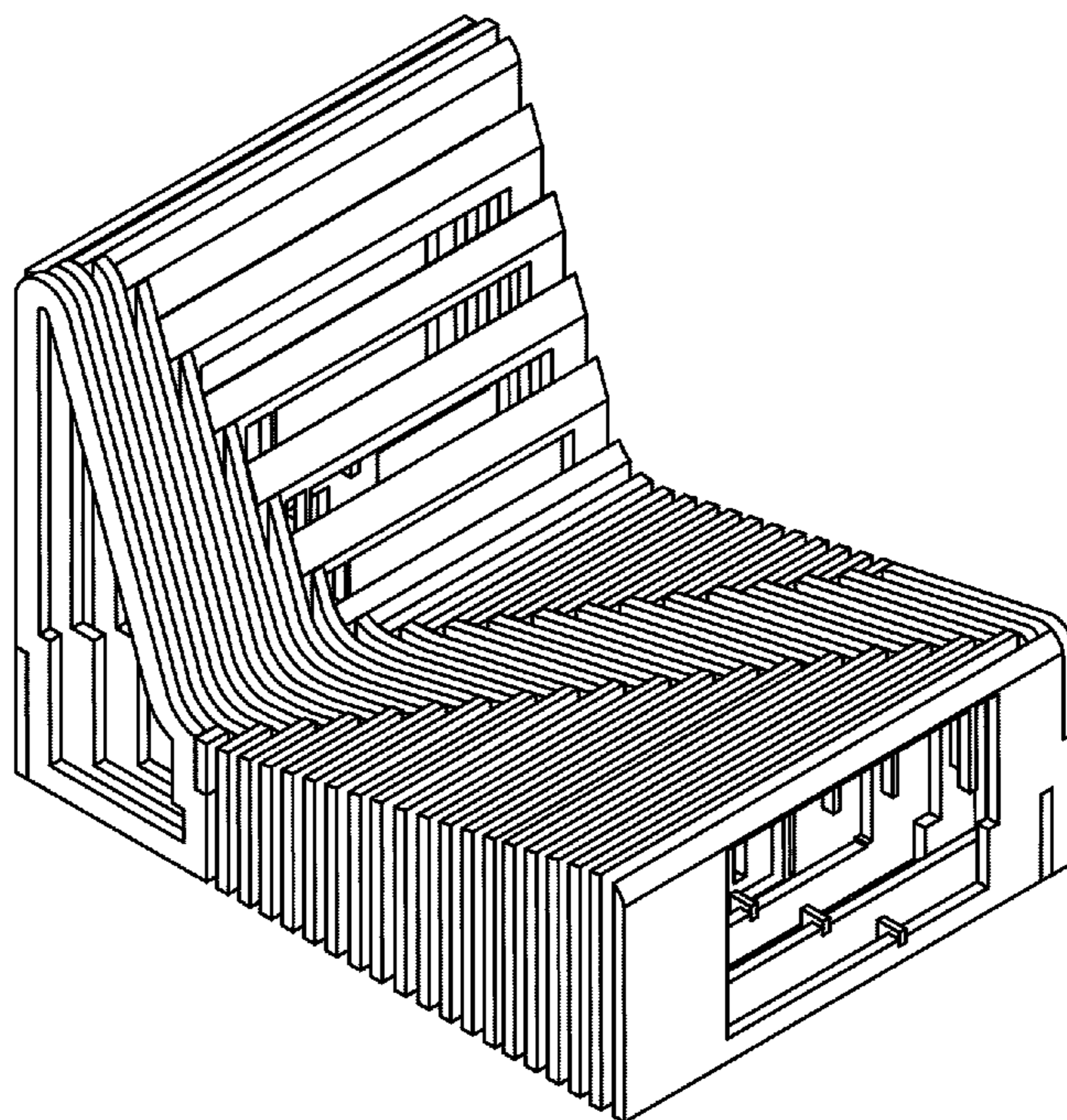

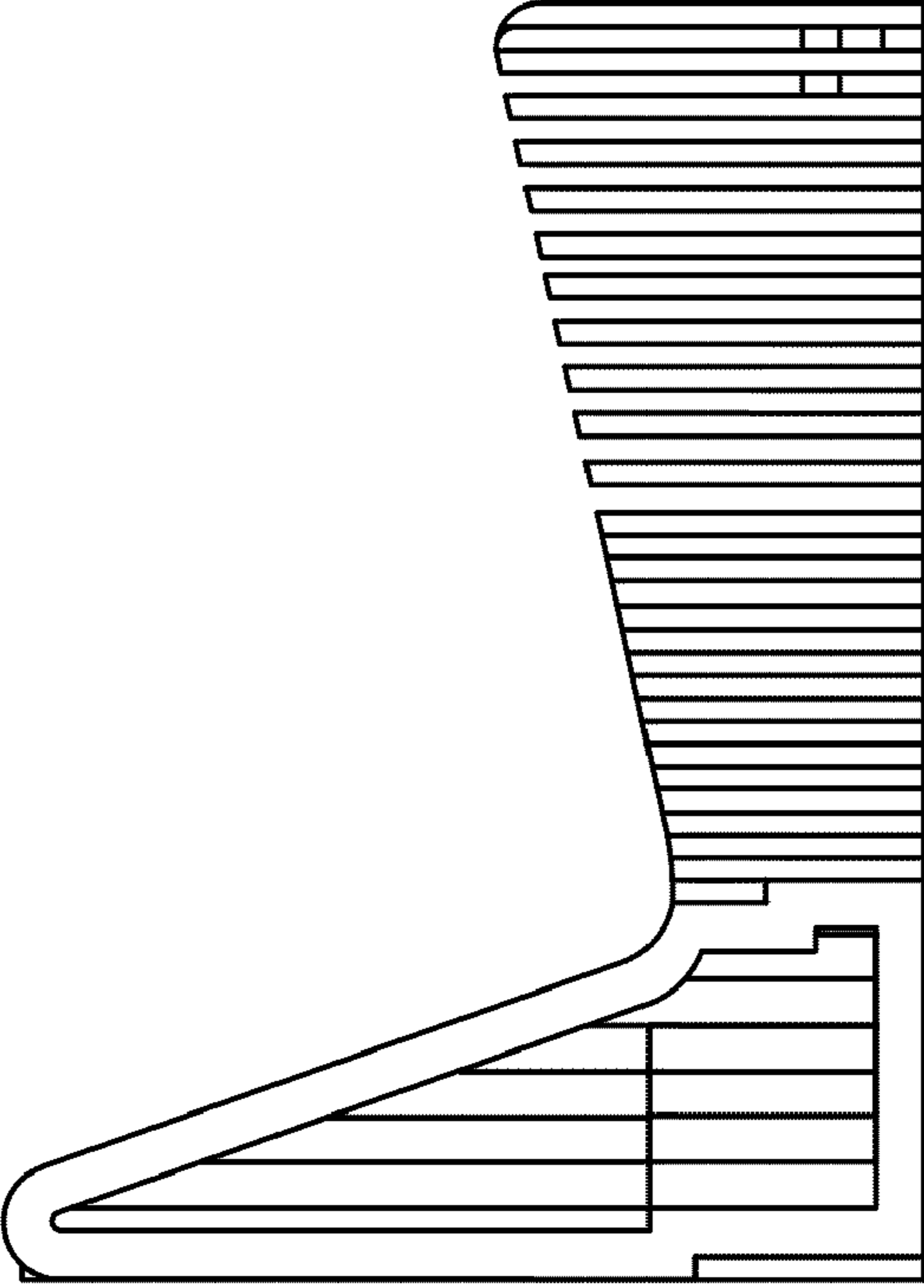

FIG. 1

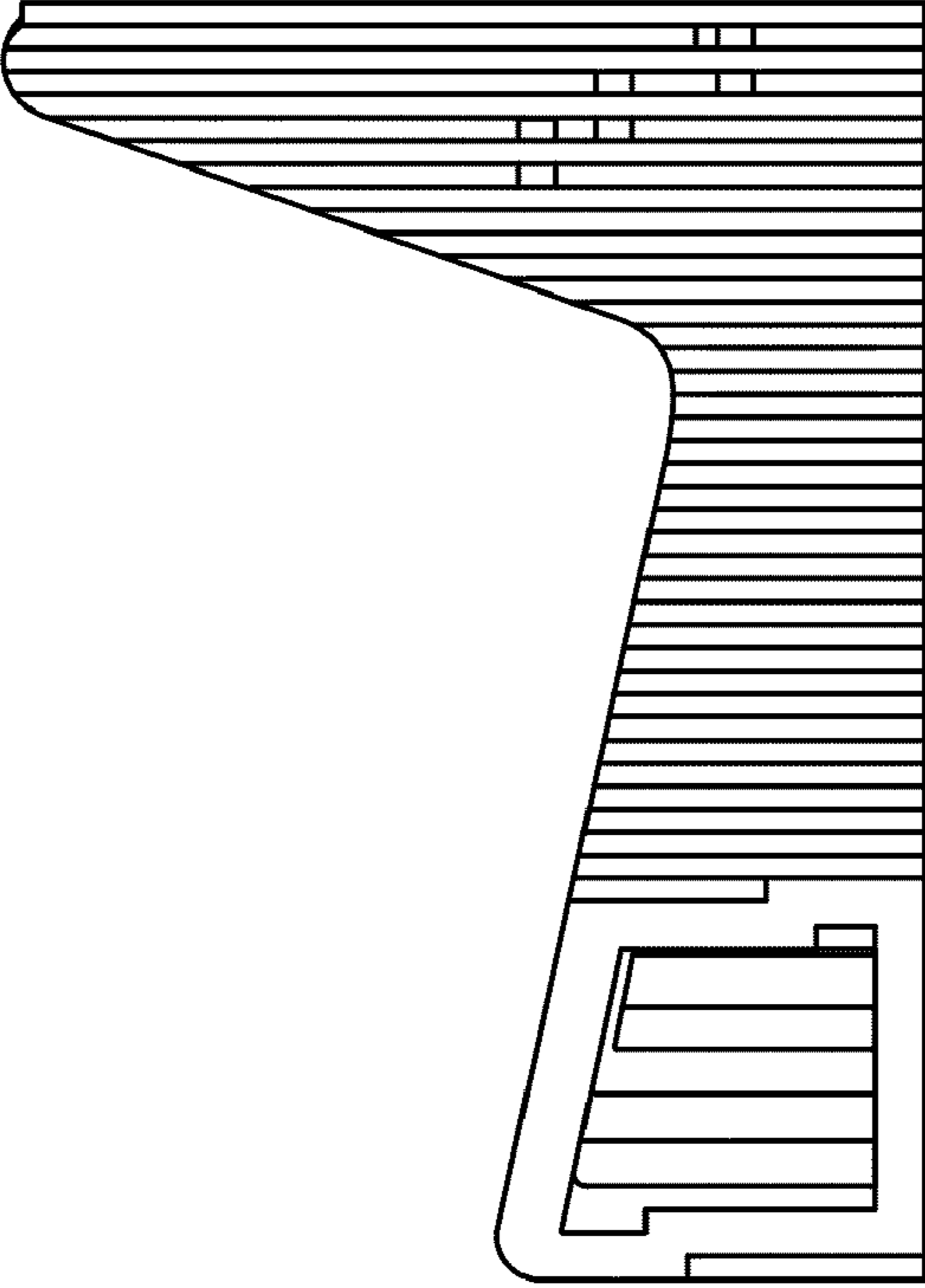

FIG. 2

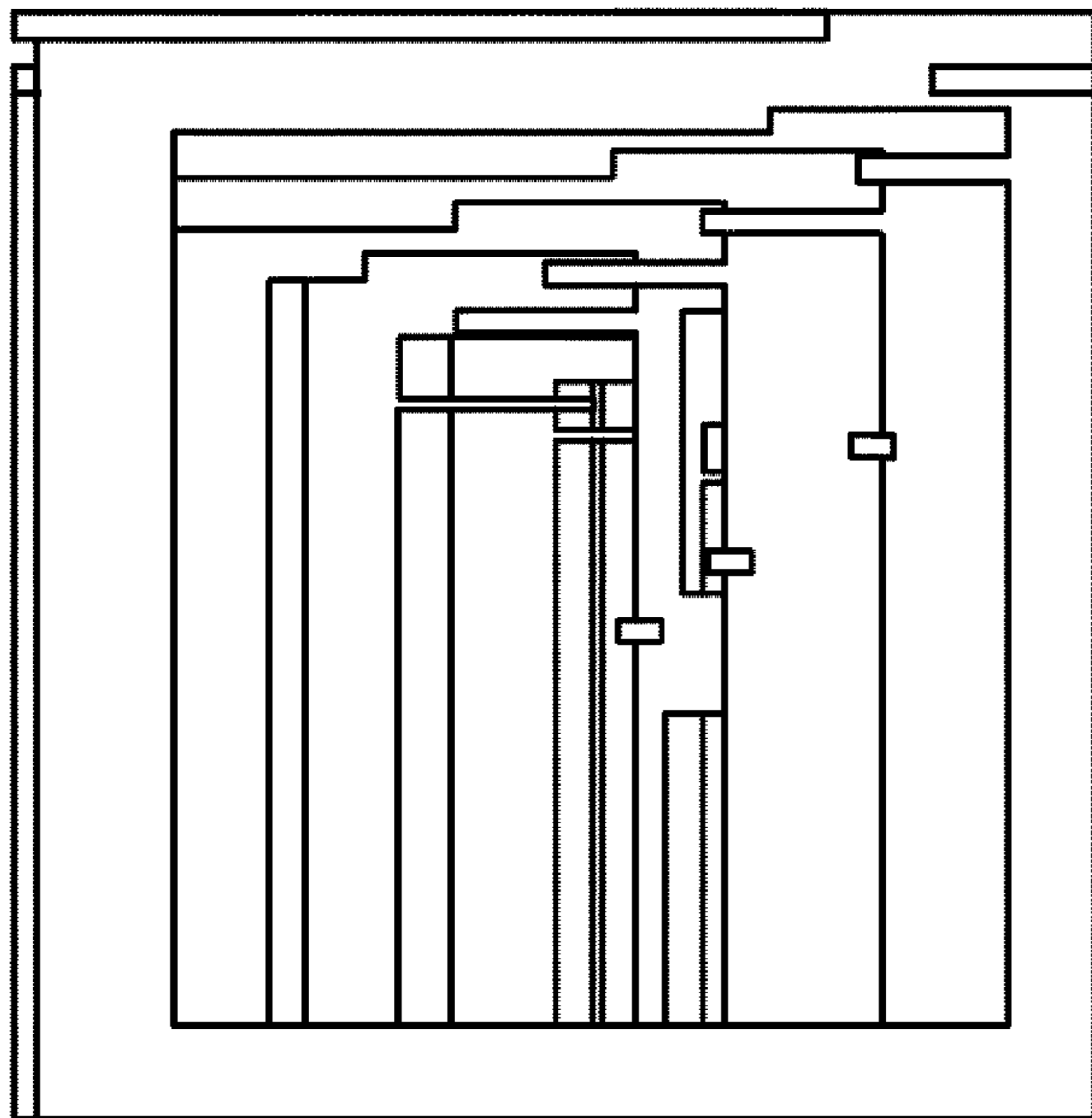

FIG. 4

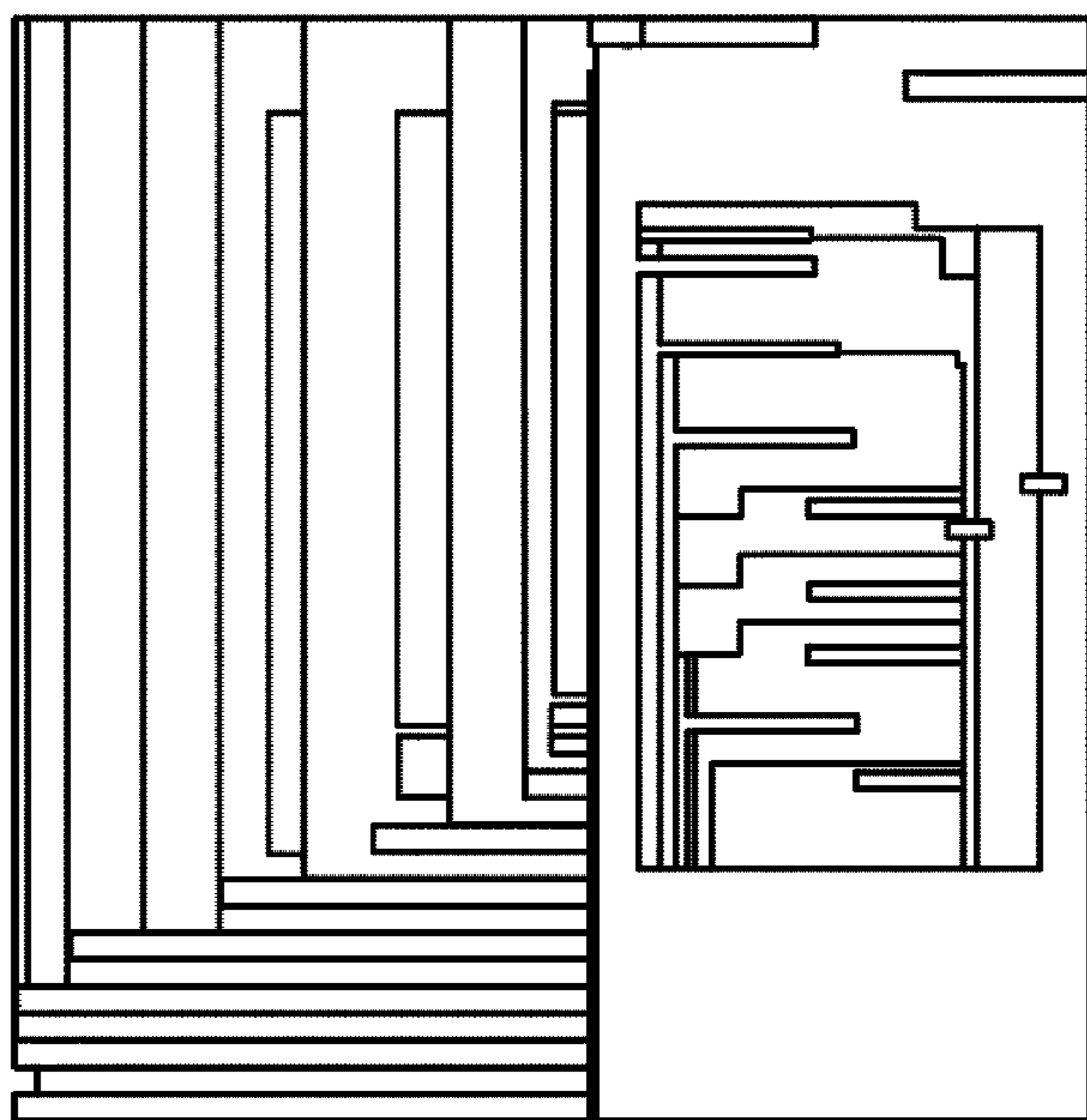

FIG. 3

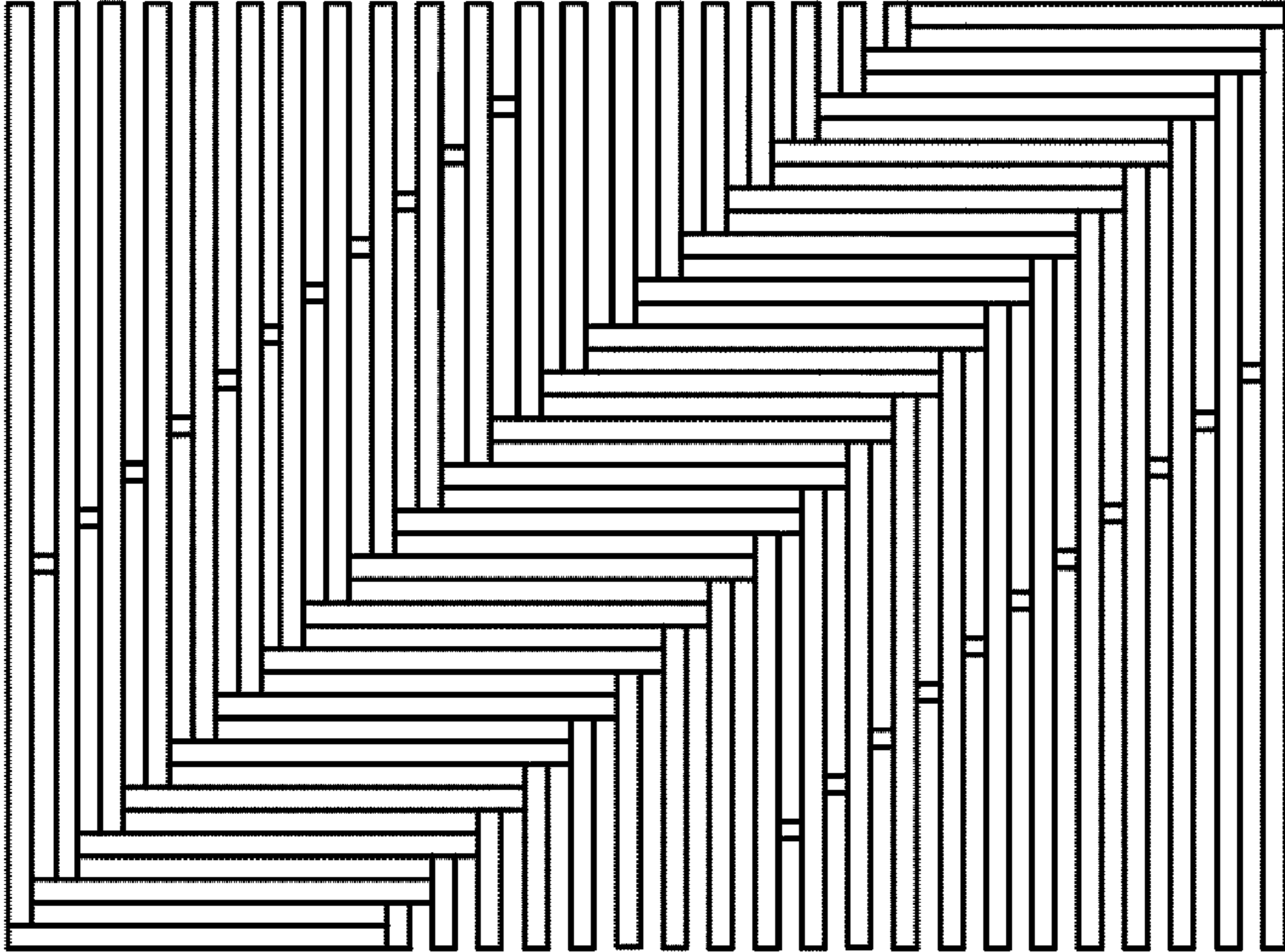

FIG. 6

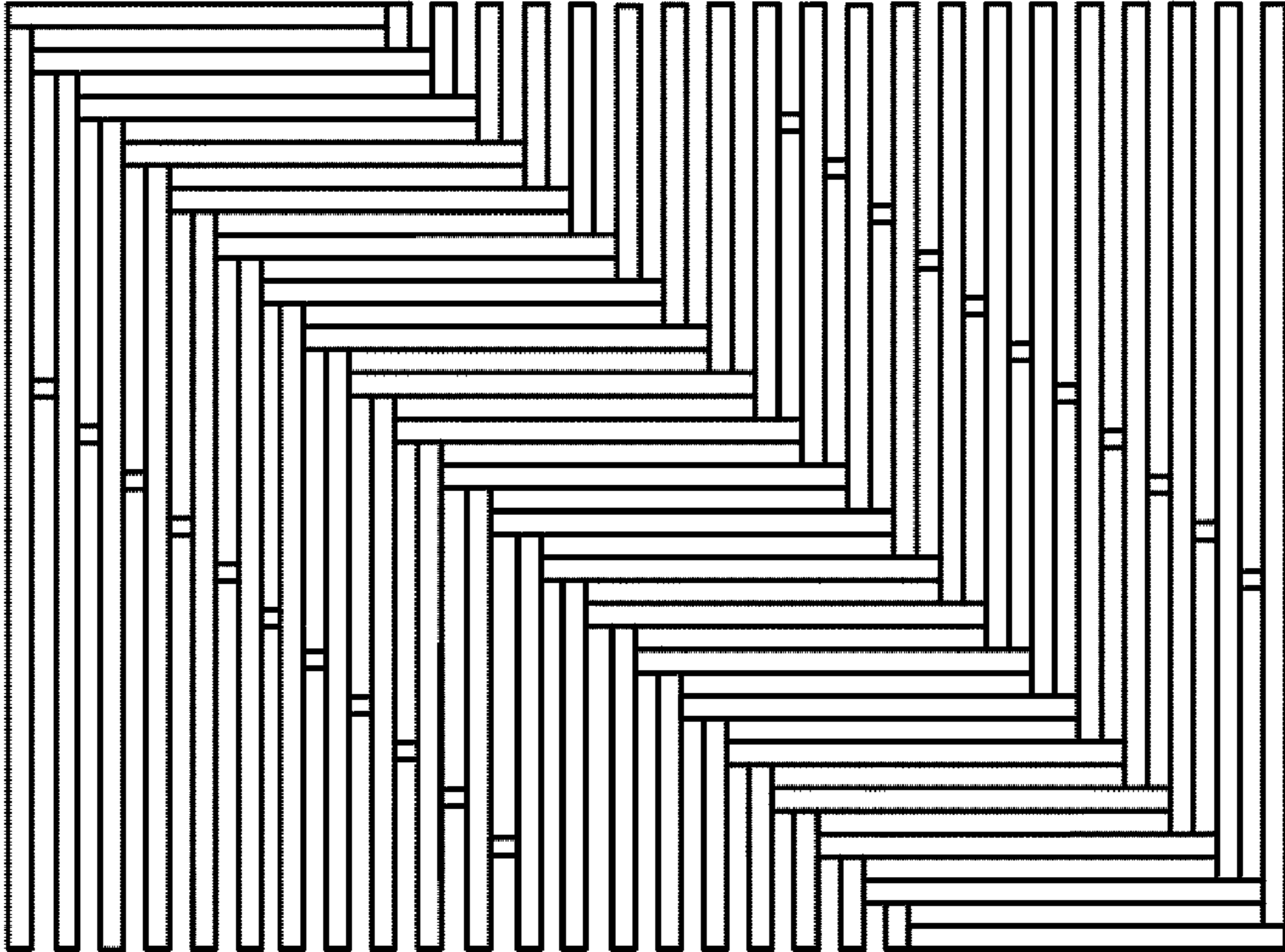

FIG. 5

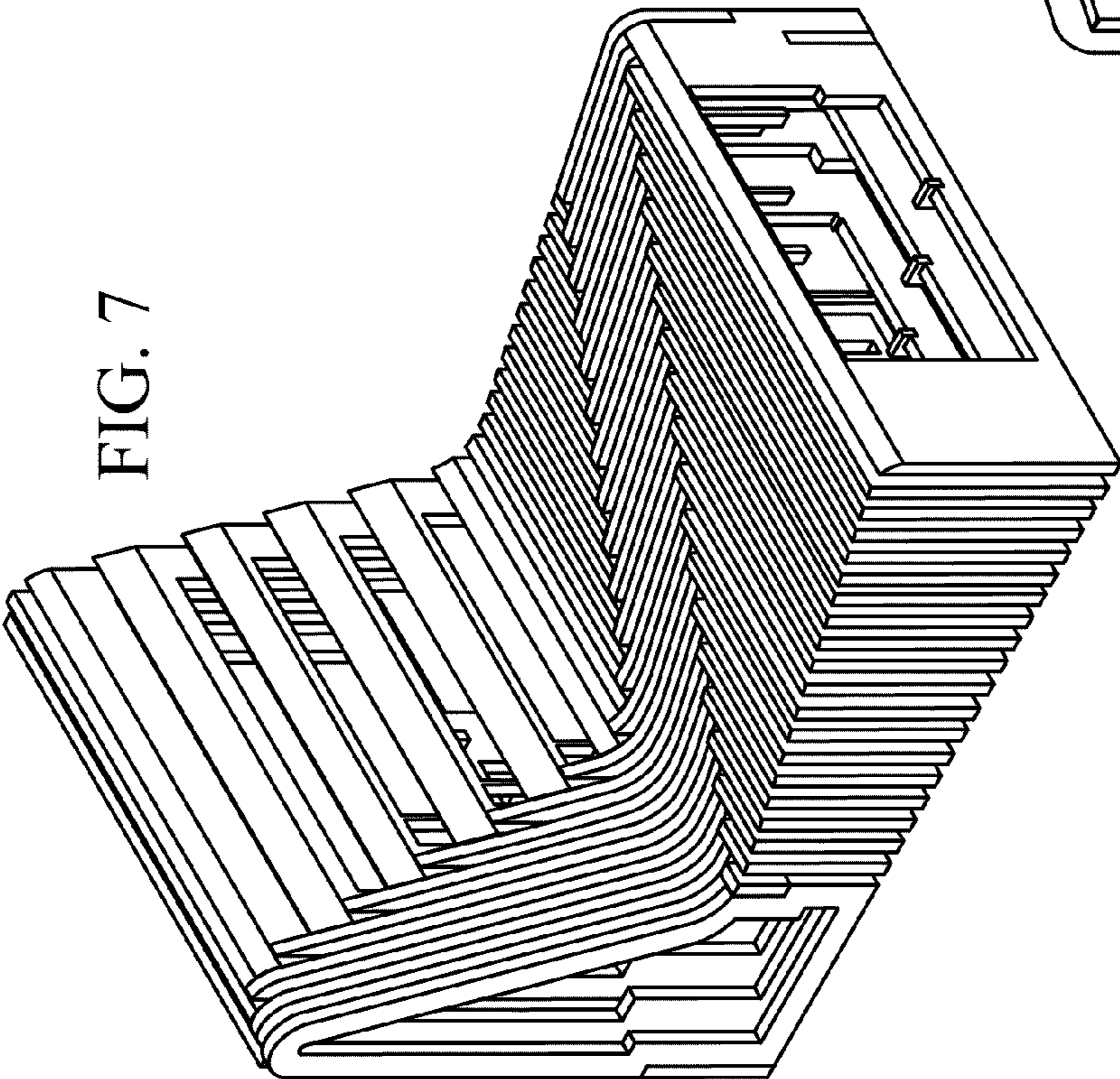

FIG. 7

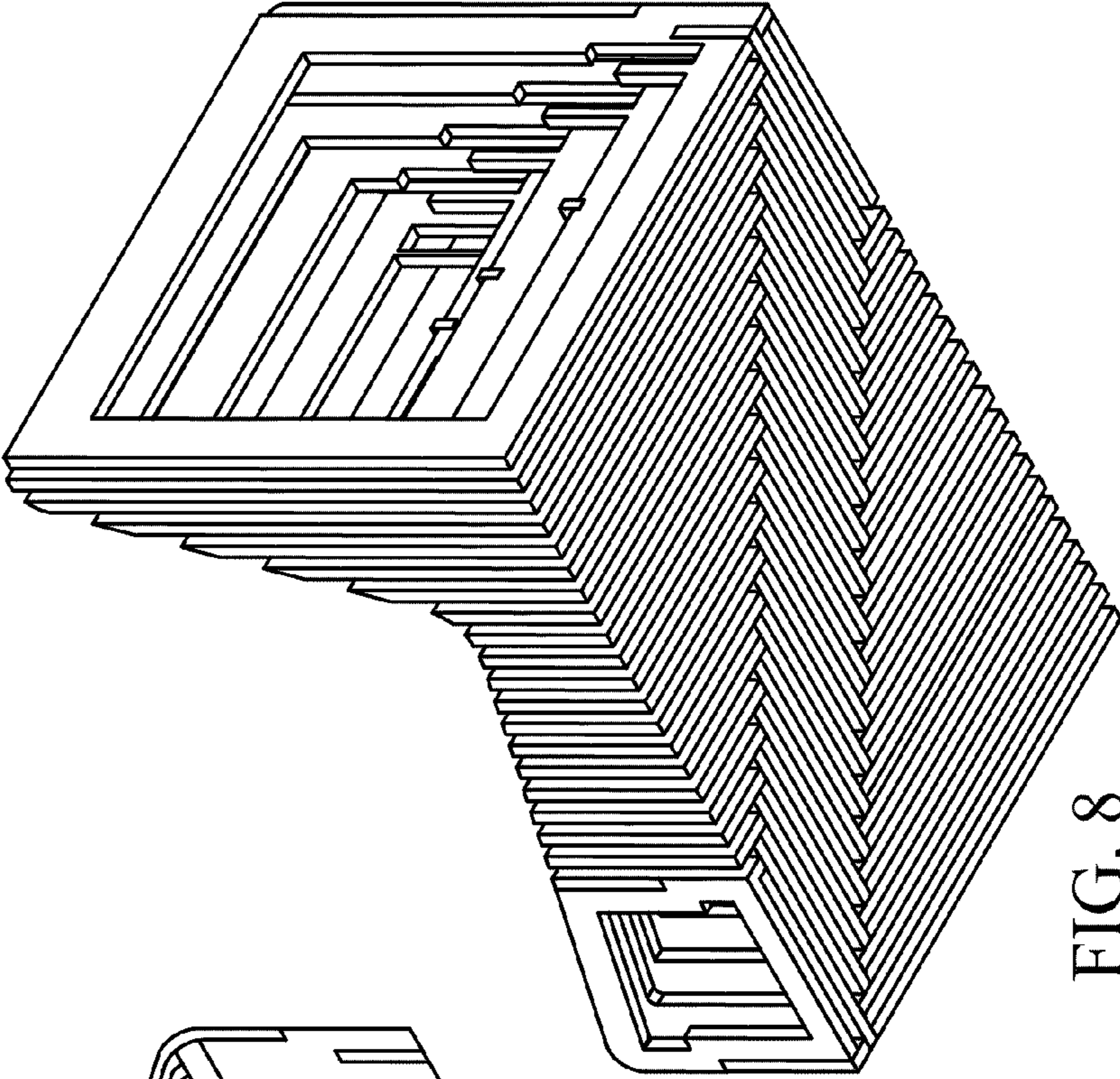

FIG. 8

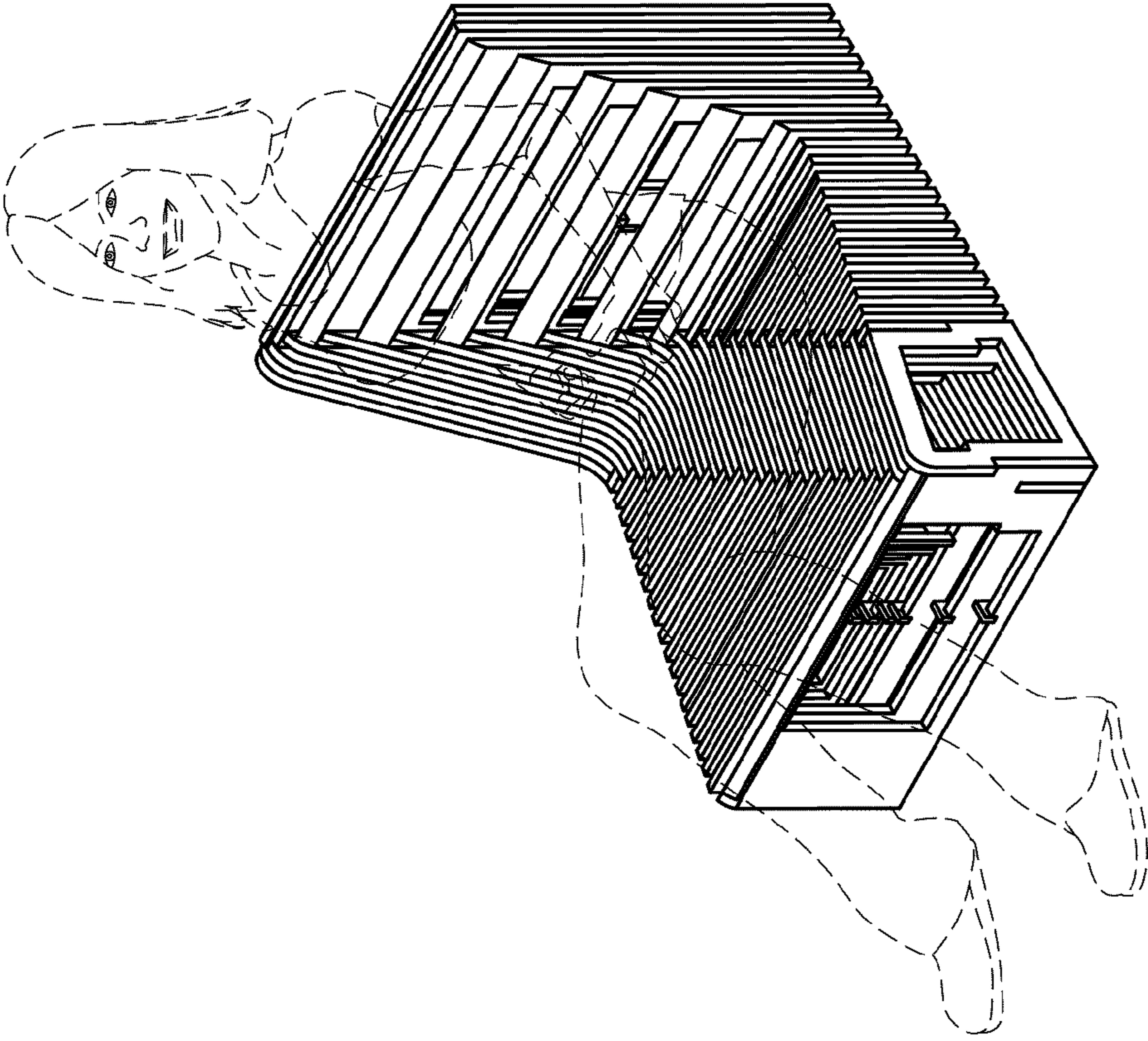

FIG. 9