

US00D651374S

(12) **United States Design Patent**
Rickards

(10) **Patent No.:** **US D651,374 S**
(45) **Date of Patent:** **** Dec. 27, 2011**

(54) **WALL VASE HOLDING BRACKET AND
ROSETTE COMBINATION**

(76) Inventor: **John W. Rickards**, San Diego, CA (US)

(**) Term: **14 Years**

(21) Appl. No.: **29/367,632**

(22) Filed: **Aug. 10, 2010**

Related U.S. Application Data

(60) Continuation-in-part of application No. 29/355,332, filed on Feb. 5, 2010, now Pat. No. Des. 621,574, which is a division of application No. 29/339,448, filed on Jun. 30, 2009, now Pat. No. Des. 610,774, which is a continuation-in-part of application No. 29/325,308, filed on Sep. 29, 2008, now Pat. No. Des. 595,475, which is a division of application No. 29/259,840, filed on May 15, 2006, now Pat. No. Des. 579,173.

(51) **LOC (9) Cl.** **25-03**

(52) **U.S. Cl.** **D99/19**

(58) **Field of Classification Search** D11/117,
D11/143, 144, 145, 146, 155; D99/17, 18,
D99/19, 20, 21, 22, 23, 25, 26, 27; D20/42,
D20/43; 47/39, 41.01, 41.11; 248/315; 206/45.25,
206/423, 769

See application file for complete search history.

(56) **References Cited**

U.S. PATENT DOCUMENTS

D74,944 S * 4/1928 Peirce, III et al. D6/556
D354,793 S * 1/1995 Fletcher D23/201
D398,801 S * 9/1998 Shaw D6/556
D604,081 S * 11/2009 Nunes D6/556

* cited by examiner

Primary Examiner — T. Chase Nelson

Assistant Examiner — Michael Pratt

(74) *Attorney, Agent, or Firm* — Charmasson, Buchaca & Leach, LLP

(57) **CLAIM**

The ornamental design for a wall vase holding bracket and rosette combination, as shown and described.

DESCRIPTION

FIG. 1 is a top, front, left side perspective view of a wall vase holding bracket and rosette combination showing my new design;

FIG. 2 is a front view thereof;

FIG. 3 is a back view thereof;

FIG. 4 is a right side view thereof, the left side being a mirror image thereof;

FIG. 5 is a top view thereof; and,

FIG. 6 is a bottom view thereof.

The broken line showing on the front face of the wall vase holding bracket and rosette combination does not form a part of the claimed design.

1 Claim, 1 Drawing Sheet

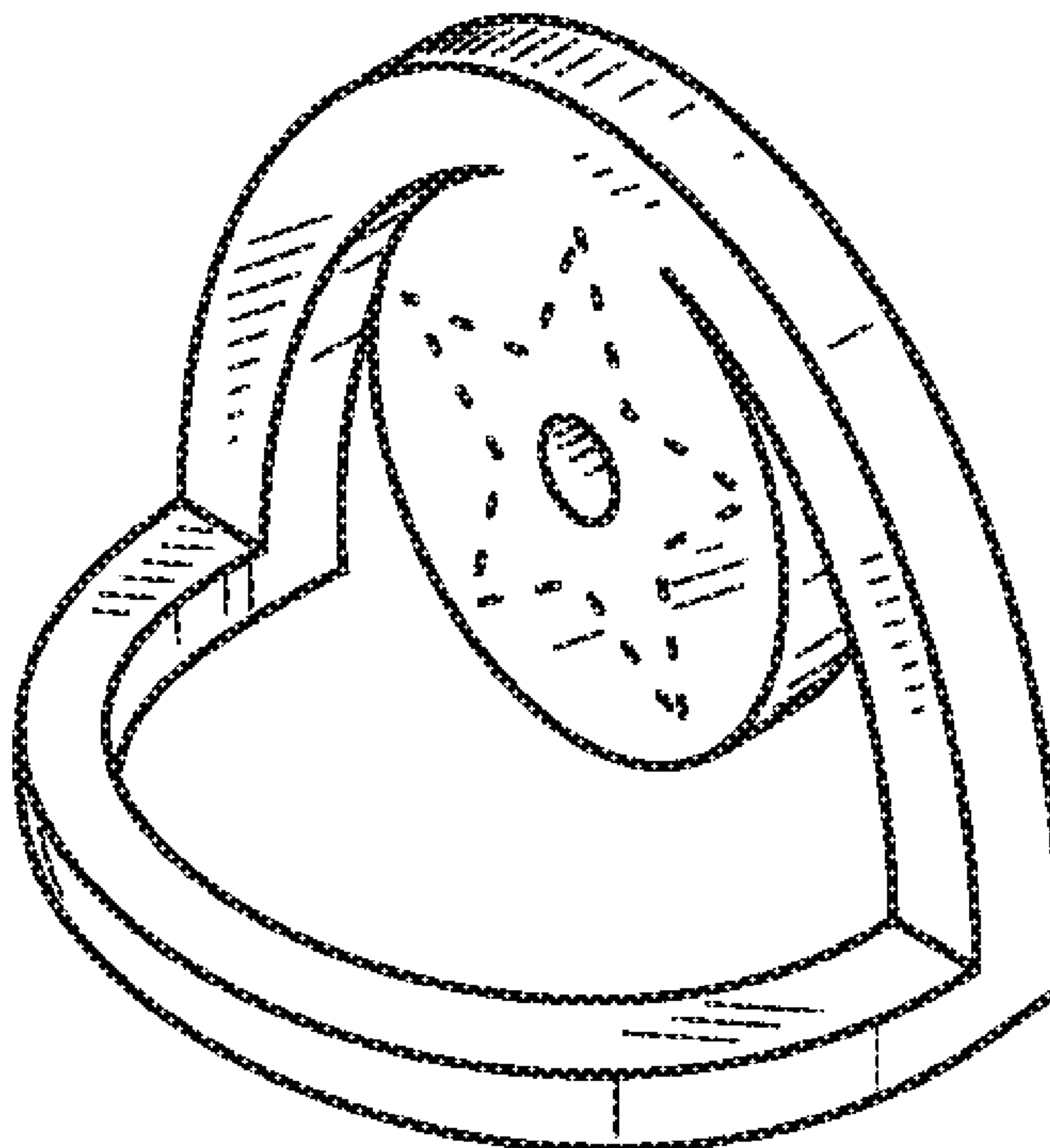

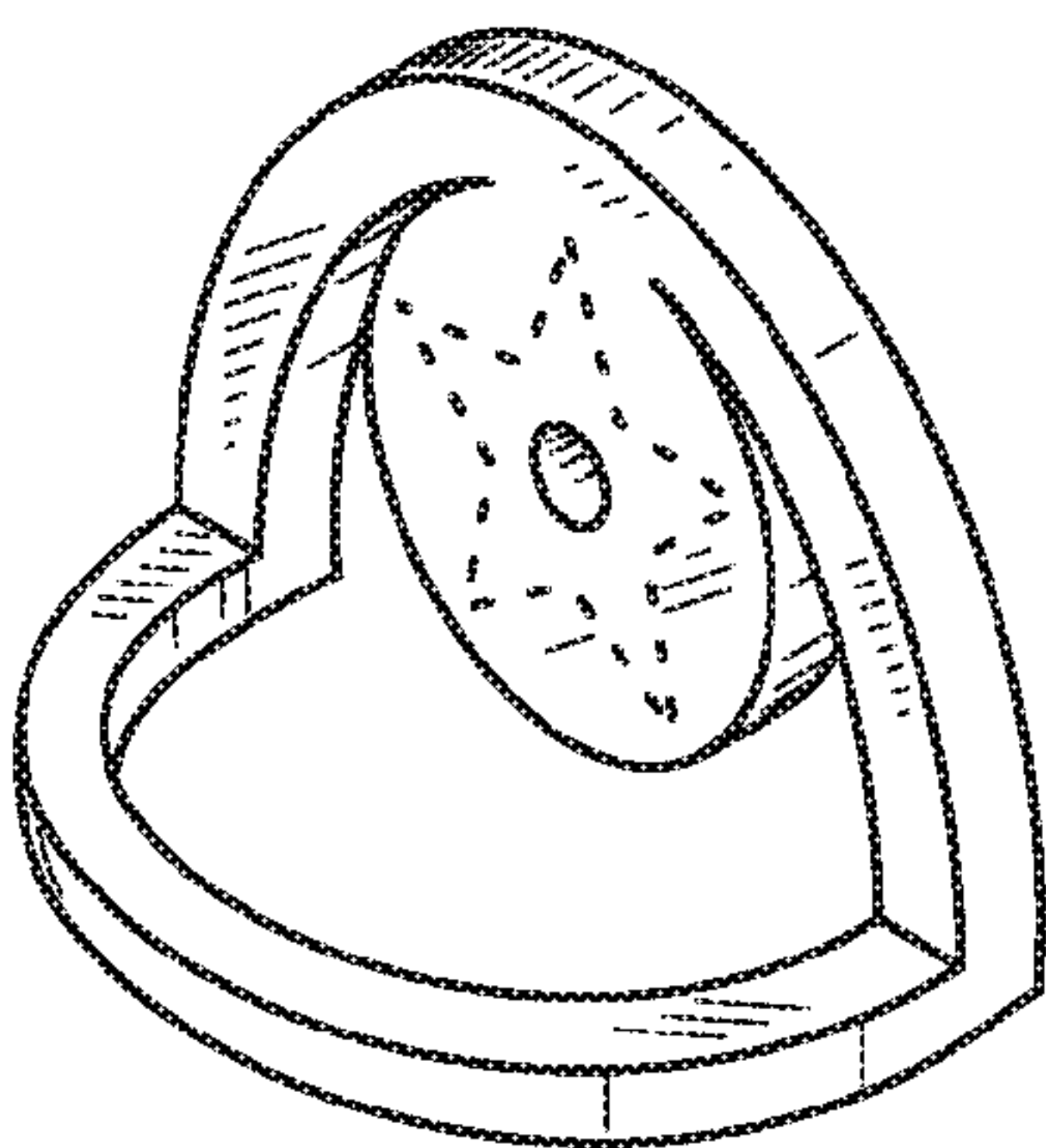

FIG. 1

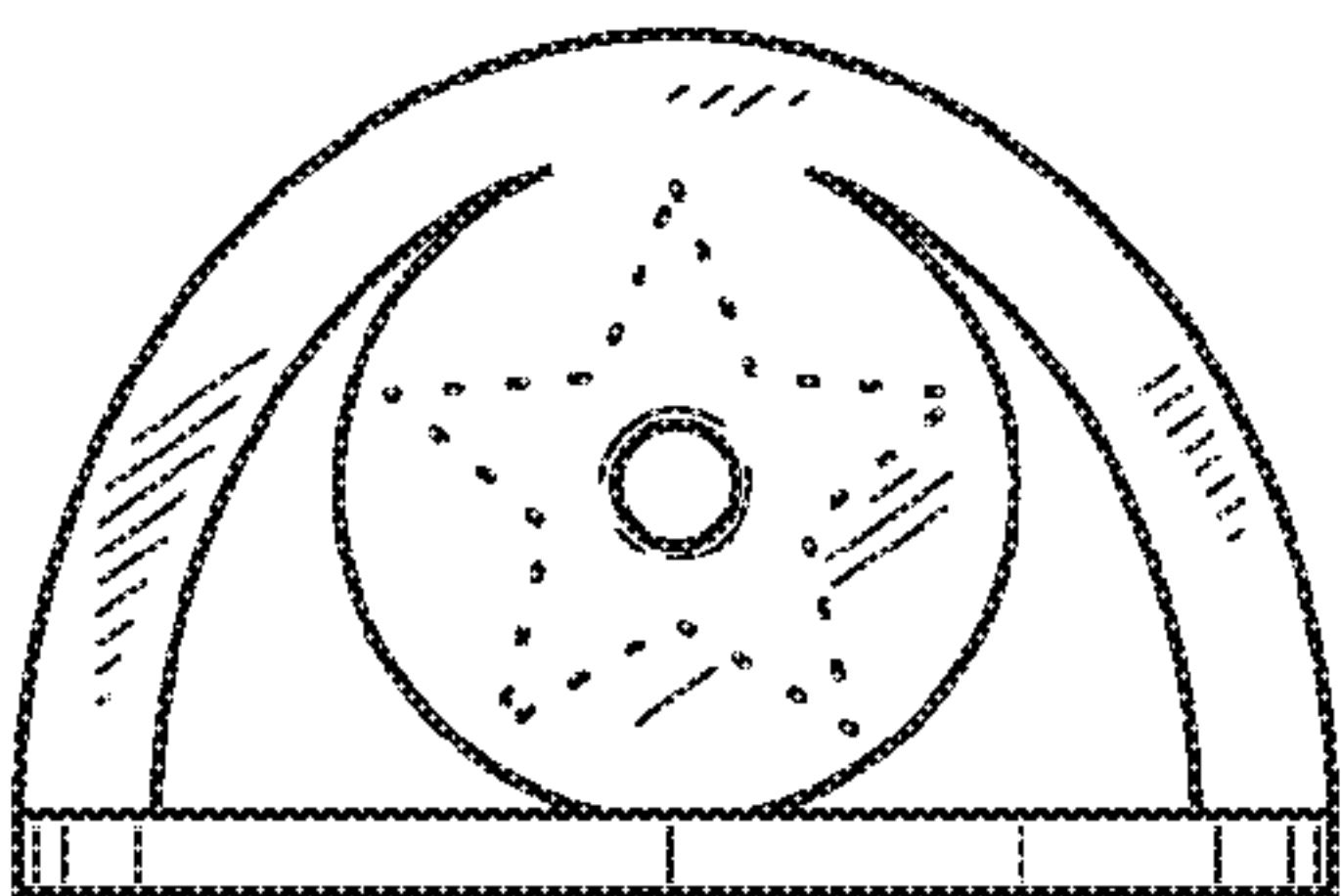

FIG. 2

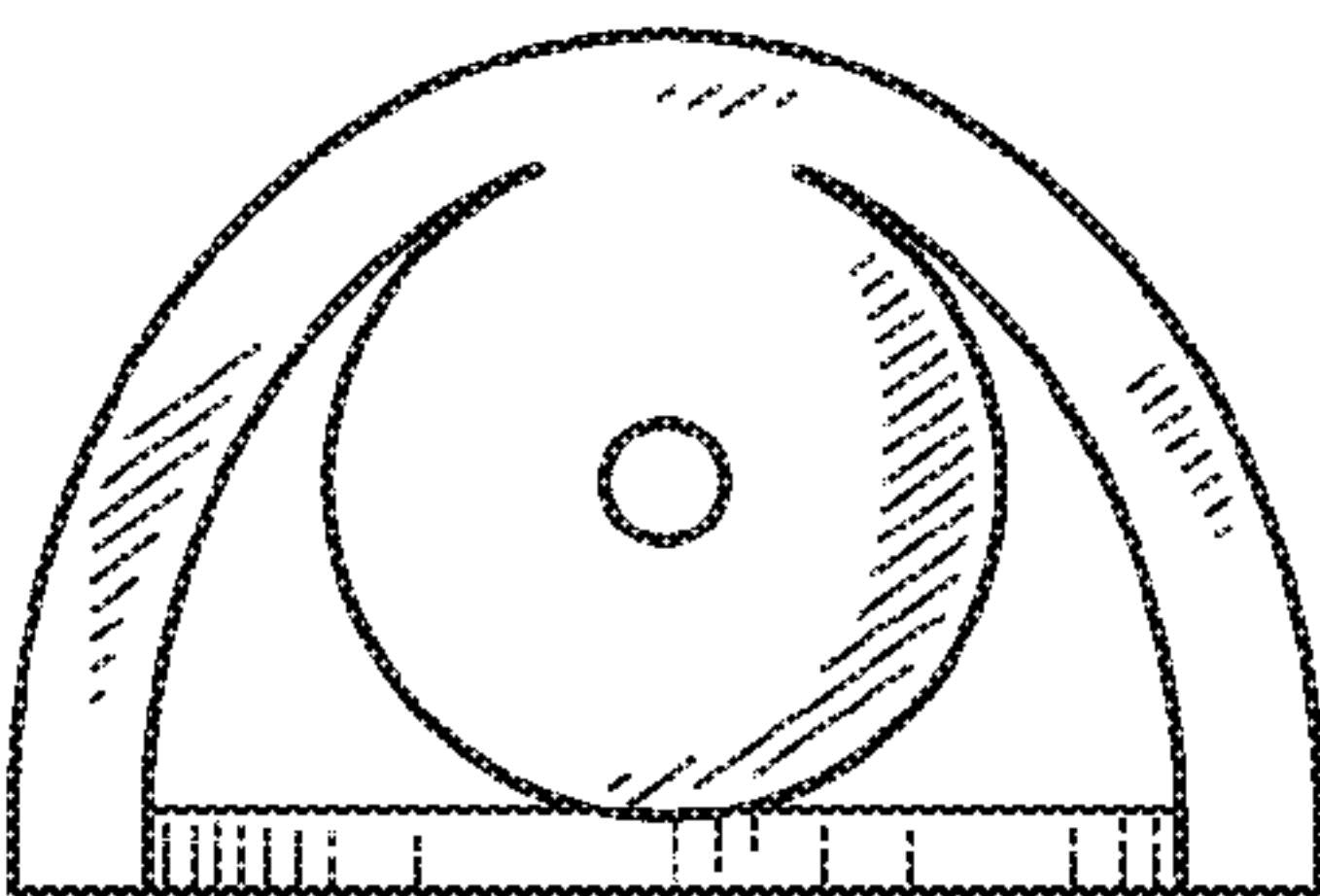

FIG. 3

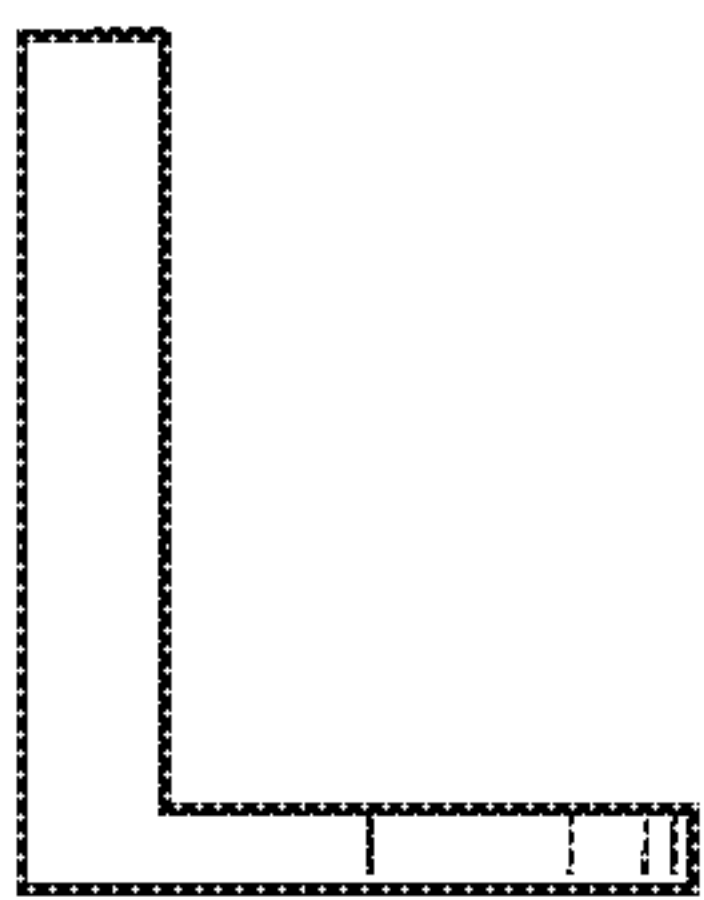

FIG. 4

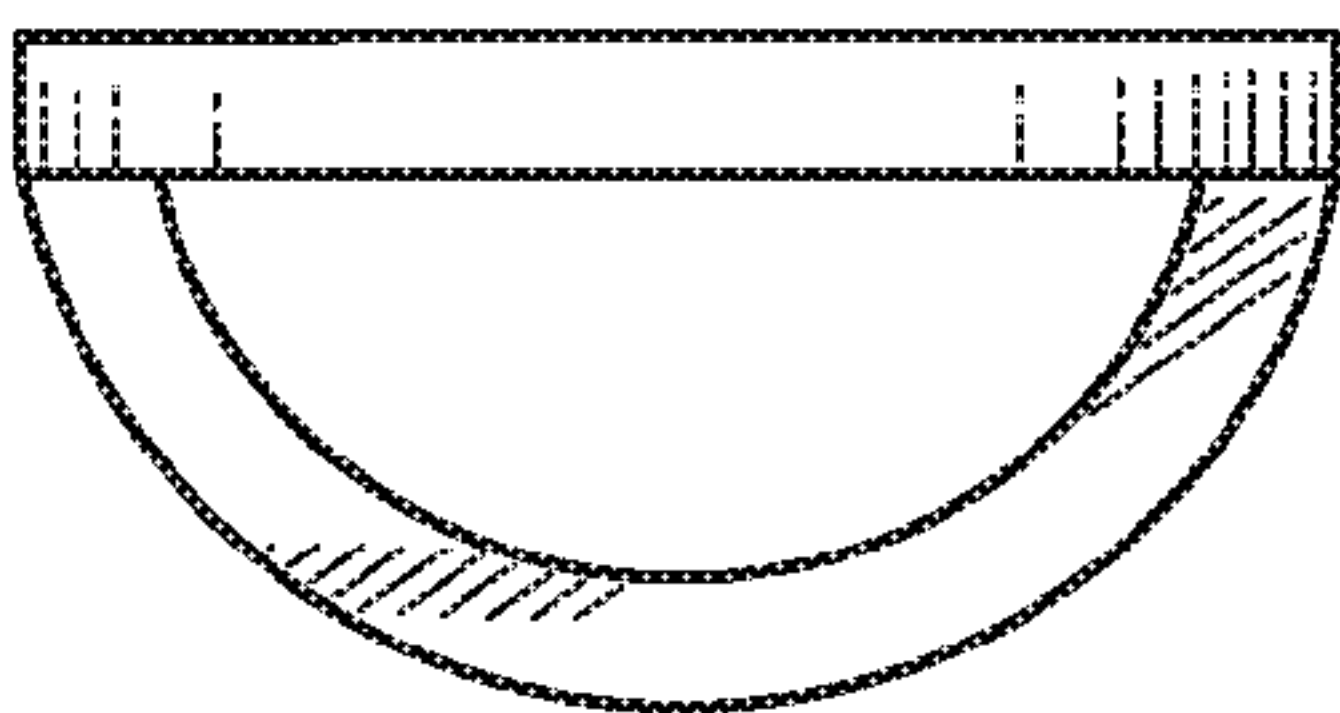

FIG. 5

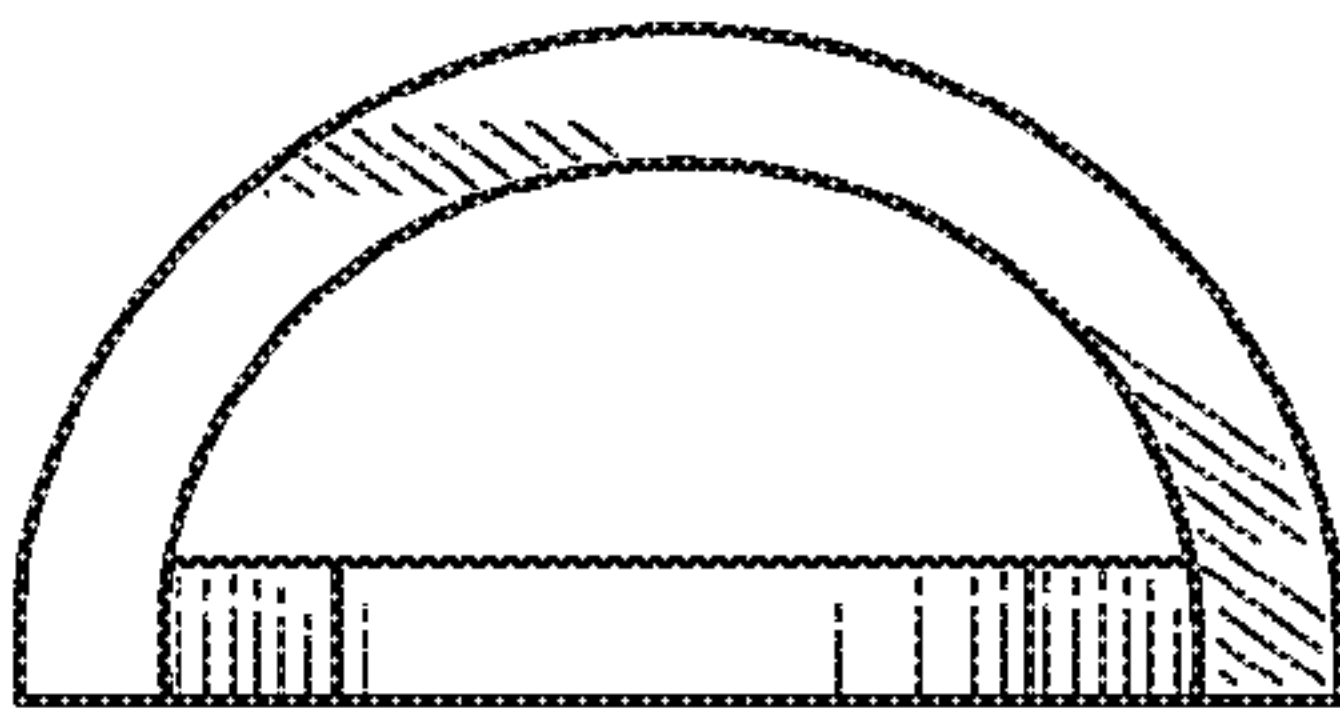

FIG. 6