

US00D650881S

(12) **United States Design Patent**  
**Abbott et al.**

(10) **Patent No.:** **US D650,881 S**  
(45) **Date of Patent:** **\*\* Dec. 20, 2011**

(54) **QUAD RAIL BIPOD**

(76) Inventors: **Craig Abbott**, Vista, CA (US); **Darin Prince**, Bonsall, CA (US)

(\*\*) Term: **14 Years**

(21) Appl. No.: **29/361,977**

(22) Filed: **May 18, 2010**

(51) **LOC (9) Cl.** ..... **22-01**

(52) **U.S. Cl.** ..... **D22/108**

(58) **Field of Classification Search** ..... D22/100,  
D22/108, 199; D8/1, 380, 381; 42/94; 89/37.04;  
211/64, 13.1, 49.1, 60.1, 70.5, 86.01, 87.01,  
211/88.01, 89.01, 181.1, 560; 248/156, 530,  
248/121, 175, 200, 302, 304, 309.1, 310,  
248/312; D6/329, 396, 417, 552, 553, 567;  
D21/385, 662, 698

See application file for complete search history.

(56) **References Cited**

**U.S. PATENT DOCUMENTS**

3,710,675	A *	1/1973	Asikainen	89/41.17
4,223,590	A *	9/1980	Donovan	89/35.01
D304,062	S *	10/1989	Barrett	D22/103
6,785,997	B2 *	9/2004	Oz	42/94
7,676,977	B1 *	3/2010	Cahill et al.	42/94
2009/0000175	A1 *	1/2009	Potterfield et al.	42/94

\* cited by examiner

*Primary Examiner* — T. Chase Nelson

*Assistant Examiner* — Michael Pratt

(74) *Attorney, Agent, or Firm* — QuickPatents, Inc.; Kevin Prince

(57) **CLAIM**

We claim the ornamental design for a quad rail bipod, as shown and described.

**DESCRIPTION**

FIG. 1 is a perspective exploded view of a quad rail bipod, showing our new design;

FIG. 2 is a perspective view thereof, illustrated with legs thereof in an extended configuration;

FIG. 3 is an alternate perspective view thereof, illustrated with the legs in a collapsed configuration;

FIG. 4 is a front elevational view thereof, illustrated with the legs in the extended configuration, the rear elevational view being a mirror image thereof;

FIG. 5 is a left-side elevational view thereof, illustrated with the legs in the collapsed configuration, the right-side elevational view being a mirror image thereof;

FIG. 6 is a front elevational view thereof, illustrated with the legs in the collapsed configuration;

FIG. 7 is a rear elevational view thereof, illustrated with the legs in the collapsed configuration;

FIG. 8 is a bottom plan view thereof, illustrated with the legs in the extended configuration;

FIG. 9 is a left-side elevational view thereof, illustrated with the legs in the extended configuration, the right-side elevational view being a mirror image thereof; and,

FIG. 10 is a top plan view thereof, illustrated with the legs in a extended configuration.

The broken lines in FIGS. 4, 6 and 7 depict environmental matter and form no part of the claimed design.

**1 Claim, 5 Drawing Sheets**

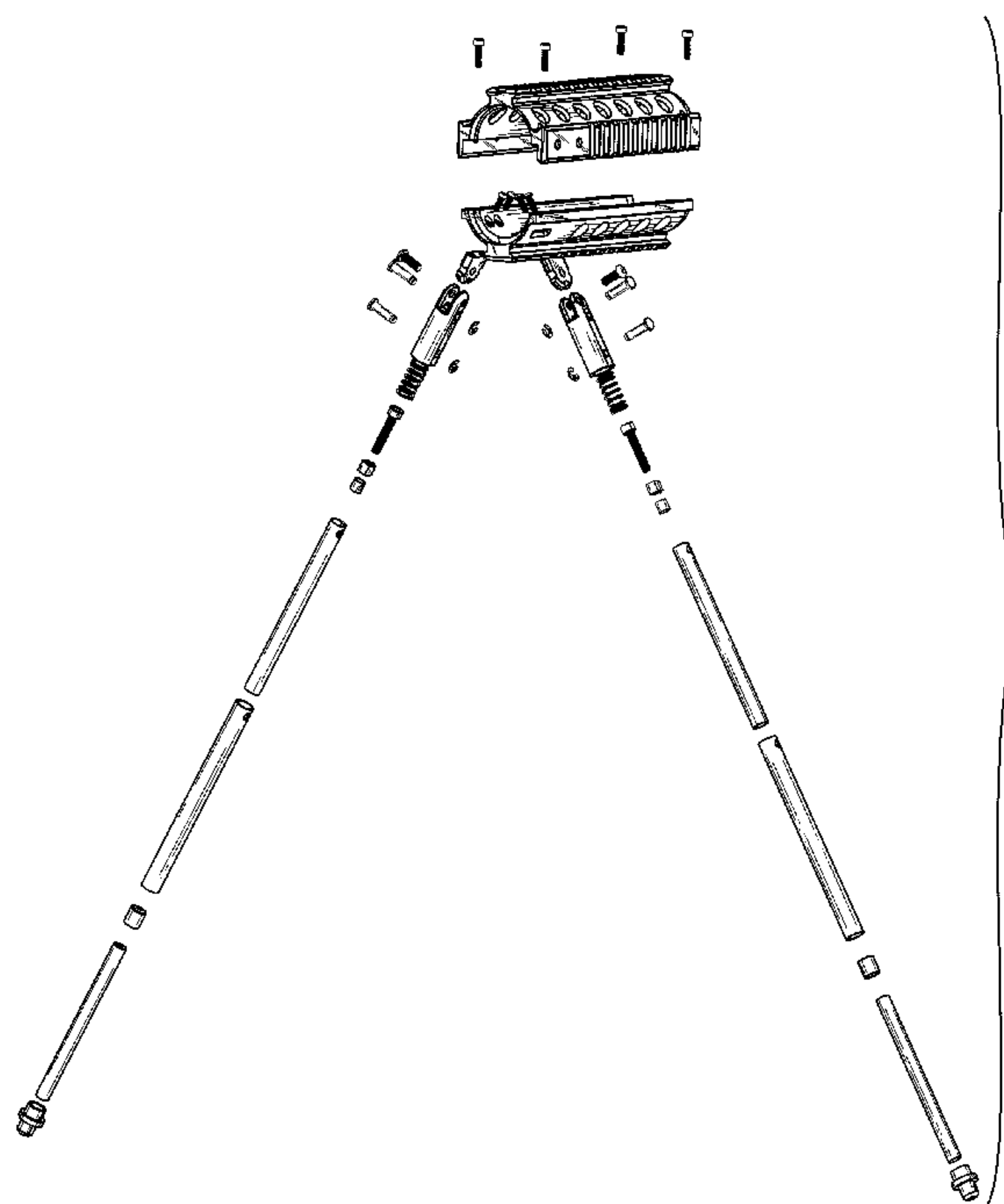

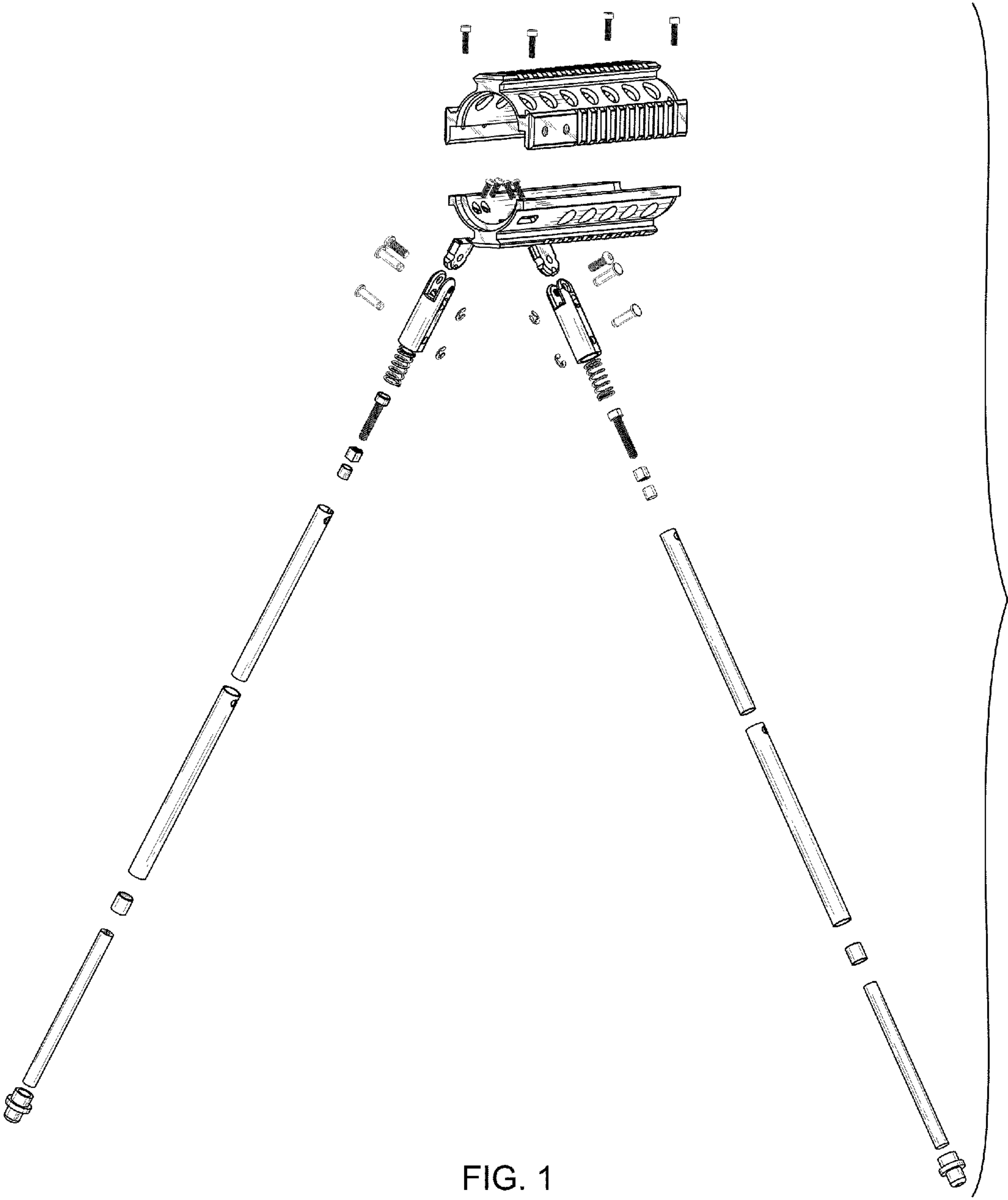

FIG. 1

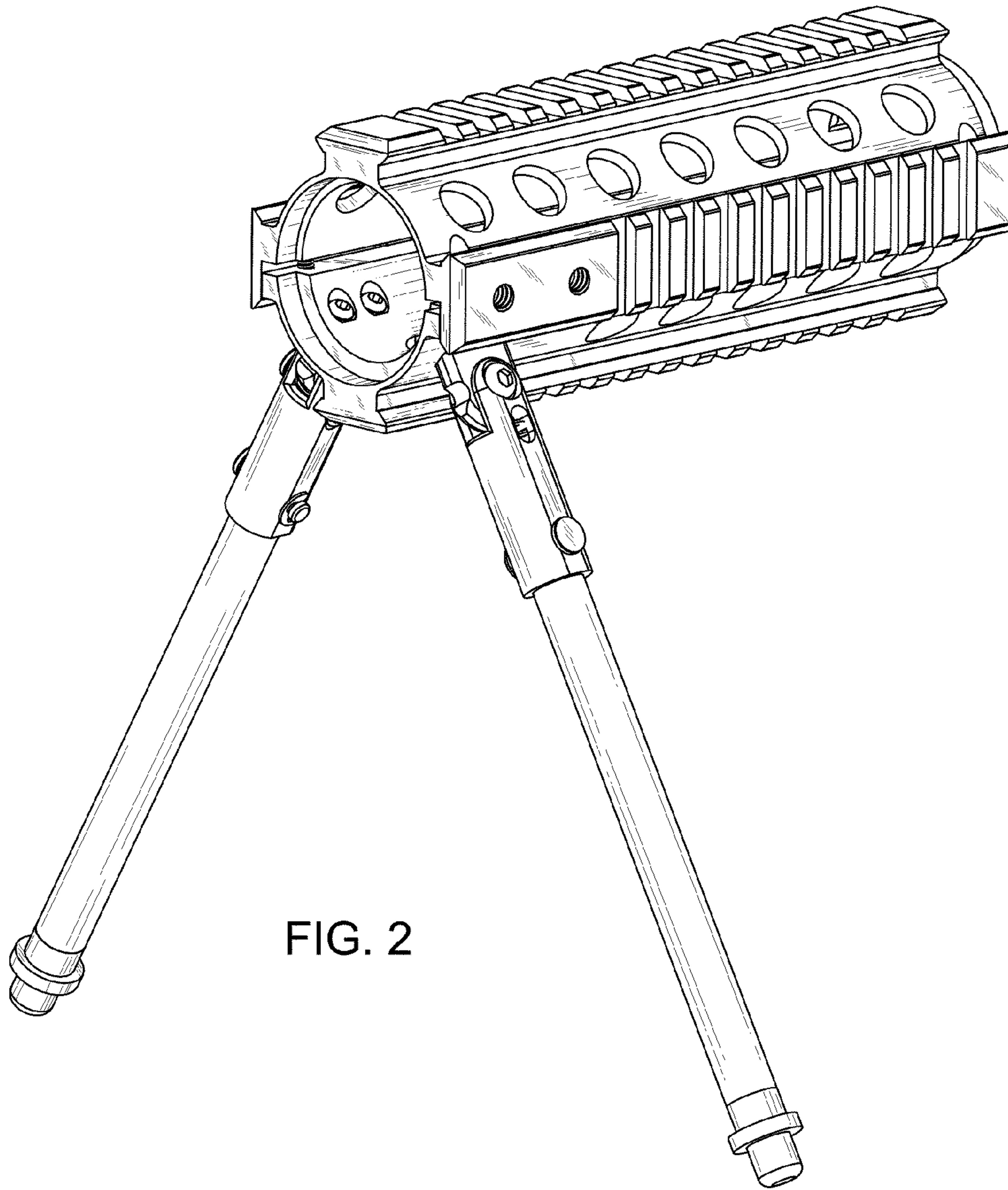

FIG. 2

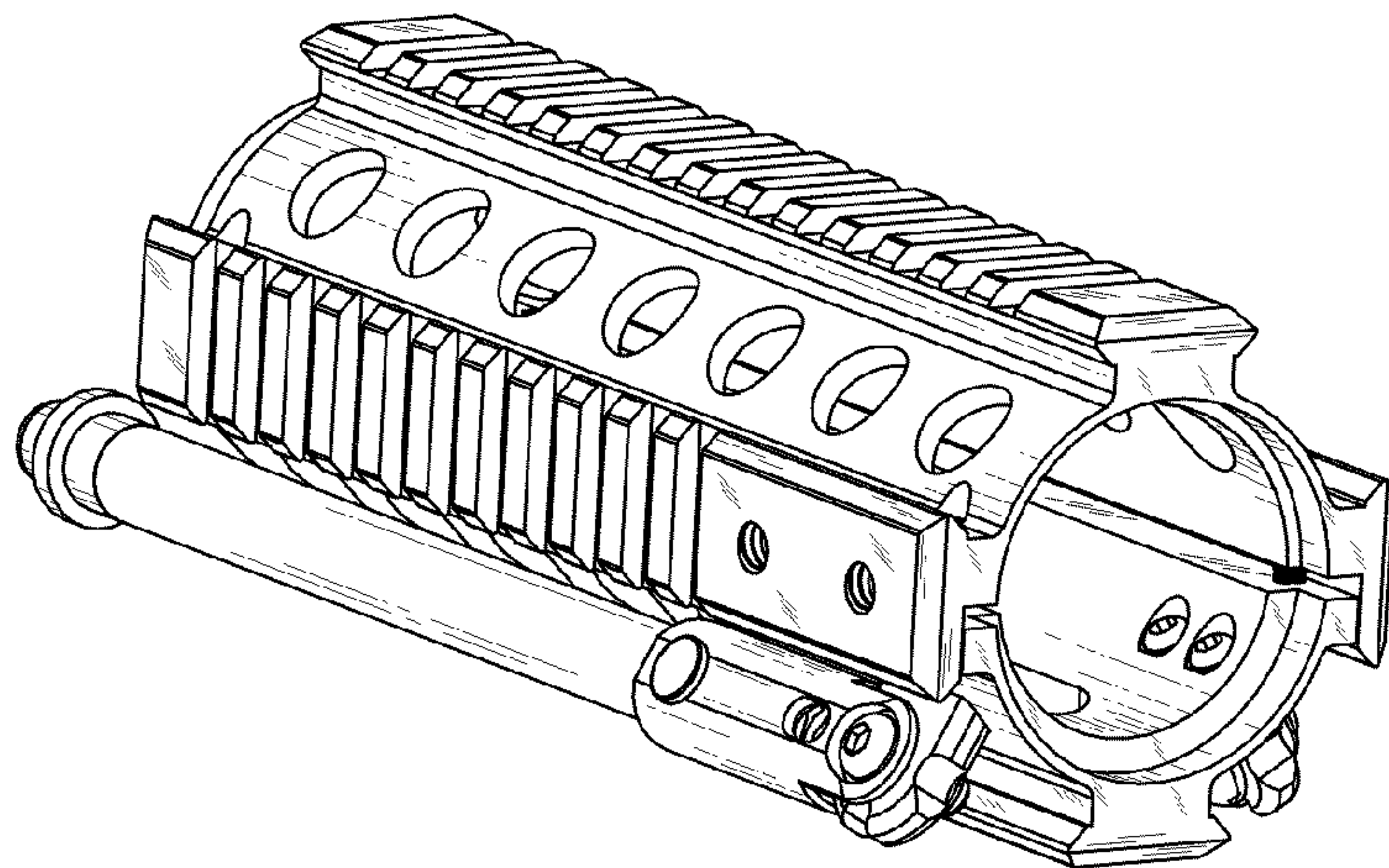

FIG. 3



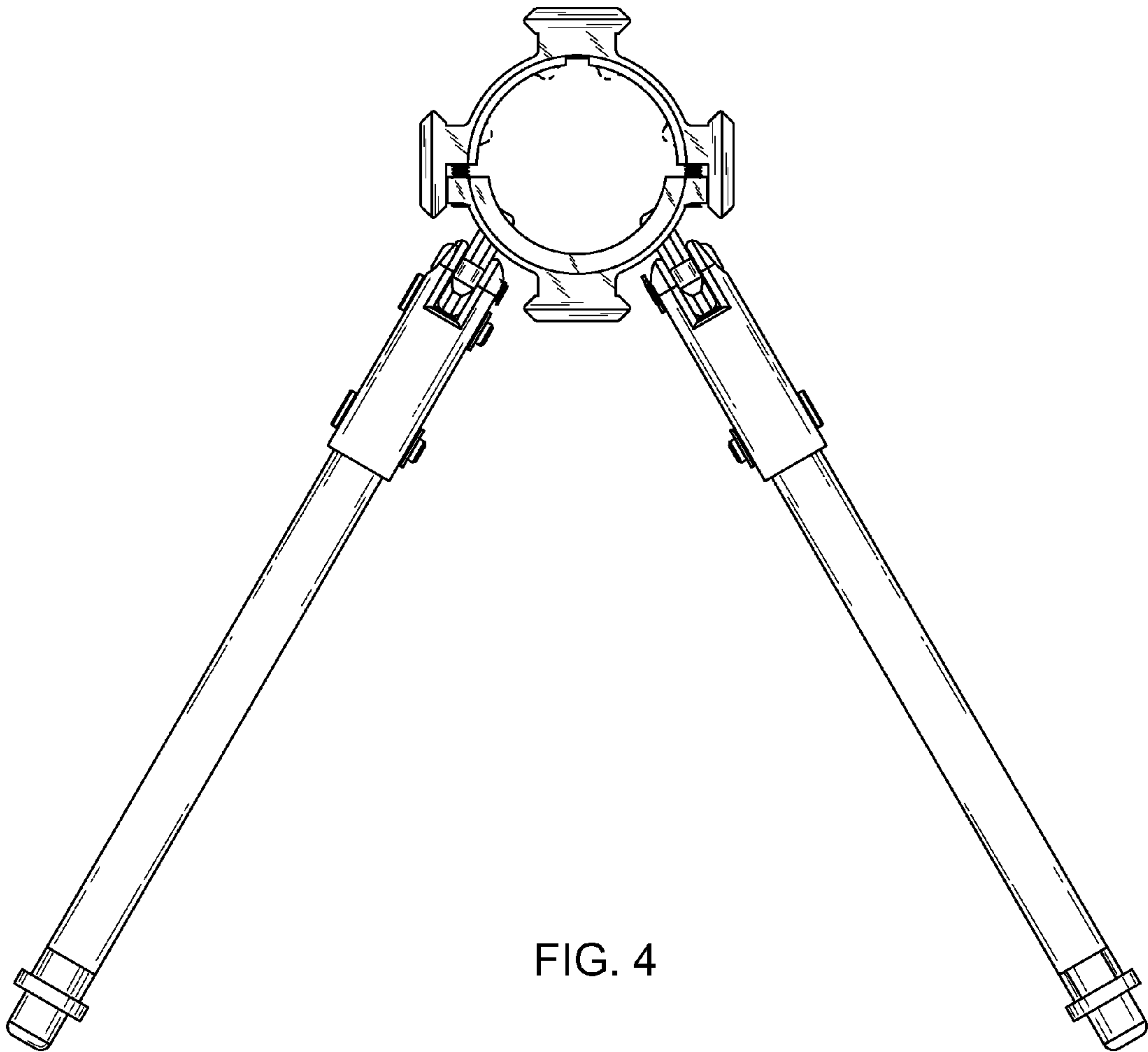

FIG. 4

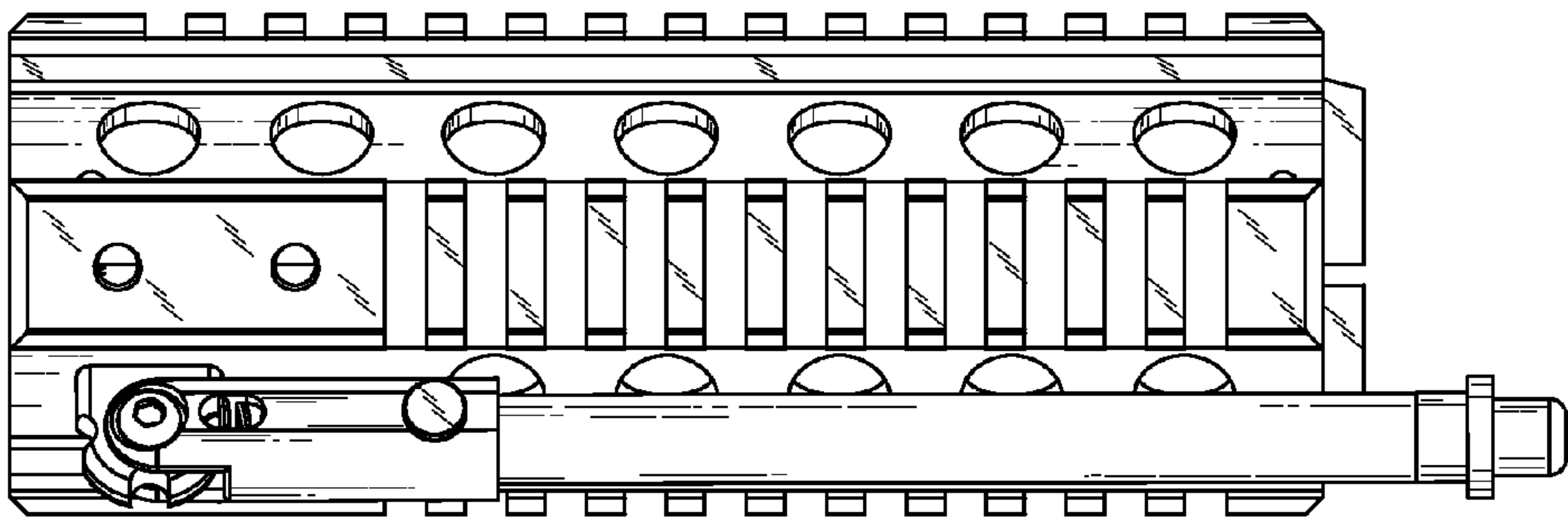

FIG. 5

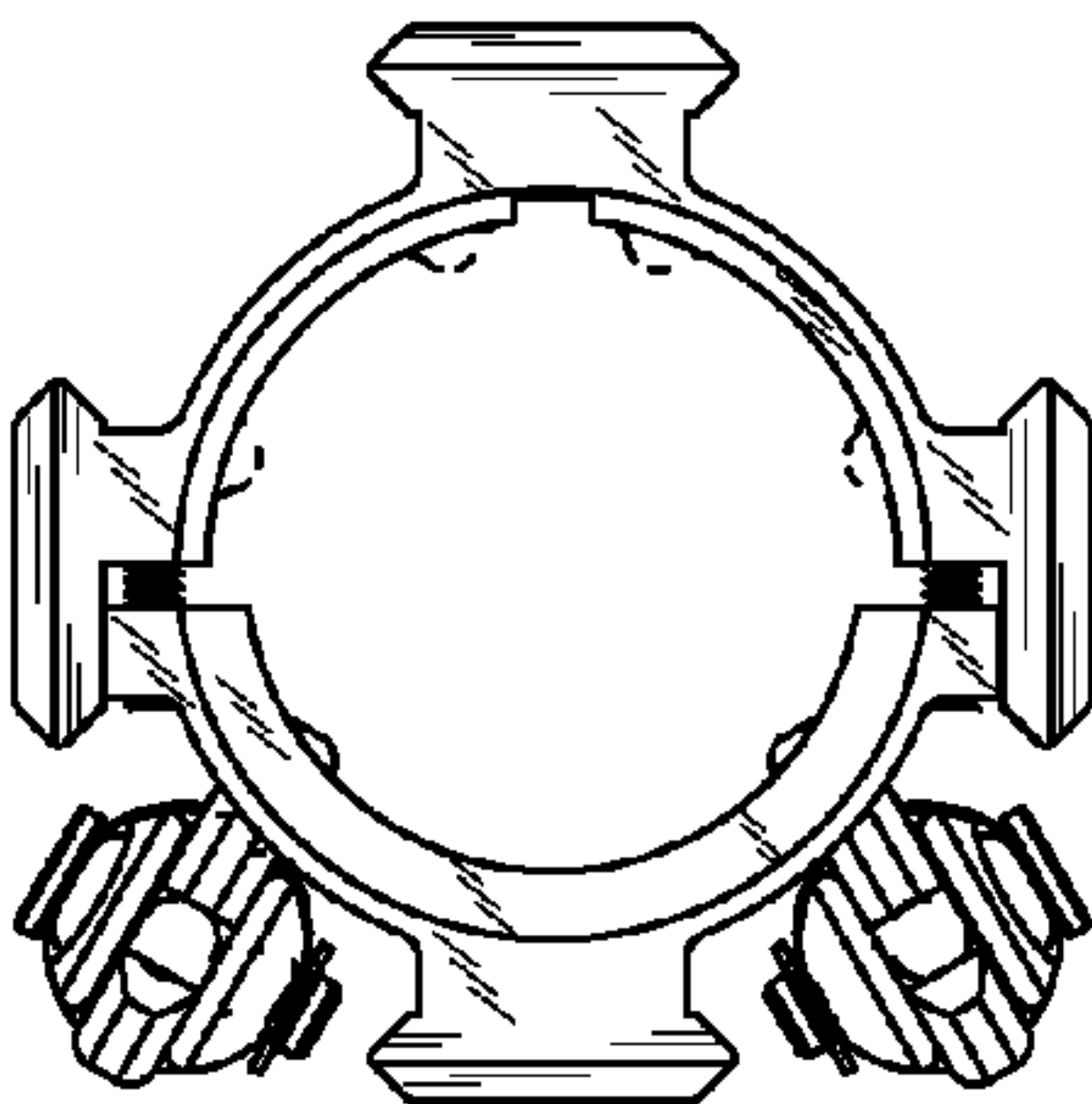

FIG. 6

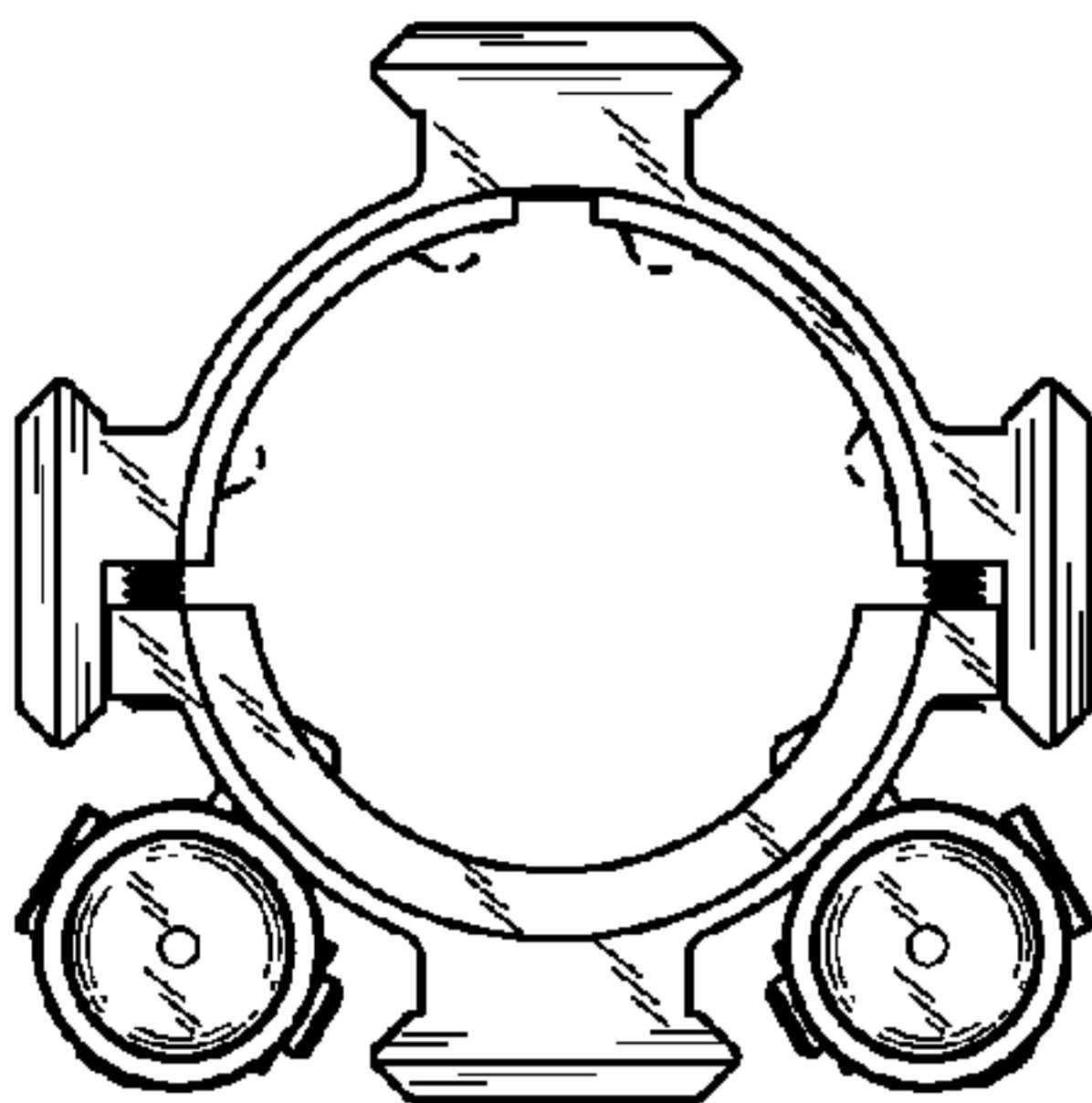

FIG. 7

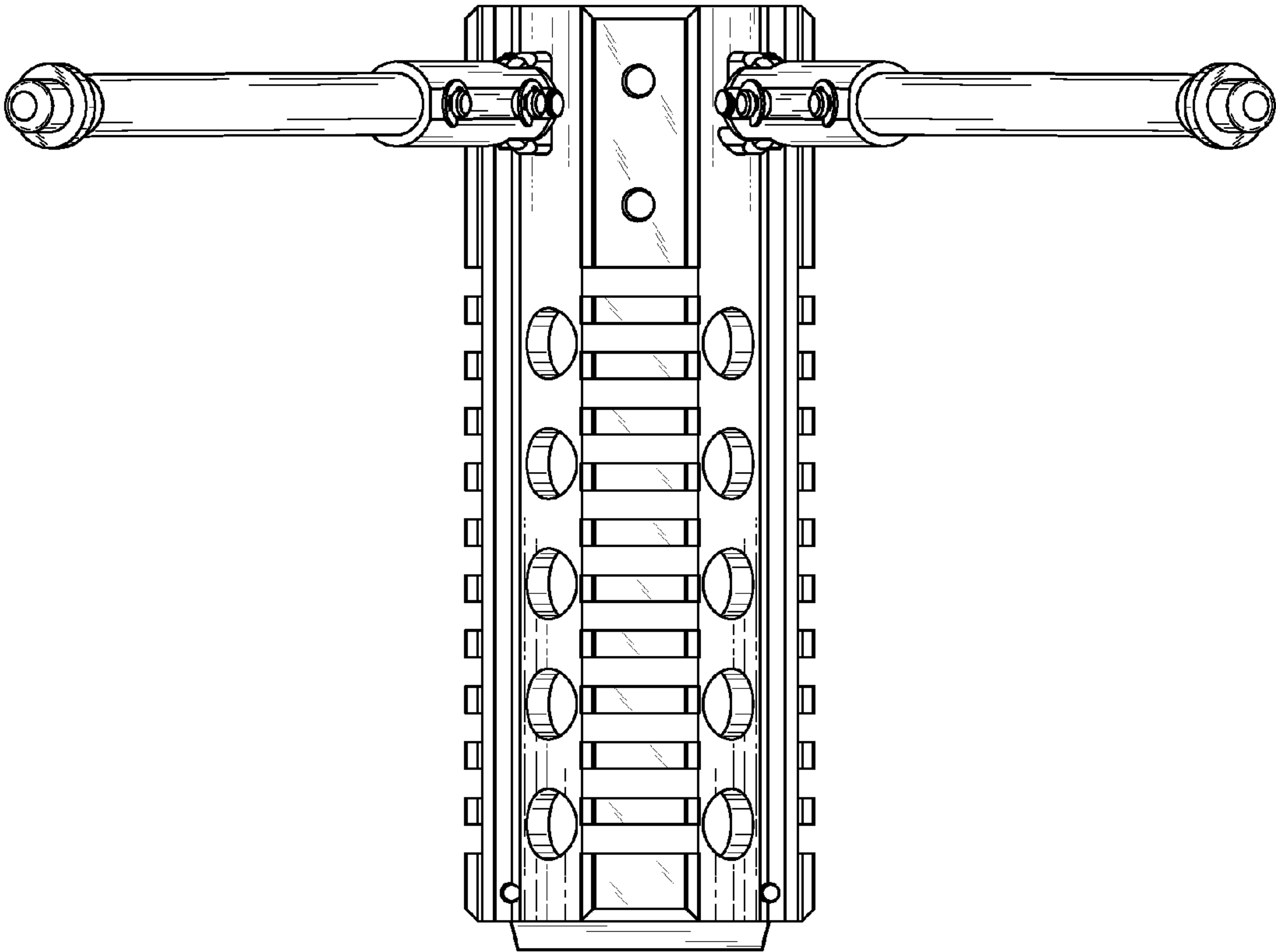

FIG. 8

