



US00D650311S

(12) **United States Design Patent**  
**Bracy**

(10) **Patent No.:** **US D650,311 S**

(45) **Date of Patent:** **\*\* \*Dec. 13, 2011**

(54) **ALL TERRAIN VEHICLE**

(75) **Inventor:** **Garth H Bracy**, Long Lake, MN (US)

(73) **Assignee:** **Polaris Industries Inc.**, Medina, MN (US)

(\*\*) **Term:** **14 Years**

(21) **Appl. No.:** **29/380,905**

(22) **Filed:** **Dec. 13, 2010**

(51) **LOC (9) Cl.** ..... **12-08**

(52) **U.S. Cl.** ..... **D12/87**

(58) **Field of Classification Search** ..... D12/86,  
D12/87, 1; D21/424, 433; 296/181.1, 181.5  
See application file for complete search history.

(56) **References Cited**

**U.S. PATENT DOCUMENTS**

D497,324 S *	10/2004	Chestnut et al.	.....	D12/87
D503,658 S *	4/2005	Lu	.....	D12/87
D535,215 S *	1/2007	Turner et al.	.....	D12/87
D549,133 S *	8/2007	LePage	.....	D12/87
D555,036 S *	11/2007	Eck	.....	D12/87
D563,274 S *	3/2008	Ramos	.....	D12/87
D606,900 S *	12/2009	Flores	.....	D12/87
D622,631 S *	8/2010	Lai et al.	.....	D12/87
D625,662 S *	10/2010	Li	.....	D12/87
D641,288 S	7/2011	Sun		

**OTHER PUBLICATIONS**

Polaris Ranger 2009 Product Catalog; © 2008 Polaris Industries Inc., Medina, Minnesota; 32 pages.

Polaris 2008 Work/Play Only Ranger Product Catalog; © 2007 Polaris Industries Inc., Medina, Minnesota; 28 pages.

Polaris Ranger RZR Sharp Side x Side Performance 2008 Product Catalog; © 2007 Polaris Industries Inc., Medina, Minnesota; 12 pages.

Polaris 2010, ATVs and Side x Sides Product Catalog, © 2009 Polaris Industries Inc., Medina, Minnesota; 52 pages.

\* cited by examiner

*Primary Examiner* — Melody N Brown

(74) *Attorney, Agent, or Firm* — Baker & Daniels LLP

(57) **CLAIM**

The ornamental design for an all terrain vehicle, as shown and described.

**DESCRIPTION**

FIG. 1 is a front perspective view of the all terrain vehicle; FIG. 2 is a right rear perspective view of the all terrain vehicle; FIG. 3 is a left side view of the all terrain vehicle; FIG. 4 is a right side view of the all terrain vehicle; FIG. 5 is a top view of the all terrain vehicle; FIG. 6 is a front view of the all terrain vehicle; and, FIG. 7 is a rear view of the all terrain vehicle.

The addendum contains a grayscale photograph of the front of the vehicle, similar to FIG. 5.

**1 Claim, 7 Drawing Sheets**

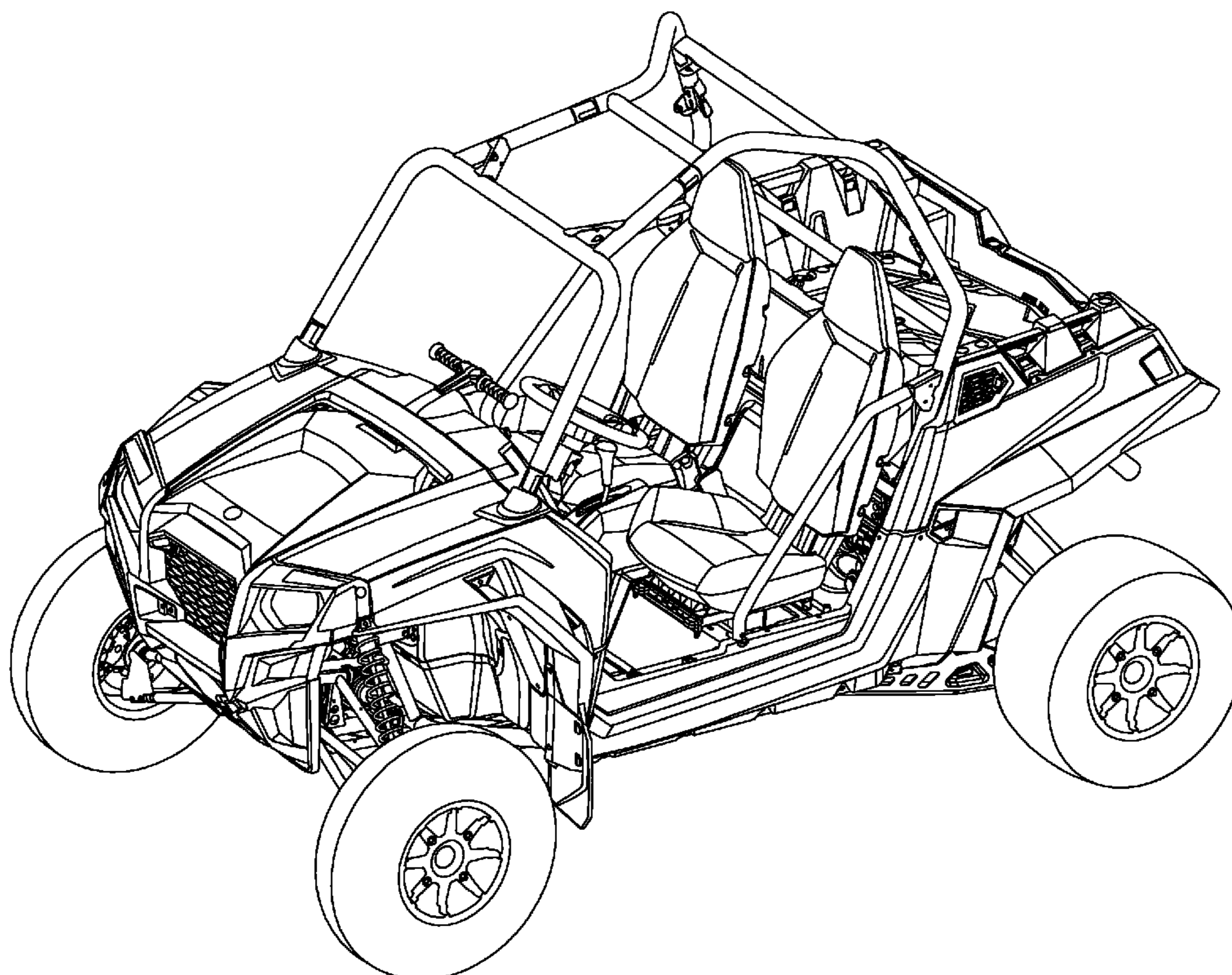

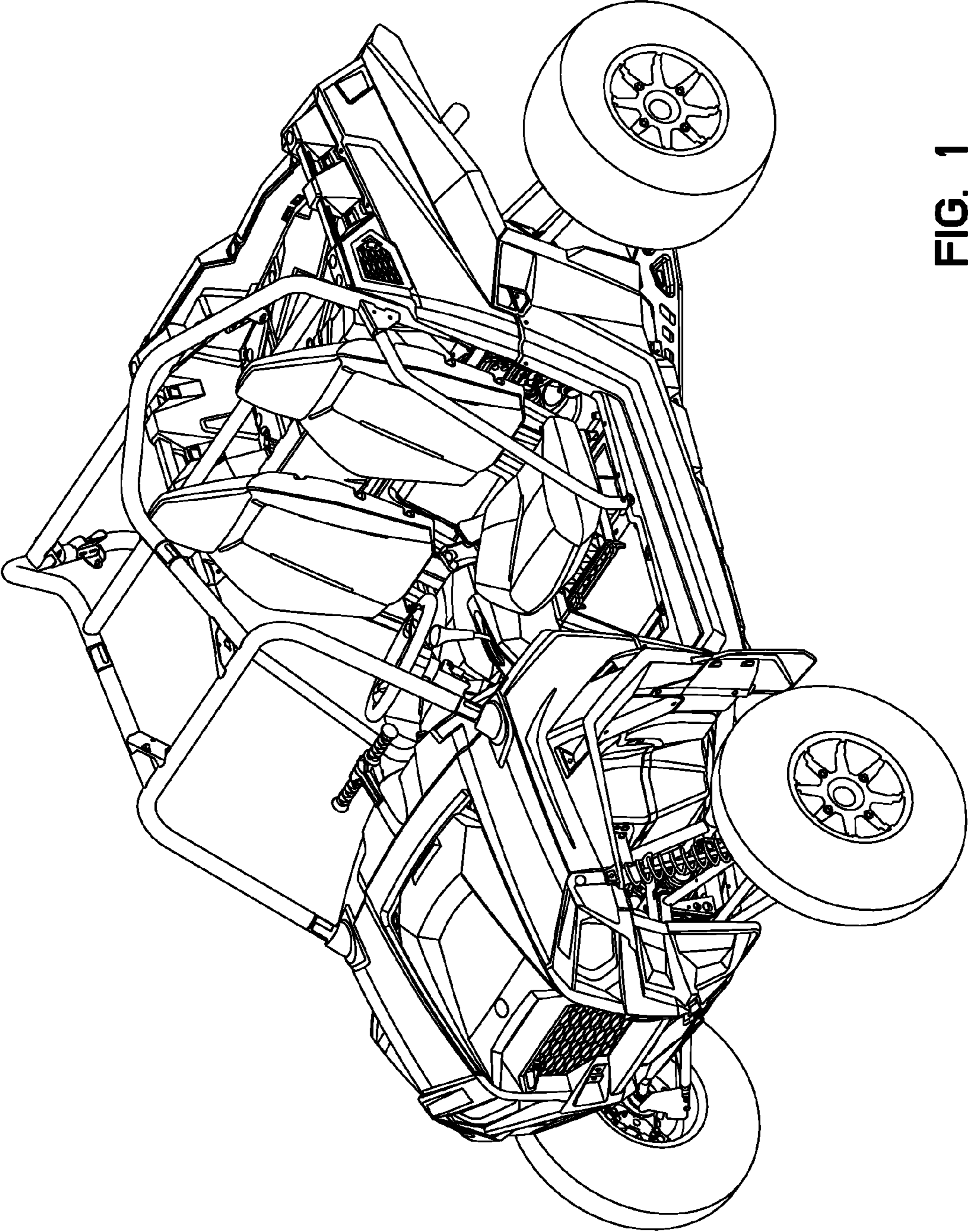

FIG. 1

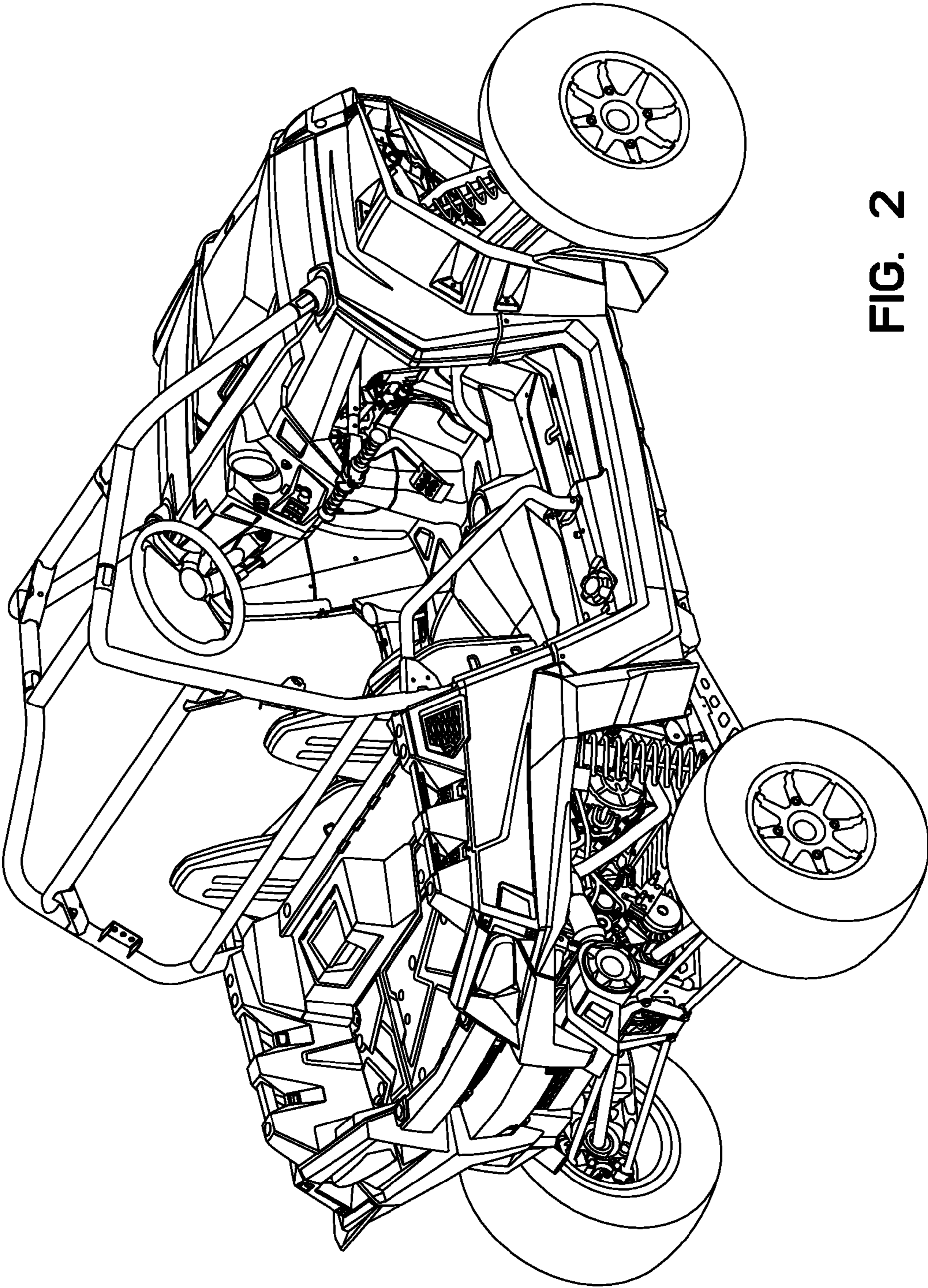

FIG. 2

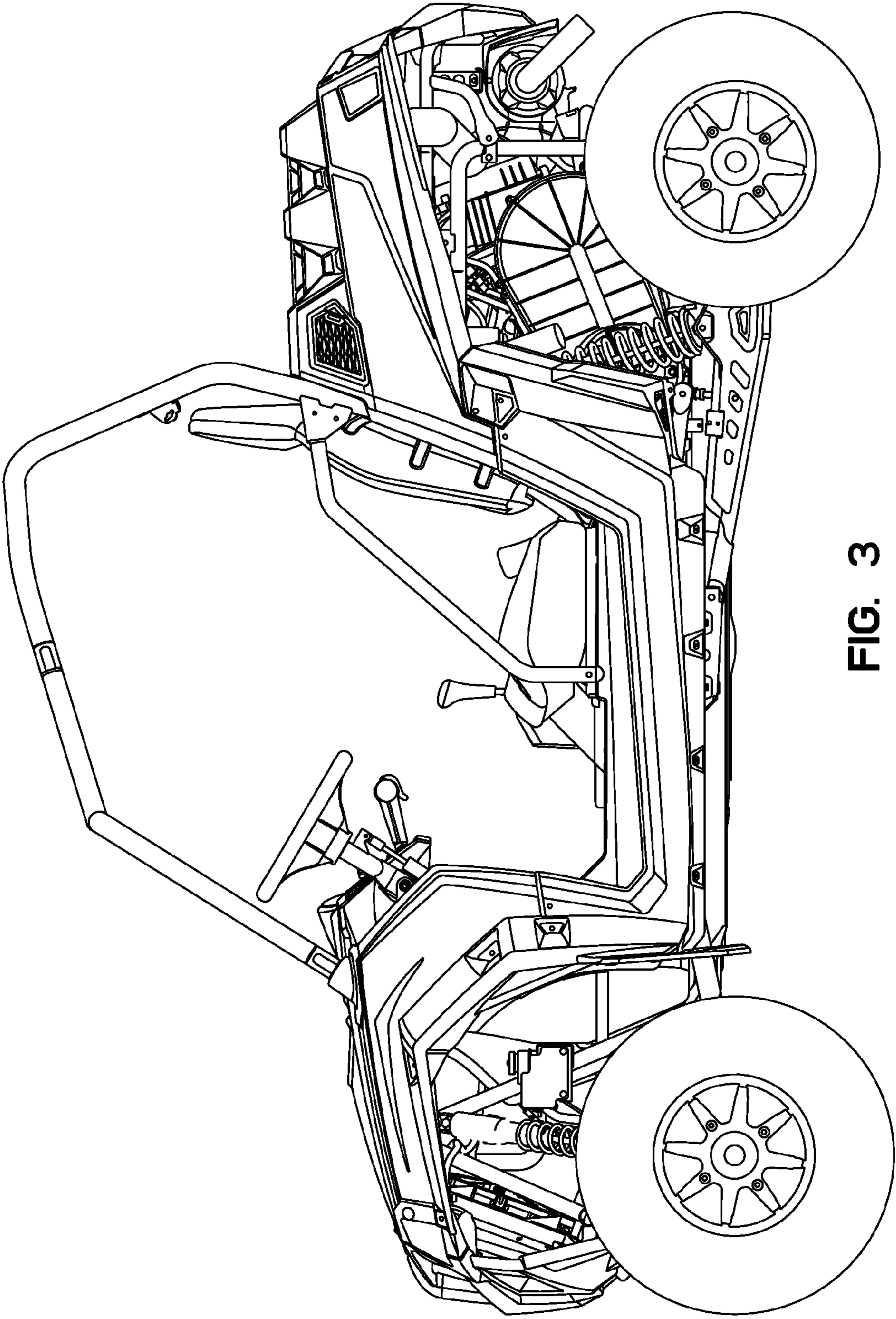

FIG. 3

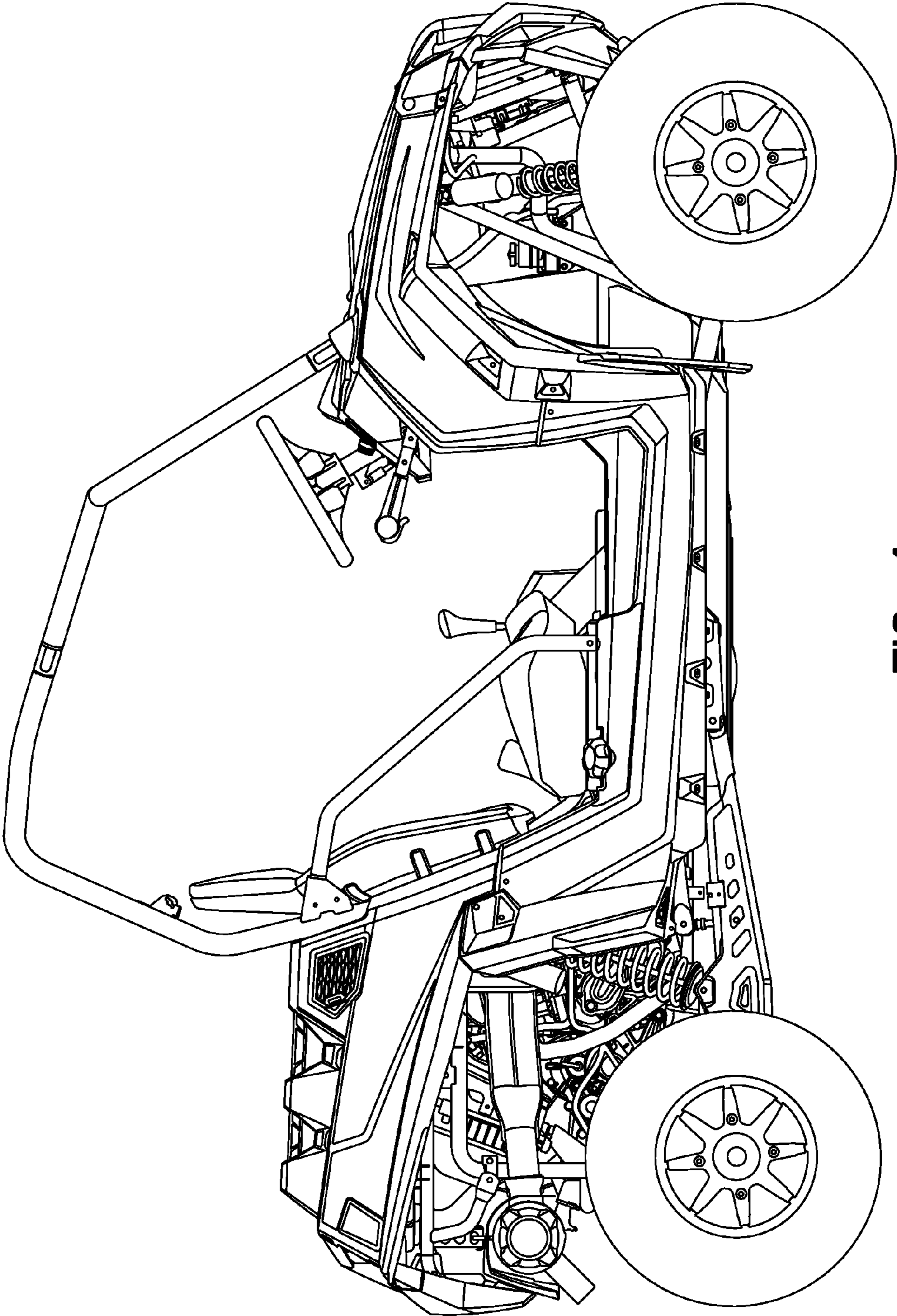

FIG. 4

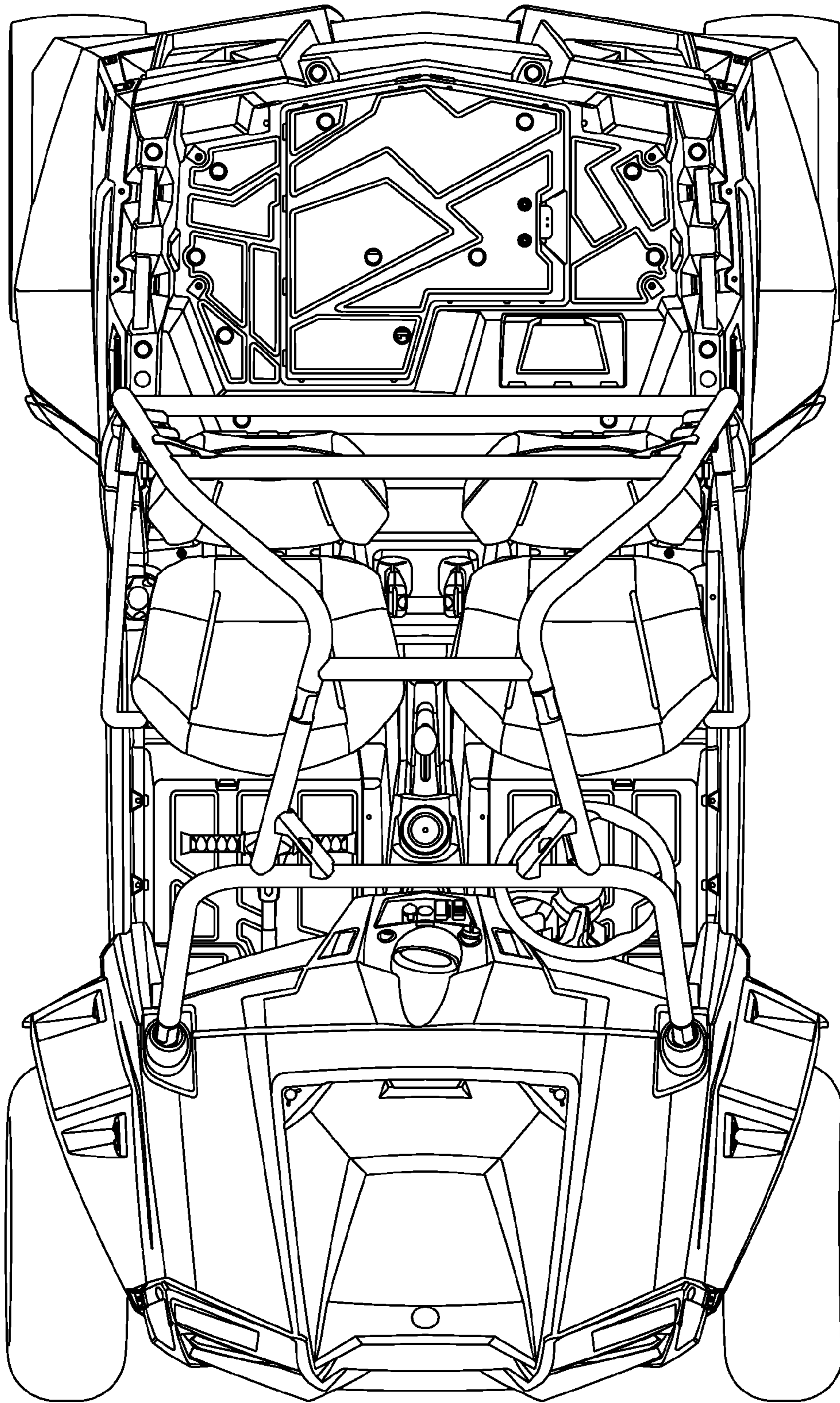

FIG. 5

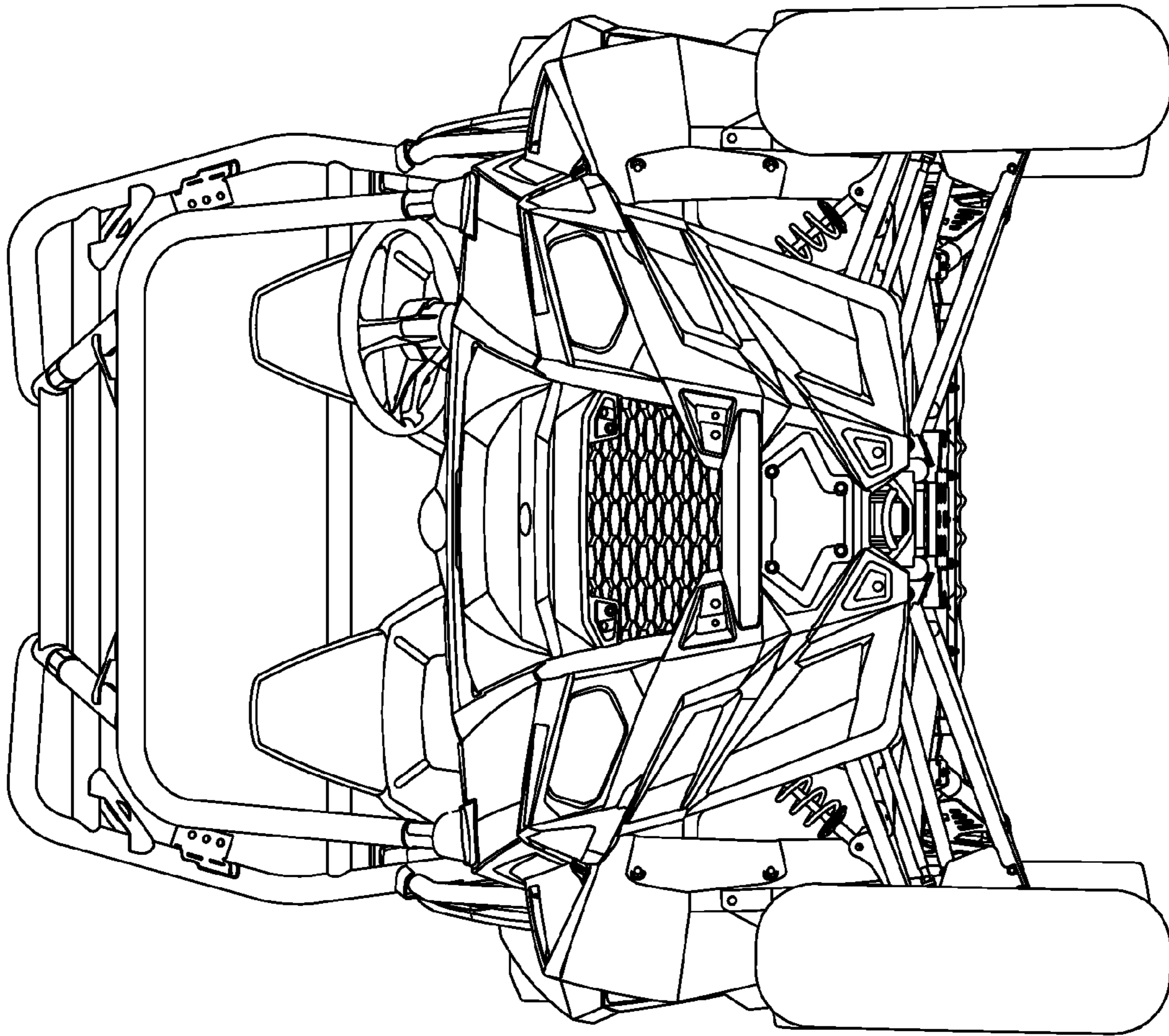

FIG. 6

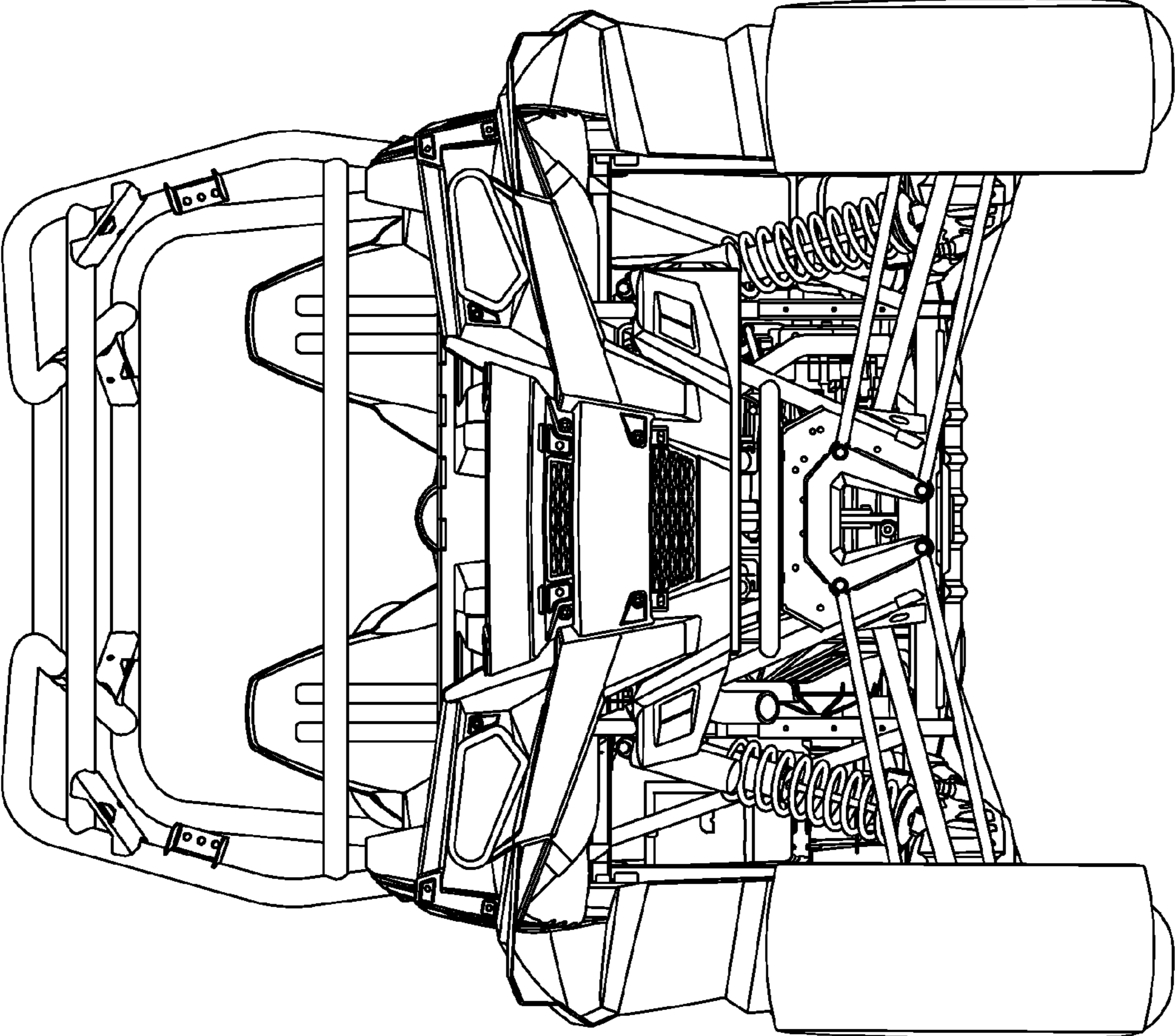

FIG. 7