



US00D650274S

(12) **United States Design Patent**
Neumann

(10) **Patent No.:** **US D650,274 S**
(45) **Date of Patent:** **** Dec. 13, 2011**

(54) **DISPENSER PACKAGE SET**

Primary Examiner — Karen S Acker

(76) Inventor: **Eric W. Neumann**, Woodstock, IL (US)

(57) **CLAIM**

The ornamental design for a dispenser package set, as shown and described.

(**) Term: **14 Years**

(21) Appl. No.: **29/357,909**

DESCRIPTION

(22) Filed: **Mar. 18, 2010**

(51) **LOC (9) Cl.** **09-03**

(52) **U.S. Cl.** **D9/433; D9/430**

(58) **Field of Classification Search** D9/430-433,
D9/414, 418, 420-423, 434; 206/278, 297,
206/299, 457, 770, 737, 822; 229/87.08,
229/101, 101.2, 101.3, 106, 108, 108.1, 116.1,
229/116.3, 116.5, 121, 122, 193, 195, 197,
229/201, 213, 221, 222, 227, 922, 939, 942
See application file for complete search history.

FIG. 1 is a front perspective view of a dispenser package set showing my new design;

FIG. 2 is a front perspective view of a dispenser package set showing an alternate embodiment of the design with the attachment shown in FIG. 12 added to the design;

FIG. 3 is a cut-away front perspective view of the design of FIG. 1 with the insert shown in FIG. 14 positioned within the design;

FIG. 4 is a front perspective view of the hinged lid of the design of FIG. 1 shown in an open position;

FIG. 5 is a front perspective view of the tag feature shown removed from the top opening of the design of FIG. 1;

FIG. 6 is a top plan view of the design of FIG. 1;

FIG. 7 is a front elevation view thereof;

FIG. 8 is a right side elevation view thereof;

FIG. 9 is a bottom plan view thereof;

FIG. 10 is a back elevation view thereof;

FIG. 11 is a left side elevation view thereof;

FIG. 12 is a plan view of the attachment which is shown in position in FIG. 2;

FIG. 13 is a plan view of the design of FIG. 1 shown unassembled; and,

FIG. 14 is a plan view of the unassembled insert which is shown within the design in FIG. 3.

(56) **References Cited**

U.S. PATENT DOCUMENTS

2,954,152	A *	9/1960	Buttery et al.	229/110
3,738,564	A *	6/1973	Persson	229/110
4,199,098	A *	4/1980	Lopez	229/108.1
4,205,775	A *	6/1980	Swan	229/104
4,392,607	A *	7/1983	Perkins, Jr.	229/109
5,011,070	A *	4/1991	Plunkett	229/109
D328,168	S *	7/1992	Bartle	D34/7
D402,201	S *	12/1998	Miller	D9/431
6,237,838	B1 *	5/2001	Bradenbaugh	229/109
D617,184	S *	6/2010	Sneva	D9/430
D628,884	S *	12/2010	Smith	D9/430
2005/0067476	A1 *	3/2005	Hengami	229/129.1

* cited by examiner

1 Claim, 7 Drawing Sheets

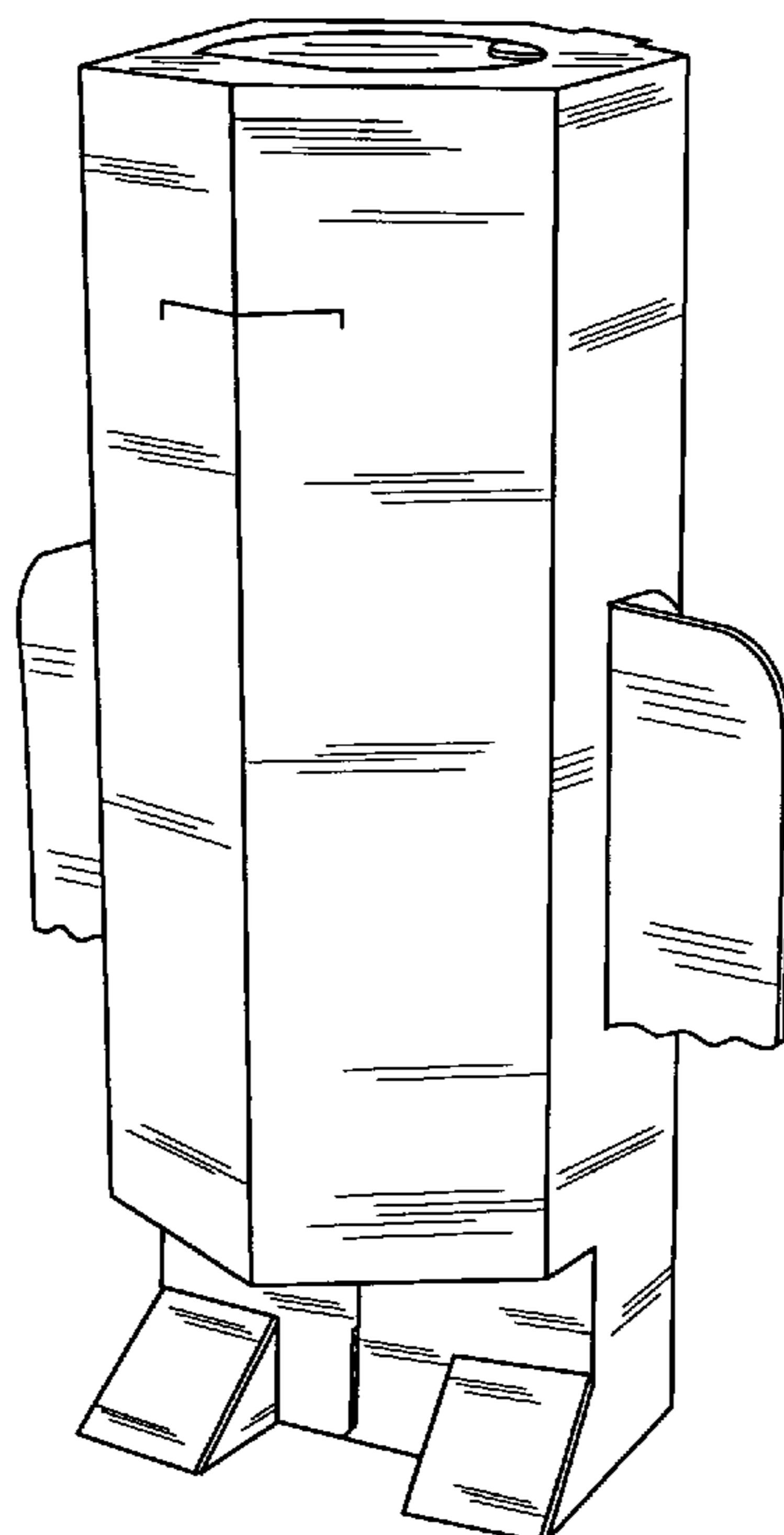

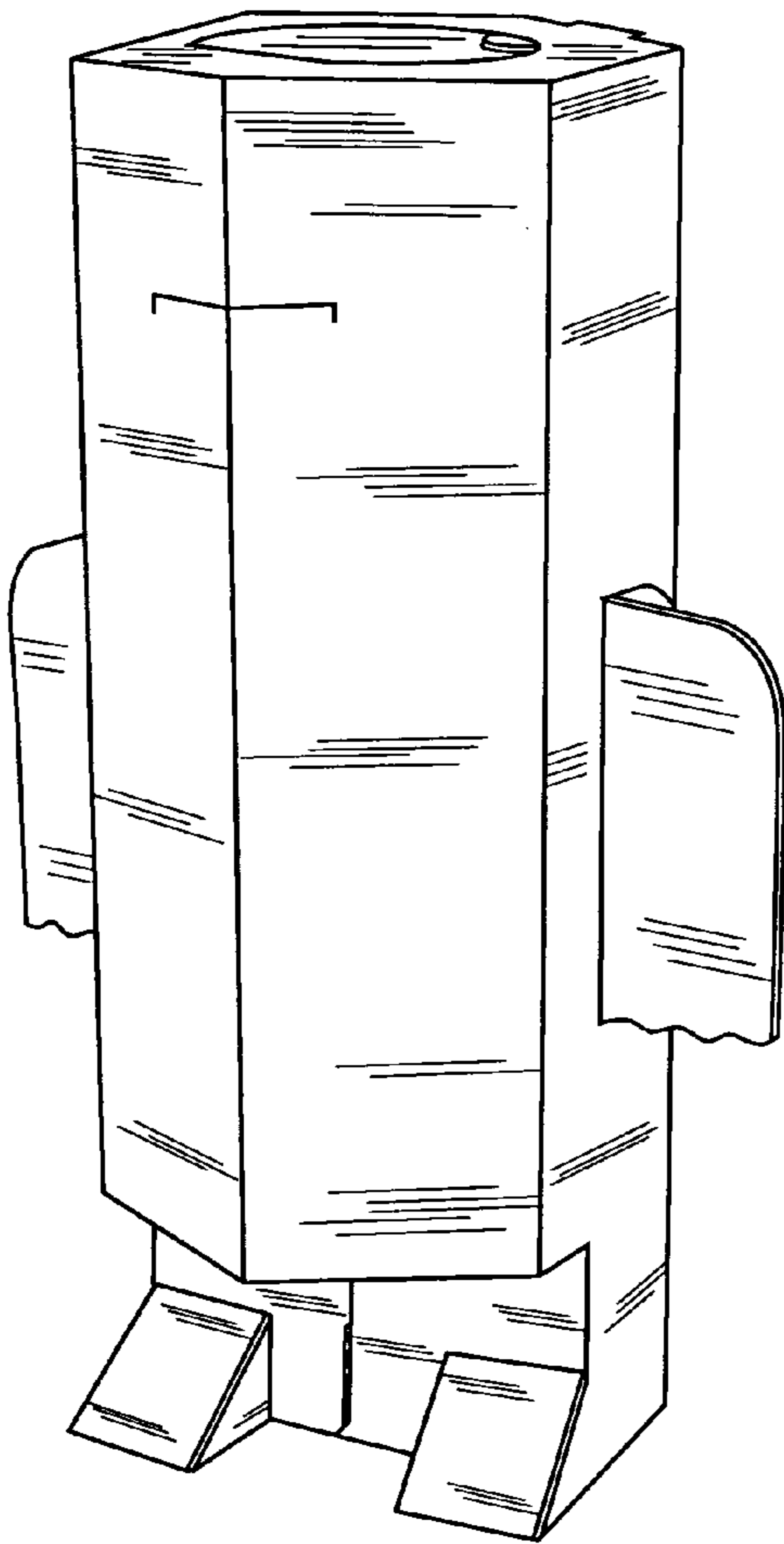

FIG. 1

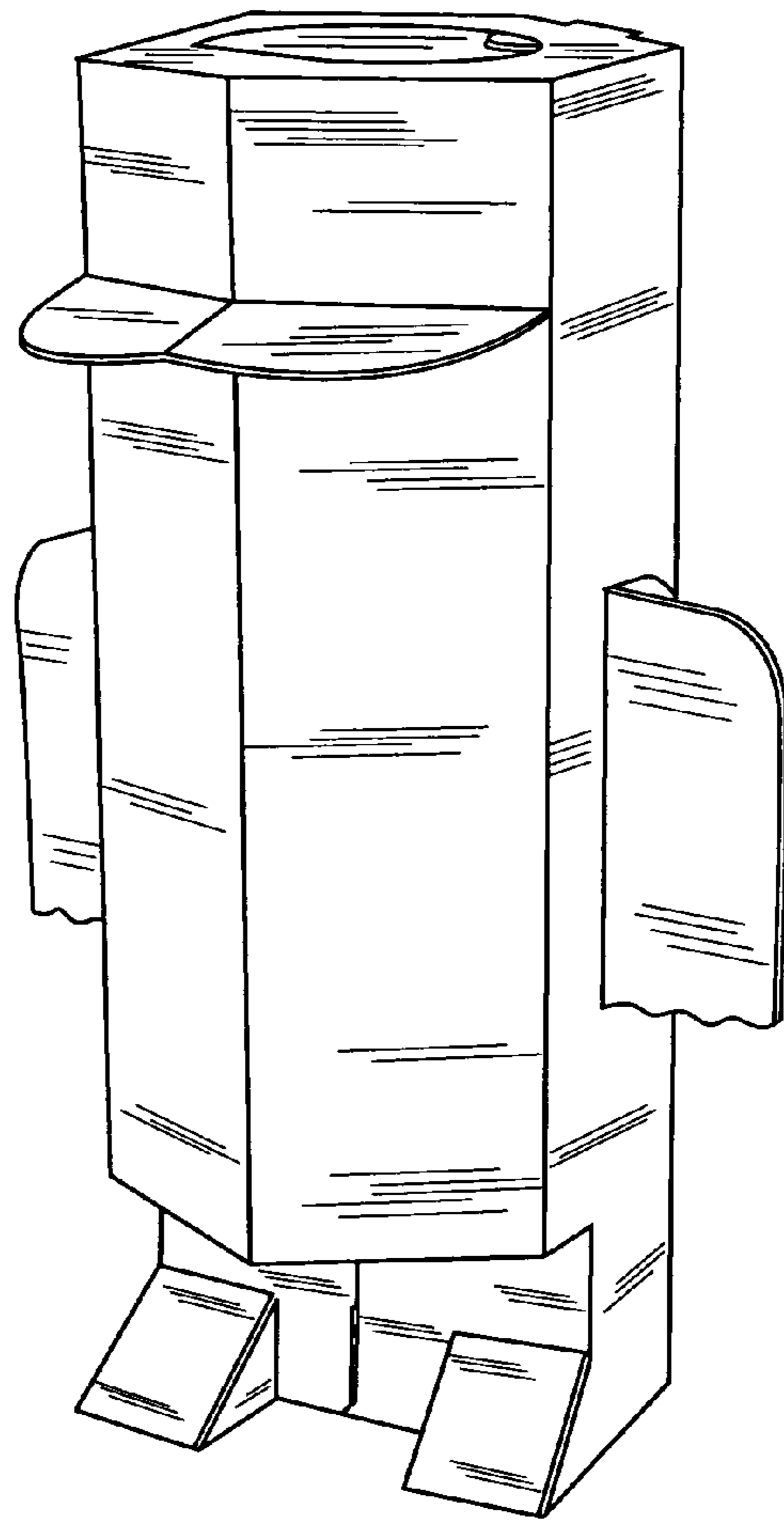

FIG. 2

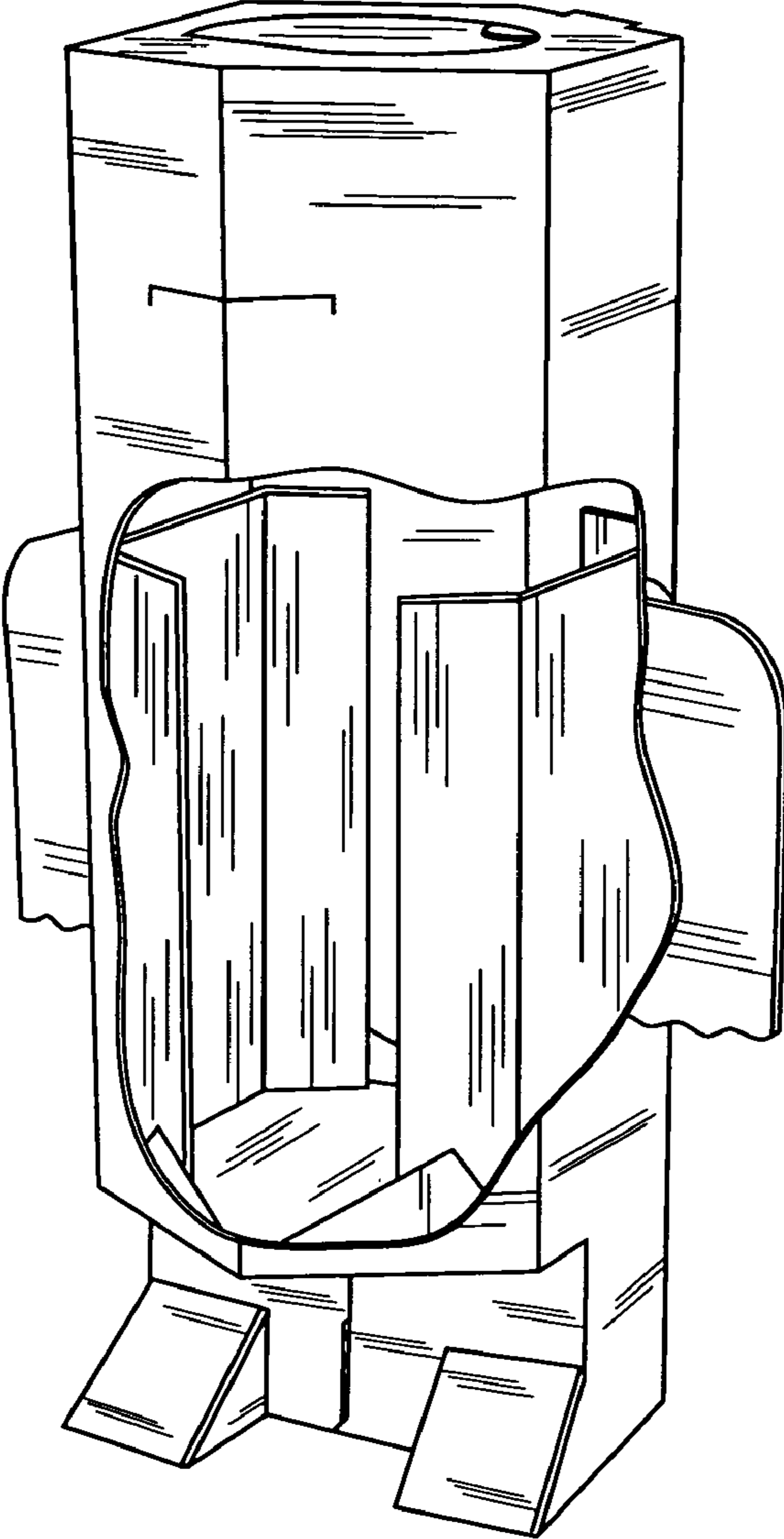

FIG. 3

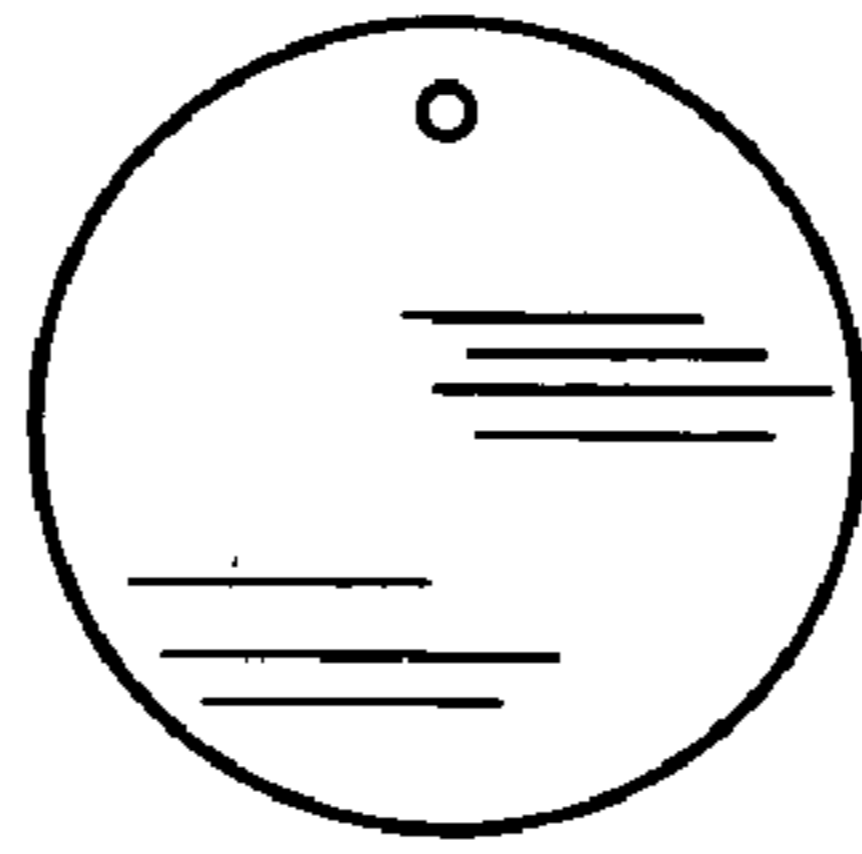

FIG. 5

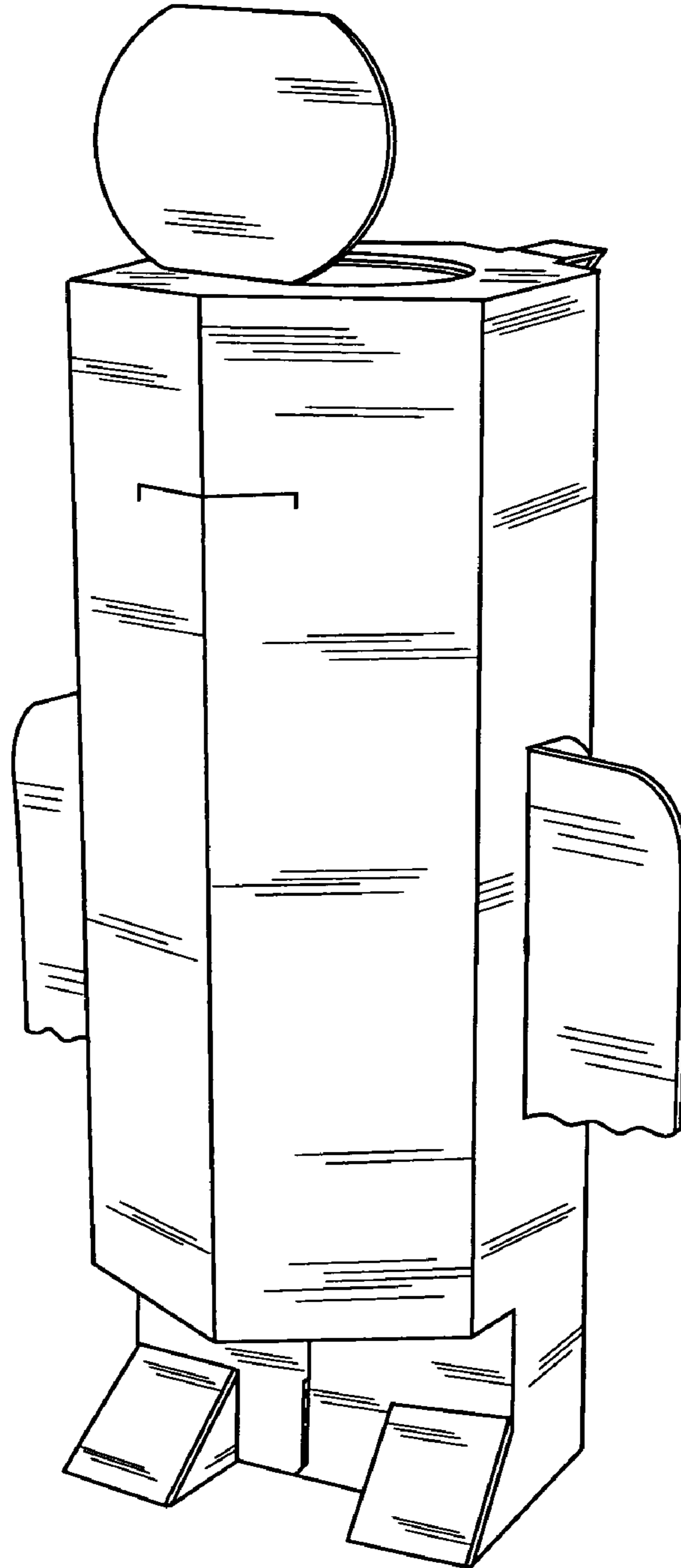

FIG. 4

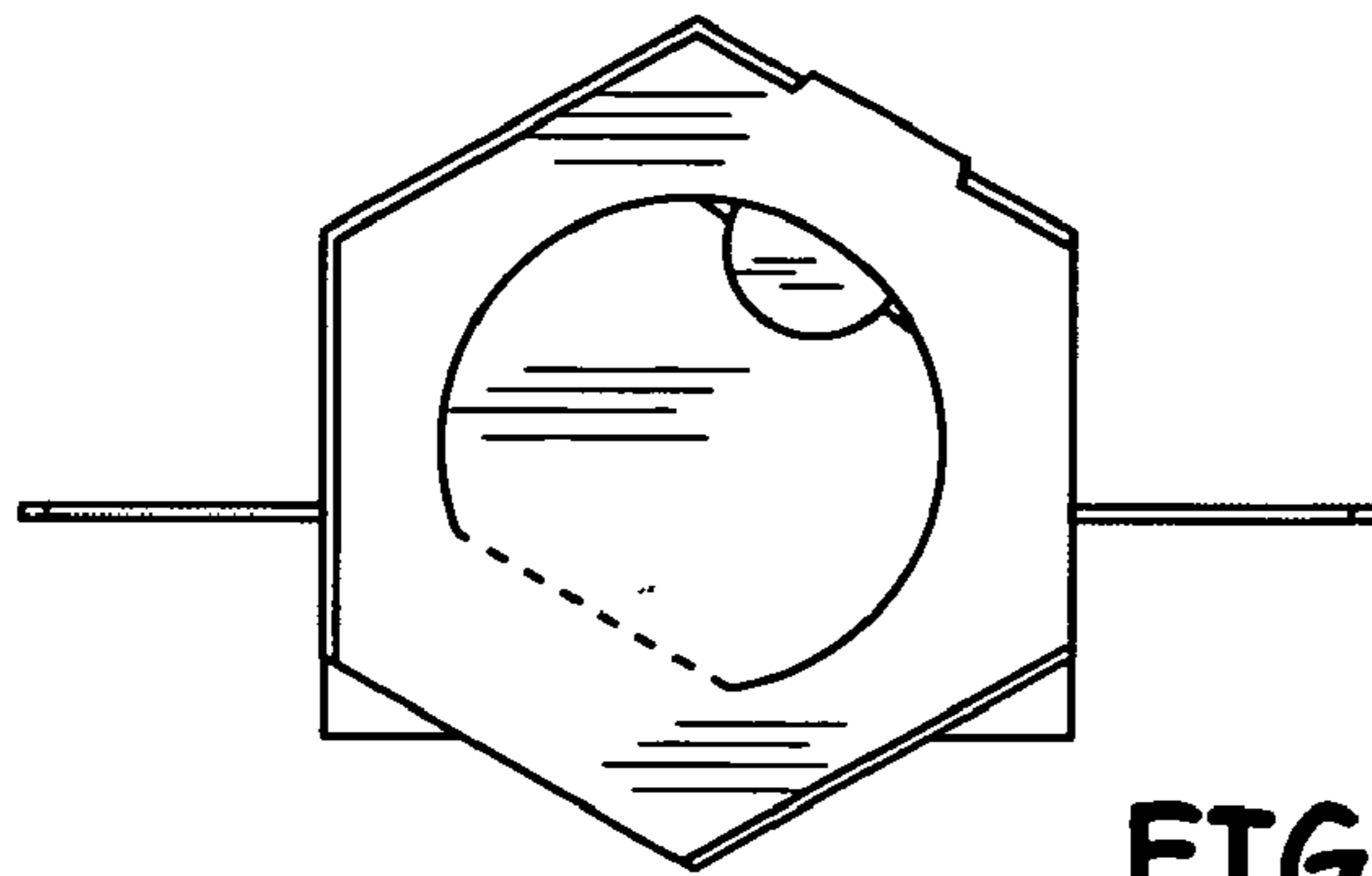

FIG. 6

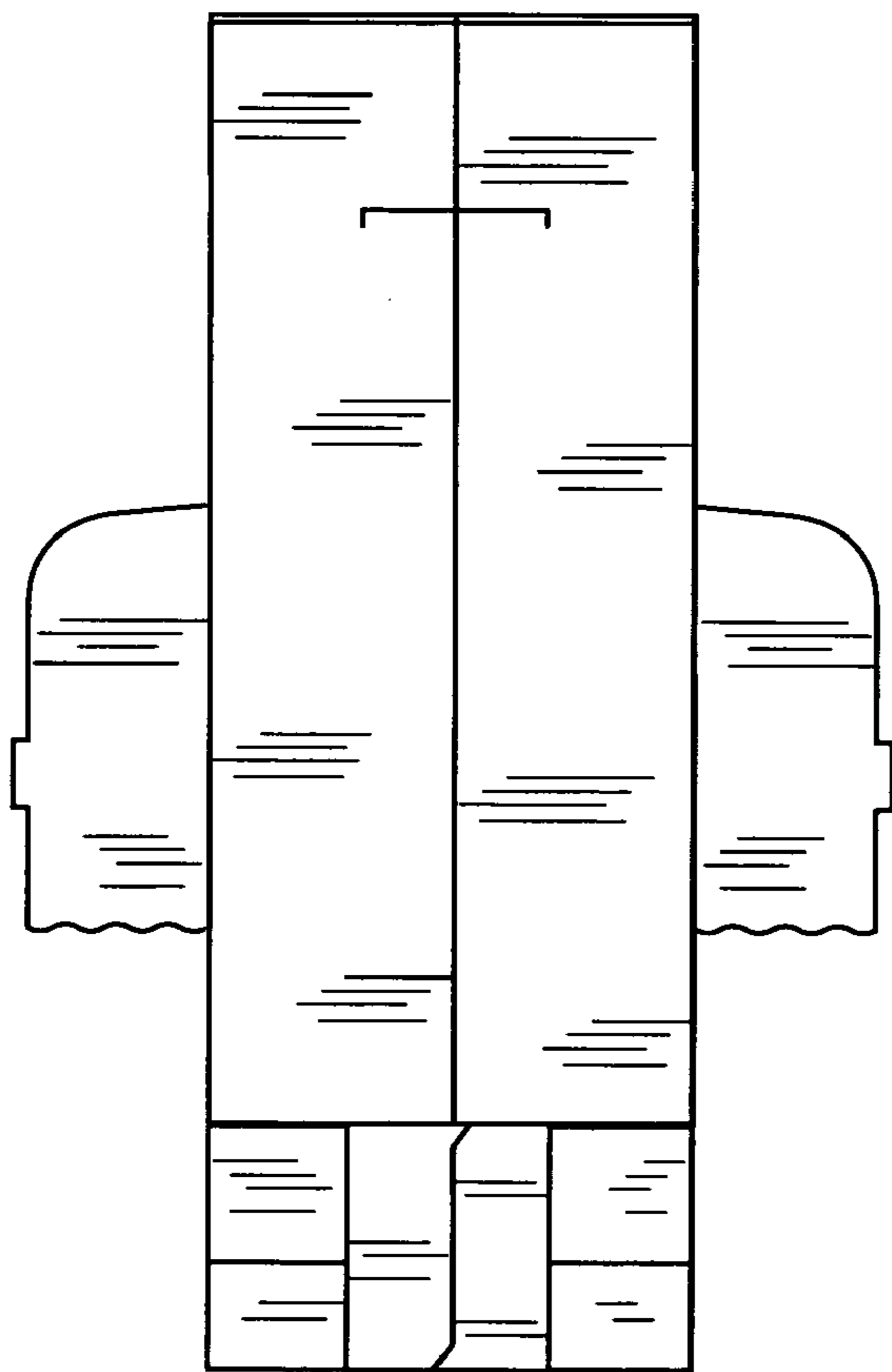

FIG. 7

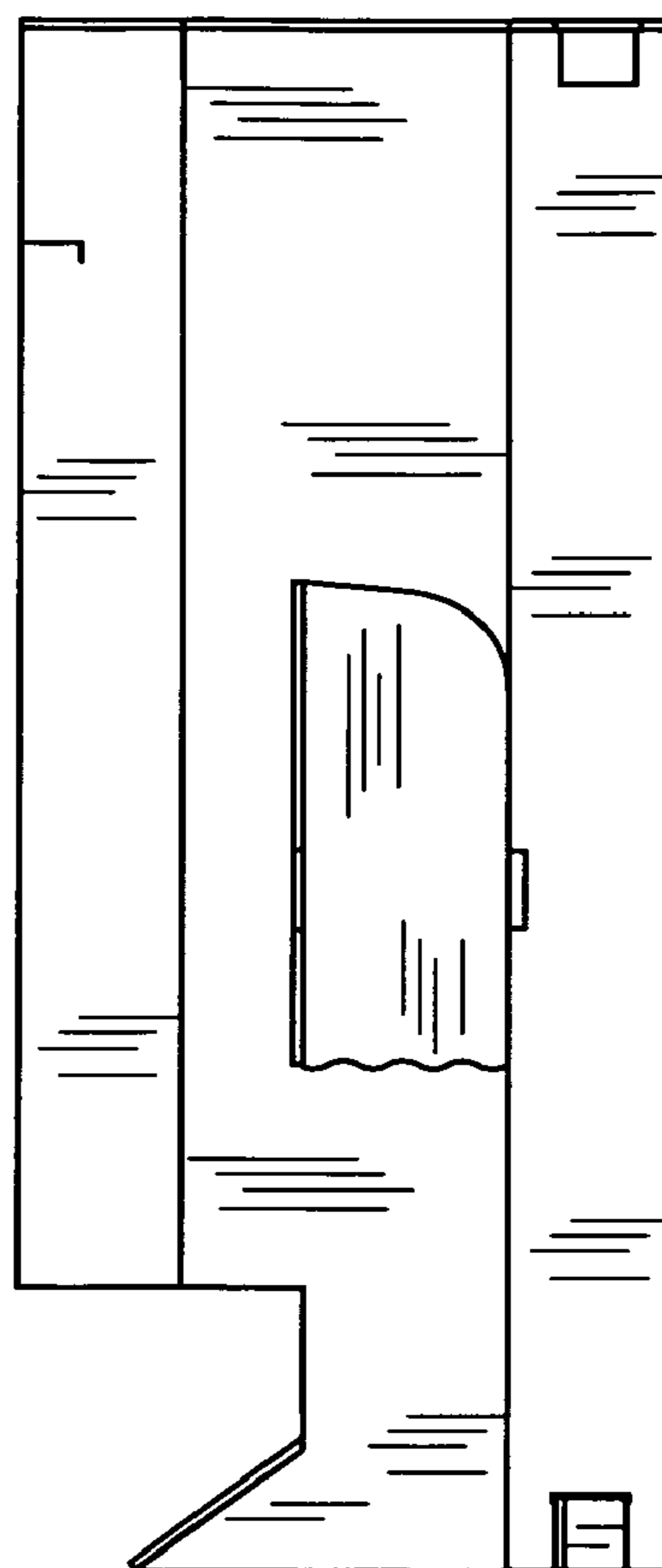

FIG. 8

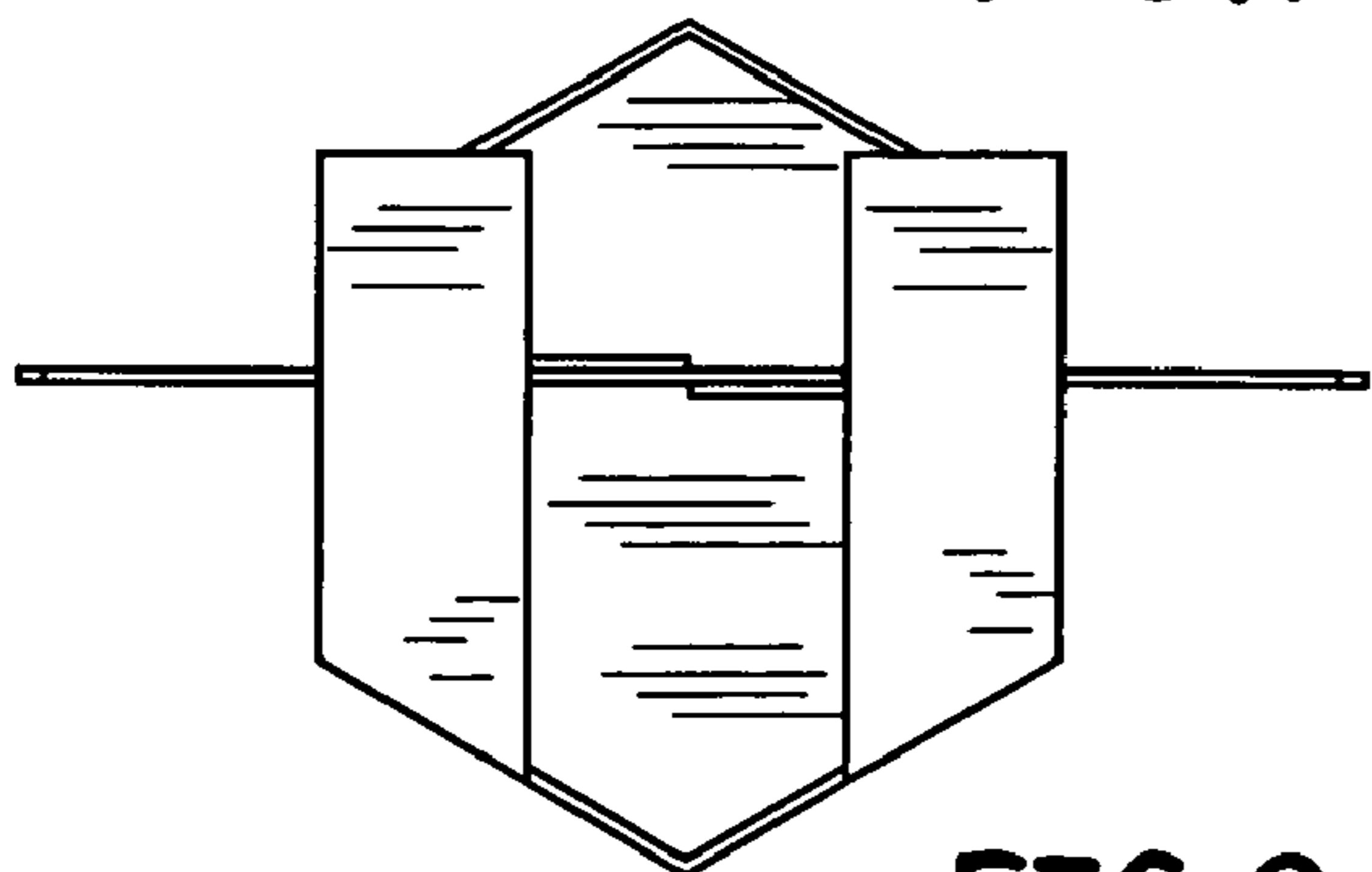

FIG. 9

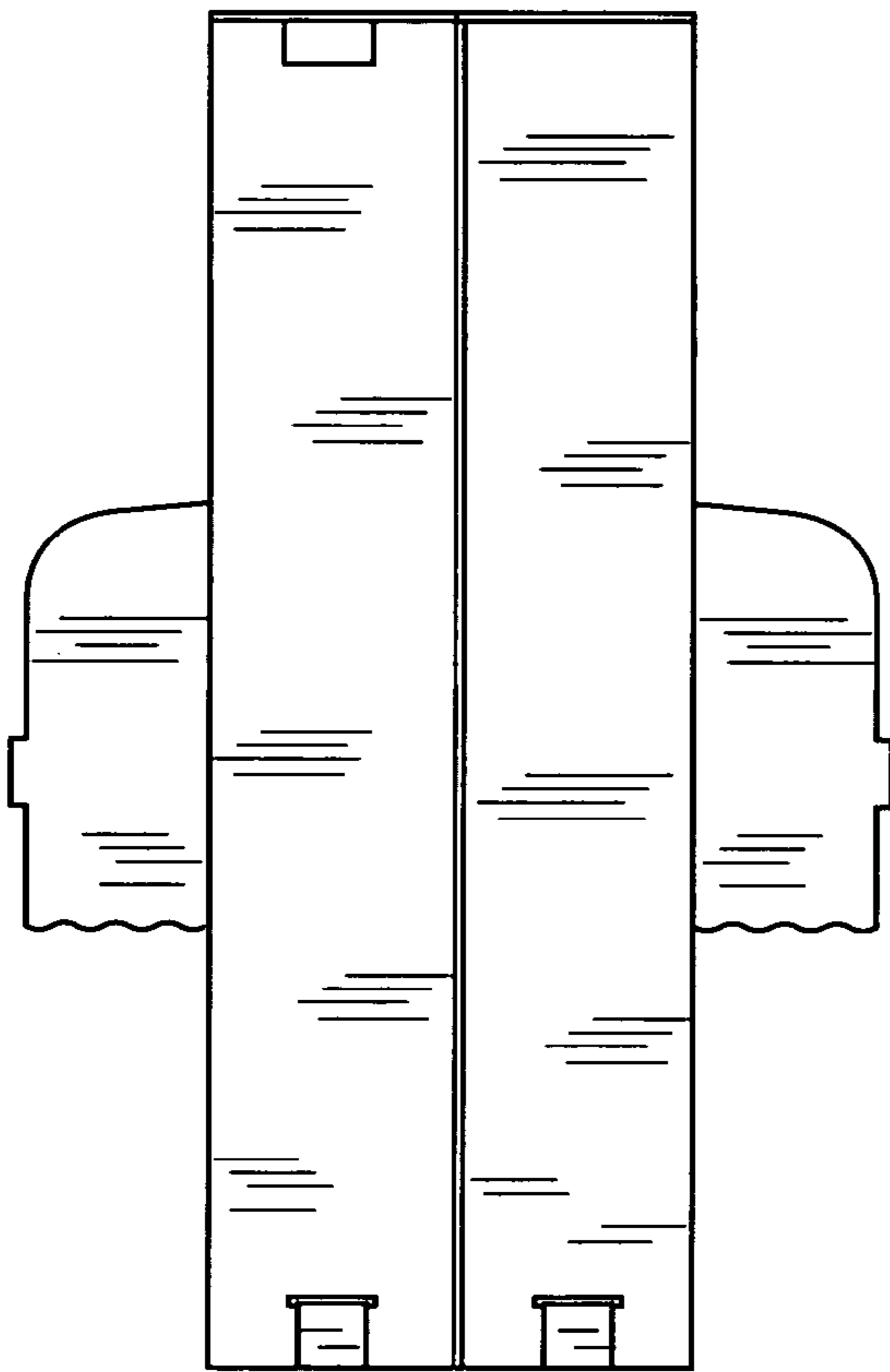

FIG. 10

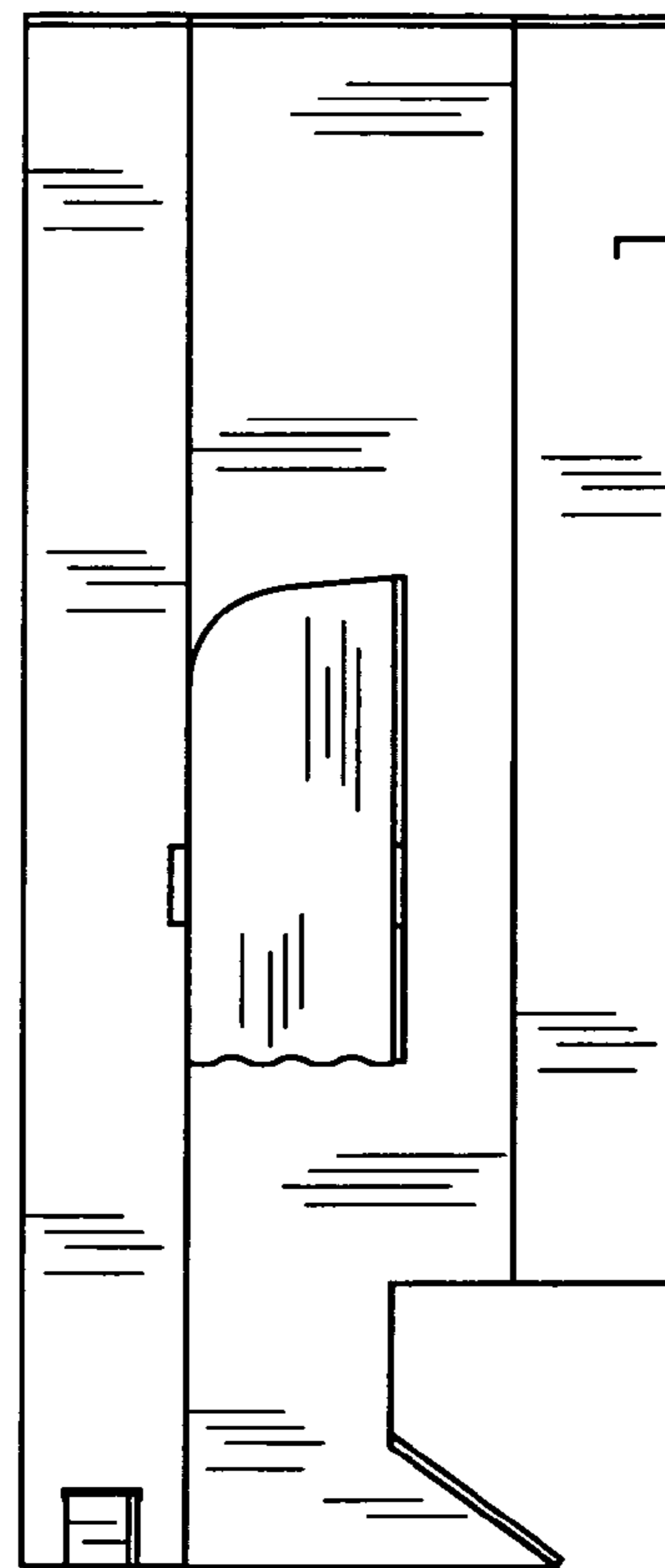

FIG. 11

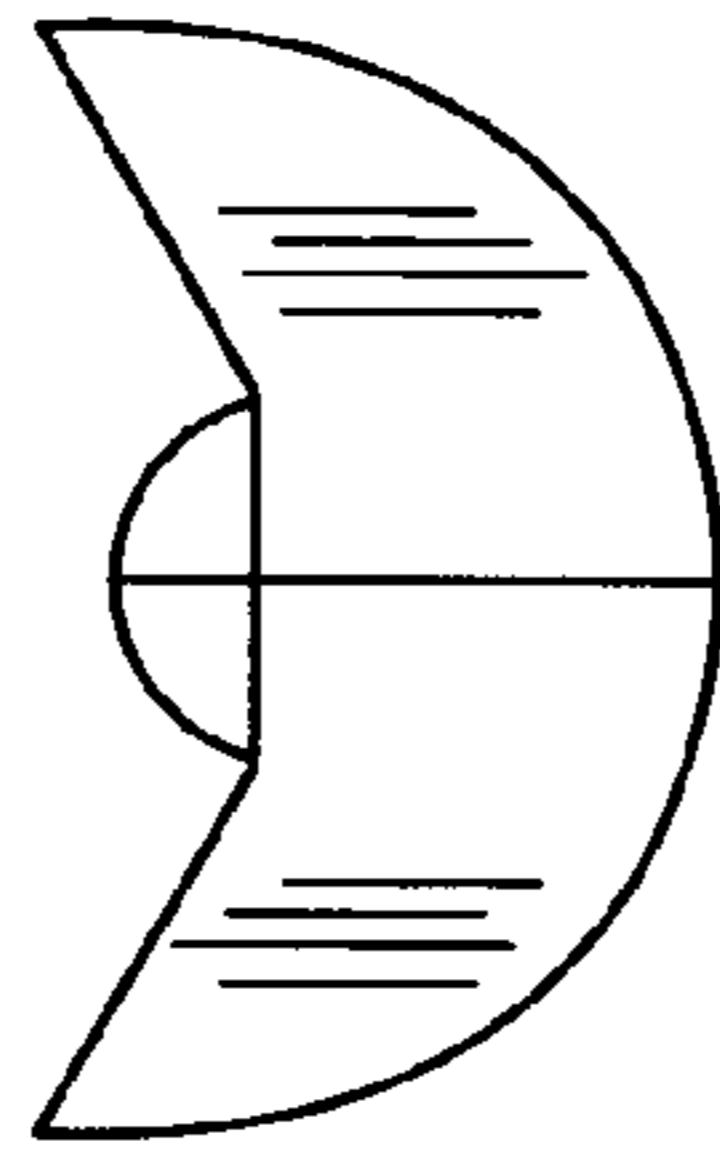

FIG. 12

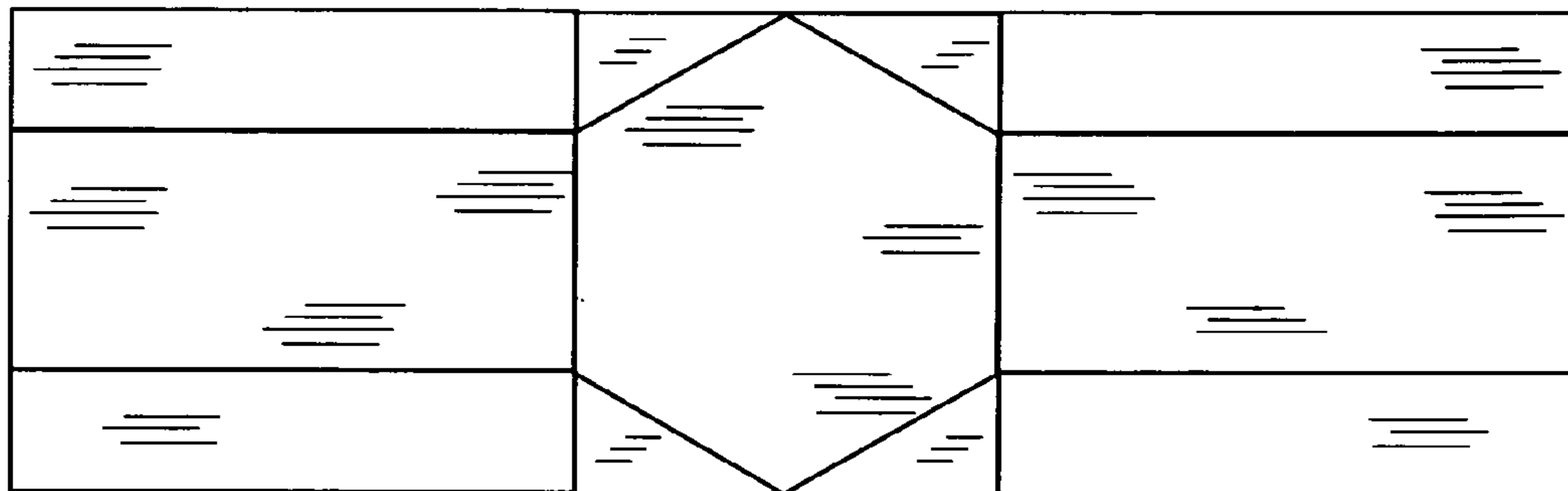

FIG. 14

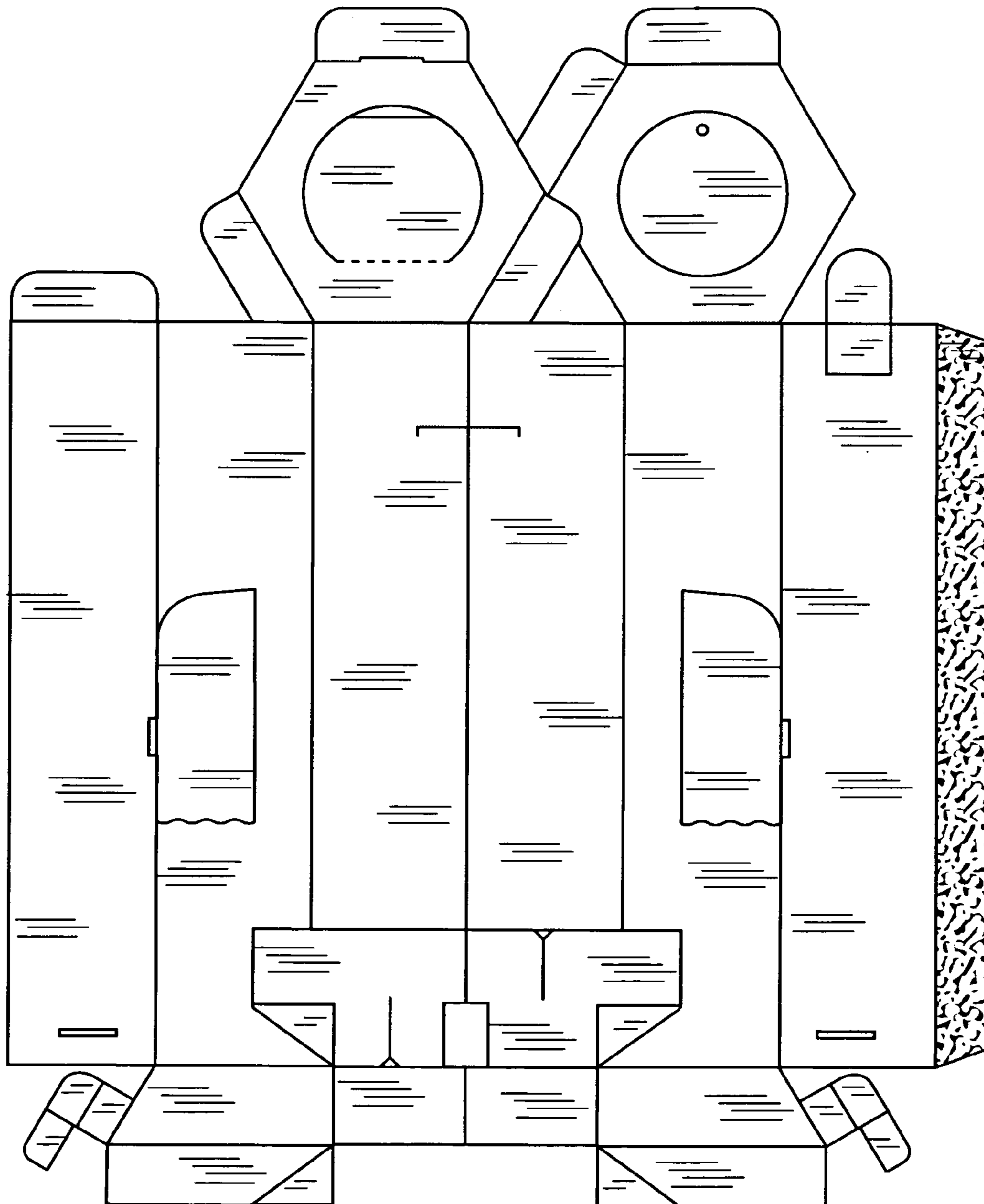

FIG. 13