



US00D649043S

(12) **United States Design Patent**
Anderson et al.

(10) **Patent No.:** **US D649,043 S**

(45) **Date of Patent:** **** Nov. 22, 2011**

(54) **PACKAGING WITH SURFACE
ORNAMENTATION**

(75) Inventors: **James Joseph Anderson**, Boston, MA
(US); **Carl Andrew Gerhards**, Astoria,
NY (US); **Andrew Anthony Markle**,
New York, NY (US)

(73) Assignee: **The Gillette Company**, Boston, MA
(US)

(**) Term: **14 Years**

(21) Appl. No.: **29/387,447**

(22) Filed: **Mar. 14, 2011**

(51) **LOC (9) Cl.** **09-07**

(52) **U.S. Cl.** **D9/434; D9/457**

(58) **Field of Classification Search** D9/600,
D9/457, 454, 441, 434, 432, 415, 414; D5/56,
D5/32; D20/40, 36, 28, 27, 26, 22, 11; D14/492,
D14/489; 715/976, 840, 764, 715, 700; 229/923,
229/922, 87.19, 116.5, 116.1, 100; 220/694,
220/376

See application file for complete search history.

(56) **References Cited**

U.S. PATENT DOCUMENTS

D248,834 S * 8/1978 Morgan D9/552
D312,423 S 11/1990 Orlinsky et al.
D427,067 S * 6/2000 Miller et al. D9/434
D429,282 S * 8/2000 Velazquez et al. D20/11
D510,788 S * 10/2005 Barre D1/199
D518,710 S * 4/2006 Harbutt et al. D9/434
D556,048 S * 11/2007 Lepoitevin D9/551
D561,416 S * 2/2008 Jackson et al. D32/37
D589,792 S * 4/2009 Clabough et al. D9/434

D593,410 S * 6/2009 Schwartz D9/434
D617,186 S * 6/2010 Bone D9/434
D621,275 S * 8/2010 Marotti et al. D9/600
D633,789 S * 3/2011 Bone D9/434
D643,715 S * 8/2011 Graham et al. D9/434

OTHER PUBLICATIONS

U.S. Appl. No. 29/387,443, filed Mar. 14, 2001, James J. Anderson et al.

* cited by examiner

Primary Examiner — Susan Bennett Hattan

(74) *Attorney, Agent, or Firm* — John M. Lipchitz; Kevin C. Johnson; Steven C. Miller

(57) **CLAIM**

The ornamental design for packaging with surface ornamentation, as shown and described.

DESCRIPTION

FIG. 1 is a perspective view of packaging with surface ornamentation of the present invention;
FIG. 2 is a front view thereof;
FIG. 3 is a rear view thereof;
FIG. 4 is a right view thereof;
FIG. 5 is a left view thereof;
FIG. 6 is a top view thereof;
FIG. 7 is a bottom view thereof;
FIG. 8 is a perspective view of a second environment thereof;
FIG. 9 is a rear view thereof;
FIG. 10 is a front view thereof;
FIG. 11 is a right view thereof;
FIG. 12 is a left view thereof;
FIG. 13 is a top view thereof; and,
FIG. 14 is a bottom view thereof.

The broken lines depict environmental subject matter only and form no part of the claimed design.

1 Claim, 6 Drawing Sheets

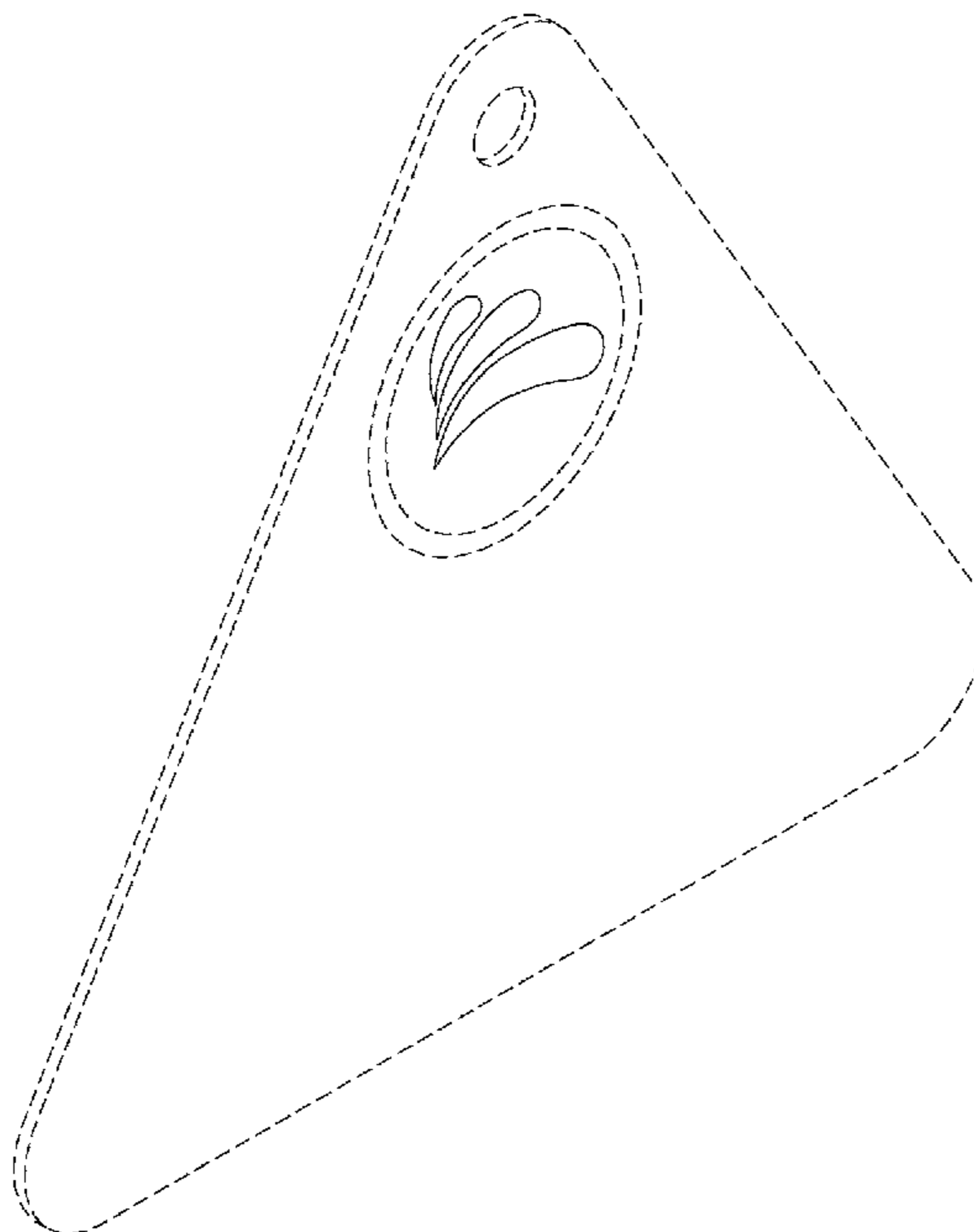

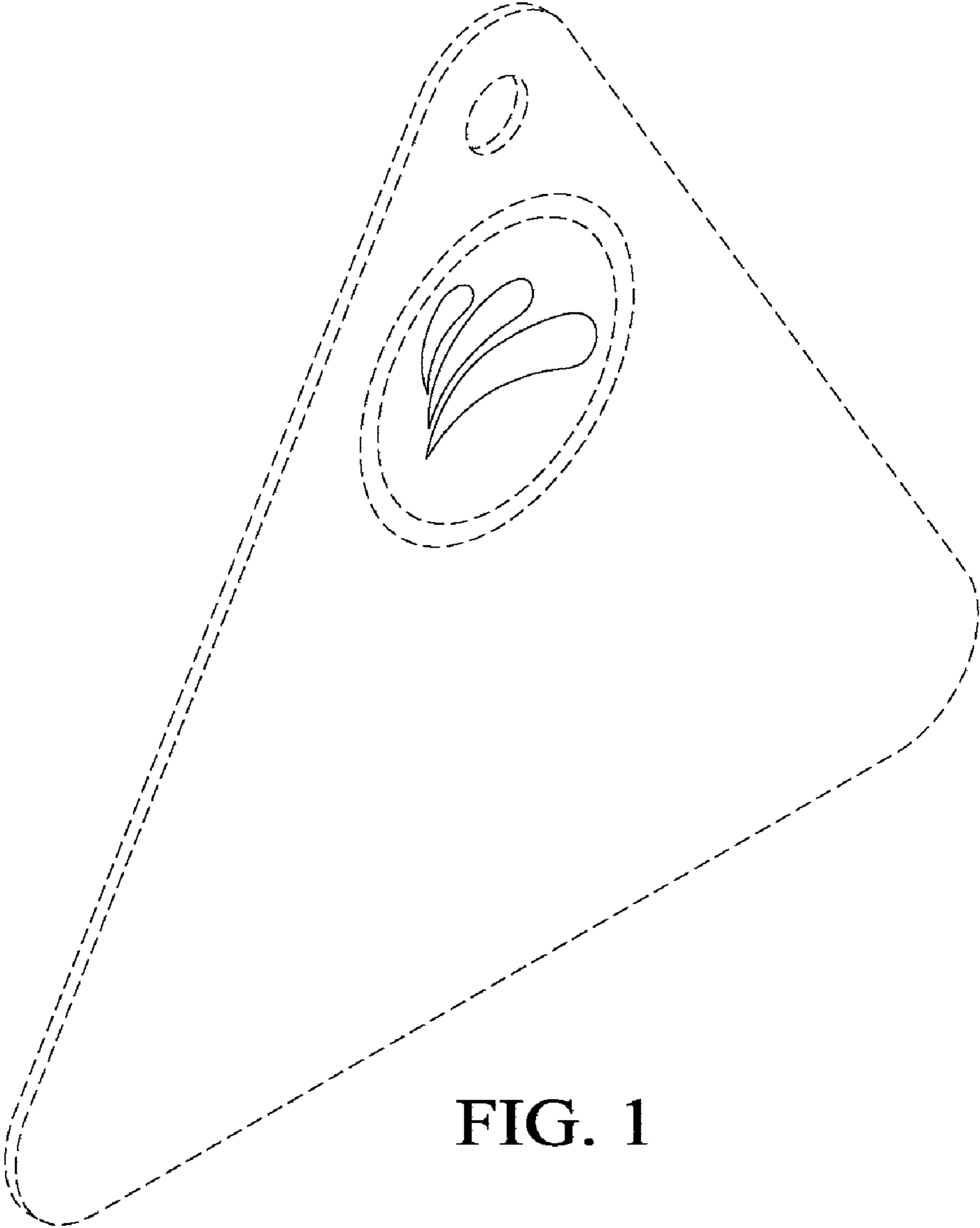

FIG. 1

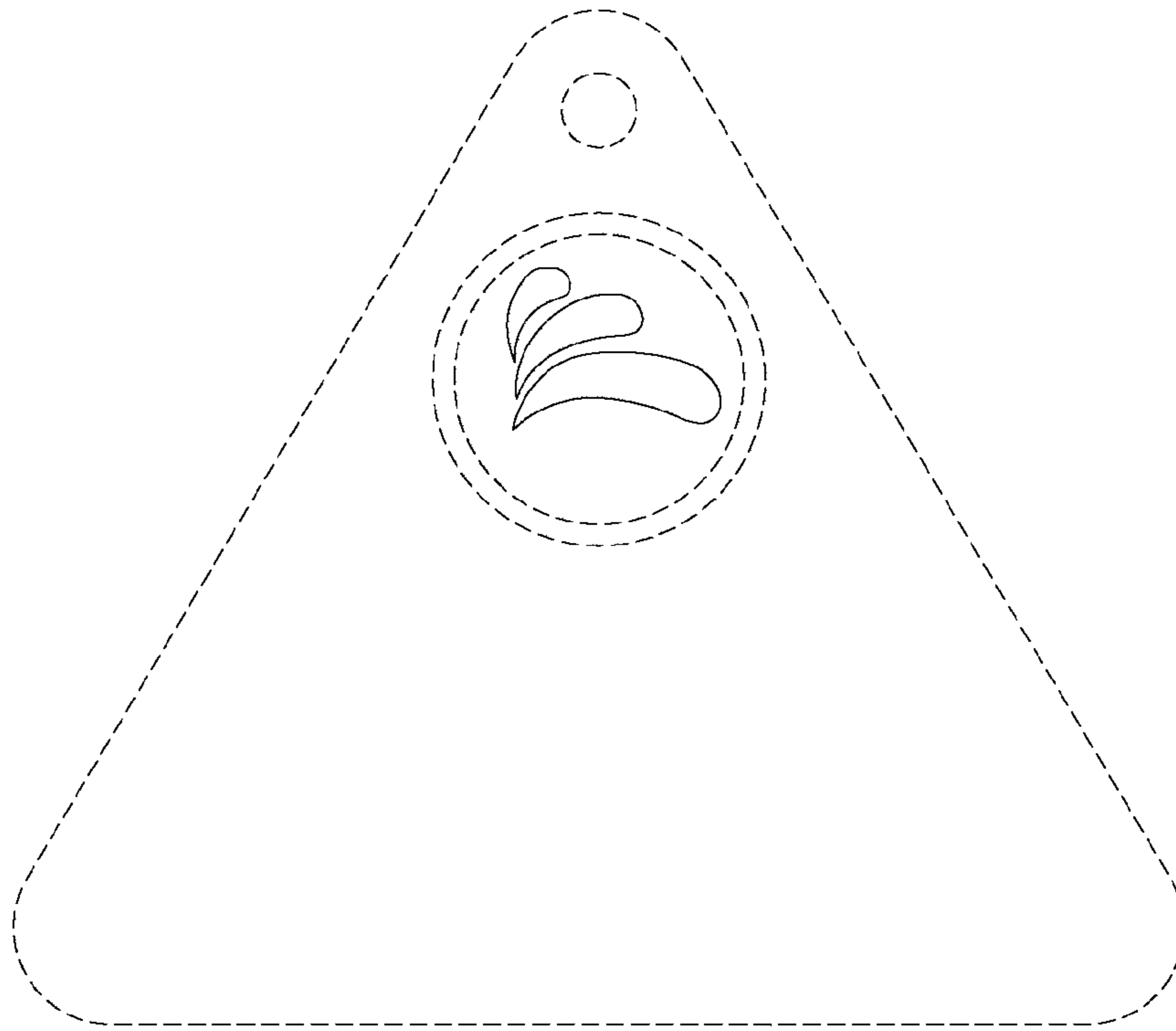

FIG. 2

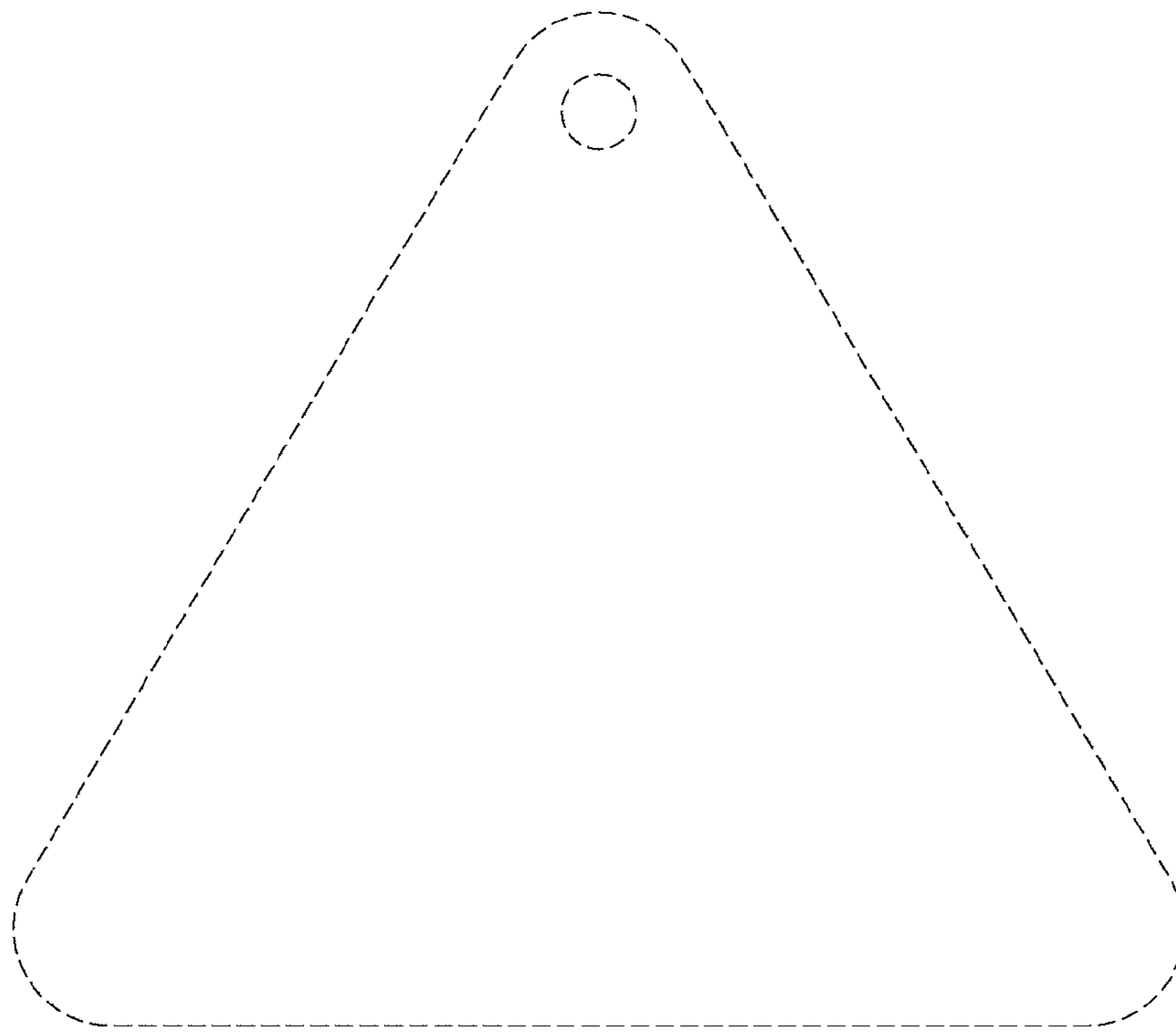

FIG. 3

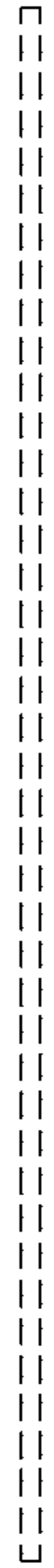

FIG. 4

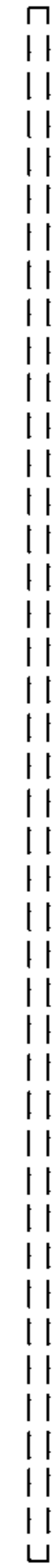

FIG. 5

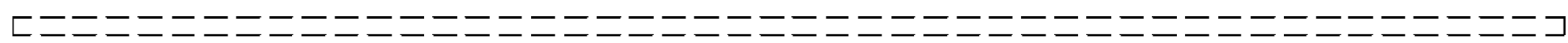

FIG. 6

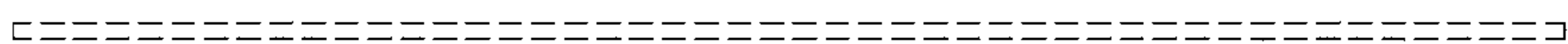

FIG. 7

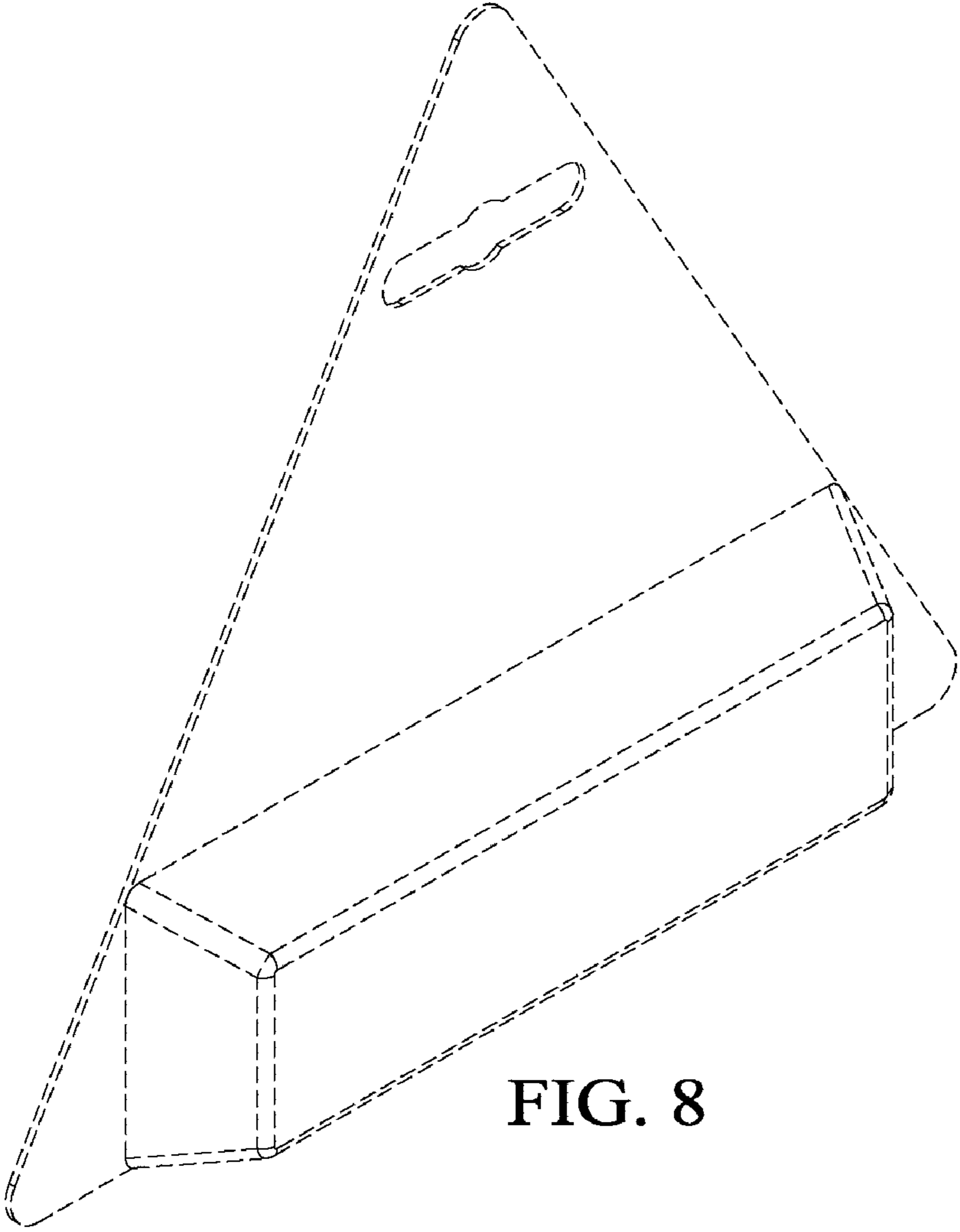

FIG. 8

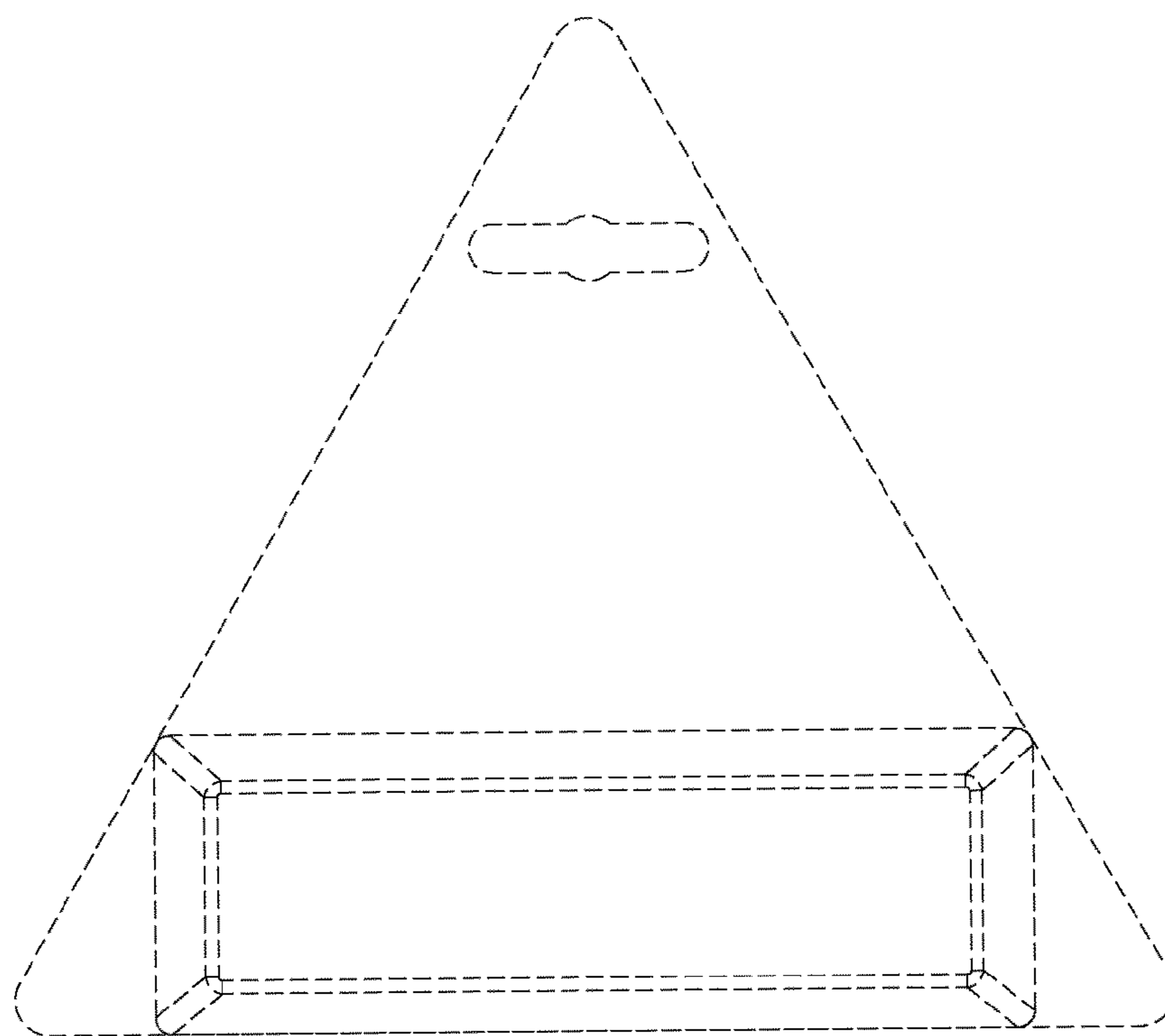

FIG. 9

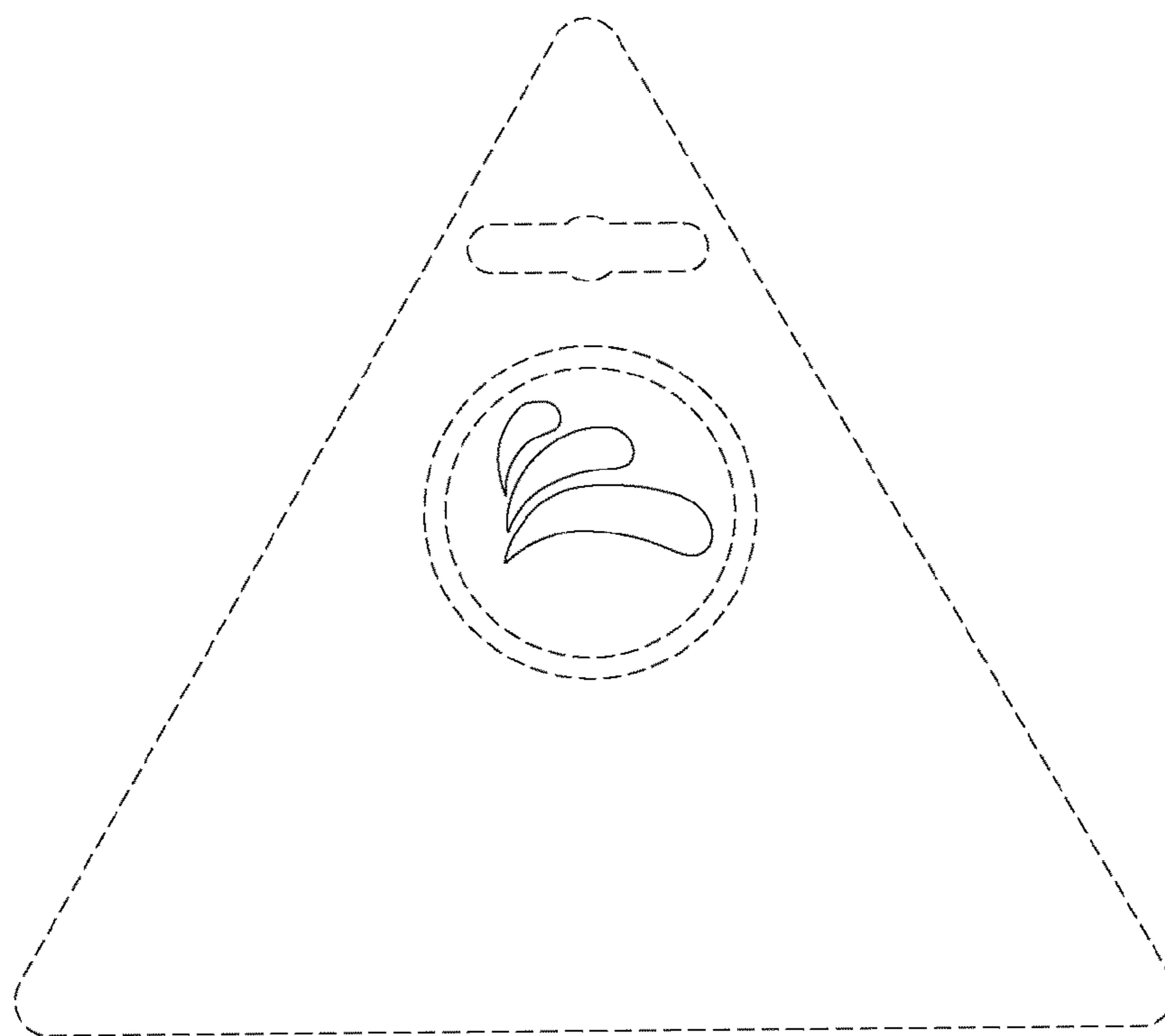

FIG. 10



FIG. 11

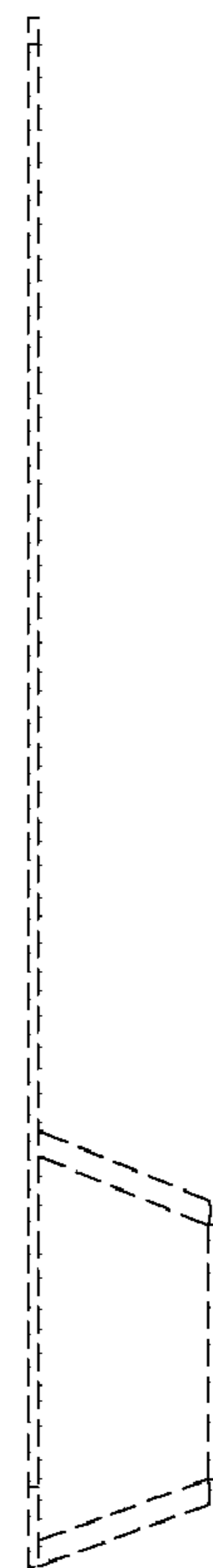

FIG. 12

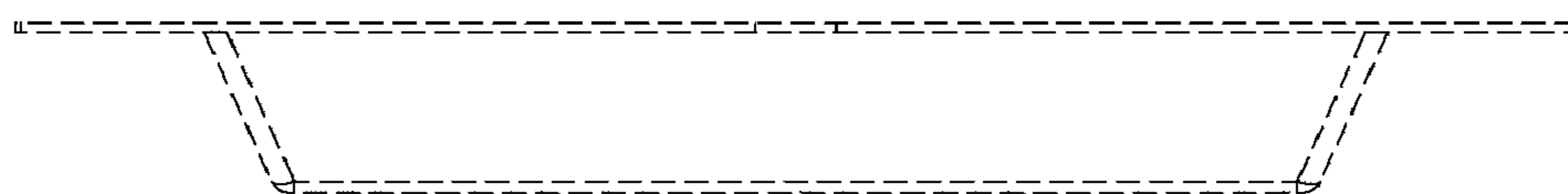

FIG. 13

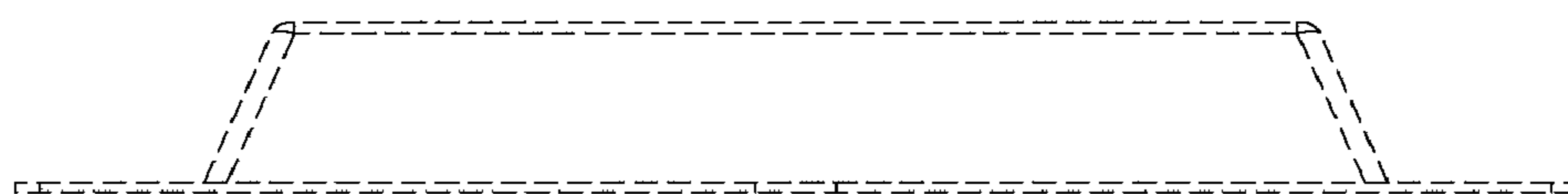

FIG. 14