

US00D648438S

(12) **United States Design Patent**  
**Chronister et al.**

(10) **Patent No.:** **US D648,438 S**

(45) **Date of Patent:** **\*\* Nov. 8, 2011**

(54) **DENTAL DEVICE CONNECTION ADAPTER**

(75) Inventors: **Benjamin Chronister**, York, PA (US);  
**Jeremy Kile**, York, PA (US)

(73) Assignee: **Dentsply International, Inc.**, York, PA  
(US)

(\*\*) Term: **14 Years**

(21) Appl. No.: **29/359,181**

(22) Filed: **Apr. 7, 2010**

**Related U.S. Application Data**

(63) Continuation-in-part of application No. 12/004,145,  
filed on Dec. 20, 2007, now Pat. No. 7,955,079.

(51) **LOC (9) Cl.** ..... **24-03**

(52) **U.S. Cl.** ..... **D24/176**

(58) **Field of Classification Search** ..... D24/155,  
D24/156, 180, 176; 433/173, 176, 125, 126;  
606/304, 74, 72; D8/394-399.349

See application file for complete search history.

(56) **References Cited**

**U.S. PATENT DOCUMENTS**

D157,122 S *	2/1950	Blake et al.	.....	D8/349
D187,243 S *	2/1960	Pinson	.....	D8/396
2,925,282 A *	2/1960	Borsetti	.....	279/123
D203,921 S *	2/1966	Terwilliger	.....	D8/396
3,433,118 A *	3/1969	Ward	.....	411/340

D241,520 S *	9/1976	Fujita et al.	.....	D8/397
D286,978 S *	12/1986	Cogburn	.....	D8/396
5,336,089 A *	8/1994	Sakurai	.....	433/126
5,749,728 A *	5/1998	Bailey	.....	433/125
D422,898 S *	4/2000	Hussaini	.....	D8/397
D432,403 S *	10/2000	Svensson	.....	D8/394
6,461,981 B1 *	10/2002	Chang	.....	438/769
6,527,552 B2 *	3/2003	Loddeke et al.	.....	433/125
D484,785 S *	1/2004	Plumer	.....	D8/397
6,695,557 B2 *	2/2004	Hove et al.	.....	411/429
D504,141 S *	4/2005	Charland et al.	.....	D15/139
7,510,396 B2 *	3/2009	Lee et al.	.....	433/125
D591,145 S *	4/2009	Kosunen et al.	.....	D8/396
D594,318 S *	6/2009	Fell et al.	.....	D8/396

\* cited by examiner

*Primary Examiner* — Ian Simmons

*Assistant Examiner* — Wan Laymon

(74) *Attorney, Agent, or Firm* — Douglas J. Hura; Leana  
Levin; David A. Zhurne

(57) **CLAIM**

The ornamental design for a dental device connection  
adapter, as shown and described is claimed.

**DESCRIPTION**

FIG. 1 is an isometric view of a dental device connection  
adapter showing our new design;

FIG. 2 is a top view thereof;

FIG. 3 is a first side view thereof;

FIG. 4 is a second side view thereof;

FIG. 5 is a front view thereof; and,

FIG. 6 is a rear view thereof.

**1 Claim, 2 Drawing Sheets**

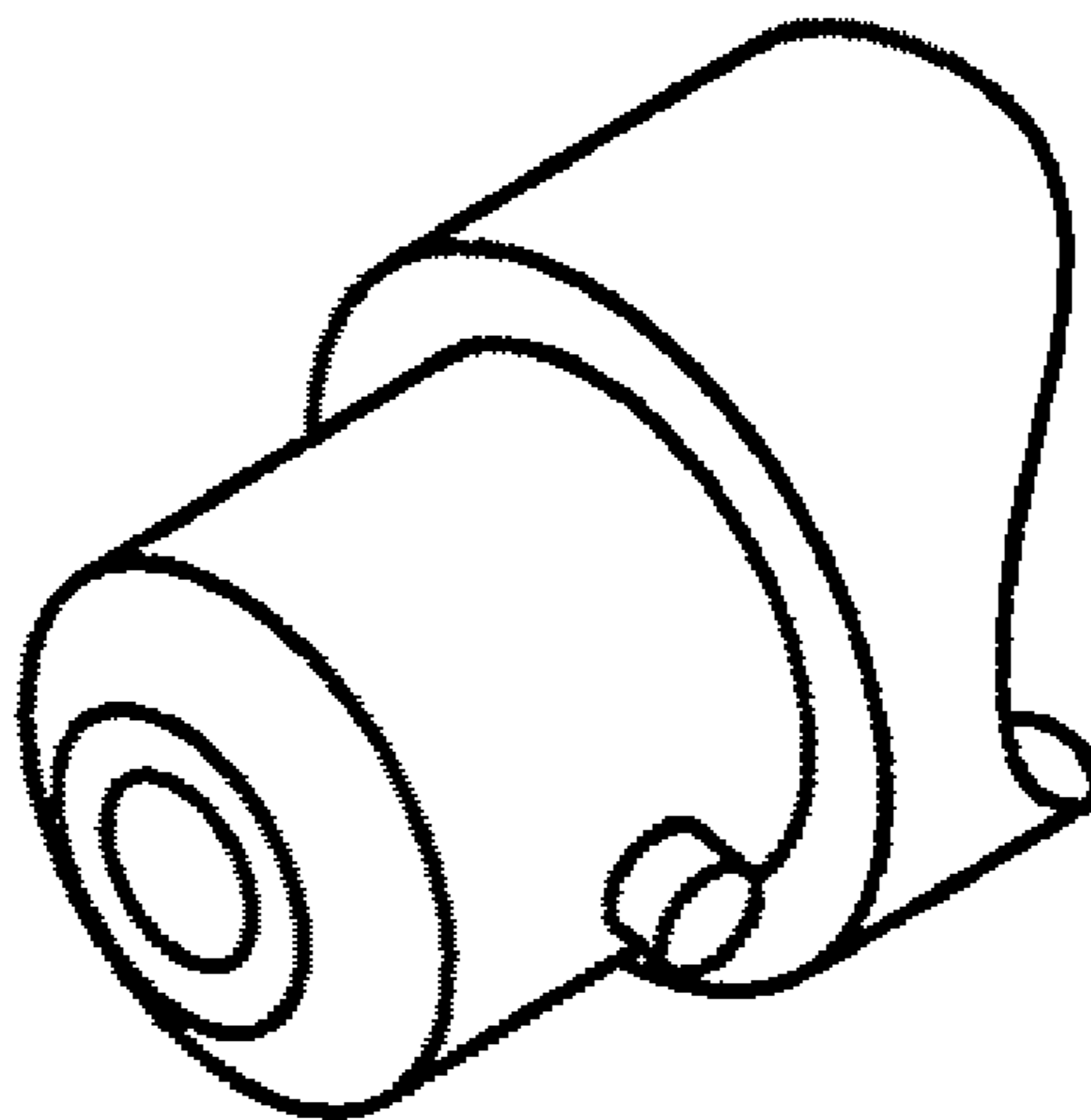

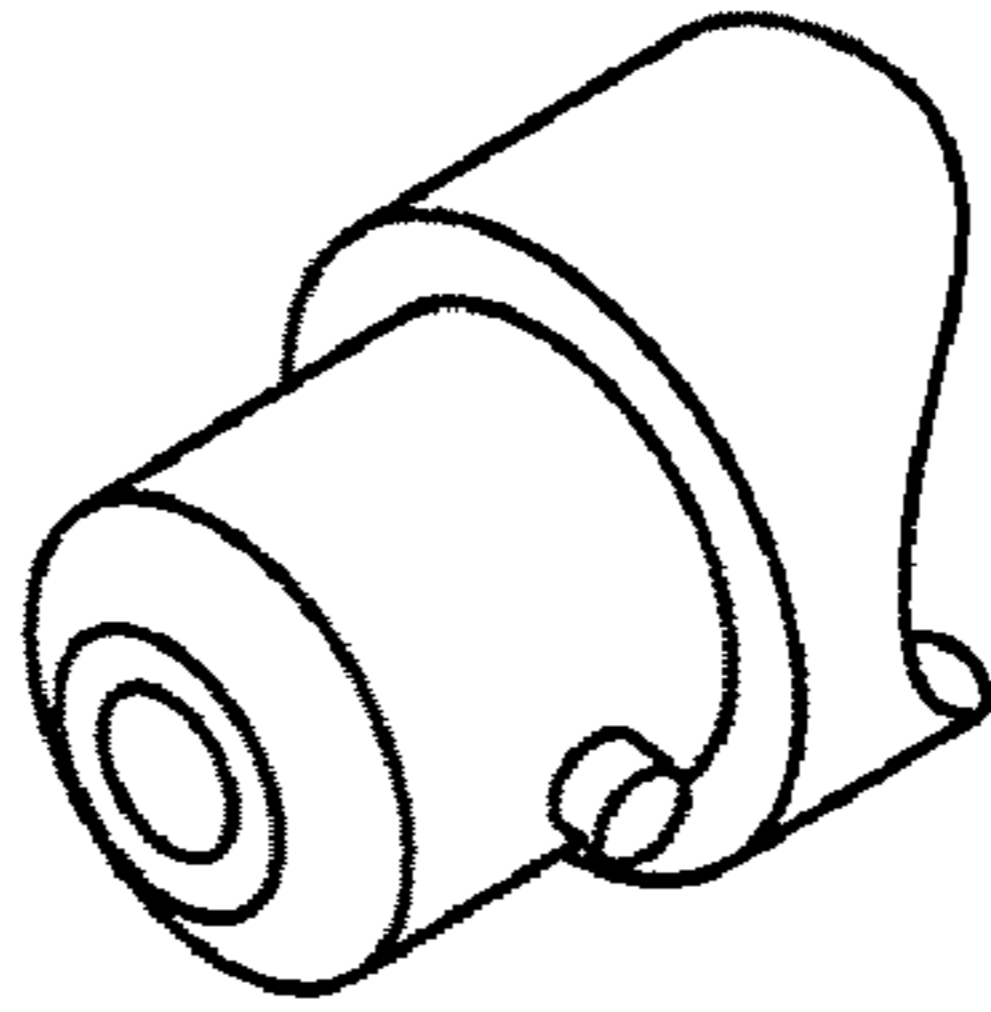

FIG. 1

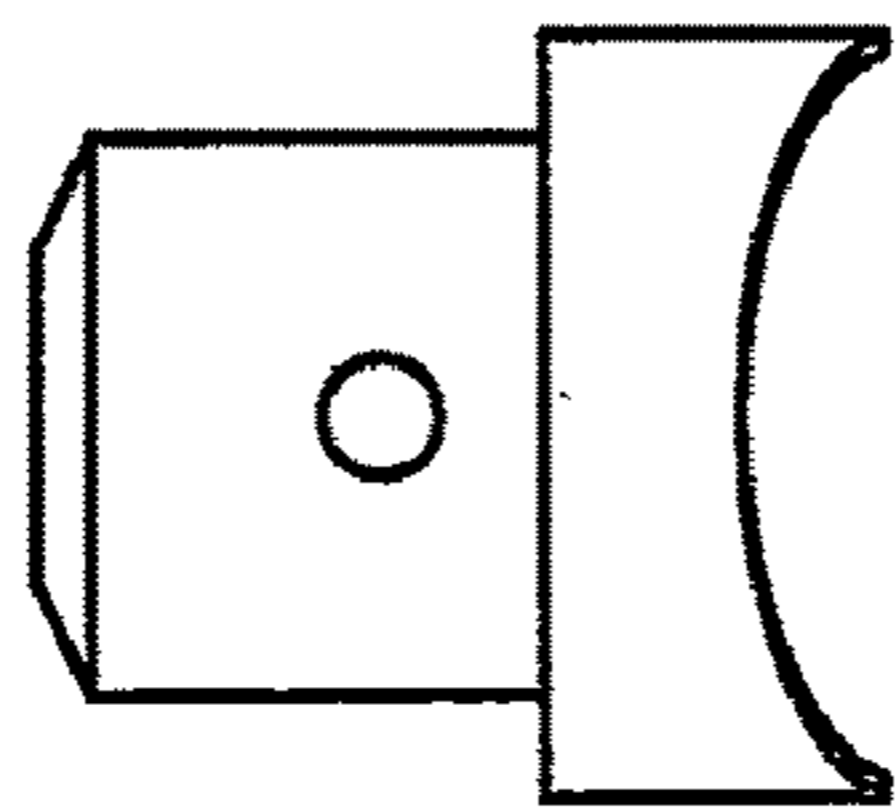

FIG. 2

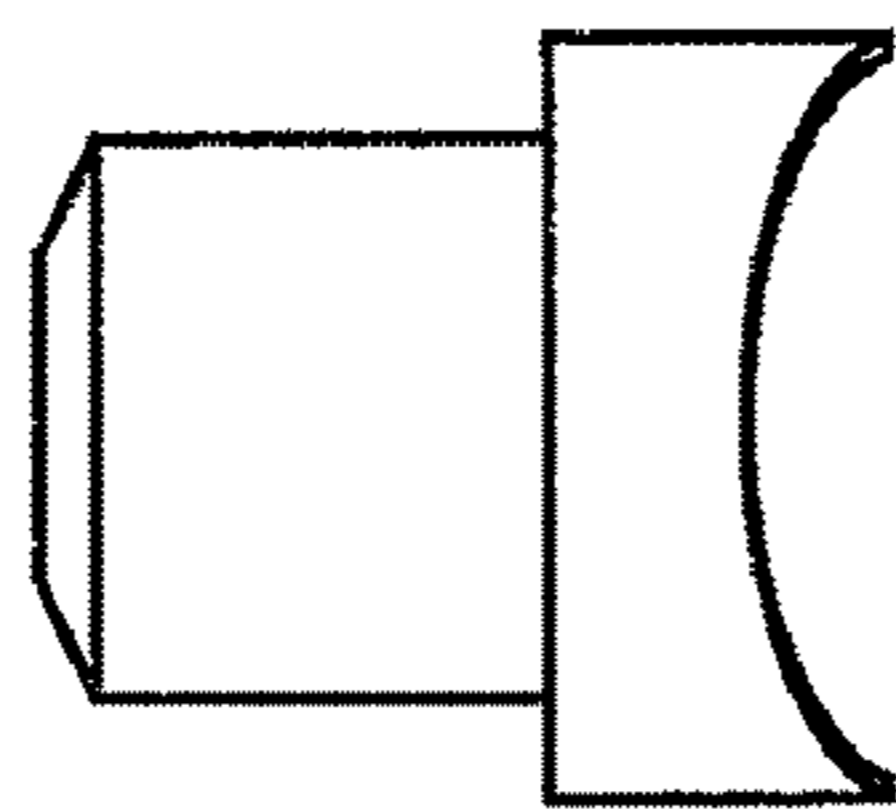

FIG. 3

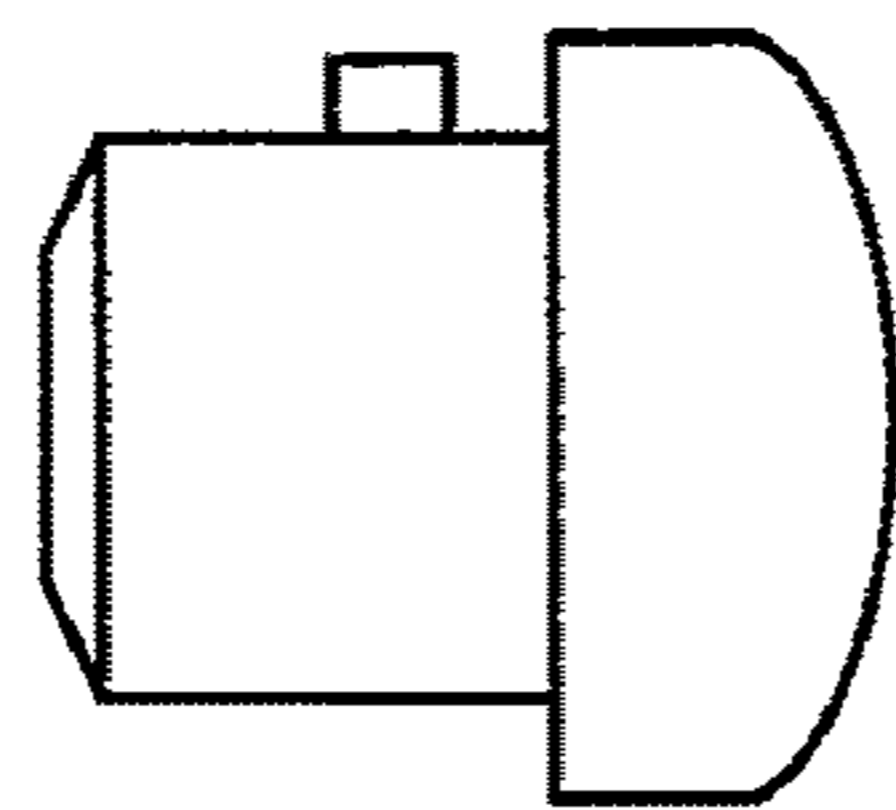

FIG. 4

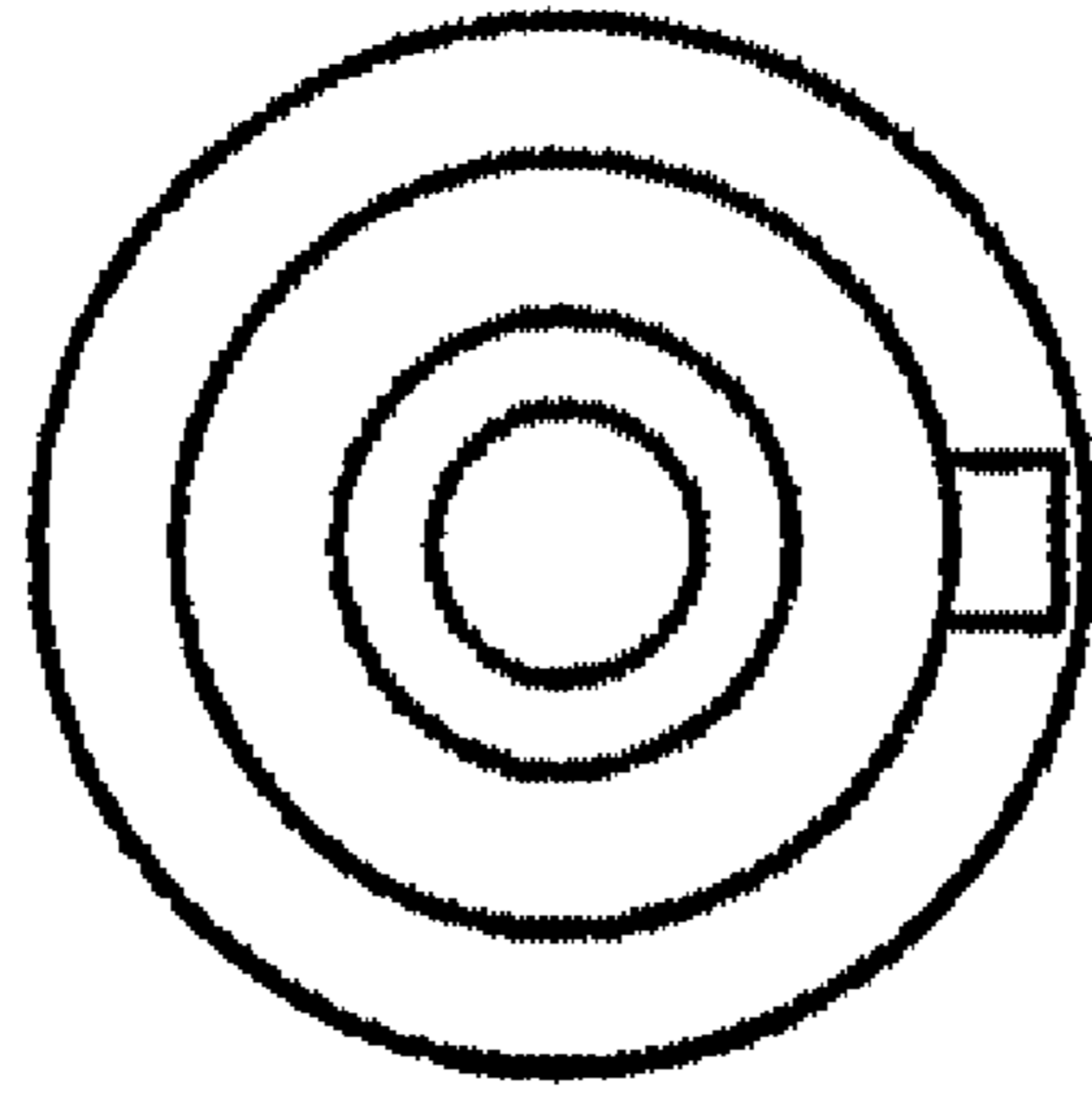

FIG. 5

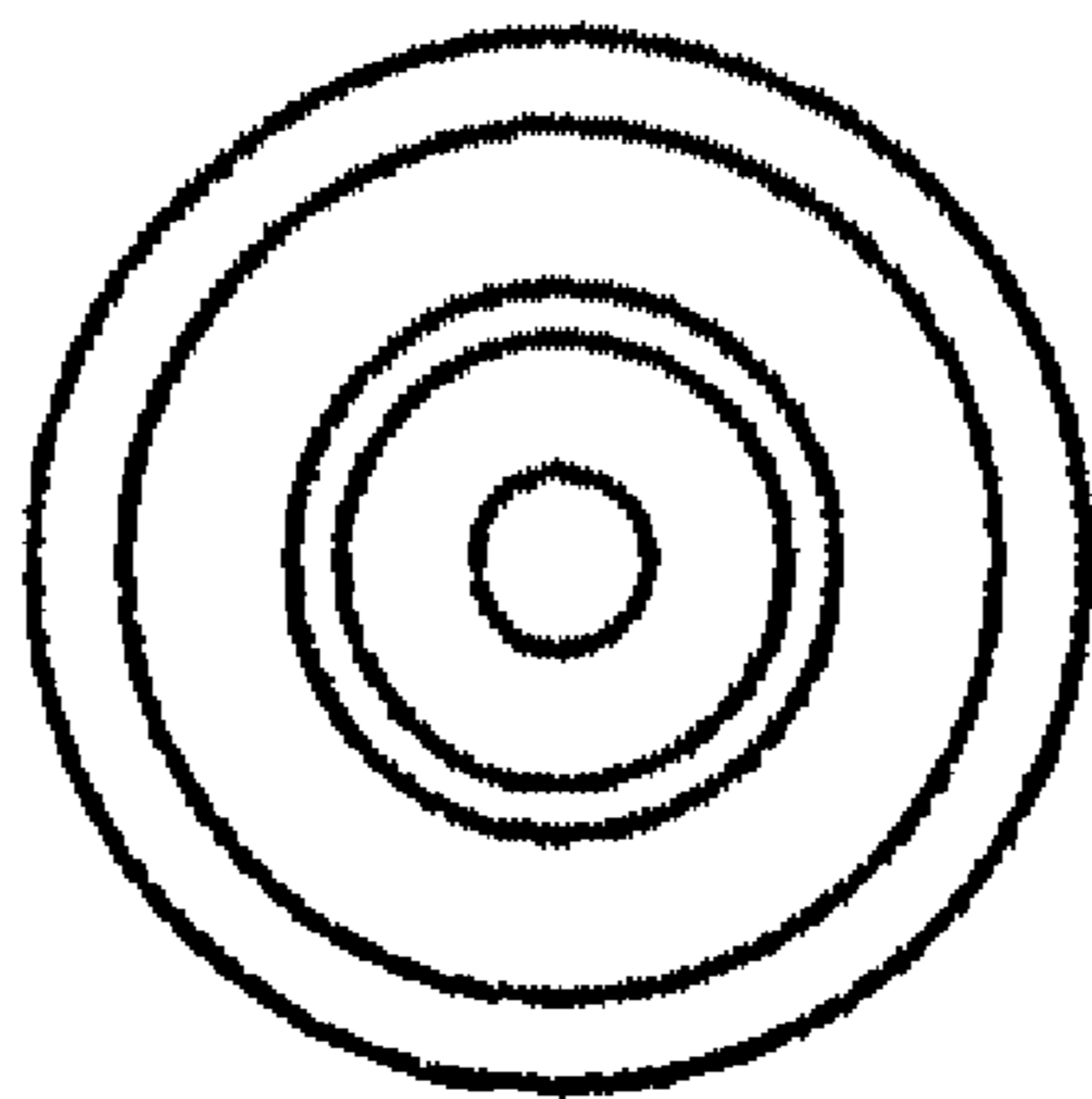

FIG. 6