



US00D646424S

(12) **United States Design Patent**
Ho

(10) **Patent No.:** **US D646,424 S**

(45) **Date of Patent:** **** Oct. 4, 2011**

(54) **WALL SCONCE**

(75) Inventor: **Jiun Ho**, San Francisco, CA (US)

(73) Assignee: **Boyd Lighting Fixture Company**, San Francisco, CA (US)

(**) Term: **14 Years**

(21) Appl. No.: **29/390,428**

(22) Filed: **Apr. 25, 2011**

(51) **LOC (9) Cl.** **26-03**

(52) **U.S. Cl.** **D26/85**

(58) **Field of Classification Search** D26/72,
D26/85, 87, 91; 362/147, 404-408, 432
See application file for complete search history.

(56) **References Cited**

U.S. PATENT DOCUMENTS

D320,668 S *	10/1991	von Kluck	D26/85
D323,906 S *	2/1992	Miranda et al.	D26/85
D324,742 S *	3/1992	von Kluck	D26/85
D379,549 S *	5/1997	Vargas, Jr.	D26/128
D405,910 S *	2/1999	Walz	D26/91
D422,373 S *	4/2000	Tihany	D26/85
D584,440 S *	1/2009	Allen	D26/76
D590,088 S *	4/2009	Dworschak	D26/85
D606,700 S *	12/2009	Sabernig	D26/85
D608,488 S *	1/2010	Miranda	D26/87
D609,388 S *	2/2010	Sabernig	D26/85

D638,977 S * 5/2011 Heyrman D26/85
* cited by examiner

Primary Examiner — Clare E Heflin

(74) *Attorney, Agent, or Firm* — Heslin Rothenberg Farley & Mesiti P.C.

(57) **CLAIM**

The ornamental design for a wall sconce, as shown and described.

DESCRIPTION

FIG. 1 is a perspective view of one embodiment of a wall sconce in accordance with one aspect of the new design; FIG. 2 is a front elevational view thereof; FIG. 3 is a right elevational view thereof; FIG. 4 is a left elevational view thereof; FIG. 5 is a bottom view thereof; FIG. 6 is a perspective view of another embodiment of a wall sconce having translucent portions in accordance with another aspect of the new design; FIG. 7 is a front elevational view thereof; FIG. 8 is a right elevational view thereof; FIG. 9 is a left elevational view thereof; and, FIG. 10 is a bottom view thereof. The rear surface of the wall sconce is devoid of surface ornamentation and forms no part of the claimed design.

1 Claim, 10 Drawing Sheets

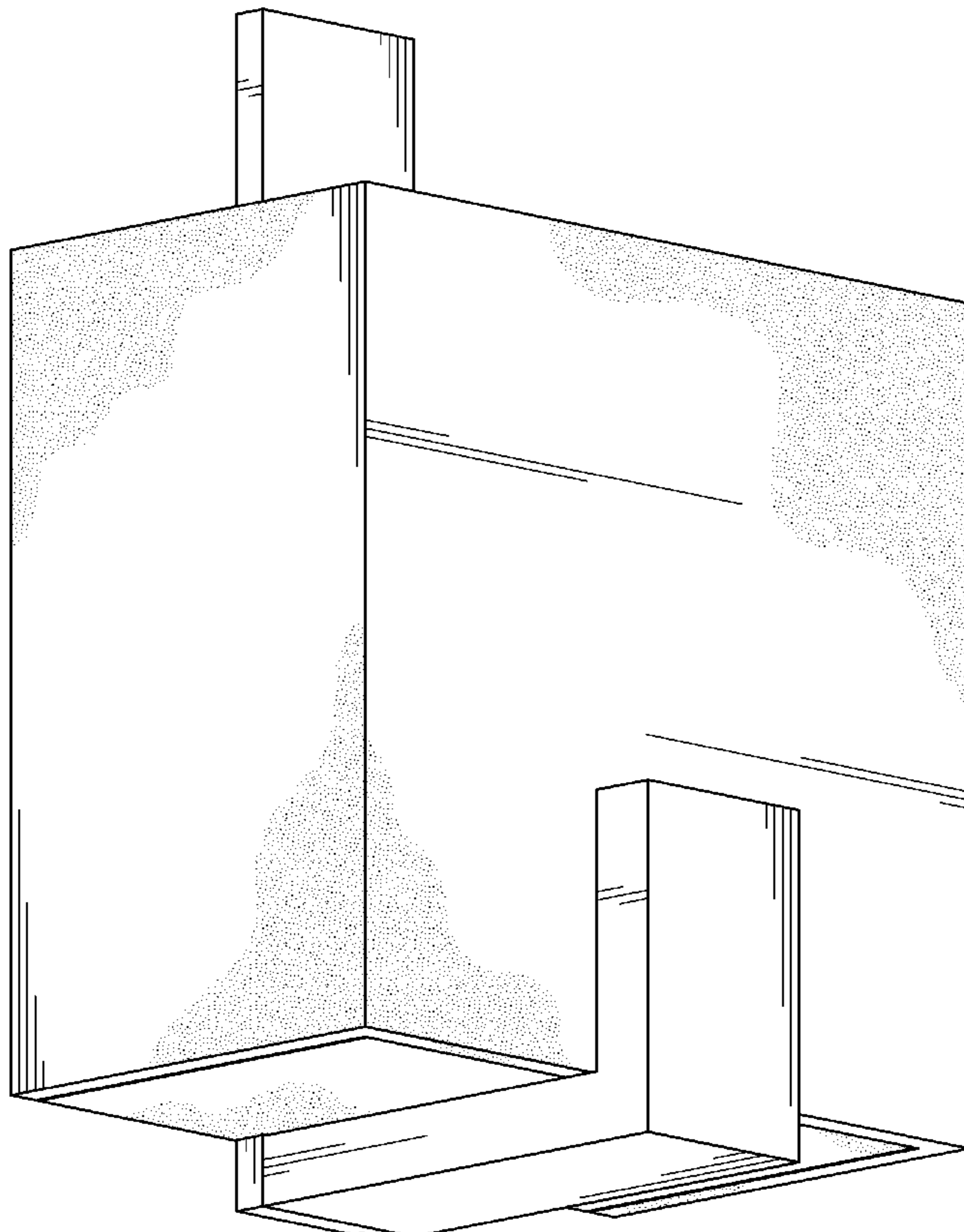

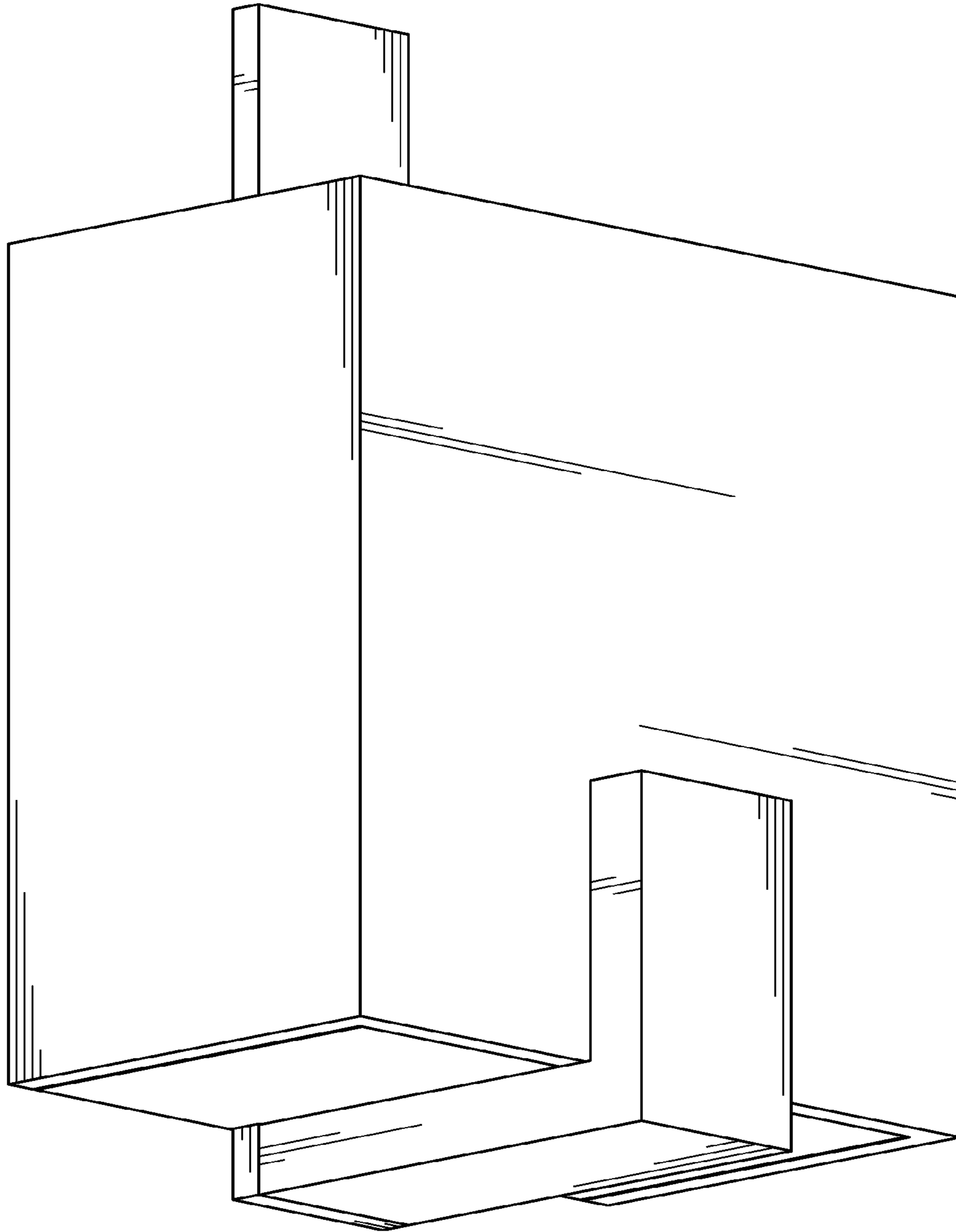

FIG. 1

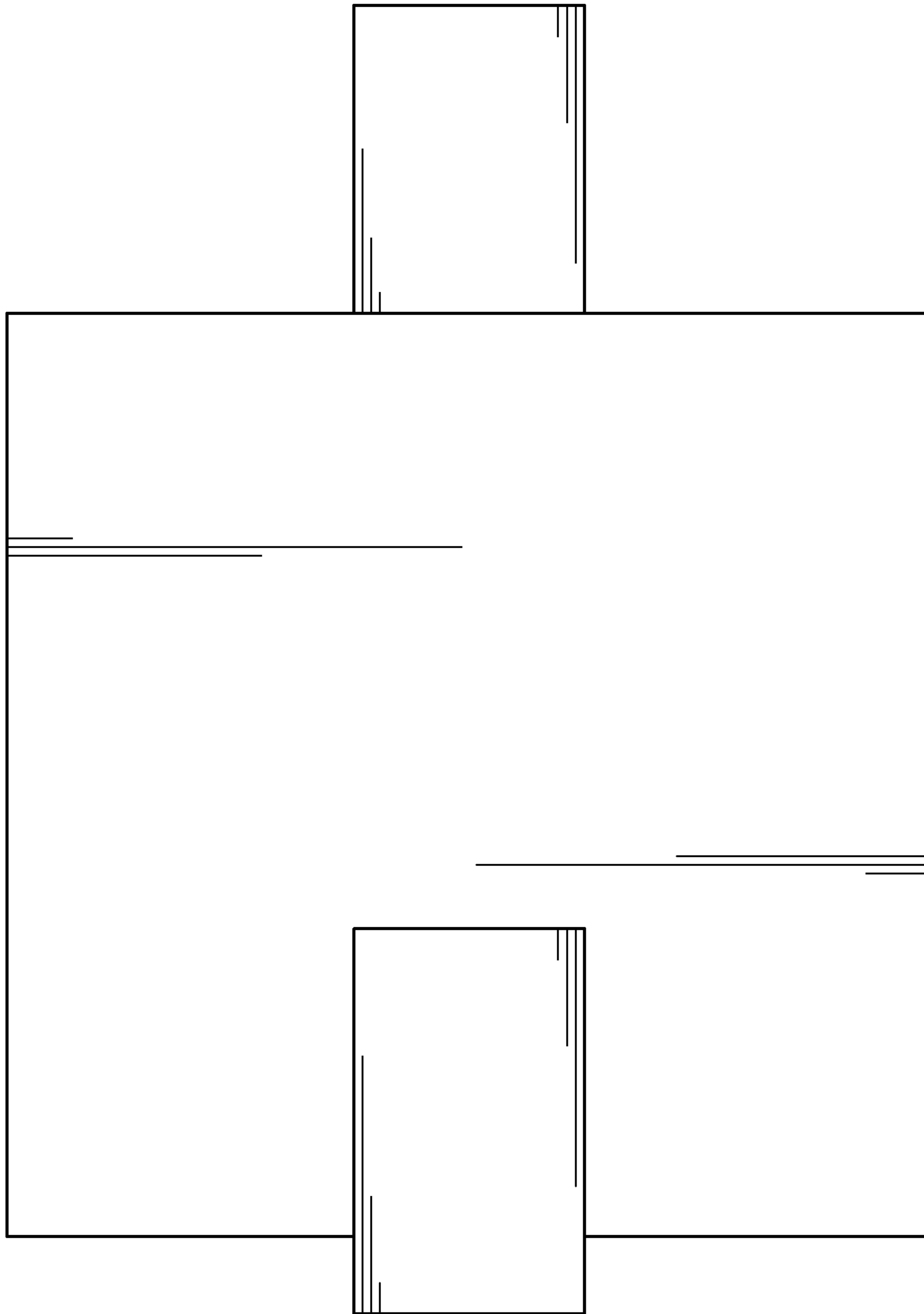

FIG. 2

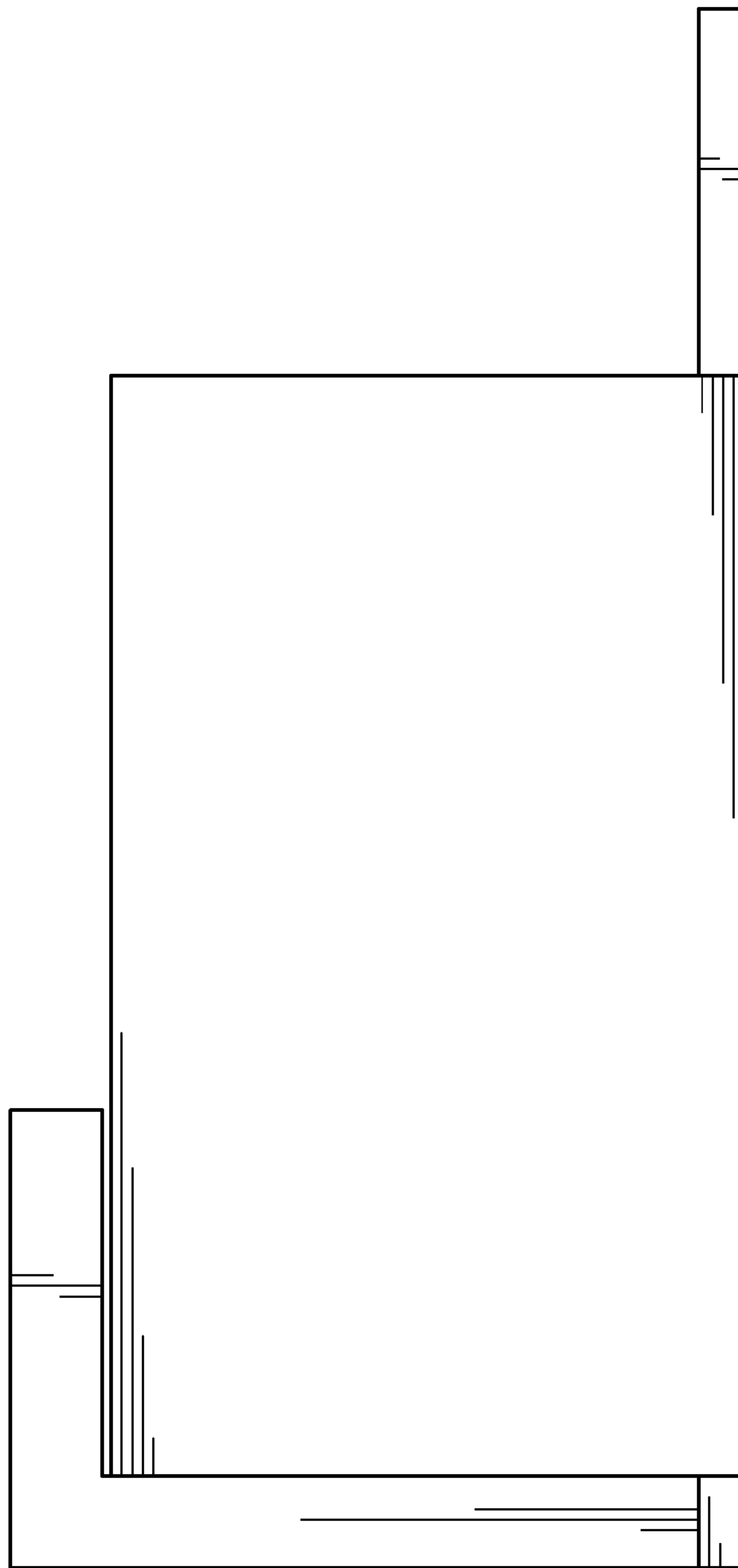

FIG. 3

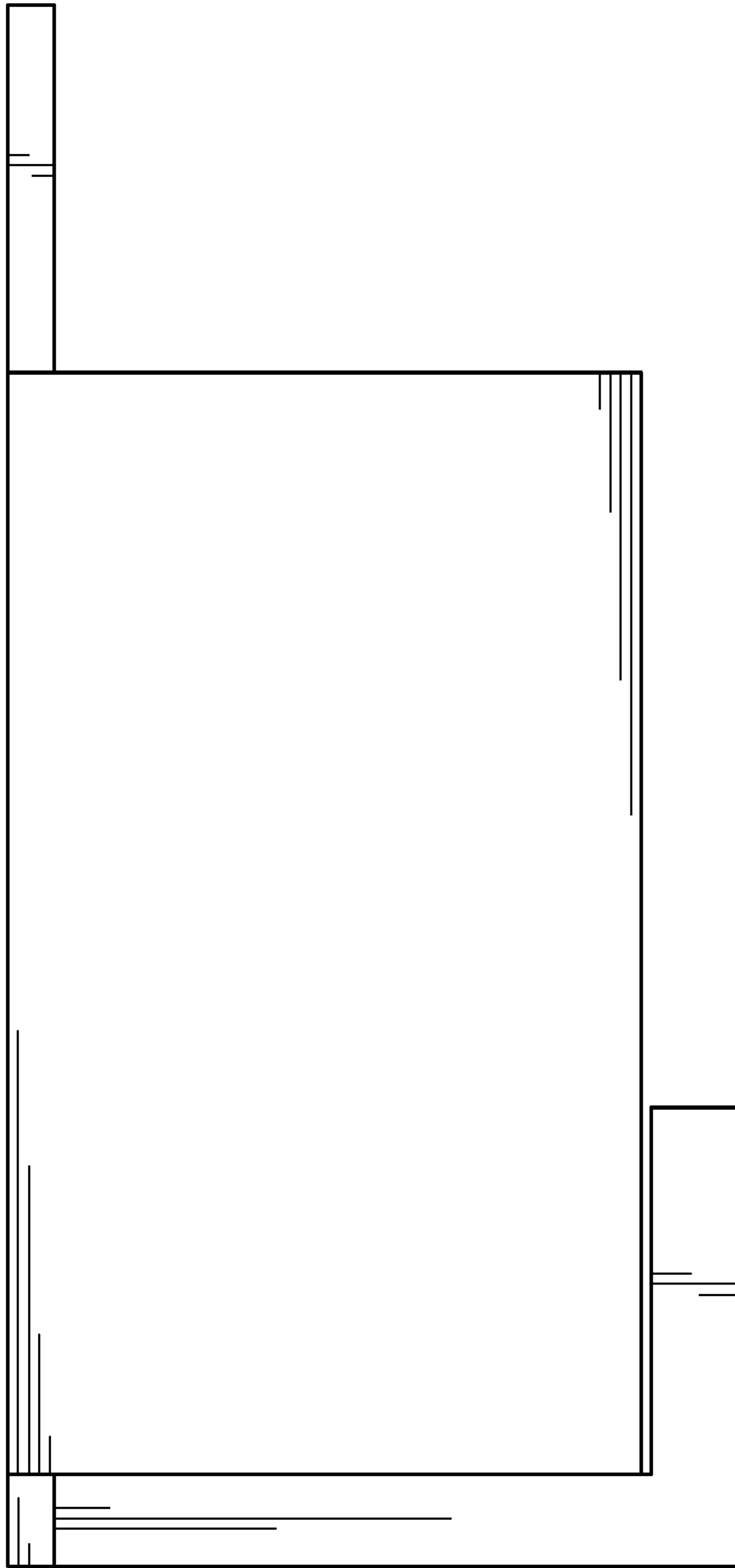

FIG. 4

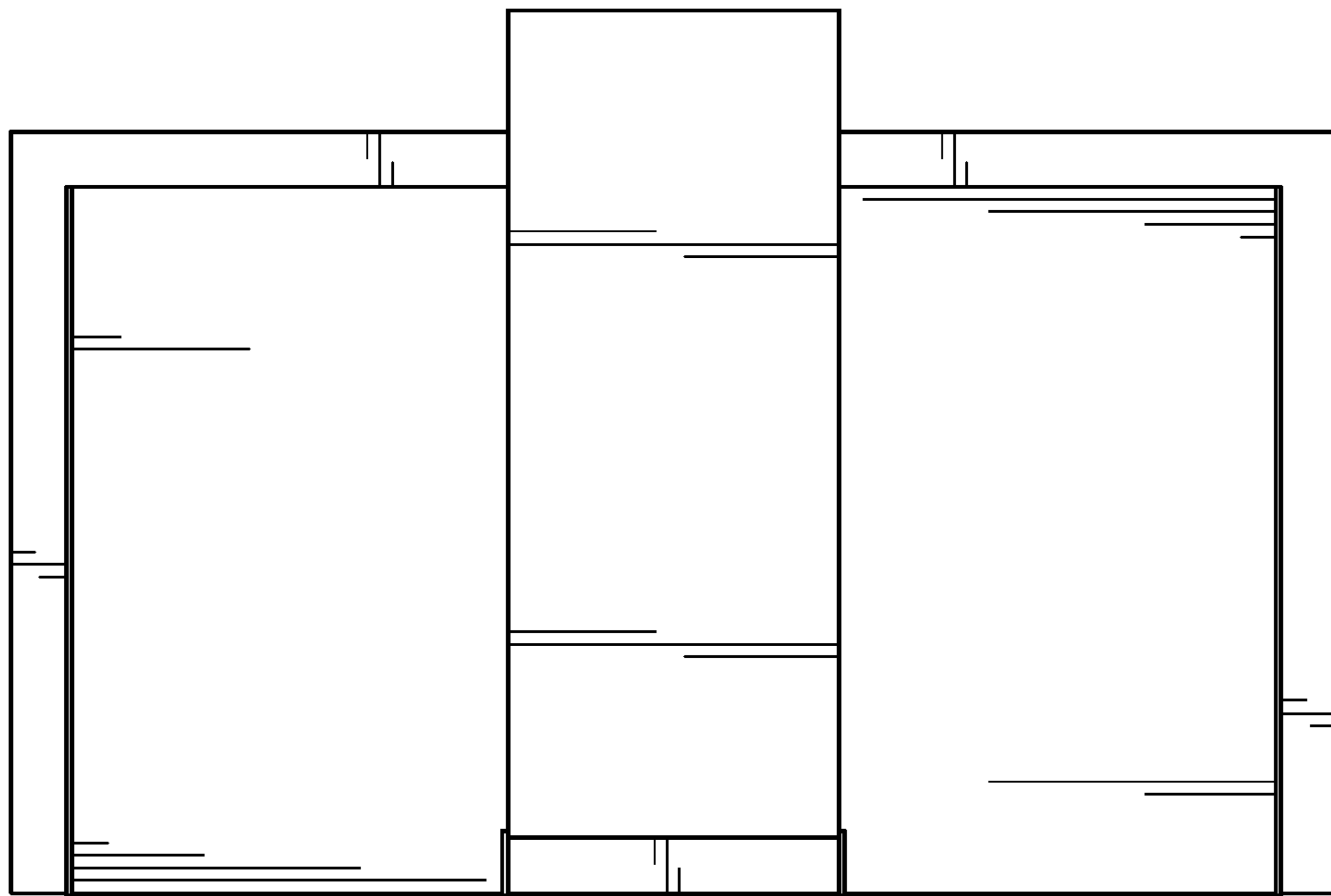

FIG. 5

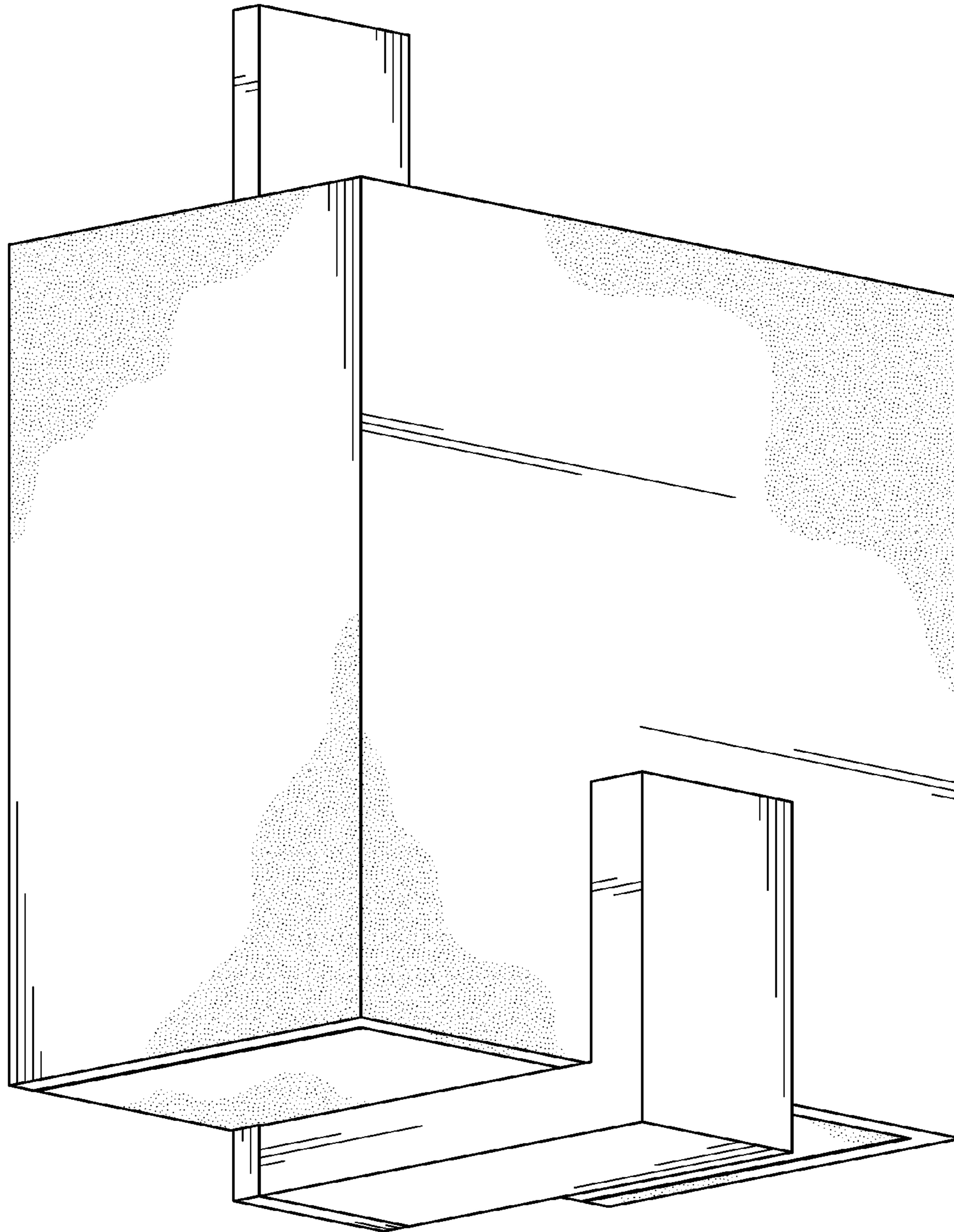

FIG. 6

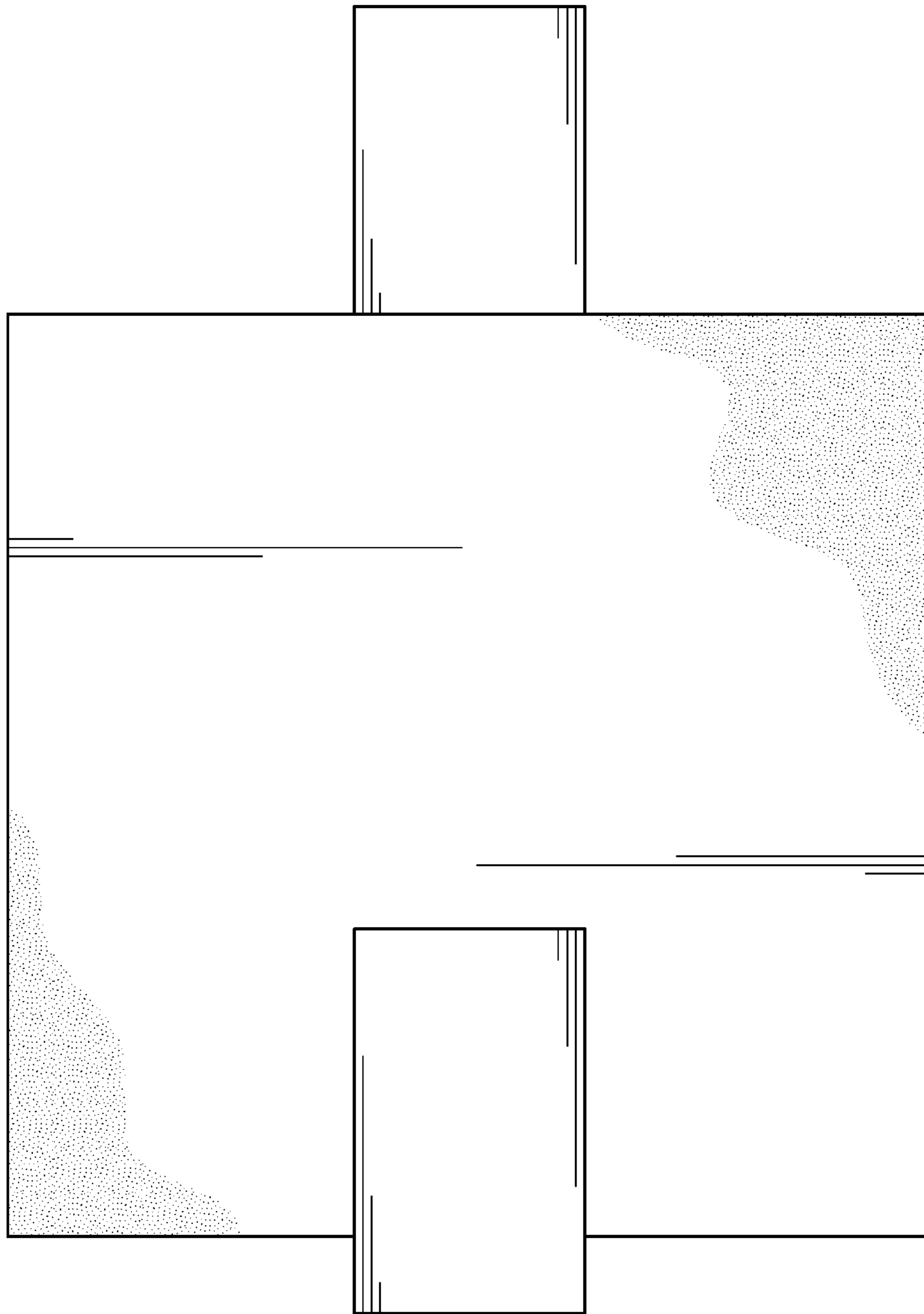

FIG. 7

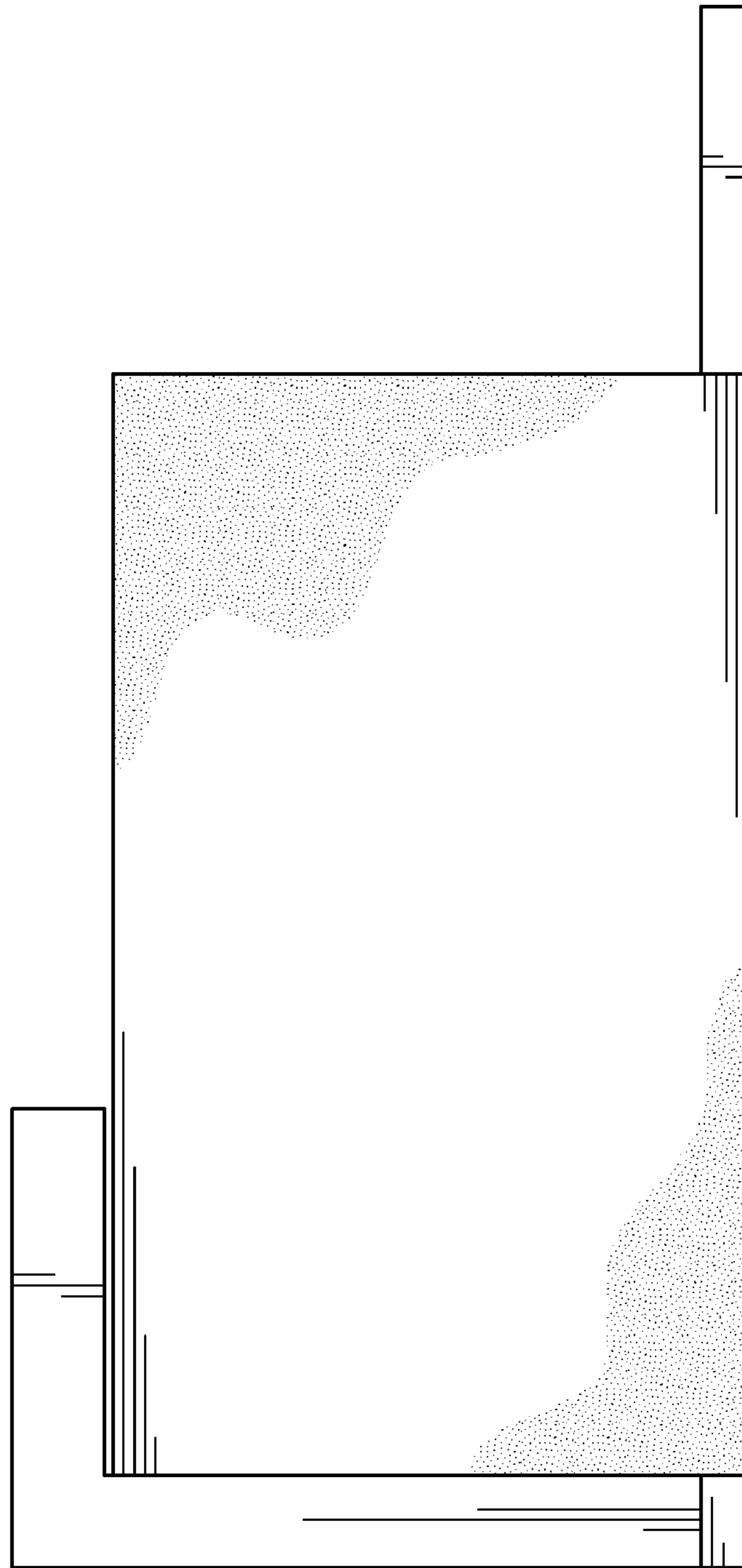

FIG. 8

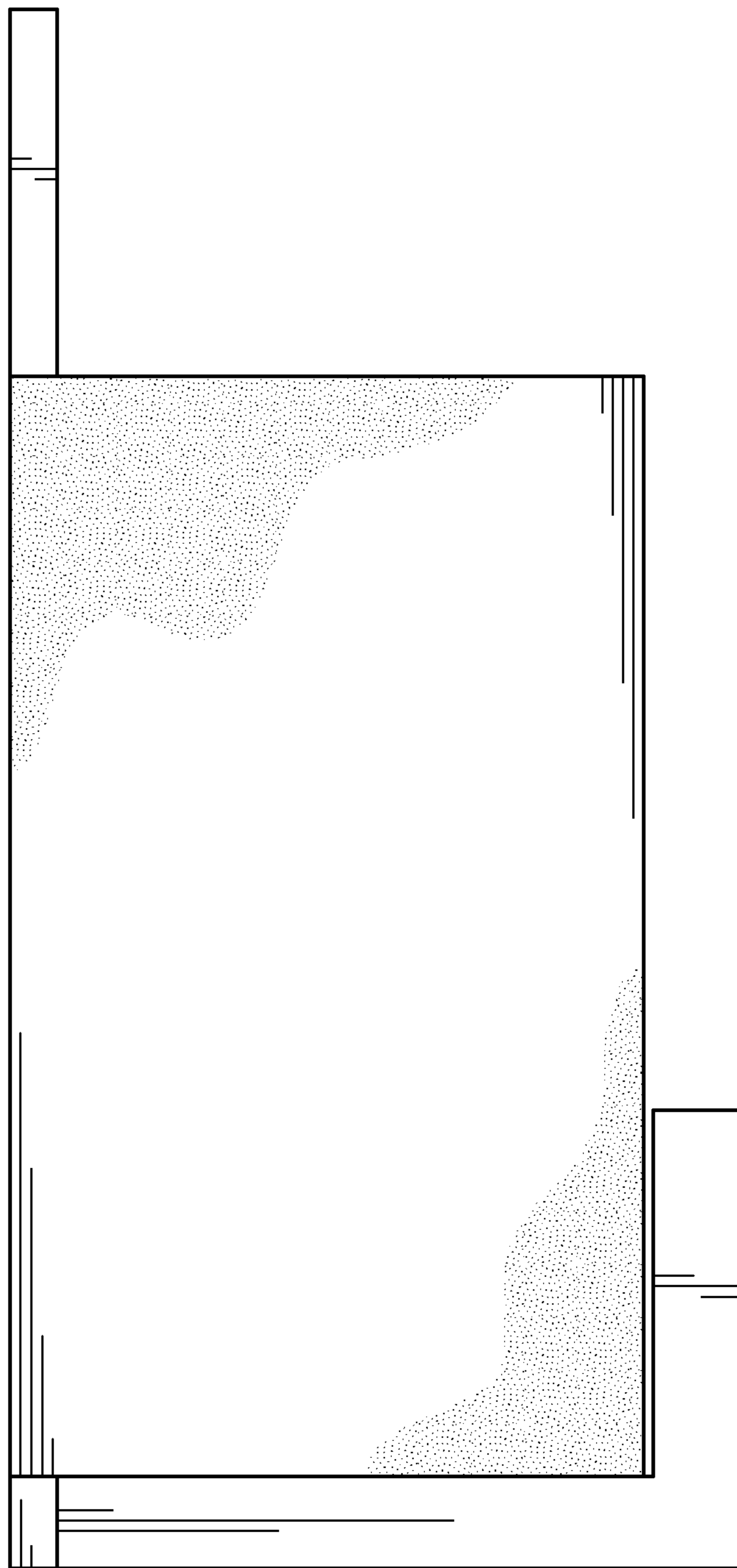

FIG. 9

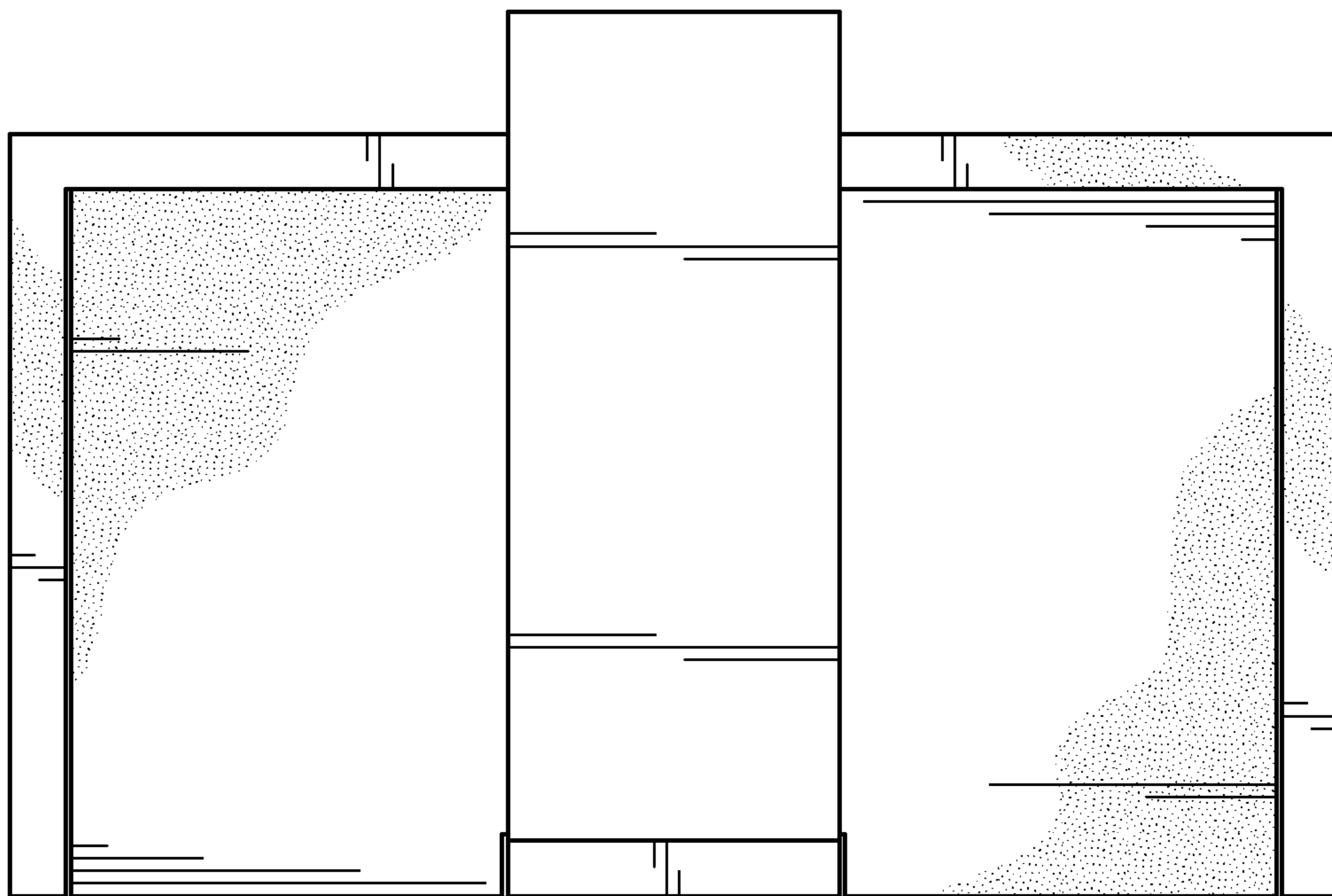

FIG. 10