



US00D645930S

(12) **United States Design Patent**
Pearce

(10) **Patent No.:** **US D645,930 S**

(45) **Date of Patent:** **** Sep. 27, 2011**

(54) **SLING PLATE**

(76) **Inventor:** **Craig M. Pearce**, Evansville, IN (US)

(**) **Term:** **14 Years**

(21) **Appl. No.:** **29/348,053**

(22) **Filed:** **Nov. 20, 2009**

(51) **LOC (9) Cl.** **22-01**

(52) **U.S. Cl.** **D22/108**

(58) **Field of Classification Search** D22/108;
D29/101.1, 101.2; D3/214, 215, 221, 262,
D3/327-328; 42/84, 94; 224/149, 150, 157-160,
224/190, 250, 257, 586, 913

See application file for complete search history.

(56) **References Cited**

U.S. PATENT DOCUMENTS

D495,870 S * 9/2004 Verdugo D3/215
D525,336 S * 7/2006 Esch D22/108
D568,957 S * 5/2008 Esch D22/108

* cited by examiner

Primary Examiner — T. Chase Nelson

Assistant Examiner — Michael A Pratt

(74) *Attorney, Agent, or Firm* — Gary K. Price

(57) **CLAIM**

The ornamental design for a sling plate, as shown and described.

DESCRIPTION

FIG. 1 is a top perspective view of my sling plate.

FIG. 2 is a top view of my design.

FIG. 3 is a side view of my design; and,

FIG. 4 is a rear partial view of my design.

1 Claim, 4 Drawing Sheets

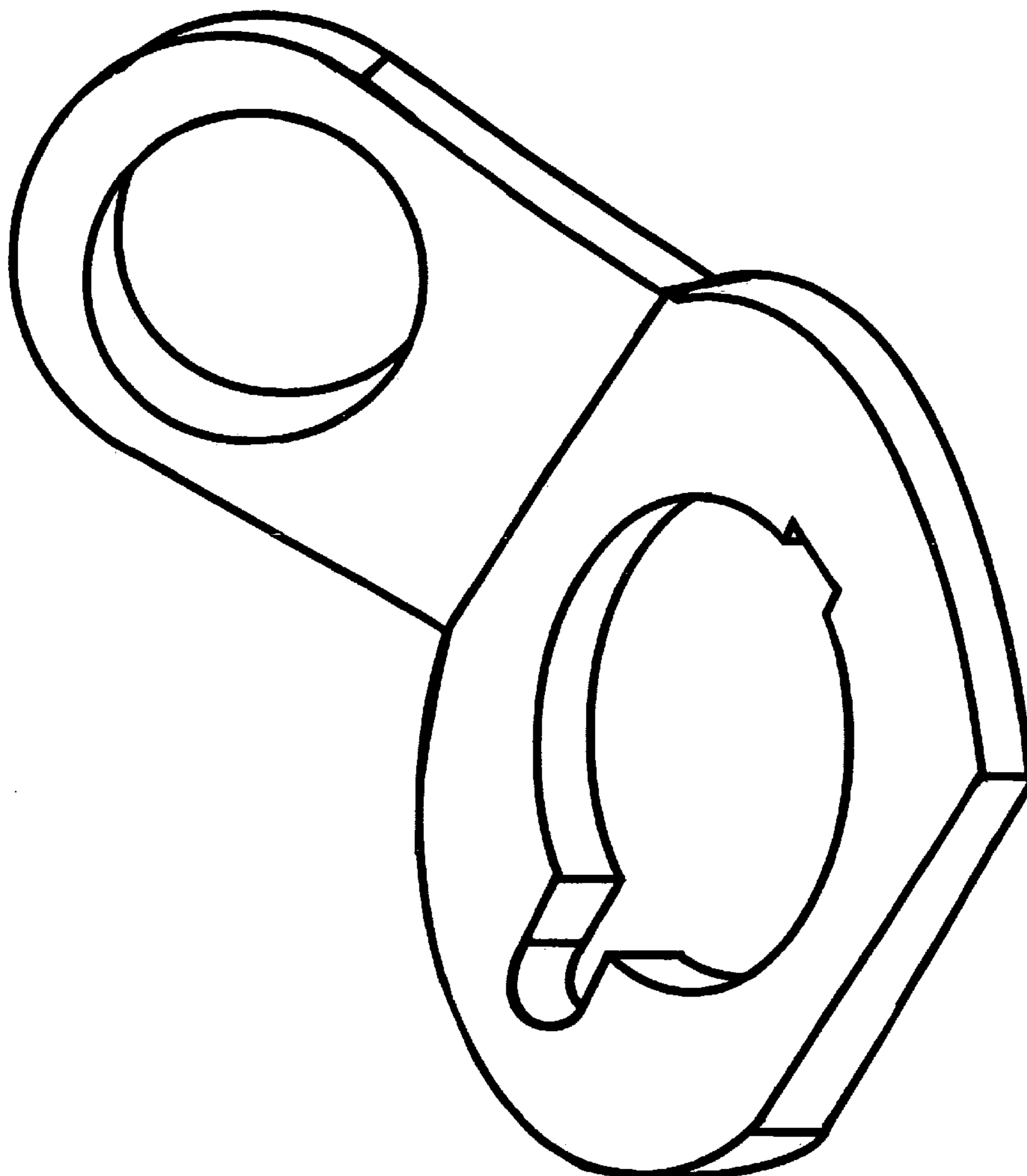

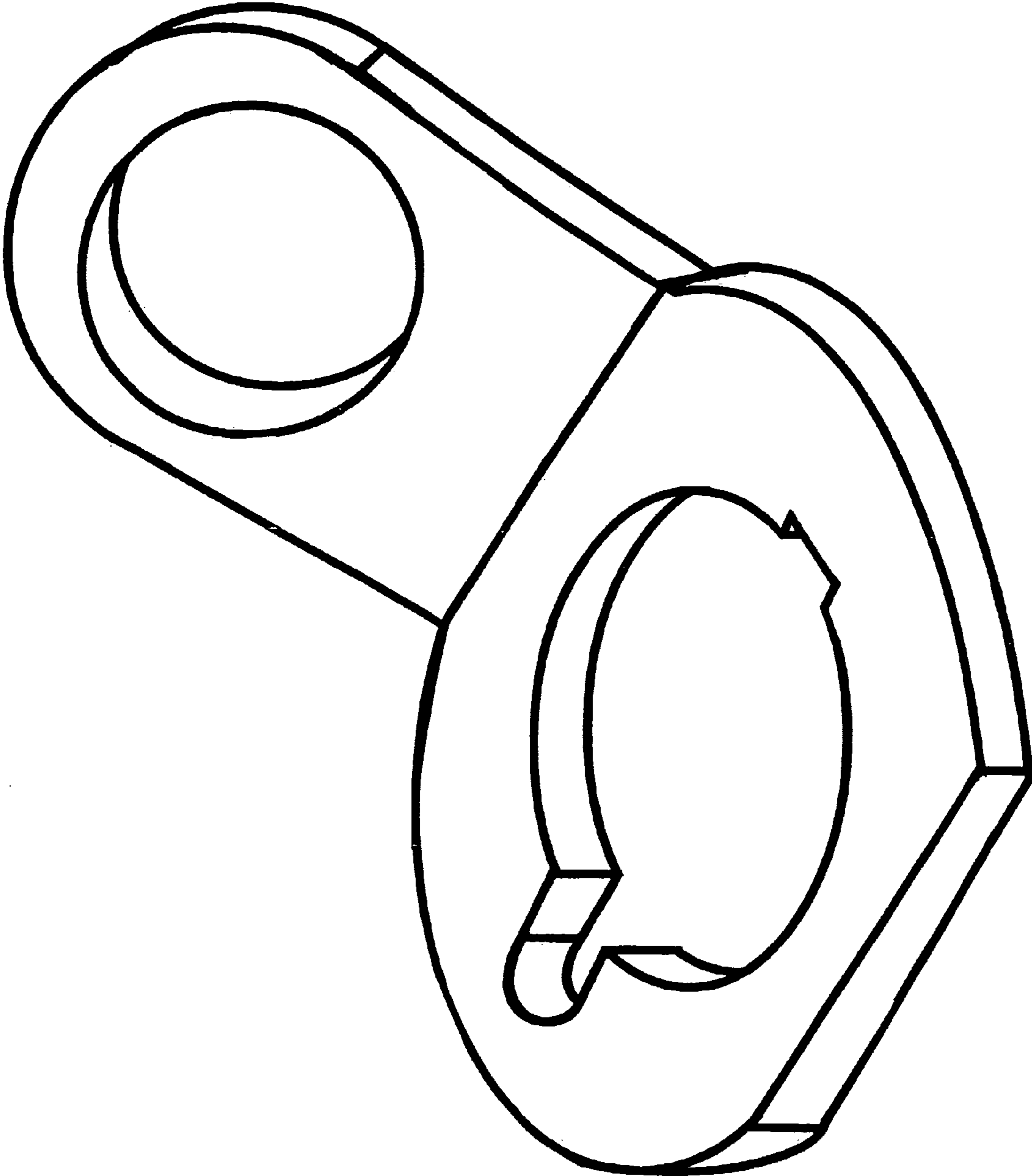

FIG. 1

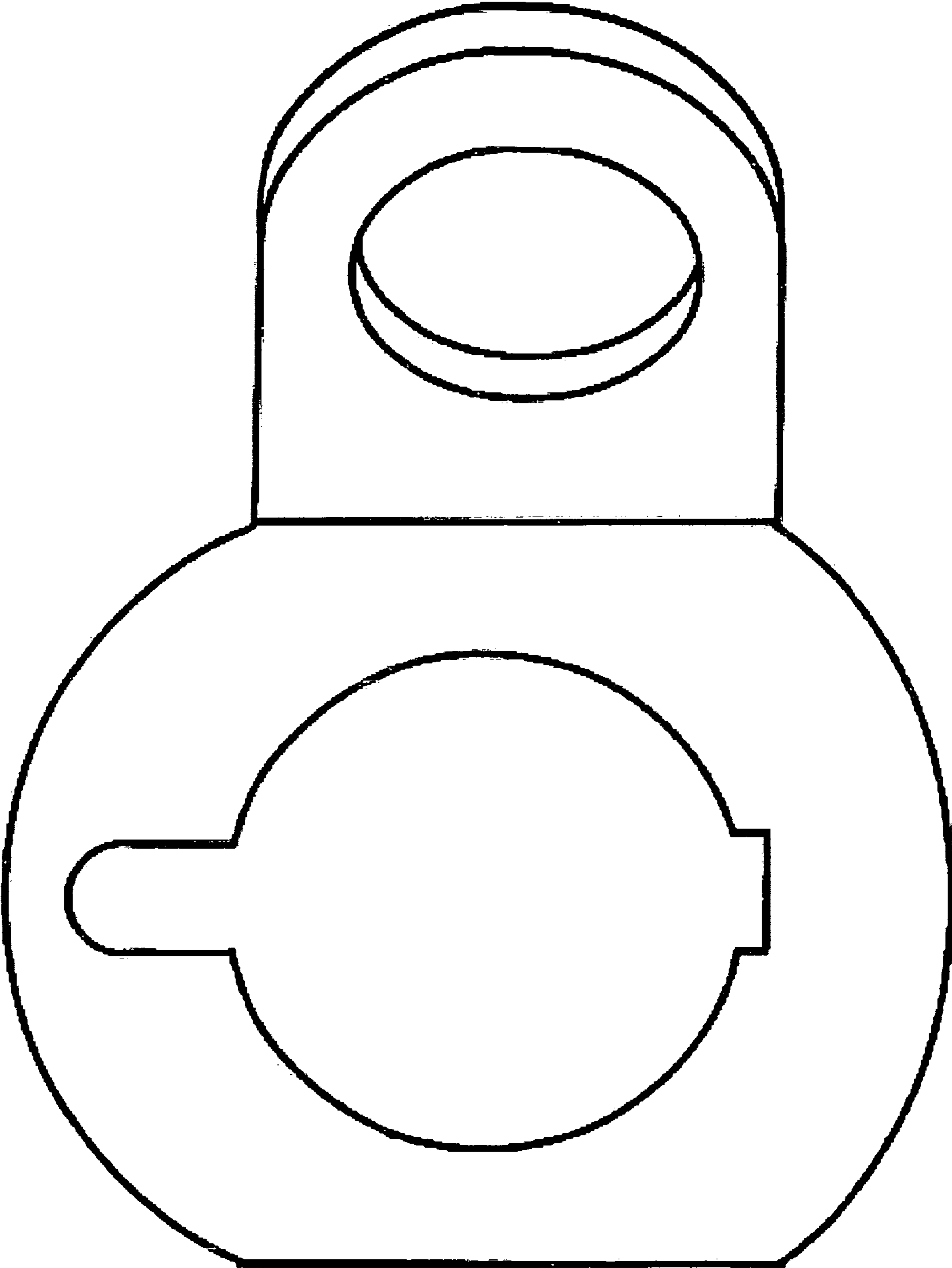

FIG. 2

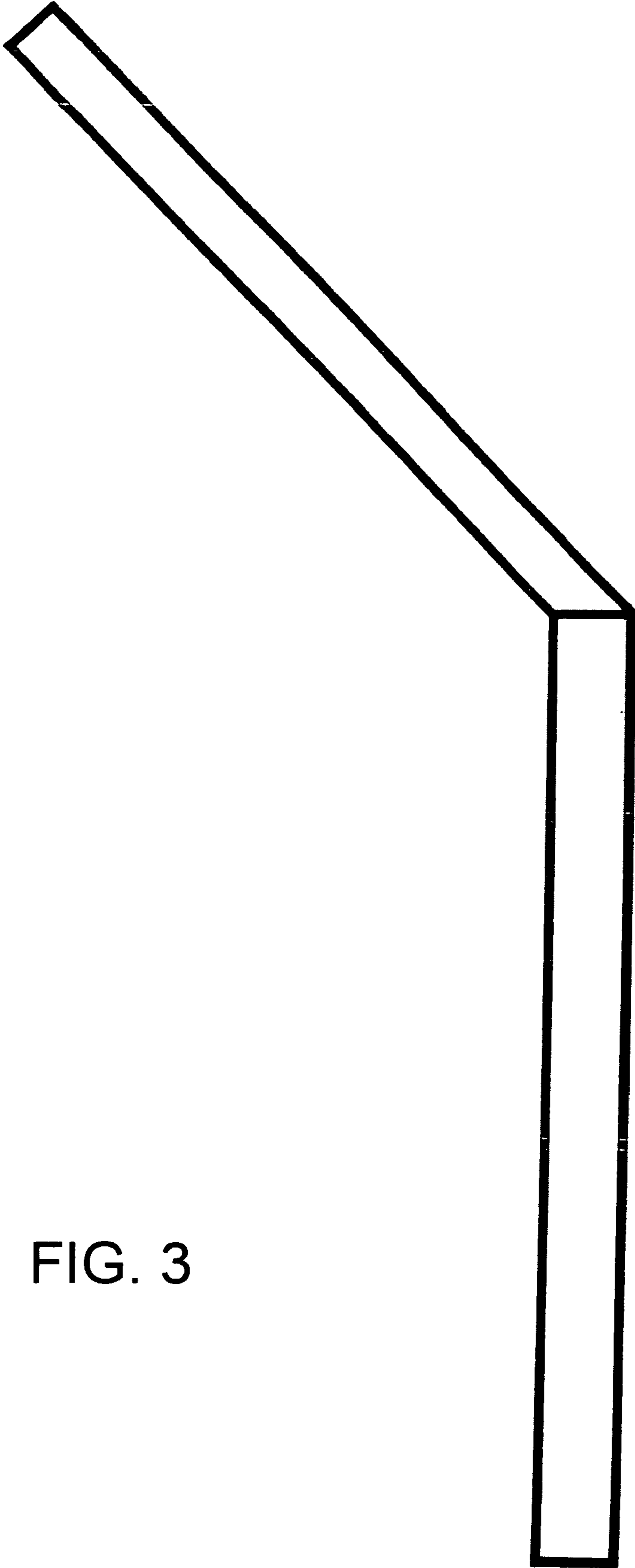

FIG. 3

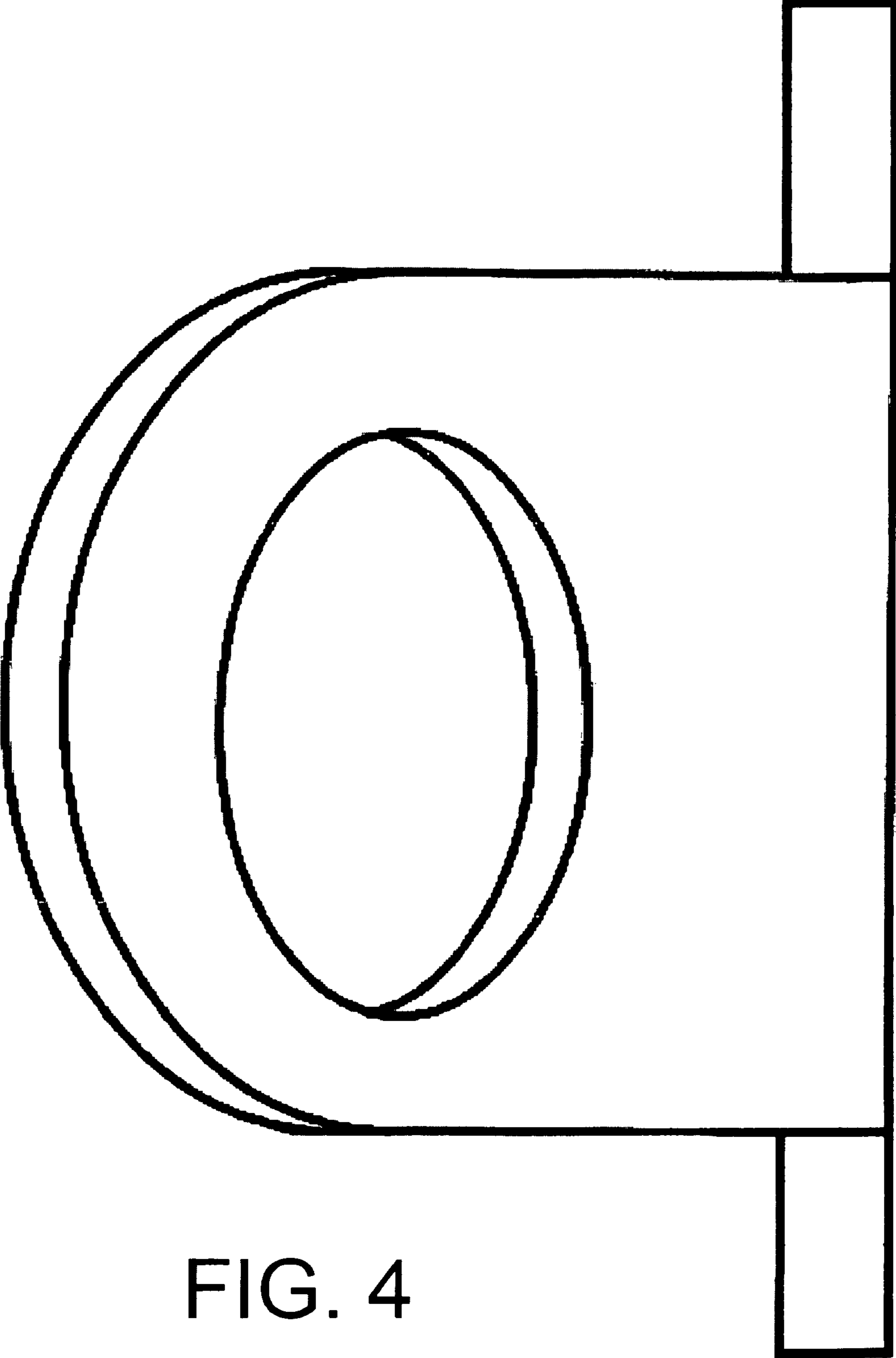

FIG. 4