



US00D644827S

(12) **United States Design Patent**  
**Lee**

(10) **Patent No.:** **US D644,827 S**  
(45) **Date of Patent:** **\*\* Sep. 13, 2011**

(54) **SHOE OUTSOLE**

(75) Inventor: **Sangmin Lee**, Portland, OR (US)

(73) Assignee: **Columbia Sportswear North America, Inc.**, Portland, OR (US)

(\*\*) Term: **14 Years**

(21) Appl. No.: **29/338,125**

(22) Filed: **Jun. 4, 2009**

(51) **LOC (9) Cl.** ..... **02-04**

(52) **U.S. Cl.** ..... **D2/959; D2/951**

(58) **Field of Classification Search** ..... D2/902,  
D2/906, 908, 916, 918, 925, 946, 947, 951-954,  
D2/956-962, 977; 36/3 B, 22 R, 24.5, 25 R,  
36/28, 32 R, 34 R, 59 C, 67 A, 103  
See application file for complete search history.

(56) **References Cited**

**U.S. PATENT DOCUMENTS**

D396,947 S *	8/1998	Serna	.....	D2/959
7,055,265 B1 *	6/2006	Bathum et al.	.....	36/3 B
D543,679 S *	6/2007	Edwards	.....	D2/959
D549,432 S *	8/2007	McClaskie	.....	D2/958

D569,594 S *	5/2008	Horne et al.	.....	D2/958
D573,334 S *	7/2008	Petrie	.....	D2/954
D619,344 S *	7/2010	Favreau et al.	.....	D2/957
D631,646 S *	2/2011	Muller	.....	D2/954

\* cited by examiner

*Primary Examiner* — T. Chase Nelson

(74) *Attorney, Agent, or Firm* — Schwabe, Williamson & Wyatt, P.C.

(57) **CLAIM**

I claim the ornamental design for a shoe outsole, as shown and described.

**DESCRIPTION**

FIG. 1 is a right front perspective view of a shoe outsole showing the claimed design;  
FIG. 2 is a left rear perspective view thereof;  
FIG. 3 is a front elevational view thereof;  
FIG. 4 is a front elevational view of the claimed design shown in an alternate broken line environment; and,  
FIG. 5 is a right front perspective view of the design as depicted in FIG. 4.

Throughout the views, the broken lines depict environmental structure that forms no part of the claimed design.

**1 Claim, 3 Drawing Sheets**

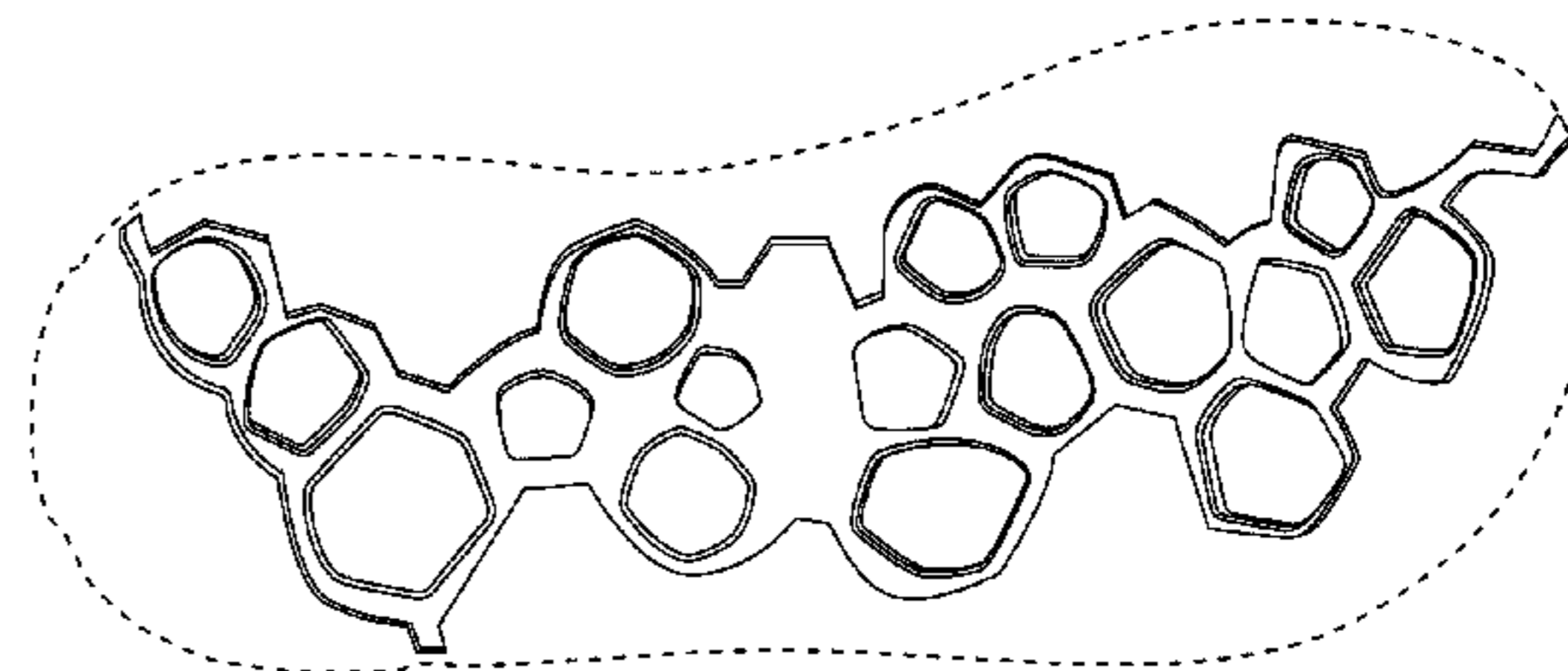
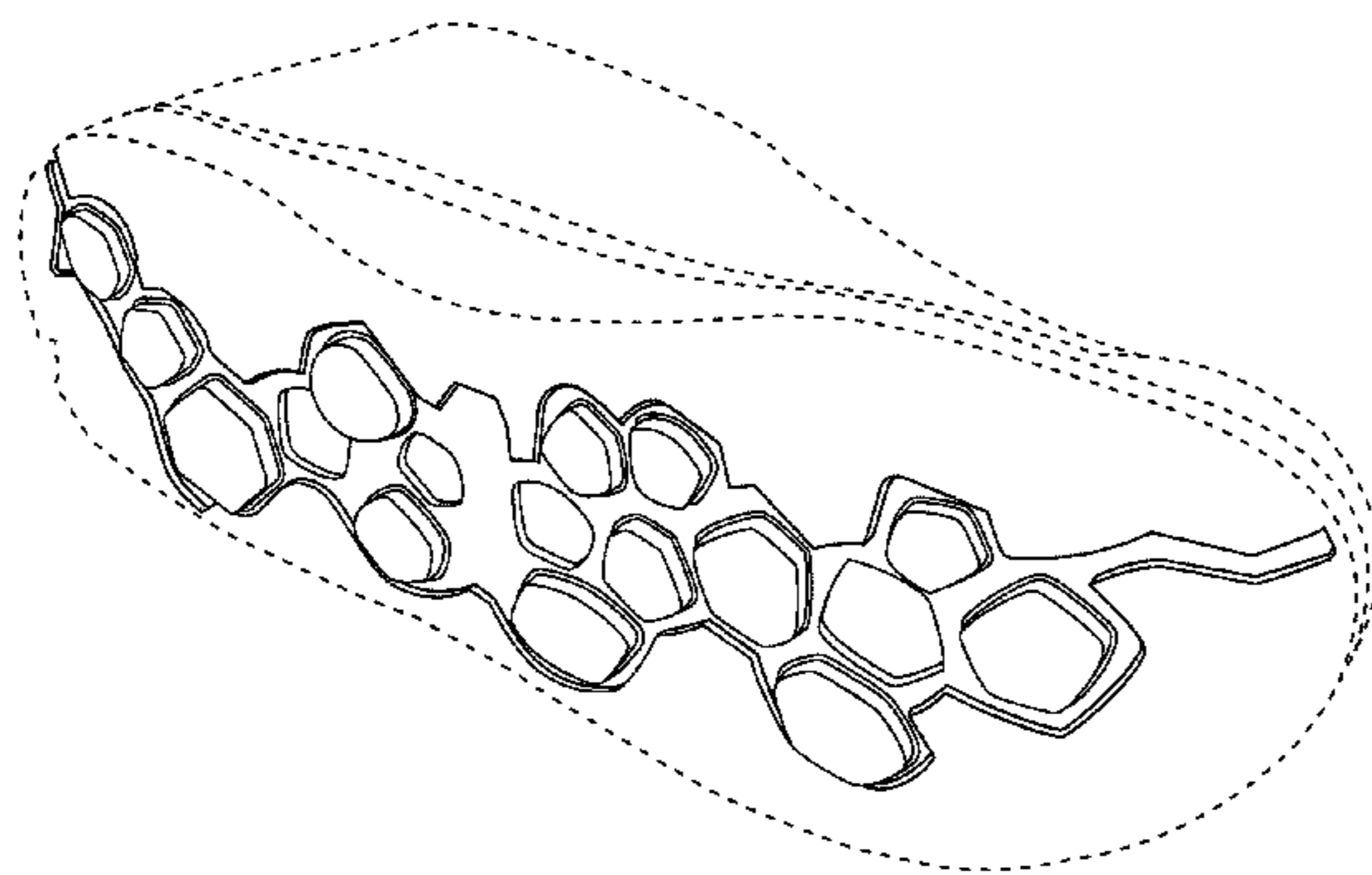

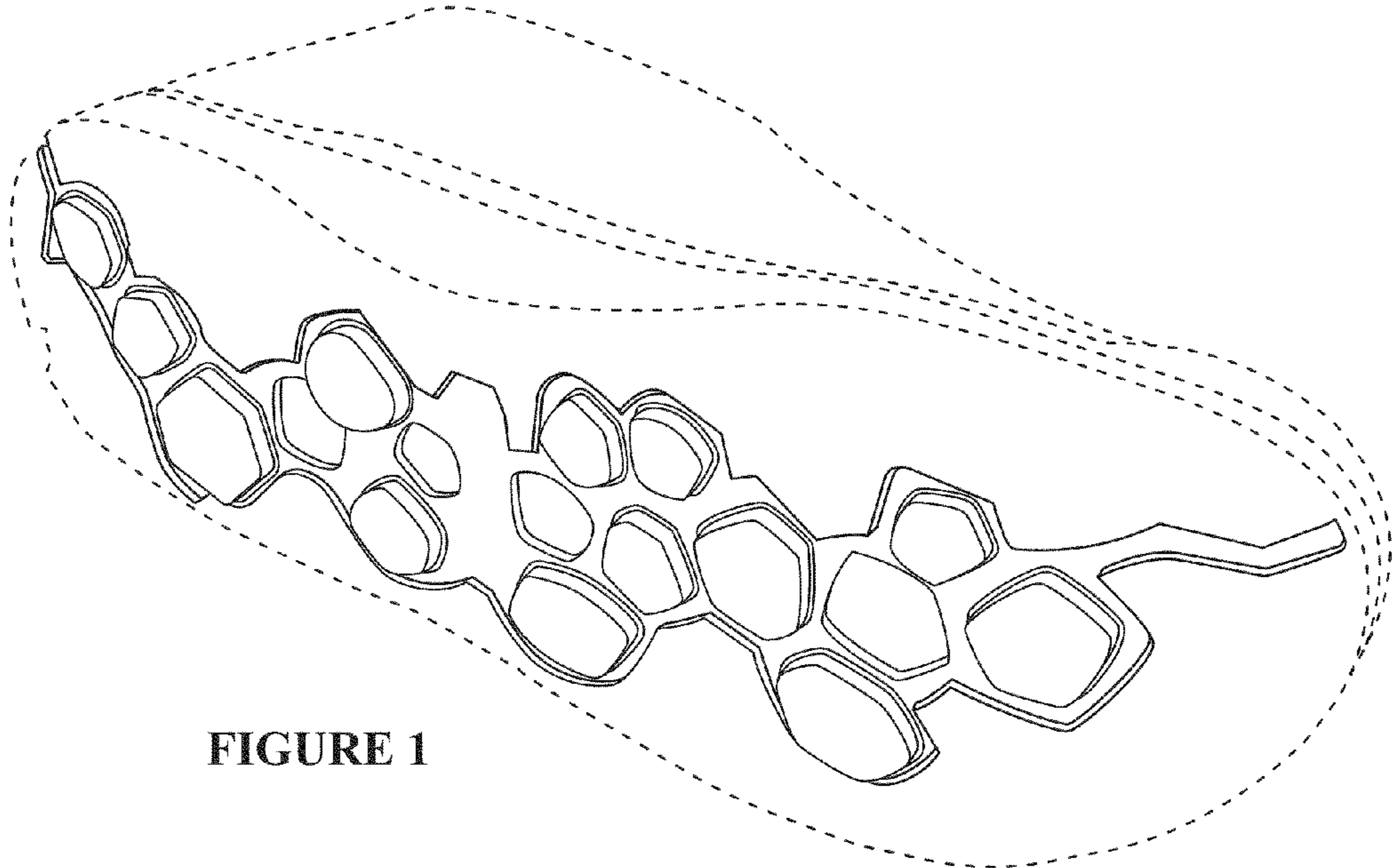

FIGURE 1

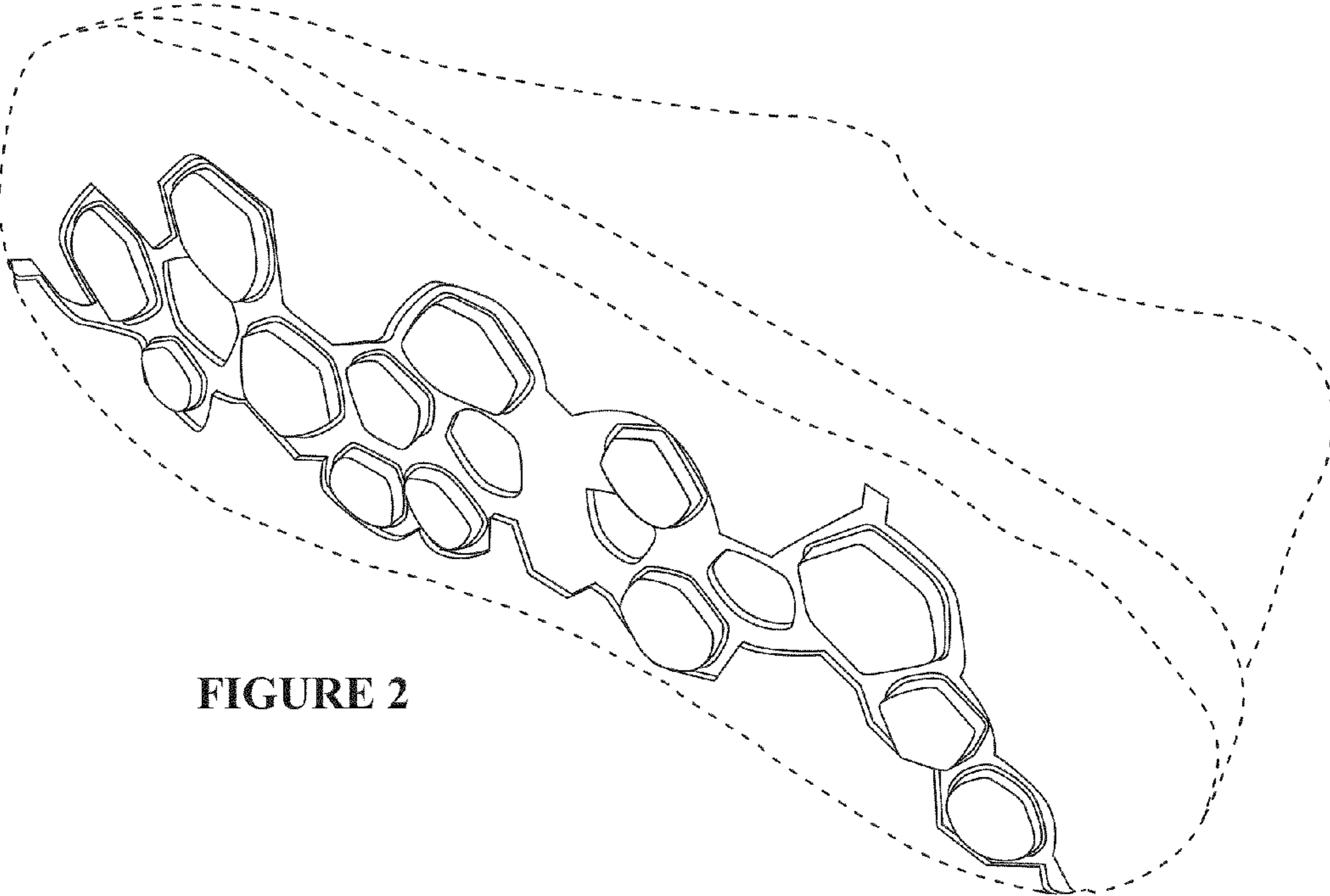

FIGURE 2

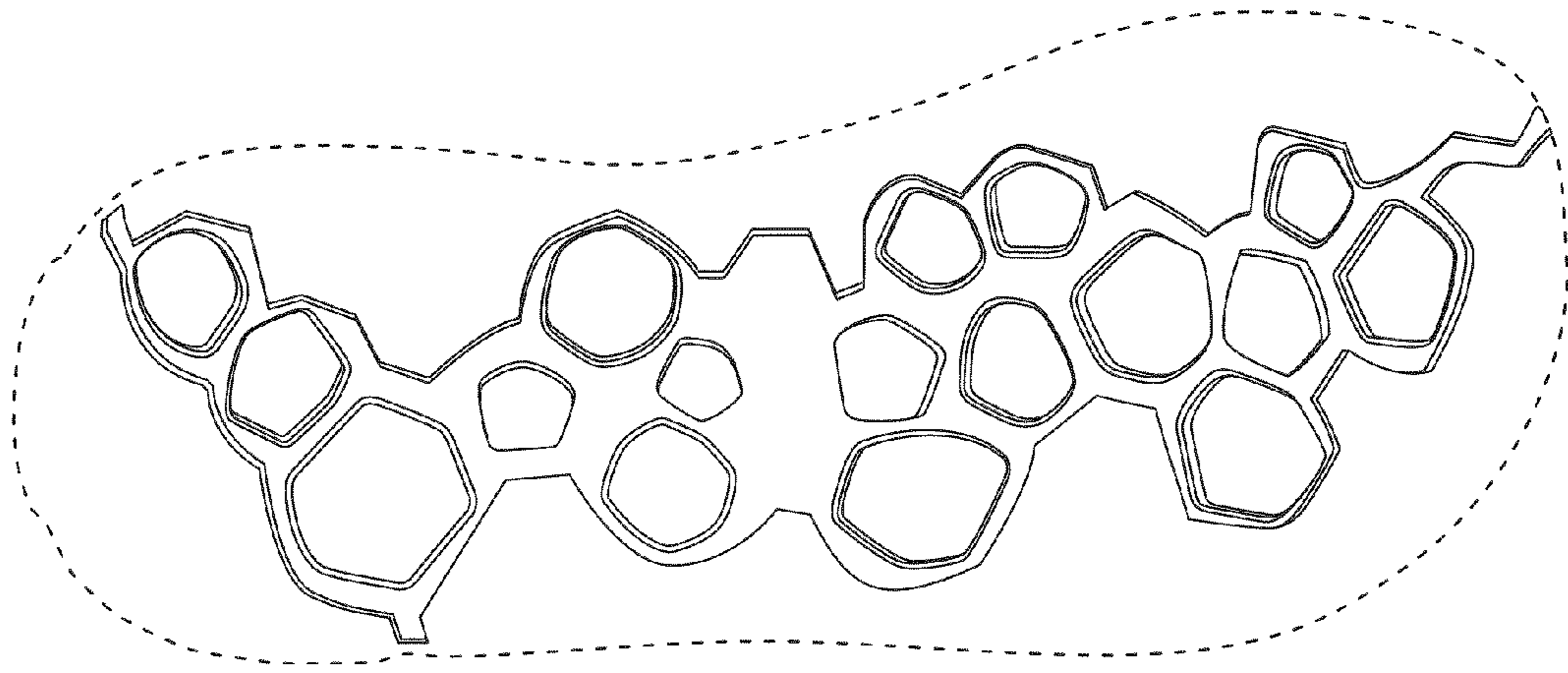

FIGURE 3

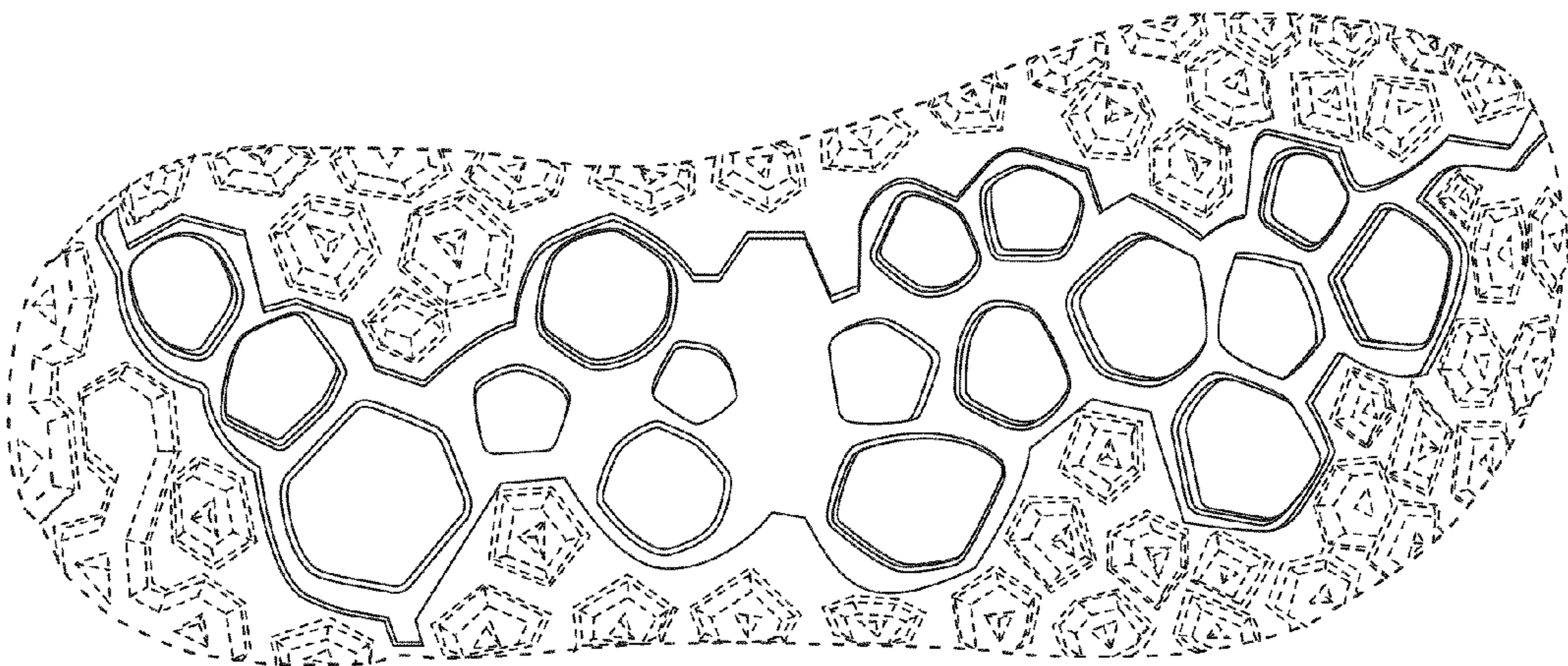
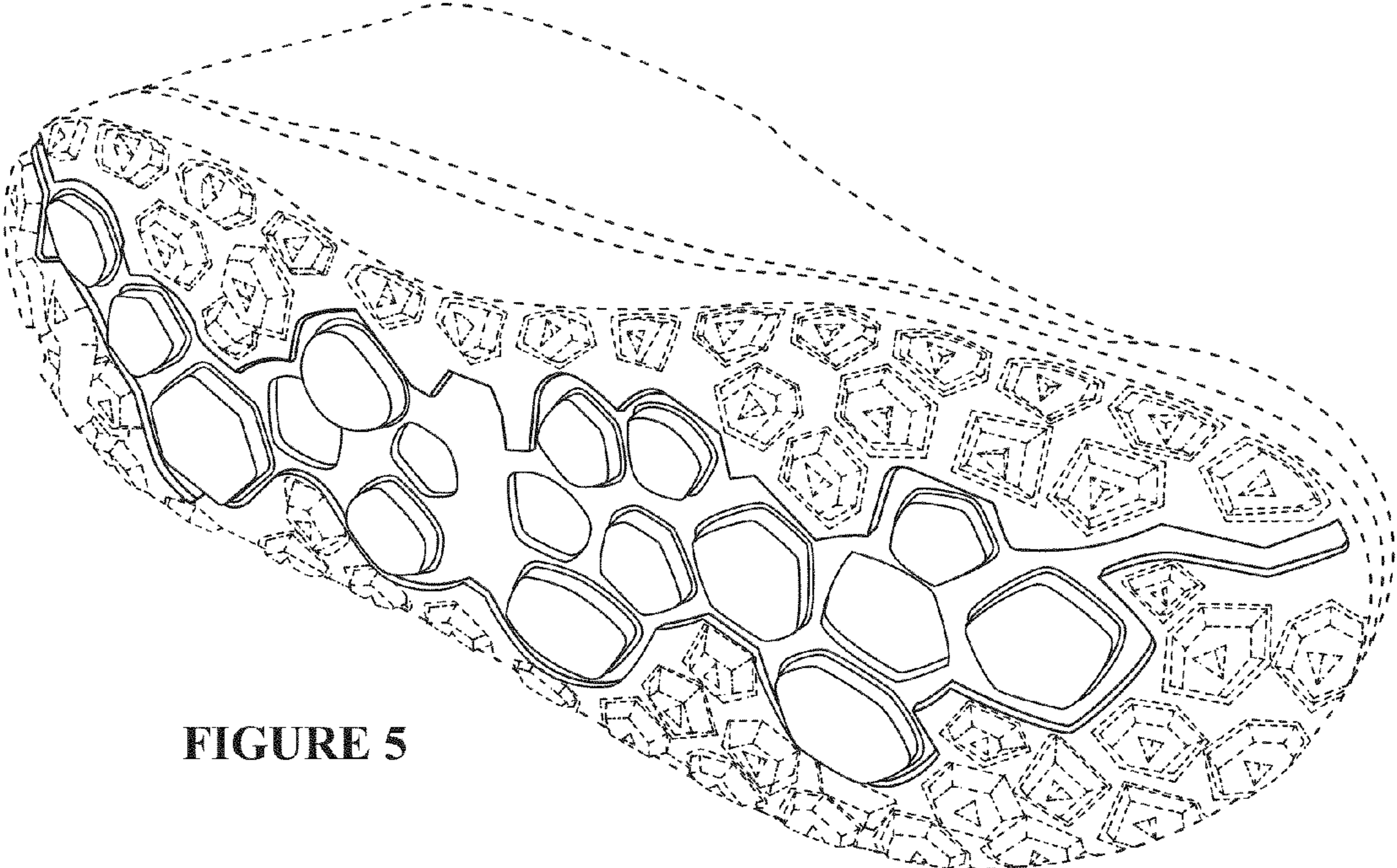

FIGURE 4



**FIGURE 5**