



US00D644513S

(12) **United States Design Patent**  
**Marotti et al.**

(10) **Patent No.:** **US D644,513 S**  
(45) **Date of Patent:** **\*\* Sep. 6, 2011**

- (54) **CONTAINER LABEL**
- (75) Inventors: **Martin Jay Marotti**, Carmel, IN (US);  
**Andrea Marie Subler**, West Chester,  
OH (US)
- (73) Assignee: **The Procter & Gamble Company**,  
Cincinnati, OH (US)
- (\*\*) Term: **14 Years**
- (21) Appl. No.: **29/366,015**
- (22) Filed: **Jul. 19, 2010**
- (51) **LOC (9) Cl.** ..... **09-07**
- (52) **U.S. Cl.** ..... **D9/434**
- (58) **Field of Classification Search** ..... D9/682,  
D9/600, 457, 454, 441, 434, 432, 430, 415,  
D9/414, 418, 704, 552, 551, 669, 750; D11/95;  
D5/56; D20/40, 36, 28, 27, 26, 22, 11; D14/492,  
D14/489, 486; 715/976, 840, 764, 715; 229/923,  
229/922, 87.19, 116.5, 116.1, 100; 220/694,  
220/376  
See application file for complete search history.

D149,813 S *	6/1948	Hollis	.....	D9/669
D258,202 S	2/1981	Astor et al.		
D351,555 S *	10/1994	Blott	.....	D9/750
D427,067 S *	6/2000	Miller et al.	.....	D9/434
6,427,832 B1	8/2002	Ali et al.		
D584,611 S *	1/2009	Ames et al.	.....	D9/432
D610,002 S *	2/2010	Frank	.....	D9/432
D612,720 S *	3/2010	Marotti et al.	.....	D9/434
2005/0218015 A1 *	10/2005	Spector	.....	206/222

\* cited by examiner

*Primary Examiner* — Susan Bennett Hattan  
(74) *Attorney, Agent, or Firm* — Emelyn L. Hiland

(57) **CLAIM**  
The ornamental design for a container label, as shown and described.

**DESCRIPTION**

FIG. 1 is a front view of a container label incorporating our new design shown in gray scale representing any color; FIG. 2 is a perspective view of our new design applied on a bottle container; FIG. 3 is a front elevational view thereof; FIG. 4 is a rear elevational view thereof; FIGS. 5 and 6 are side elevational views thereof; FIG. 7 is a top plan view thereof; and, FIG. 8 is a bottom view thereof.  
The broken lines shown in the drawings depict environmental subject matter only and form no part of the claimed design.

**1 Claim, 5 Drawing Sheets**

- (56) **References Cited**
- U.S. PATENT DOCUMENTS
- D16,979 S    11/1886 Noone
- D54,616 S    3/1920 Hall

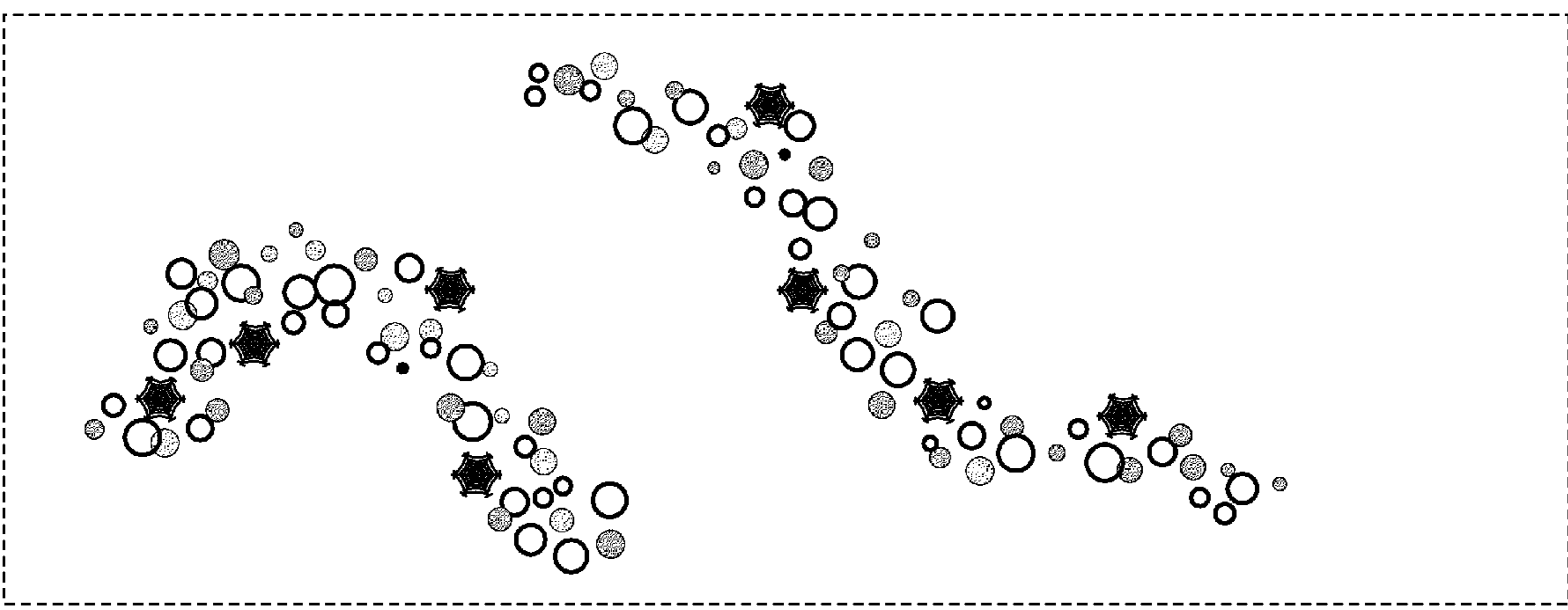

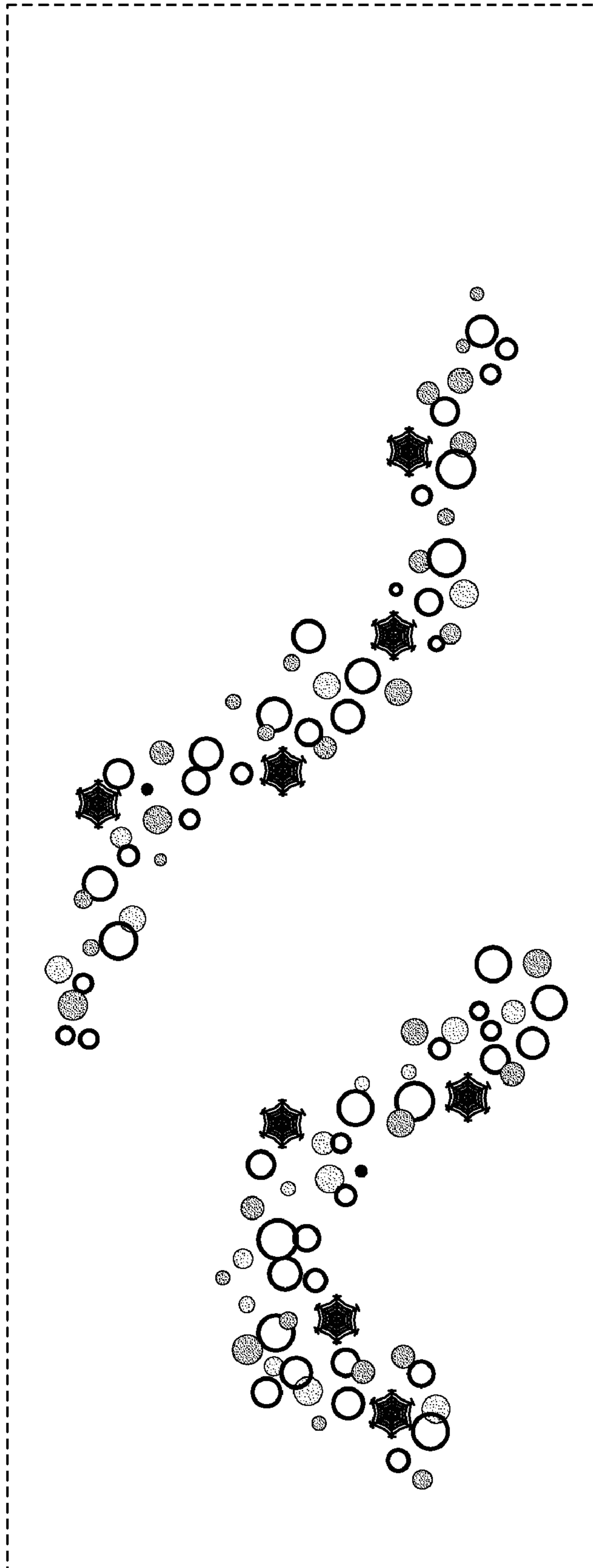

Fig. 1

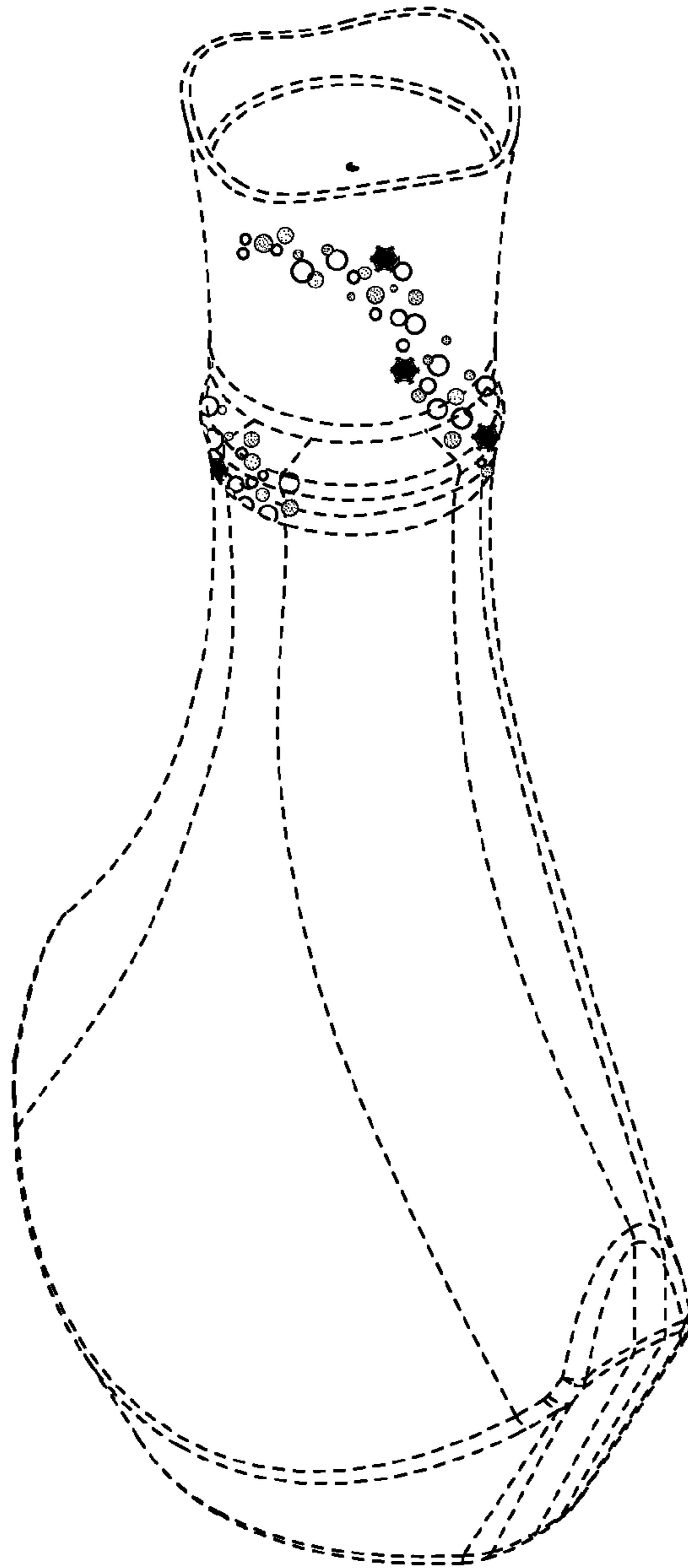

Fig. 2

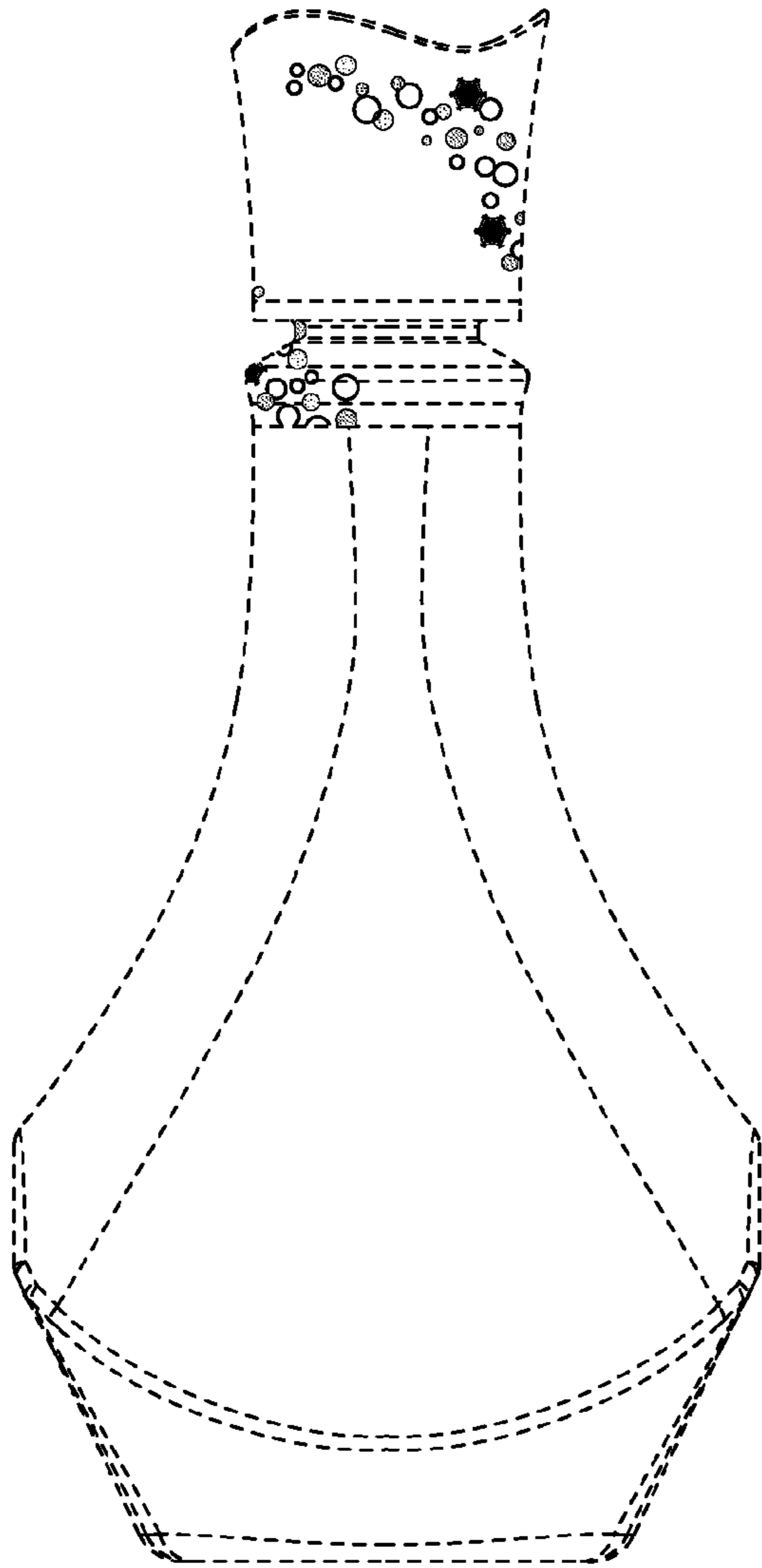

Fig. 3

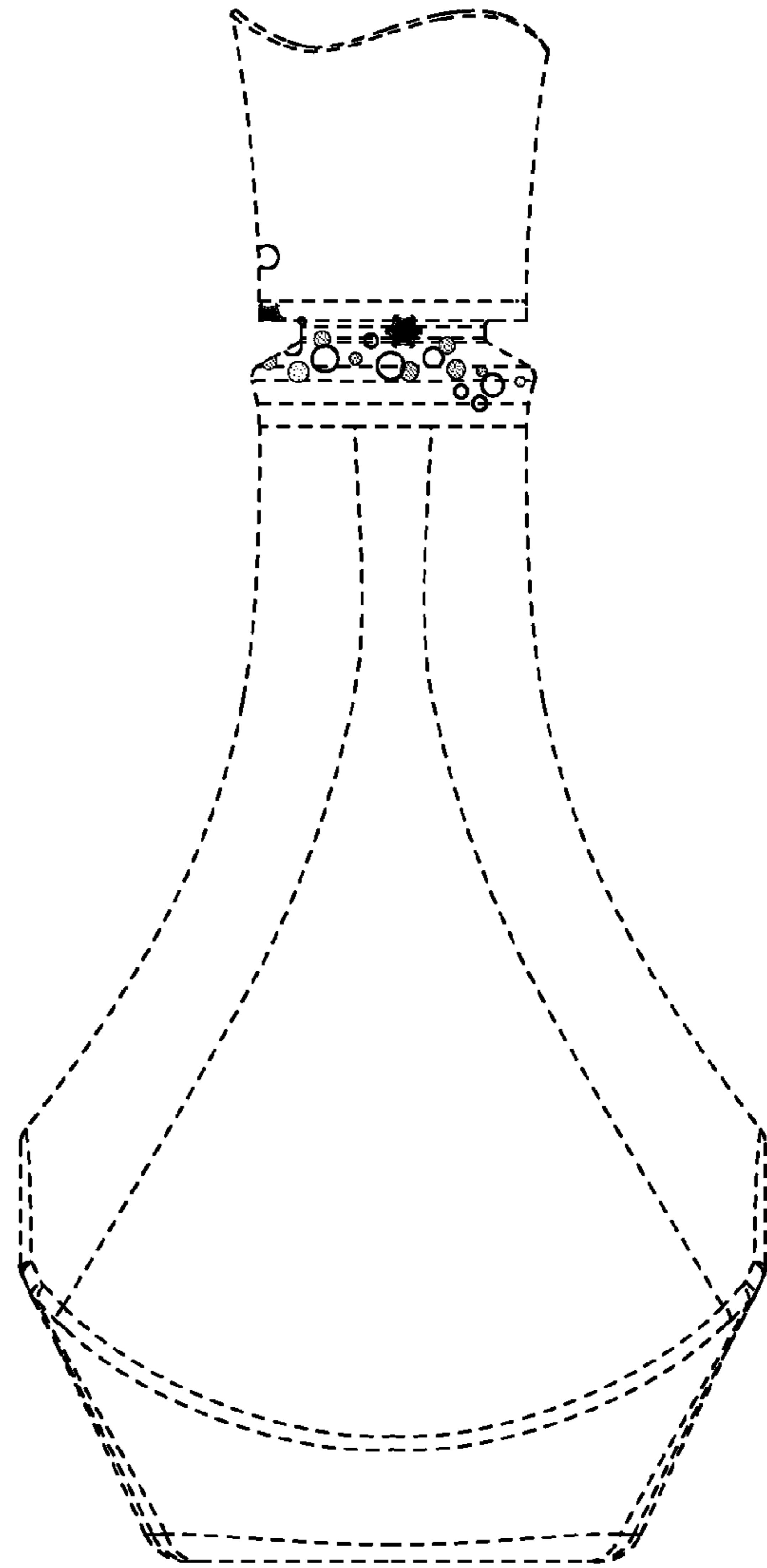

Fig. 4

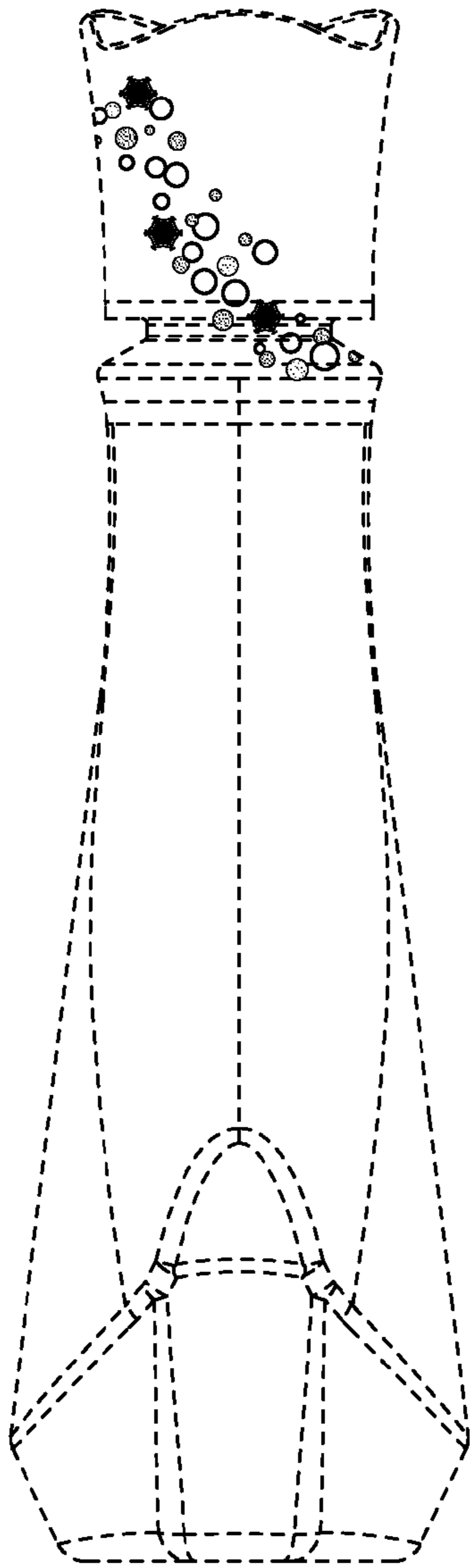

Fig. 5

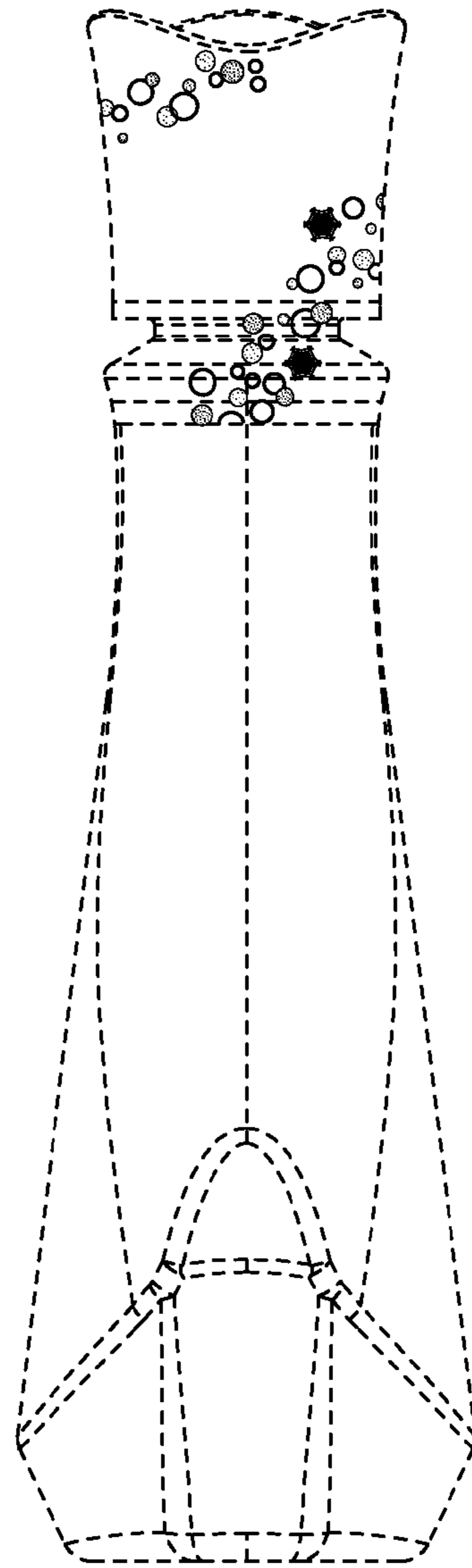

Fig. 6

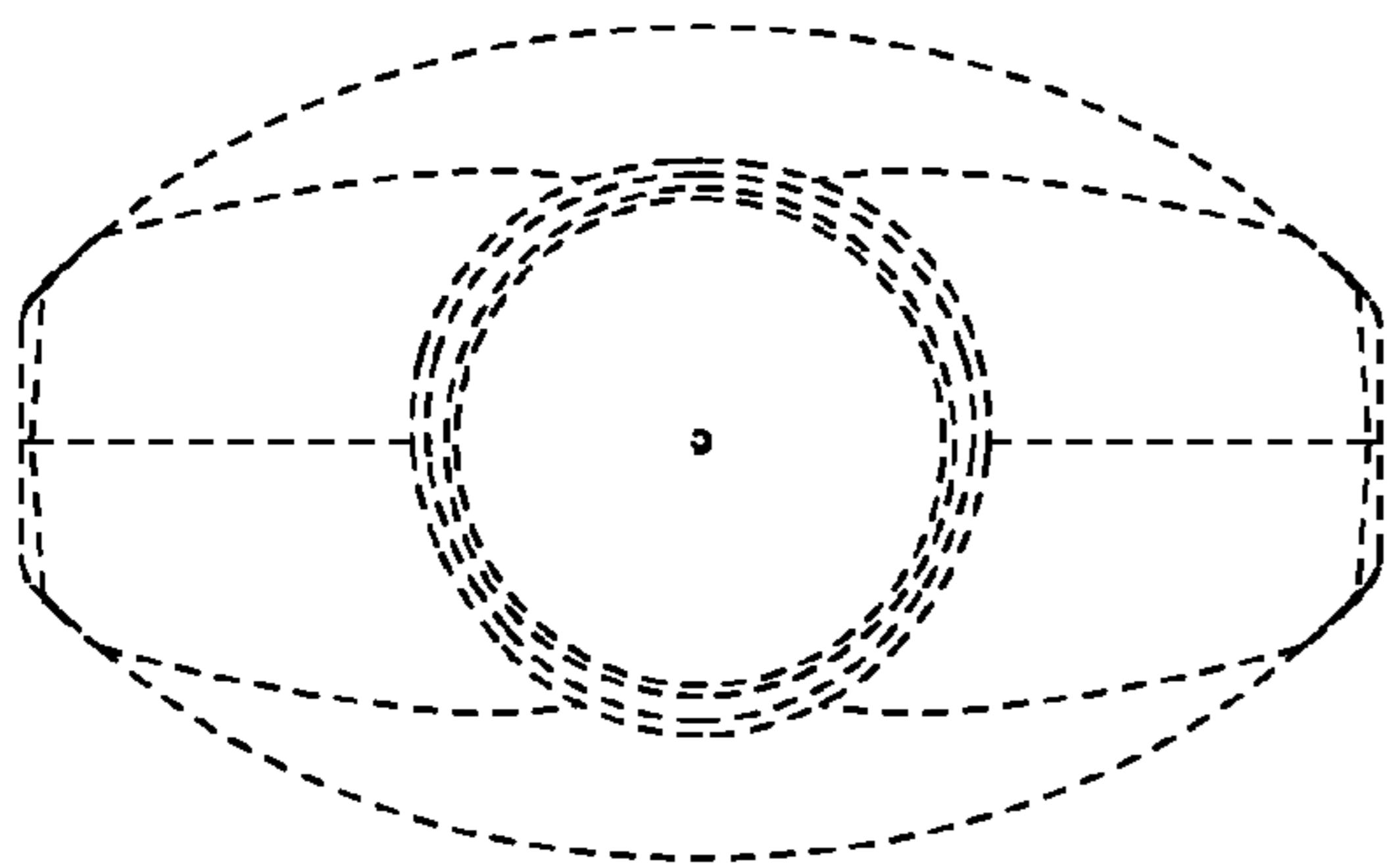

Fig. 7

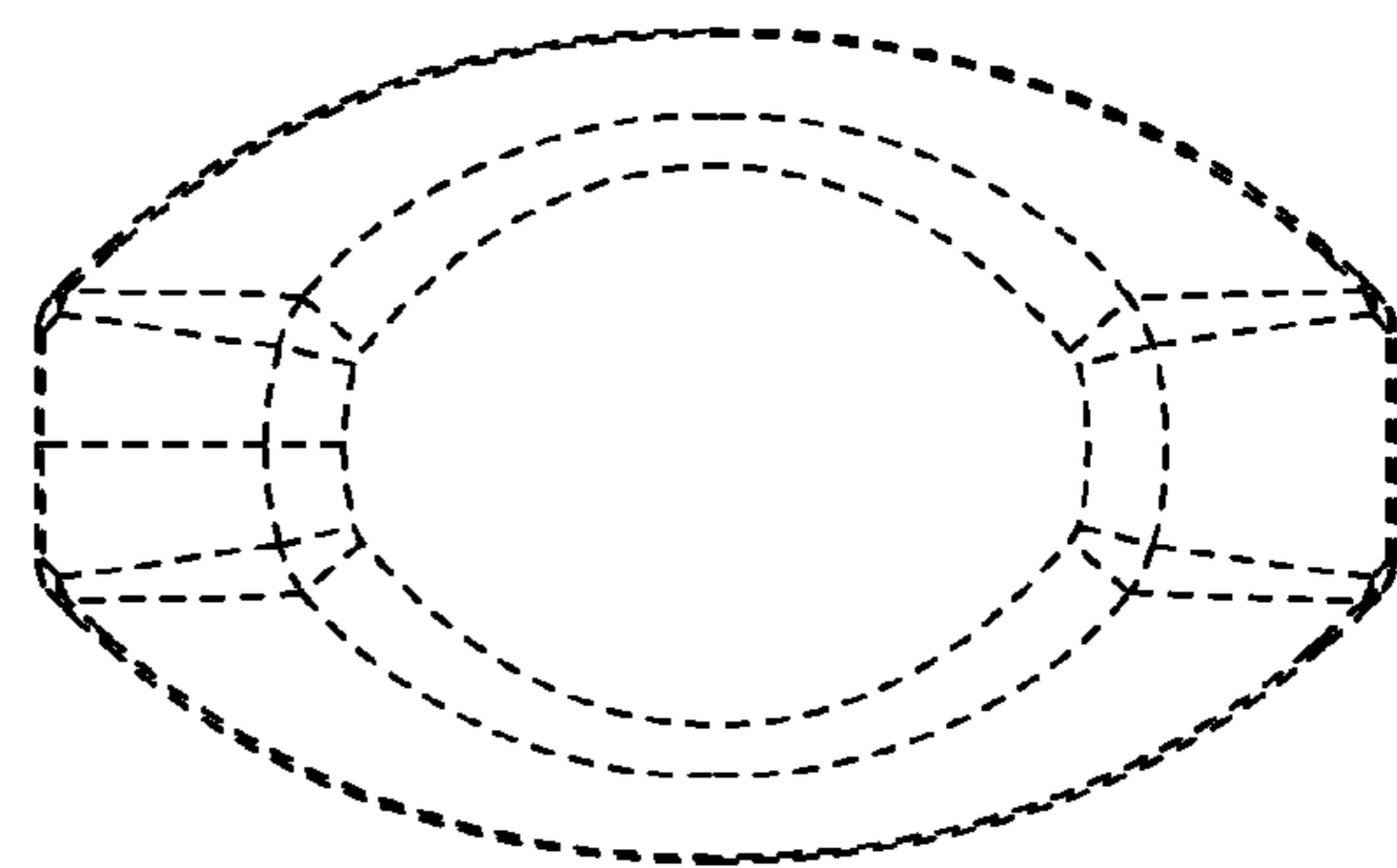

Fig. 8