



US00D644338S

(12) **United States Design Patent**
Thuma et al.

(10) **Patent No.:** **US D644,338 S**

(45) **Date of Patent:** **** Aug. 30, 2011**

(54) **MODULAR STORAGE ENCLOSURE**

(75) Inventors: **Michael Thuma**, La Grange, IL (US);
Matthew McKimmy, Orland Hills, IL
(US); **Torrence Anderson**, Overland
Park, KS (US); **Michael R. Vogler**,
Oswego, IL (US)

(73) Assignee: **Suncast Technologies, LLC**, Palm
Beach Gardens, FL (US)

(**) Term: **14 Years**

(21) Appl. No.: **29/382,140**

(22) Filed: **Dec. 29, 2010**

(51) **LOC (9) Cl.** **25-03**

(52) **U.S. Cl.** **D25/33**

(58) **Field of Classification Search** D25/1-33;
52/79.4, 81.5, 236.1, 274, 74, 71, 245-246,
52/82, 79.1, 79.5, 90.1, 64

See application file for complete search history.

(56) **References Cited**

U.S. PATENT DOCUMENTS

3,845,592	A	*	11/1974	Patena	52/93.2
3,987,597	A	*	10/1976	Smrt	52/764
D525,715	S	*	7/2006	Richardson et al.	D25/33
D529,623	S	*	10/2006	Richardson et al.	D25/33
D547,880	S	*	7/2007	Ashby et al.	D25/33
D548,362	S	*	8/2007	Ashby et al.	D25/33
D558,890	S	*	1/2008	Grosfillex et al.	D25/33
D558,891	S	*	1/2008	Grosfillex et al.	D25/33
D558,892	S	*	1/2008	Grosfillex et al.	D25/33

D558,893	S	*	1/2008	Grosfillex et al.	D25/33
D560,818	S	*	1/2008	Grosfillex et al.	D25/33
D567,390	S	*	4/2008	Grosfillex et al.	D25/33
D606,666	S	*	12/2009	Berger et al.	D25/33
D606,667	S	*	12/2009	Berger et al.	D25/33
D612,515	S	*	3/2010	Berger et al.	D25/29
D612,950	S	*	3/2010	Berger et al.	D25/29
D617,004	S	*	6/2010	Berger et al.	D25/29
D625,834	S	*	10/2010	McKimmy et al.	D25/33
D625,835	S	*	10/2010	McKimmy et al.	D25/33

* cited by examiner

Primary Examiner — T. Chase Nelson

Assistant Examiner — Eric L Goodman

(74) *Attorney, Agent, or Firm* — McHale & Slavin, P.A.

(57) **CLAIM**

The ornamental design for a modular storage enclosure, as shown and described.

DESCRIPTION

FIG. 1 is a top right perspective view of the modular storage enclosure of the instant invention;

FIG. 2 is a front view thereof;

FIG. 3 is a rear view thereof;

FIG. 4 is a left side view thereof;

FIG. 5 is a right side view thereof; and,

FIG. 6 is a top view thereof.

The portions of the figures illustrated in broken lines are for illustrative purposes only and form no part of the claimed design.

1 Claim, 6 Drawing Sheets

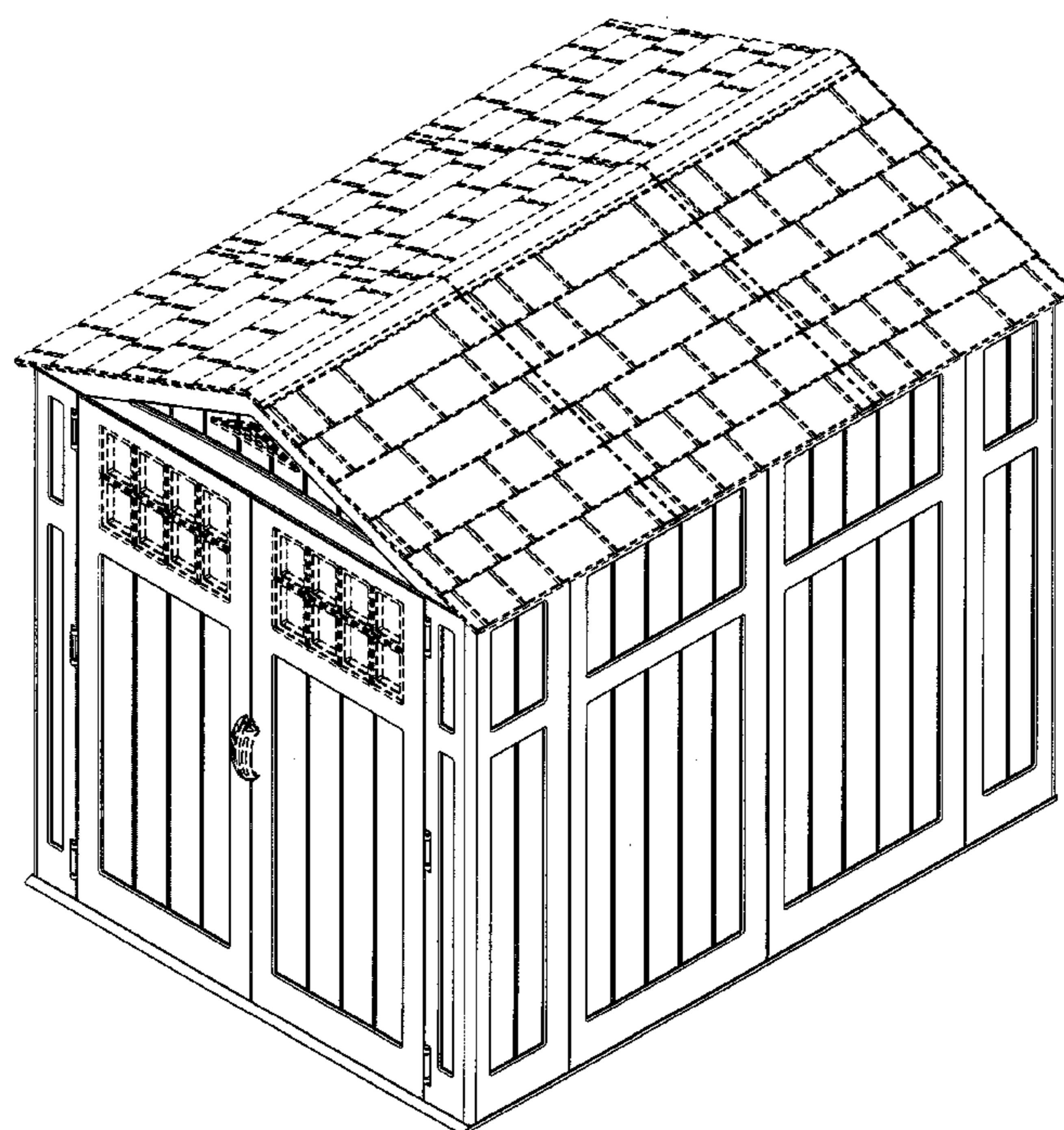

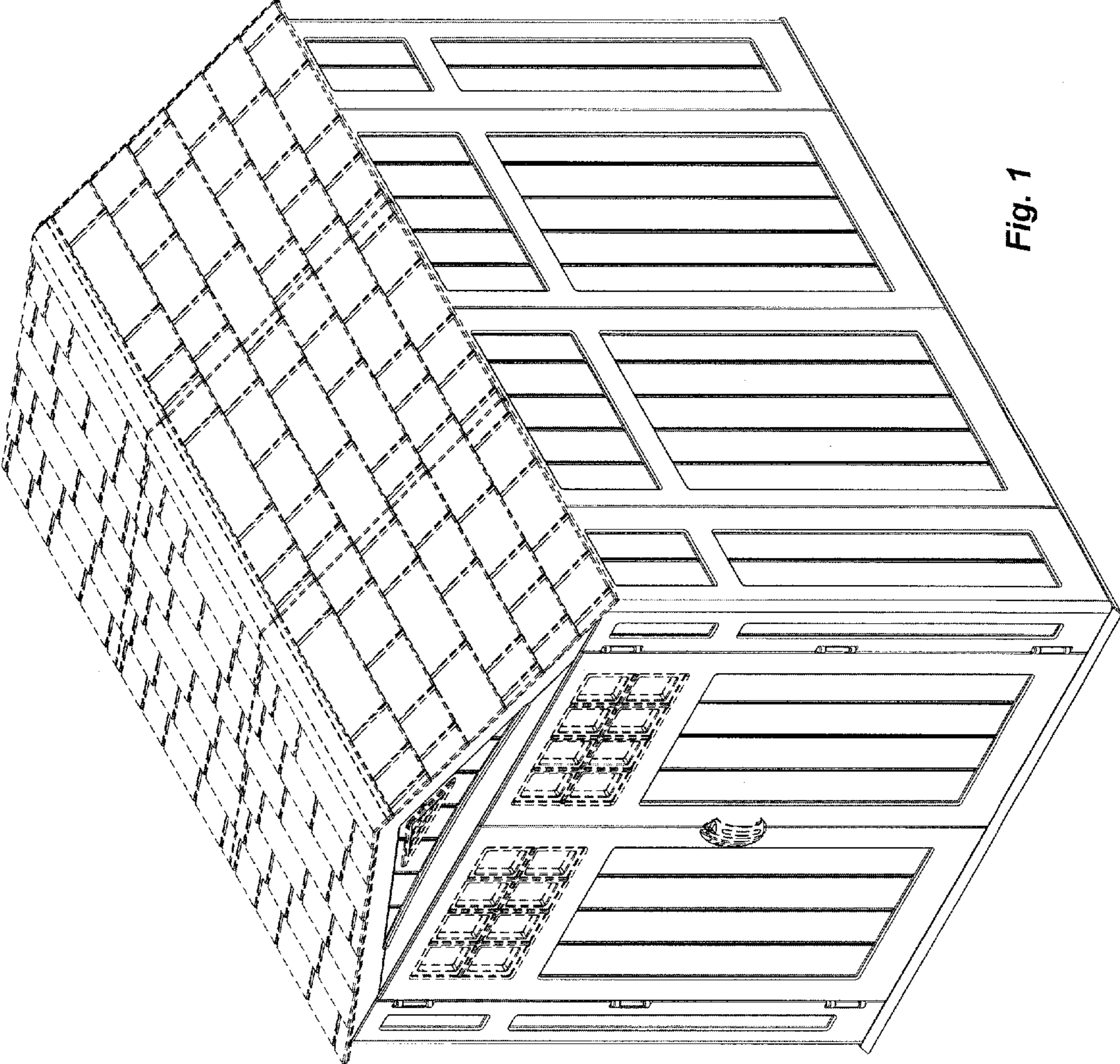

Fig. 1

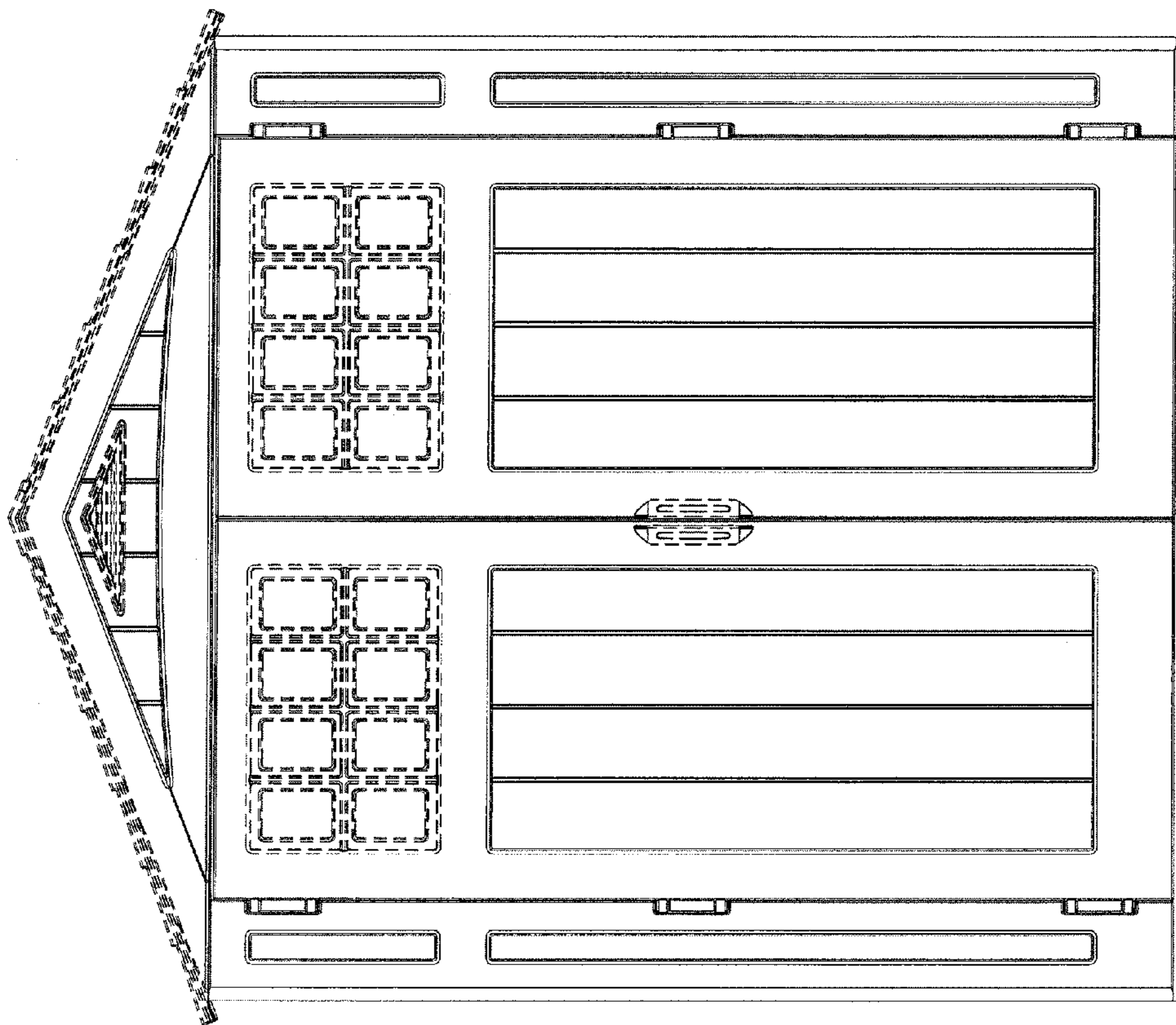

Fig. 2

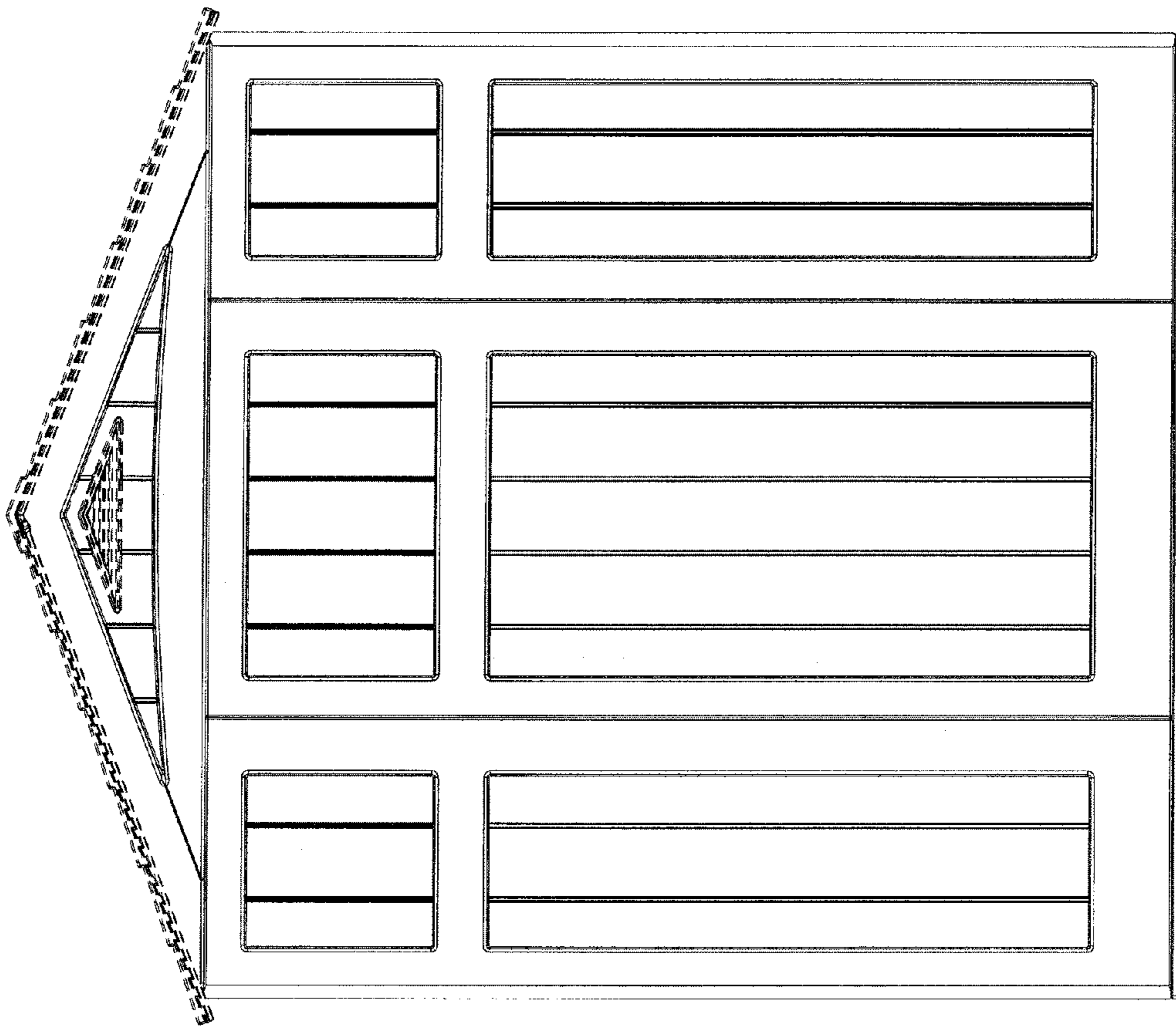

Fig. 3

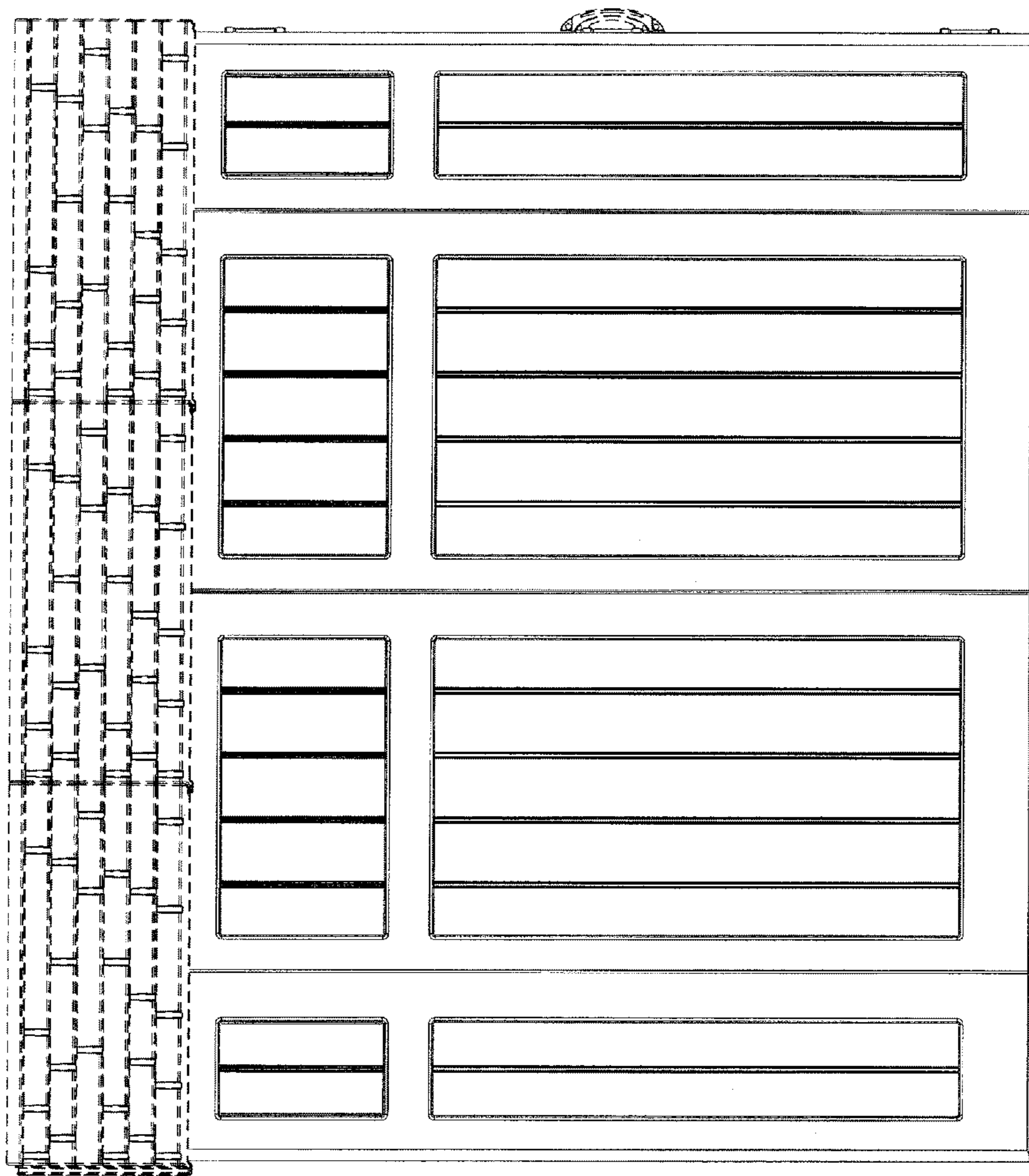

Fig. 4

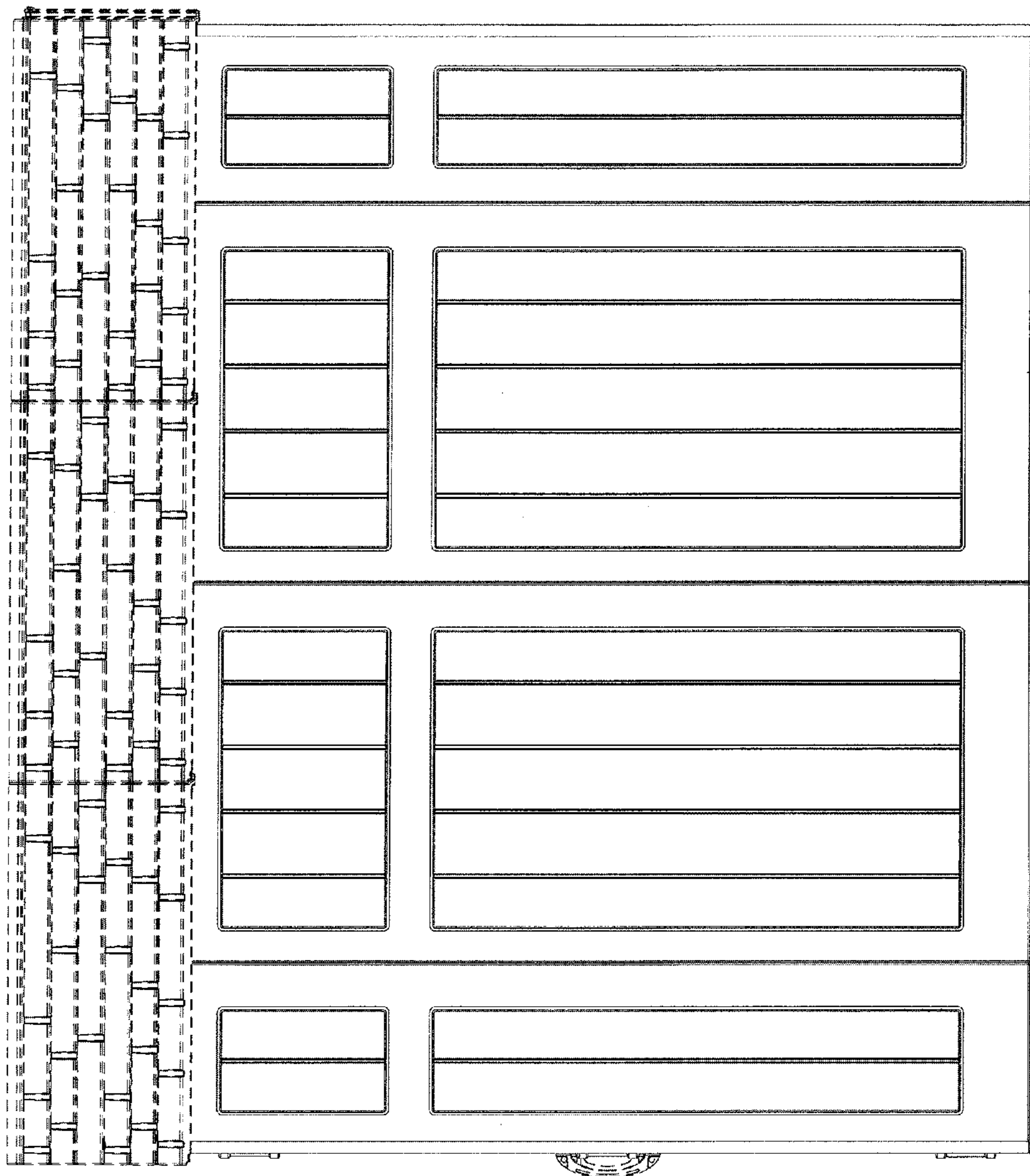

Fig. 5

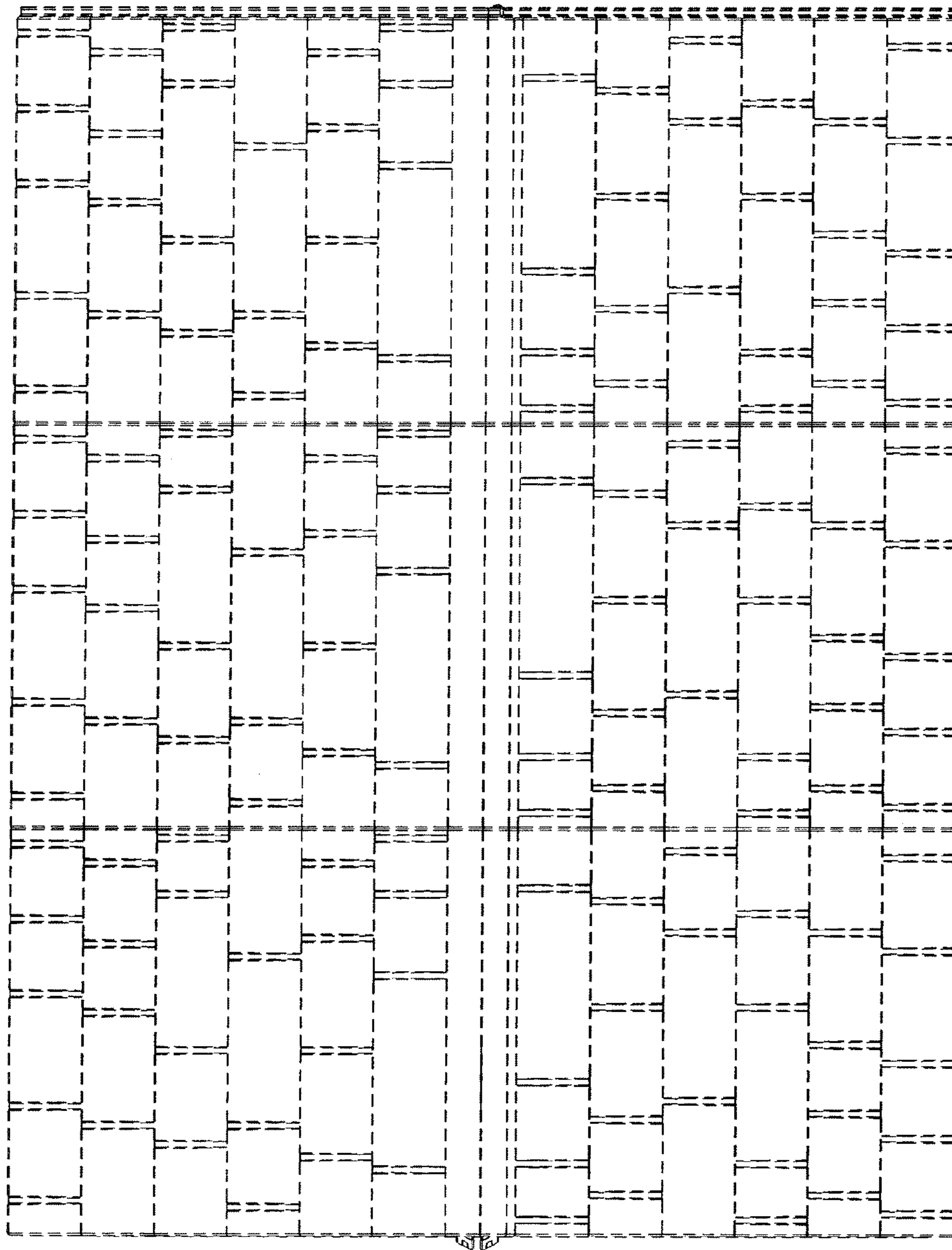

Fig. 6