



US00D643938S

(12) **United States Design Patent**  
**Baccarini**

(10) **Patent No.:** **US D643,938 S**

(45) **Date of Patent:** **\*\* Aug. 23, 2011**

(54) **DOOR FRAME**

2,234,043 A 3/1941 Dworetz  
2,261,054 A 10/1941 Dietrich  
2,301,187 A 11/1942 Balhatchet

(Continued)

(75) Inventor: **Tony Baccarini**, Essex (GB)

(73) Assignee: **Tony Baccarini and Nigel Aulton**,  
Bures (GB)

**FOREIGN PATENT DOCUMENTS**

DE 4300130 A1 7/1994

(Continued)

(\*\*) Term: **14 Years**

(21) Appl. No.: **29/378,137**

**OTHER PUBLICATIONS**

(22) Filed: **Oct. 29, 2010**

“Application No. PCT/GB2007/000492, International Search Report  
mailed Jun. 19, 2007”, 5 pgs.

(Continued)

**Related U.S. Application Data**

(60) Division of application No. 29/359,398, filed on Apr.  
9, 2010, now Pat. No. Des. 634,026, which is a division  
of application No. 29/335,688, filed on Apr. 20, 2009,  
now Pat. No. Des. 622,415, which is a division of  
application No. 29/276,951, filed on Feb. 9, 2007, now  
Pat. No. Des. 597,683, which is a continuation-in-part  
of application No. 11/519,371, filed on Sep. 11, 2006.

*Primary Examiner* — Doris Clark

(74) *Attorney, Agent, or Firm* — Schwegman, Lundberg &  
Woessner, P.A.

(57) **CLAIM**

The ornamental design for a door frame, as shown and  
described.

**DESCRIPTION**

(30) **Foreign Application Priority Data**

Apr. 10, 2006 (GB) ..... 0607223

Sep. 27, 2006 (GB) ..... 0619068

(51) **LOC (9) Cl.** ..... **25-02**

(52) **U.S. Cl.** ..... **D25/60**

(58) **Field of Classification Search** ..... 52/717.01,  
52/204.1; 49/DIG. 2, 505; D25/60

See application file for complete search history.

FIG. 1 is a left side elevation view of a door frame;  
FIG. 2 is a top plan view thereof;  
FIG. 3 is a right side elevation view thereof;  
FIG. 4 is a rear elevation view thereof;  
FIG. 5 is a front elevation view thereof;  
FIG. 6 is a perspective view thereof;  
FIG. 7 is a rear elevation view of the door frame of FIG. 1  
arranged, in an example, as a doorframe assembly; and,  
FIG. 8 is a perspective view of the door frame of FIG. 1  
arranged as a doorframe assembly of FIG. 7.

The broken lines are for illustrative purposes and form no part  
of the claimed design.

The ornamental design of a door frame pertains to elongated  
plaster moldings designed to run between a ceiling and a floor  
and having an abutment surface for abutment against the end  
surface of a partition wall or as a join between two such walls.

(56) **References Cited**

**U.S. PATENT DOCUMENTS**

1,465,539 A 8/1923 Atterbury  
1,555,555 A 9/1925 Comerma  
1,875,576 A 9/1932 Een  
2,110,728 A 3/1938 Hoggatt

**1 Claim, 4 Drawing Sheets**

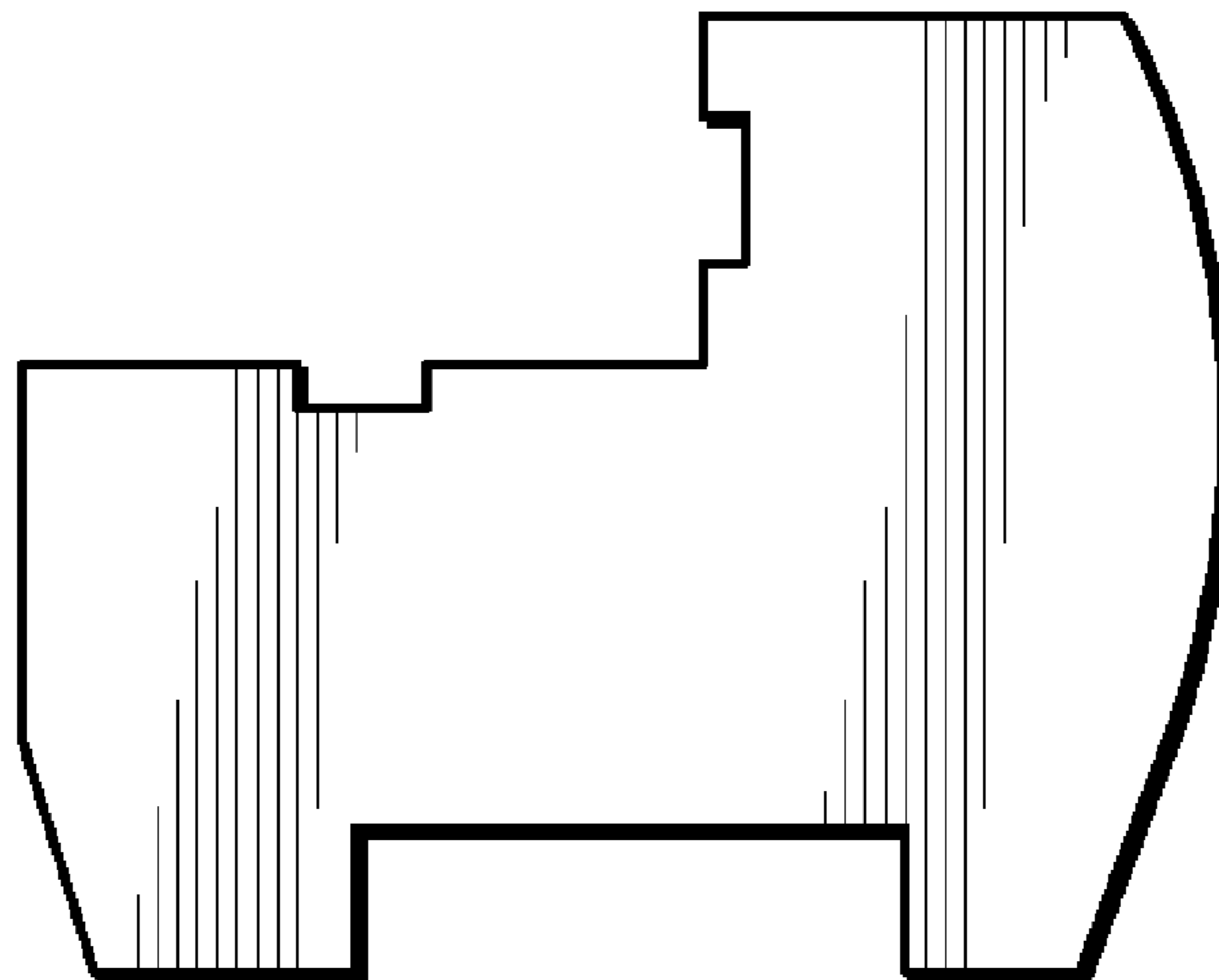

# US D643,938 S

Page 2

## U.S. PATENT DOCUMENTS

2,453,221 A 11/1948 Haden  
2,537,715 A 1/1951 Stead  
3,391,509 A 7/1968 Fruman  
3,396,504 A 8/1968 Luiz  
3,420,016 A 1/1969 Robert  
3,465,488 A 9/1969 Peter  
3,654,734 A \* 4/1972 Lehman ..... 49/505  
3,935,049 A 1/1976 Schmidt et al.  
3,973,371 A 8/1976 Heller  
D245,018 S 7/1977 Harris  
D251,804 S \* 5/1979 Balkany et al. .... D25/60  
4,753,622 A 6/1988 Nakama  
4,964,250 A 10/1990 Nelson  
5,115,605 A 5/1992 Butler  
5,544,463 A 8/1996 Bergin  
5,755,066 A 5/1998 Becker  
5,819,458 A 10/1998 Hadden  
5,934,030 A \* 8/1999 McDonald ..... 52/204.1  
6,026,620 A 2/2000 Spude  
6,119,432 A 9/2000 Niemann  
6,176,053 B1 1/2001 St. Germain  
6,228,507 B1 5/2001 Hahn  
6,286,286 B1 9/2001 Simonar  
6,408,576 B1 6/2002 Roth  
D467,007 S 12/2002 Daudet et al.  
6,560,944 B1 \* 5/2003 Wilson ..... 52/717.01  
6,604,331 B1 8/2003 Pallas et al.  
7,404,272 B2 7/2008 Piché  
D581,545 S \* 11/2008 Dove ..... D25/60

D597,683 S 8/2009 Baccarini  
D622,415 S 8/2010 Baccarini  
2003/0089058 A1 5/2003 Kunz et al.  
2004/0055245 A1 3/2004 Fitch  
2004/0168384 A1 9/2004 Wesolowska  
2005/0011159 A1 1/2005 Standal et al.  
2007/0245654 A1 10/2007 Baccarini  
2009/0038250 A1 2/2009 Frenkil

## FOREIGN PATENT DOCUMENTS

DE 29809789 9/1998  
DE 20104657 U1 7/2001  
DE 10041362 3/2002  
DE 10102882 7/2002  
FR 2793269 4/2003  
GB 830602 3/1960  
GB 2209135 5/1989  
GB 2437083 10/2007  
WO WO 0233187 4/2002  
WO WO 0243953 A1 6/2002  
WO WO 03001007 1/2003  
WO WO 03076732 A1 9/2003  
WO WO 2007116198 A1 10/2007

## OTHER PUBLICATIONS

“UK Search Report for Application No. 0619068.0”, (Oct. 24, 2006).

“UK Search Report for Application No. 0619068.0”, (May 26, 2006).

\* cited by examiner



*FIG. 3*

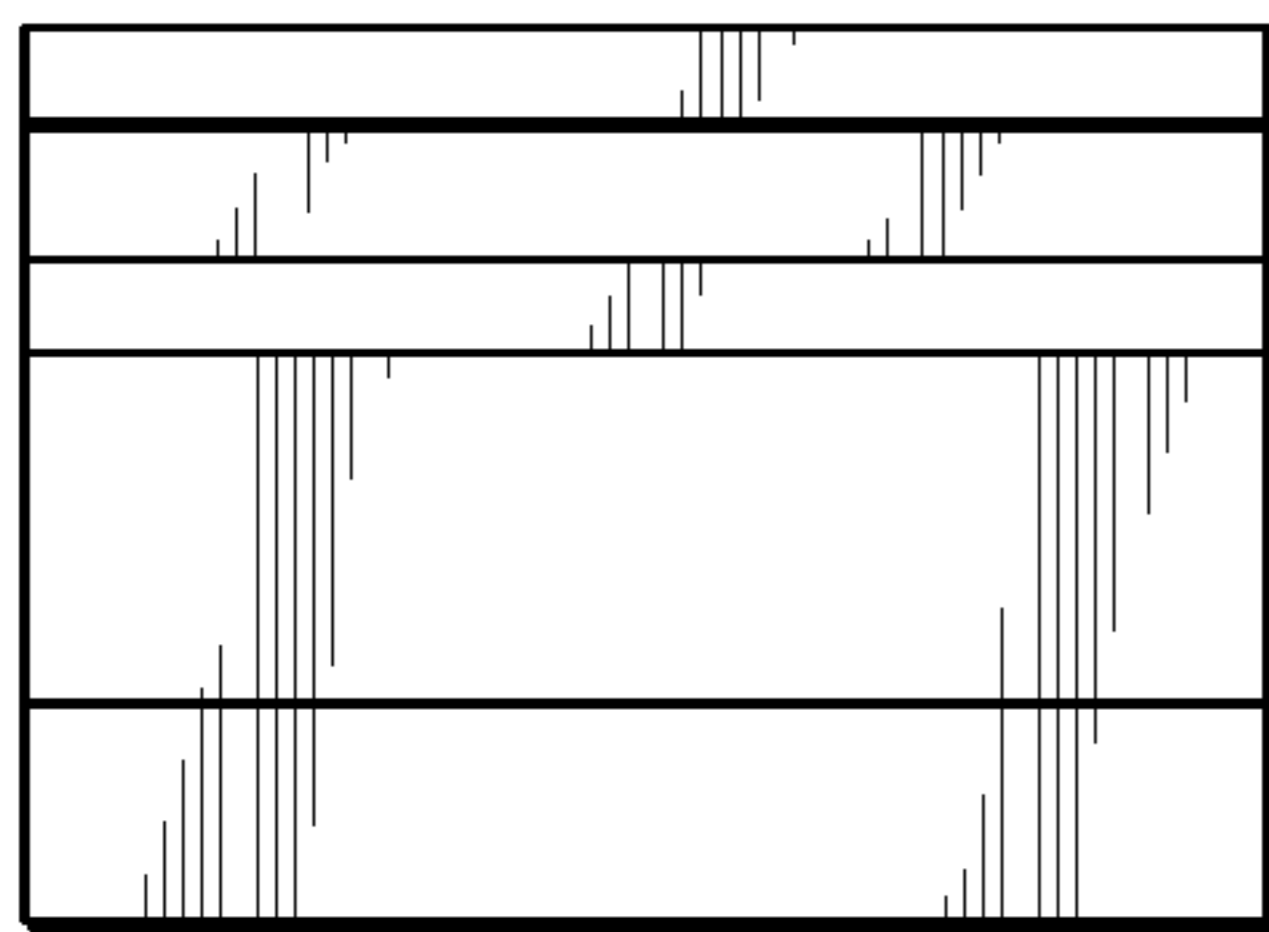

*FIG. 4*

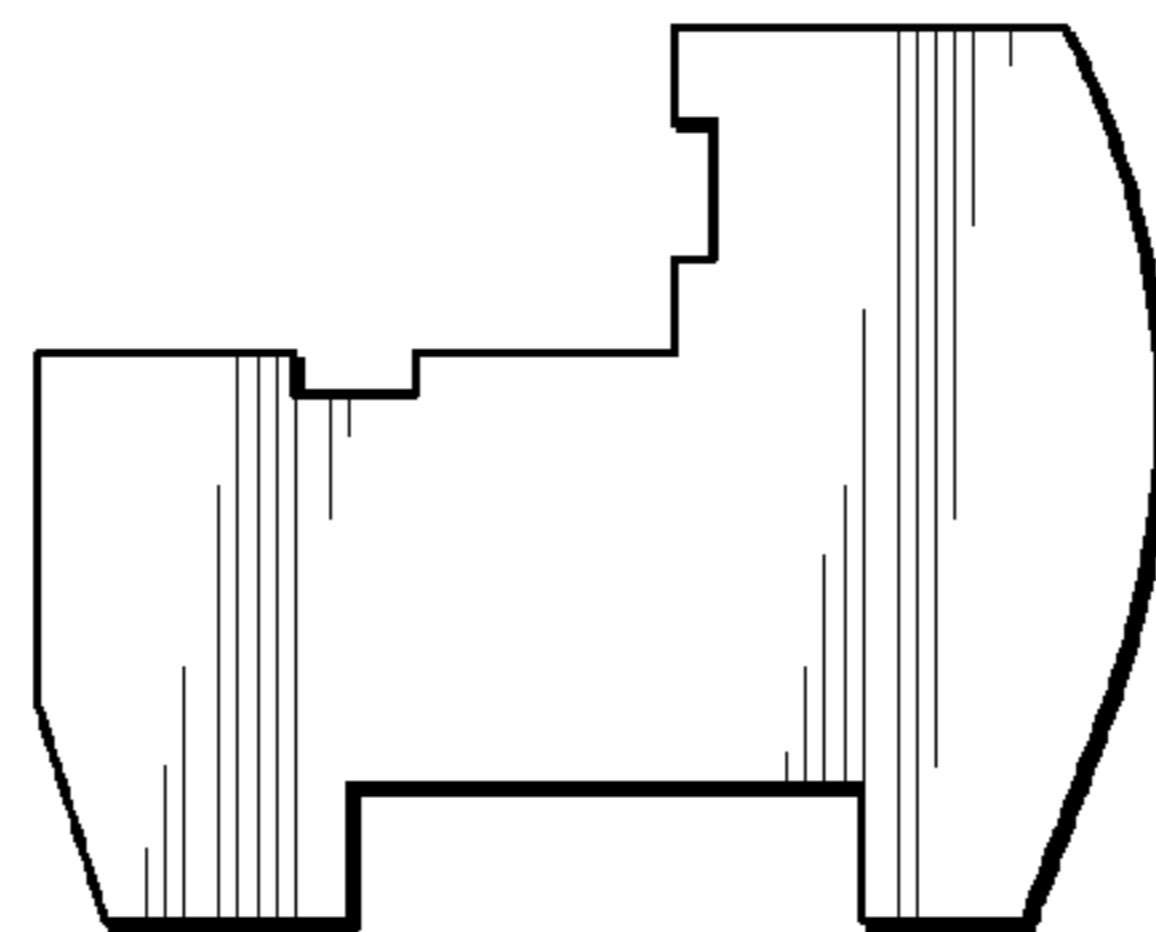

*FIG. 2*

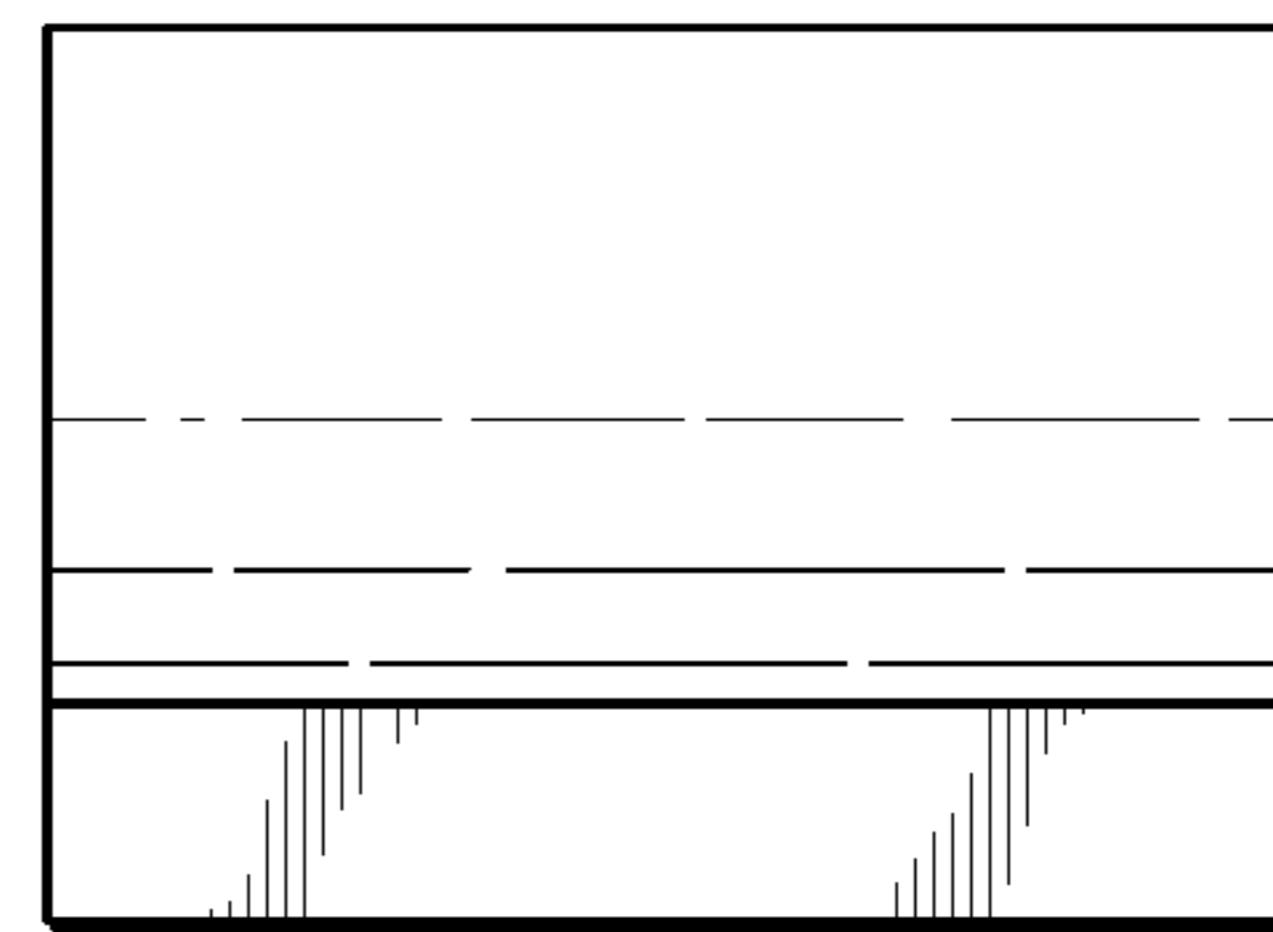

*FIG. 5*

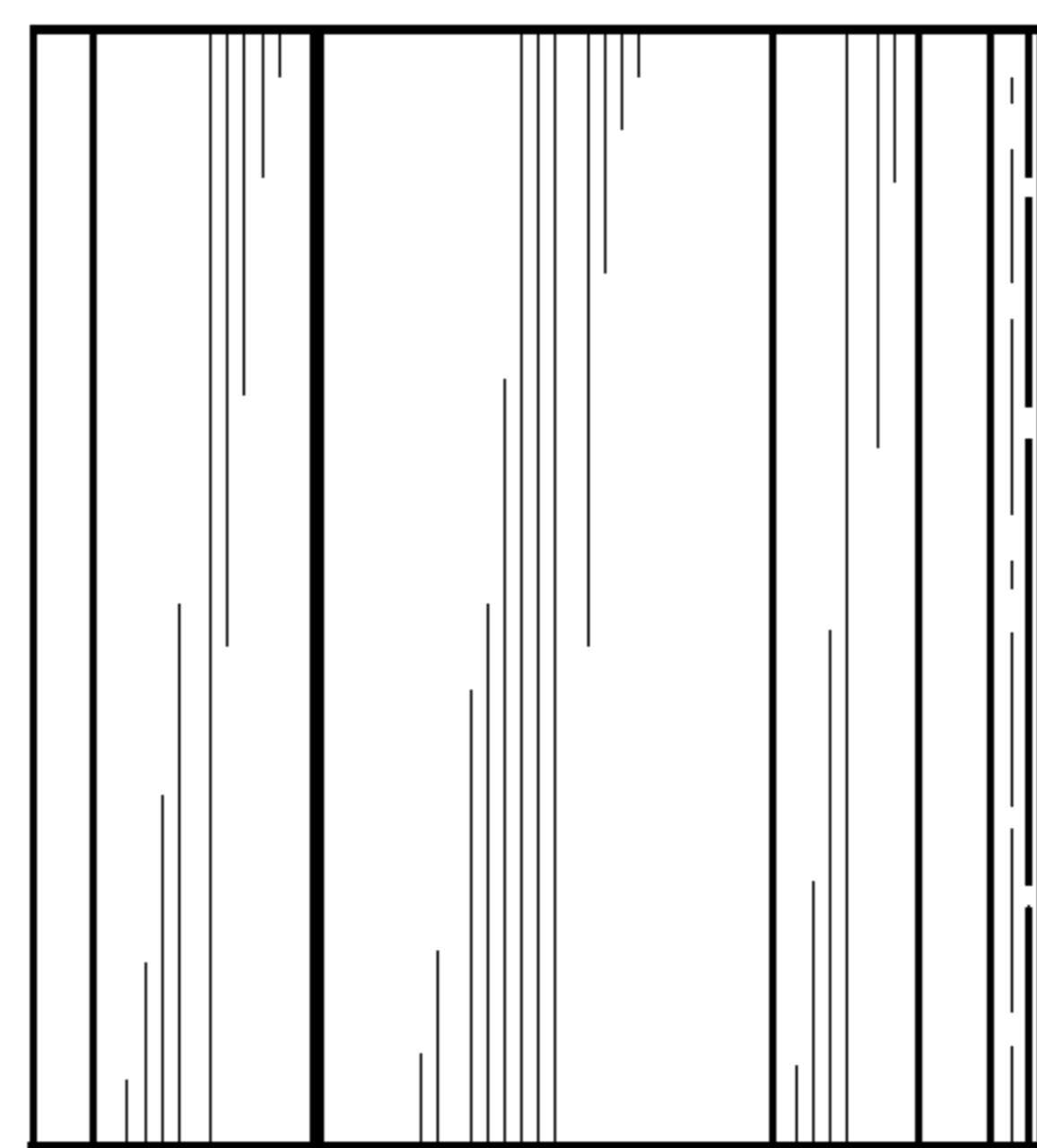

*FIG. 1*

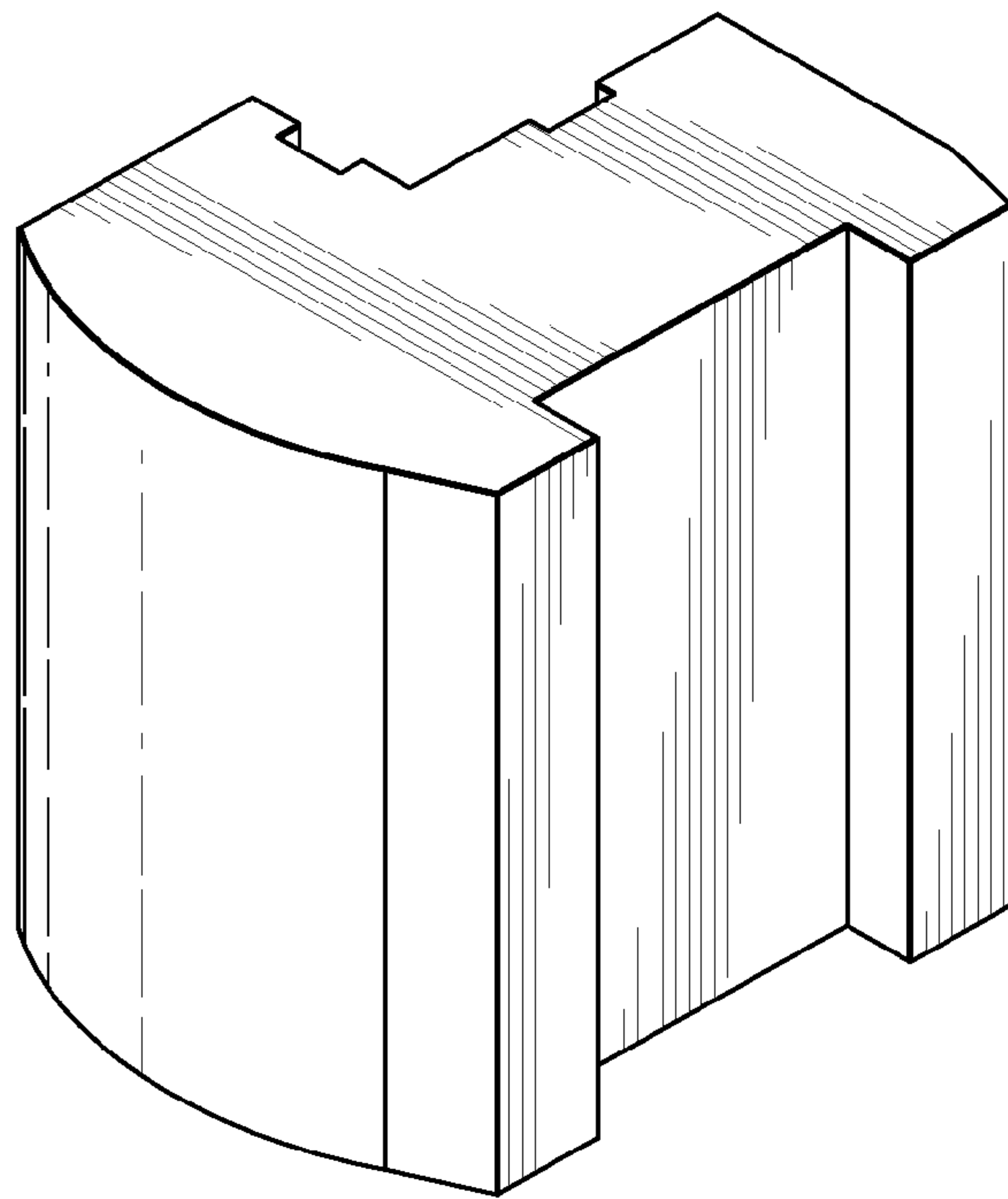

*FIG. 6*

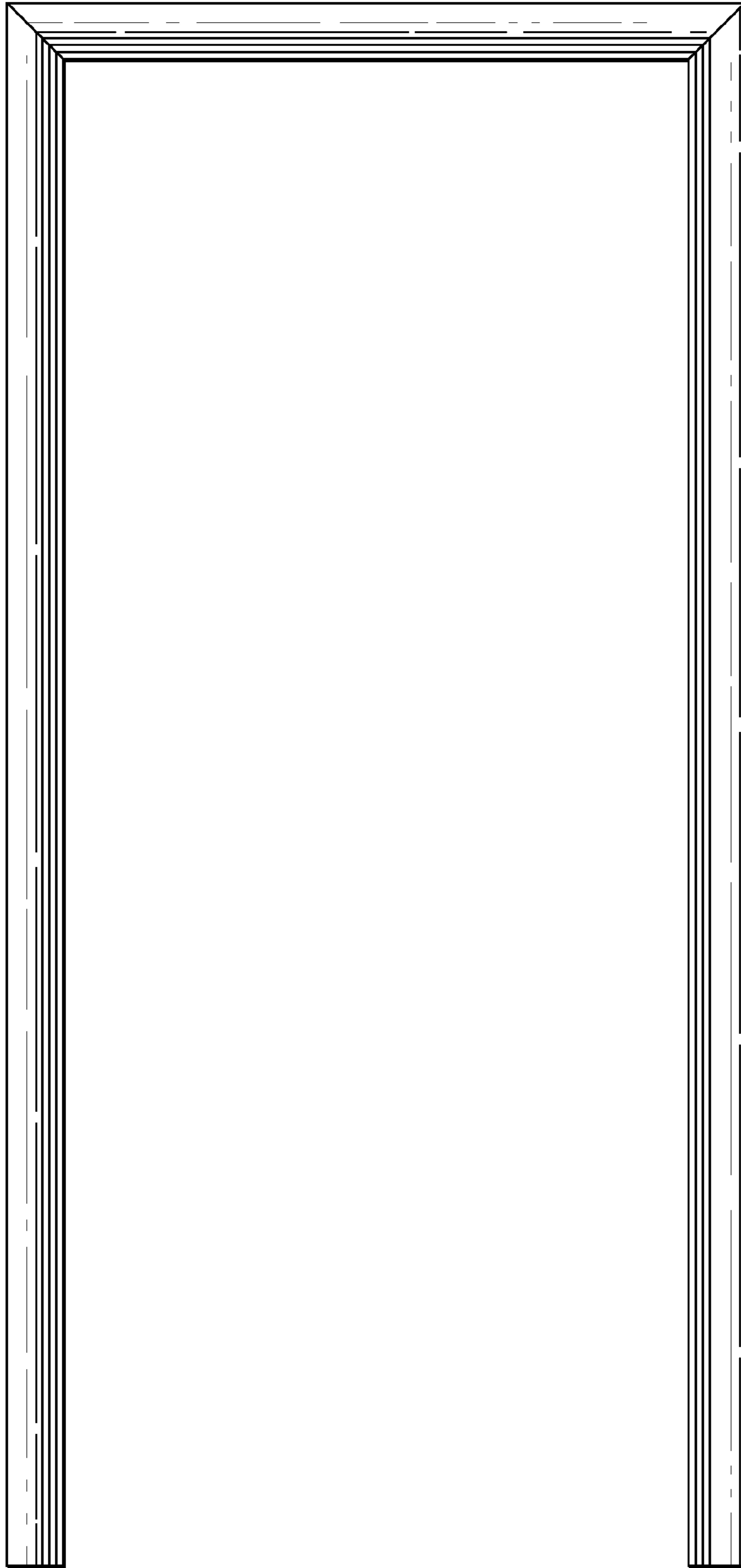

*FIG. 7*

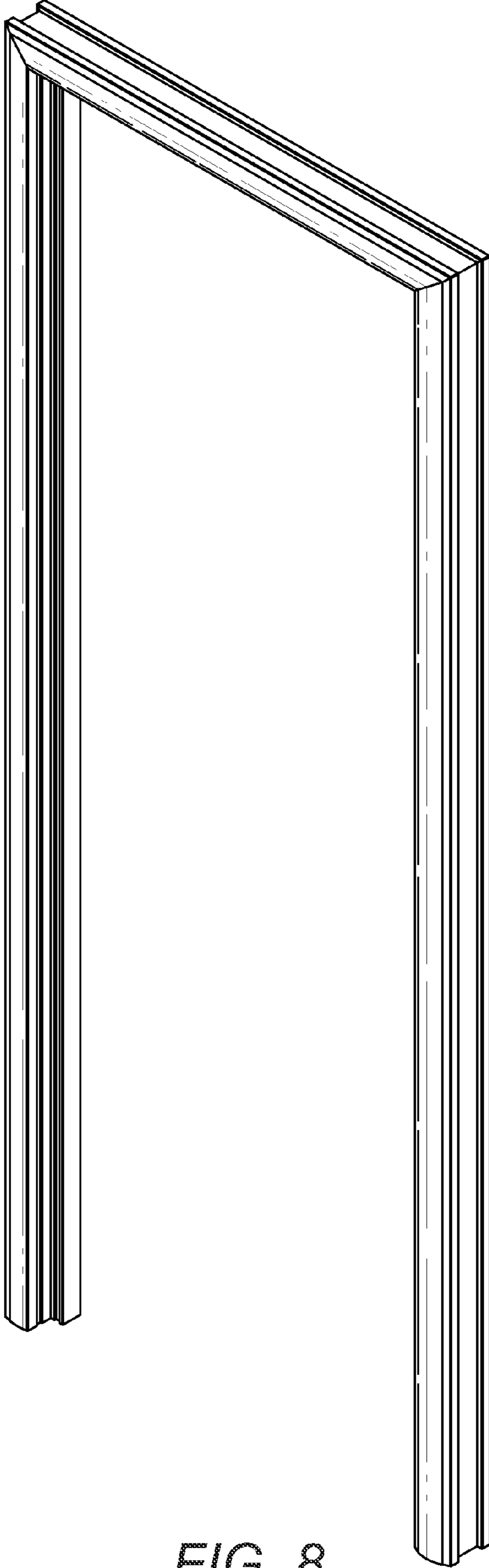

FIG. 8