



US00D643821S

(12) **United States Design Patent**
Yun

(10) **Patent No.:** **US D643,821 S**

(45) **Date of Patent:** **** Aug. 23, 2011**

(54) **BASE FOR LIGHT EMITTING DIODE**

(75) Inventor: **Sang Bok Yun**, Gyunggi-do (KR)

(73) Assignee: **Samsung LED Co., Ltd.**, Gyunggi-Do (KR)

(**) Term: **14 Years**

(21) Appl. No.: **29/382,589**

(22) Filed: **Jan. 5, 2011**

(30) **Foreign Application Priority Data**

Jul. 5, 2010 (KR) 30-2010-0029397

(51) **LOC (9) Cl.** **13-03**

(52) **U.S. Cl.** **D13/180**

(58) **Field of Classification Search** D13/180;
257/79, 80, 81, 88, 89, 95, 98, 99, 100, E33.058;
313/483, 498, 500; 362/555, 800
See application file for complete search history.

(56) **References Cited**

U.S. PATENT DOCUMENTS

- 7,301,175 B2 * 11/2007 Izuno et al. 257/98
- D573,114 S * 7/2008 Min et al. D13/180
- 7,425,083 B2 * 9/2008 Kim et al. 362/294
- D599,750 S 9/2009 Kim et al.

- D606,950 S * 12/2009 Ariizumi D13/180
- 7,683,394 B2 * 3/2010 Tomioka 257/98
- 7,719,024 B2 * 5/2010 Bando 257/99
- D621,798 S * 8/2010 Lu et al. D13/180
- 7,815,343 B2 * 10/2010 Nii et al. 362/311.03
- 7,923,739 B2 * 4/2011 Hussell 257/88
- 7,939,843 B2 * 5/2011 Haruna et al. 257/98
- 2004/0256706 A1 * 12/2004 Nakashima 257/678
- 2007/0075325 A1 * 4/2007 Baek et al. 257/99

* cited by examiner

Primary Examiner — Selina Sikder

(74) *Attorney, Agent, or Firm* — McDermott Will & Emery LLP

(57) **CLAIM**

The ornamental design for a base for light emitting diode, as shown and described.

DESCRIPTION

FIG. 1 is a perspective view of a base for light emitting diode
FIG. 2 is a front view thereof
FIG. 3 is a rear view thereof
FIG. 4 is a left side view thereof
FIG. 5 is a right side view thereof
FIG. 6 is a top plan view thereof; and,
FIG. 7 is a bottom view thereof.

1 Claim, 7 Drawing Sheets

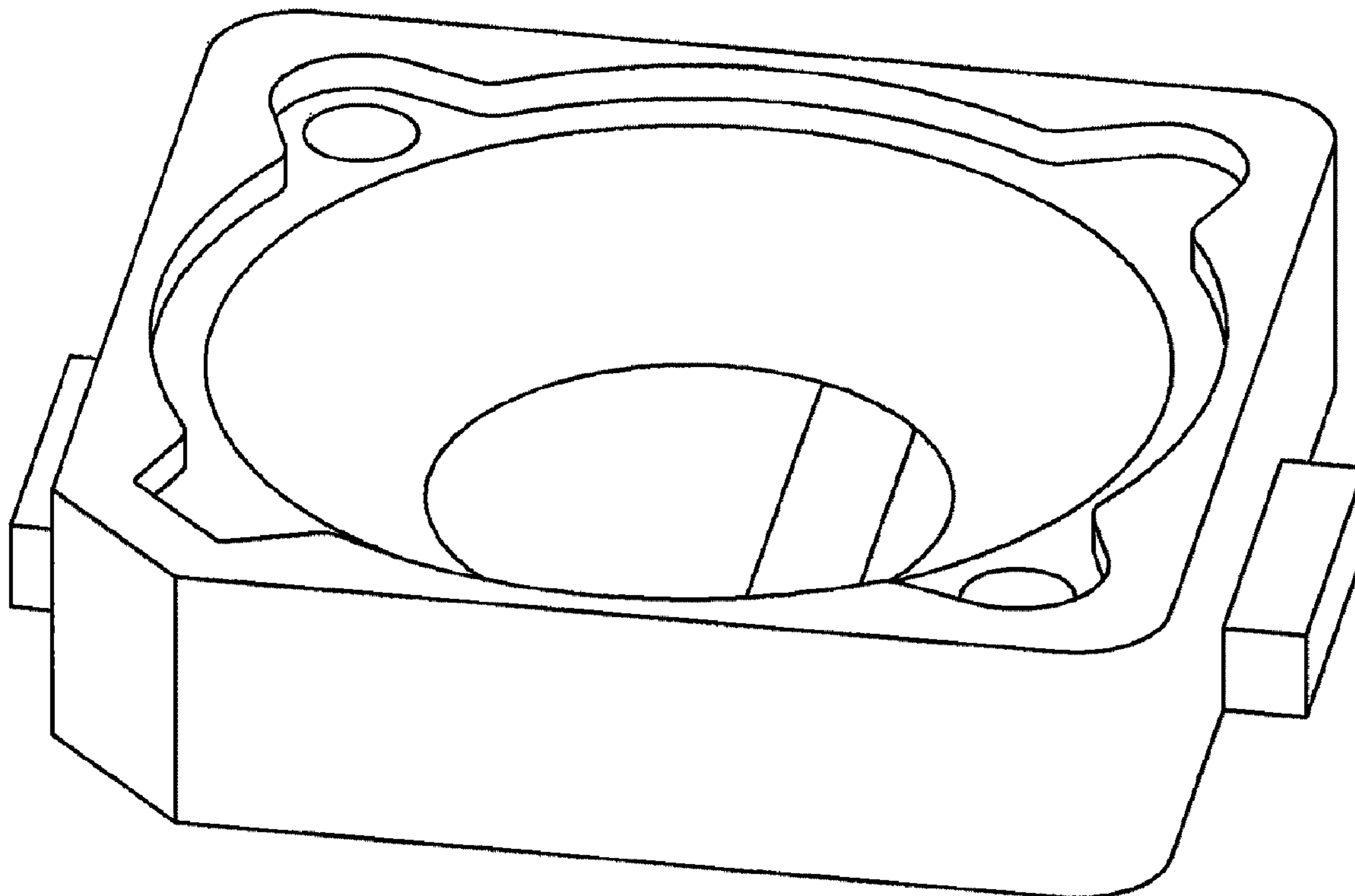

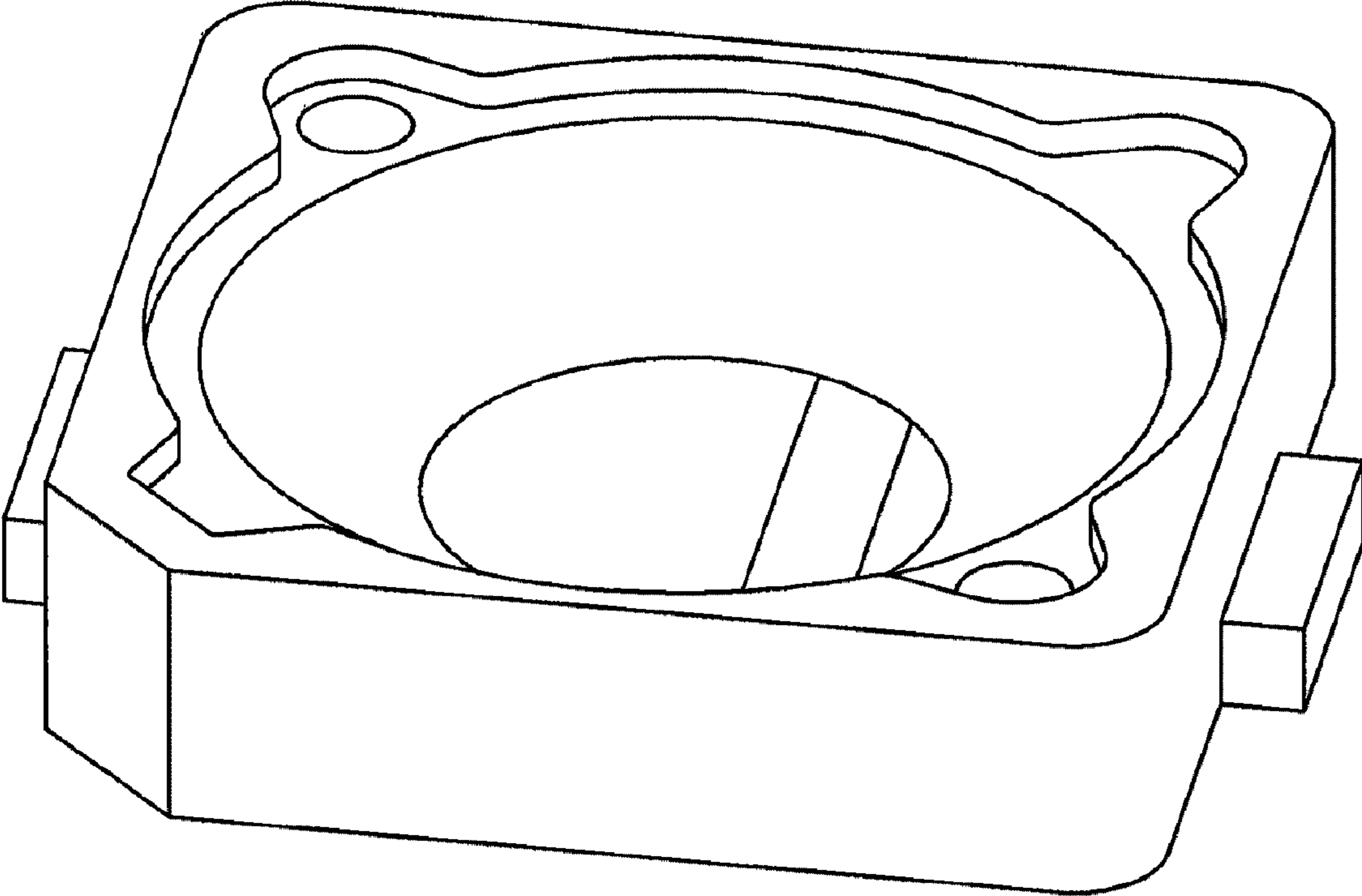

FIG. 1

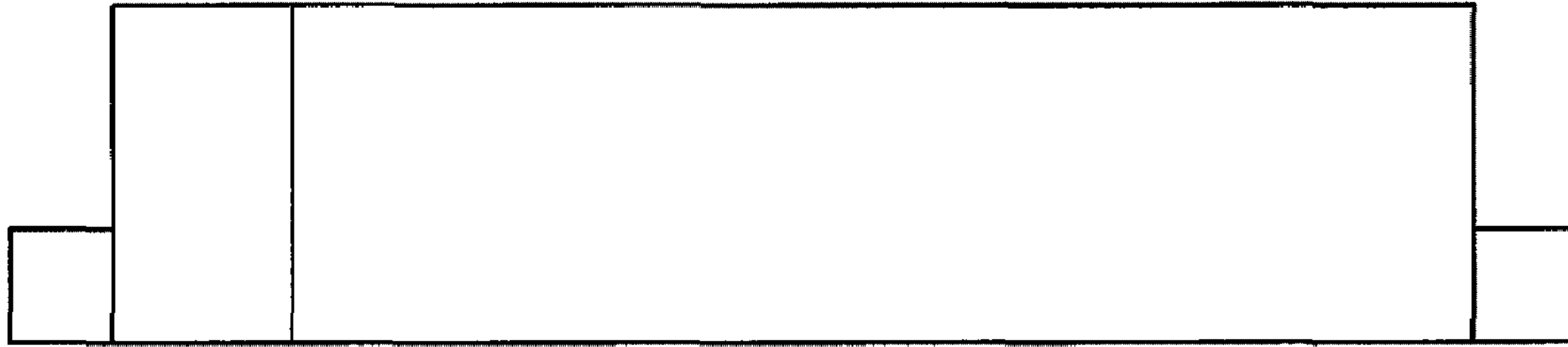

FIG. 2

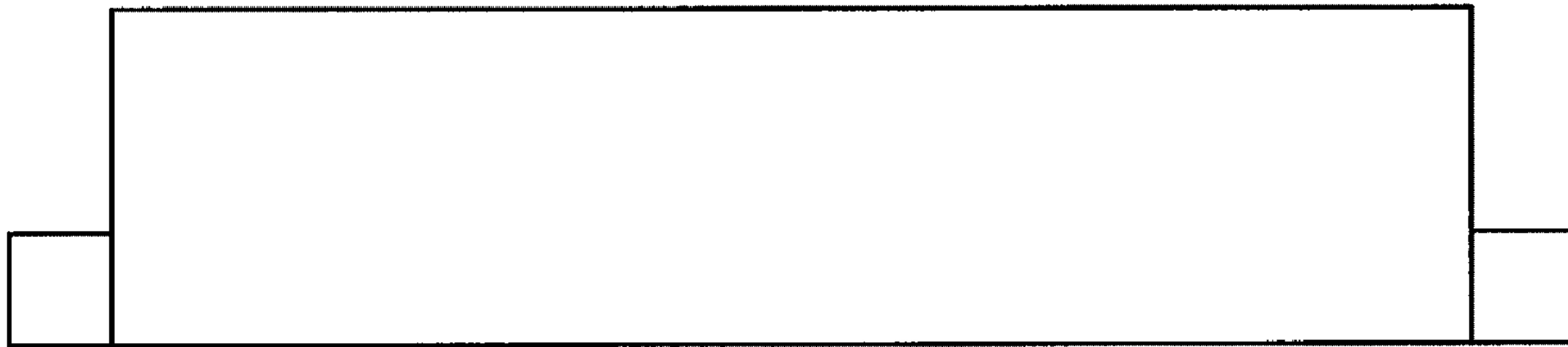

FIG. 3

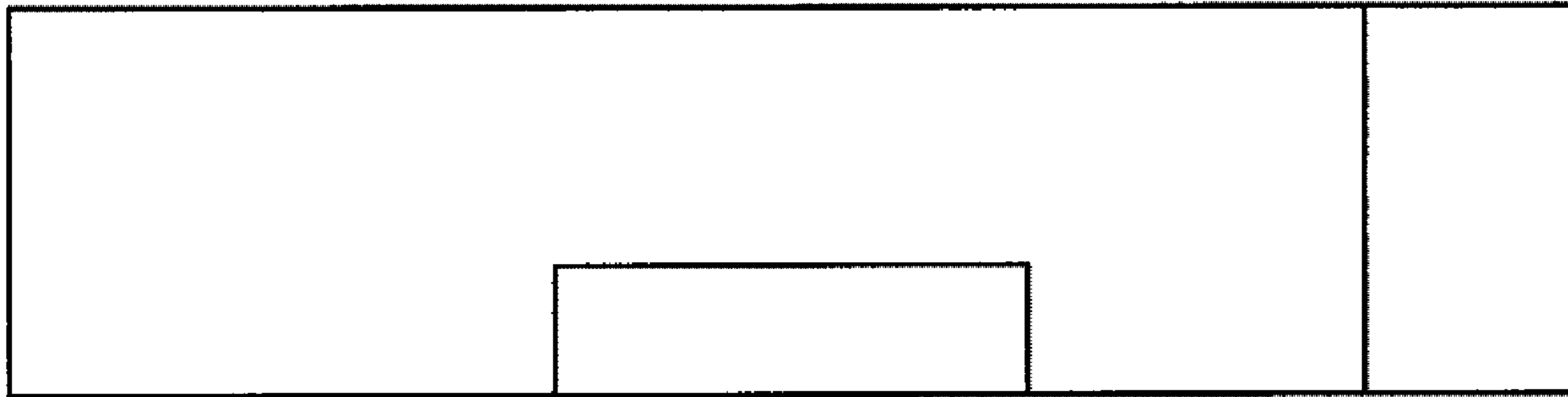

FIG. 4

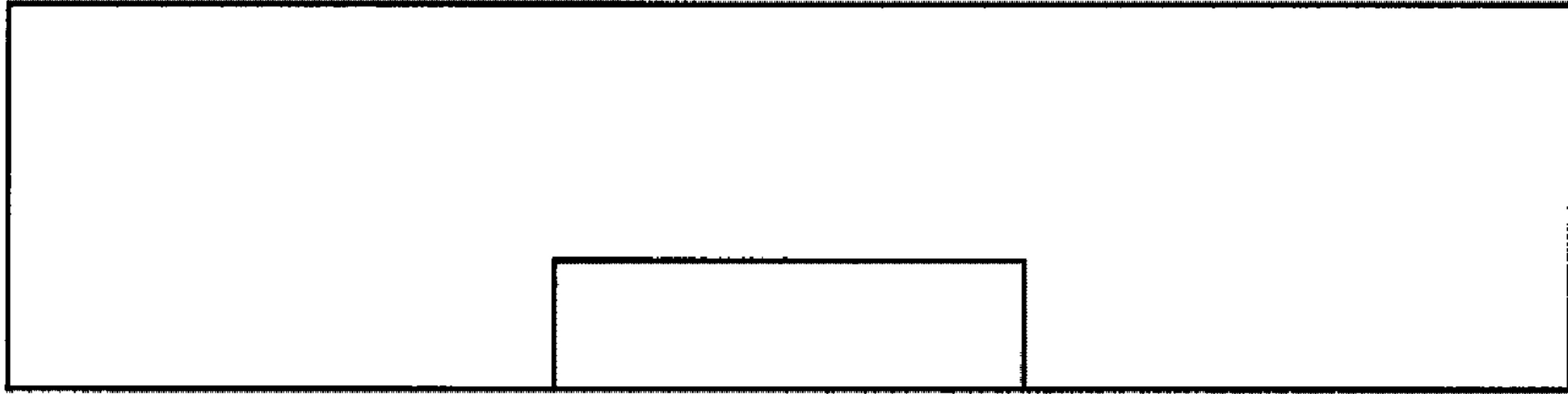

FIG. 5

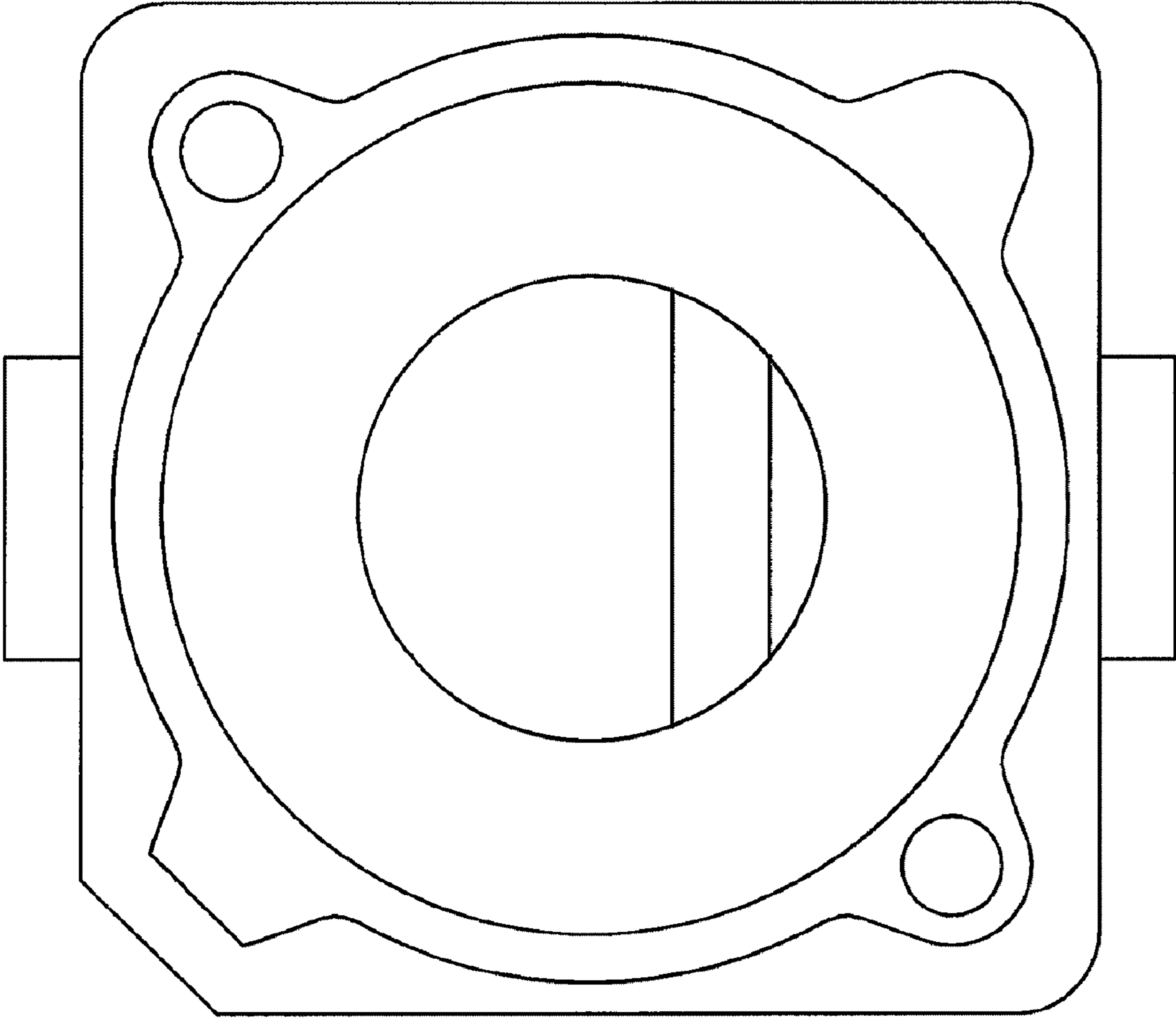

FIG. 6

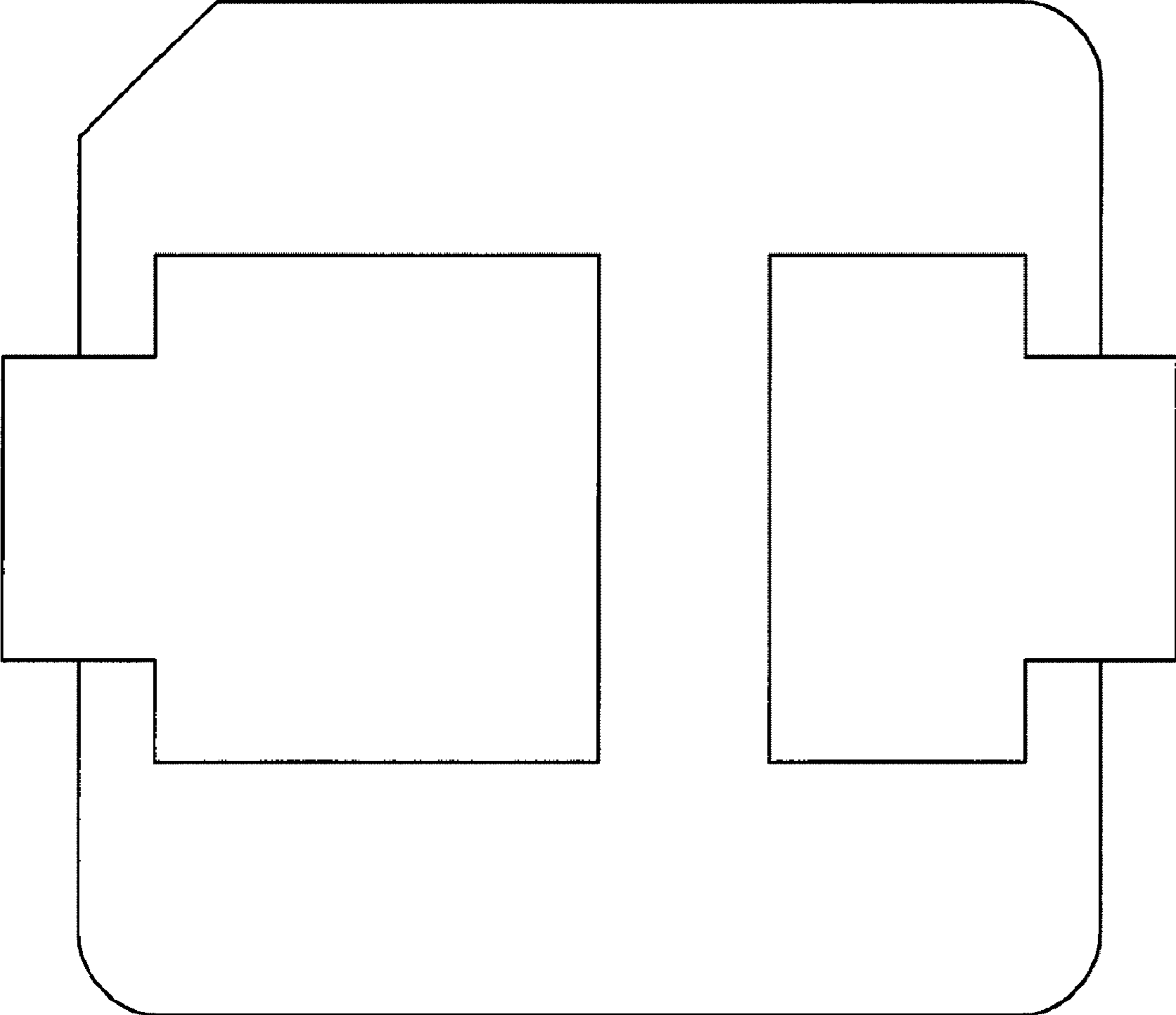

FIG. 7