



US00D642081S

(12) **United States Design Patent**  
**Kashimoto**

(10) **Patent No.:** **US D642,081 S**

(45) **Date of Patent:** **\*\* Jul. 26, 2011**

(54) **CONTROLLER FOR AIR CONDITIONER**

(75) Inventor: **Hiroko Kashimoto**, Kusatsu (JP)

(73) Assignee: **Daikin Industries Ltd.**, Osaka (JP)

(\*\*) Term: **14 Years**

(21) Appl. No.: **29/347,910**

(22) Filed: **Jul. 23, 2010**

(30) **Foreign Application Priority Data**

Jan. 26, 2010 (JP) ..... 2010-001742

(51) **LOC (9) Cl.** ..... **10-01**

(52) **U.S. Cl.** ..... **D10/49**

(58) **Field of Classification Search** ..... D10/49-50,  
D10/60, 74, 75, 80; D13/156, 162, 177;  
116/220-221, 206; 374/109, 142, 147, 148,  
374/163, 170, 208; 361/690, 699; 165/104.33;  
D14/371, 374

See application file for complete search history.

(56) **References Cited**

U.S. PATENT DOCUMENTS

D457,820 S \* 5/2002 Amborn et al. .... D10/49  
D553,091 S \* 10/2007 Lin et al. .... D13/147  
D591,410 S \* 4/2009 Kashimoto ..... D23/351  
D628,199 S \* 11/2010 Yukikado et al. .... D14/374

\* cited by examiner

*Primary Examiner* — Brian N Vinson

(74) *Attorney, Agent, or Firm* — Manabu Kanesaka

(57) **CLAIM**

The ornamental design for a controller for air conditioner, as shown and described.

**DESCRIPTION**

FIG. 1 is a perspective view of a controller for air conditioner showing my new design;  
FIG. 2 is a front view thereof;  
FIG. 3 is a rear view thereof;  
FIG. 4 is a plan view thereof;  
FIG. 5 is a bottom view thereof;  
FIG. 6 is a left side view thereof;  
FIG. 7 is a right side view thereof; and,  
FIG. 8 is a perspective view thereof, wherein a cover is open.  
The broken-line disclosure in the views is understood to represent portions of the article in which the claimed design is embodied, but which form no part of the claimed design.

**1 Claim, 4 Drawing Sheets**

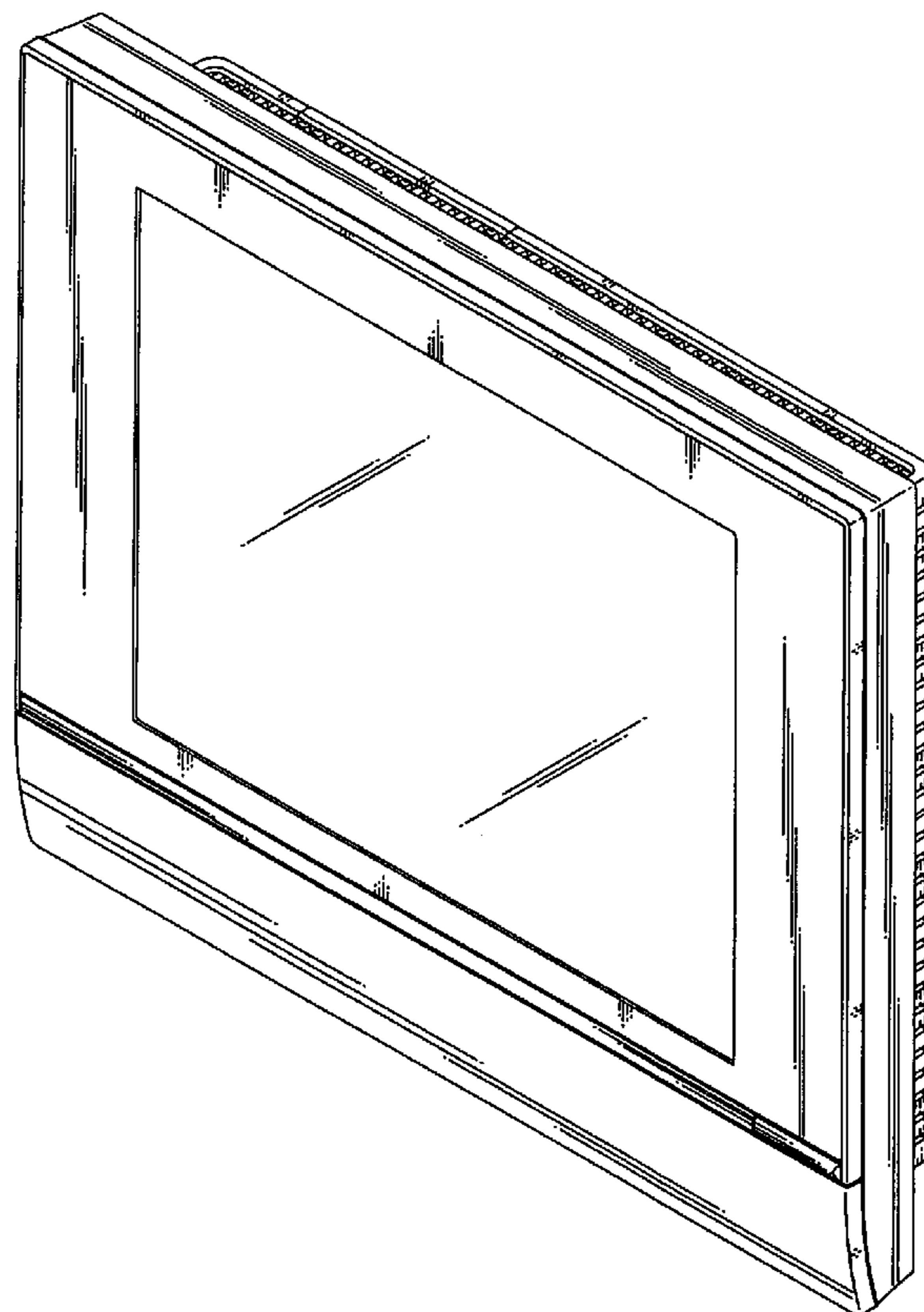

FIG. 1

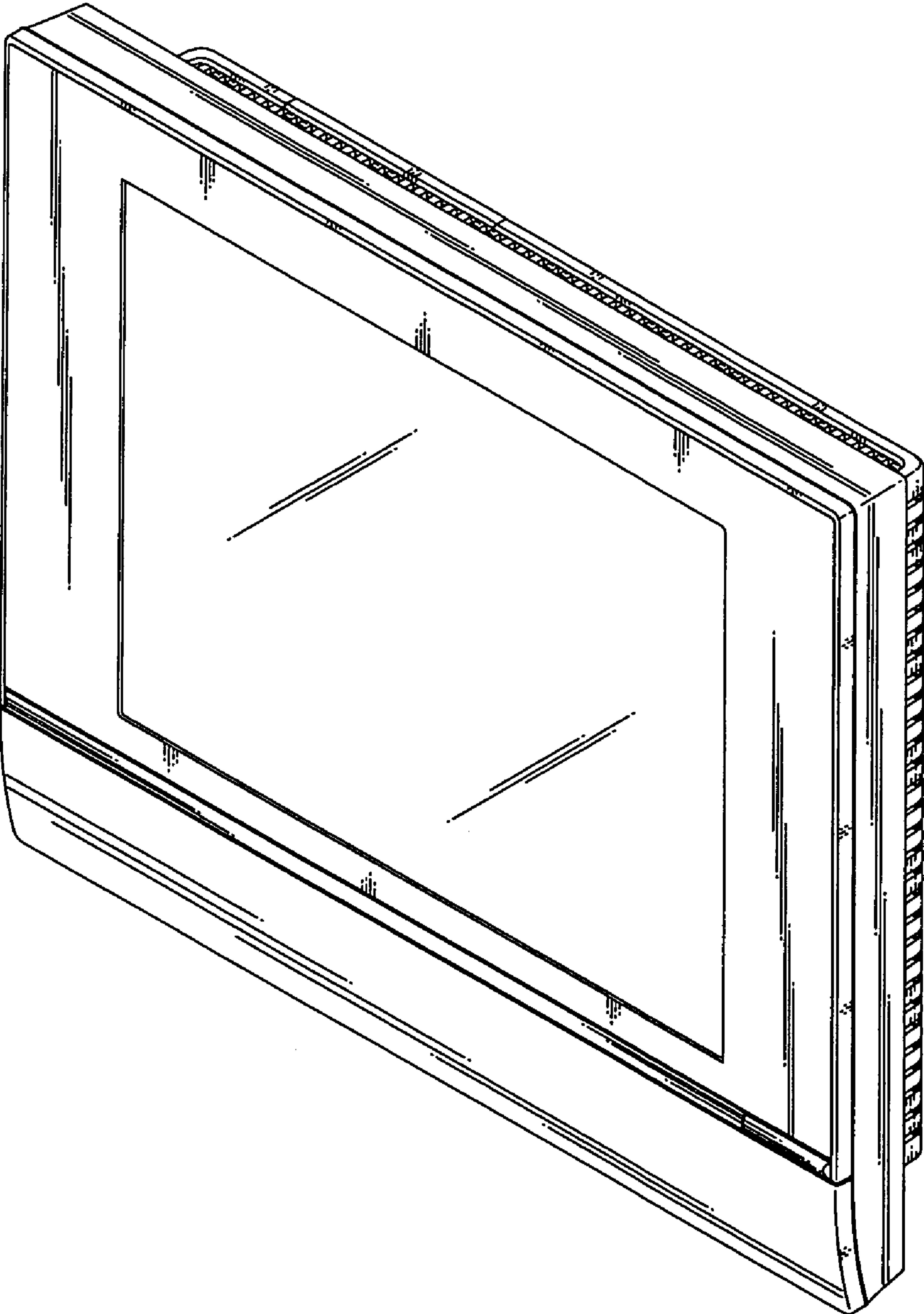

FIG. 2

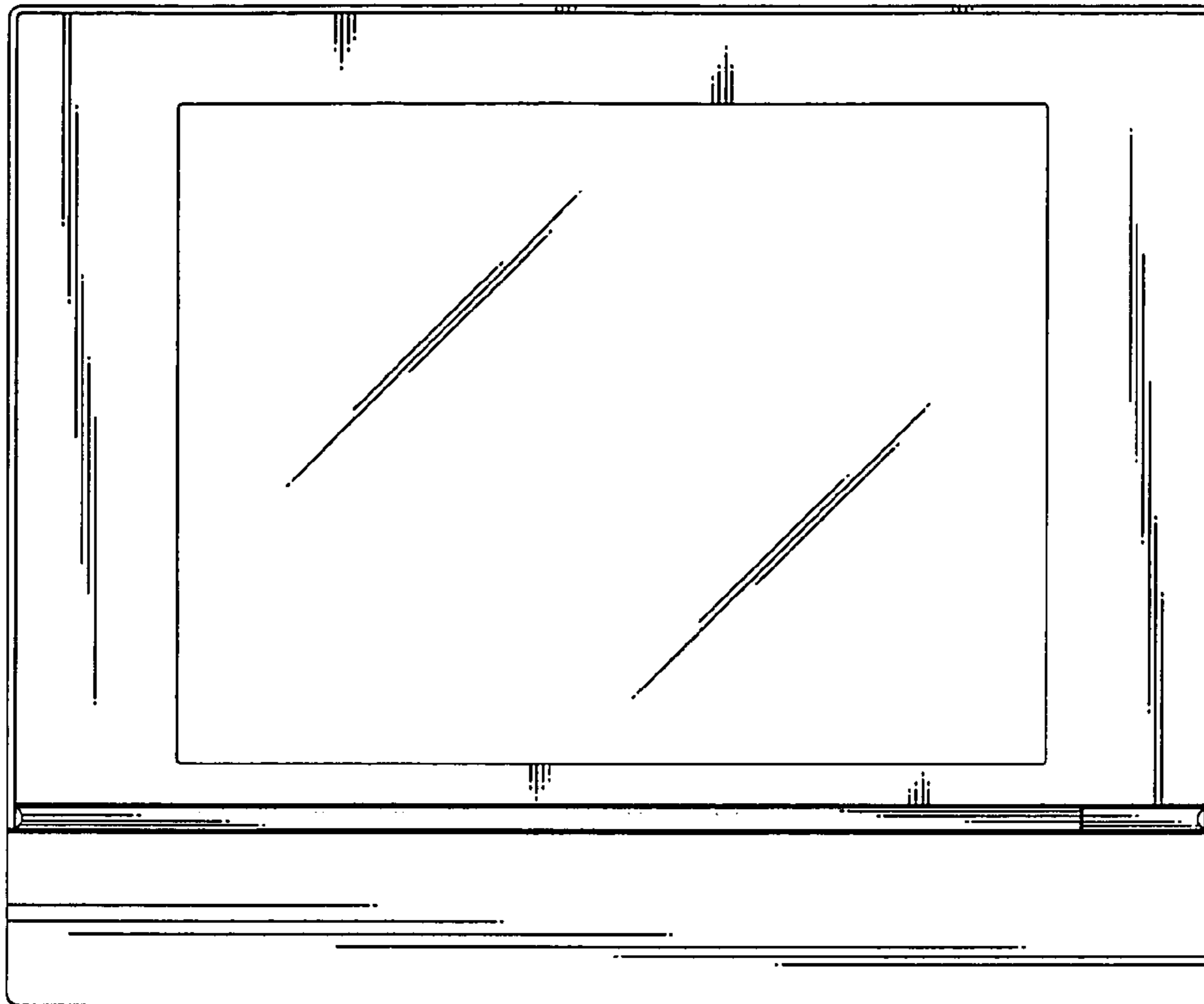

FIG. 3

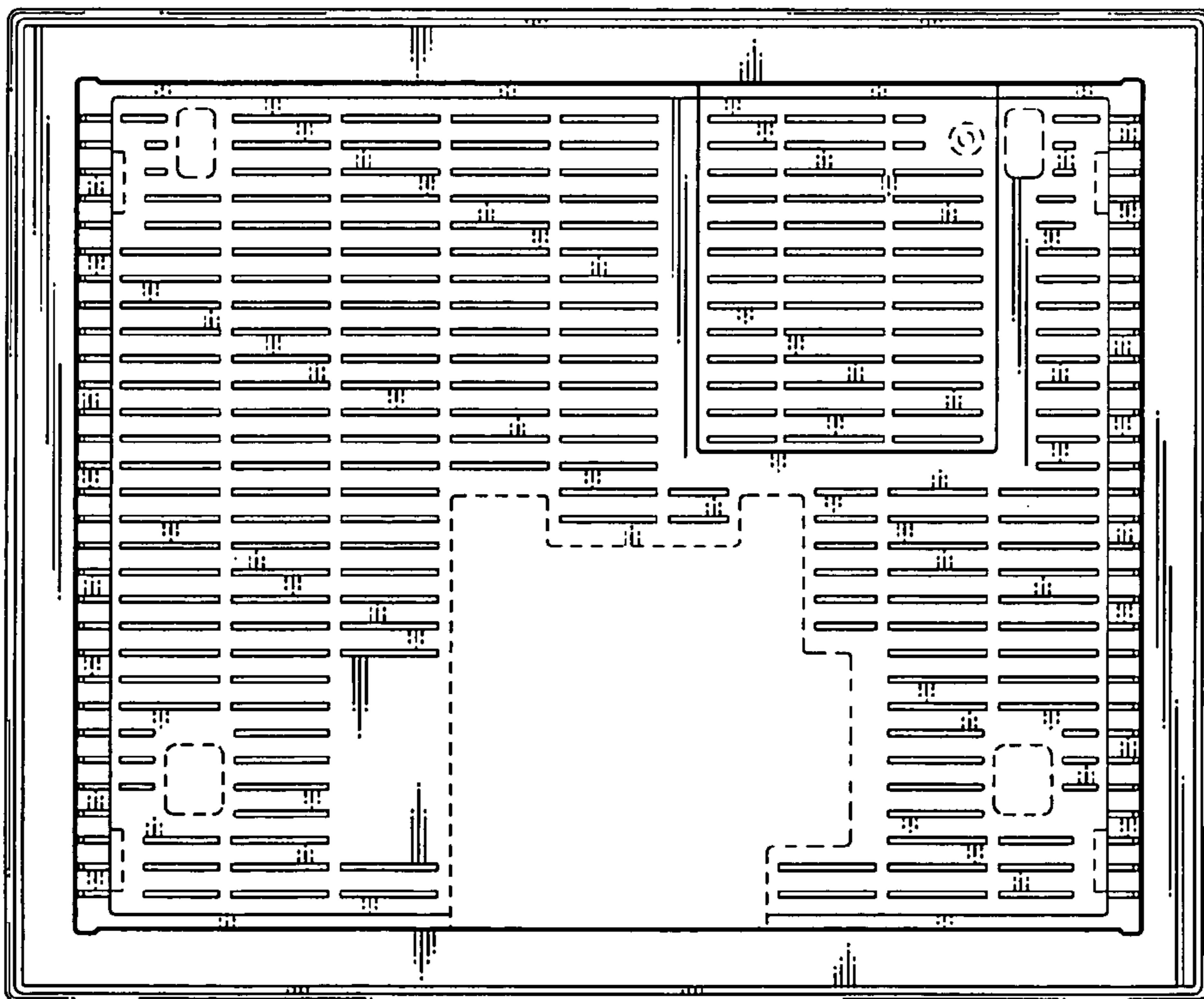

FIG. 4

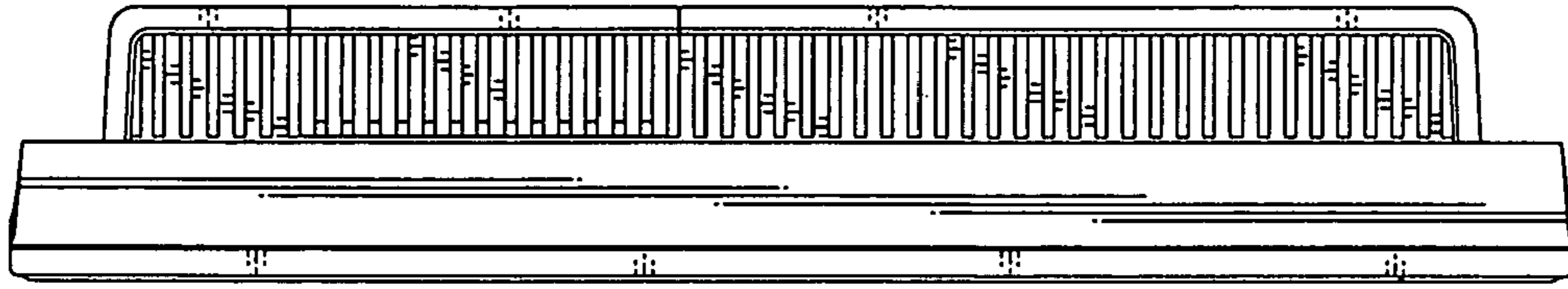

FIG. 5

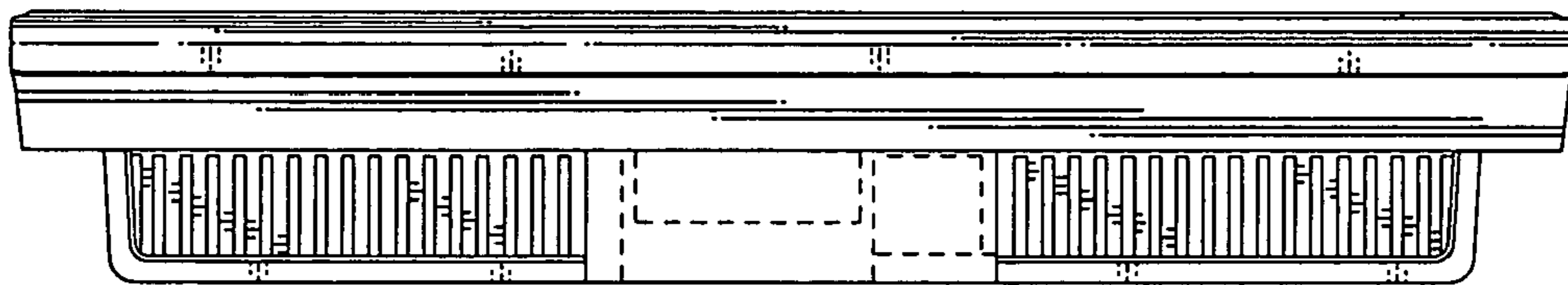

FIG. 6

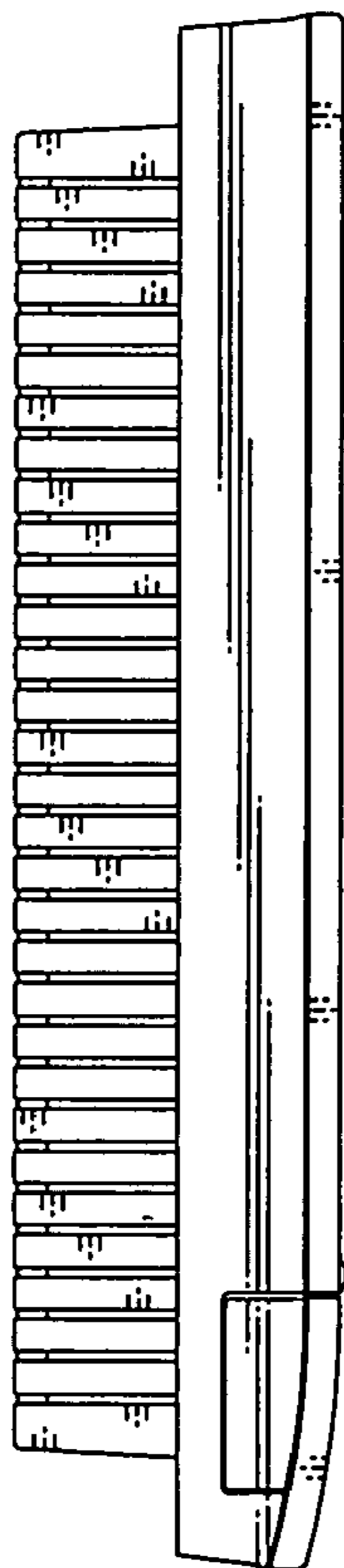

FIG. 7

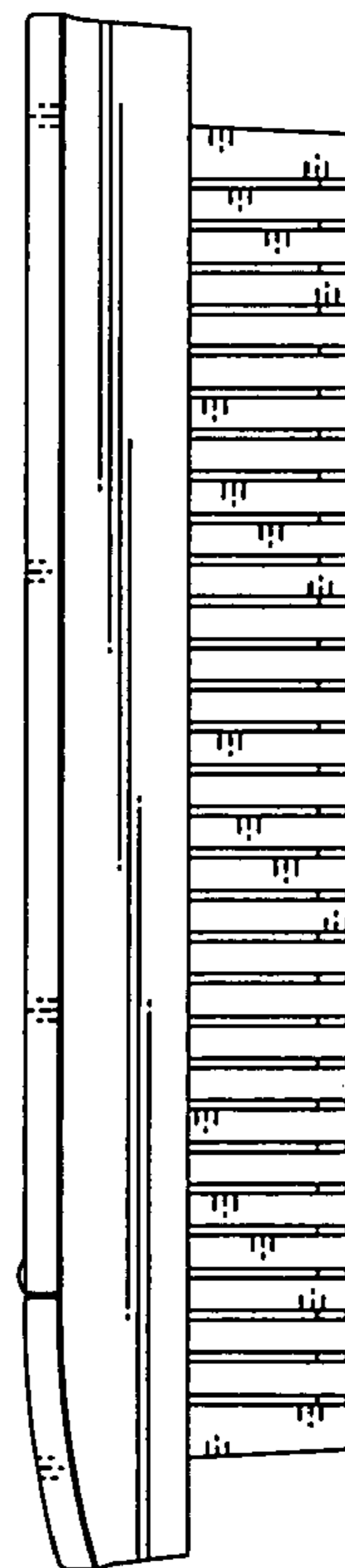

FIG. 8

