



US00D642060S

(12) **United States Design Patent**  
**Leclair et al.**

(10) **Patent No.:** **US D642,060 S**  
(45) **Date of Patent:** **\*\* Jul. 26, 2011**

(54) **BOTTLE WITH A CONICAL INTERNAL BOTTOM**

(75) Inventors: **Ronald Leclair**, Deux-Montagnes (CA);  
**Serge Turcotte**,  
Saint-Etienne-de-Lauzon, CA (US)

(73) Assignee: **Roy + Leclair Emballage Inc.**, Levis,  
Québec (CA)

(\*\*) Term: **14 Years**

(21) Appl. No.: **29/304,525**

(22) Filed: **Mar. 4, 2008**

(51) **LOC (9) Cl.** ..... **09-01**

(52) **U.S. Cl.** ..... **D9/516; D9/520**

(58) **Field of Classification Search** ..... D9/737,  
D9/738, 739, 741, 744, 745, 500, 516, 520,  
D9/548, 549, 558, 574; 215/6, 10, 393, 395,  
215/379, 381-385; 220/500-506, 527, 529,  
220/660, 669

See application file for complete search history.

(56) **References Cited**

U.S. PATENT DOCUMENTS

567,199	A *	9/1896	Rively	215/6
D209,244	S *	11/1967	Koenigsberg	D9/548
3,927,782	A *	12/1975	Edwards	215/372
3,948,404	A *	4/1976	Collins et al.	215/372
D247,578	S	3/1978	Sponseller	
4,241,839	A *	12/1980	Alberghini	215/376
D258,534	S	3/1981	Nagel	
4,438,856	A *	3/1984	Chang	215/12.1
4,552,275	A *	11/1985	Chang et al.	215/372
D284,837	S *	7/1986	Nilsson	D9/503
D288,293	S *	2/1987	Arvans	D9/500
D289,937	S *	5/1987	Cleveland, Jr.	D34/39
4,880,126	A *	11/1989	Anderson	215/386
D305,601	S *	1/1990	Hewson	D7/368
D316,035	S *	4/1991	Pepitone	D9/745
5,062,537	A *	11/1991	Hayashi	215/12.1
5,062,549	A	11/1991	Smith et al.	
D332,919	S *	2/1993	Turnbull et al.	D9/500

5,295,598	A *	3/1994	Gerlach et al.	215/376
5,400,911	A *	3/1995	Mahajan	215/400
D378,847	S	4/1997	Ey	
D381,141	S *	7/1997	Balz	D32/29.1
D383,264	S *	9/1997	Balz	D32/29.1
D401,697	S	11/1998	Cloonan et al.	

(Continued)

FOREIGN PATENT DOCUMENTS

WO 9838095 9/1998

(Continued)

*Primary Examiner* — Stella Reid

*Assistant Examiner* — Elizabeth J Oswecki

(74) *Attorney, Agent, or Firm* — Norton Rose Or LLP

(57) **CLAIM**

The ornamental design for a bottle with a conical internal bottom, as shown and described.

**DESCRIPTION**

FIG. 1 is a perspective view of a bottle with a conical internal bottom showing my new design;  
 FIG. 2 is a top plan view thereof;  
 FIG. 3 is a side elevation view thereof;  
 FIG. 4 is a bottom plan view thereof;  
 FIG. 5 is a sectional view along cross-section lines 5—5 of FIG. 2 thereof showing a conical internal bottom of the upper section having a groove defined internally therein;  
 FIG. 6 is a sectional view along cross-section lines 6—6 of FIG. 2 thereof showing the conical internal bottom with the internal groove;  
 FIG. 7 is a sectional view along cross-section lines 7—7 of FIG. 3 thereof showing the conical internal bottom with the internal groove;  
 FIG. 8 is a perspective view of the upper section of the bottle shown in FIG. 1;  
 FIG. 9 is a side elevation view of the upper section; and,  
 FIG. 10 is a bottom plan view of the upper section.  
 The parts shown in dotted lines form no part of the invention.

**1 Claim, 6 Drawing Sheets**

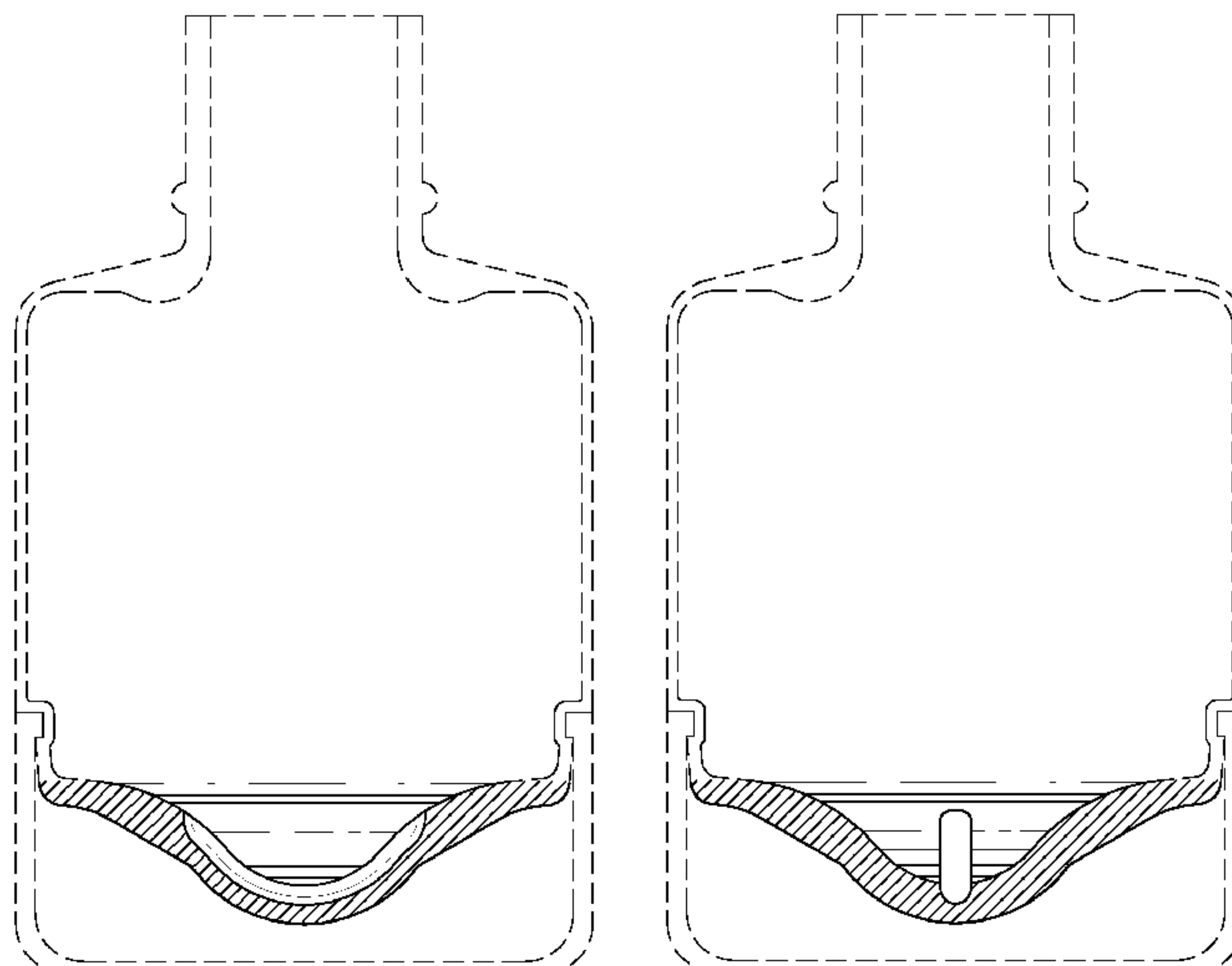

# US D642,060 S

Page 2

## U.S. PATENT DOCUMENTS

D406,062 S \* 2/1999 Brewer ..... D9/520  
D407,020 S \* 3/1999 Doty ..... D9/520  
6,024,244 A \* 2/2000 Hicks ..... 220/603  
D422,906 S \* 4/2000 Mellish ..... D9/745  
D426,160 S \* 6/2000 Lindsay et al. .... D9/500  
D441,657 S \* 5/2001 Brown, III ..... D9/764  
D445,908 S \* 7/2001 Conway ..... D24/224  
D447,419 S 9/2001 Jaketic  
D448,289 S \* 9/2001 Yuen et al. .... D9/428  
D454,498 S \* 3/2002 Darr et al. .... D9/520  
D456,075 S \* 4/2002 Clements et al. .... D24/121  
D459,658 S \* 7/2002 Darr et al. .... D9/520

D487,697 S \* 3/2004 Rosen ..... D9/745  
6,756,008 B2 6/2004 Sudo  
D515,940 S \* 2/2006 Kratko ..... D9/745  
D528,422 S \* 9/2006 Darr et al. .... D9/516  
D534,079 S \* 12/2006 Livingston ..... D9/516  
D554,764 S 11/2007 Gerretz et al.  
D563,238 S \* 3/2008 Nevins et al. .... D9/684  
D599,208 S \* 9/2009 Kissinger et al. .... D9/516  
D612,735 S \* 3/2010 Leclair et al. .... D9/516

## FOREIGN PATENT DOCUMENTS

WO 089383 8/2006

\* cited by examiner

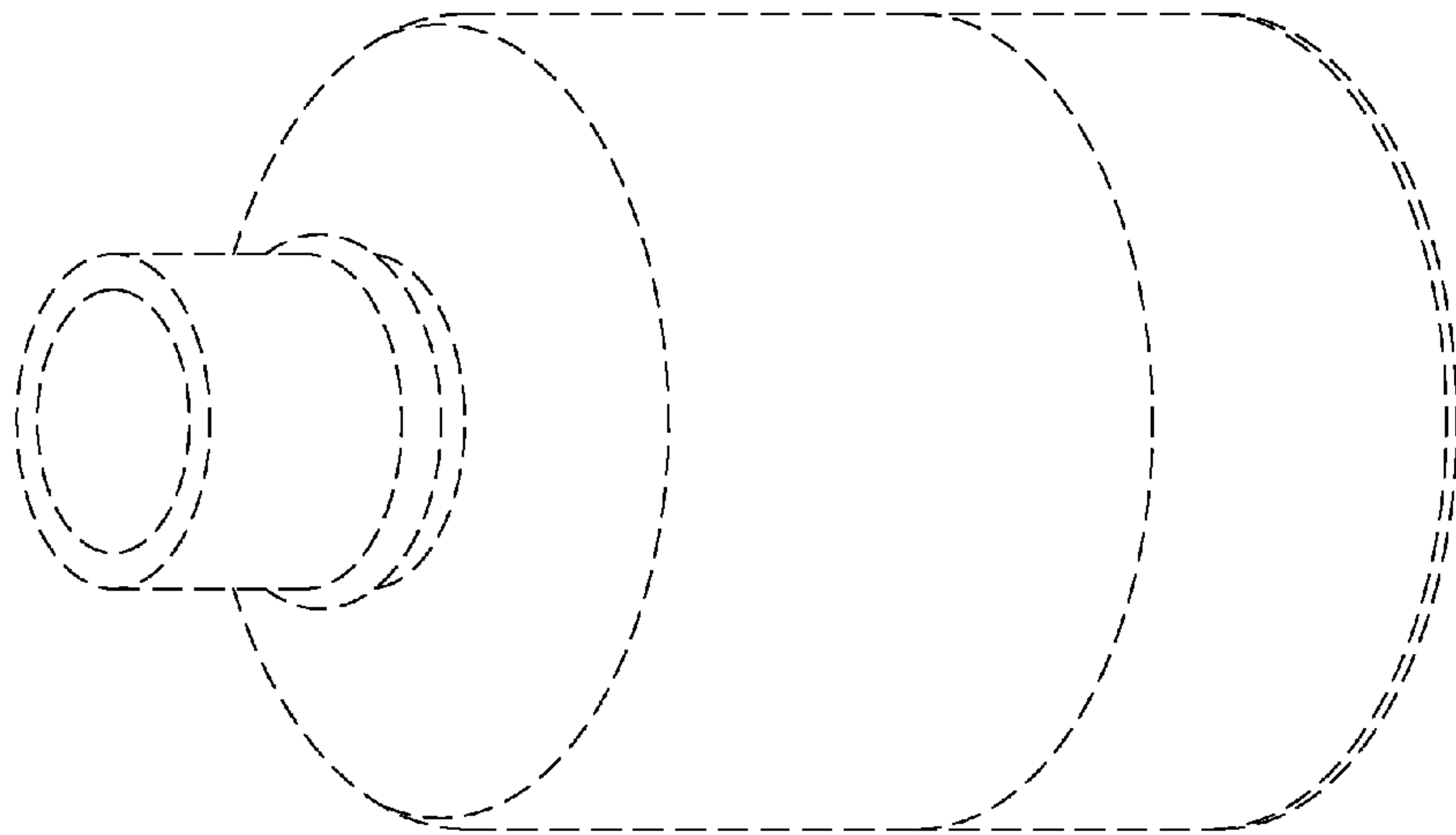

*FIG. 1*

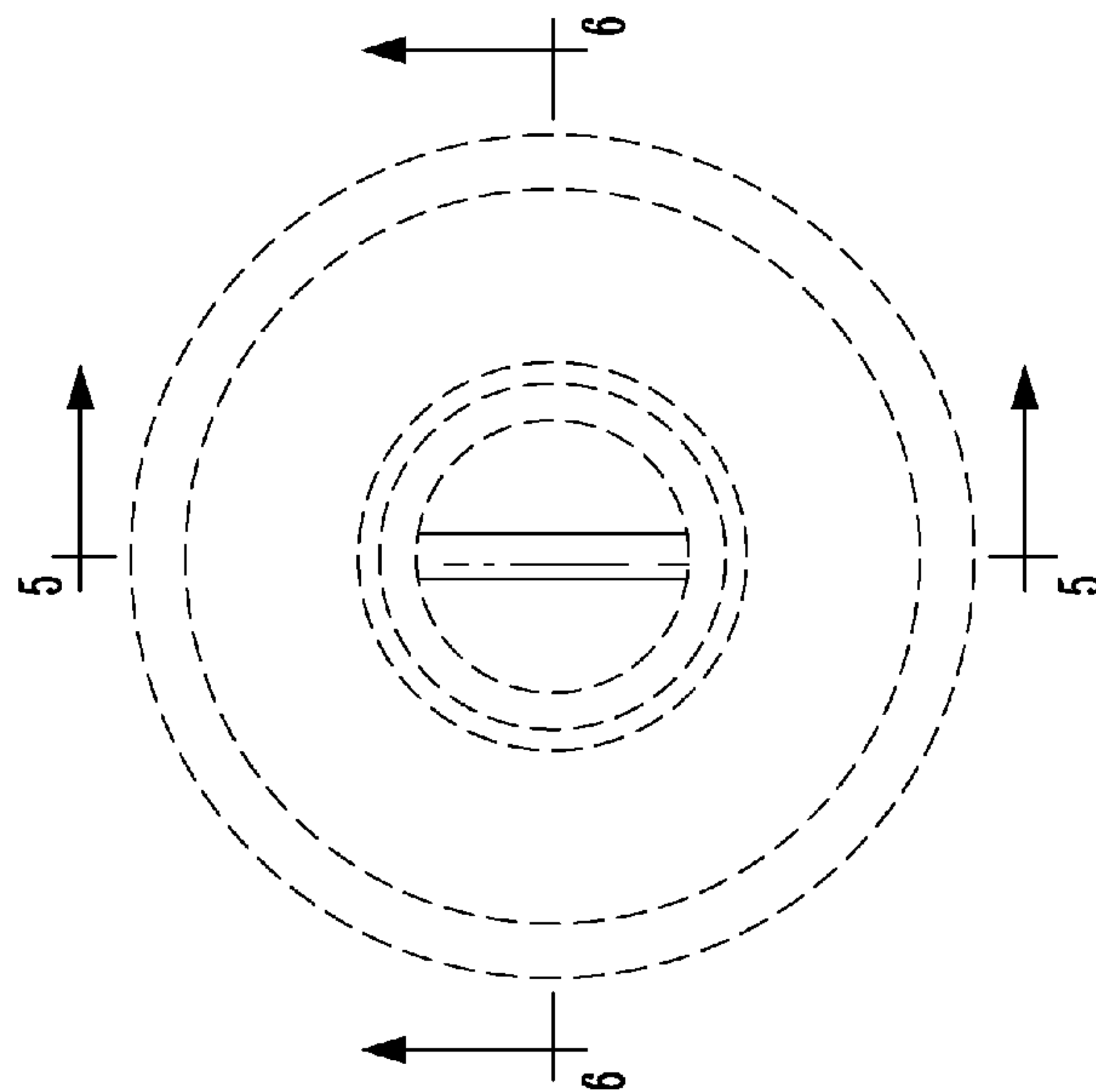
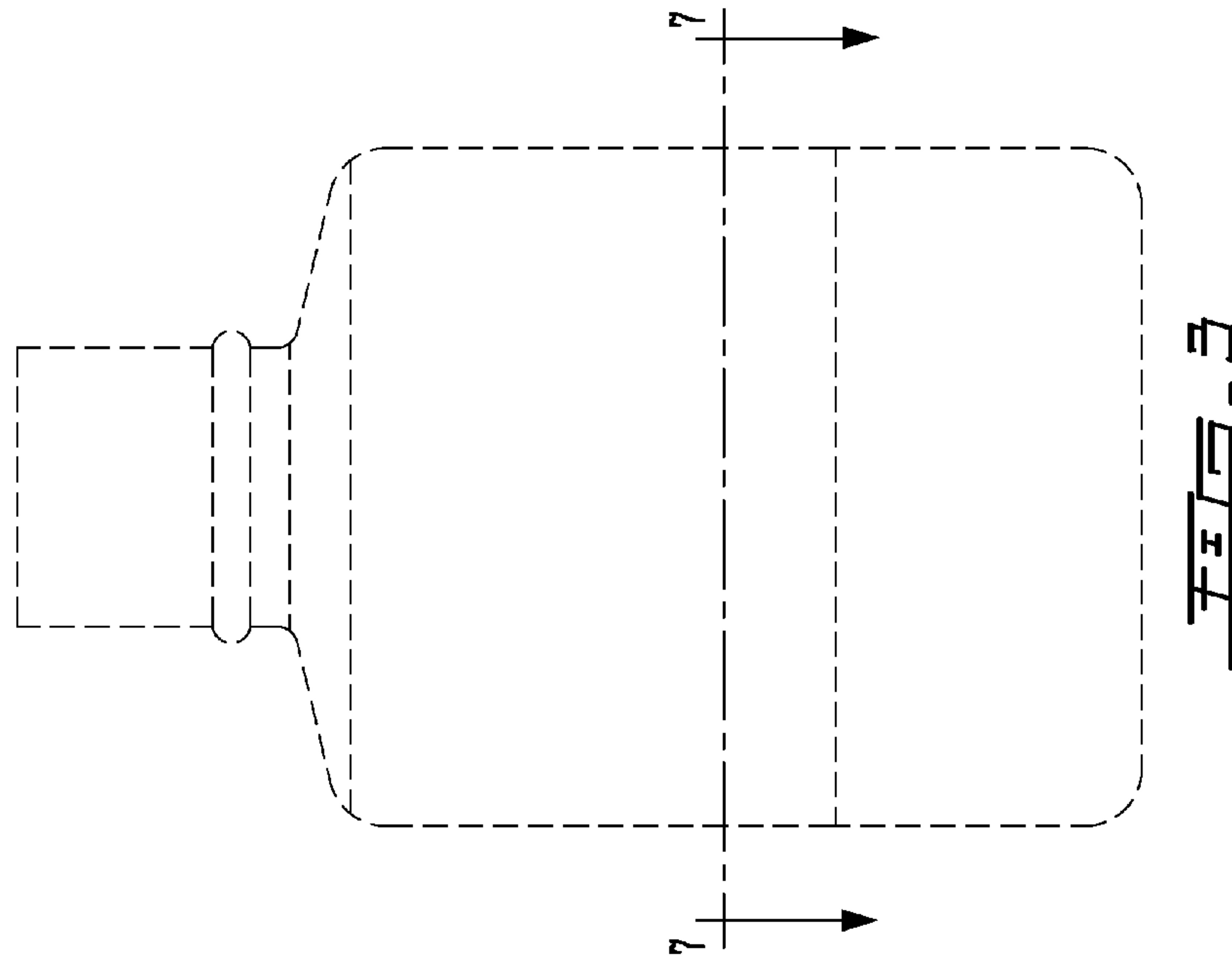

FIG. 2

FIG. 3

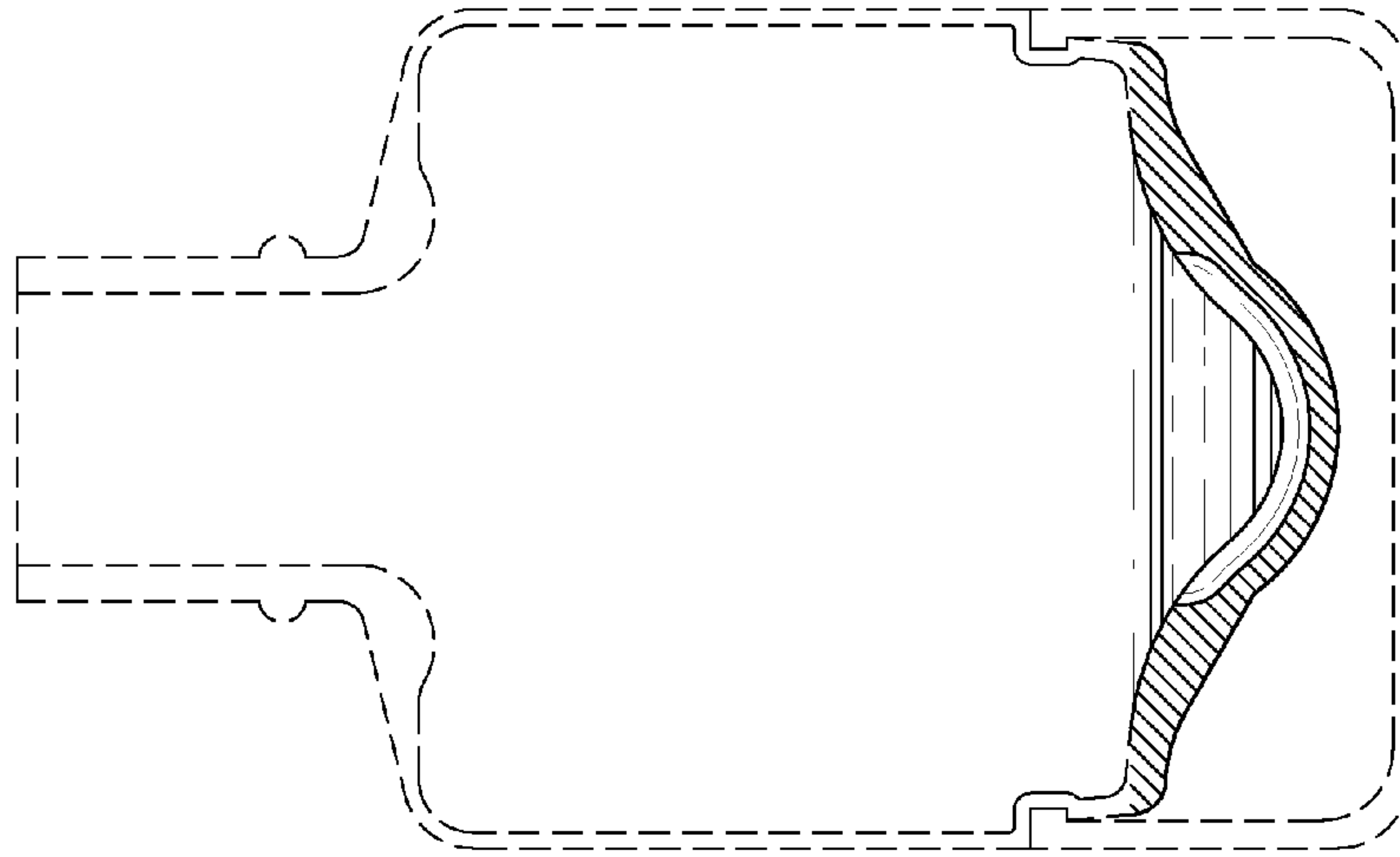

FIG. 5

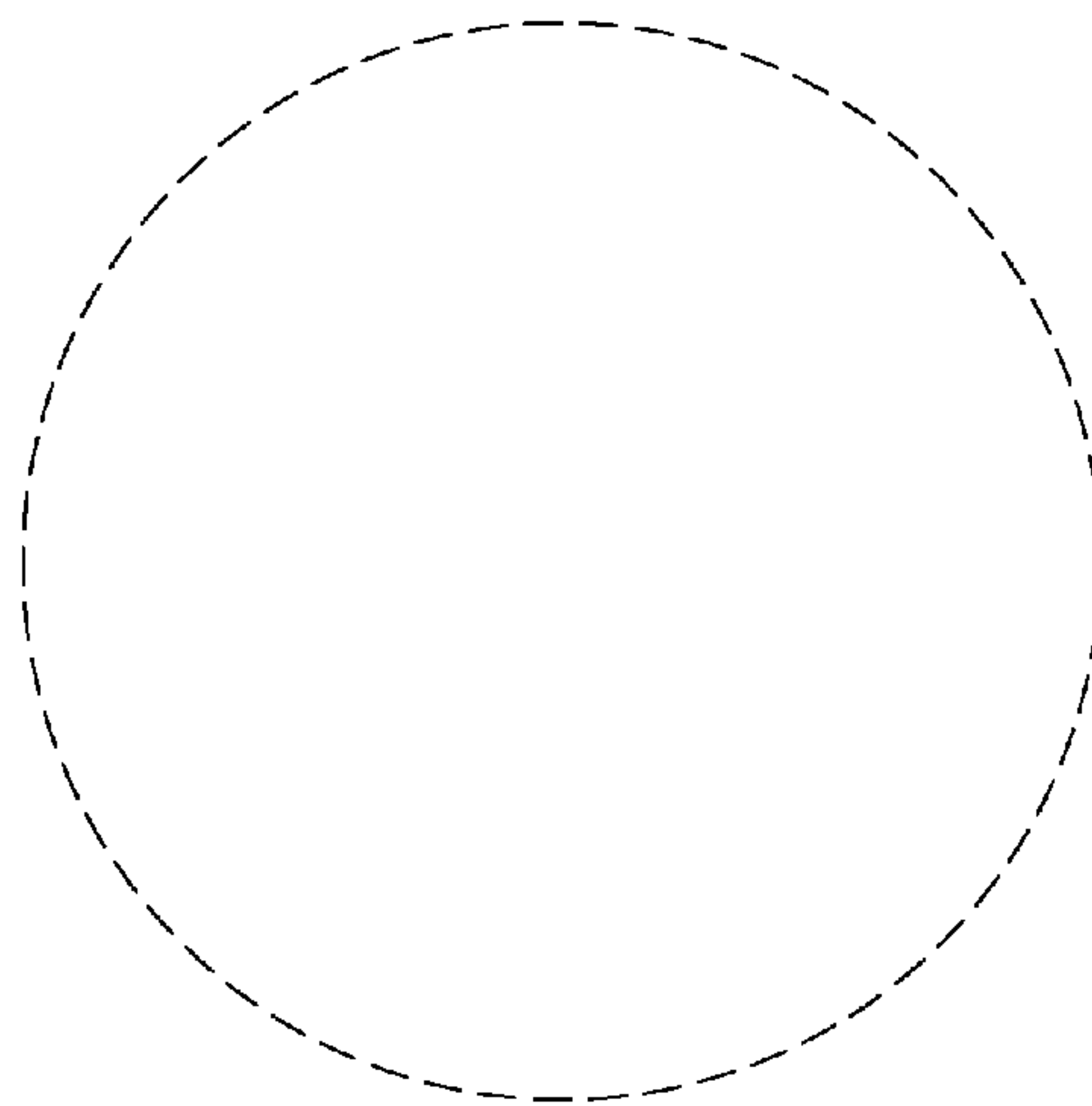

FIG. 4

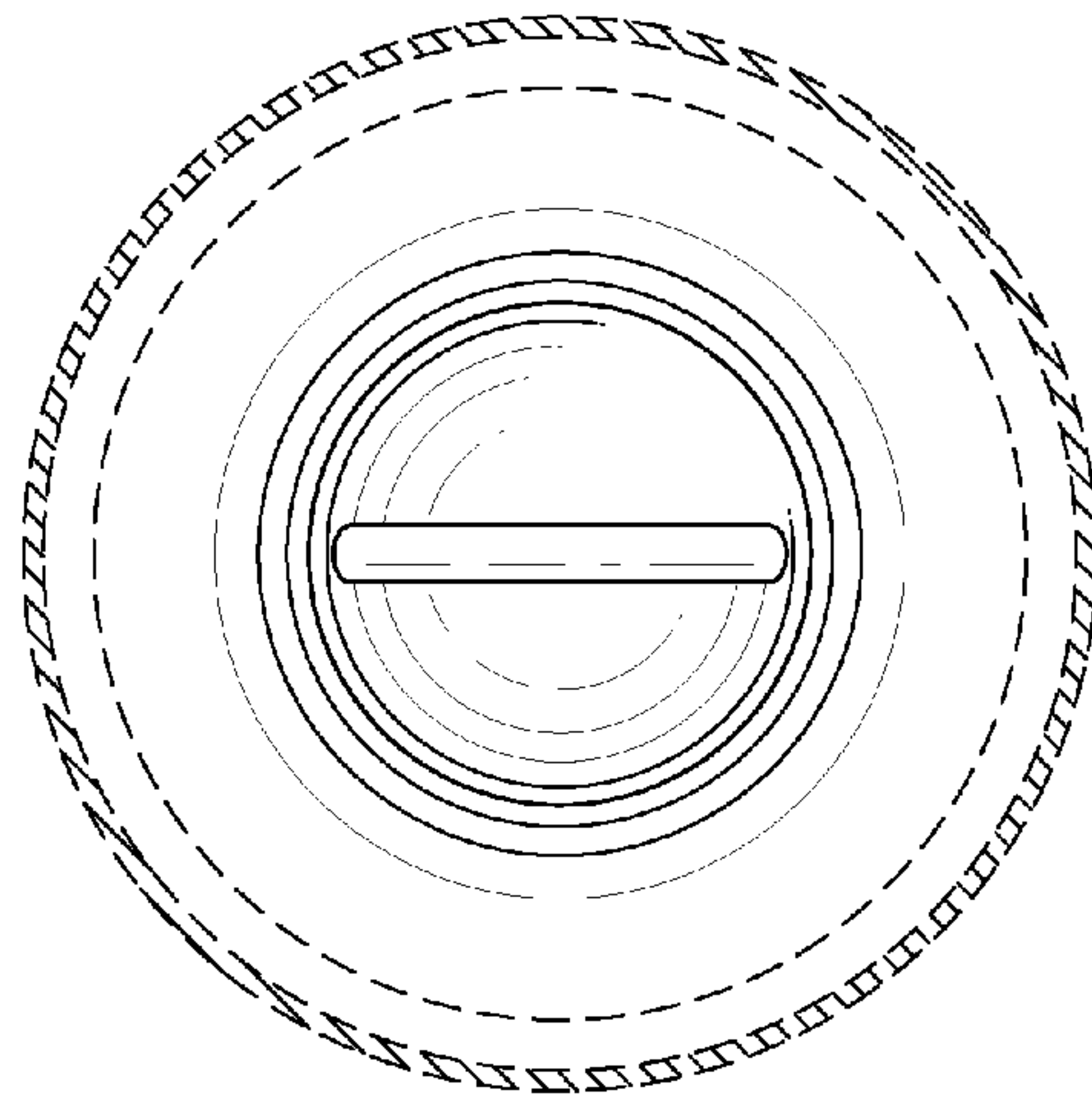

FIG. 7

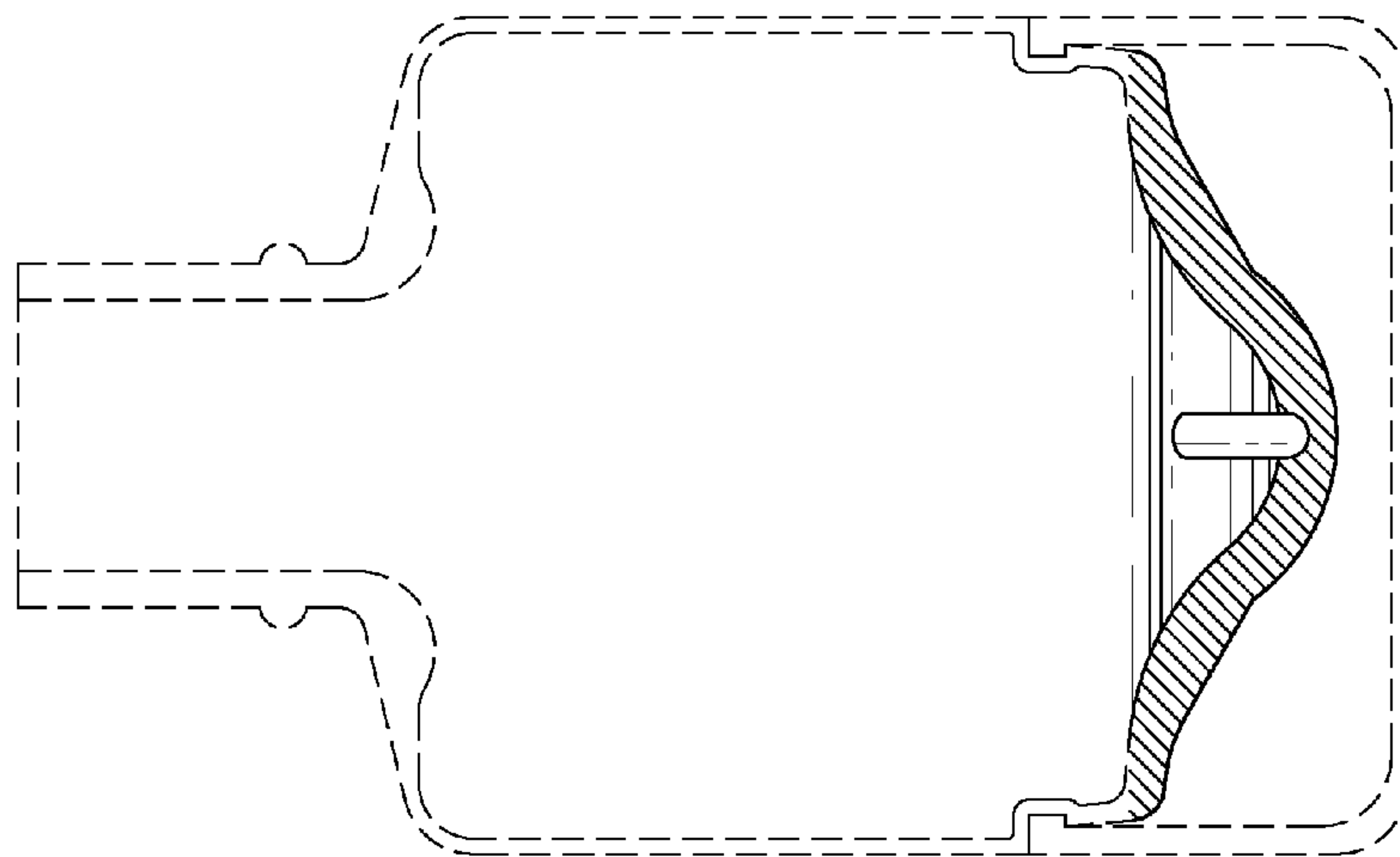

FIG. 8

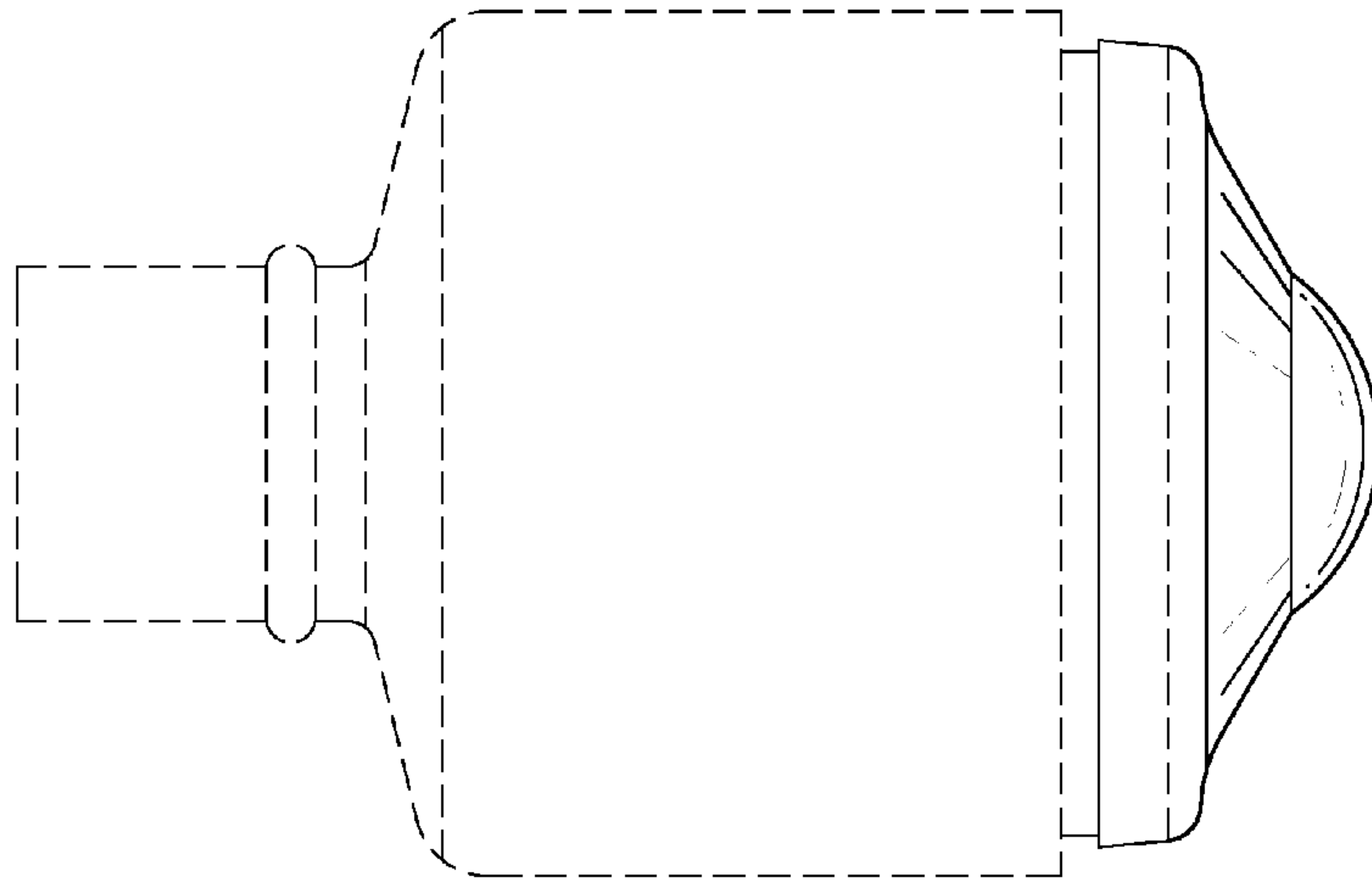

FIG. 8

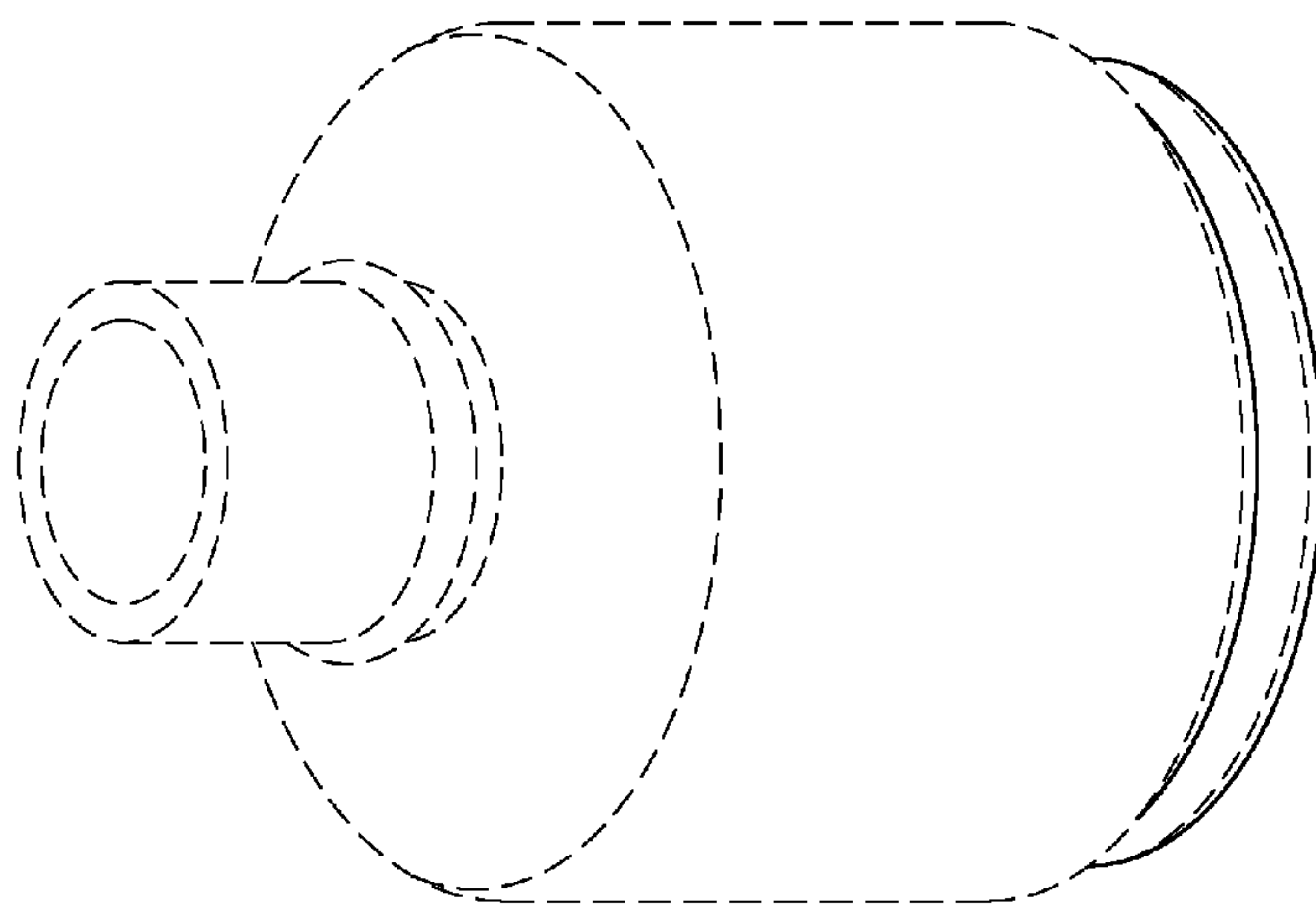
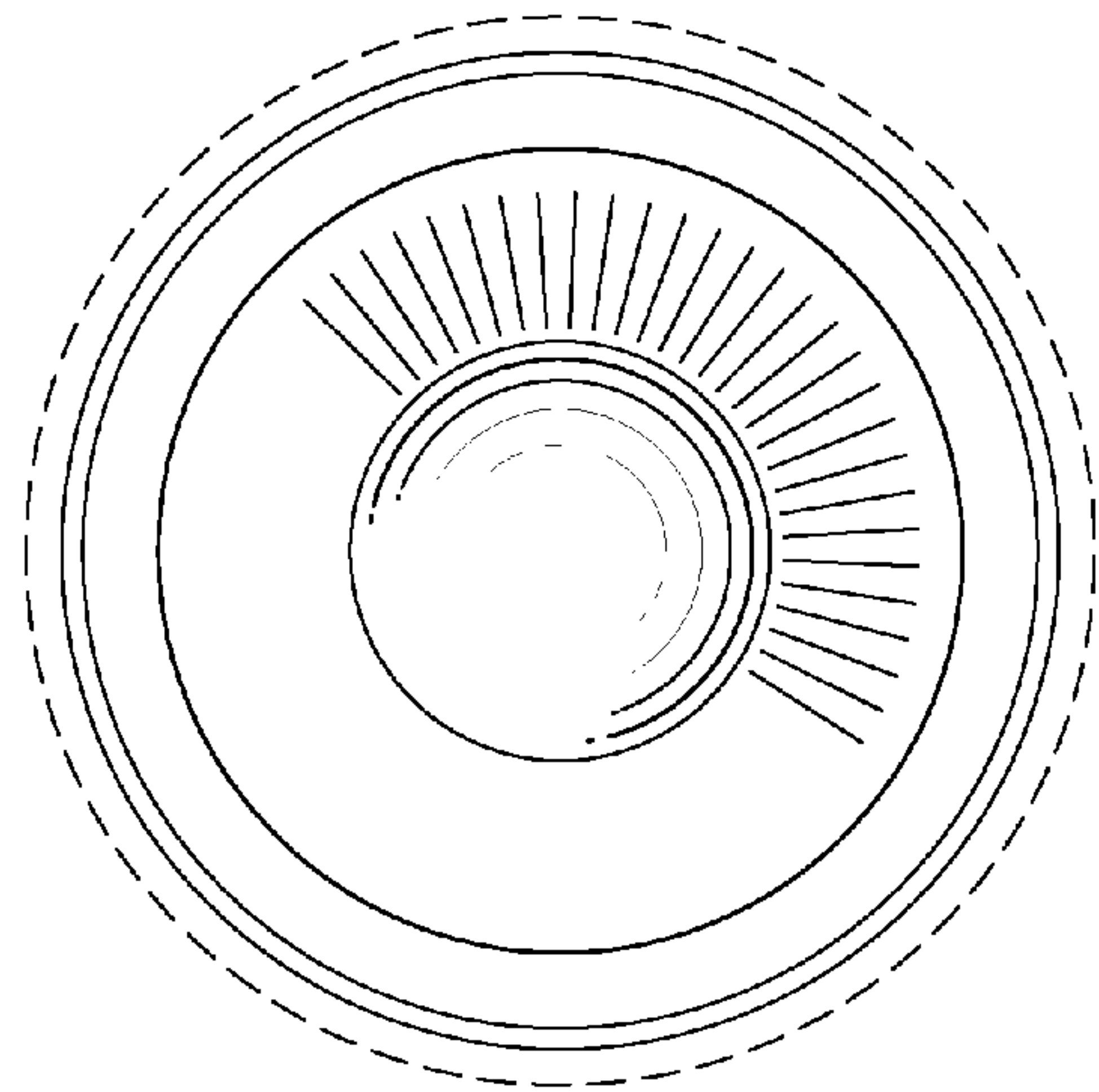

FIG. 9





*FIG. 10*