



US00D641377S

(12) **United States Design Patent**
Luxon et al.

(10) **Patent No.:** **US D641,377 S**
(45) **Date of Patent:** **** Jul. 12, 2011**

(54) **AIR INTAKE FILTER CONNECTOR FOR A VEHICLE SNORKEL**
(75) Inventors: **Peter Luxon**, South Croydon (AU);
Manvir Randhawa, South Croydon (AU)
(73) Assignee: **Australian Performance Development Pty Ltd**, South Croydon VIC (AU)

(**) Term: **14 Years**
(21) Appl. No.: **29/347,717**
(22) Filed: **Apr. 20, 2010**

(30) **Foreign Application Priority Data**
Oct. 20, 2009 (AU) 14061/2009
(51) **LOC (9) Cl.** **15-01**
(52) **U.S. Cl.** **D15/5; D12/400**
(58) **Field of Classification Search** D15/1-6;
123/184.21, 184.24, 184.34, 184.35, 23.2,
123/184.48, 184.42; D12/400, 194, 206,
D12/418; D24/110.5, 110.6
See application file for complete search history.

(56) **References Cited**
U.S. PATENT DOCUMENTS
6,564,766 B2 * 5/2003 Ayton 123/184.21
6,637,537 B2 * 10/2003 Porter et al. 180/309
6,966,292 B2 * 11/2005 Huang 123/184.21
D532,019 S * 11/2006 Huang D15/5
D545,725 S * 7/2007 Zimbardo D12/114
7,281,511 B2 * 10/2007 Quezada 123/184.53
D562,749 S * 2/2008 LaRussa D12/194

7,685,985 B2 * 3/2010 Madeira 123/184.21
D627,369 S * 11/2010 Troxell D15/5
2002/0179030 A1 * 12/2002 Fiesel et al. 123/184.42
2003/0019456 A1 * 1/2003 Ayton 123/184.21
2006/0185639 A1 * 8/2006 Rosenbaum 123/184.21
2006/0196462 A1 * 9/2006 Quezada 123/184.21
2010/0083928 A1 * 4/2010 Saito et al. 123/184.56
2010/0229817 A1 * 9/2010 Hirai 123/184.21
2010/0229818 A1 * 9/2010 Silvano 123/184.21

* cited by examiner
Primary Examiner — T. Chase Nelson
Assistant Examiner — Ania Dworzecka
(74) *Attorney, Agent, or Firm* — Duane Morris LLP

(57) **CLAIM**
The ornamental design for an air intake filter connector for a vehicle snorkel, as shown and described.

DESCRIPTION
FIG. 1 is a front left perspective view of the air intake filter connector for a vehicle snorkel of the present invention. FIG. 2 is a rear left perspective view of the present invention. FIG. 3 is a top plan view of the present invention. FIG. 4 is a bottom plan view of the present invention. FIG. 5 is a front elevational view of the present invention. FIG. 6 is a rear elevational view of the present invention. FIG. 7 is a left side elevational view of the present invention; and, FIG. 8 is a right side elevational view of the present invention. The broken lines showing environmental structure are for illustrative purposes only and form no part of the claimed design.

1 Claim, 8 Drawing Sheets

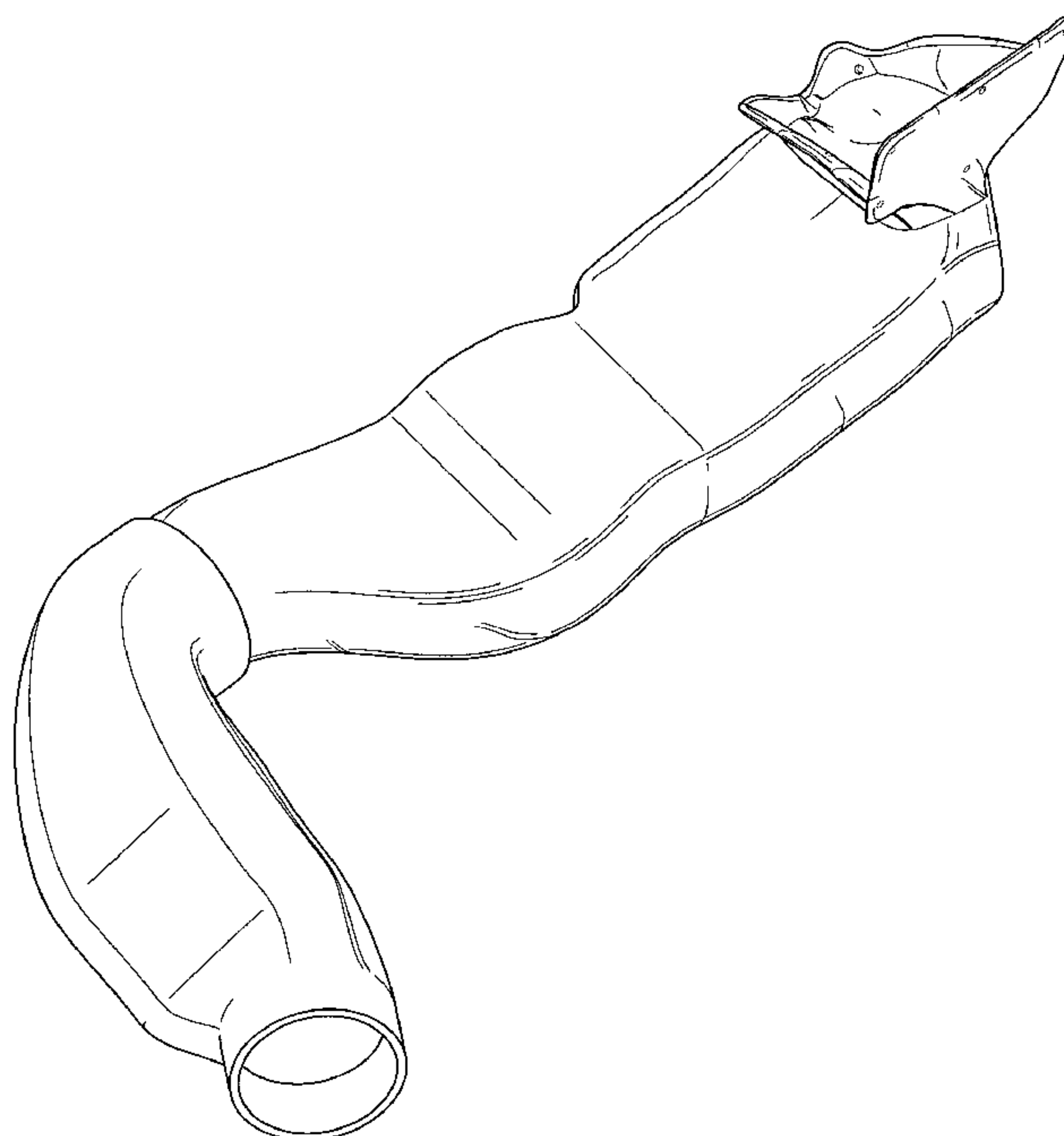

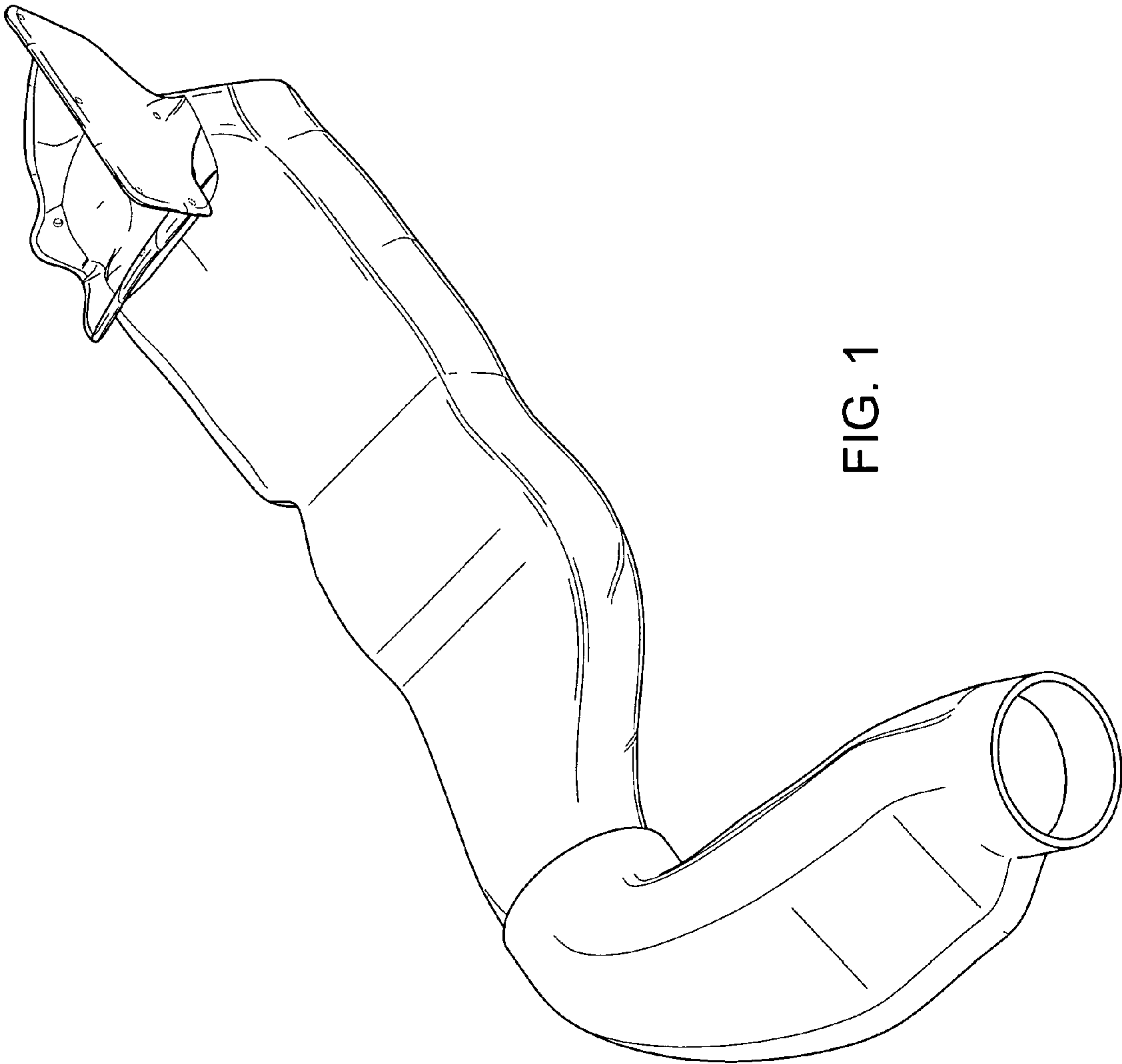

FIG. 1

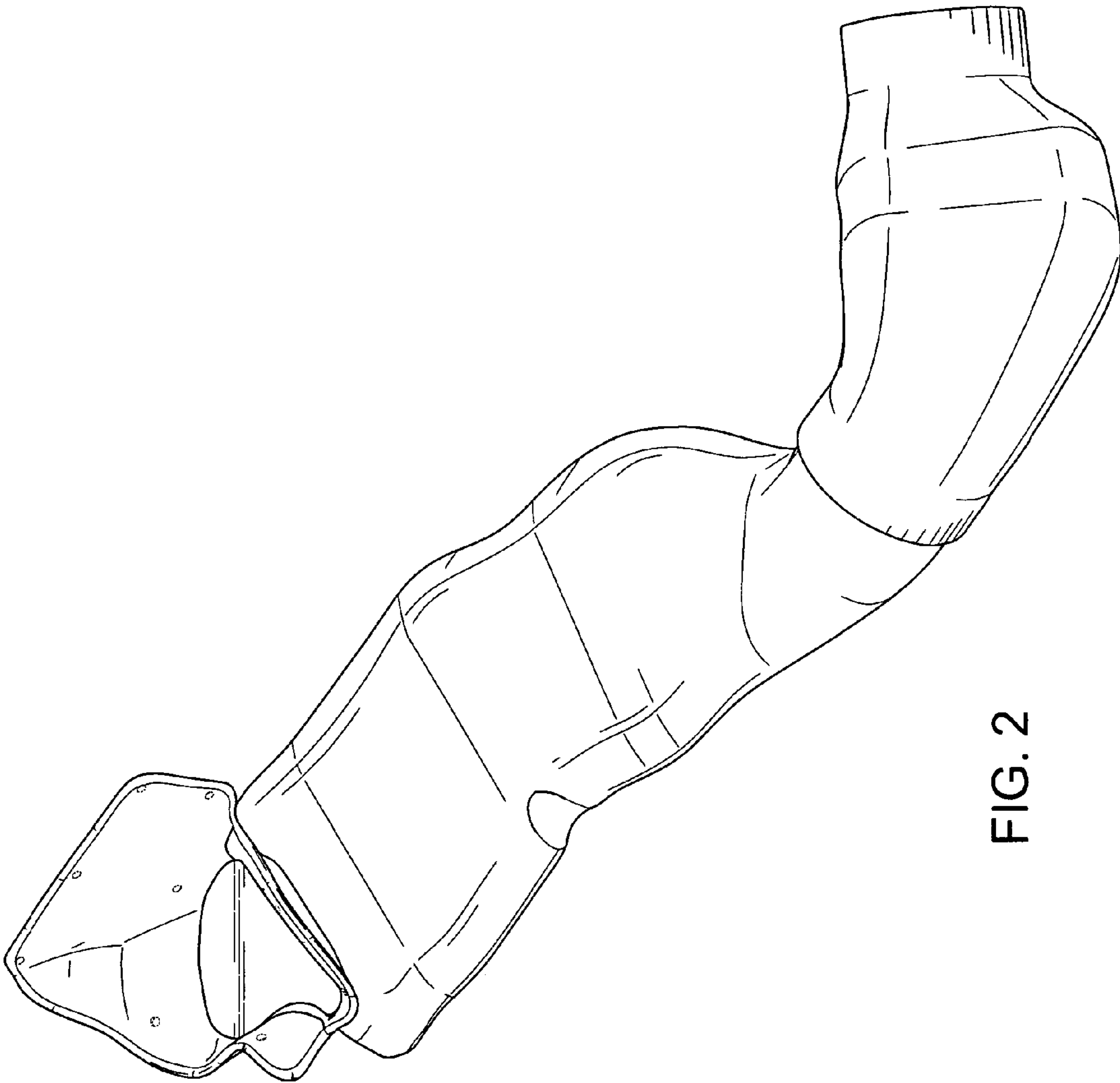

FIG. 2

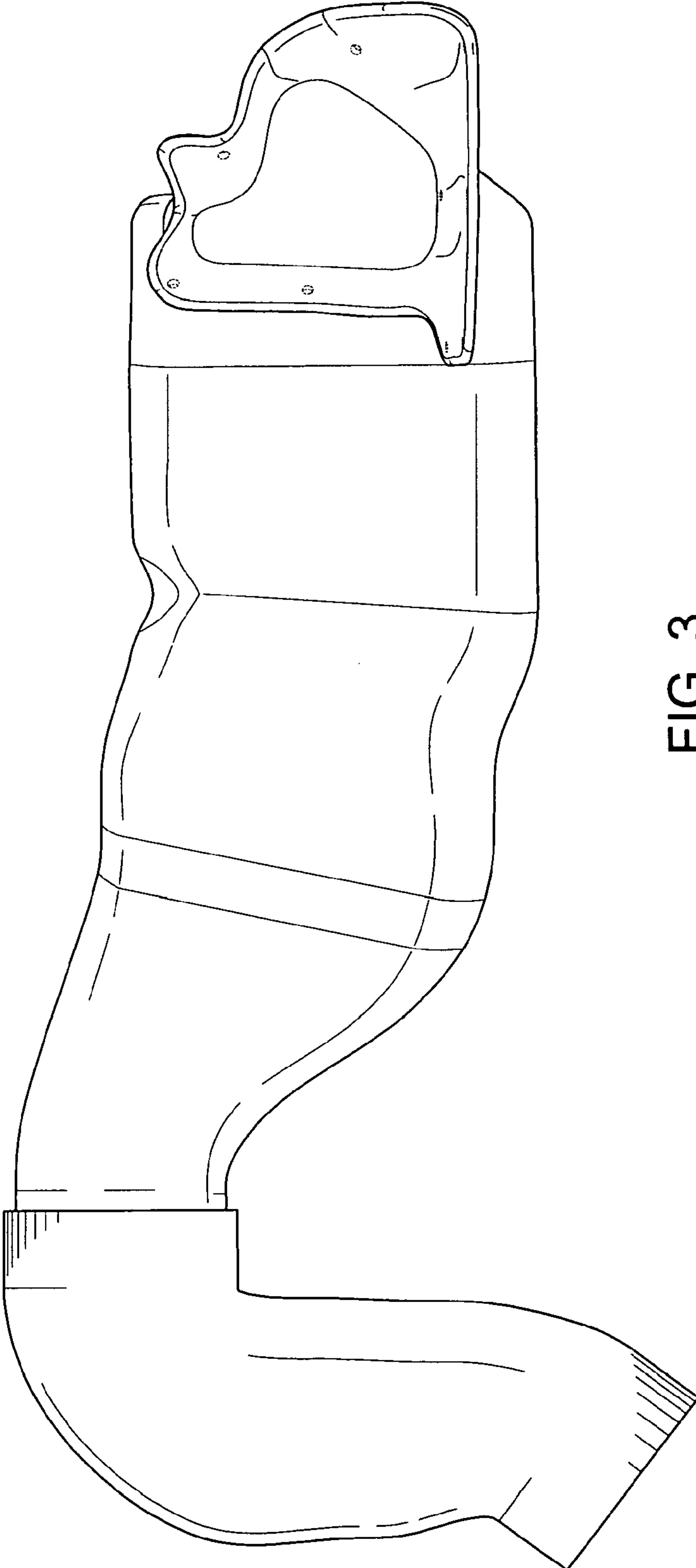

FIG. 3

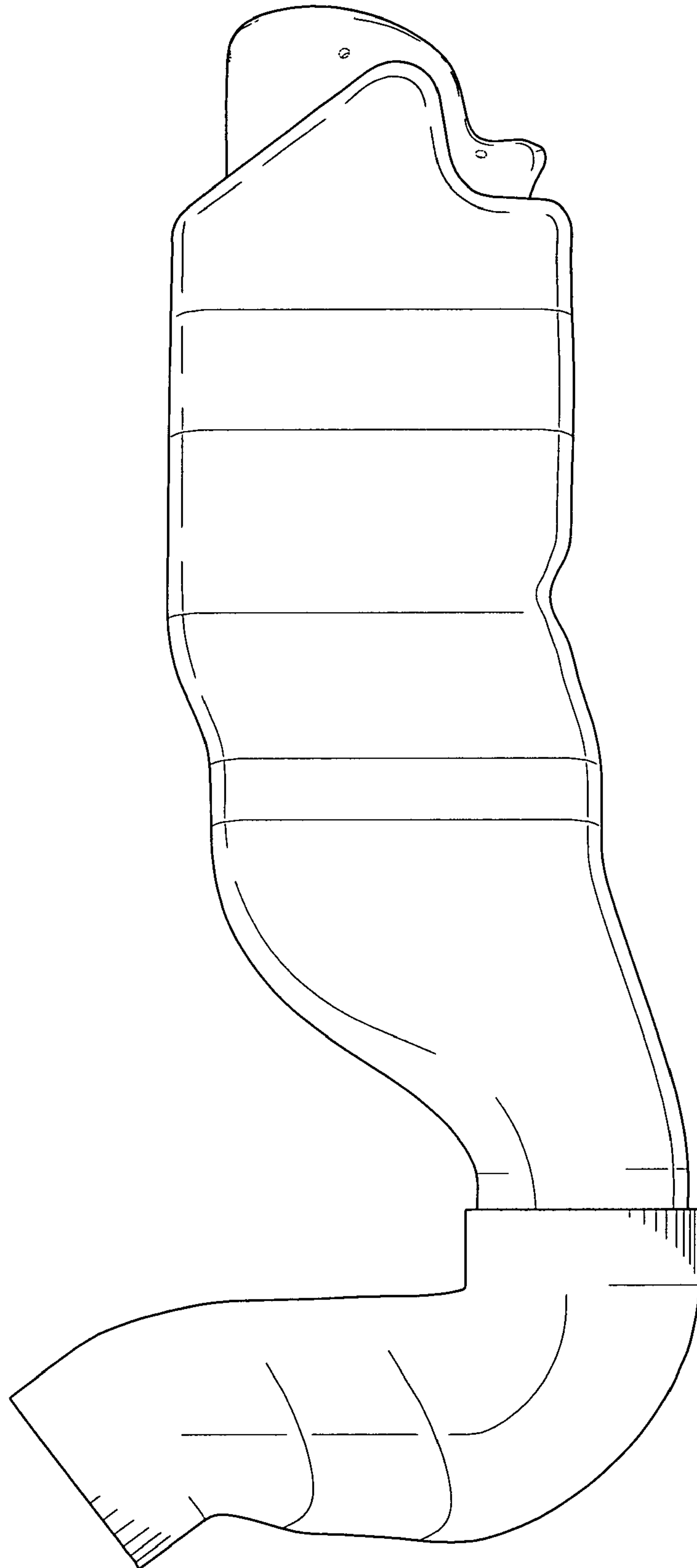

FIG. 4

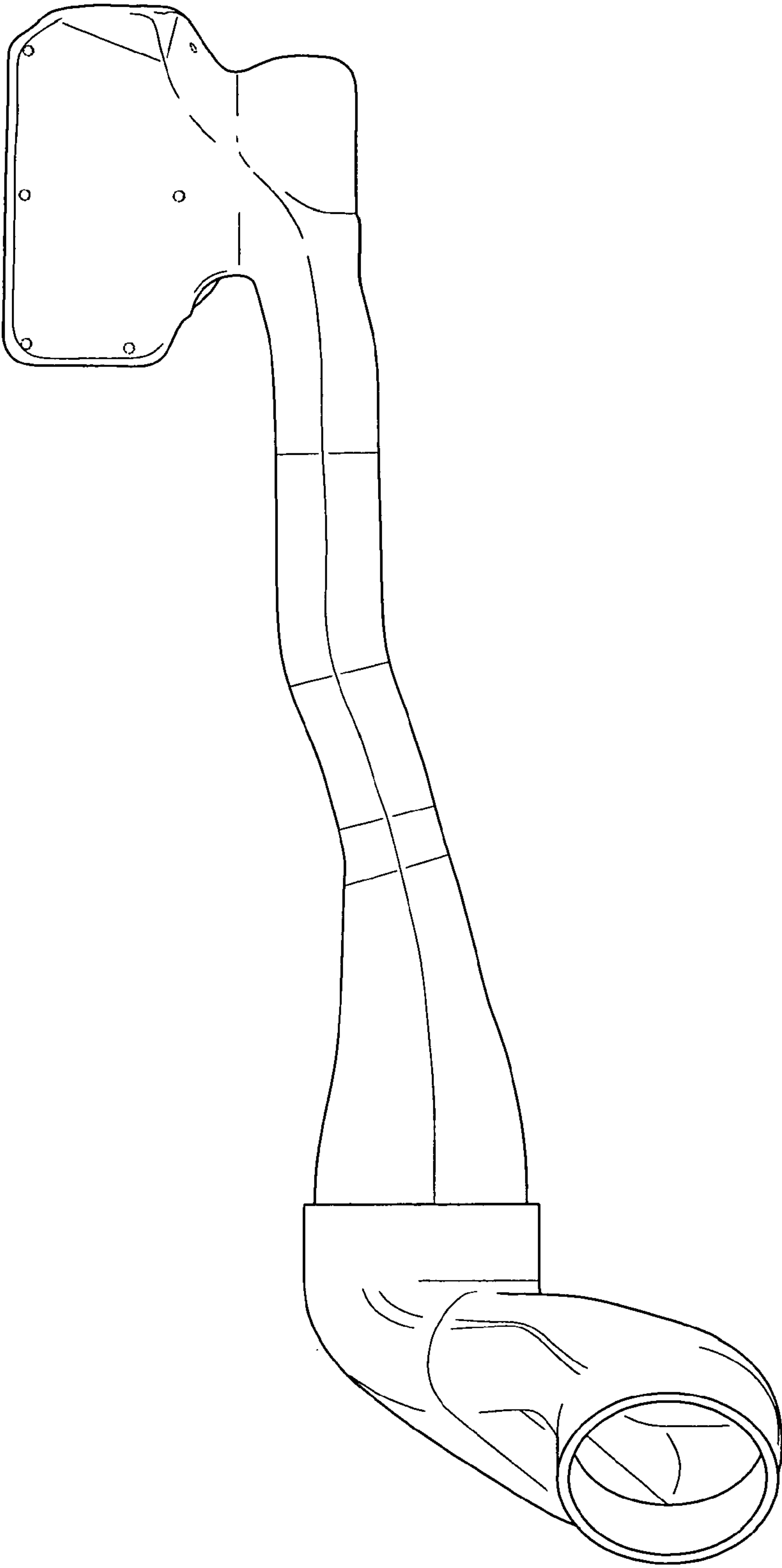

FIG. 5

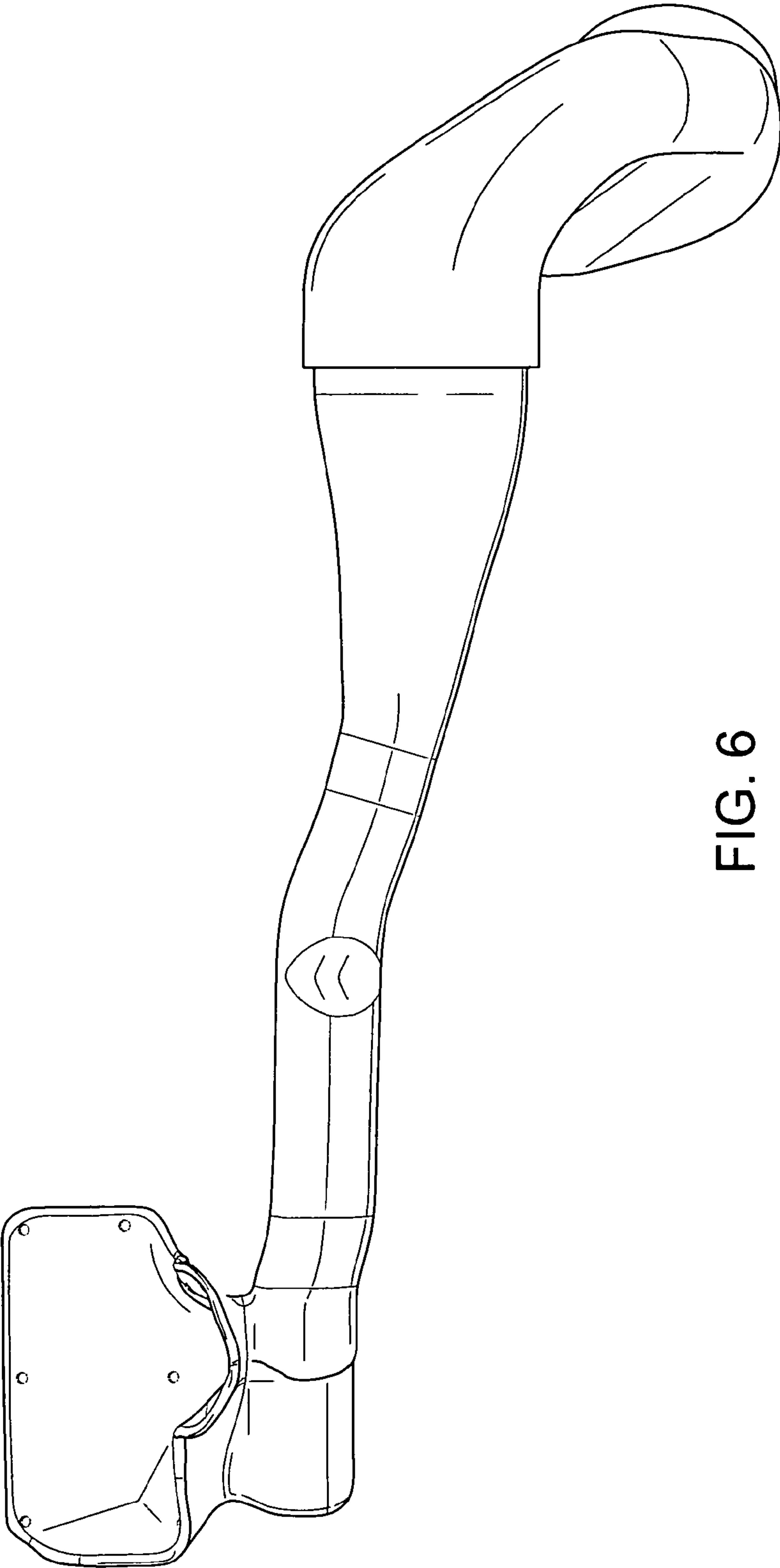

FIG. 6

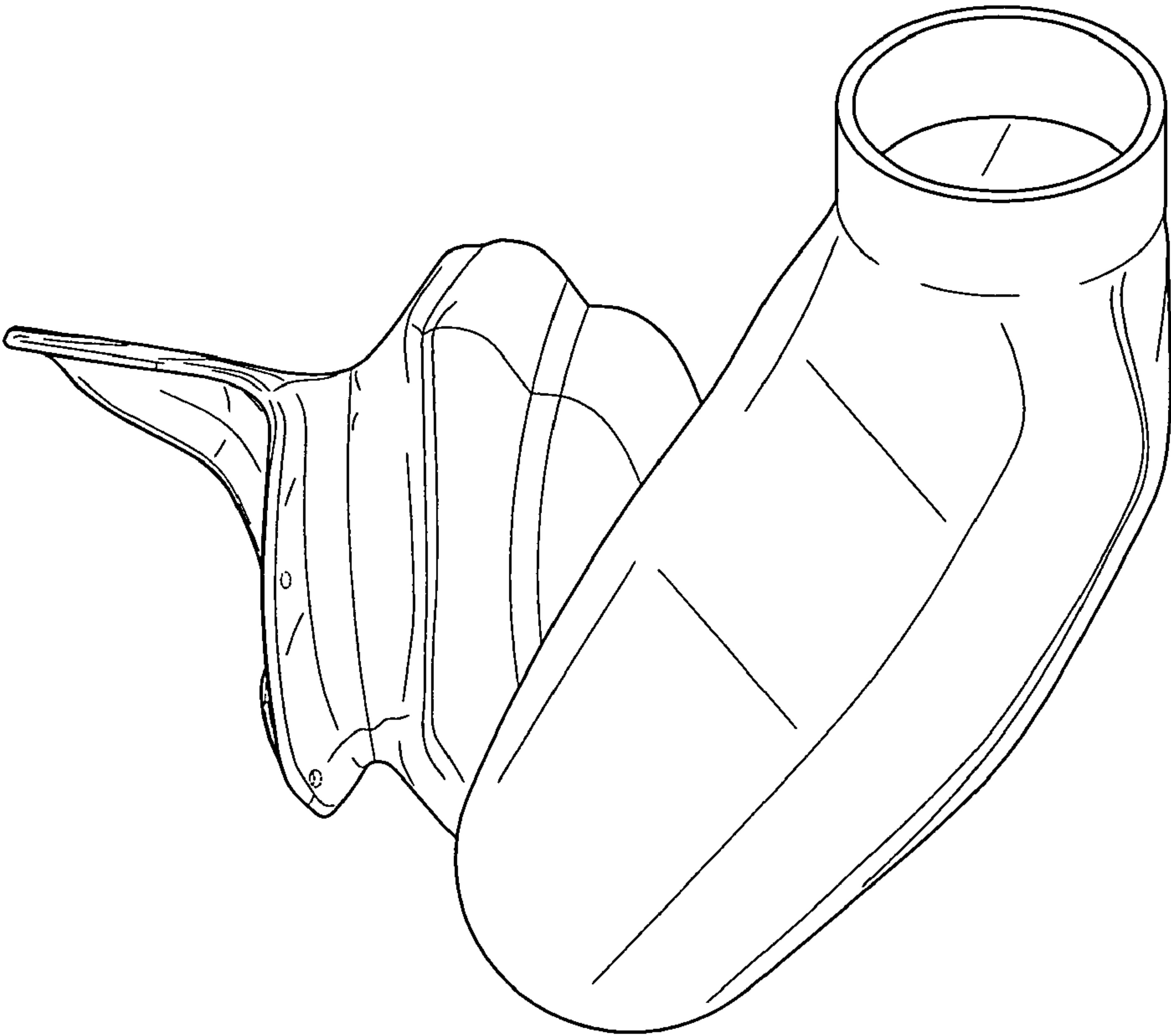

FIG. 7

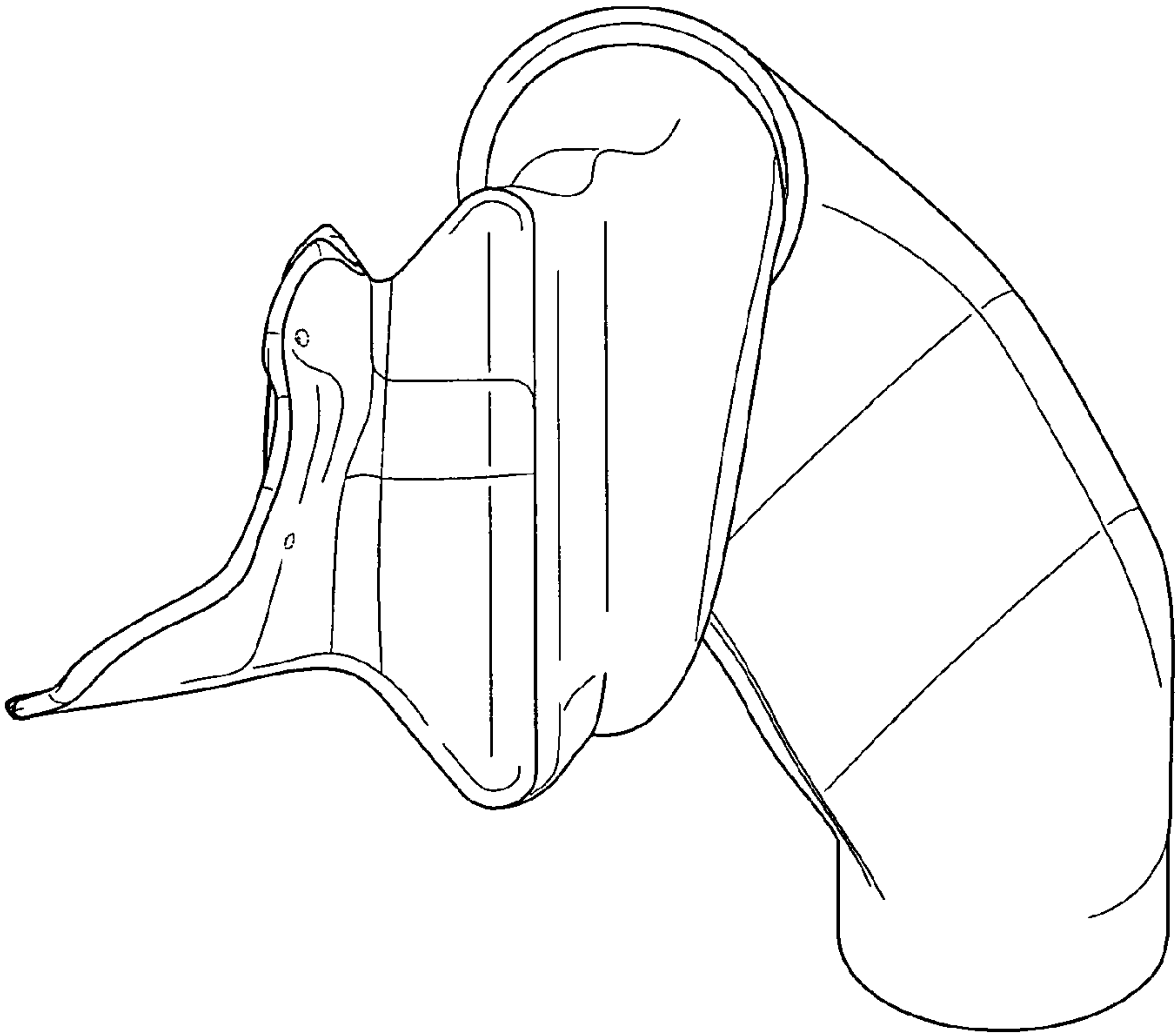

FIG. 8