



US00D640105S

(12) **United States Design Patent**
Benz

(10) **Patent No.:** **US D640,105 S**
(45) **Date of Patent:** **** Jun. 21, 2011**

(54) **BOTTLE UTENSIL HAVING BASEBALL BAT POMMEL**

(75) Inventor: **Gina Benz**, Armonk, NY (US)

(73) Assignee: **Private Label Autographs, LLC**,
Armonk, NY (US)

(**) Term: **14 Years**

(21) Appl. No.: **29/381,205**

(22) Filed: **Dec. 16, 2010**

(51) **LOC (9) Cl.** **07-99**

(52) **U.S. Cl.** **D8/38**

(58) **Field of Classification Search** D8/14,
D8/16-19, 33-43, 88, 89, 107; D21/725;
7/113, 151-156; 81/3.07, 3.09, 3.2, 3.27,
81/3.29, 3.31, 3.35, 3.37, 3.4, 3.45, 3.48,
81/3.49, 3.55

See application file for complete search history.

(56) **References Cited**

U.S. PATENT DOCUMENTS

D27,208 S *	6/1897	Carlson	D8/41
D27,532 S *	8/1897	Molidor	D8/41
D38,166 S *	8/1906	Hasselbring	D8/40
1,425,704 A *	8/1922	Shek	30/443
1,520,670 A *	12/1924	Appel	7/156
D141,352 S *	5/1945	Block	D8/38
D167,005 S *	6/1952	Sarna	D8/34

D344,777 S *	3/1994	Lo	D21/725
D415,398 S *	10/1999	Wysopal	D8/38
D461,213 S *	8/2002	Smith	D21/725
D516,885 S *	3/2006	Yang	D8/33
D526,034 S *	8/2006	Davis et al.	D21/725
D623,915 S *	9/2010	Willoughby	D8/40

* cited by examiner

Primary Examiner — Garth Rademaker

(74) *Attorney, Agent, or Firm* — Leason Ellis LLP

(57) **CLAIM**

The ornamental design for a bottle utensil having baseball bat pommel, as shown and described.

DESCRIPTION

FIG. 1 is a perspective view of a bottle utensil having baseball bat pommel illustrating my new design;
 FIG. 2 is a side elevation view thereof, shown in an alternative environment, the opposite side, front, and rear elevation views appearing identical thereto;
 FIG. 3 is a side elevation view thereof, shown in another alternative environment;
 FIG. 4 is a side elevation view thereof, shown in the same environment as in FIG. 1;
 FIG. 5 is a top plan view thereof; and,
 FIG. 6 is a bottom plan view thereof, shown in the same environment as FIG. 1.

The broken lines shown in the figures illustrate different environments only and form no part of the claimed design.

1 Claim, 3 Drawing Sheets

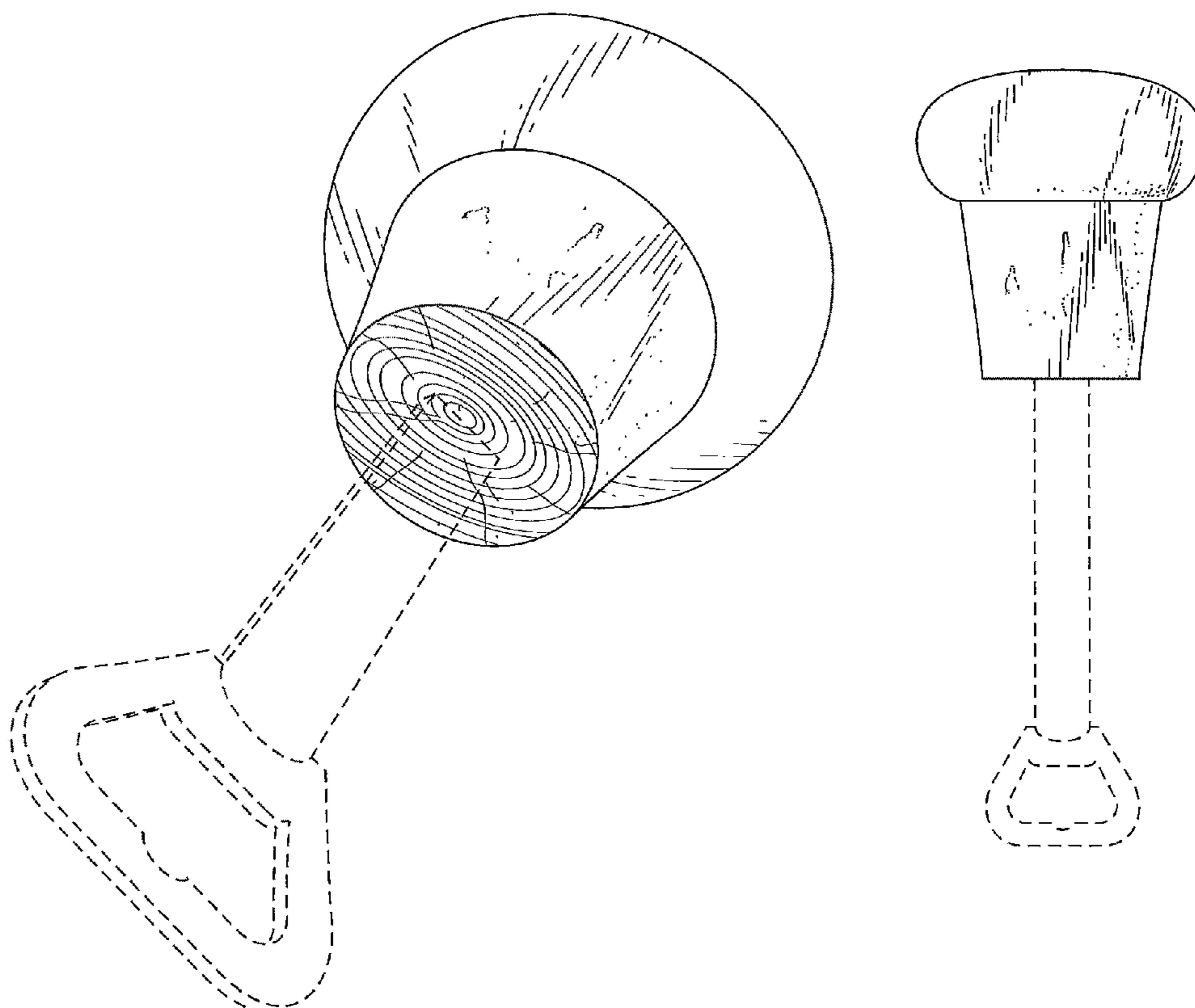

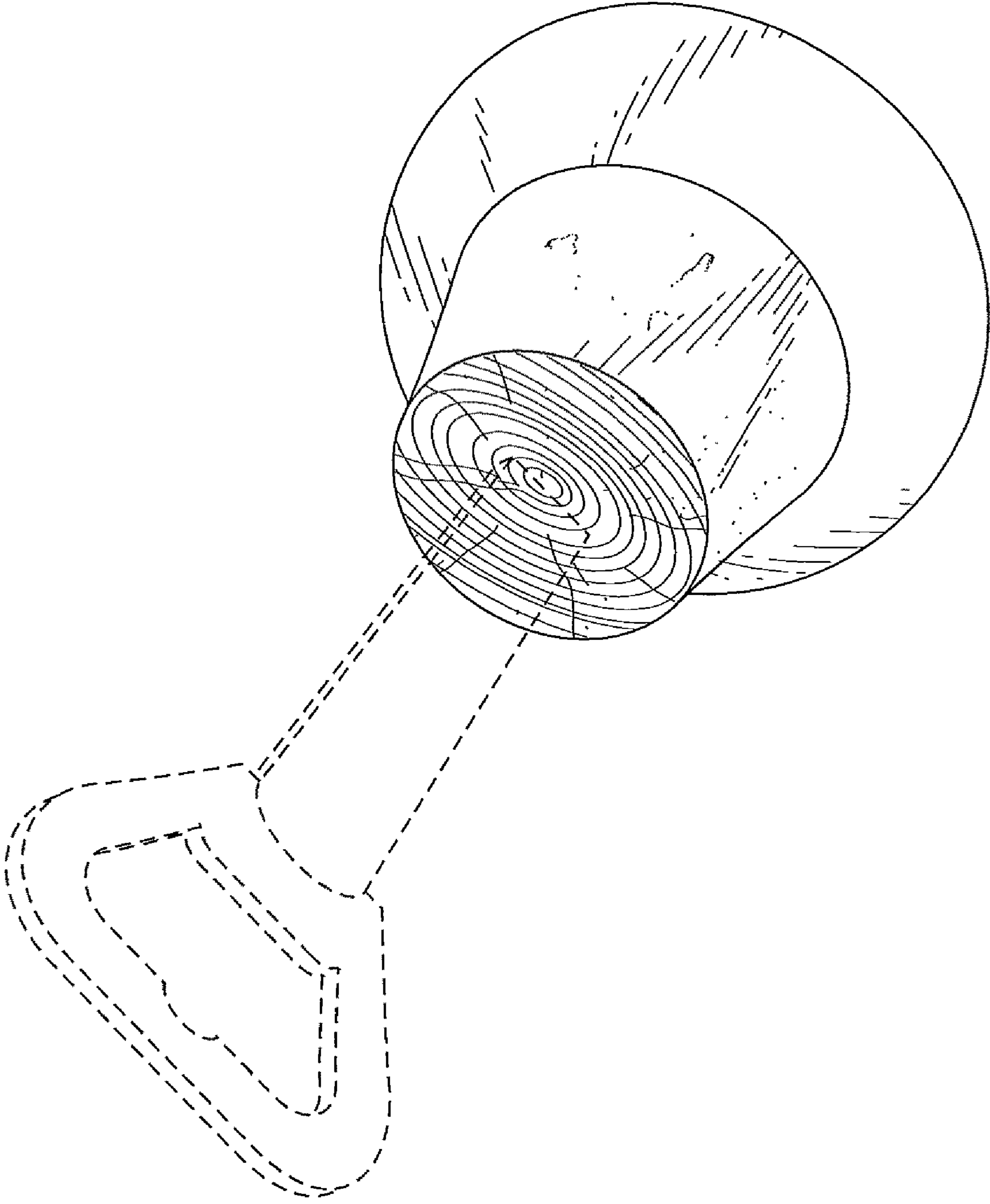

Fig. 1

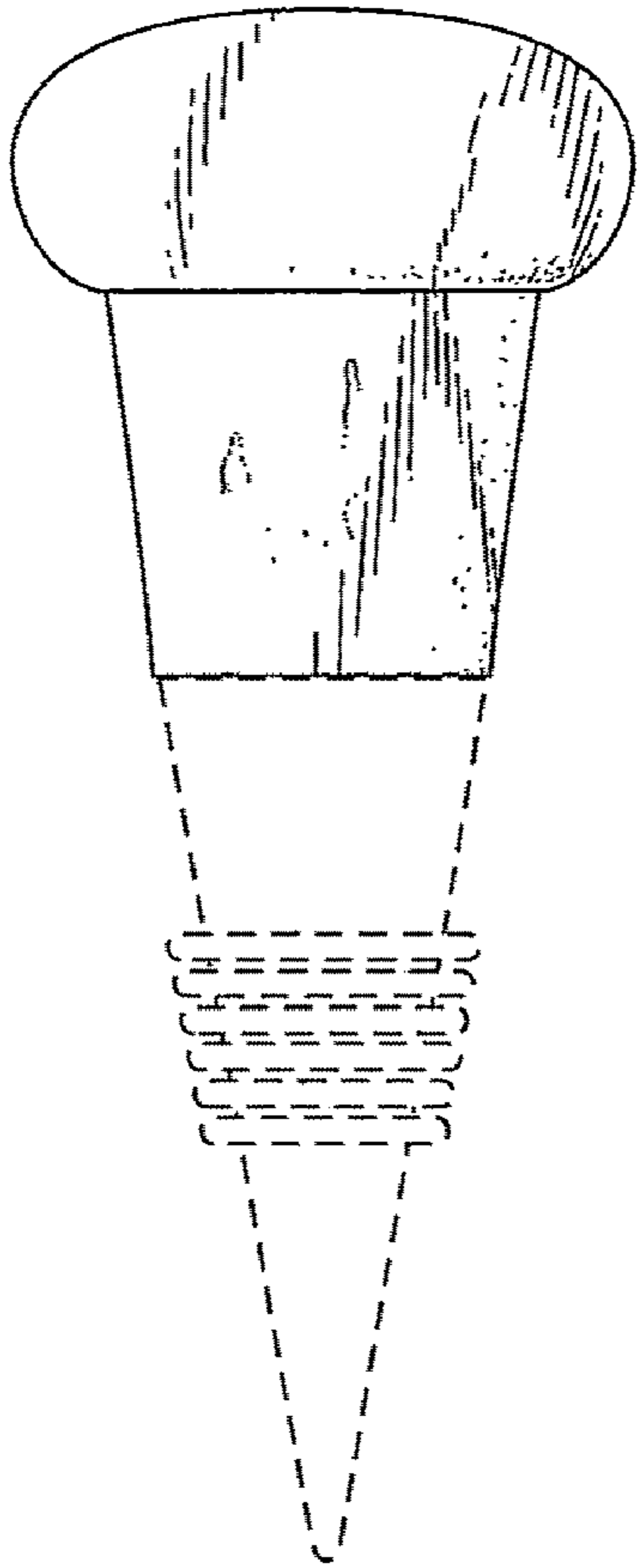

Fig. 2

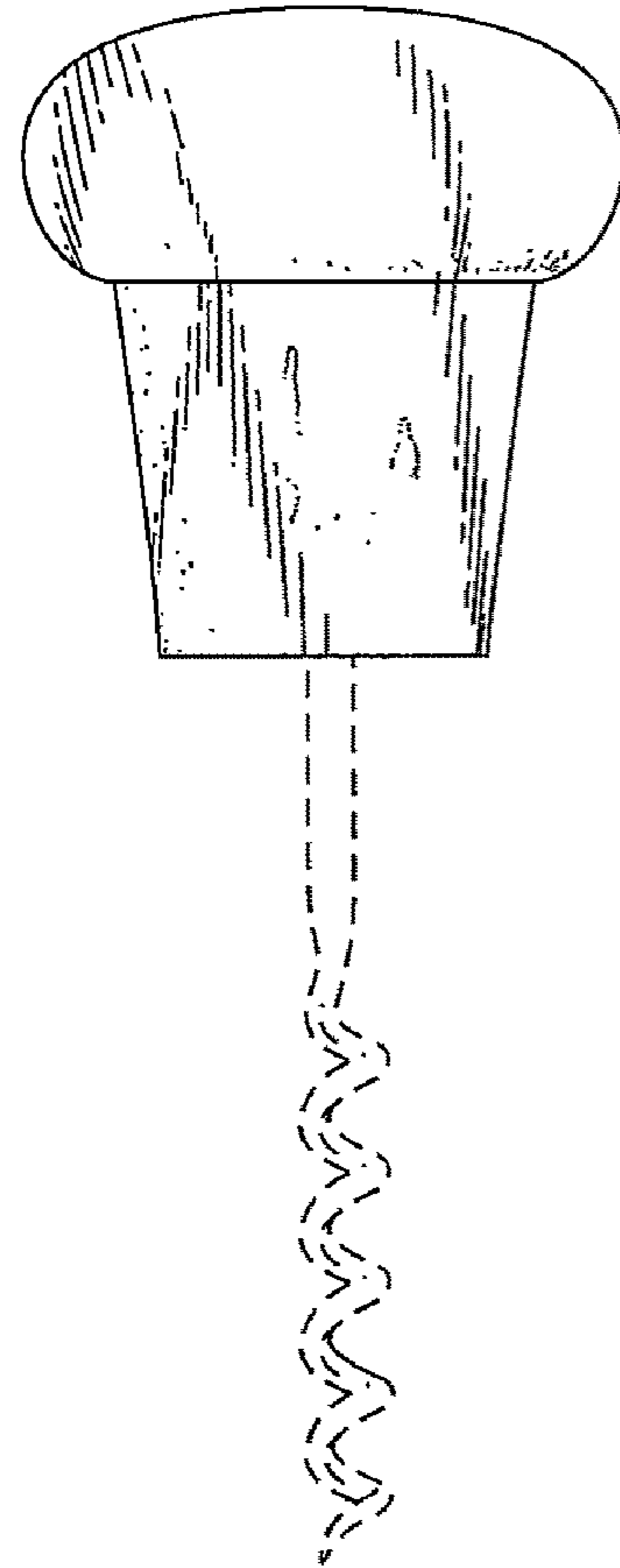

Fig. 3

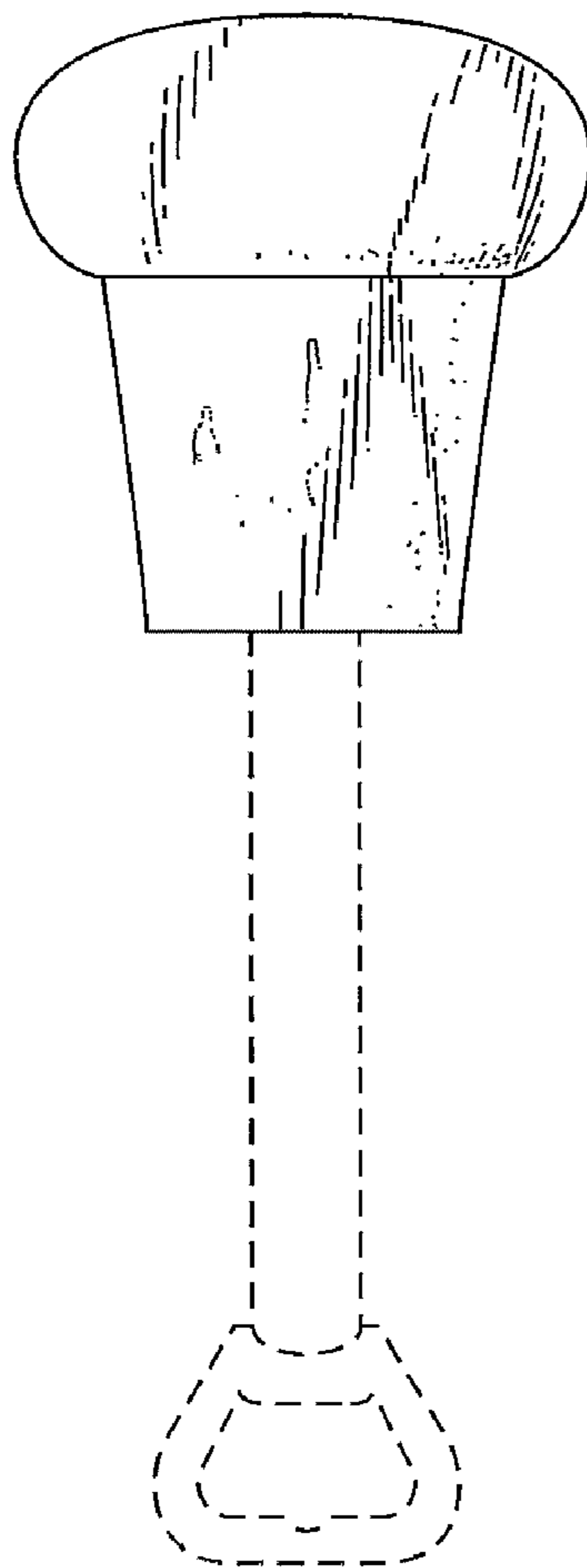

Fig. 4

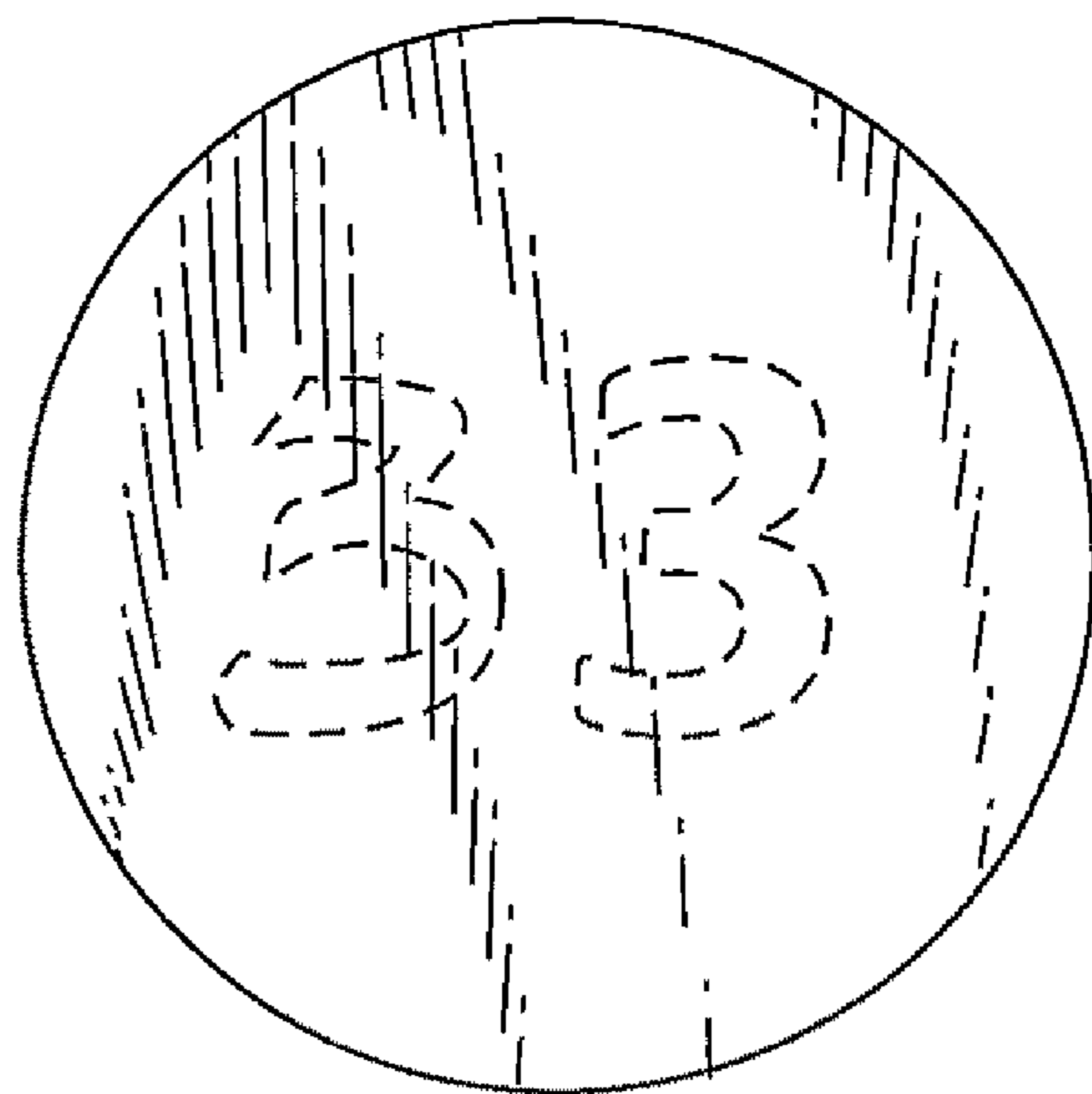

Fig. 5

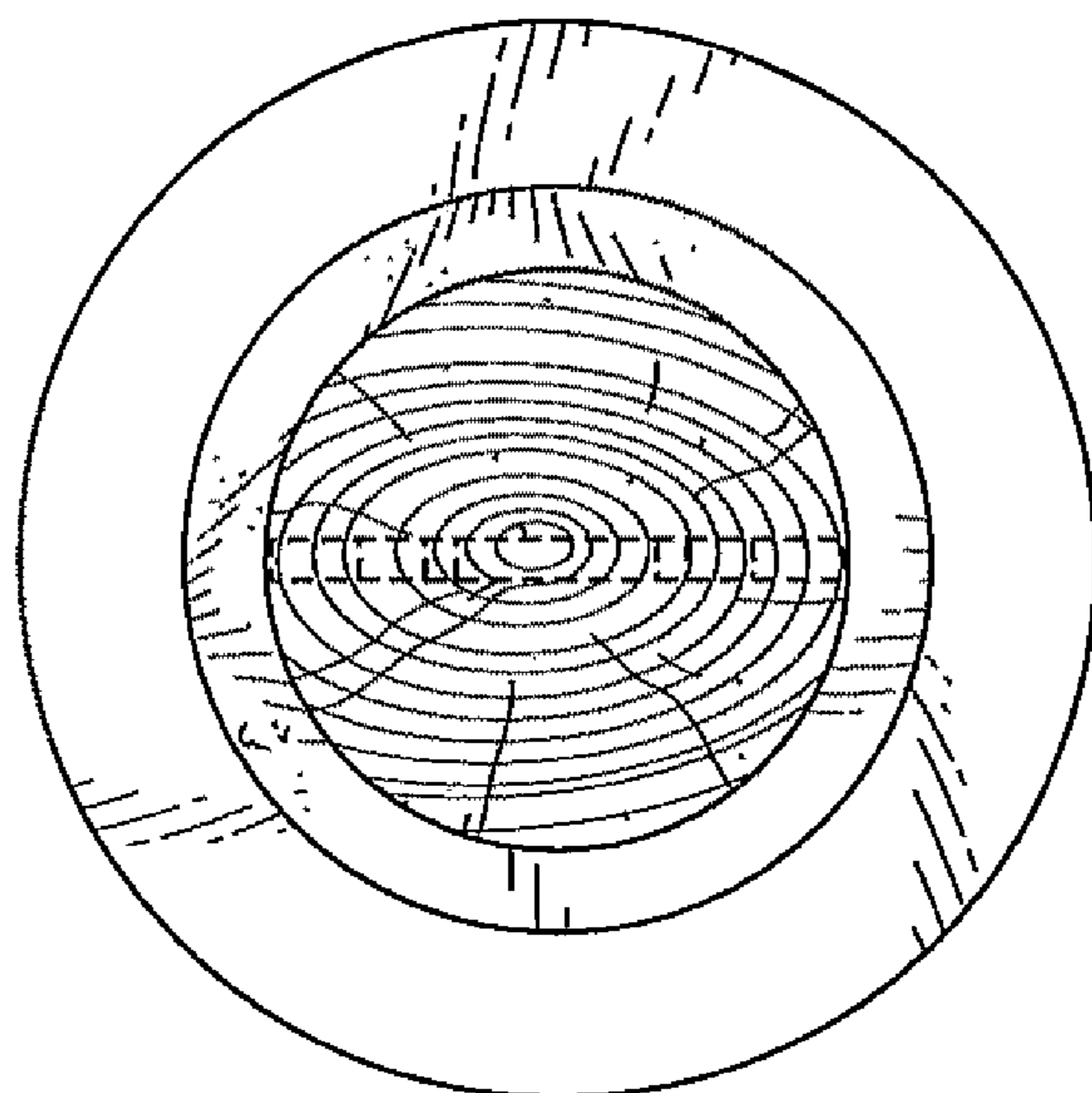

Fig. 6