



US00D639630S

(12) **United States Design Patent**
Kawase et al.

(10) **Patent No.:** **US D639,630 S**

(45) **Date of Patent:** **** Jun. 14, 2011**

(54) **PORTABLE ELECTRIC JIGSAW**

(75) Inventors: **Tomonori Kawase**, Aichi (JP);
Masanori Hayashi, Aichi (JP)

(73) Assignee: **Makita Corporation**, Anjo-shi (JP)

(**) Term: **14 Years**

(21) Appl. No.: **29/381,175**

(22) Filed: **Dec. 16, 2010**

(30) **Foreign Application Priority Data**

Jul. 16, 2010 (JP) 2010-017425

(51) **LOC (9) Cl.** **08-03**

(52) **U.S. Cl.** **D8/64**

(58) **Field of Classification Search** D8/69,
D8/68, 67, 66, 64, 61; 83/747, 699.21; 310/50;
30/394, 393, 392, 391, 390, 377, 376; 173/216,
173/217

See application file for complete search history.

(56) **References Cited**

U.S. PATENT DOCUMENTS

D409,469 S *	5/1999	Niwa et al.	D8/69
D474,384 S *	5/2003	Andriolo	D8/64
D519,804 S *	5/2006	Wu	D8/64
D560,455 S *	1/2008	Yamamoto et al.	D8/64
D566,504 S	4/2008	Hayakawa et al.		
D573,858 S *	7/2008	Van Wambeke	D8/64

D578,366 S *	10/2008	Van Wambeke	D8/64
D581,760 S *	12/2008	Van Wambeke	D8/64
D581,761 S *	12/2008	Van Wambeke	D8/64
2002/0124419 A1 *	9/2002	Hirabayashi	30/329

FOREIGN PATENT DOCUMENTS

JP D1385617 S 4/2010

* cited by examiner

Primary Examiner — Austin Murphy

(74) *Attorney, Agent, or Firm* — Posz Law Group, PLC

(57) **CLAIM**

The ornamental design for a portable electric jigsaw, as shown and described.

DESCRIPTION

FIG. 1 is a perspective view of top, rear, and right side of a portable electric jigsaw showing our new design;

FIG. 2 is a front view thereof;

FIG. 3 is a rear view thereof;

FIG. 4 is a top view thereof;

FIG. 5 is a bottom view thereof;

FIG. 6 is a right view thereof; and,

FIG. 7 is a left view thereof.

The broken lines and the areas within the broken lines are included for illustrative purposes only and form no part of the claimed design.

1 Claim, 7 Drawing Sheets

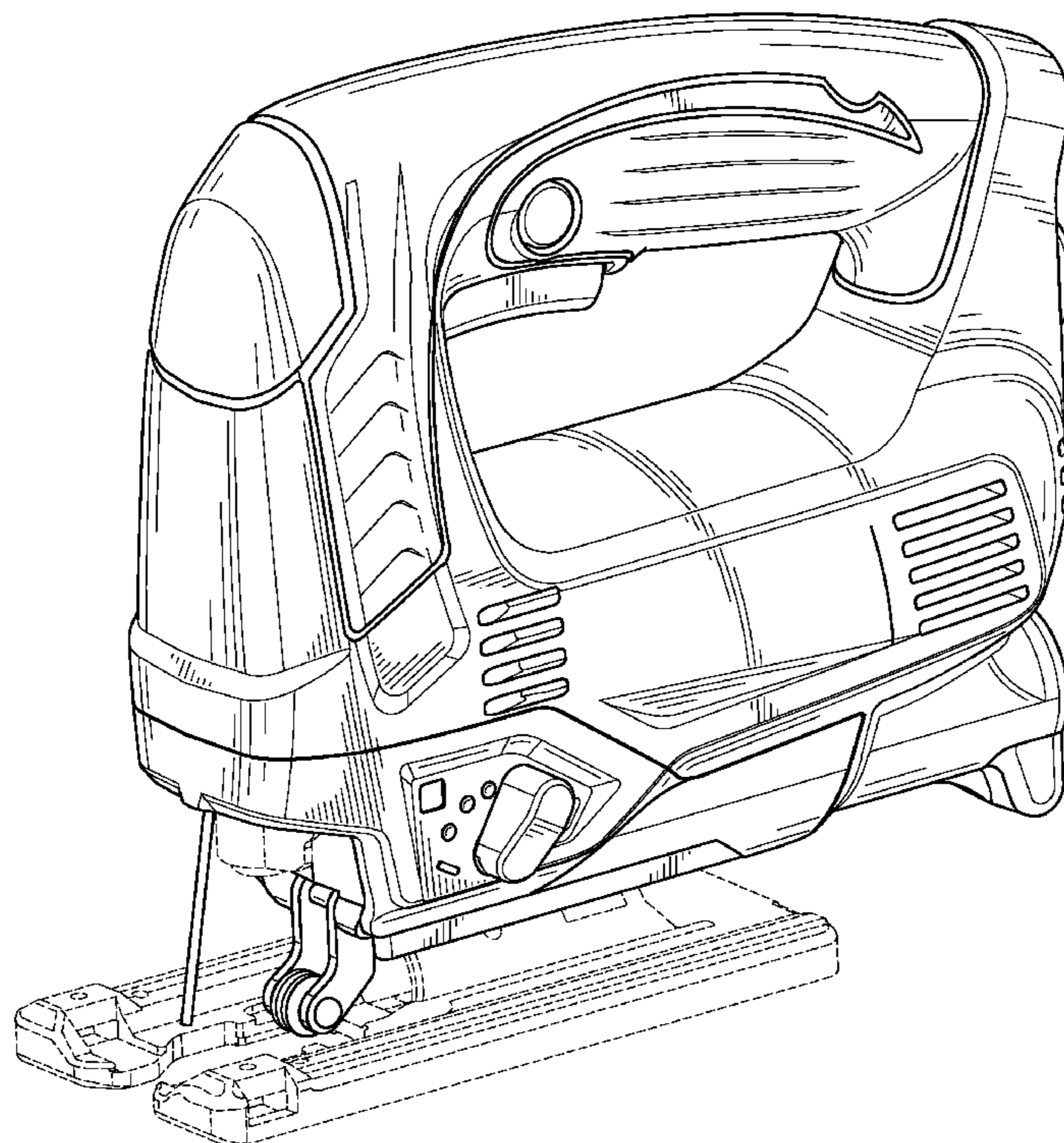

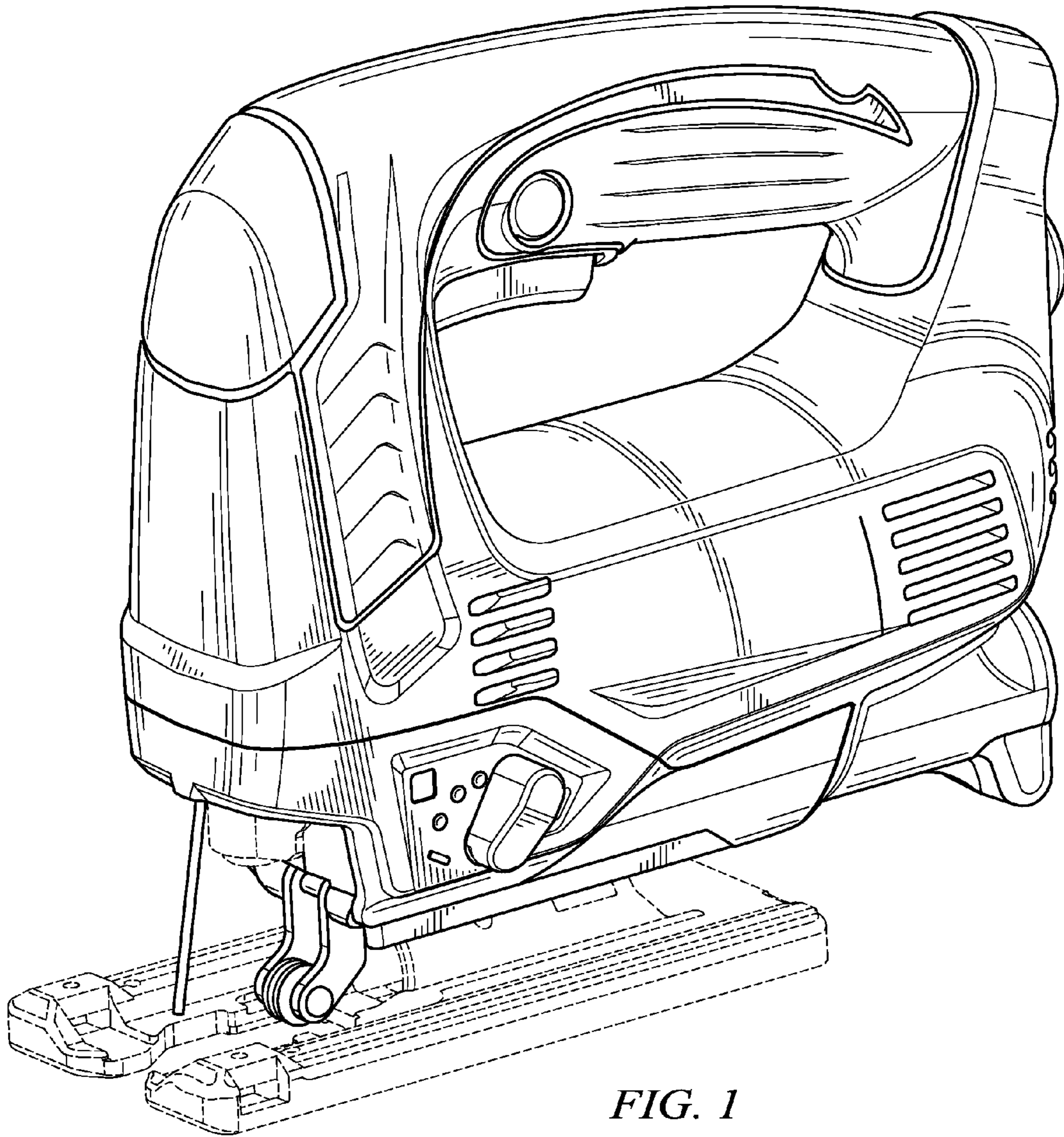

FIG. 1

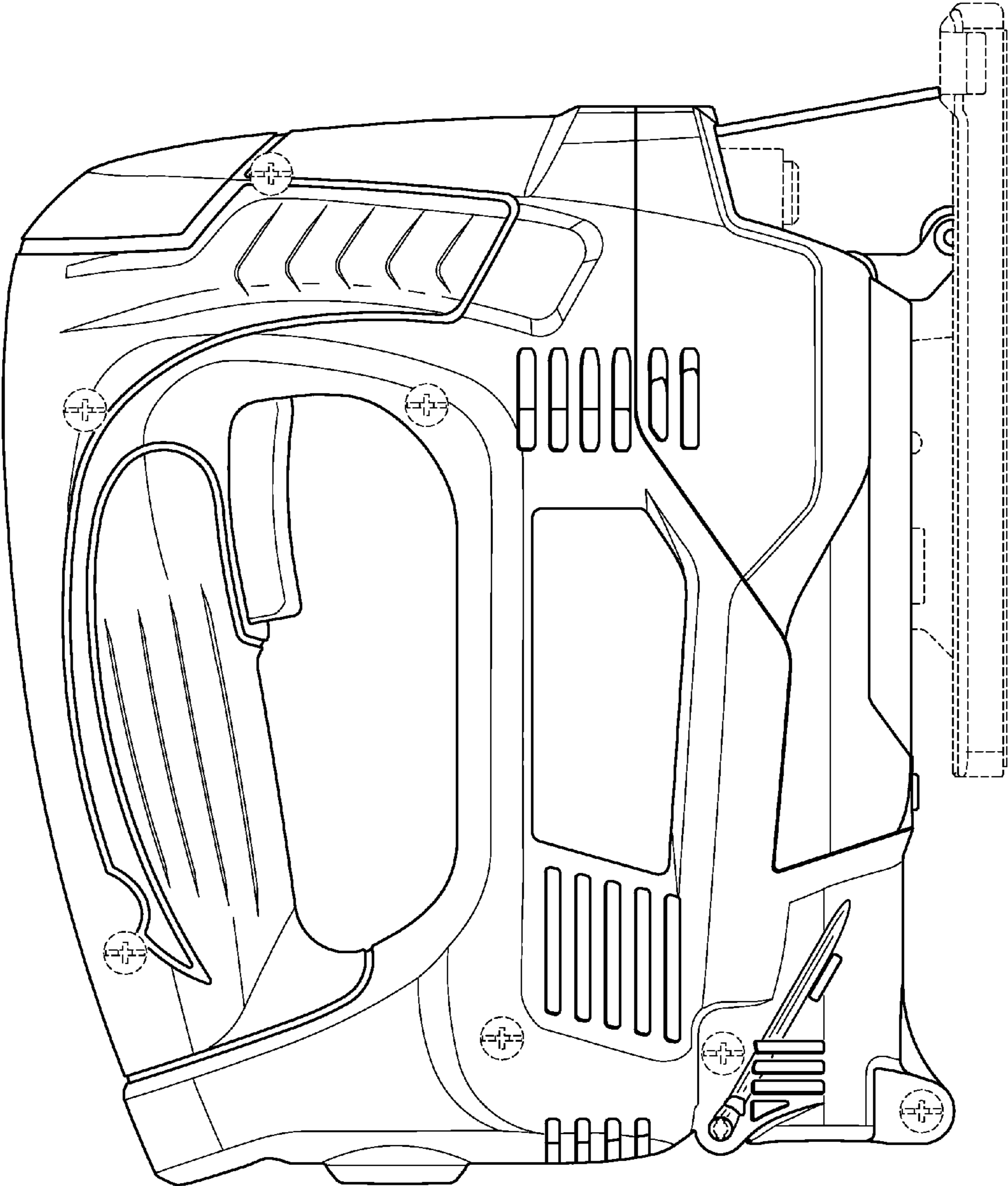

FIG. 2

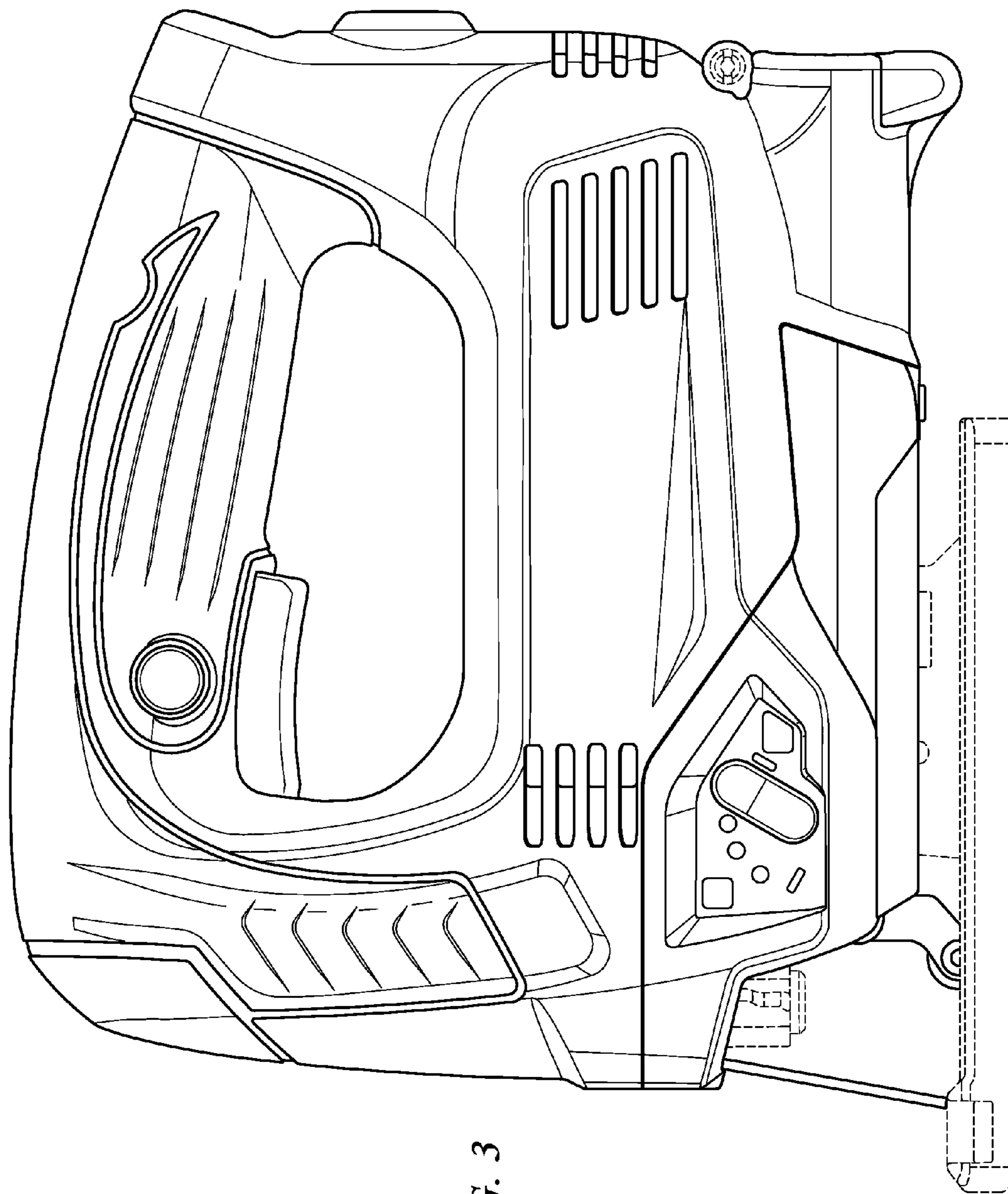

FIG. 3

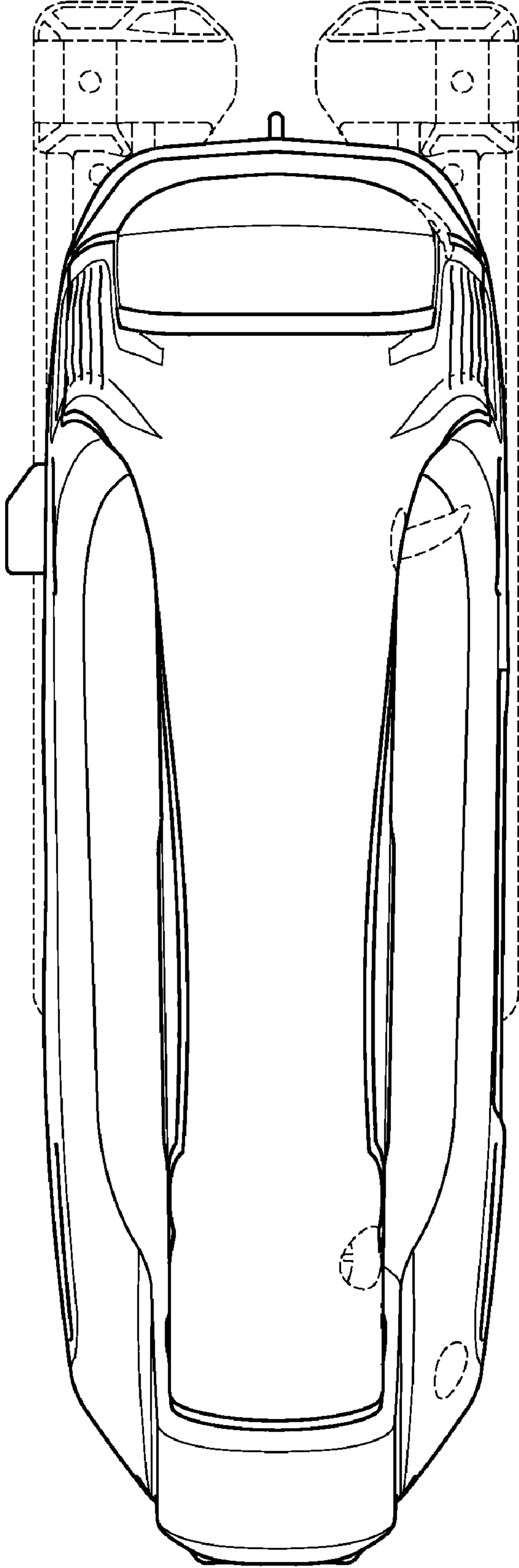

FIG. 4

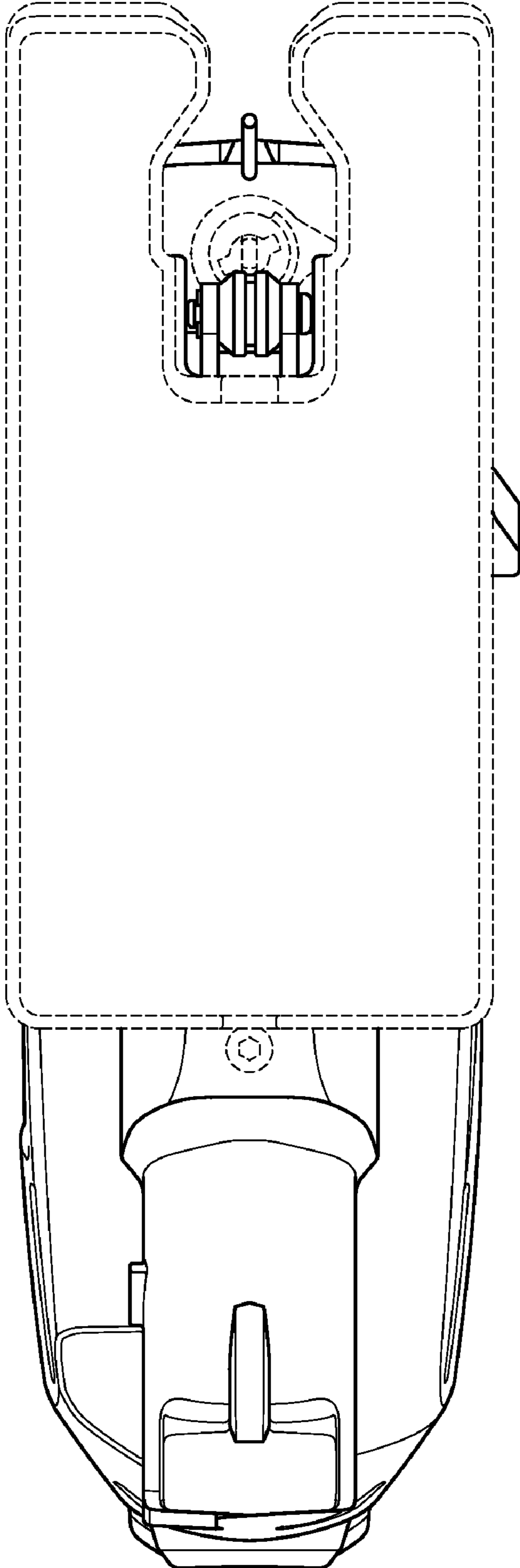

FIG. 5

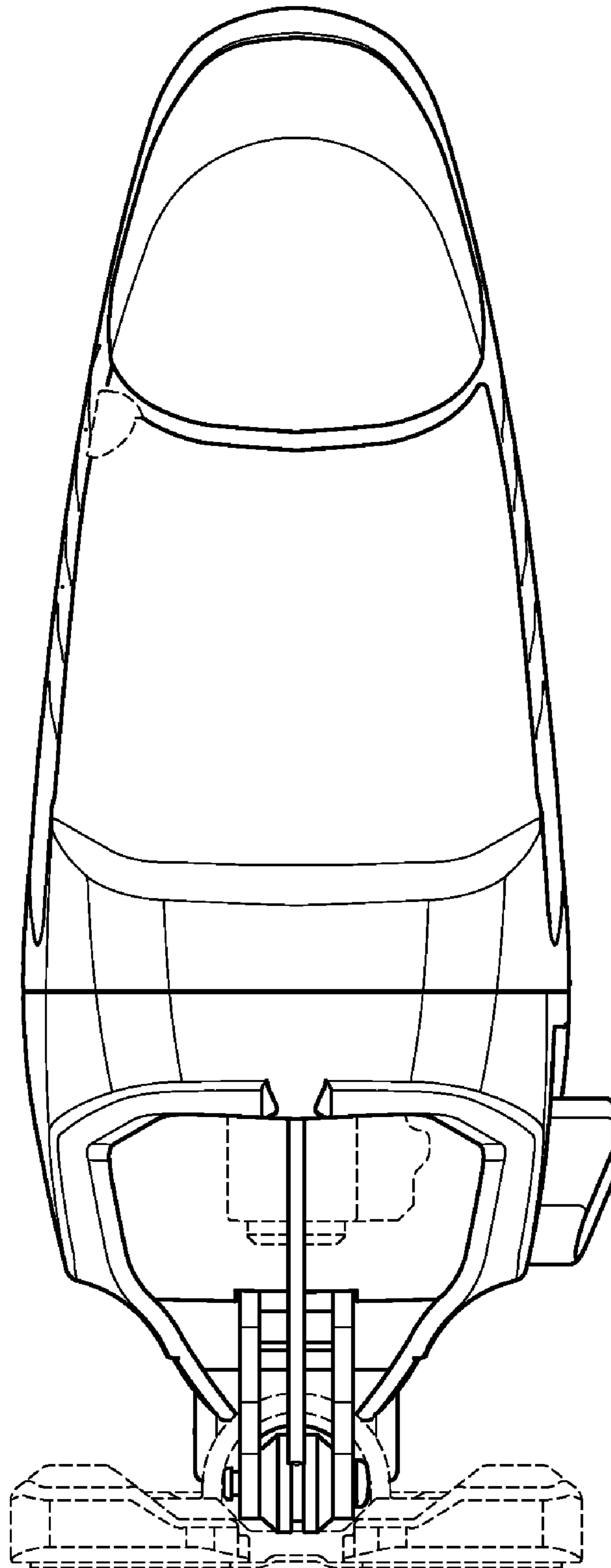

FIG. 6

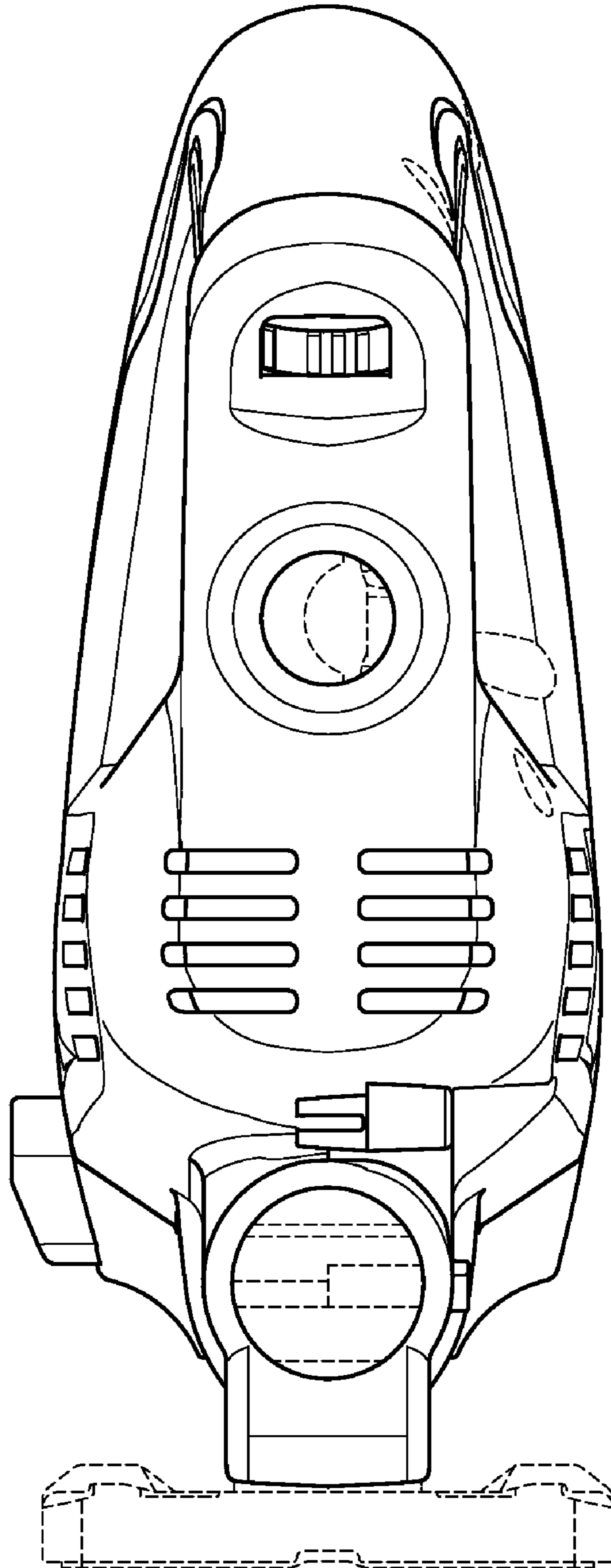

FIG. 7