

US00D639001S

(12) **United States Design Patent**
Alexander et al.

(10) **Patent No.:** **US D639,001 S**
(45) **Date of Patent:** **** May 31, 2011**

(54) **PRESSURE WASHER**

(75) Inventors: **Gus Alexander**, Inverness, IL (US);
Ryan D Sherwood, Chicago, IL (US);
Christopher C Alexander, Chicago, IL
(US); **William N Alexander**, Inverness,
IL (US)

(73) Assignee: **FNA IP Holdings, Inc.**, Elk Grove
Village, IL (US)

(**) Term: **14 Years**

(21) Appl. No.: **29/365,617**

(22) Filed: **Jul. 12, 2010**

(51) **LOC (9) Cl.** **15-05**

(52) **U.S. Cl.** **D32/15**

(58) **Field of Classification Search** D32/15-16,
D32/1, 17-18, 21; D23/225; 15/315, 320-321,
15/340.1, 344-345, 412, 414, 415.1; 239/146-149,
239/525, 722; 417/360, 364
See application file for complete search history.

(56) **References Cited**

U.S. PATENT DOCUMENTS

D345,842	S *	4/1994	Sloan et al.	D34/26
5,700,137	A *	12/1997	Simonette	417/364
D424,771	S *	5/2000	Sivells et al.	D34/14
D444,279	S *	6/2001	Kristiansen et al.	D34/12
D458,423	S *	6/2002	Rehkugler et al.	D32/16
D463,888	S *	10/2002	Rehkugler et al.	D32/16
D467,692	S *	12/2002	Morgan et al.	D32/15
6,695,235	B2 *	2/2004	Faller et al.	239/722
6,779,987	B2 *	8/2004	Dexter et al.	417/299
D499,848	S *	12/2004	Leasure	D32/15
6,857,444	B2 *	2/2005	Davis	137/115.06
6,866,486	B2 *	3/2005	Dexter et al.	417/299

6,935,642	B1 *	8/2005	Craig et al.	280/47.24
7,125,228	B2 *	10/2006	Dexter et al.	417/299
D532,942	S *	11/2006	Busschaert	D32/15
7,316,286	B2 *	1/2008	Hillary	180/291
D580,610	S *	11/2008	Hawkins	D32/25
D585,622	S *	1/2009	Allsop et al.	D34/24
7,475,888	B2 *	1/2009	Craig et al.	280/47.18
7,562,780	B2 *	7/2009	Gilpatrick et al.	211/70.6
7,604,246	B2 *	10/2009	Sodemann et al.	280/47.315
2005/0145270	A1 *	7/2005	Ray	134/174
2006/0102745	A1 *	5/2006	Dexter	239/146

OTHER PUBLICATIONS

Operator's Manual for Simpson Pressure Washer Model MSV2200,
Rev. 1 5/10, (40 pages) dated 2010.

* cited by examiner

Primary Examiner — T. Chase Nelson
Assistant Examiner — Kathleen M Sims

(74) *Attorney, Agent, or Firm* — Cook Alex Ltd.

(57) **CLAIM**

The ornamental design for a pressure washer, as shown and
described.

DESCRIPTION

FIG. 1 is a perspective view of a pressure washer showing our
new design;
FIG. 2 is a left side elevation view thereof;
FIG. 3 is a front elevation view thereof;
FIG. 4 is a right side elevation view thereof;
FIG. 5 is a rear elevation view thereof;
FIG. 6 is a top plan view thereof; and,
FIG. 7 is a bottom plan view thereof.
The broken lines in FIGS. 1-7 are for illustrative purposes
only and form no part of the claimed design.

1 Claim, 6 Drawing Sheets

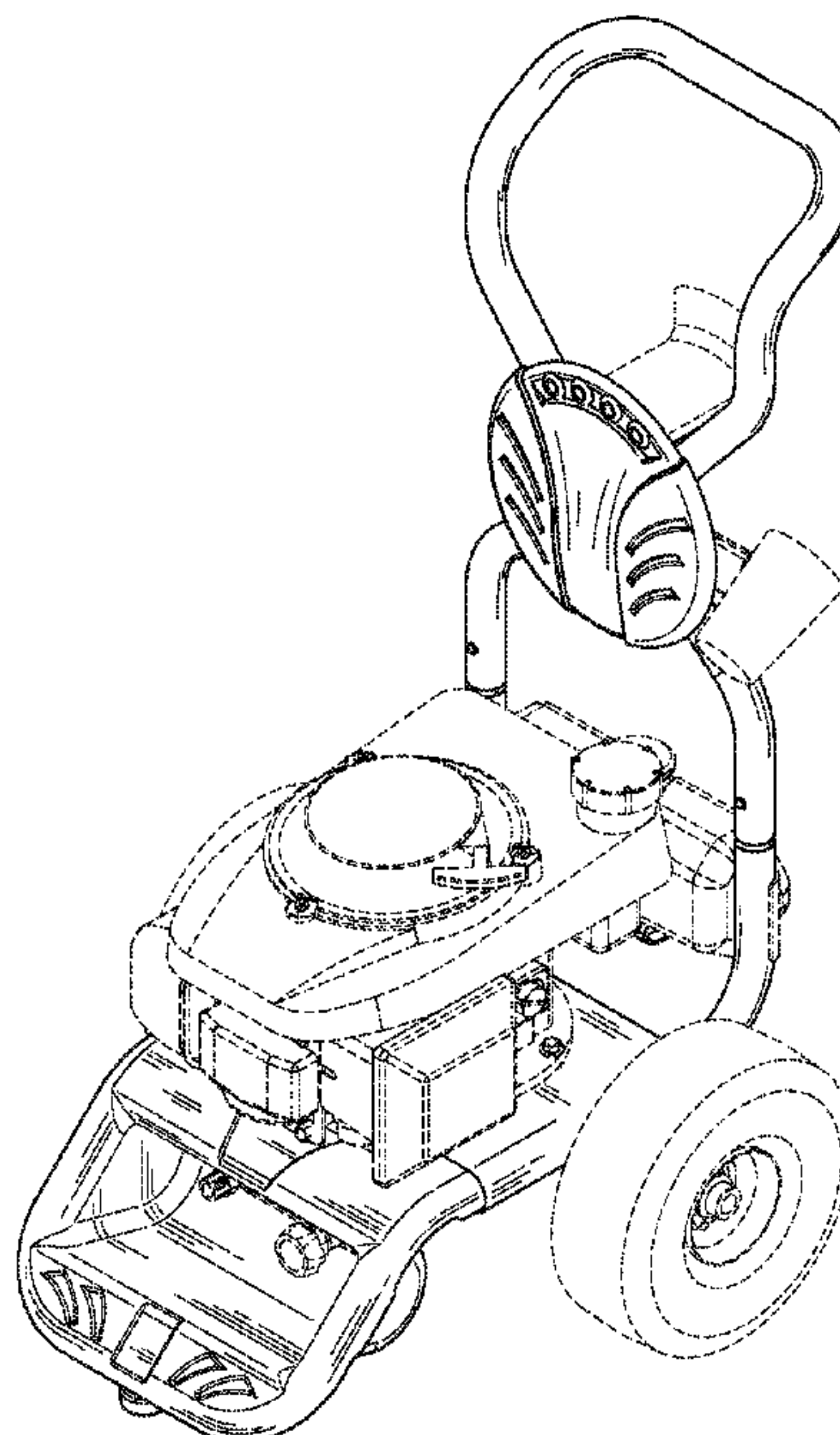

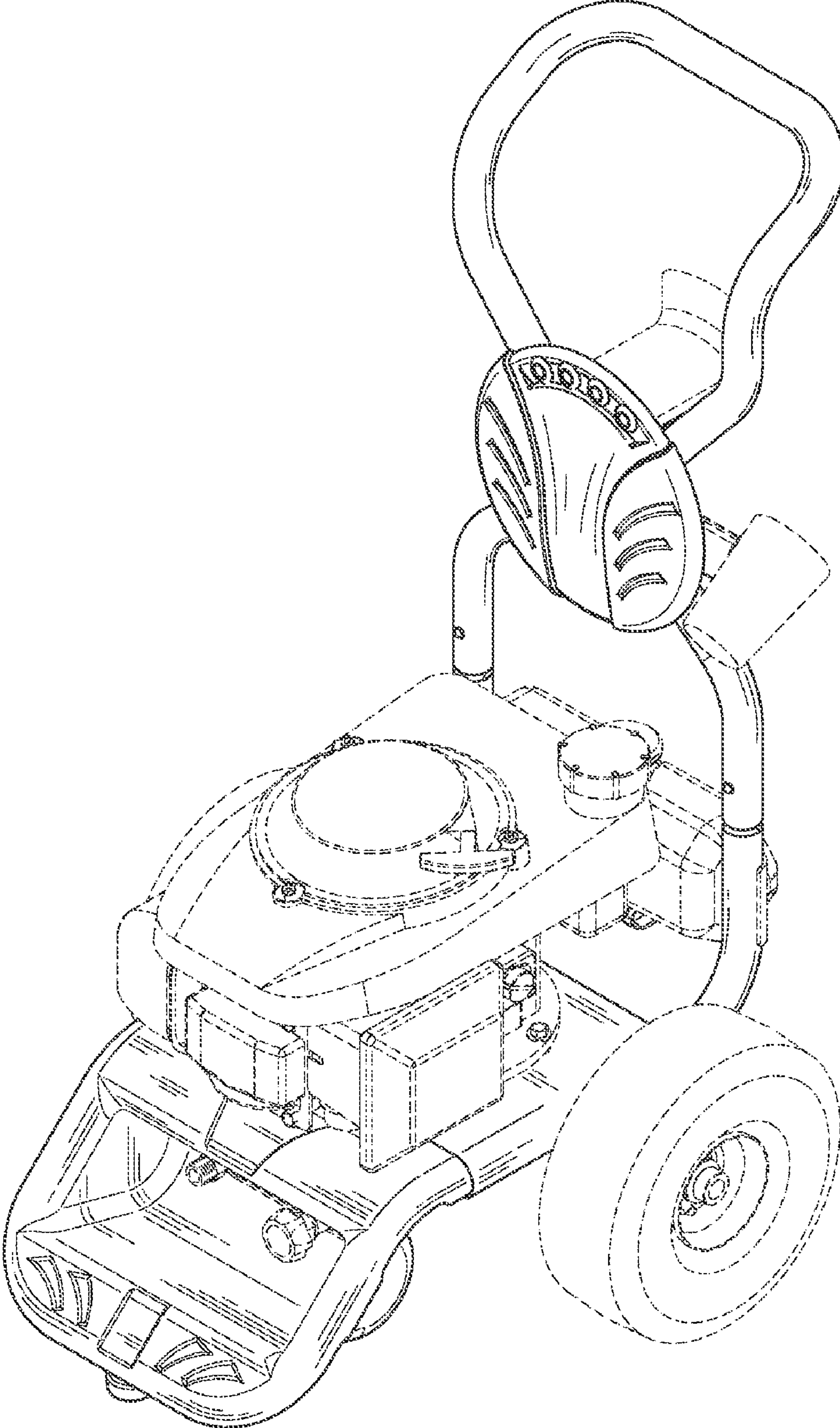

FIG. 1

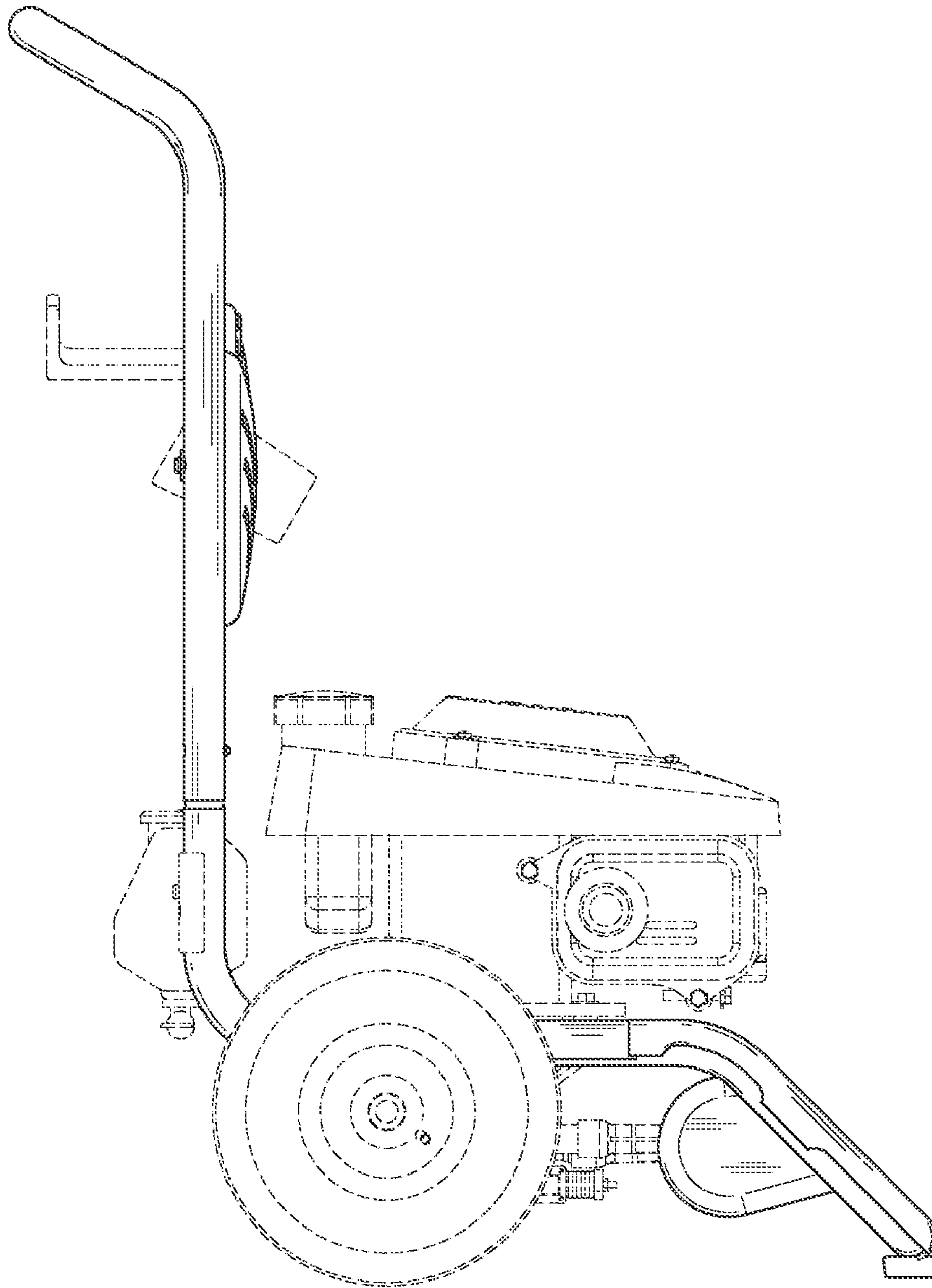

FIG. 2

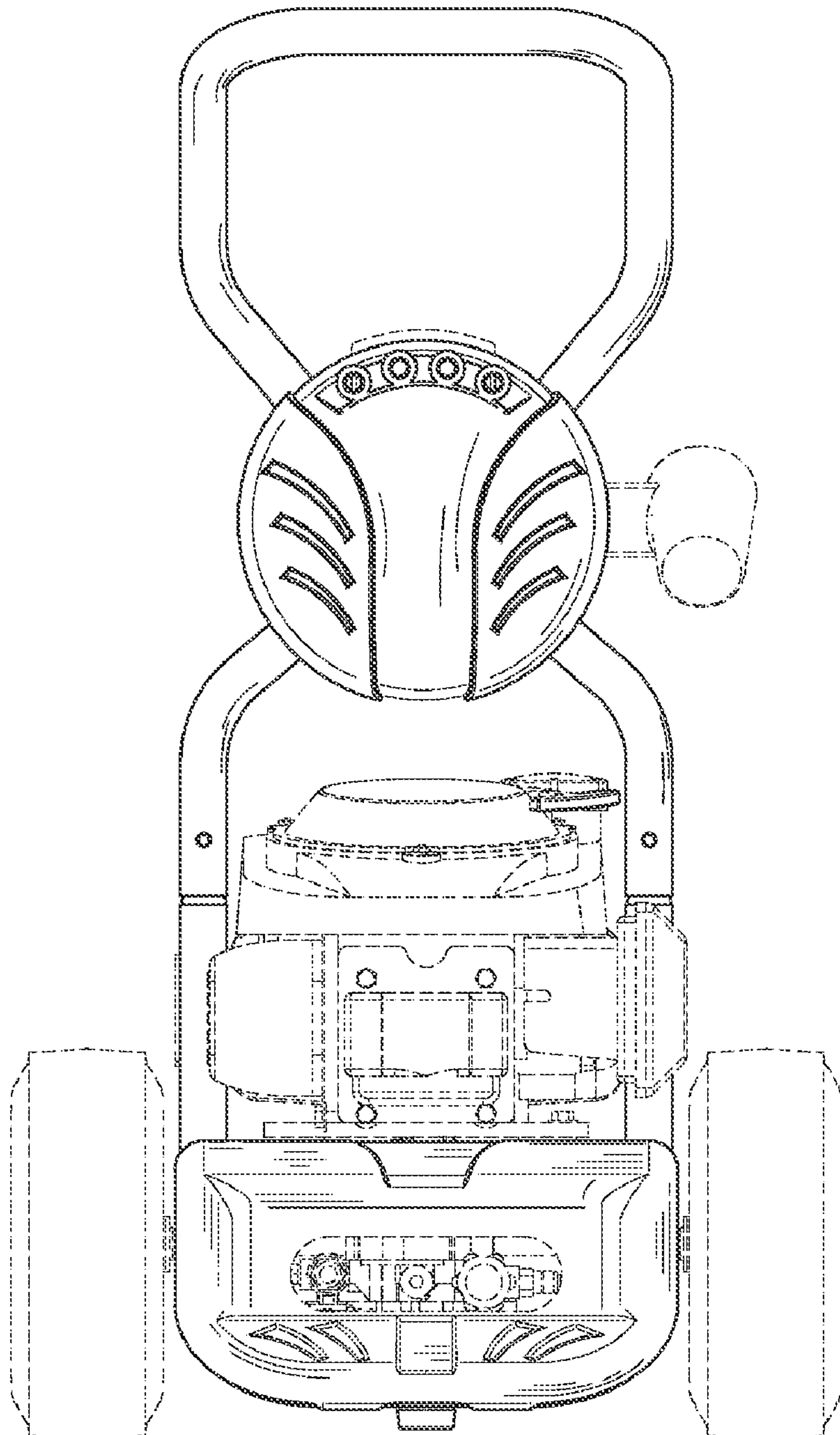

FIG. 3

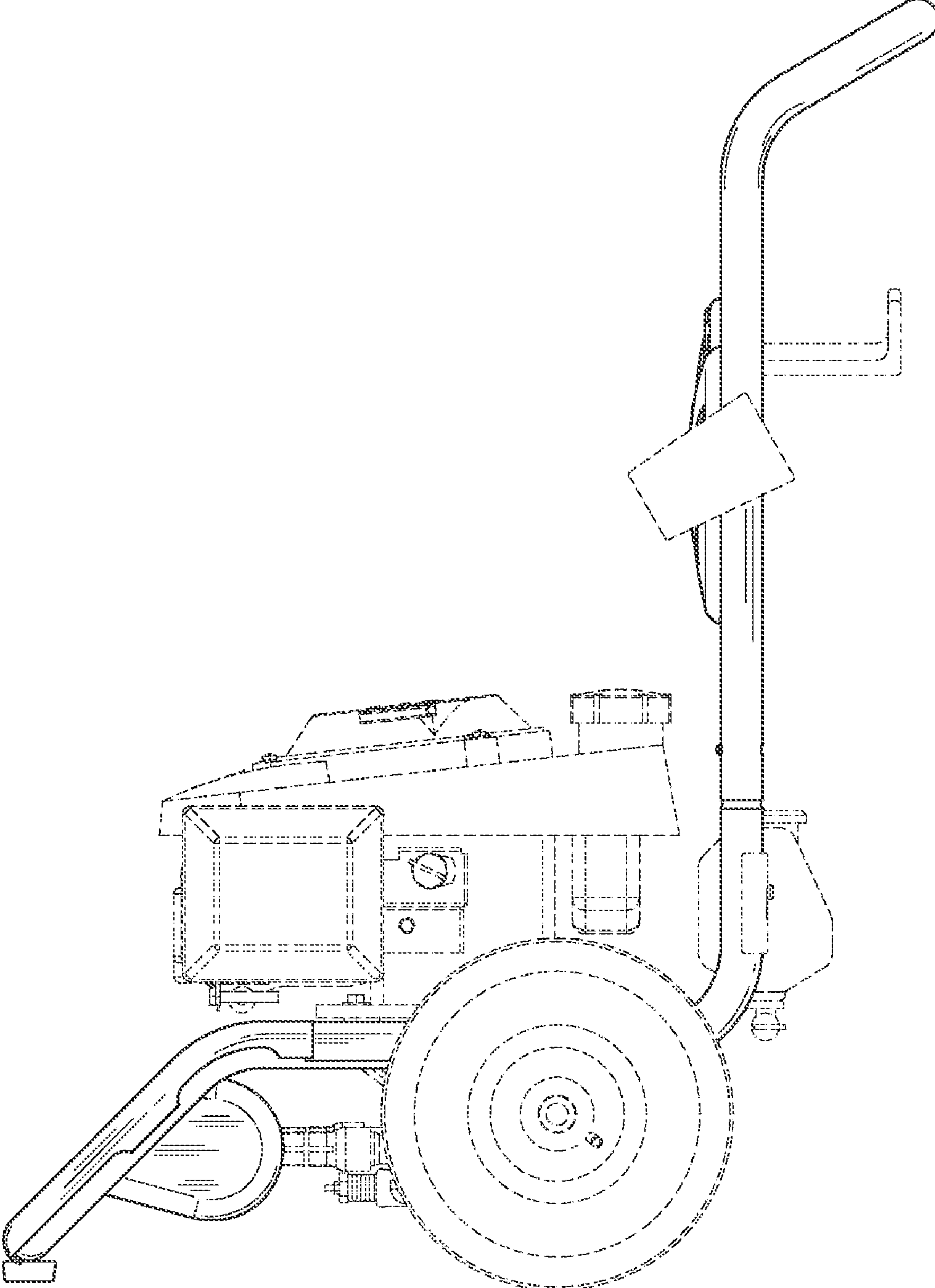

FIG. 4

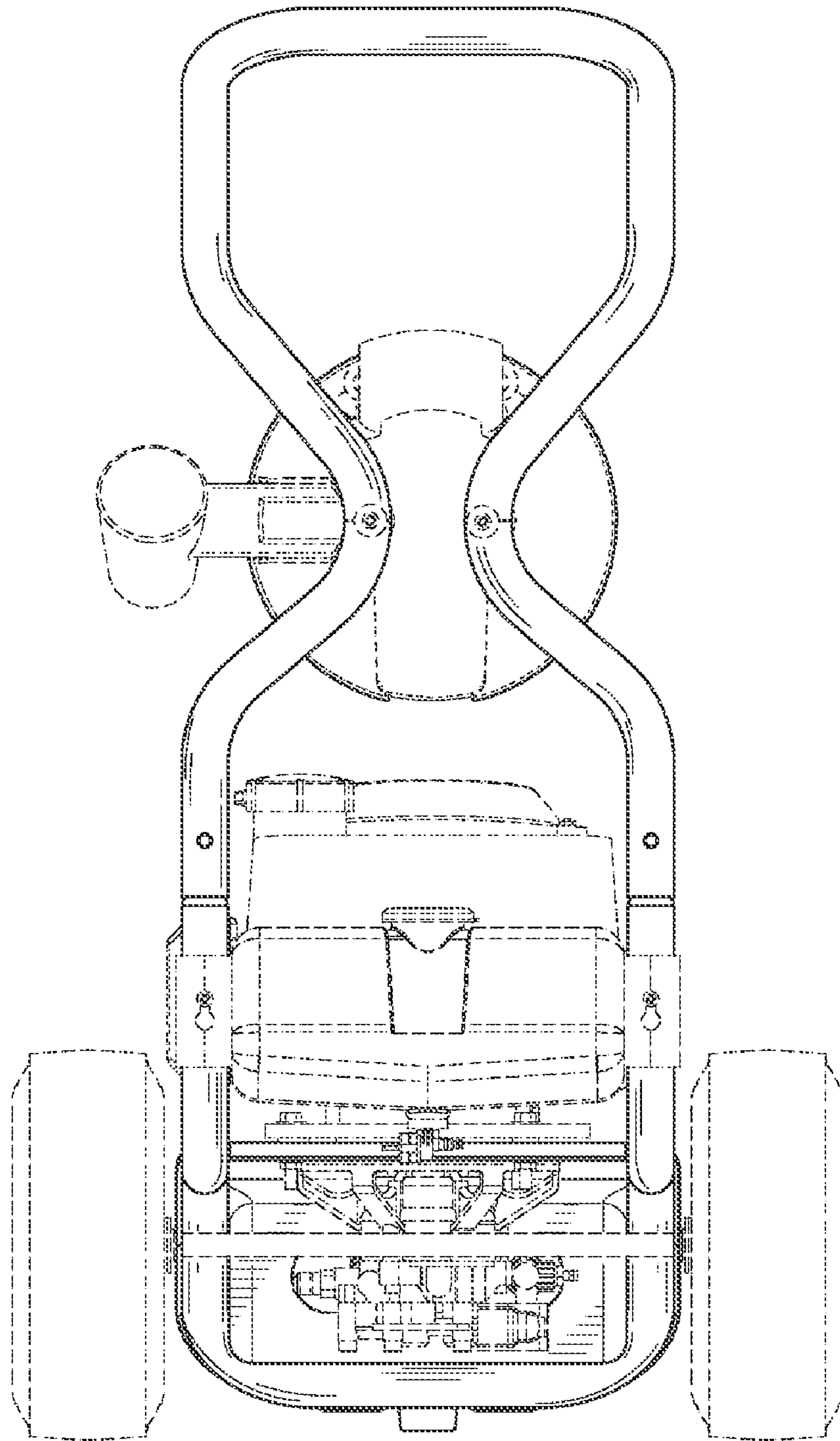

FIG. 5

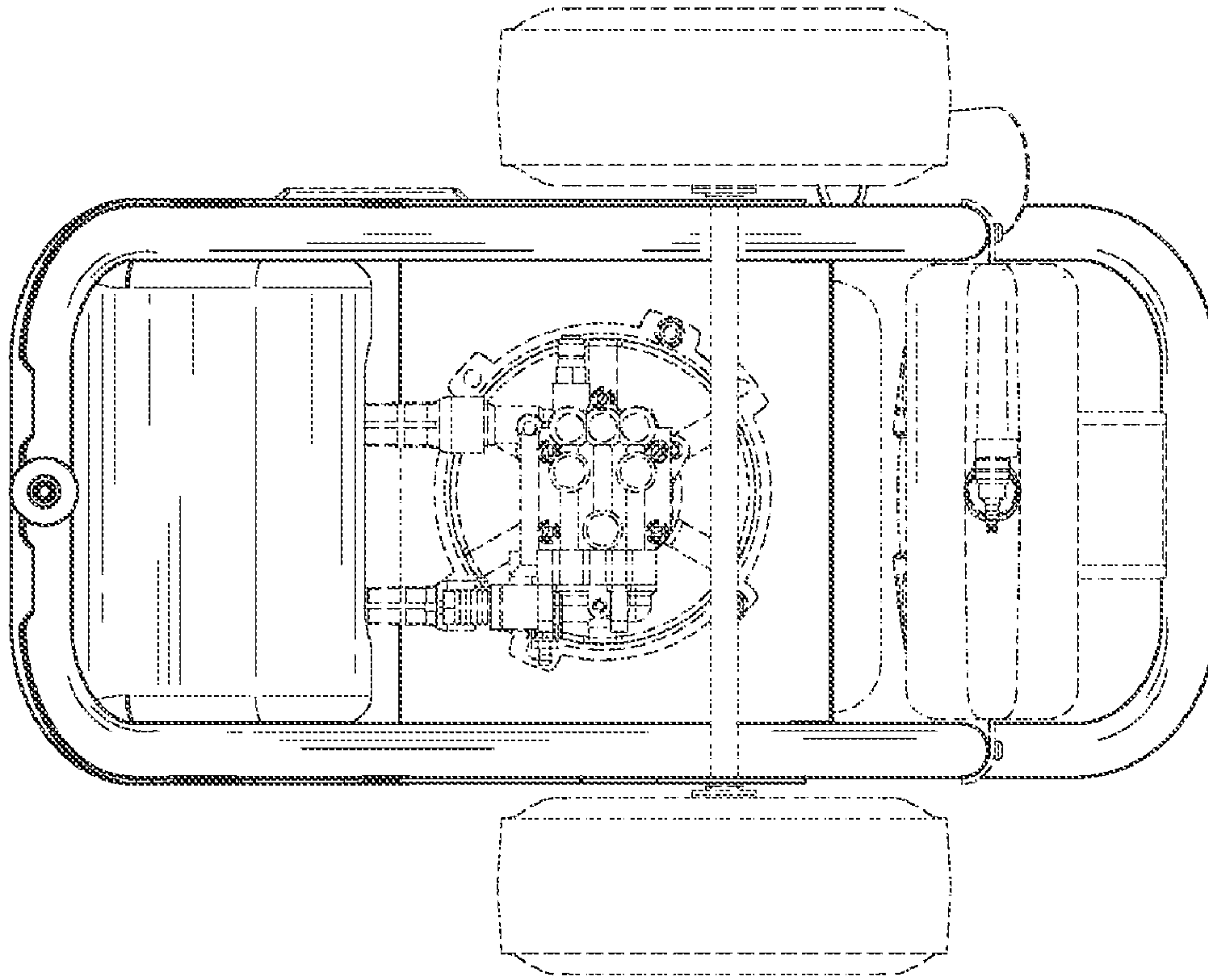

FIG. 6

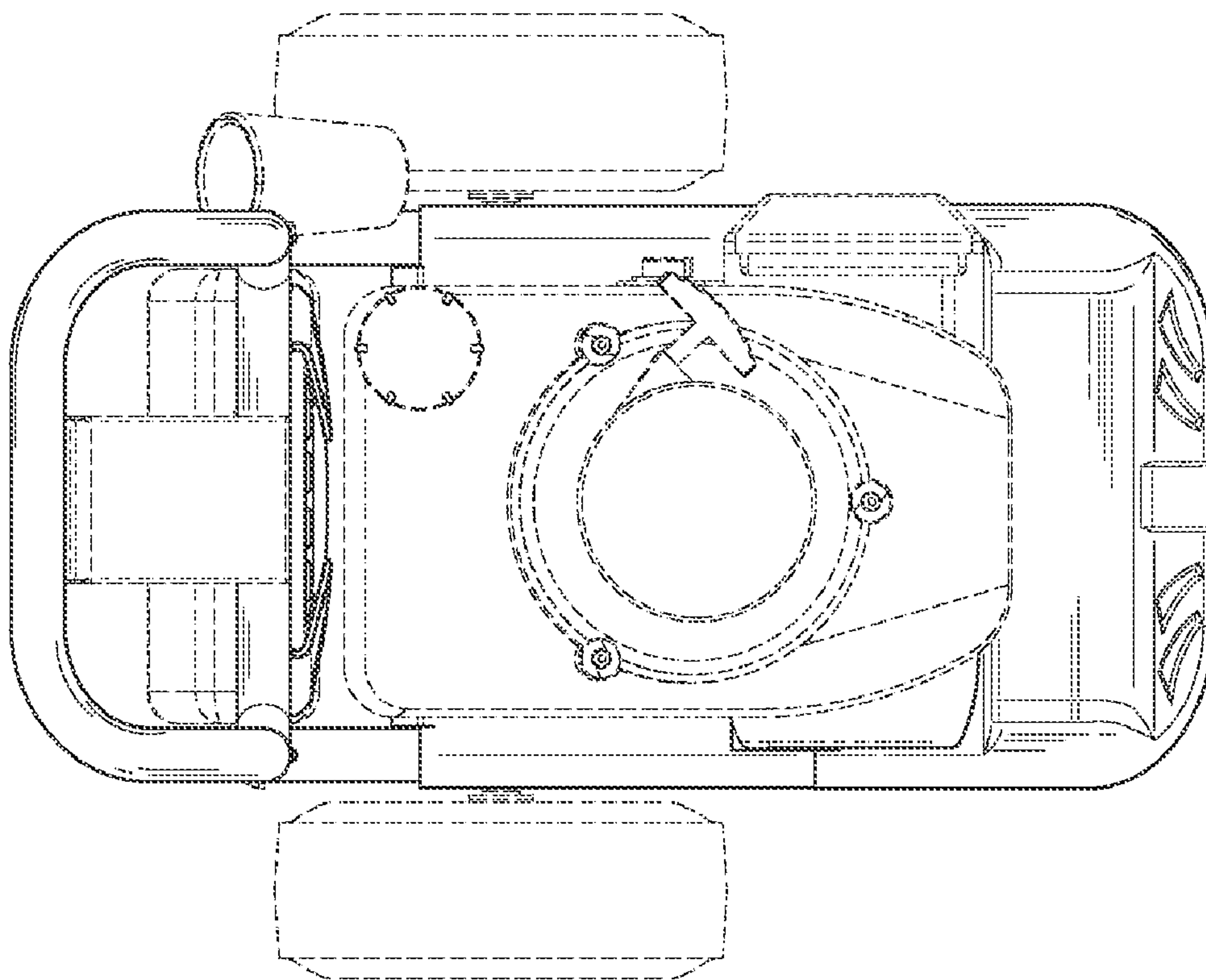

FIG. 7