



US00D638437S

(12) **United States Design Patent**
Cavanaugh et al.

(10) **Patent No.:** **US D638,437 S**

(45) **Date of Patent:** **** May 24, 2011**

(54) **DISPLAY SCREEN WITH A GROUP OF
ICONS**

(75) Inventors: **Nathan R. Cavanaugh**, Seattle, WA
(US); **Karthik G. Anbalagan**,
Redmond, WA (US); **Alan A. Urdan**,
Seattle, WA (US)

(73) Assignee: **Microsoft Corporation**, Redmond, WA
(US)

(**) Term: **14 Years**

(21) Appl. No.: **29/355,809**

(22) Filed: **Feb. 13, 2010**

(51) **LOC (9) Cl.** **32-00**

(52) **U.S. Cl.** **D14/488**

(58) **Field of Classification Search** D14/485-495;
D18/26, 31-33; D20/11, 12, 23-25, 29-32,
D20/36-38; 715/700-867, 973-977
See application file for complete search history.

(56) **References Cited**

U.S. PATENT DOCUMENTS

D396,853	S	*	8/1998	Cooper et al.	D14/493
D398,001	S	*	9/1998	Bohnert et al.	D14/493
D409,591	S	*	5/1999	Newton et al.	D14/490
5,974,171	A	*	10/1999	Hayashi et al.	382/162
D535,659	S	*	1/2007	Hally et al.	D14/485
D543,986	S	*	6/2007	Rimas-Ribikauskas et al.	D14/485
D544,492	S	*	6/2007	Rimas-Ribikauskas et al.	D14/485
D548,239	S	*	8/2007	Rimas-Ribikauskas et al.	D14/485
D568,892	S	*	5/2008	Stabb et al.	D14/485
7,477,321	B2	*	1/2009	Yokoyama et al.	348/553

D585,903	S	*	2/2009	Yamaoka	D14/485
D593,111	S	*	5/2009	Danton	D14/485
D594,016	S	*	6/2009	King	D14/486
D594,024	S	*	6/2009	King	D14/488
D606,080	S	*	12/2009	Murchie et al.	D14/485
D612,389	S	*	3/2010	Garcia	D14/485
D612,391	S	*	3/2010	Fletcher et al.	D14/486
D614,647	S	*	4/2010	Winjum	D14/488
D624,932	S	*	10/2010	Chaudhri	D14/488
D626,137	S	*	10/2010	McLaughlin et al.	D14/486
2007/0282871	A1	*	12/2007	Ohwa et al.	707/100
2010/0111429	A1	*	5/2010	Wang et al.	382/233
2010/0229115	A1	*	9/2010	Augustine et al.	715/800
2010/0293470	A1	*	11/2010	Zhao et al.	715/732

OTHER PUBLICATIONS

Symbol Source Book, by Henry Dreyfuss, Van Nostrand Reinhold
Company, New York, NY, © 1972, pp. 59 and 75-77.*
Screenshots from Microsoft Office 2003 and 2007, four color pages.
Date unknown but prior to the filing of this application.

* cited by examiner

Primary Examiner — Cathron C Brooks

Assistant Examiner — Karen E Kearney

(74) *Attorney, Agent, or Firm* — Banner & Witcoff, Ltd.

(57) **CLAIM**

The ornamental design for a display screen with a group of
icons, as shown and described.

DESCRIPTION

The FIGURE is a front view of a display screen with a group
of icons showing the new design.
The broken line showing of the portion of a display screen is
for the purpose of illustrating environmental structure and
forms no part of the claimed design.

1 Claim, 1 Drawing Sheet

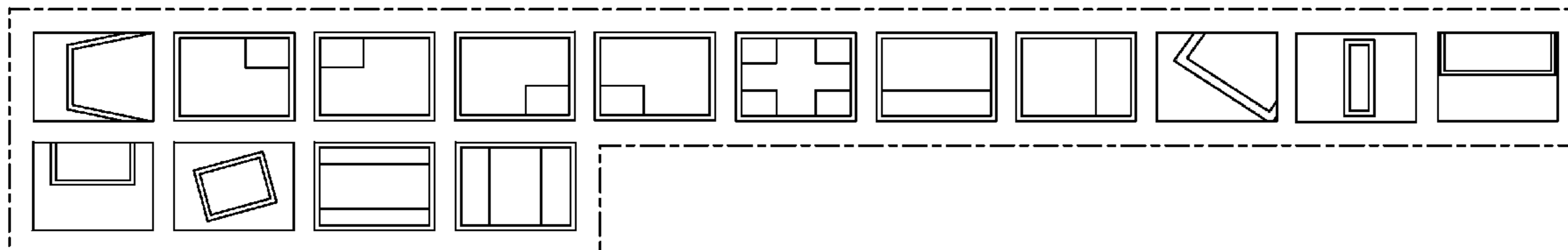

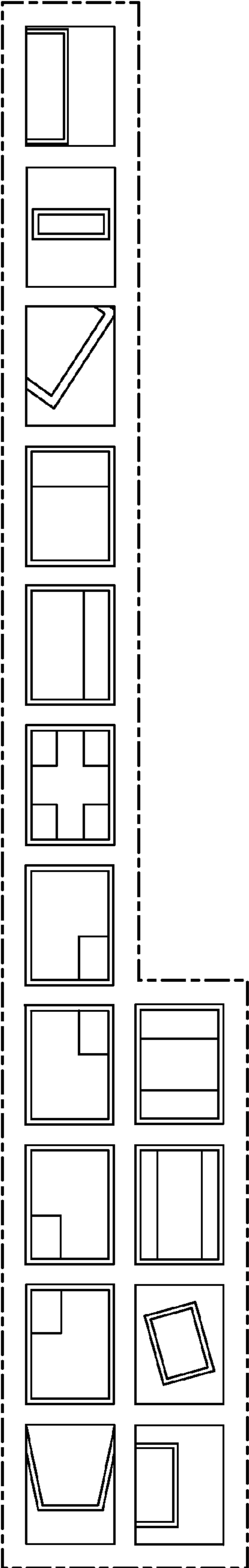

FIGURE