

US00D636652S

(12) **United States Design Patent**  
**Mehra**

(10) **Patent No.:** **US D636,652 S**

(45) **Date of Patent:** **\*\* Apr. 26, 2011**

(54) **CHAINSAW**

(75) **Inventor:** **Rajinder Mehra, Johanneshov (SE)**

(73) **Assignee:** **Husqvarna AB, Huskvarna (SE)**

(\*\*) **Term:** **14 Years**

(21) **Appl. No.:** **29/360,310**

(22) **Filed:** **Apr. 23, 2010**

(51) **LOC (9) Cl.** ..... **08-03**

(52) **U.S. Cl.** ..... **D8/65**

(58) **Field of Classification Search** ..... D8/65,  
D8/7, 8, 9, 70, 66, 67, 62, 63, 64, 61, 91;  
30/386, 383, 382, 371, 123, 381; 125/21;  
D21/532; 83/832, 833, 834; 123/185.3

See application file for complete search history.

(56) **References Cited**

**U.S. PATENT DOCUMENTS**

D364,326 S *	11/1995	Lohse et al. ....	D8/65
D386,958 S *	12/1997	Karlsson et al. ....	D8/65
D412,652 S *	8/1999	Durr et al. ....	D8/65
D538,123 S *	3/2007	Yates ....	D8/65
D558,019 S *	12/2007	Granberg et al. ....	D8/65
D558,020 S *	12/2007	Karlsson et al. ....	D8/65
D563,747 S *	3/2008	Tinius ....	D8/65

D574,207 S *	8/2008	Arnesson et al. ....	D8/65
D606,829 S *	12/2009	Tinius ....	D8/65
D607,292 S *	1/2010	Tinius ....	D8/65
D607,293 S *	1/2010	Tinius ....	D8/65
D615,836 S *	5/2010	Kosugi et al. ....	D8/65
2004/0103857 A1 *	6/2004	Kruse ....	123/1 R
2006/0230900 A1 *	10/2006	Bergquisto ....	83/381
2006/0254557 A1 *	11/2006	Hamisch et al. ....	123/198 E

\* cited by examiner

*Primary Examiner* — Austin Murphy

(74) *Attorney, Agent, or Firm* — Novak Druce + Quigg LLP

(57) **CLAIM**

I claim the ornamental design for a chainsaw, as shown and described.

**DESCRIPTION**

FIG. 1 is a perspective view of a chainsaw;  
FIG. 2 is a rear elevational view thereof;  
FIG. 3 is a front elevational view thereof;  
FIG. 4 is a right side elevational view thereof;  
FIG. 5 is a left side elevational view thereof;  
FIG. 6 is a top plan view thereof; and,  
FIG. 7 is bottom plan view thereof.  
The broken lines shown in the drawings represent portions of the chain saw that form no part of the claimed design.

**1 Claim, 7 Drawing Sheets**

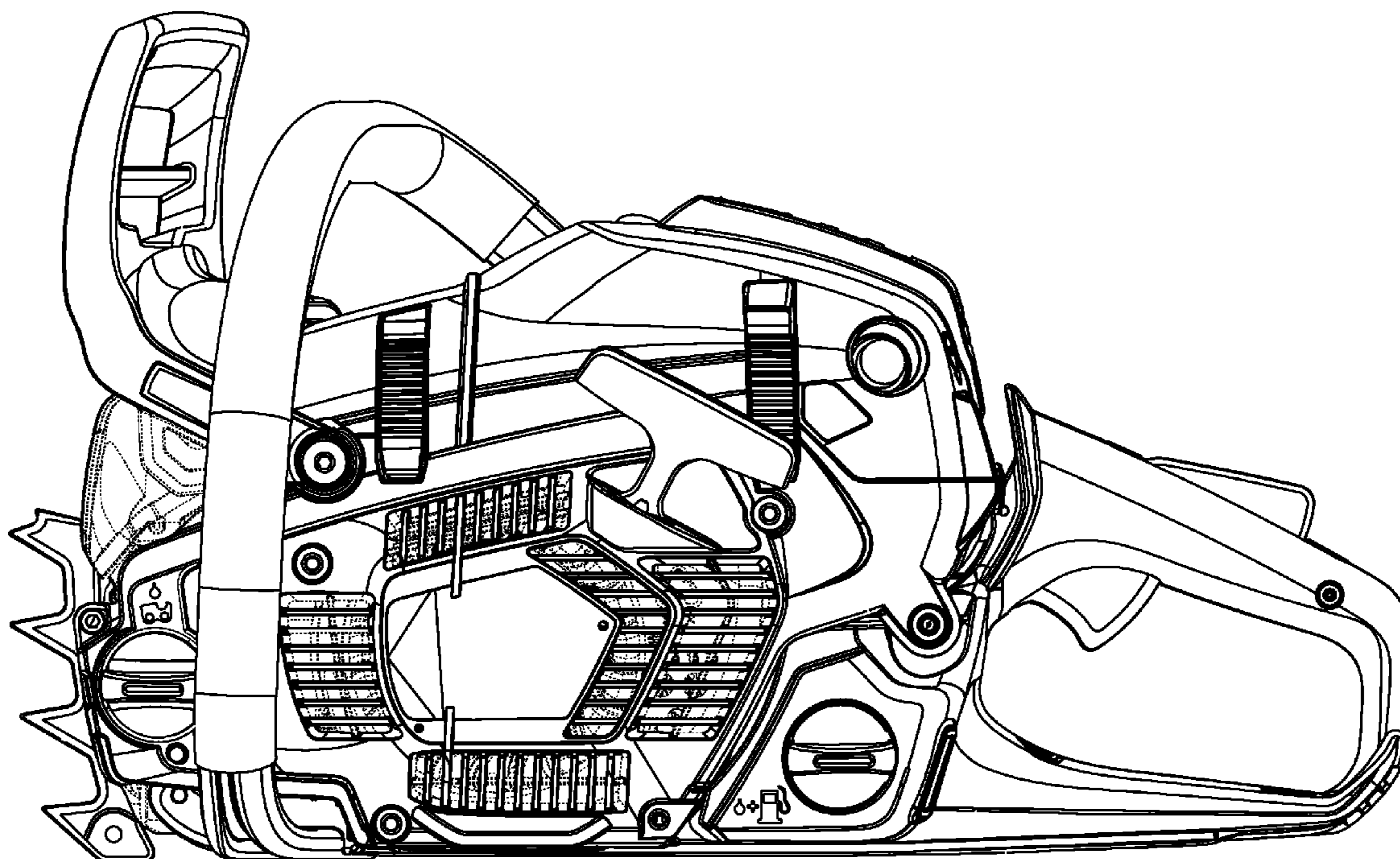

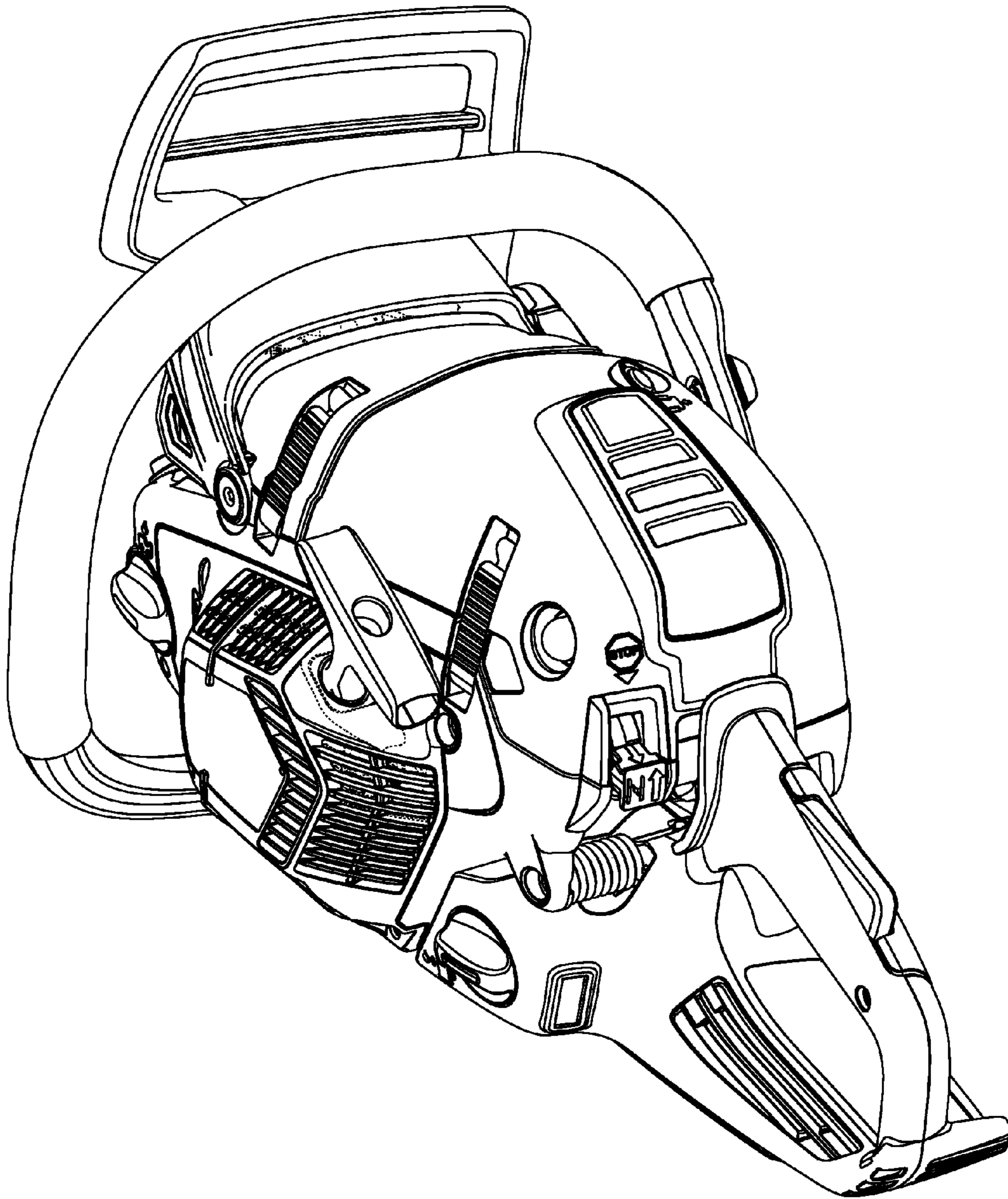

FIG. 1

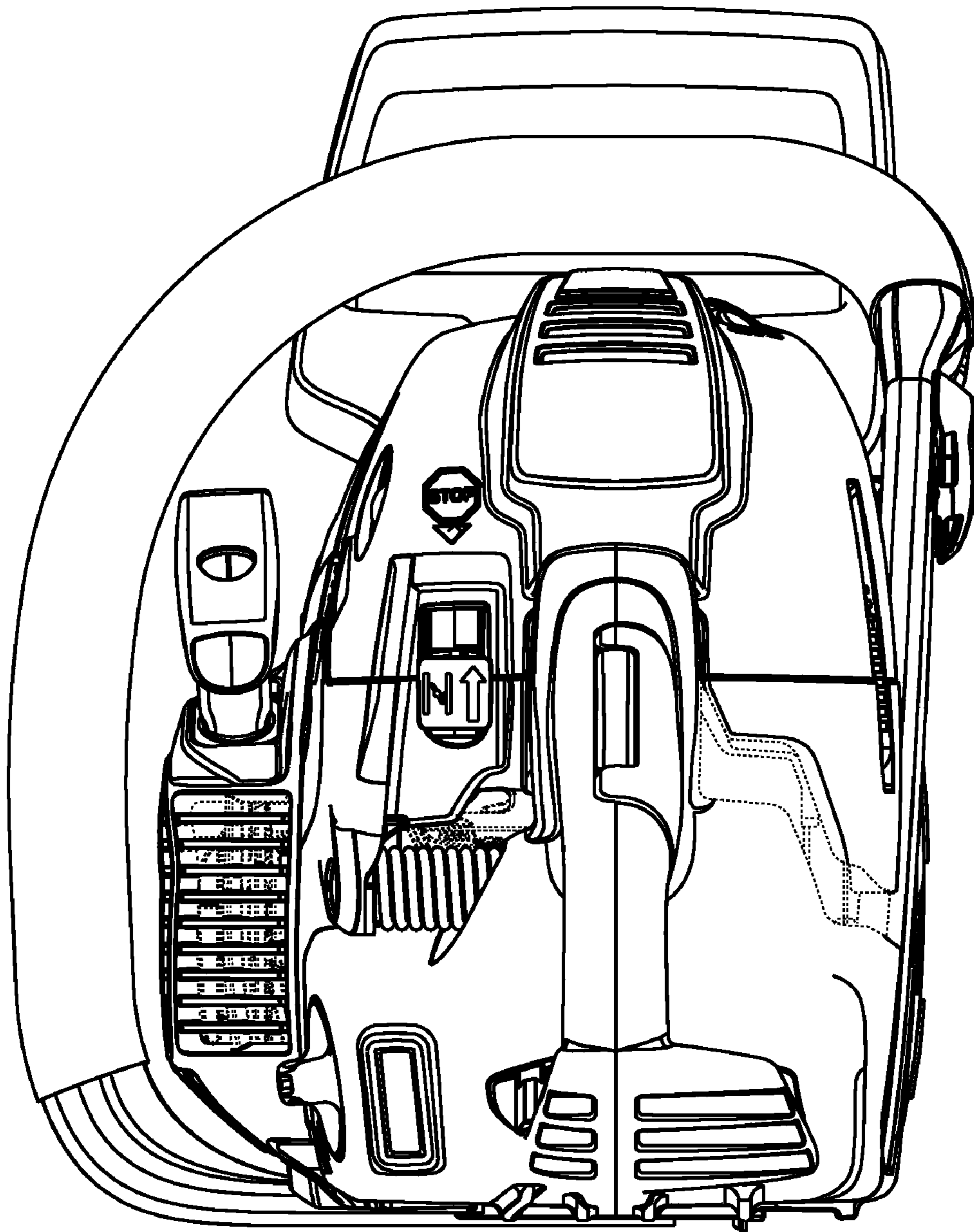

FIG. 2

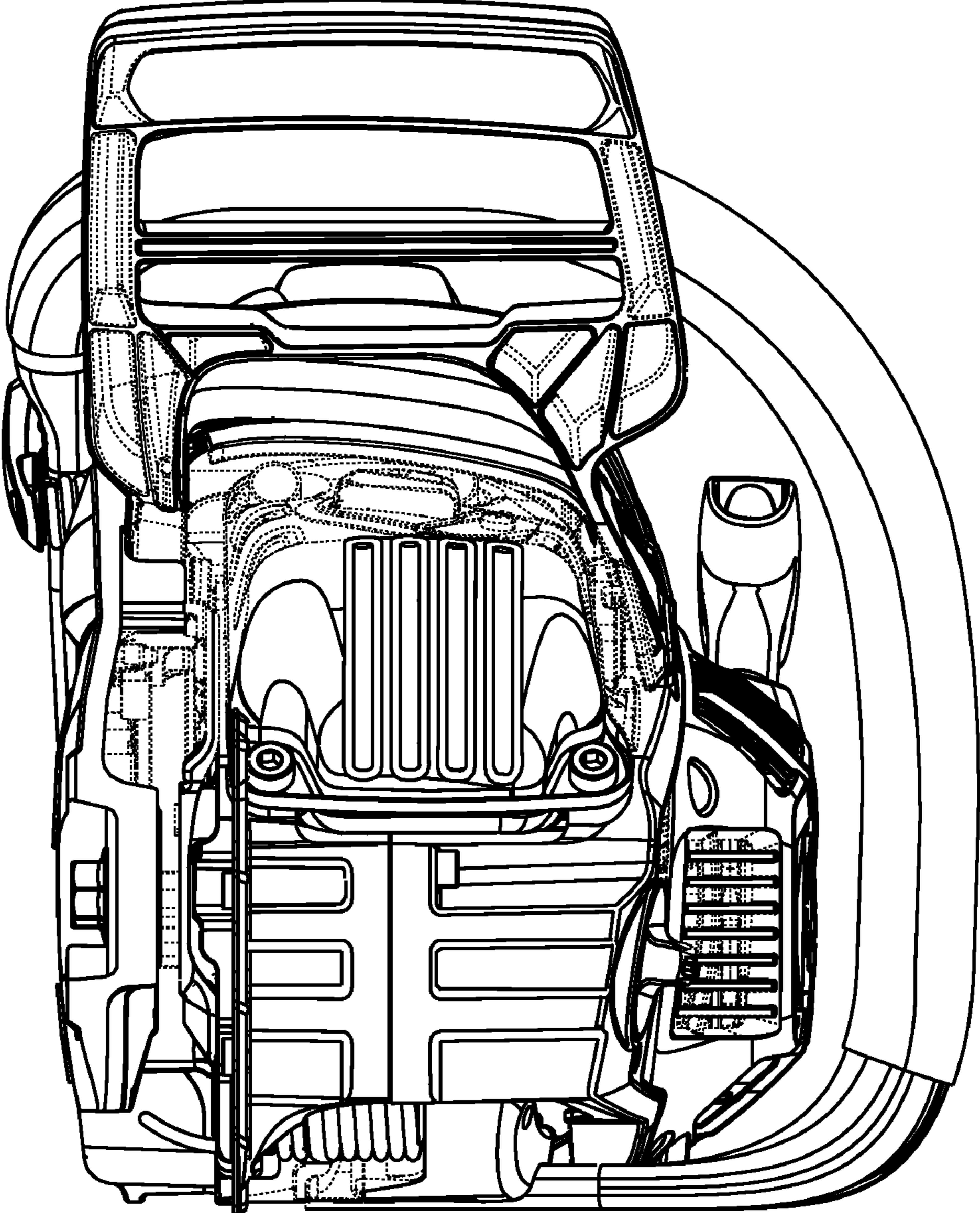

FIG. 3

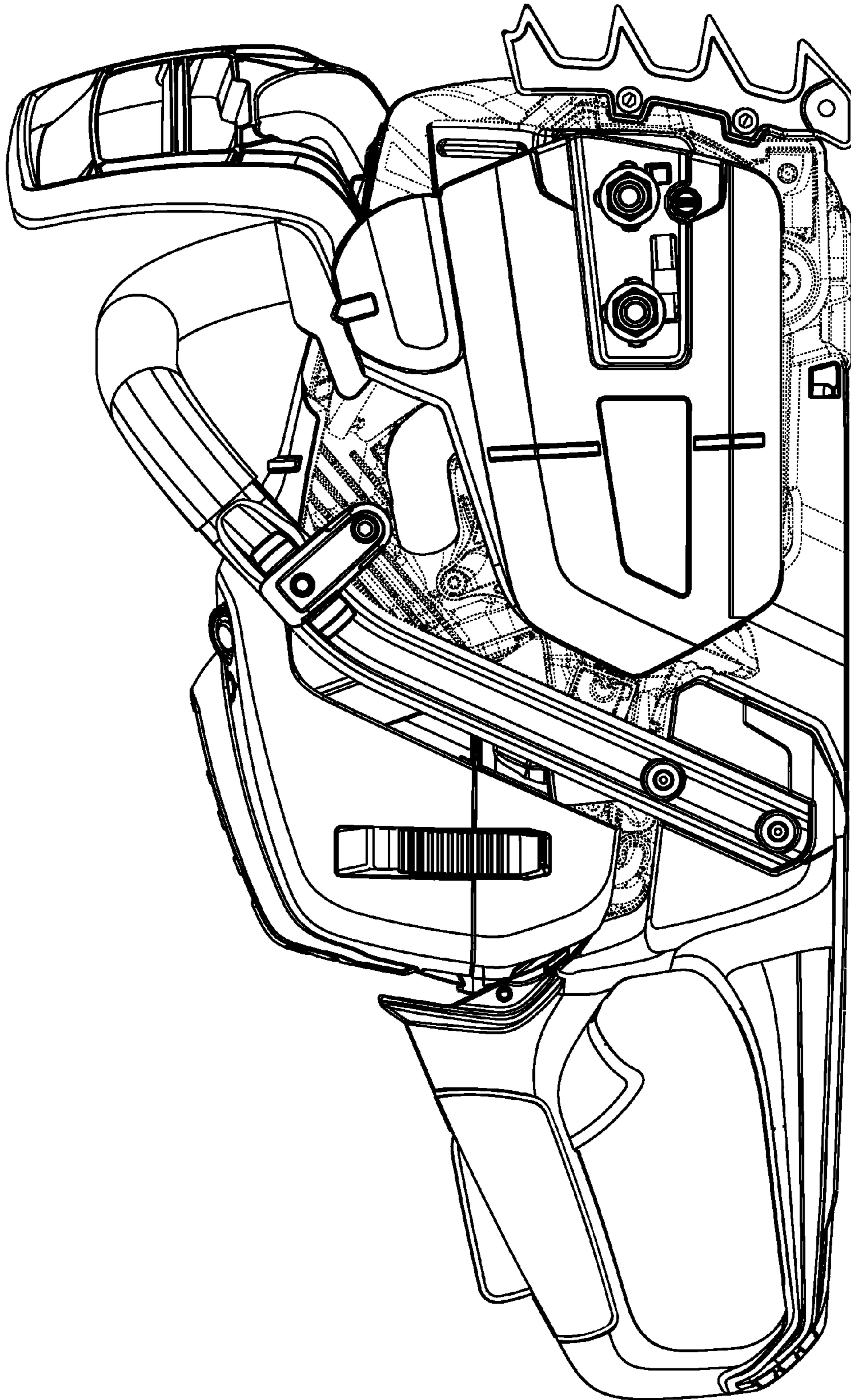

FIG. 4

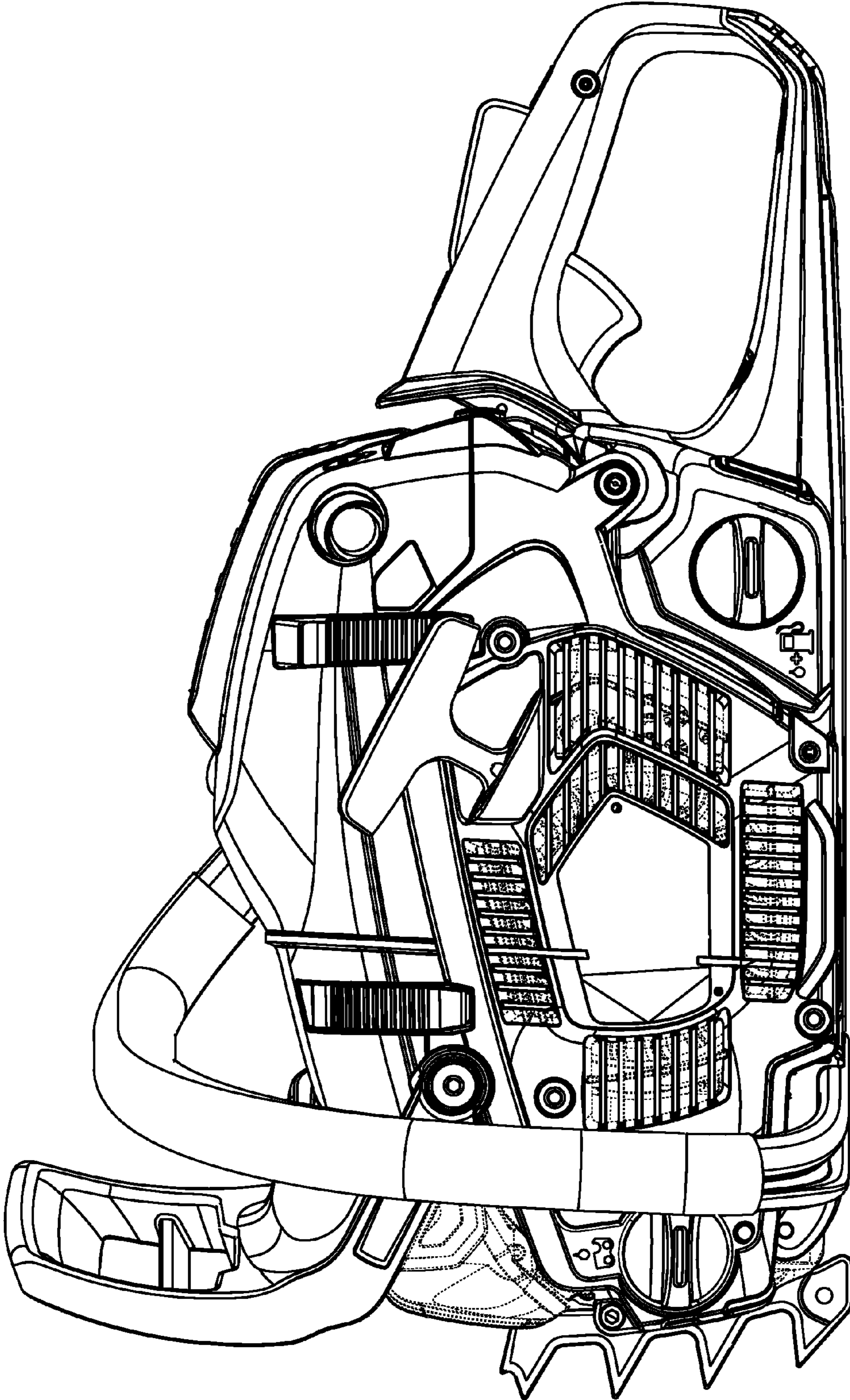

FIG. 5

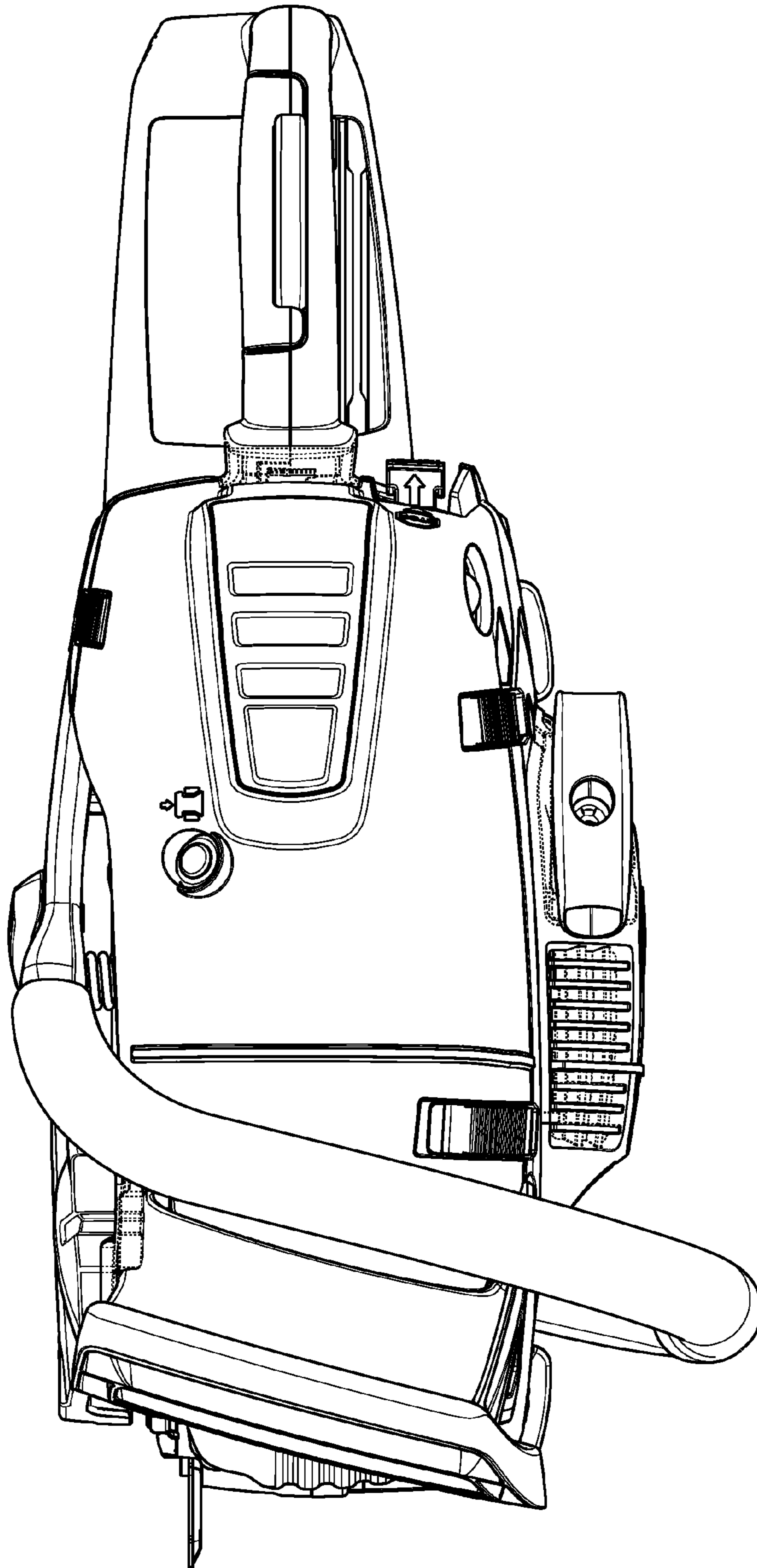

FIG. 6

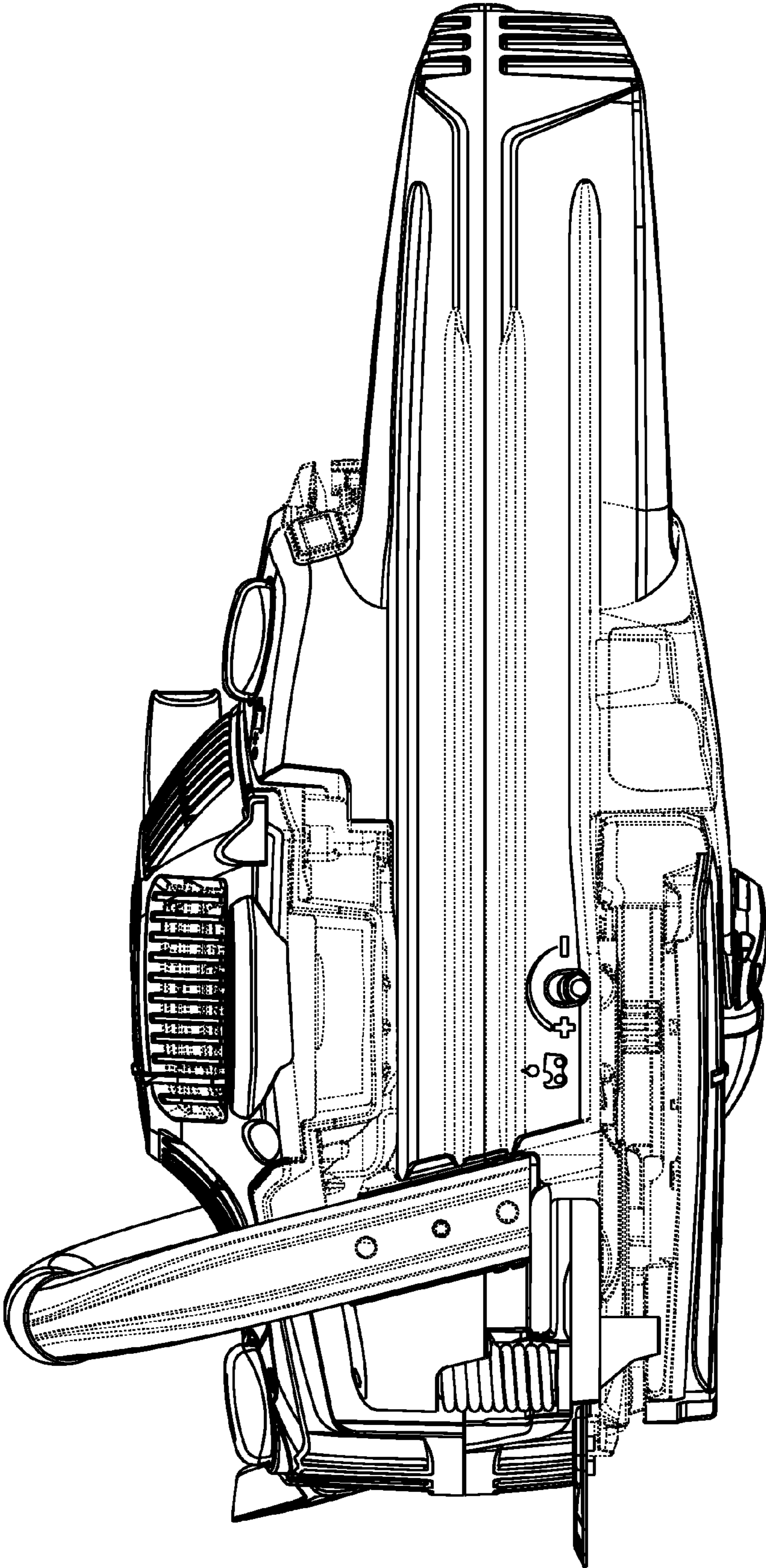

FIG. 7