



US00D635821S

(12) **United States Design Patent**  
**Waitkus**

(10) **Patent No.:** **US D635,821 S**

(45) **Date of Patent:** **\*\* Apr. 12, 2011**

(54) **SERVING TRAY ACCESSORY**

*Primary Examiner* — Brian N Vinson

(76) Inventor: **Teresa Waitkus**, Las Vegas, NV (US)

(74) *Attorney, Agent, or Firm* — Howard & Howard Attorneys PLLC

(\*\*) Term: **14 Years**

(21) Appl. No.: **29/361,980**

(57) **CLAIM**

The ornamental design for a serving tray accessory, as shown and described herein.

(22) Filed: **May 18, 2010**

(51) **LOC (9) Cl.** ..... **07-01**

(52) **U.S. Cl.** ..... **D7/396.1**

(58) **Field of Classification Search** ..... D7/39.1,  
D7/387, 500, 550.1, 552.2, 554.3; 220/574,  
220/571, 571.1, 572, DIG. 12, DIG. 13  
See application file for complete search history.

**DESCRIPTION**

FIG. 1 is a top perspective view of the serving tray accessory; FIG. 2 is a bottom perspective view of the serving tray accessory; FIG. 3 is a top elevational view of the serving tray accessory; FIG. 4 is a front elevational view of the serving tray accessory; FIG. 5 is a side elevational view of the of the serving tray accessory; FIG. 6 is a rear elevational view of the of the serving tray accessory; and, FIG. 7 is a bottom elevational view of the serving tray accessory.

(56) **References Cited**

**U.S. PATENT DOCUMENTS**

D50,885 S *	6/1917	Fried	.....	D7/396.1
D195,345 S *	6/1963	Stageberg	.....	D7/396.1
D207,111 S *	3/1967	Stageberg	.....	D7/396.1
D211,202 S *	5/1968	Bergeron	.....	D7/396.1
D230,810 S *	3/1974	Ryan, Jr.	.....	D7/396.1
D283,774 S *	5/1986	Bratcher	.....	D7/396.1

\* cited by examiner

**1 Claim, 5 Drawing Sheets**

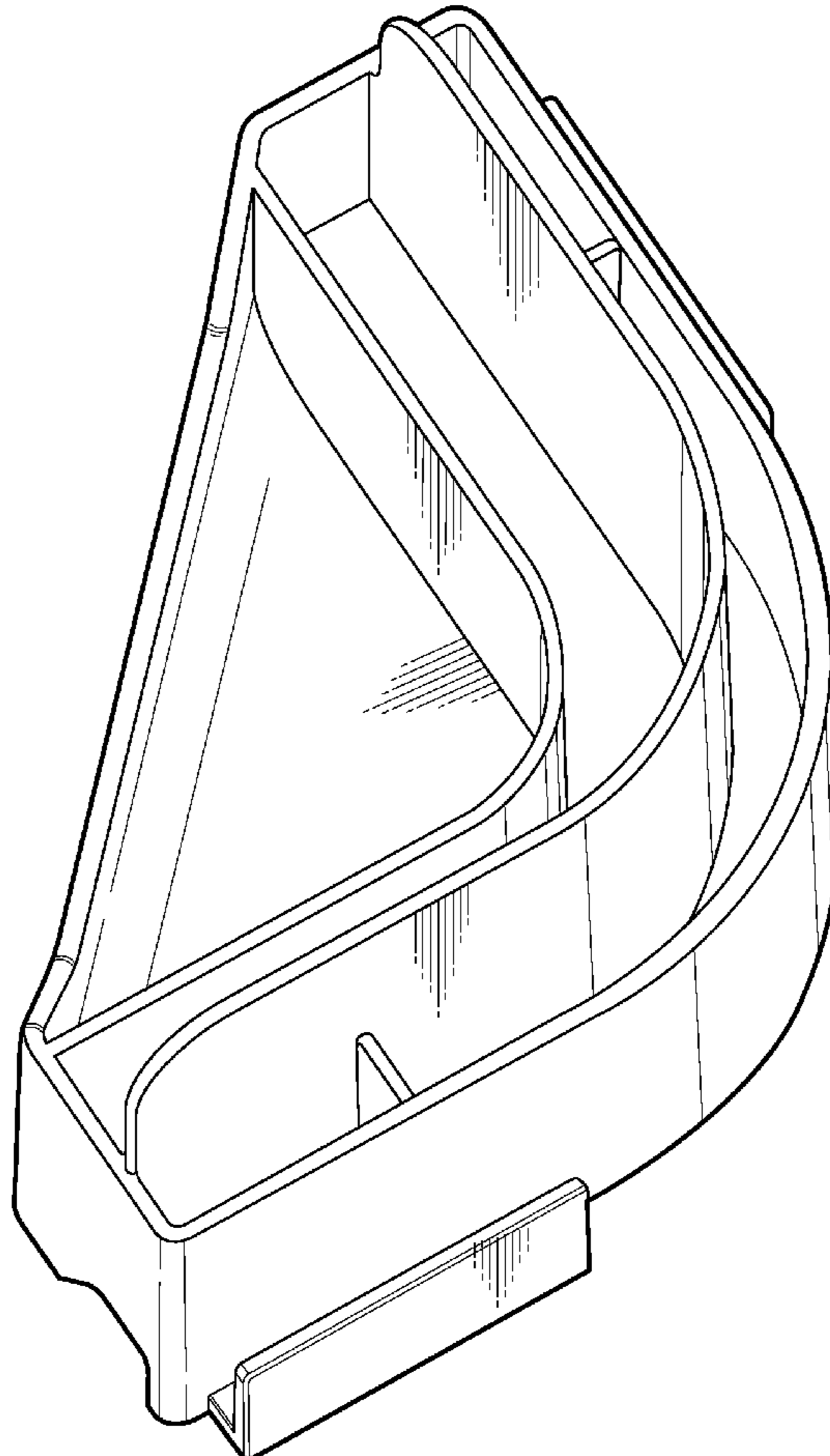

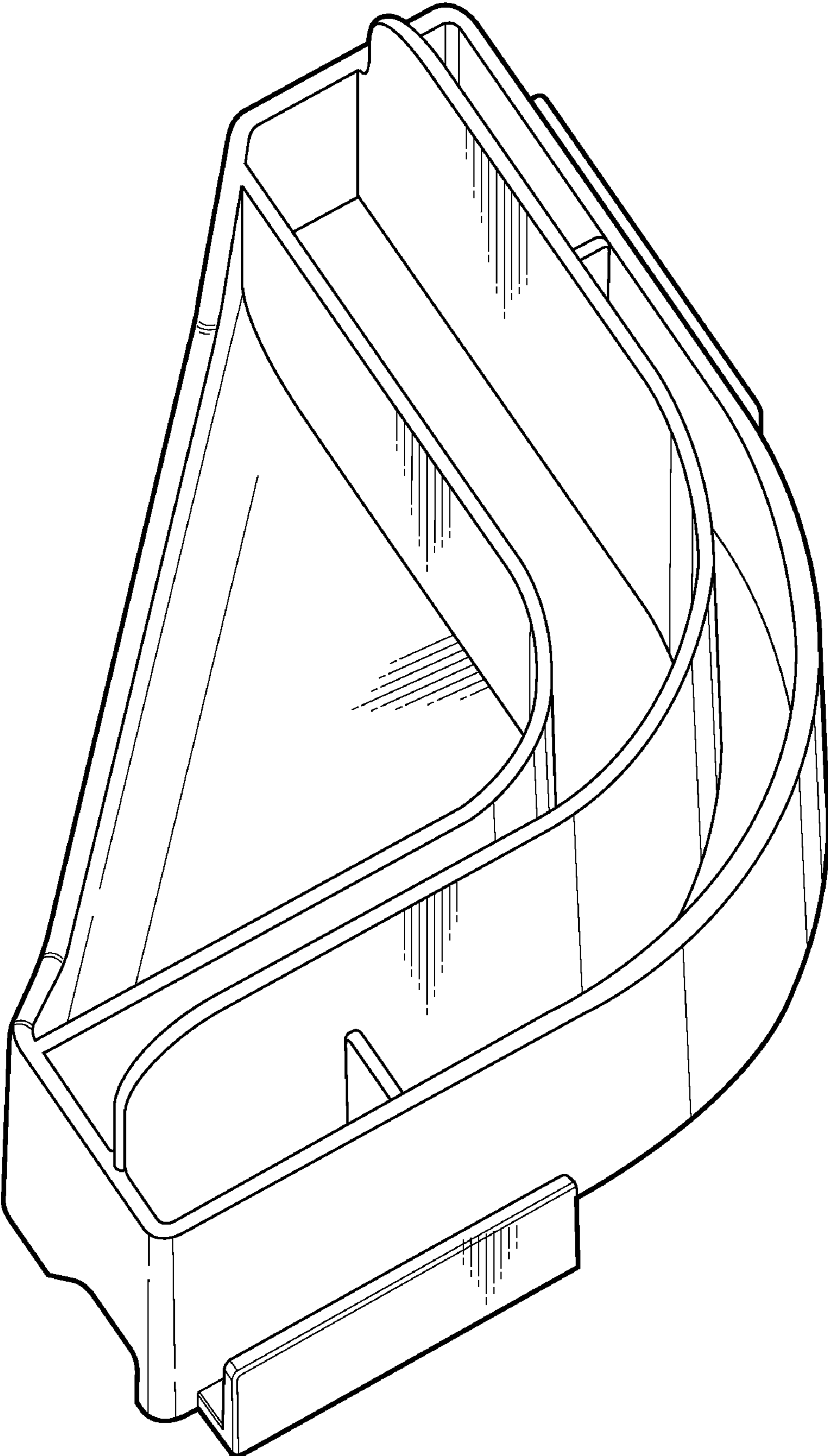

**FIG. 1**

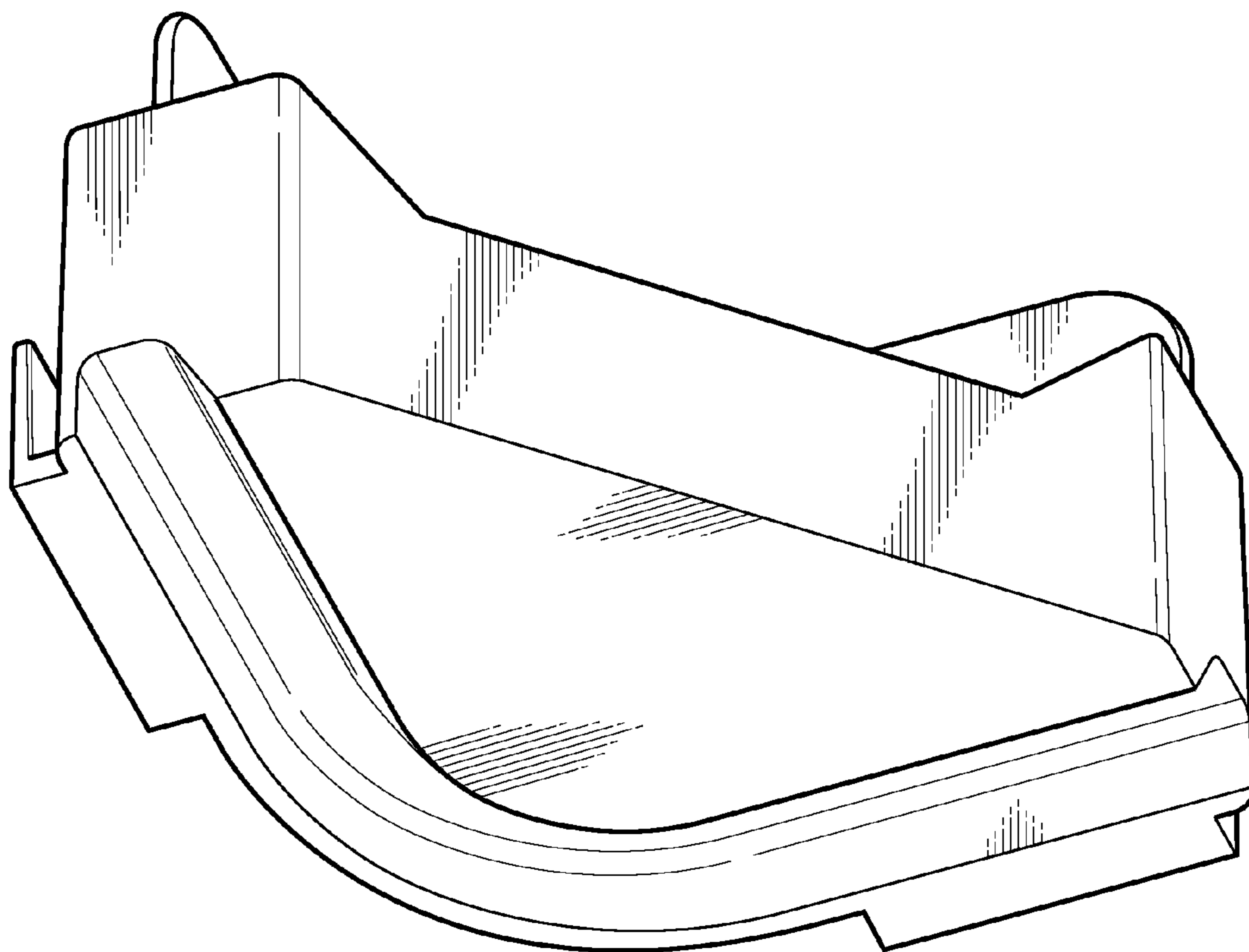

**FIG. 2**

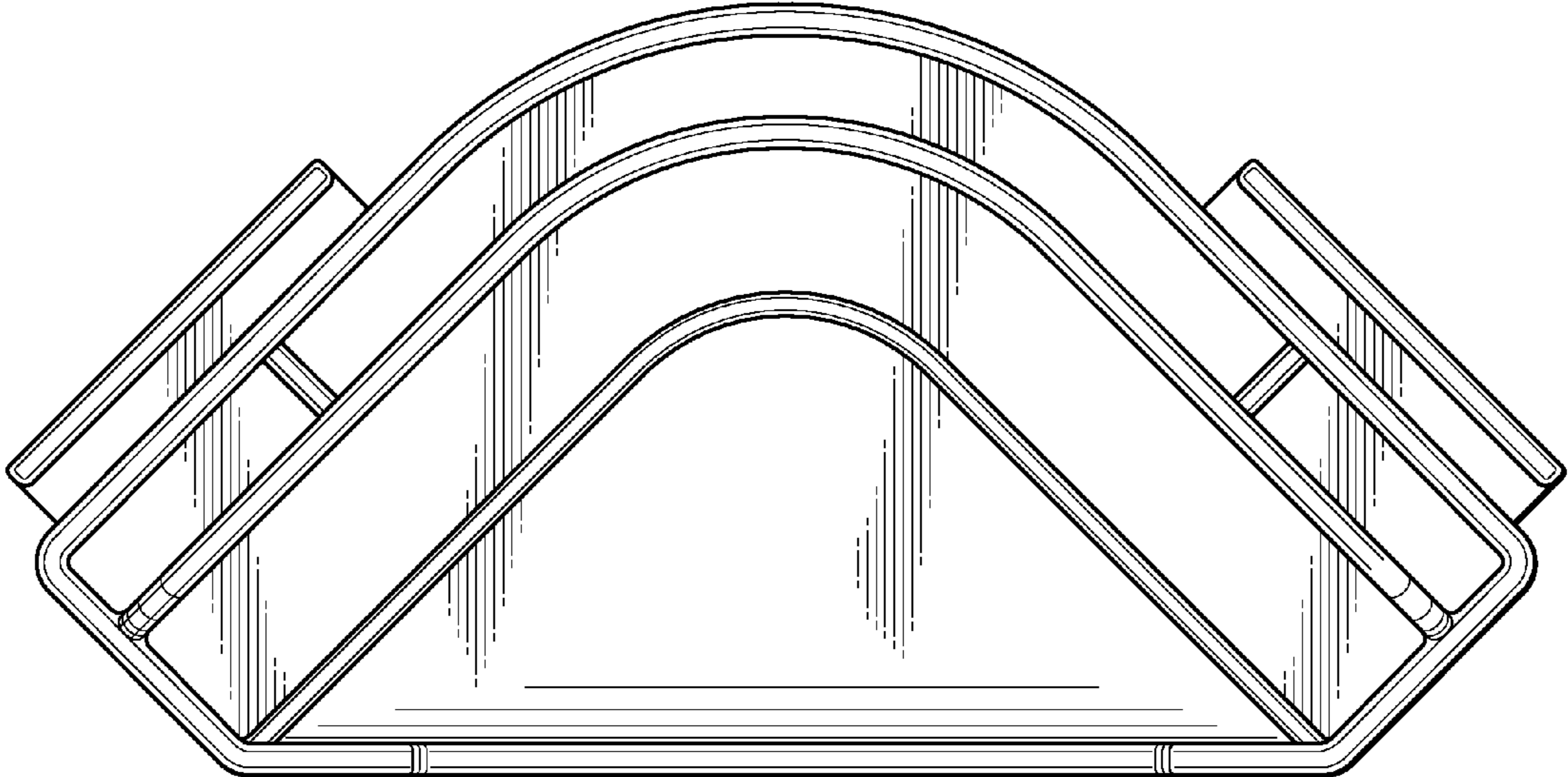

FIG. 3

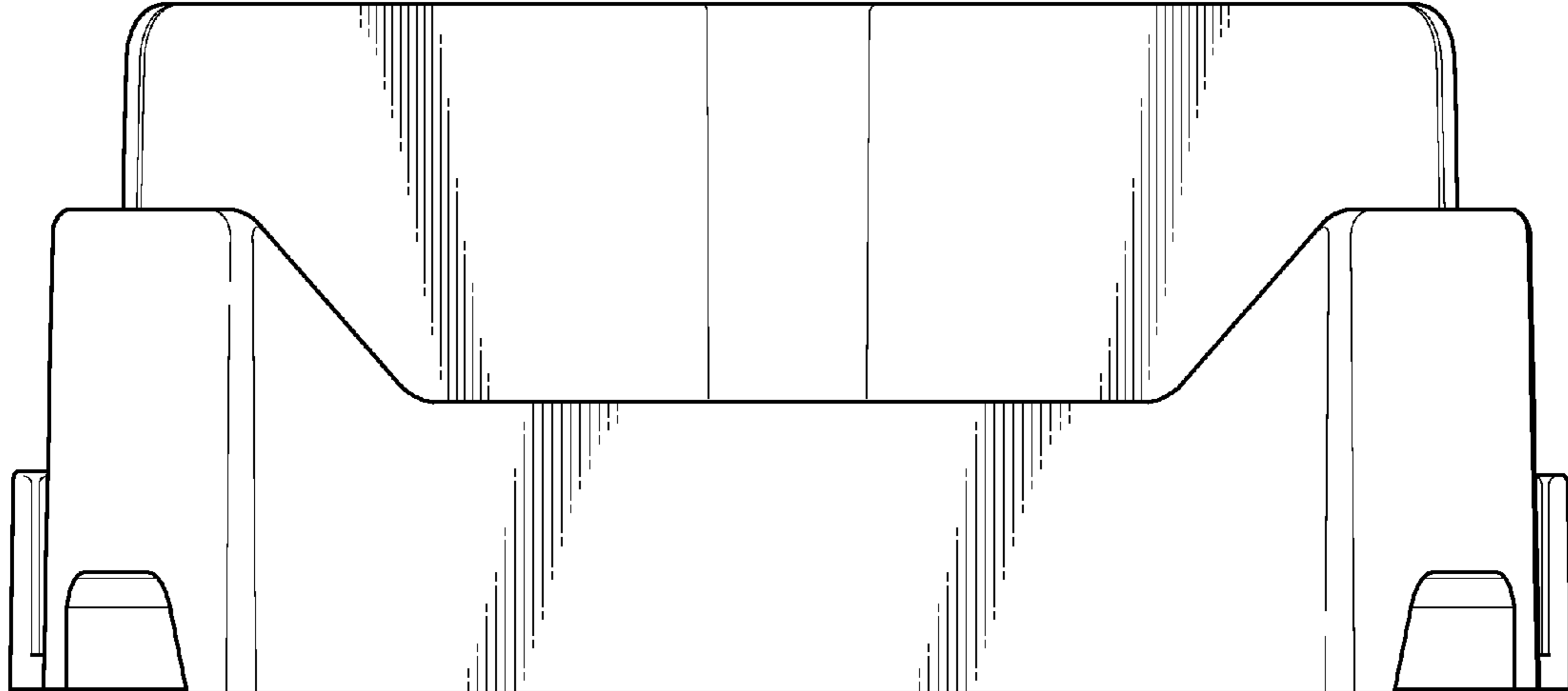

FIG. 4

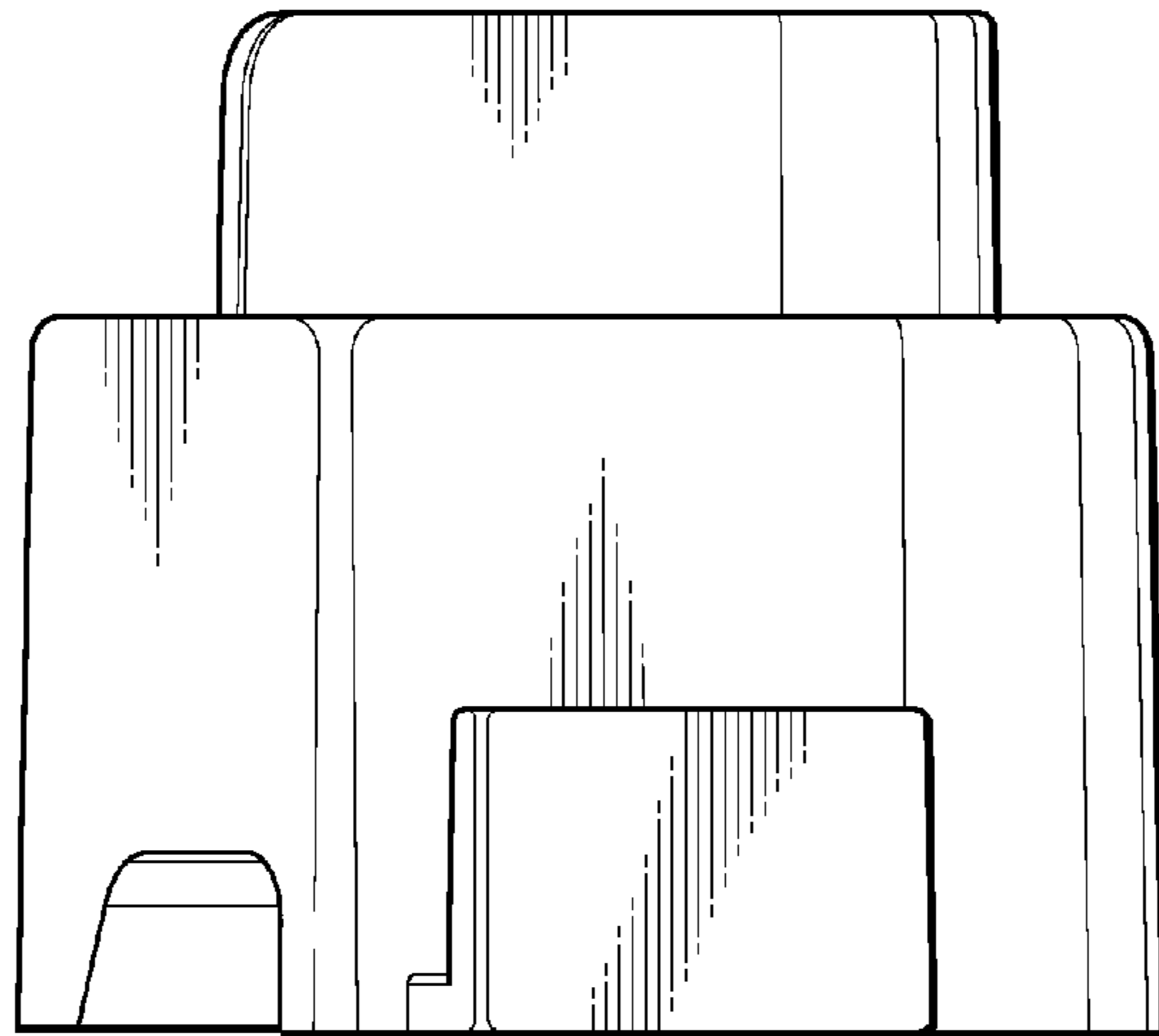

FIG. 5

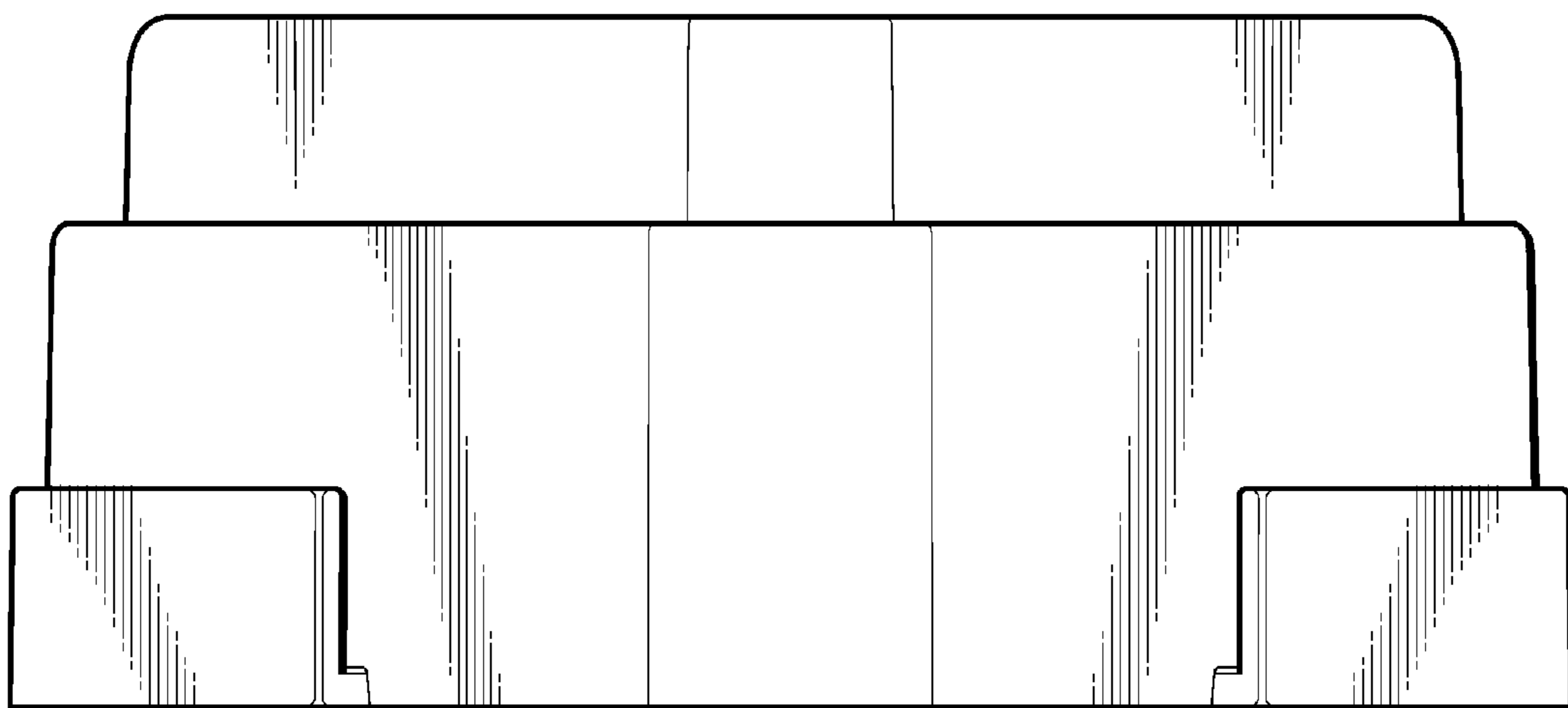

FIG. 6

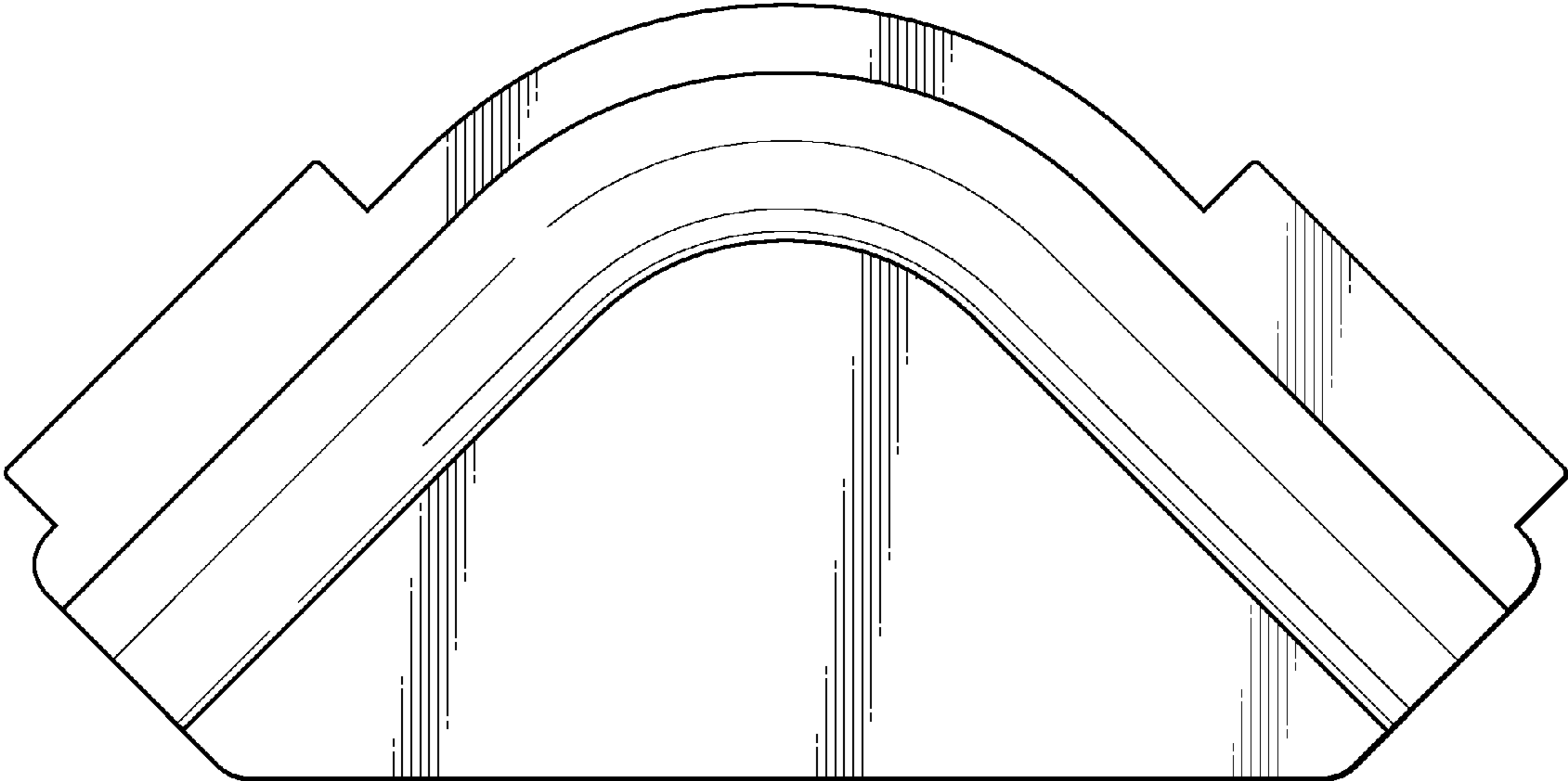

FIG. 7