

US00D635445S

(12) **United States Design Patent**  
**Foresman**

(10) **Patent No.:** **US D635,445 S**

(45) **Date of Patent:** **\*\* Apr. 5, 2011**

(54) **WIRE TANG CASTING**

(76) Inventor: **Robert Foresman**, San Juan Capistrano,  
CA (US)

(\*\*) Term: **14 Years**

(21) Appl. No.: **29/348,356**

(22) Filed: **Dec. 24, 2009**

**Related U.S. Application Data**

(62) Division of application No. 29/314,158, filed on Mar.  
9, 2009.

(51) **LOC (9) Cl.** ..... **08-05**

(52) **U.S. Cl.** ..... **D8/354**

(58) **Field of Classification Search** ..... D8/323,  
D8/329, 349, 354, 356, 364, 367, 373, 380,  
D8/382, 499; D12/223; D34/35; 248/58,  
248/65, 67.5, 67.7, 68.1, 71, 74.1, 200, 205.1,  
248/213.1, 218.4, 231.9, 300-304, 309.1,  
248/314, 315; 242/566

See application file for complete search history.

D453,102	S *	1/2002	Postelwait	.....	D8/349
D465,188	S *	11/2002	McCoy et al.	.....	D12/223
6,672,547	B1 *	1/2004	Westerberg et al.	.....	248/74.1
6,732,982	B1 *	5/2004	Messinger	.....	248/74.1
D500,441	S *	1/2005	Senn	.....	D8/323
D512,903	S *	12/2005	Gallien	.....	D8/349
D523,730	S *	6/2006	Weinerman et al.	.....	D8/343
D542,505	S *	5/2007	Alba	.....	D34/35
D547,168	S *	7/2007	Churchill	.....	D8/382
D560,471	S *	1/2008	Short et al.	.....	D8/354
D563,769	S *	3/2008	Short et al.	.....	D8/354
D566,527	S *	4/2008	Cavarsan	.....	D8/356
D569,231	S *	5/2008	Terada et al.	.....	D8/354
D572,571	S *	7/2008	Terada et al.	.....	D8/354
D578,378	S *	10/2008	Huang	.....	D8/349
D581,250	S *	11/2008	Florent	.....	D8/349
7,464,905	B2 *	12/2008	Wang	.....	248/65
D604,148	S *	11/2009	Clarke	.....	D8/356
2008/0054126	A1 *	3/2008	Wang	.....	248/65

\* cited by examiner

*Primary Examiner* — Cynthia M Chin

(74) *Attorney, Agent, or Firm* — G. Donald Weber, Jr.

(57) **CLAIM**

The ornamental design for a wire tang casting, as shown and described.

**DESCRIPTION**

FIG. 1 is a perspective view of the wire tang casting of the instant invention.

FIG. 2 is a front view of the casting shown in FIG. 1.

FIG. 3 is a rear view of the casting shown in FIG. 1.

FIG. 4 is a side view of the casting shown in FIG. 1. The opposite side view is the mirror image.

FIG. 5 is a top end view of the casting shown in FIG. 1; and,

FIG. 6 is a bottom end view of the casting shown in FIG. 1.

**1 Claim, 3 Drawing Sheets**

(56) **References Cited**

**U.S. PATENT DOCUMENTS**

D43,847	S *	4/1913	Mallory	.....	D8/349
2,155,189	A *	4/1939	Heinrich	.....	248/71
D345,904	S *	4/1994	Sauber	.....	D8/354
D348,827	S *	7/1994	Berti et al.	.....	D8/382
D371,504	S *	7/1996	Massie	.....	D8/349
D395,996	S *	7/1998	Fischer	.....	D8/349
D402,881	S *	12/1998	Fischer	.....	D8/354
D409,895	S *	5/1999	Schron et al.	.....	D8/349
D420,566	S *	2/2000	Ely et al.	.....	D8/354
D426,453	S *	6/2000	Stearns et al.	.....	D8/354

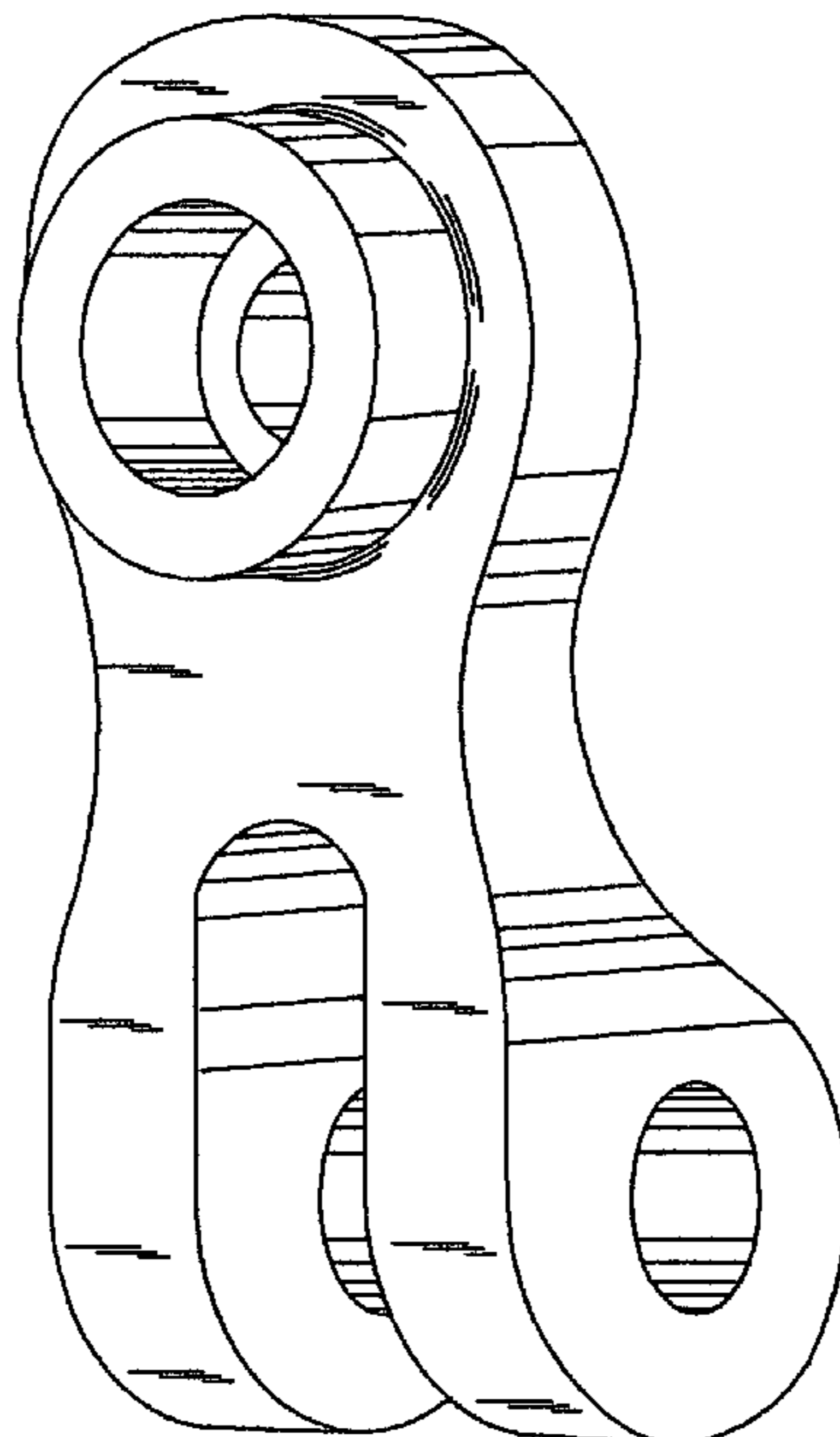

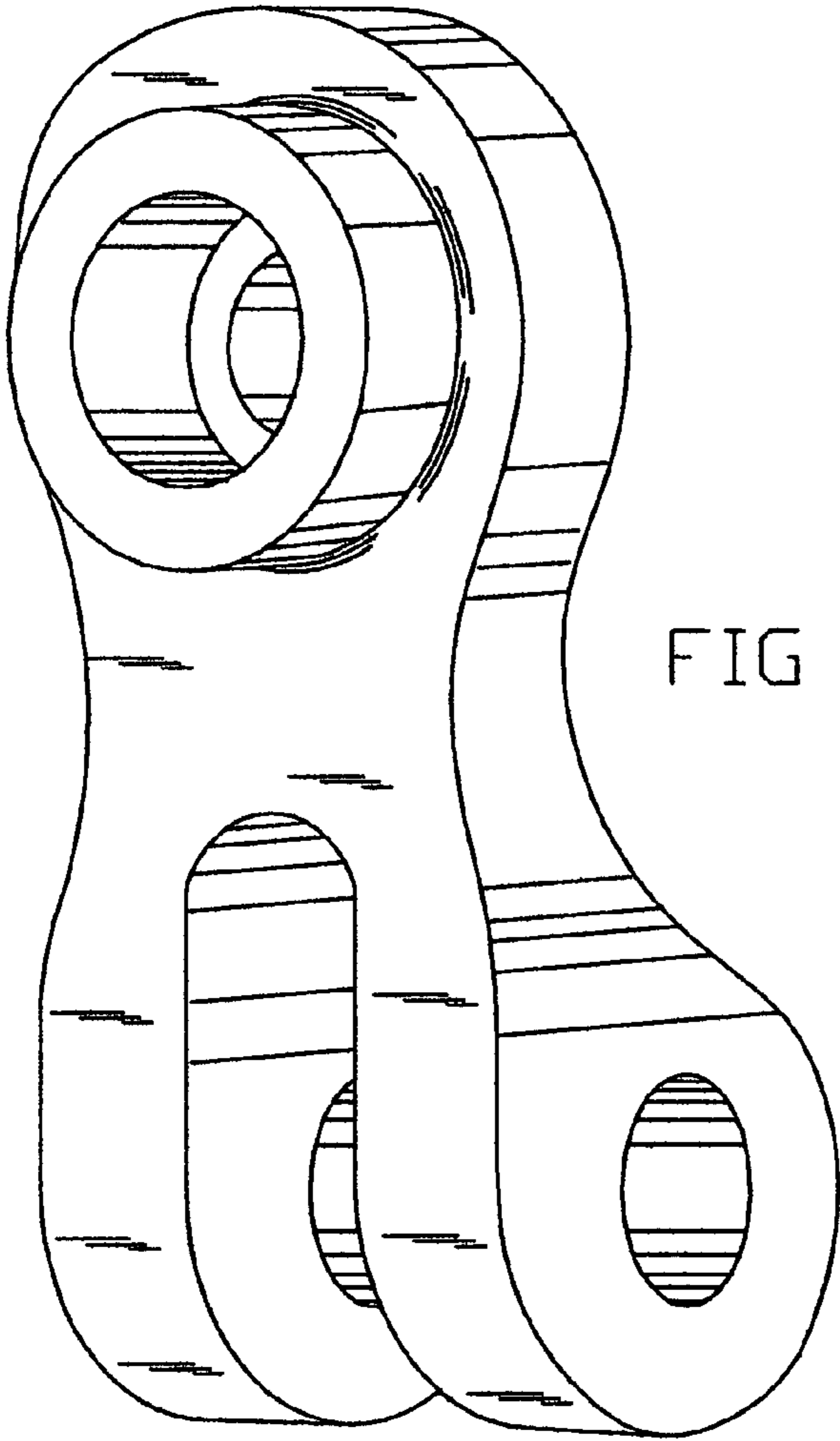

FIG 1

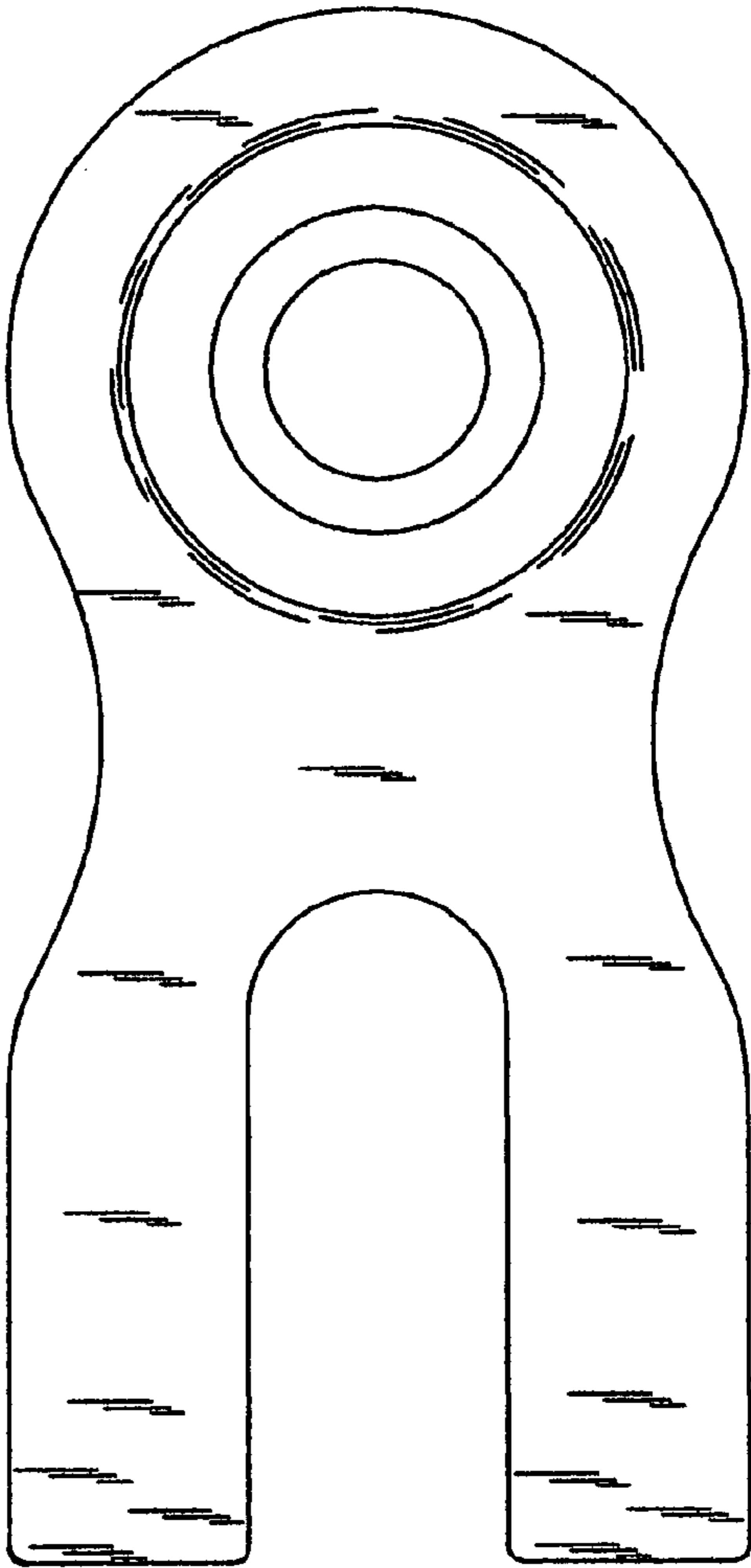

FIG 2

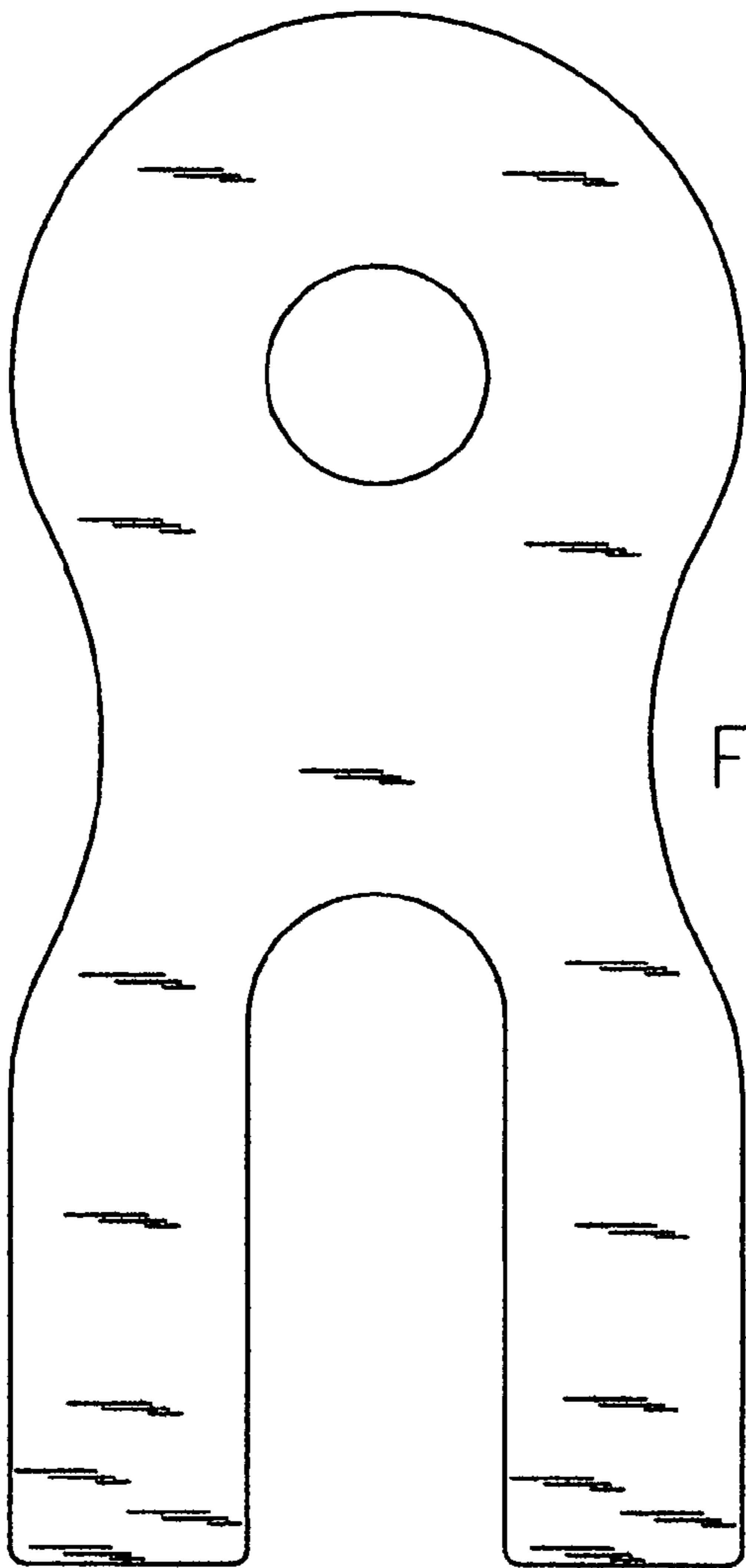

FIG 3

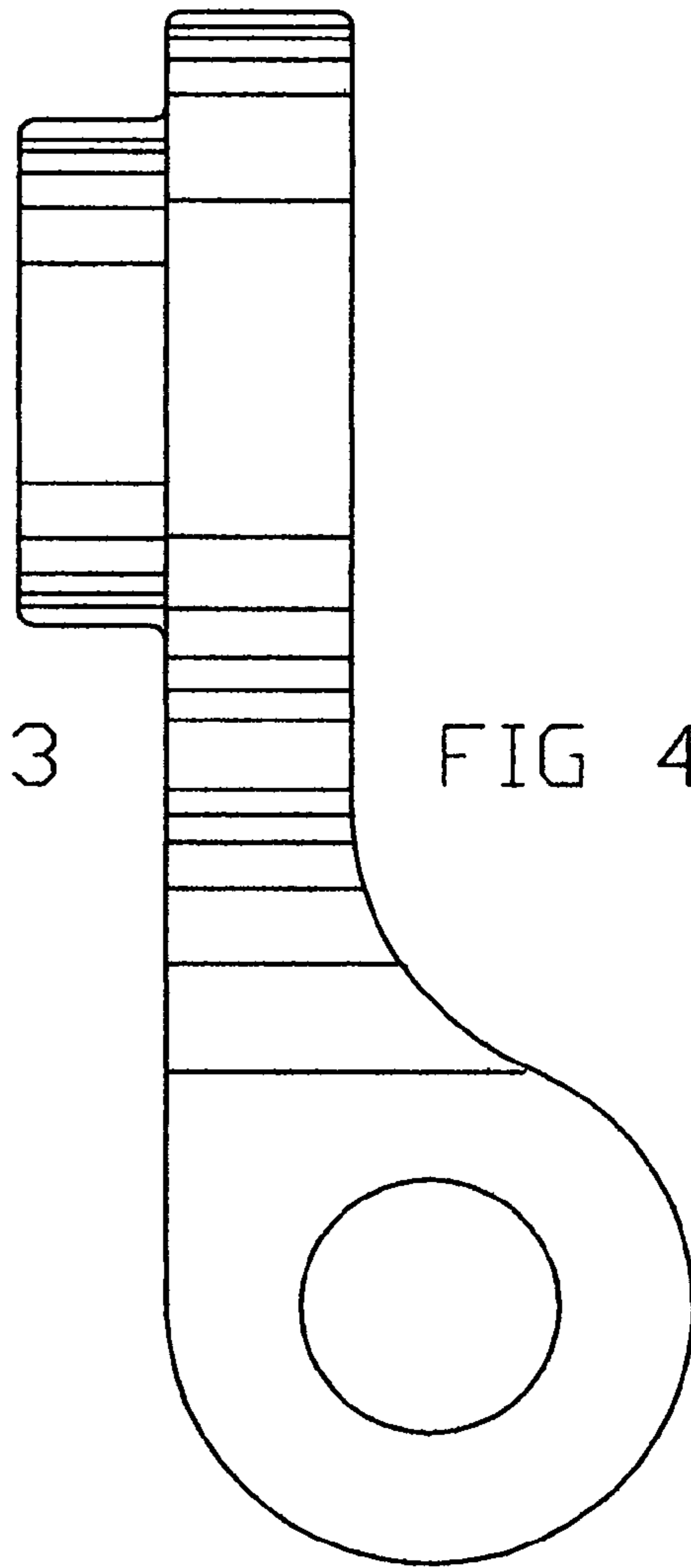

FIG 4

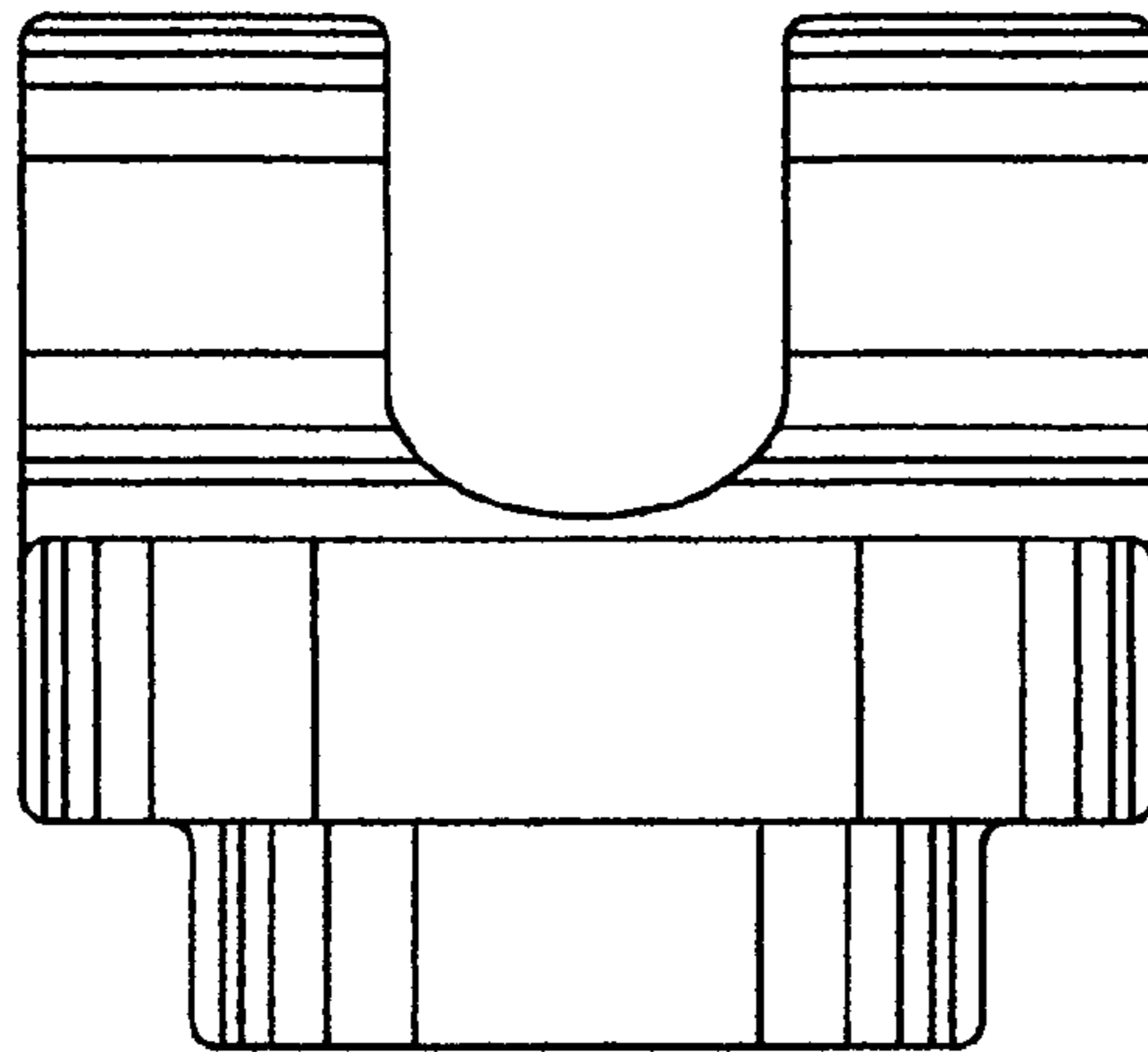

FIG 5

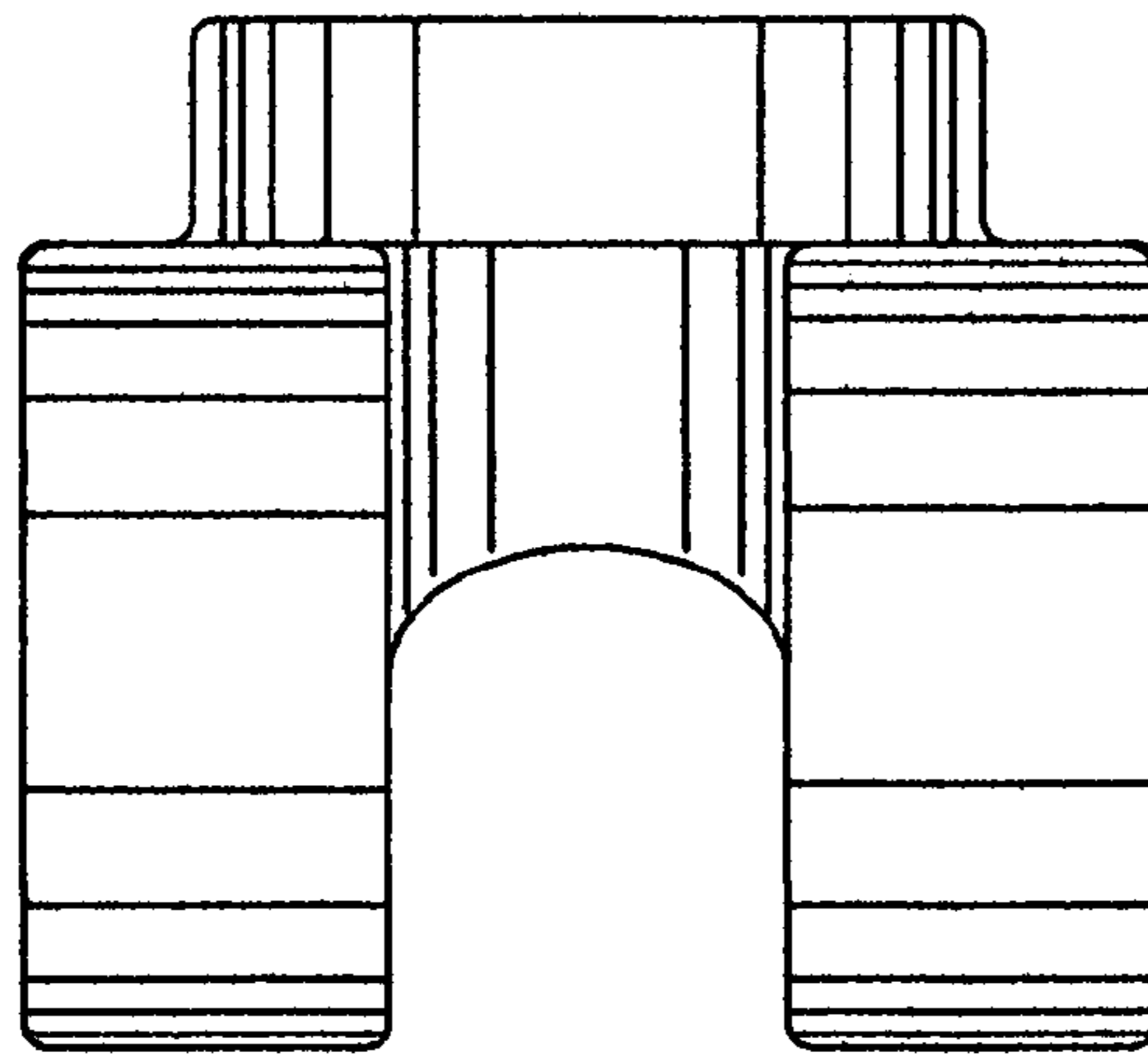

FIG 6