



US00D635382S

(12) **United States Design Patent**
Kim

(10) **Patent No.:** **US D635,382 S**
(45) **Date of Patent:** **** Apr. 5, 2011**

(54) **ACCESSORY POST**
(75) Inventor: **Josephina Ji Yeon Kim**, Cleveland, OH (US)
(73) Assignee: **Moen Incorporated**, North Olmsted, OH (US)
(**) Term: **14 Years**
(21) Appl. No.: **29/362,375**
(22) Filed: **May 25, 2010**
(51) **LOC (9) Cl.** **23-02**
(52) **U.S. Cl.** **D6/524; D6/550**
(58) **Field of Classification Search** D6/518-524, D6/546-550; D8/300, 370, 315; 108/28-29; 211/13.1, 16, 85.5, 86.01, 87.01, 88.04, 100, 211/105.1, 105.2, 106, 113, 123, 181.1, 182-183; 248/49, 175, 176.1, 200, 201, 205.1, 251, 248/302, 309.1, 315; 242/570, 590, 595-598
See application file for complete search history.

D483,585 S 12/2003 Chen
D489,120 S 4/2004 Shieh
D493,054 S 7/2004 Roberts, III et al.
D493,314 S 7/2004 Gilbert
D497,751 S 11/2004 Roberts, III et al.
D501,746 S 2/2005 Gilbert
D504,042 S 4/2005 Wu
D509,568 S 9/2005 Blattner et al.
D520,791 S 5/2006 Solowiej
D521,293 S 5/2006 Solowiej
D540,586 S 4/2007 Solowiej
D540,595 S 4/2007 Solowiej
D554,406 S 11/2007 Sedwick
D562,607 S 2/2008 Chen
D575,565 S * 8/2008 Gilbert D6/524
D577,937 S * 10/2008 Krumpe D6/524
D591,542 S * 5/2009 Chen D6/524
D600,479 S * 9/2009 Gao D6/524
2002/0104946 A1 8/2002 Lai

* cited by examiner

Primary Examiner — Brian N Vinson
(74) *Attorney, Agent, or Firm* — Calfee, Halter & Griswold LLP

(56) **References Cited**

U.S. PATENT DOCUMENTS

D318,717 S 7/1991 Spangler
D391,831 S 3/1998 Doughty et al.
D392,720 S 3/1998 Doughty et al.
D433,108 S 10/2000 Spangler
D436,775 S 1/2001 Ming-Hsiao
D439,955 S 4/2001 Spangler
D442,407 S 5/2001 Solowiej
D449,948 S 11/2001 Lai
D451,324 S 12/2001 Lai
D452,791 S 1/2002 Chen
D454,175 S 3/2002 Spangler
D460,892 S 7/2002 Hoernig
D463,936 S 10/2002 Chen
D464,712 S 10/2002 Lord
D470,701 S 2/2003 Kuo
D472,417 S 4/2003 Hunt
D476,836 S 7/2003 Lai
D477,482 S 7/2003 Green
D477,486 S 7/2003 Green
D478,153 S 8/2003 Friedrich

(57) **CLAIM**
The ornamental design for an accessory post, as shown and described.

DESCRIPTION

FIG. 1 is a perspective view of an accessory post of the new design;
FIG. 2 is a front elevational view of the accessory post of FIG. 1;
FIG. 3 is a left side elevational view of the accessory post of FIG. 1;
FIG. 4 is a right side elevational view of the accessory post of FIG. 1; and,
FIG. 5 is a top plan view of the accessory post of FIG. 1, the bottom plan view being a mirror image thereof.
The broken-line disclosure in the views is understood to represent portions of the article in which the claimed design is embodied, but which forms no part of the claimed design.

1 Claim, 3 Drawing Sheets

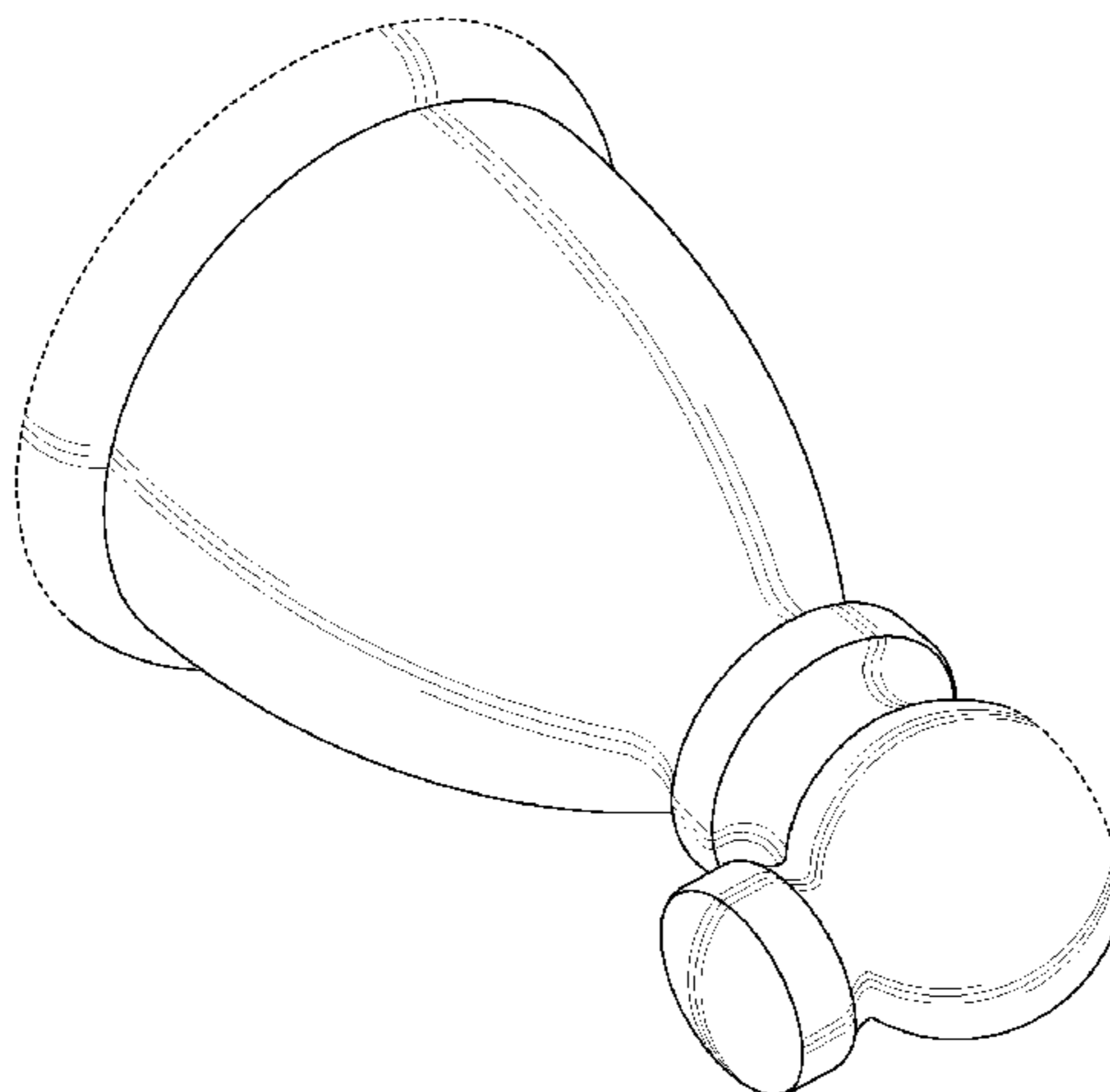

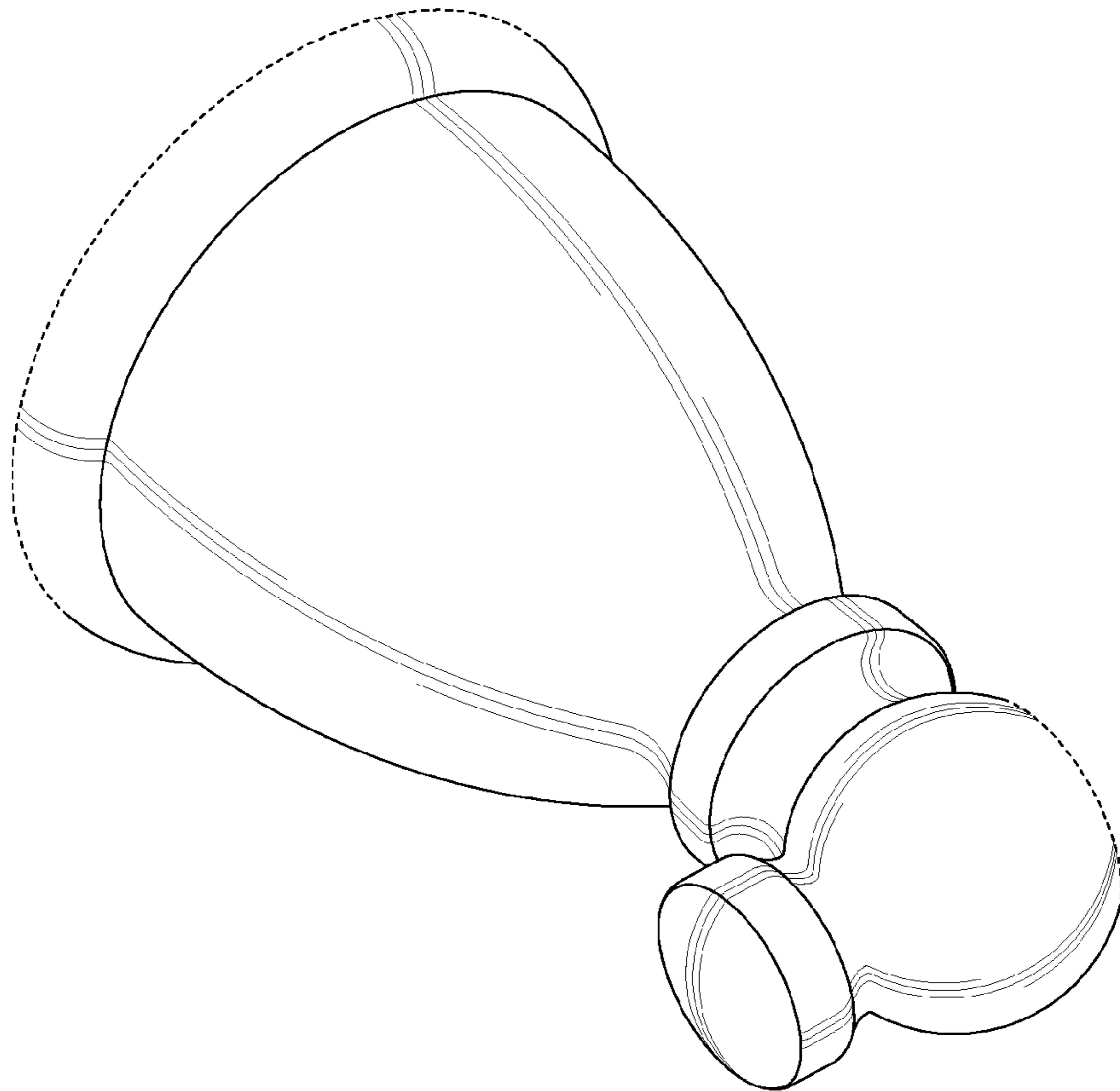

FIG. 1

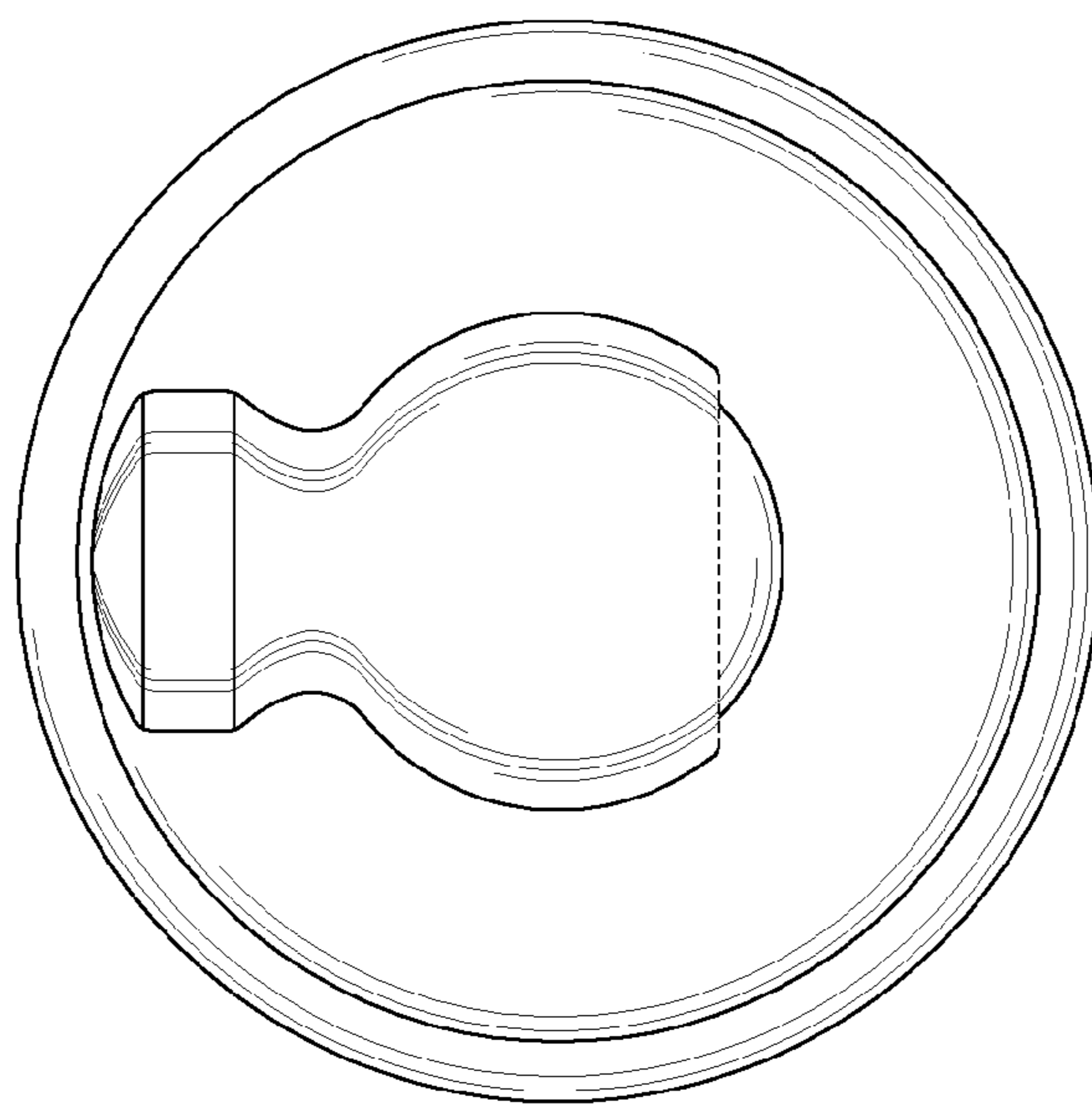

FIG. 2

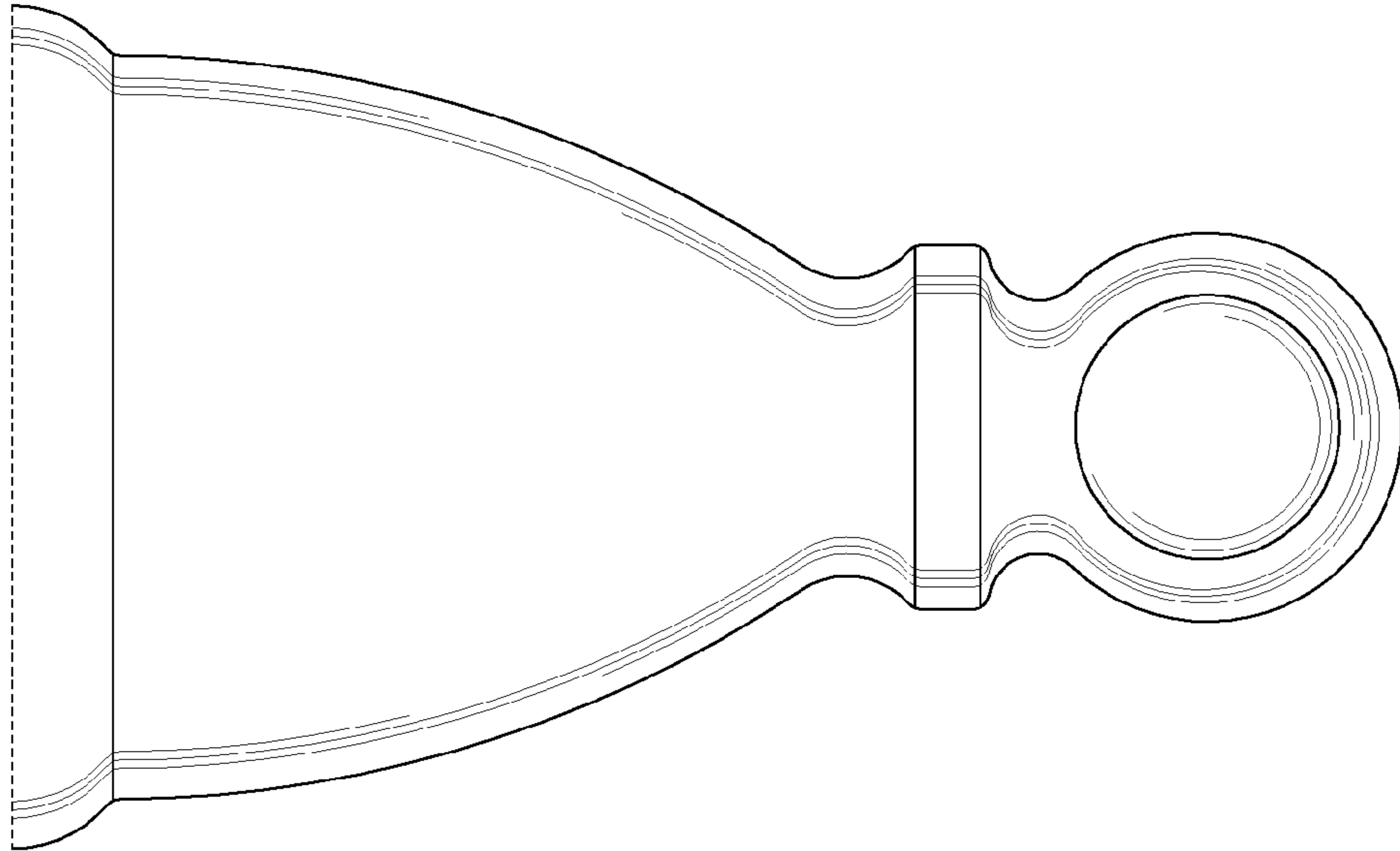

FIG. 3

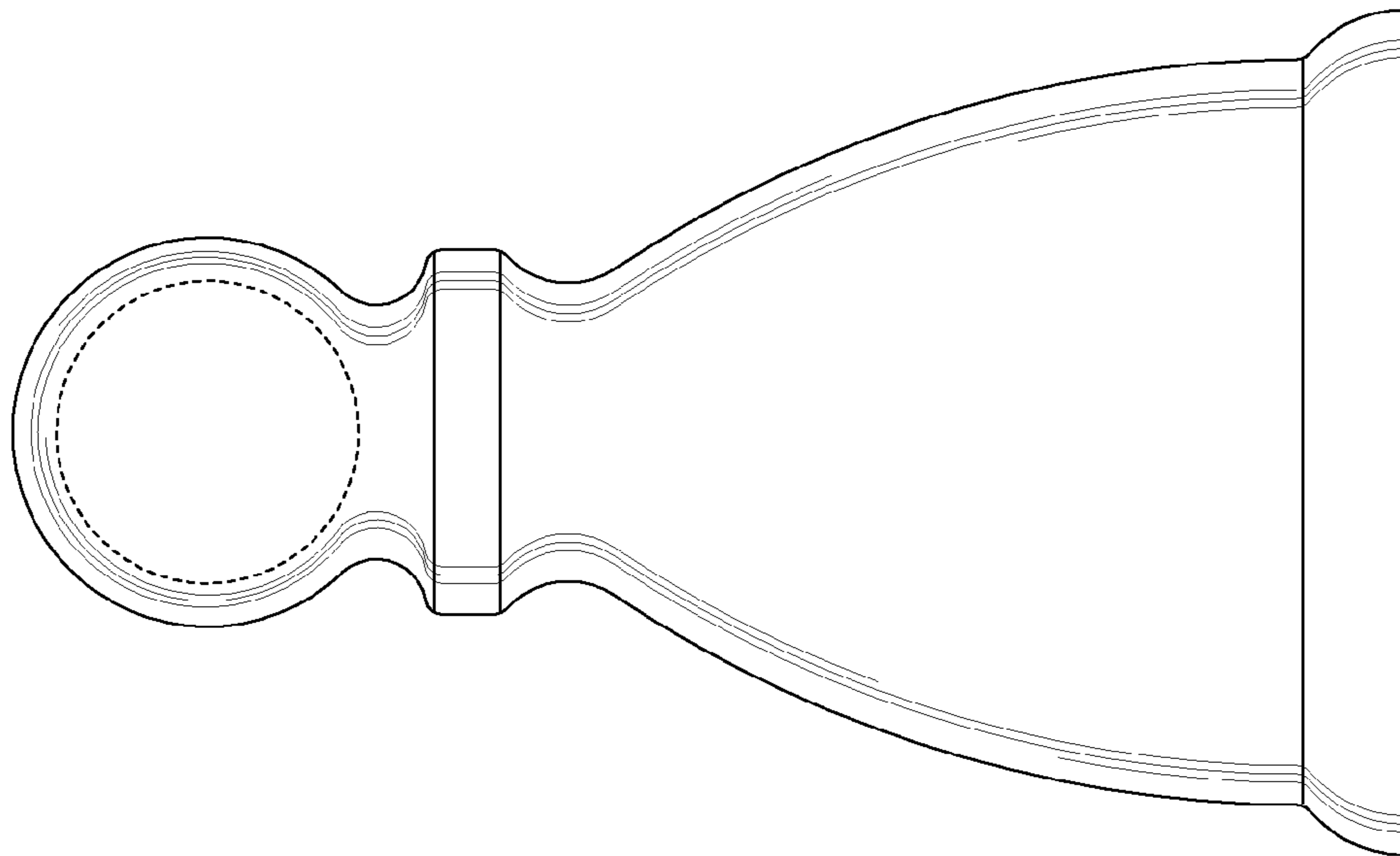

FIG. 4

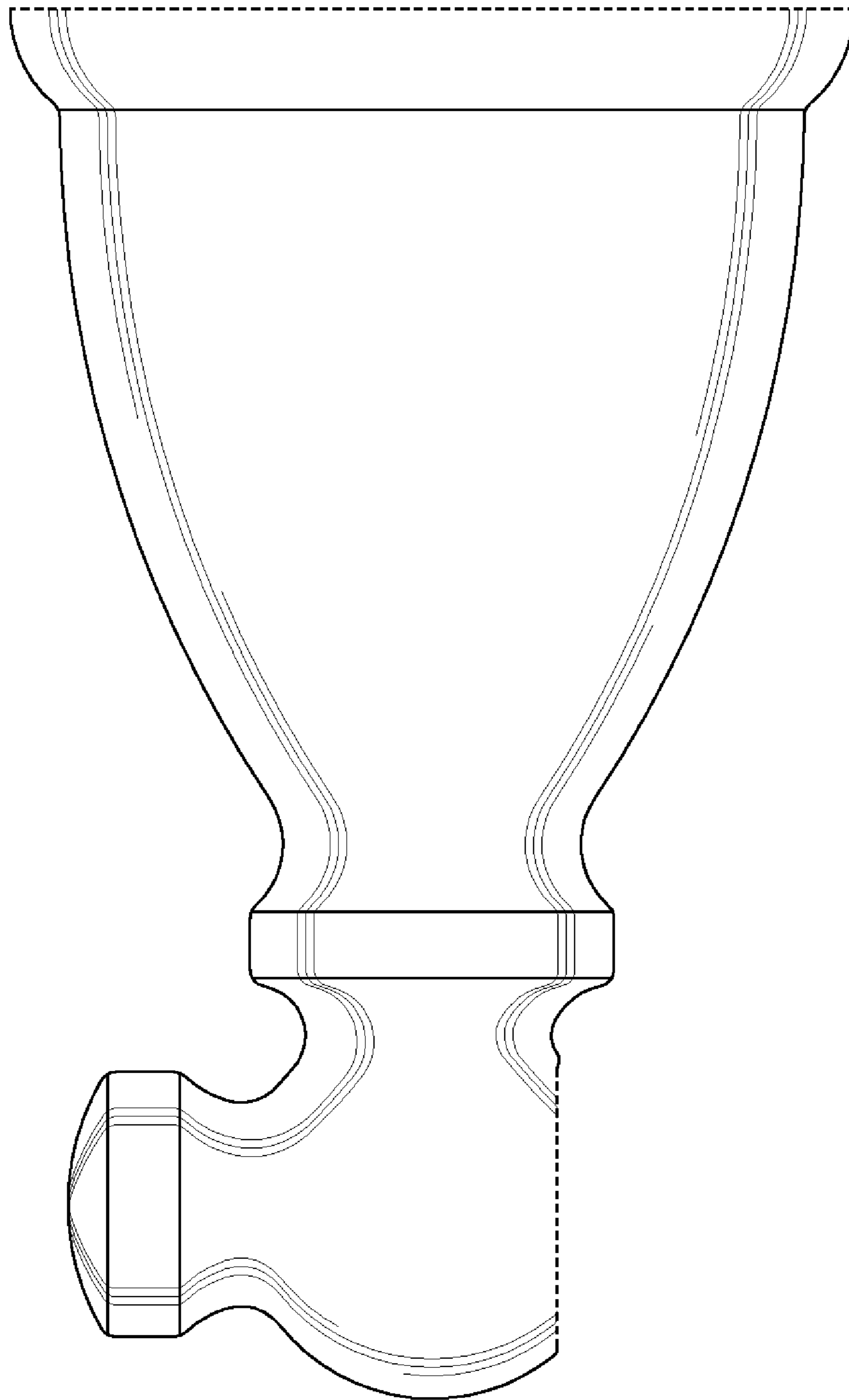

FIG. 5