



US00D635153S

(12) **United States Design Patent**  
**Gerbaud et al.**

(10) **Patent No.:** **US D635,153 S**  
(45) **Date of Patent:** **\*\* Mar. 29, 2011**

(54) **MOTOR HOE**

(75) Inventors: **Nicolas Gerbaud**, Monsireigne (FR);  
**Peter Vion**, Pouzauges (FR)

(73) Assignee: **Pubert Henri SAS**, Chantonnay (FR)

(\*\*) Term: **14 Years**

(21) Appl. No.: **29/368,556**

(22) Filed: **Aug. 25, 2010**

(30) **Foreign Application Priority Data**

Mar. 3, 2010 (EM) ..... 001677295

(51) **LOC (9) Cl.** ..... **15-03**

(52) **U.S. Cl.** ..... **D15/12**

(58) **Field of Classification Search** ..... D15/10-12;  
172/41-44, 74, 260, 256, 250, 48, 72, 351,  
172/365, 329, 57, 518; 180/53.1; 56/16.7  
See application file for complete search history.

(56) **References Cited**

**U.S. PATENT DOCUMENTS**

|           |   |   |         |                |       |        |
|-----------|---|---|---------|----------------|-------|--------|
| D231,005  | S | * | 3/1974  | Noma et al.    | ..... | D15/12 |
| D249,518  | S | * | 9/1978  | Cognata et al. | ..... | D15/12 |
| 4,640,366 | A | * | 2/1987  | Saito          | ..... | 172/42 |
| 5,573,069 | A | * | 11/1996 | Shipley        | ..... | 172/42 |
| D415,502  | S | * | 10/1999 | Yoshida        | ..... | D15/12 |
| D416,026  | S | * | 11/1999 | Ohsumi et al.  | ..... | D15/12 |
| D417,458  | S | * | 12/1999 | Waibel         | ..... | D15/14 |

|              |    |   |         |                 |       |        |
|--------------|----|---|---------|-----------------|-------|--------|
| D449,052     | S  | * | 10/2001 | Ito et al.      | ..... | D15/12 |
| D475,067     | S  | * | 5/2003  | Ito et al.      | ..... | D15/12 |
| D486,502     | S  | * | 2/2004  | Yuzuriha et al. | ..... | D15/12 |
| 6,766,866    | B2 | * | 7/2004  | Miyahara et al. | ..... | 172/41 |
| 6,904,977    | B2 | * | 6/2005  | Zerrer et al.   | ..... | 172/42 |
| D515,592     | S  | * | 2/2006  | Thackery        | ..... | D15/11 |
| D523,026     | S  | * | 6/2006  | Vaughn          | ..... | D15/12 |
| D540,827     | S  | * | 4/2007  | Notaras et al.  | ..... | D15/12 |
| D567,822     | S  | * | 4/2008  | Martz           | ..... | D15/12 |
| D613,772     | S  | * | 4/2010  | Azuma           | ..... | D15/12 |
| 2003/0159838 | A1 | * | 8/2003  | Miyahara et al. | ..... | 172/42 |
| 2004/0079538 | A1 | * | 4/2004  | Zerrer et al.   | ..... | 172/42 |

\* cited by examiner

*Primary Examiner* — Mark A Goodwin

(74) *Attorney, Agent, or Firm* — Workman Nydegger

(57) **CLAIM**

The ornamental design for a motor hoe, as shown and described.

**DESCRIPTION**

FIG. 1 is a perspective view of a motor hoe showing our new design;

FIG. 2 is a front elevational view thereof;

FIG. 3 is a rear elevational view thereof;

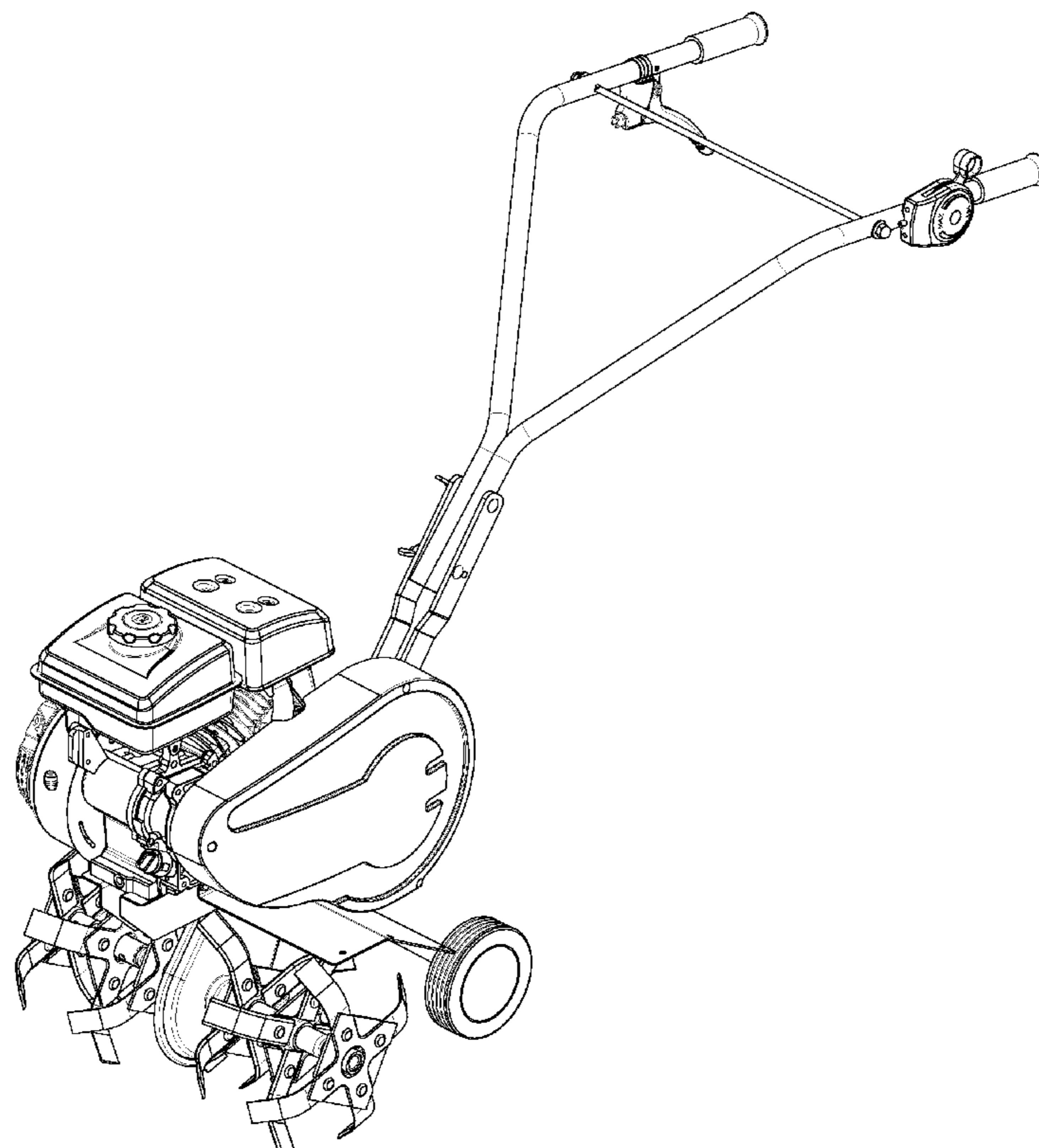
FIG. 4 is a right side elevational view thereof;

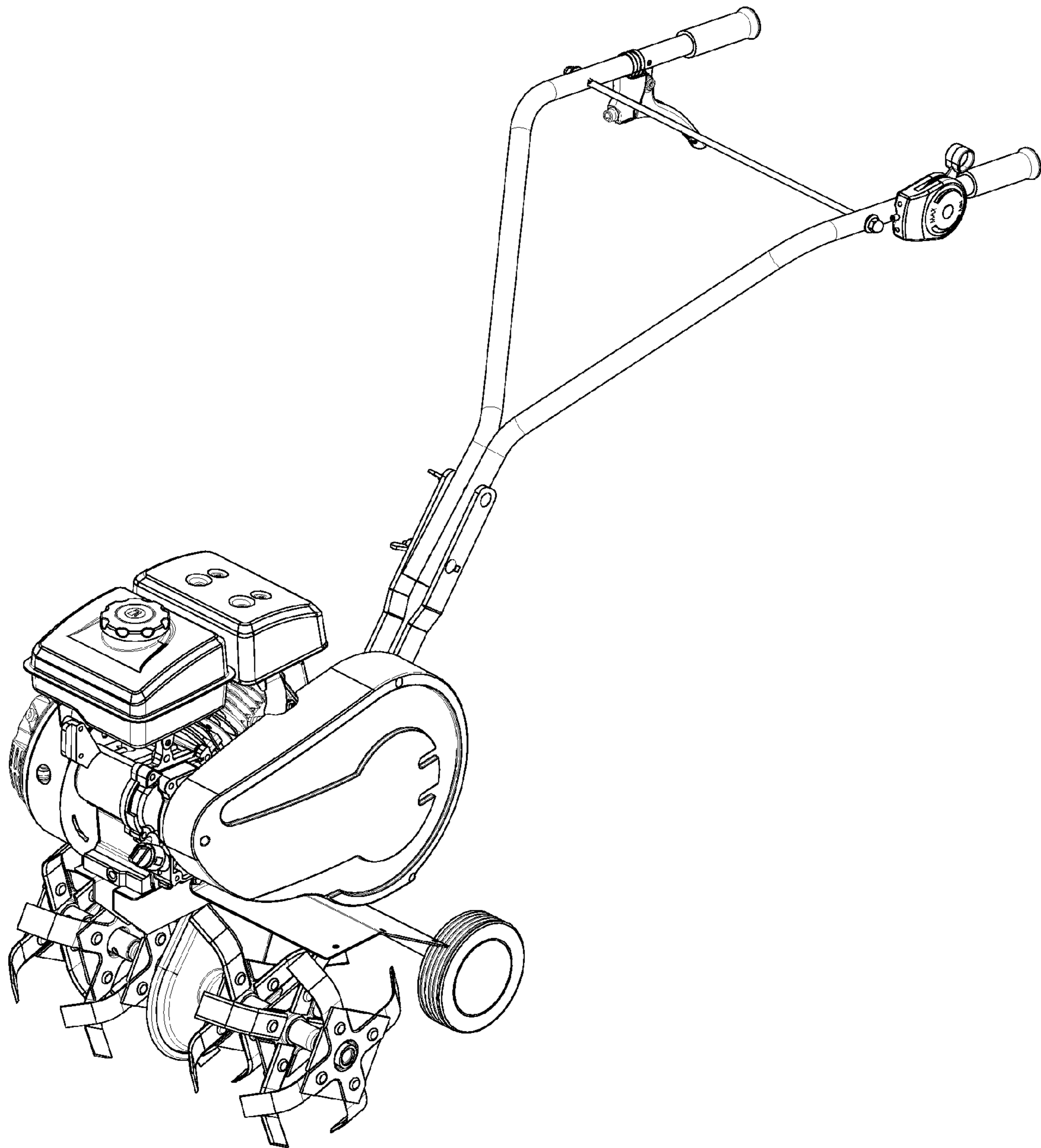
FIG. 5 is a left side elevational view thereof;

FIG. 6 is a top plan view thereof; and,

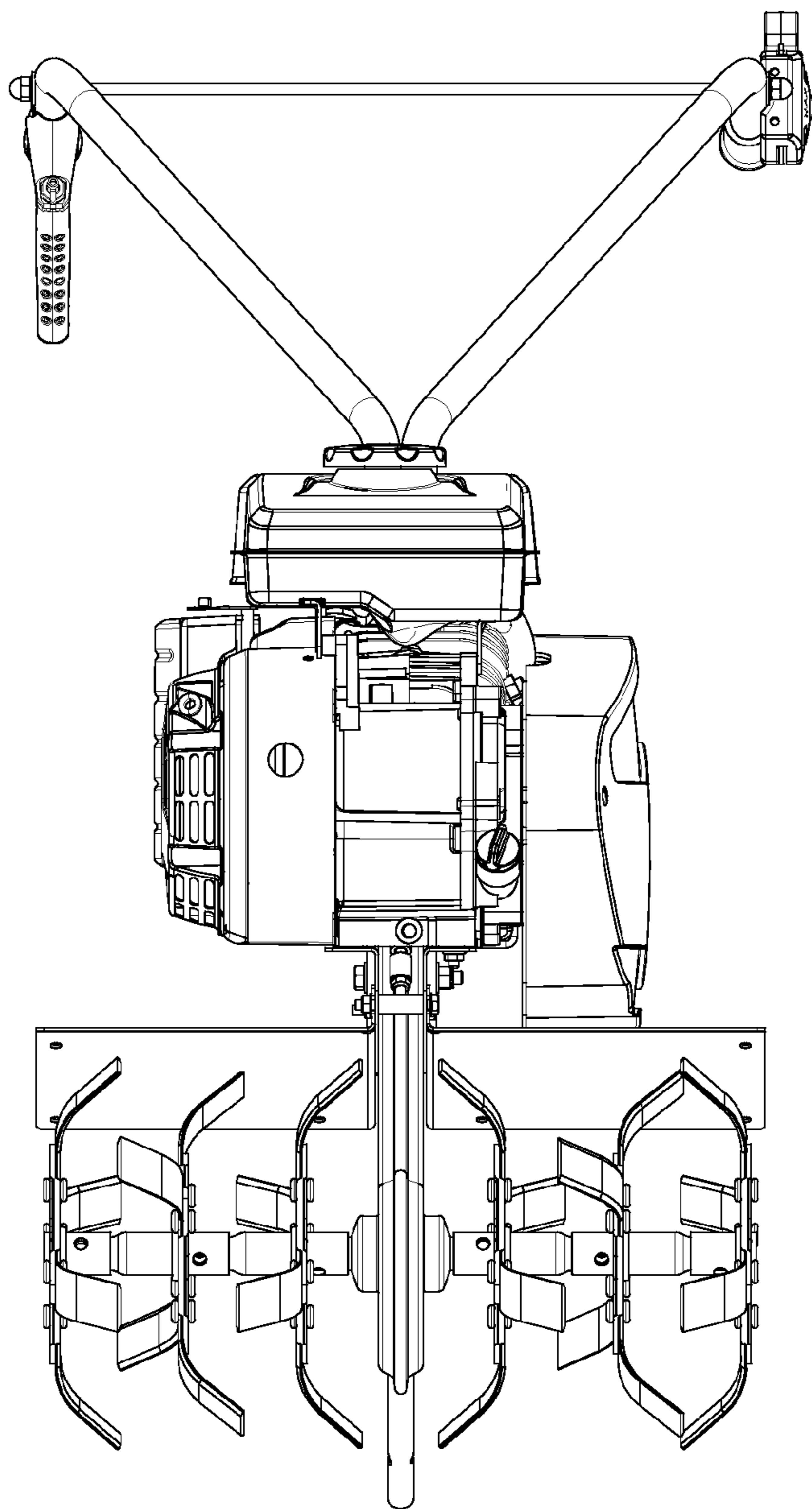
FIG. 7 is a bottom plan view thereof.

**1 Claim, 7 Drawing Sheets**

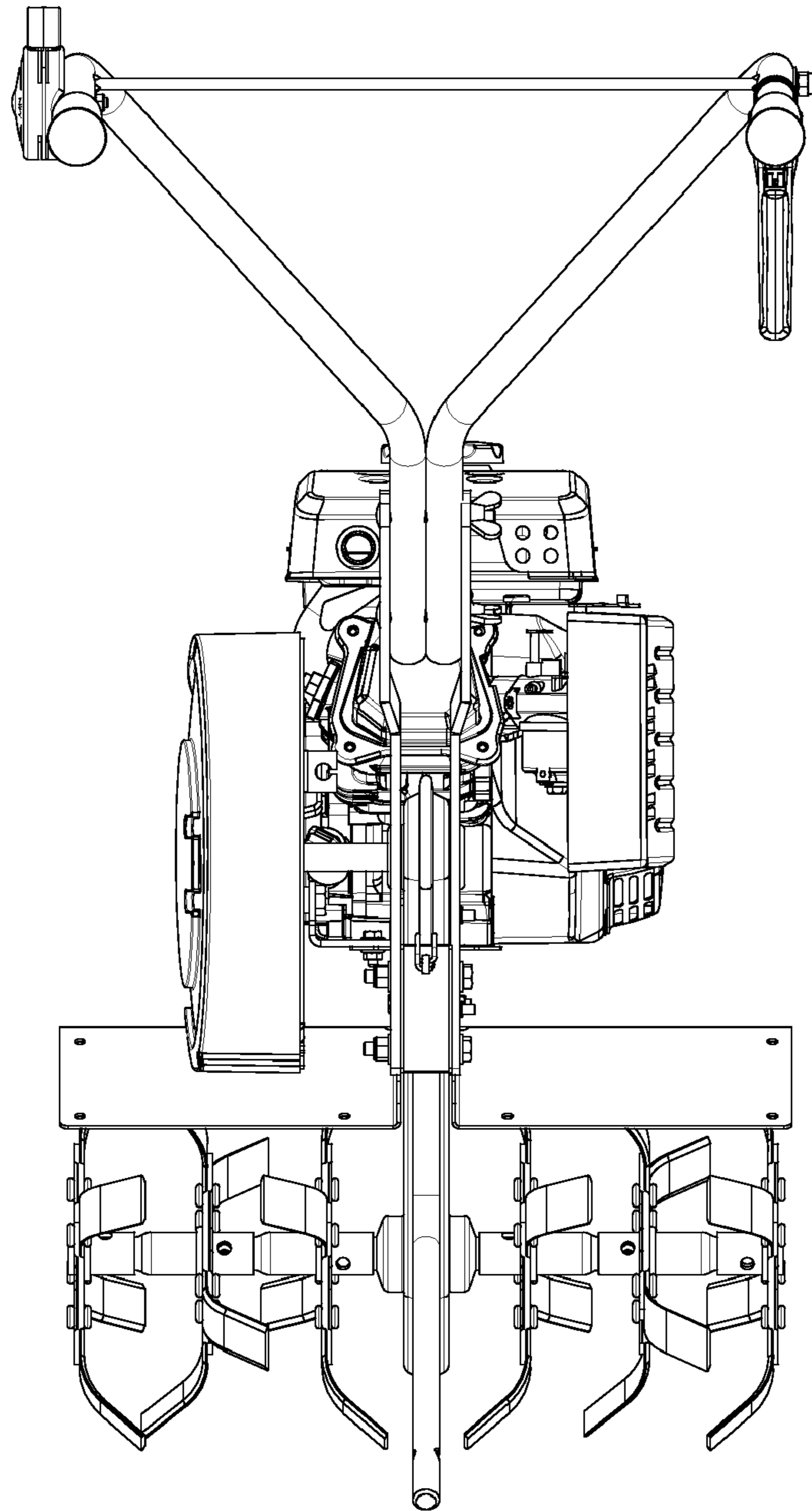




**Fig. 1**



**Fig. 2**



**Fig. 3**



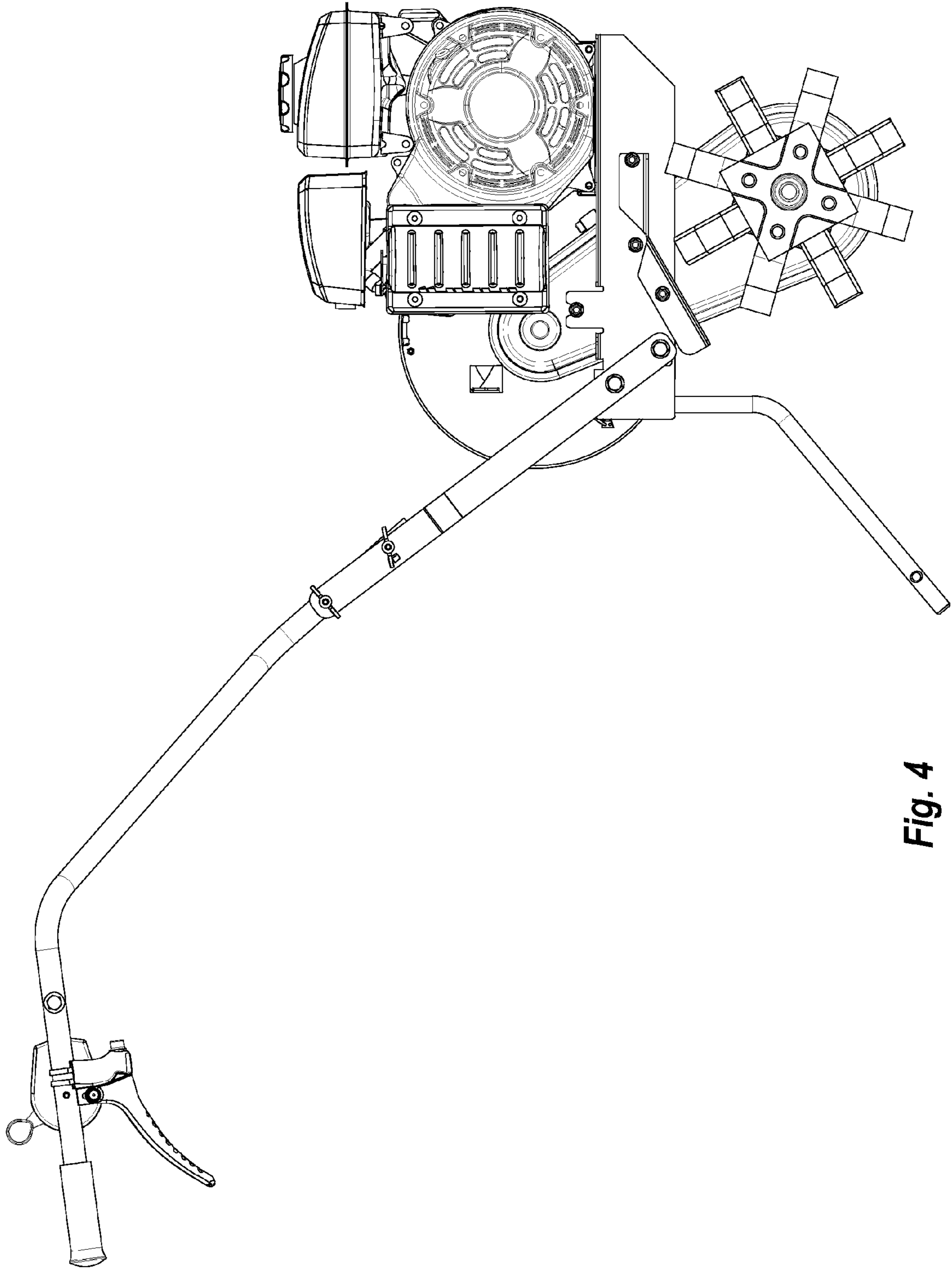


Fig. 4

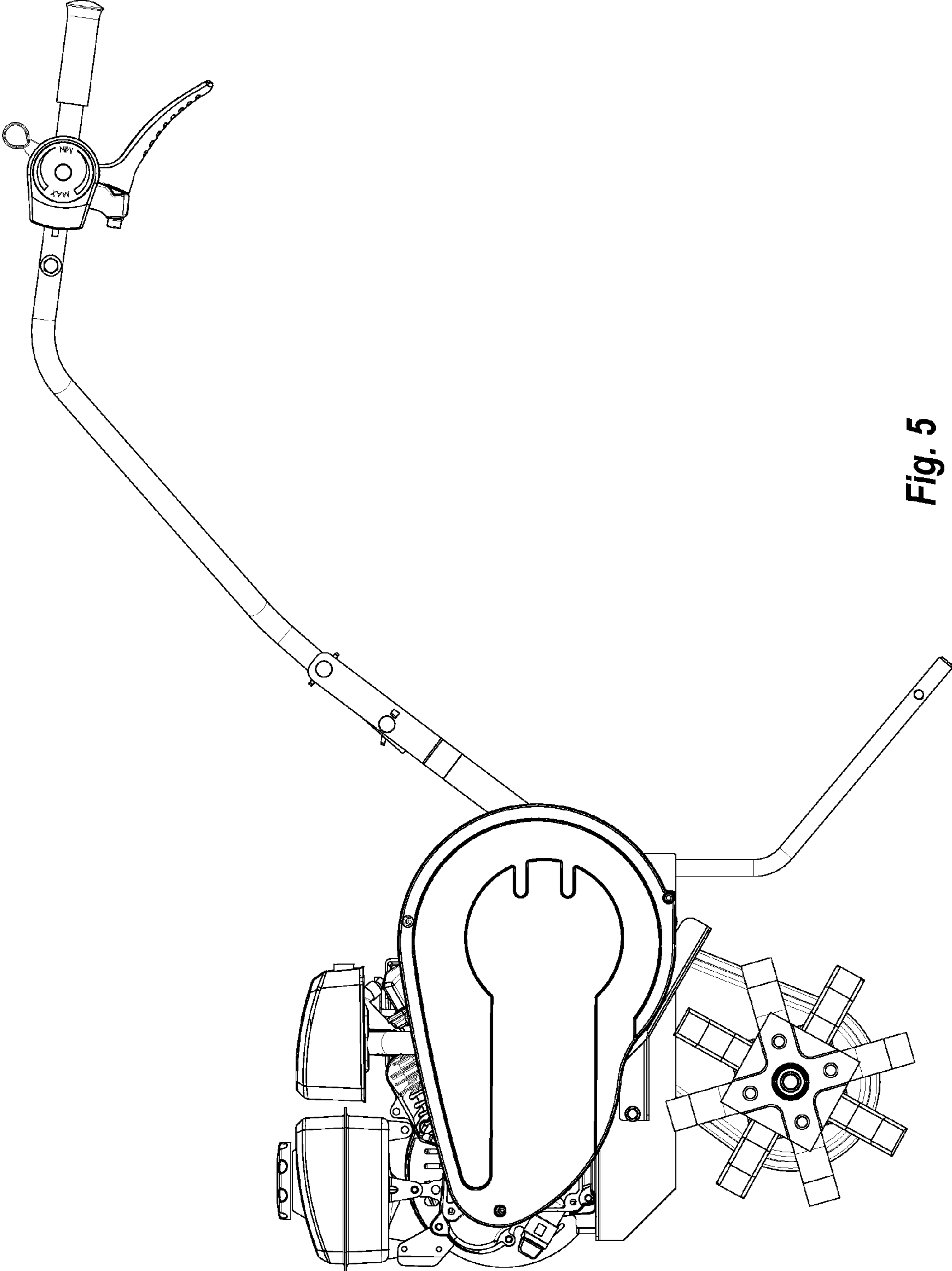
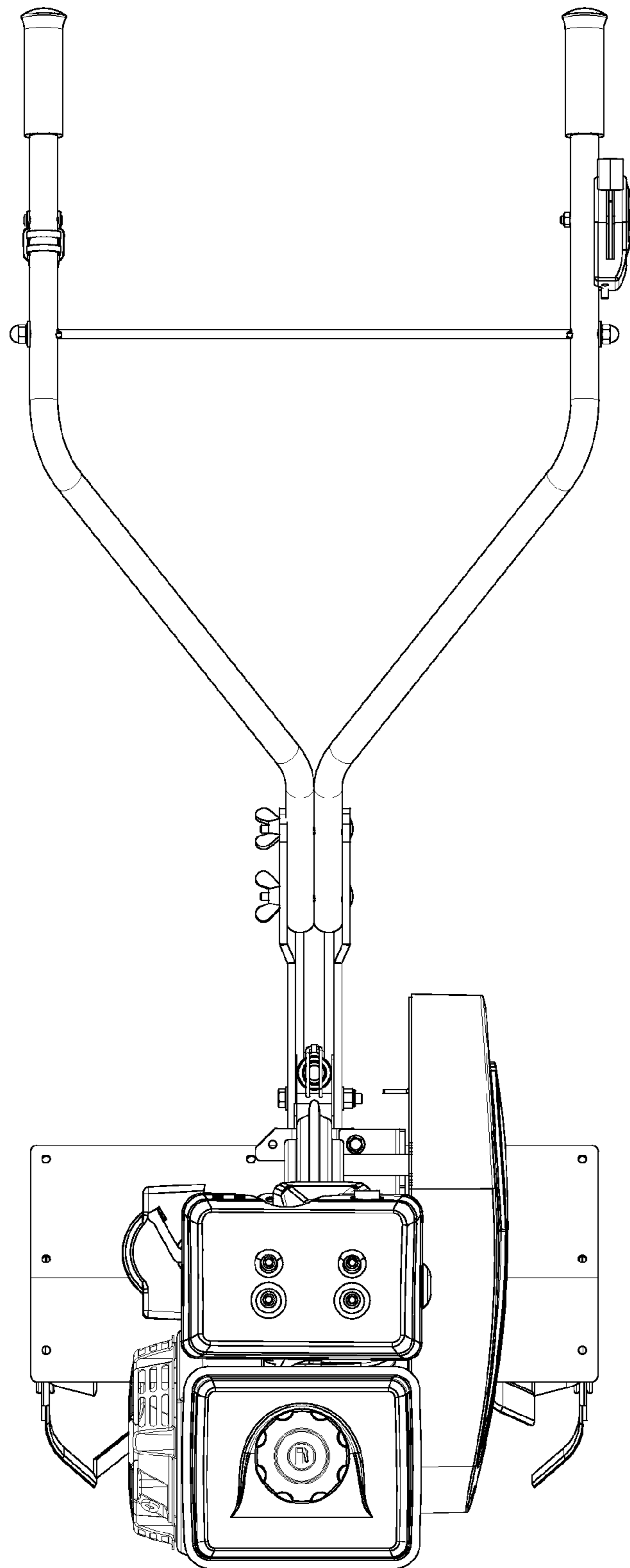
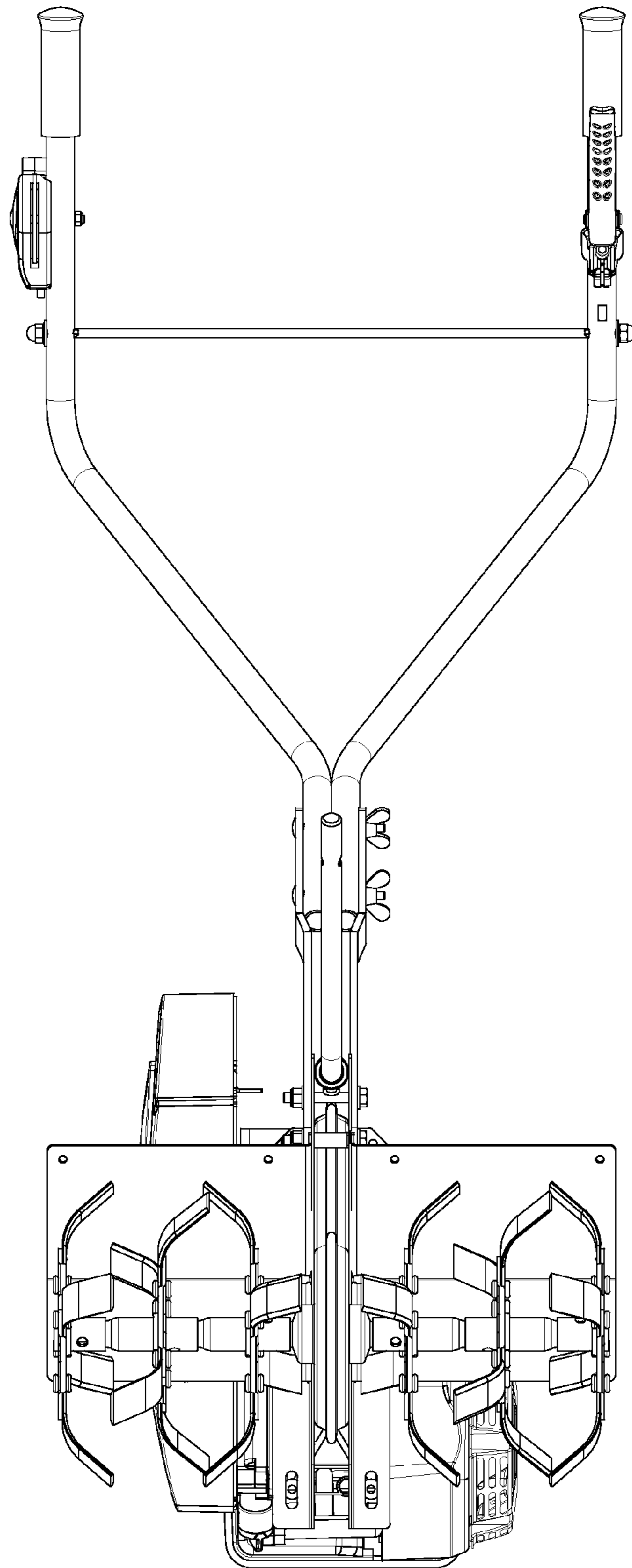


Fig. 5



*Fig. 6*



**Fig. 7**