



US00D635057S

(12) **United States Design Patent**  
**Pontaoe**

(10) **Patent No.:** **US D635,057 S**  
(45) **Date of Patent:** **\*\* Mar. 29, 2011**

- (54) **BUCKLE**
- (75) Inventor: **John S. Pontaoe**, Chicago, IL (US)
- (73) Assignee: **Illinois Tool Works, Inc.**, Glenview, IL (US)
- (\*\*) Term: **14 Years**
- (21) Appl. No.: **29/365,949**
- (22) Filed: **Jul. 16, 2010**
- (51) **LOC (9) Cl.** ..... **02-07**
- (52) **U.S. Cl.** ..... **D11/216**
- (58) **Field of Classification Search** ..... D11/1-2,  
D11/200-201, 206-210, 214-218; 24/163 R,  
24/169-171, 173, 177-179, 191, 194-195,  
24/197, 200, 614-616, 625  
See application file for complete search history.

(56) **References Cited**

**U.S. PATENT DOCUMENTS**

D524,693 S *	7/2006	Uehara et al.	.....	D11/216
D543,897 S *	6/2007	Anscher	.....	D11/218
7,320,160 B2	1/2008	Uehara et al.		
D566,003 S *	4/2008	Anscher	.....	D11/216
D576,074 S *	9/2008	Yoshiguchi	.....	D11/216
D597,441 S *	8/2009	Uehara	.....	D11/216
D619,042 S *	7/2010	Uehara	.....	D11/216
D619,496 S *	7/2010	Paik	.....	D11/216

D625,226 S *	10/2010	Pontaoe	.....	D11/216
2007/0089280 A1	4/2007	Pontaoe		
2008/0134479 A1	6/2008	Kolasa et al.		
2009/0007391 A1	1/2009	Uehara		
2009/0056089 A1	3/2009	Yoshie		

**OTHER PUBLICATIONS**

YKK Corporation Ultra-Lightweight Series Advertisement.  
Duraflex Global Trims & Fastener Advertisement.  
Sample Buckle Pictures.

\* cited by examiner

*Primary Examiner* — Ralf Seifert

(74) *Attorney, Agent, or Firm* — Mark W. Croll; Paul F. Donovan

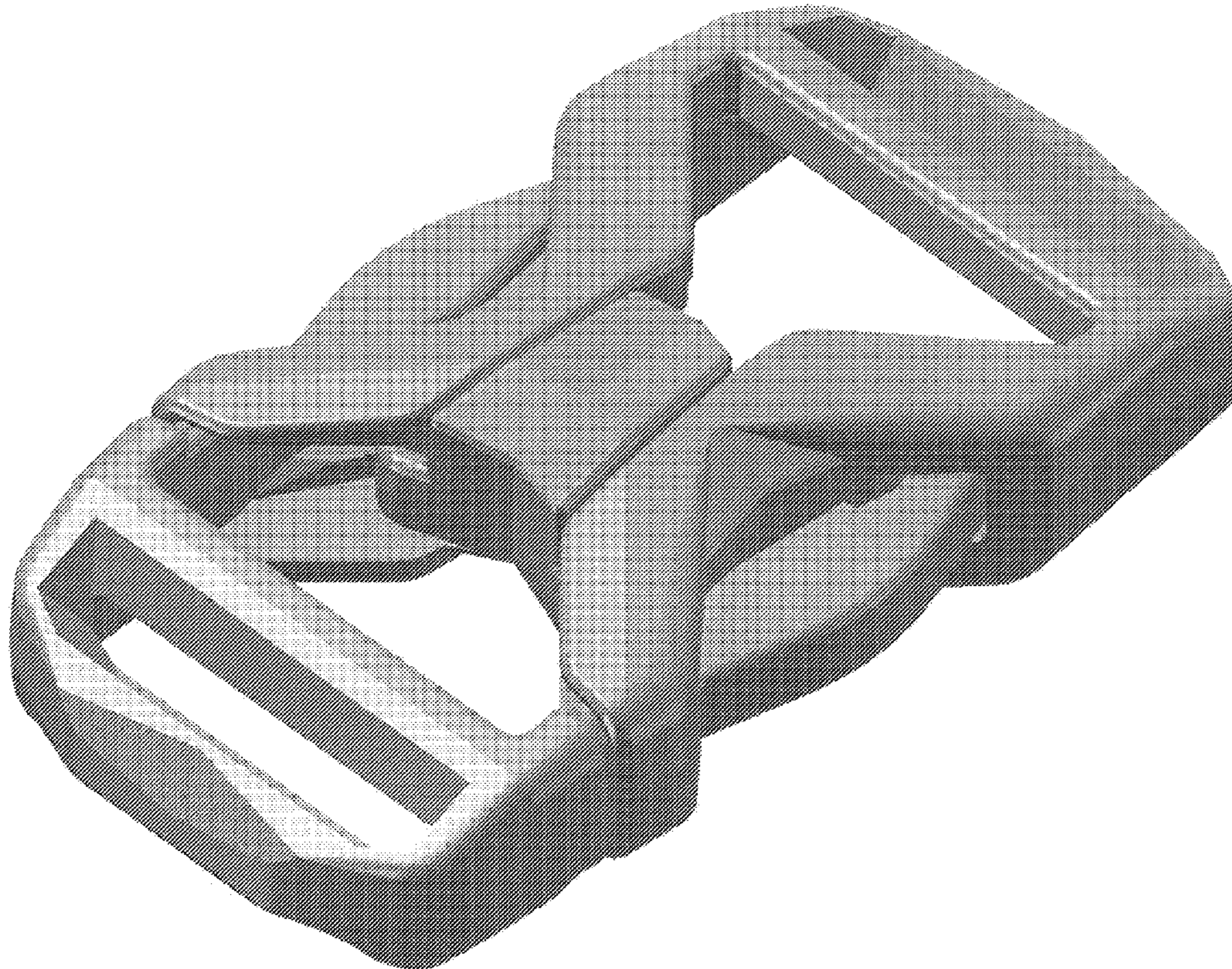
(57) **CLAIM**

The ornamental design for a buckle, as shown and described.

**DESCRIPTION**

FIG. 1 is a perspective view of the buckle showing the new design;  
FIG. 2 is an exploded perspective view thereof;  
FIG. 3 is a top view thereof;  
FIG. 4 is a bottom view thereof;  
FIG. 5 is a front view thereof;  
FIG. 6 is a back view thereof;  
FIG. 7 is a side view thereof; and,  
FIG. 8 is the other side view thereof.

**1 Claim, 8 Drawing Sheets**



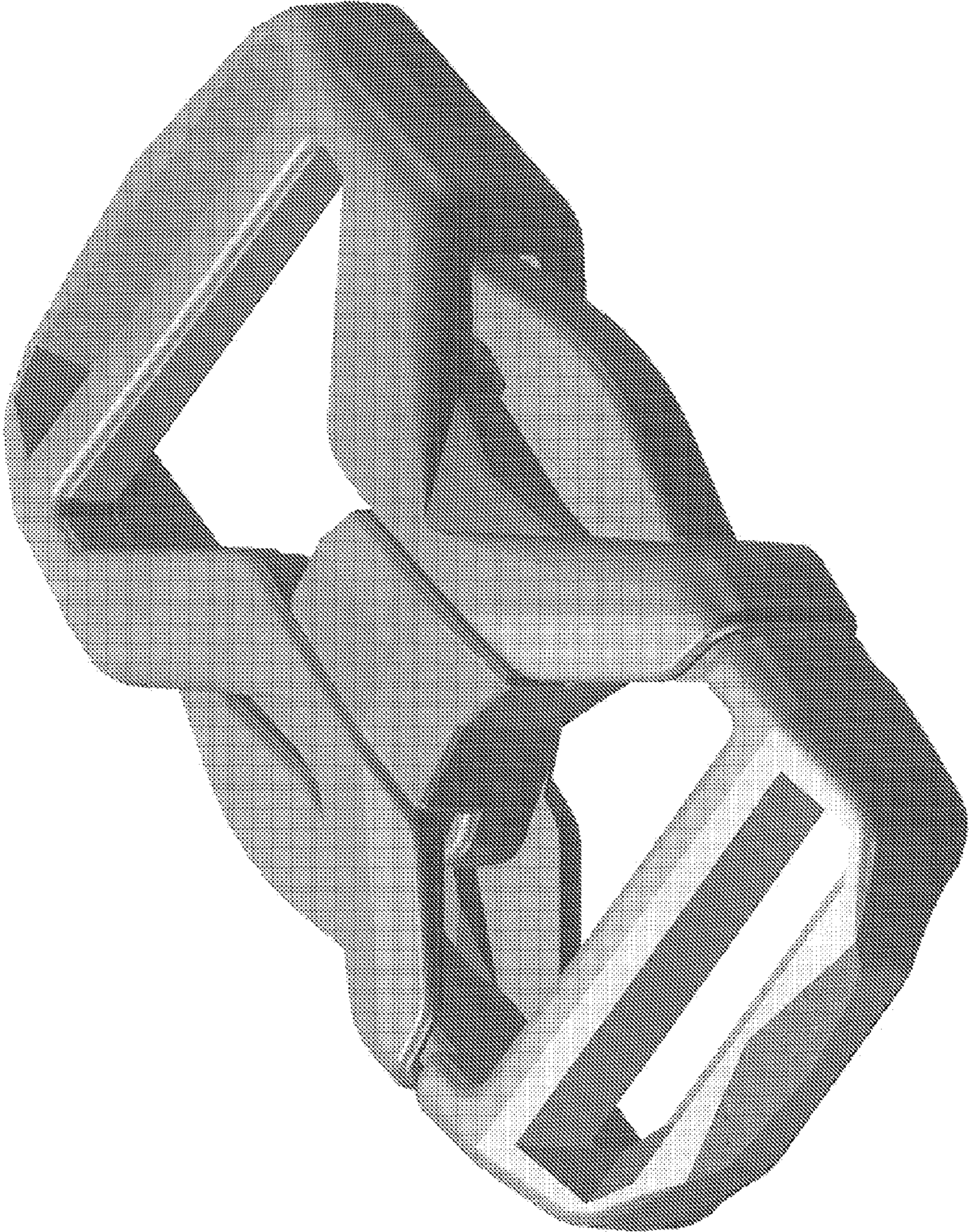


FIG. 1

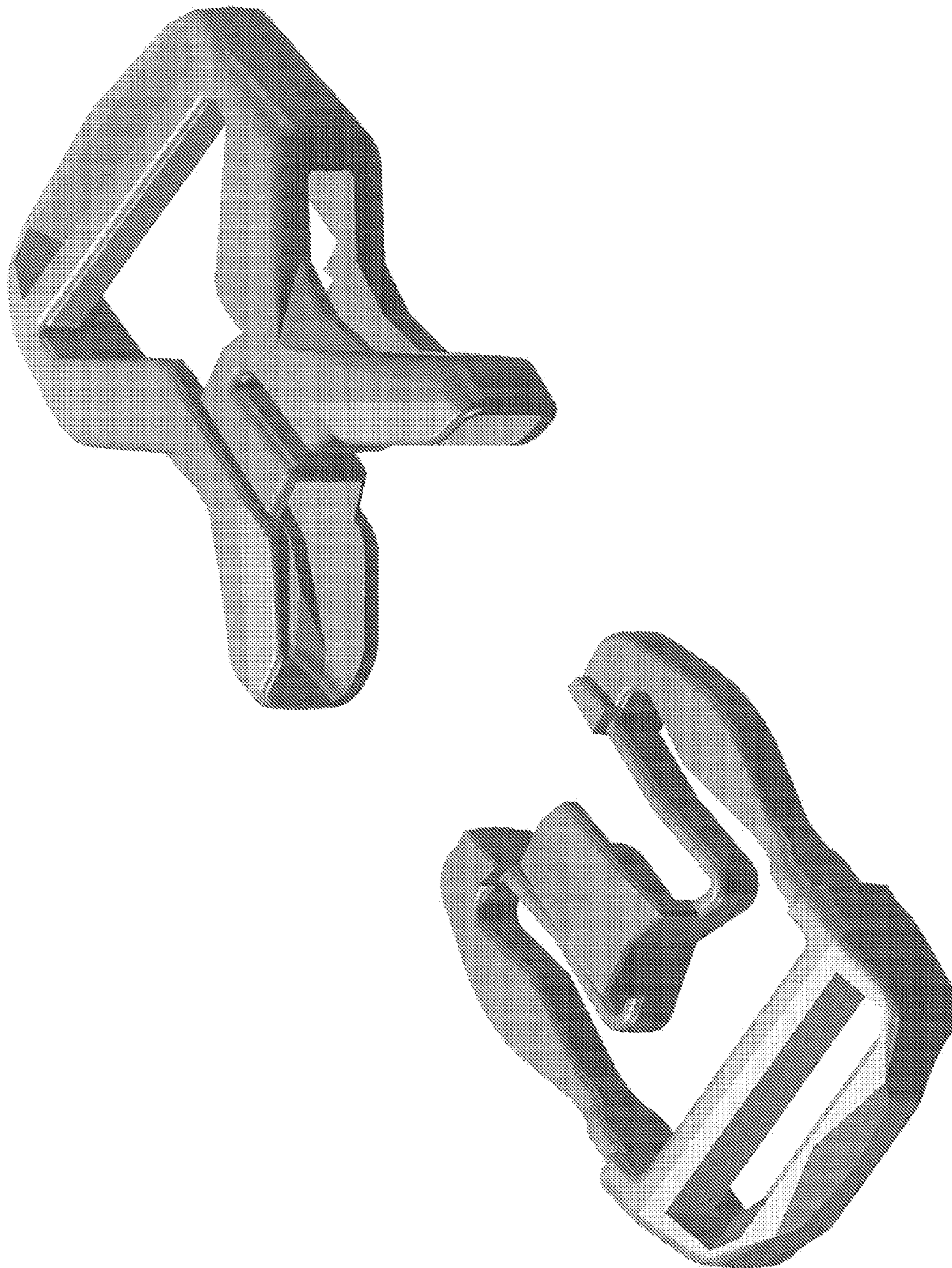


FIG. 2

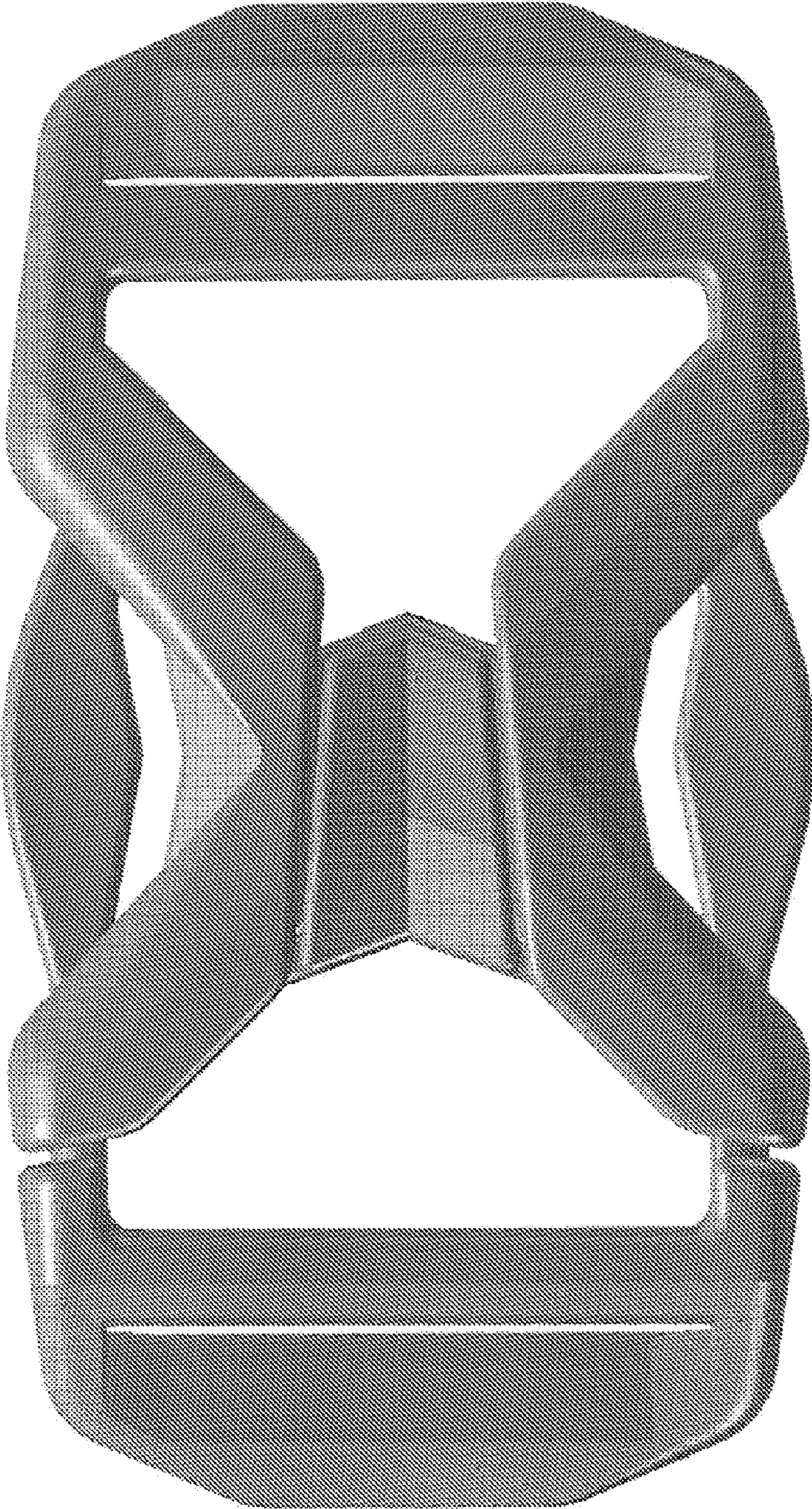
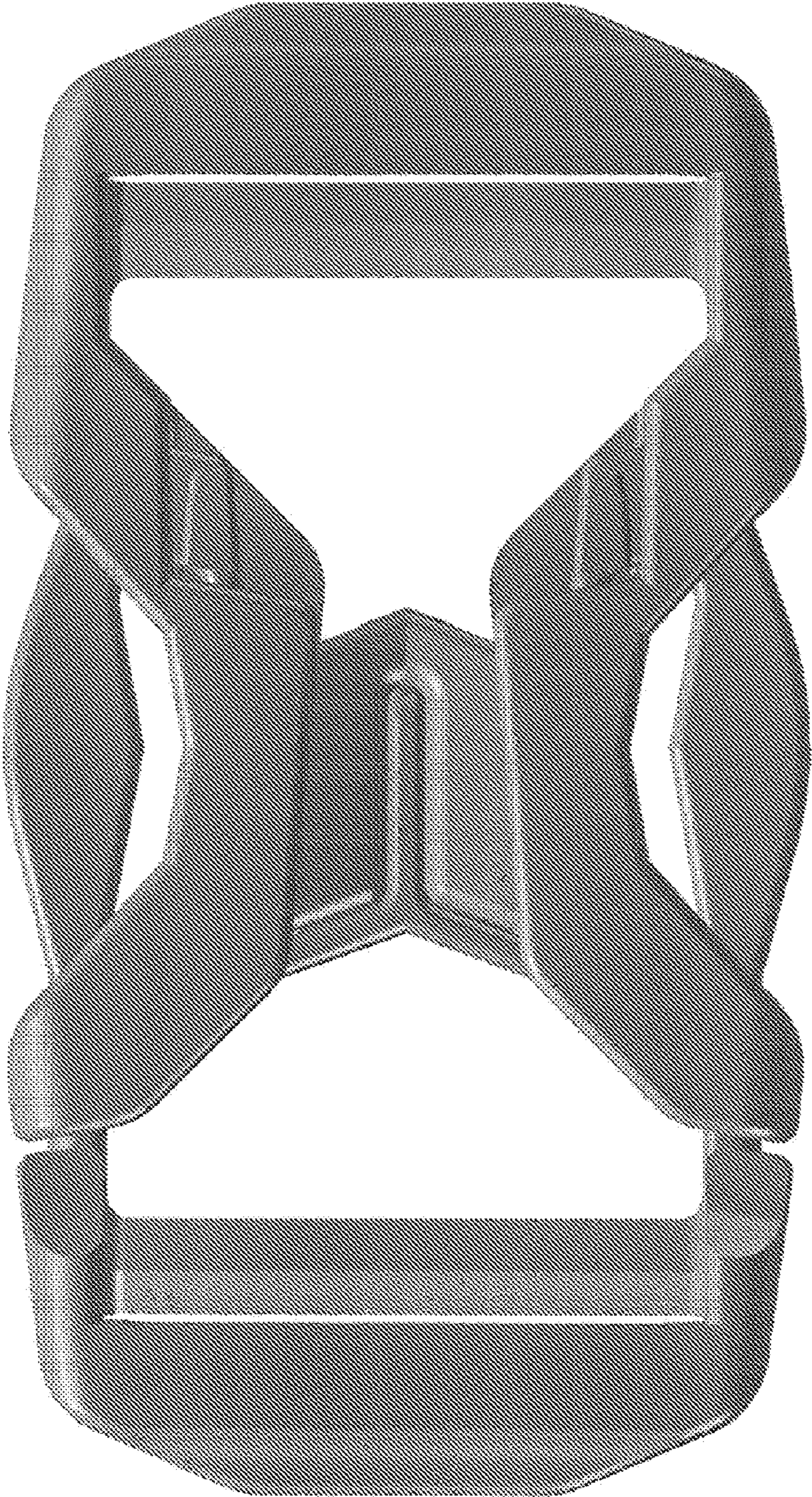
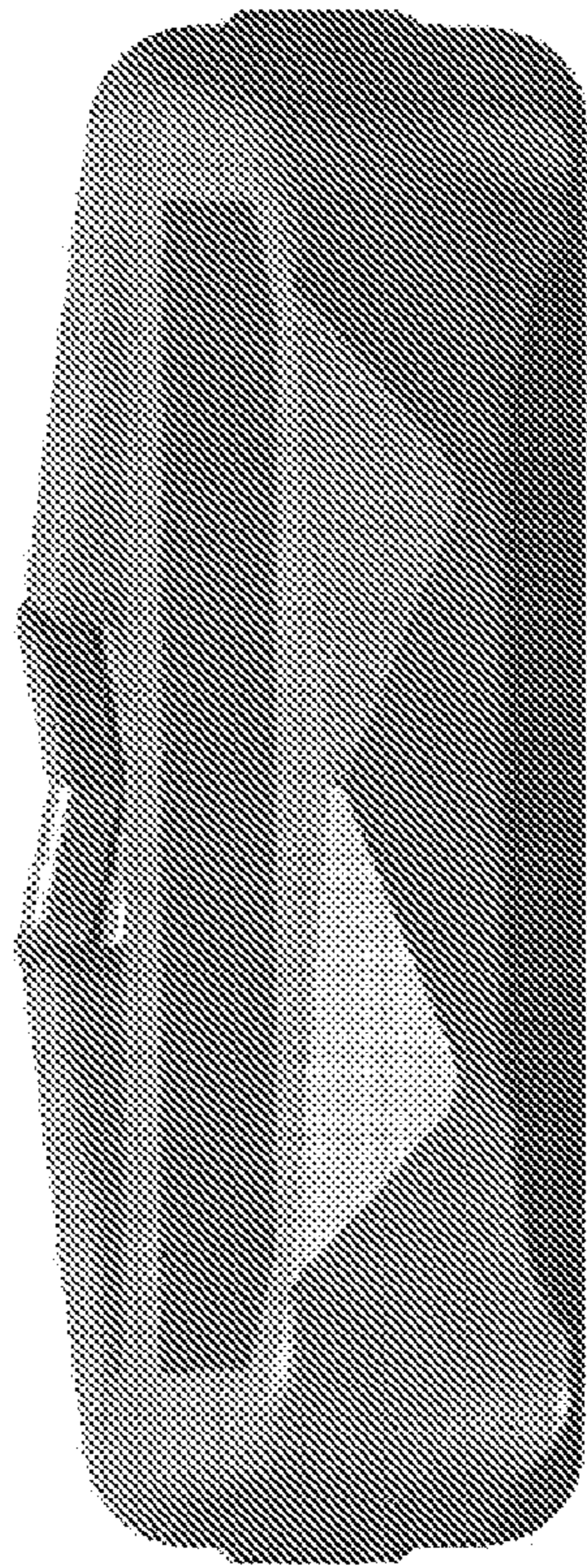


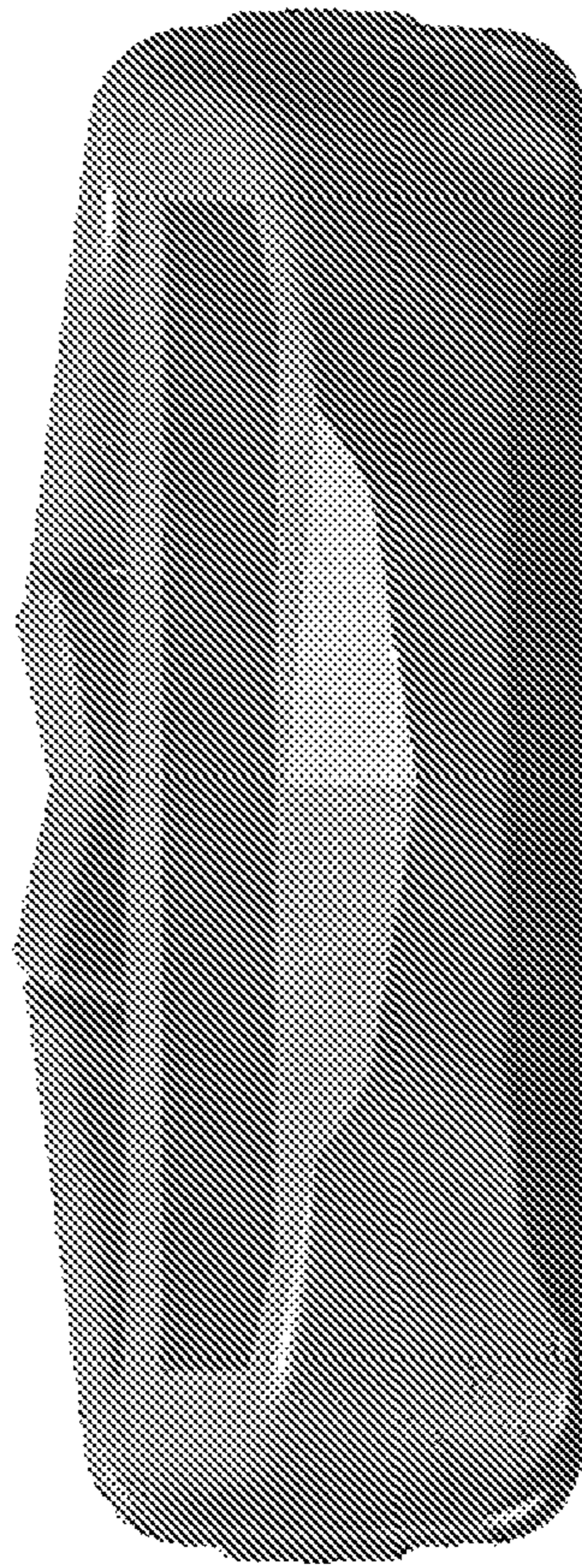
FIG. 3



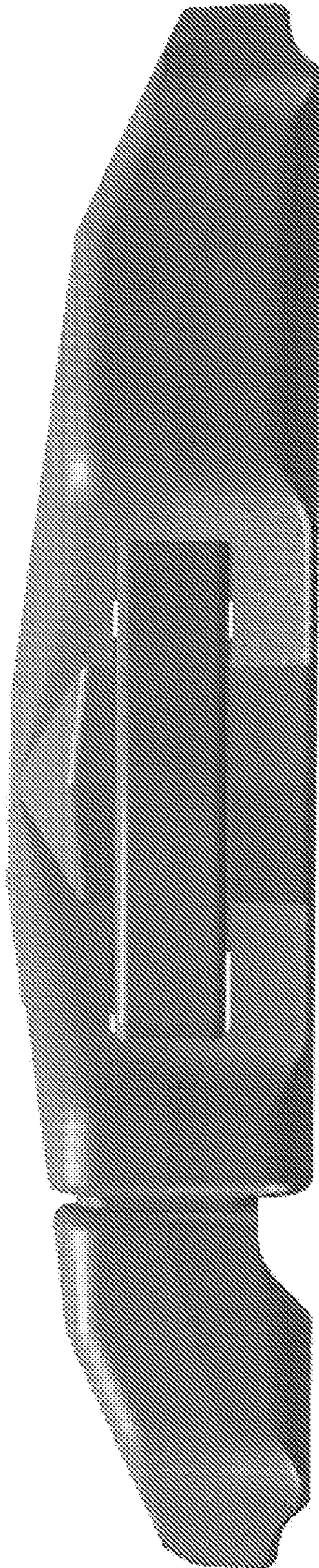
**FIG. 4**



**FIG. 5**

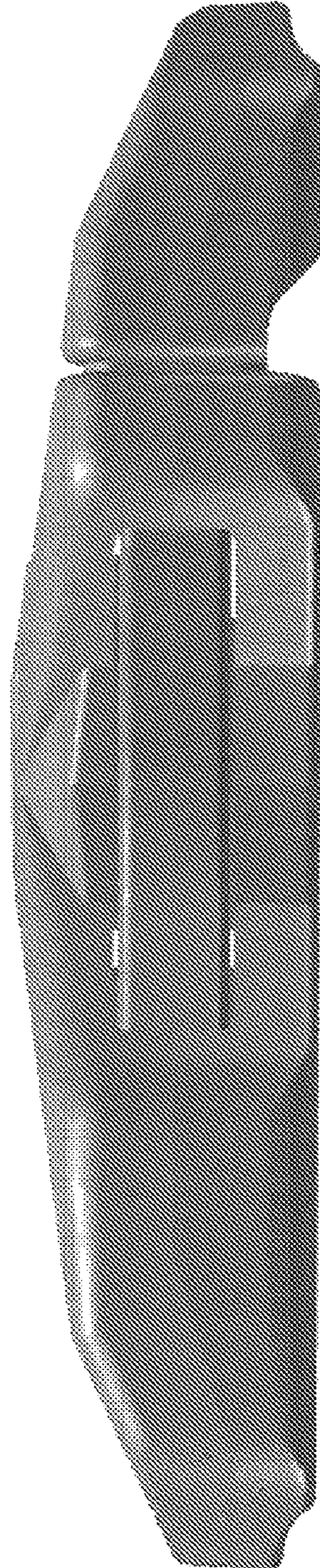


**FIG. 6**



**FIG. 7**





**FIG. 8**