



US00D635040S

(12) **United States Design Patent**  
**Tsai**

(10) **Patent No.:** **US D635,040 S**  
(45) **Date of Patent:** **\*\* Mar. 29, 2011**

(54) **RETRACTABLE PULL REEL**  
(76) Inventor: **Hai Pin Tsai**, Kowloon (HK)  
(\*\*) Term: **14 Years**

5,509,616 A \* 4/1996 Millen et al. .... 242/381.5  
5,791,580 A \* 8/1998 Anderson et al. .... 242/378.4  
6,474,585 B2 \* 11/2002 Liao ..... 242/378.1  
D573,491 S \* 7/2008 Tsai ..... D10/72  
D585,313 S \* 1/2009 Mandel ..... D10/72

\* cited by examiner

(21) Appl. No.: **29/361,829**

*Primary Examiner* — Antoine D Davis

(22) Filed: **May 14, 2010**

(74) *Attorney, Agent, or Firm* — Intellectual Property Law Group LLP; Juneko Jackson; Otto O. Lee

(30) **Foreign Application Priority Data**

Dec. 30, 2009 (HK) ..... 0902227.2M002

(51) **LOC (9) Cl.** ..... **10-04**

(52) **U.S. Cl.** ..... **D10/72**

(58) **Field of Classification Search** ..... D10/72,  
D10/74; 33/755-771; 242/285, 291, 379,  
242/379.1, 379.2, 381, 381.1-381.6, 405  
See application file for complete search history.

(57) **CLAIM**

The ornamental design for a retractable pull reel, as shown and described.

(56) **References Cited**

**U.S. PATENT DOCUMENTS**

4,907,348 A \* 3/1990 Hubbard, Jr. .... 33/767  
D311,874 S \* 11/1990 Ingram et al. .... D10/72  
D315,109 S \* 3/1991 Ingram et al. .... D10/72  
D319,347 S \* 8/1991 VanLandingham et al. ... D10/72

**DESCRIPTION**

FIG. 1 is a rear, bottom, right side perspective view of a retractable pull reel embodying my new design;  
FIG. 2 is a front, top, left side perspective view thereof;  
FIG. 3 is a rear elevational view thereof;  
FIG. 4 is a front elevational view thereof;  
FIG. 5 is a right side elevational view thereof;  
FIG. 6 is a left side elevational view thereof;  
FIG. 7 is a bottom plan view thereof; and,  
FIG. 8 is a top plan view thereof.

**1 Claim, 3 Drawing Sheets**

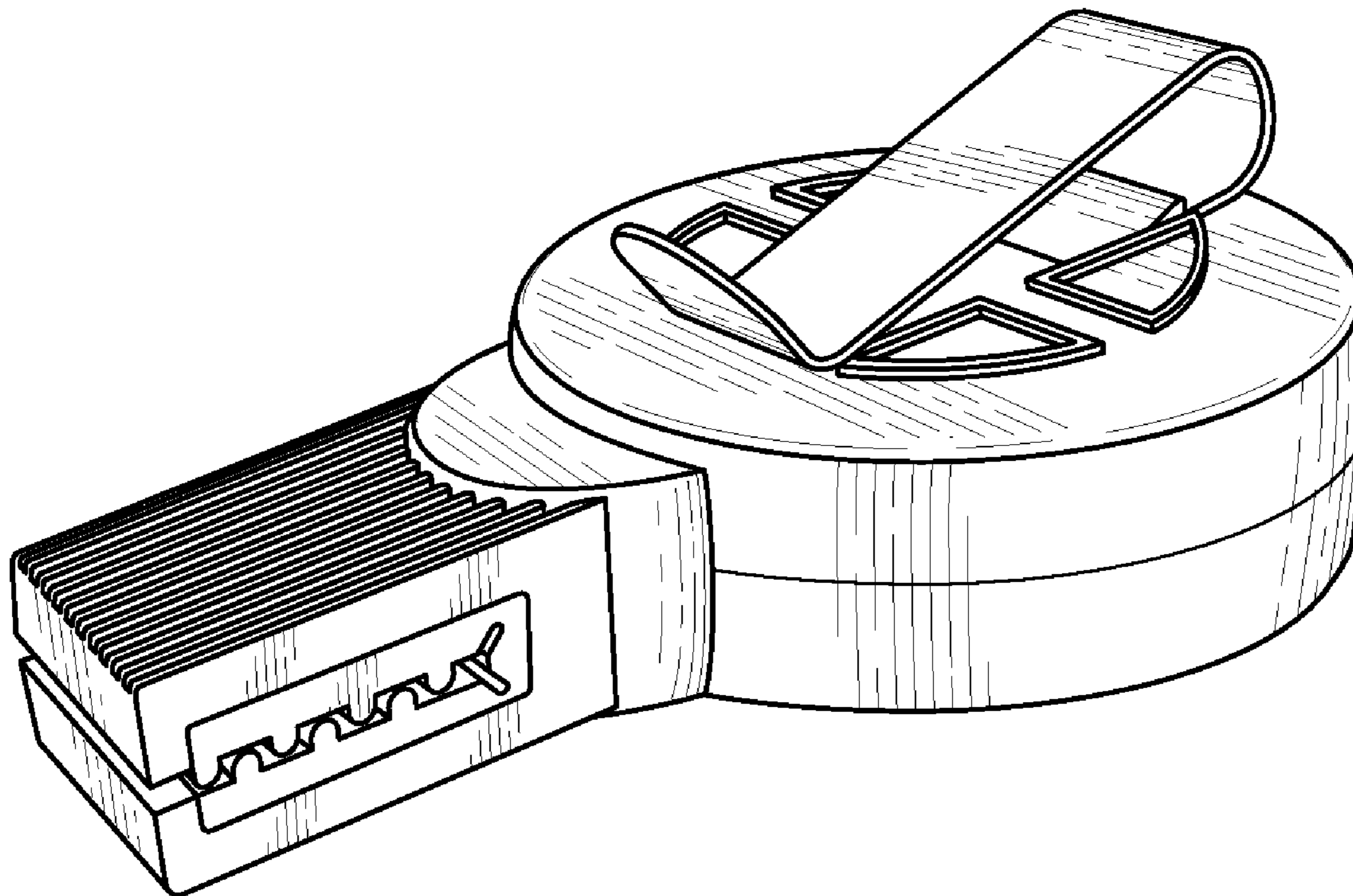

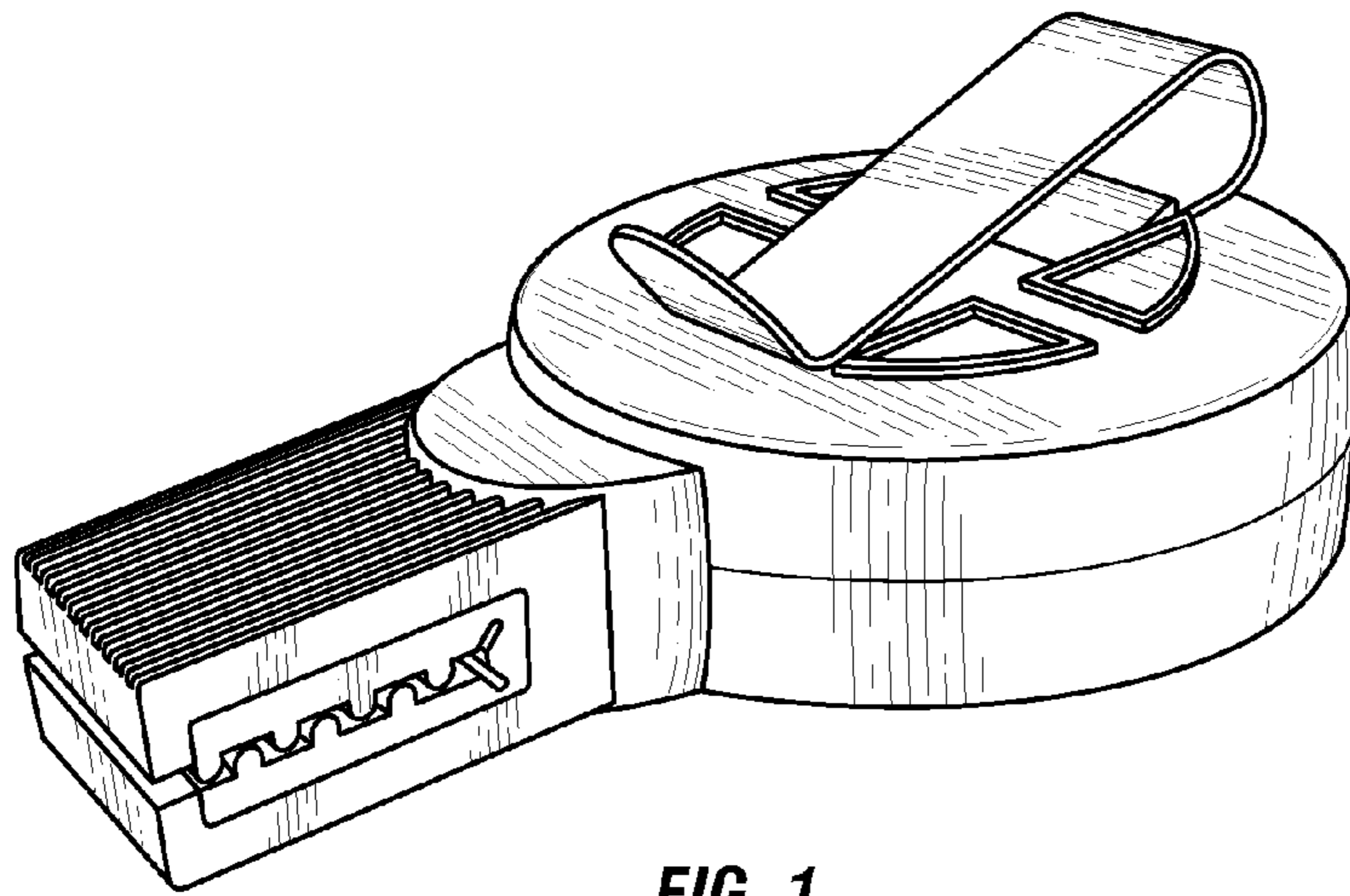

FIG. 1

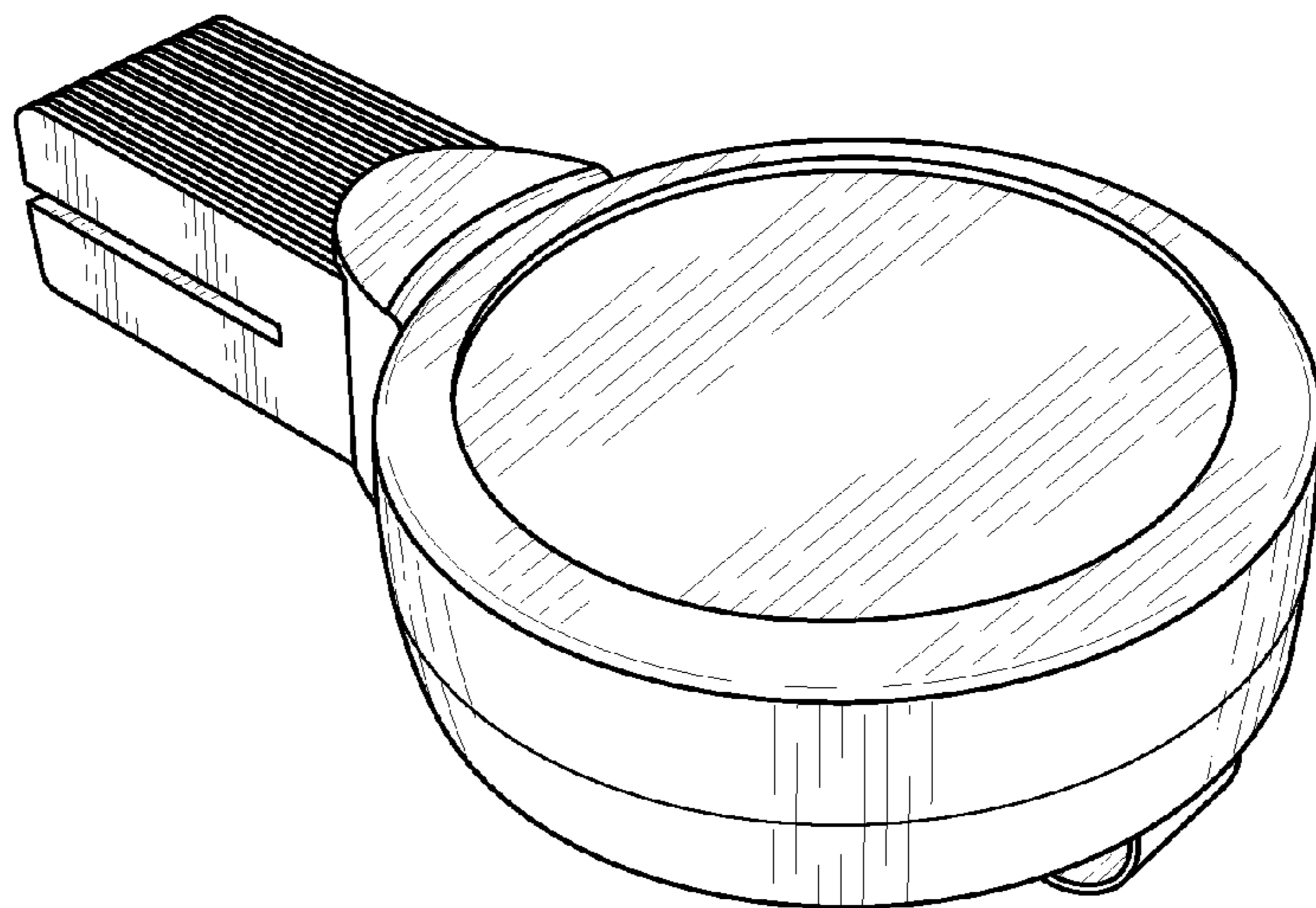

FIG. 2

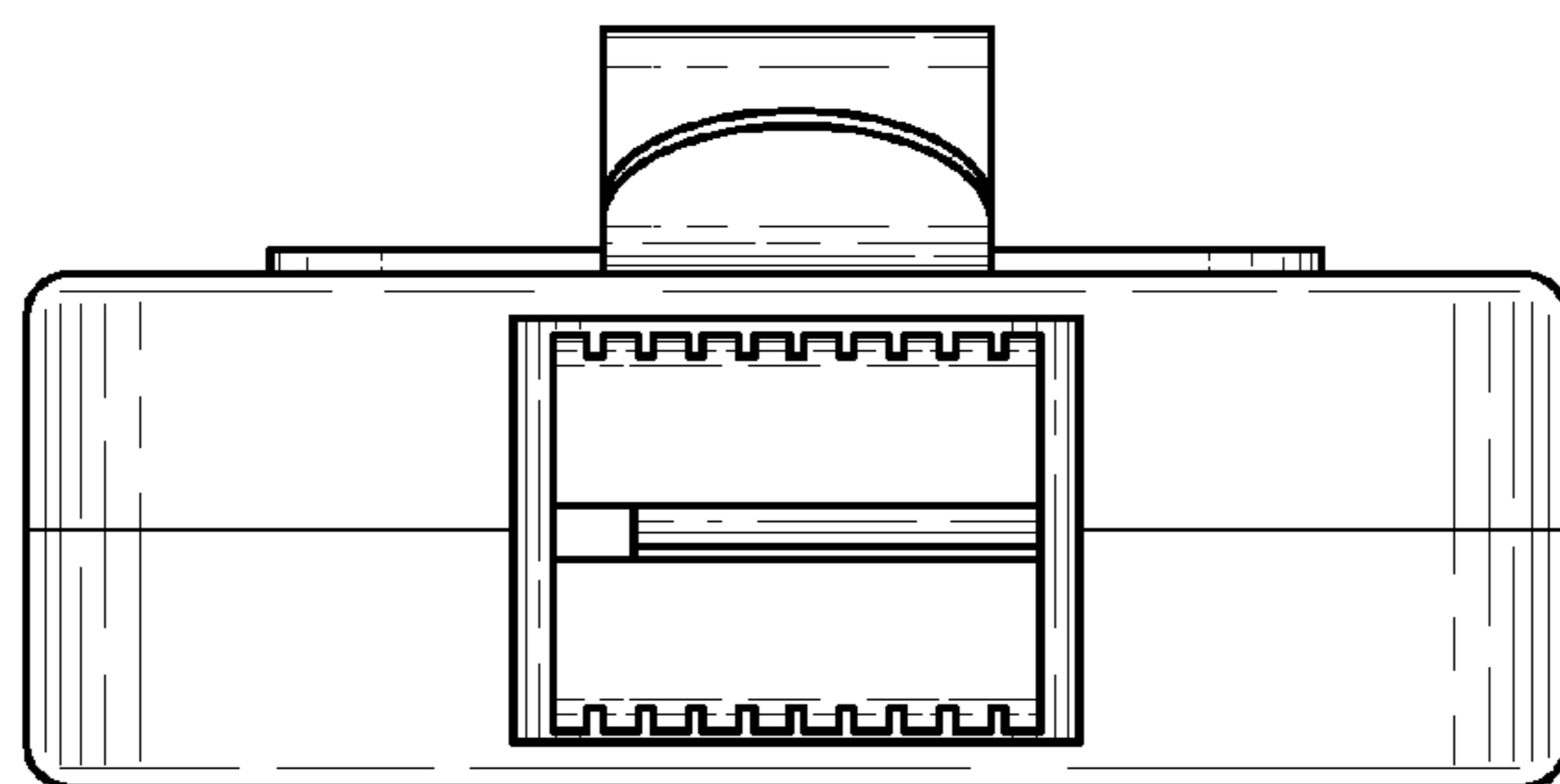
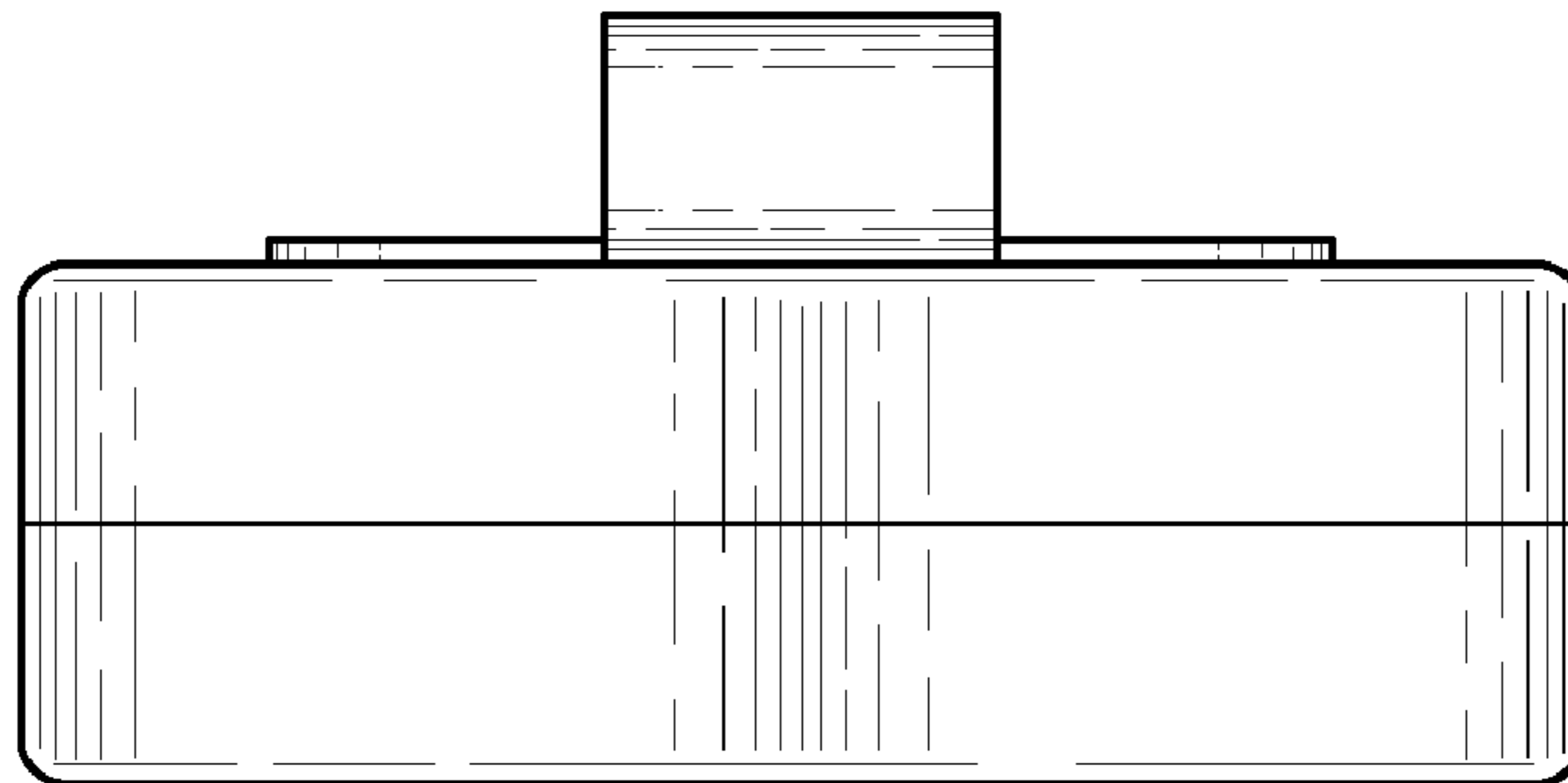
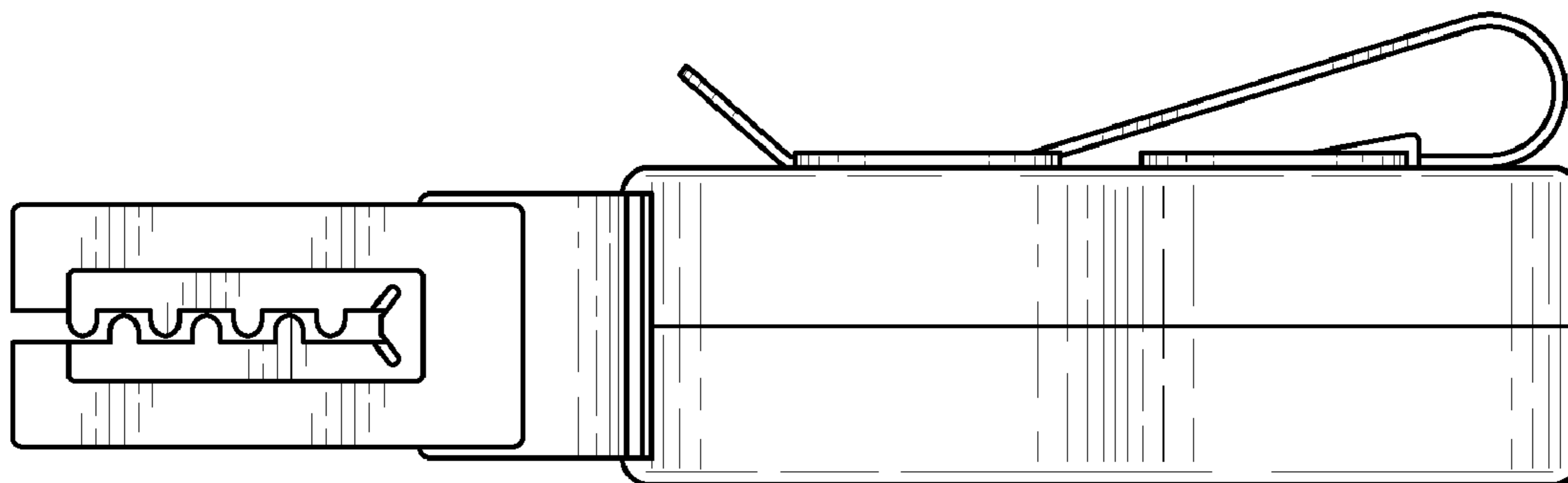

FIG. 3



**FIG. 4**



**FIG. 5**

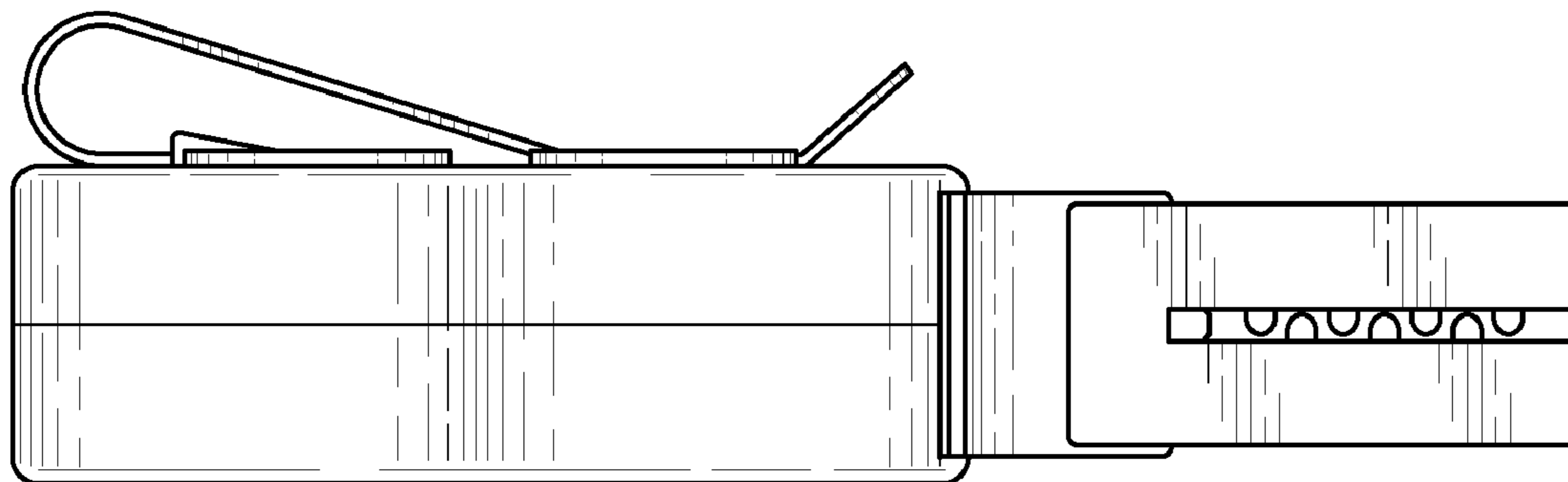

**FIG. 6**

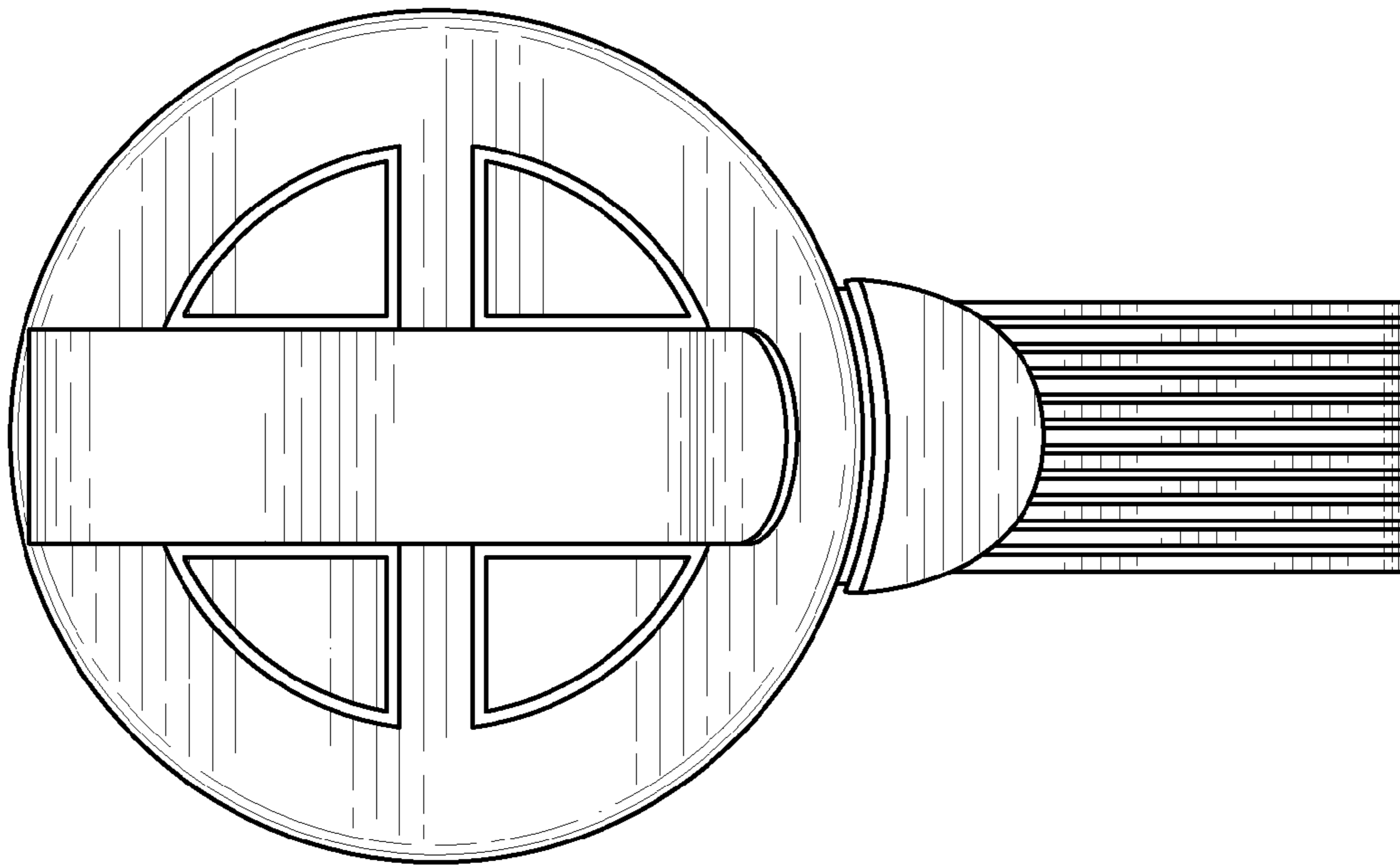

**FIG. 7**

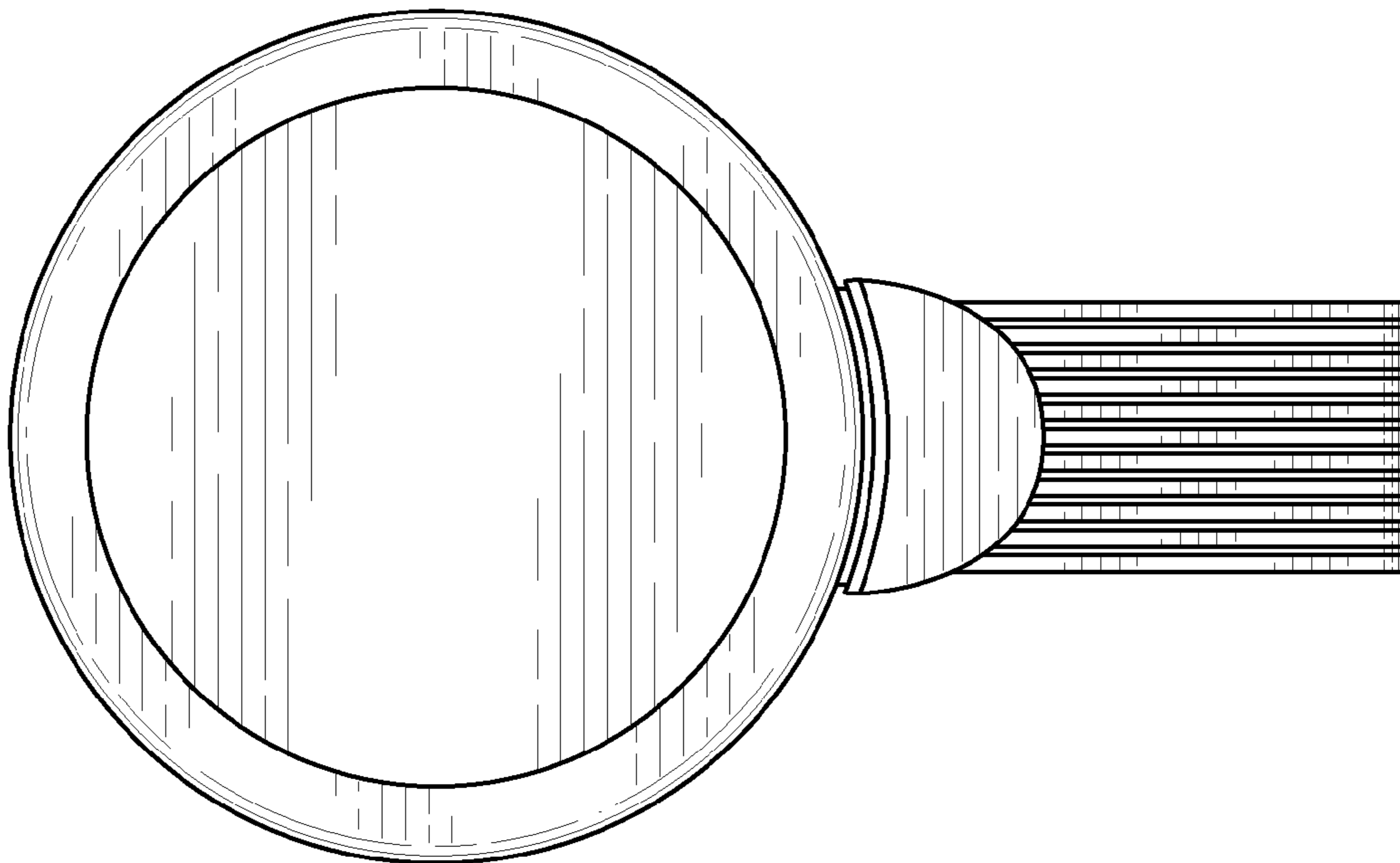

**FIG. 8**