



US00D633668S

(12) **United States Design Patent**  
**Griffin et al.**

(10) **Patent No.:** **US D633,668 S**

(45) **Date of Patent:** **\*\* \*Mar. 1, 2011**

(54) **VACUUM CLEANER**

(75) Inventors: **John Griffin**, Phoenix, AZ (US); **Robert Lent Crevling, Jr.**, Williamsport, PA (US)

(73) Assignee: **Shop Vac Corporation**, Williamsport, PA (US)

(\*\*) Term: **14 Years**

(21) Appl. No.: **29/335,677**

(22) Filed: **Apr. 20, 2009**

**Related U.S. Application Data**

(63) Continuation of application No. 11/364,460, filed on Feb. 28, 2006.

(51) **LOC (9) Cl.** ..... **15-05**

(52) **U.S. Cl.** ..... **D32/23**

(58) **Field of Classification Search** ..... D32/21, D32/23, 31; 15/327.1, 327.2, 327.4, 327.5, 15/327.7, 320-321, 323, 301, 312.1, 314, 15/353, 412, 347; 220/23.83, 23.6

See application file for complete search history.

(56) **References Cited**

**U.S. PATENT DOCUMENTS**

6,055,700 A \* 5/2000 Holsten et al. .... 15/327.2  
D470,279 S 2/2003 Griffin et al.  
D470,281 S \* 2/2003 Griffin et al. .... D32/23

D569,066 S 5/2008 Crevling, Jr. et al.  
D599,968 S \* 9/2009 Crevling et al. .... D32/23  
2006/0191099 A1 \* 8/2006 Fry et al. .... 15/353

\* cited by examiner

*Primary Examiner*—Ruth McInroy

(74) *Attorney, Agent, or Firm*—Marshall, Gerstein & Borun LLP; Richard M. LaBarge; Robert M. Gerstein

(57) **CLAIM**

The ornamental design for a vacuum cleaner, as shown and described.

**DESCRIPTION**

FIG. 1 is a top, front, and right side perspective view of the smaller tank shown in FIG. 2.

FIG. 2 is an exploded perspective view.

FIG. 3 is a perspective view of the vacuum cleaner in assembled condition.

FIG. 4 is a top plan view of the vacuum cleaner as seen in FIG. 3.

FIG. 5 is a left side elevation of the vacuum cleaner as seen in FIG. 3; and,

FIG. 6 is a front elevation of the vacuum cleaner as seen in FIG. 3.

FIG. 1 is shown separately for clarity of illustration. The claimed design is for a full vacuum cleaner in assembled condition as seen in FIG. 3.

**1 Claim, 6 Drawing Sheets**

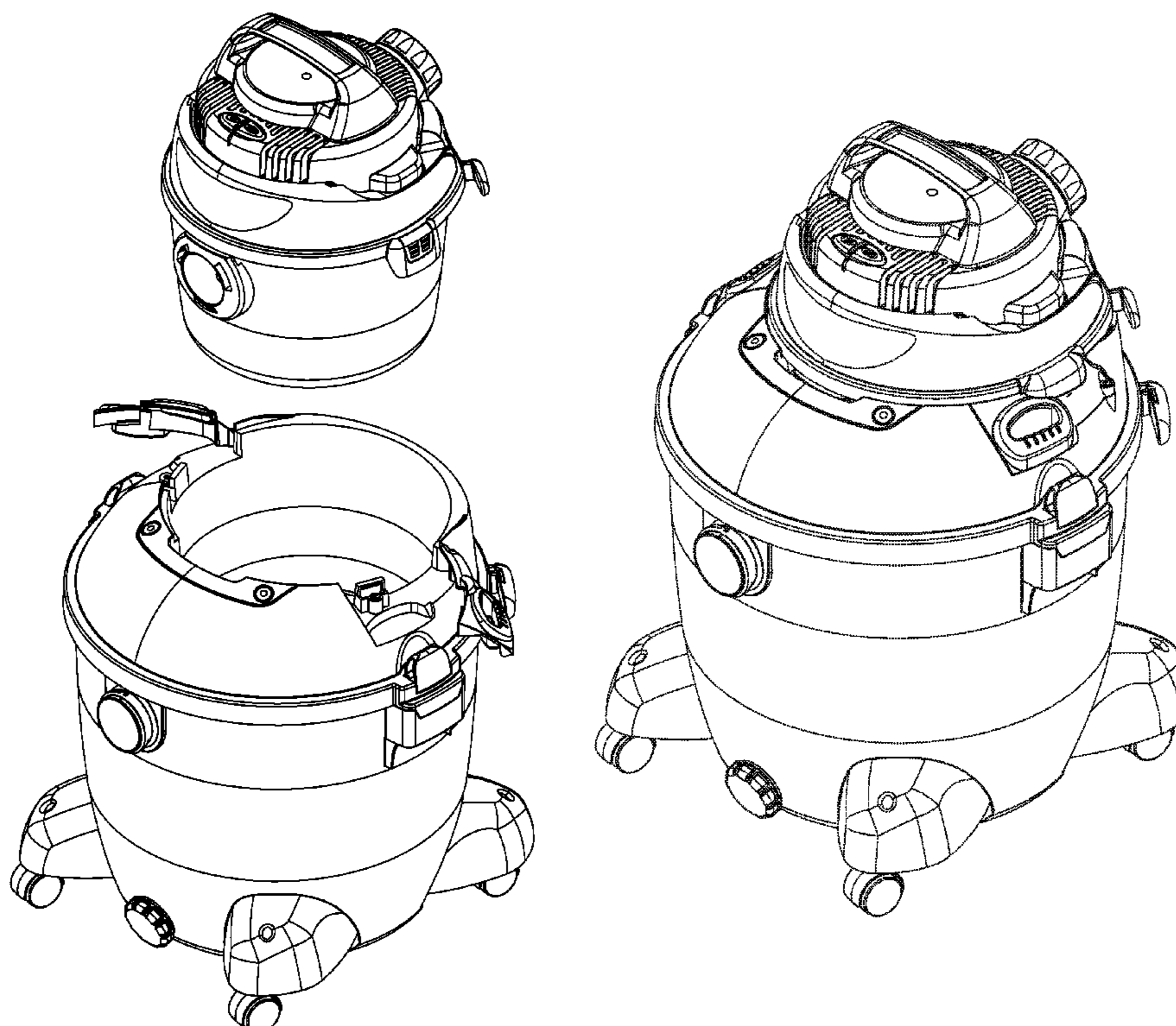

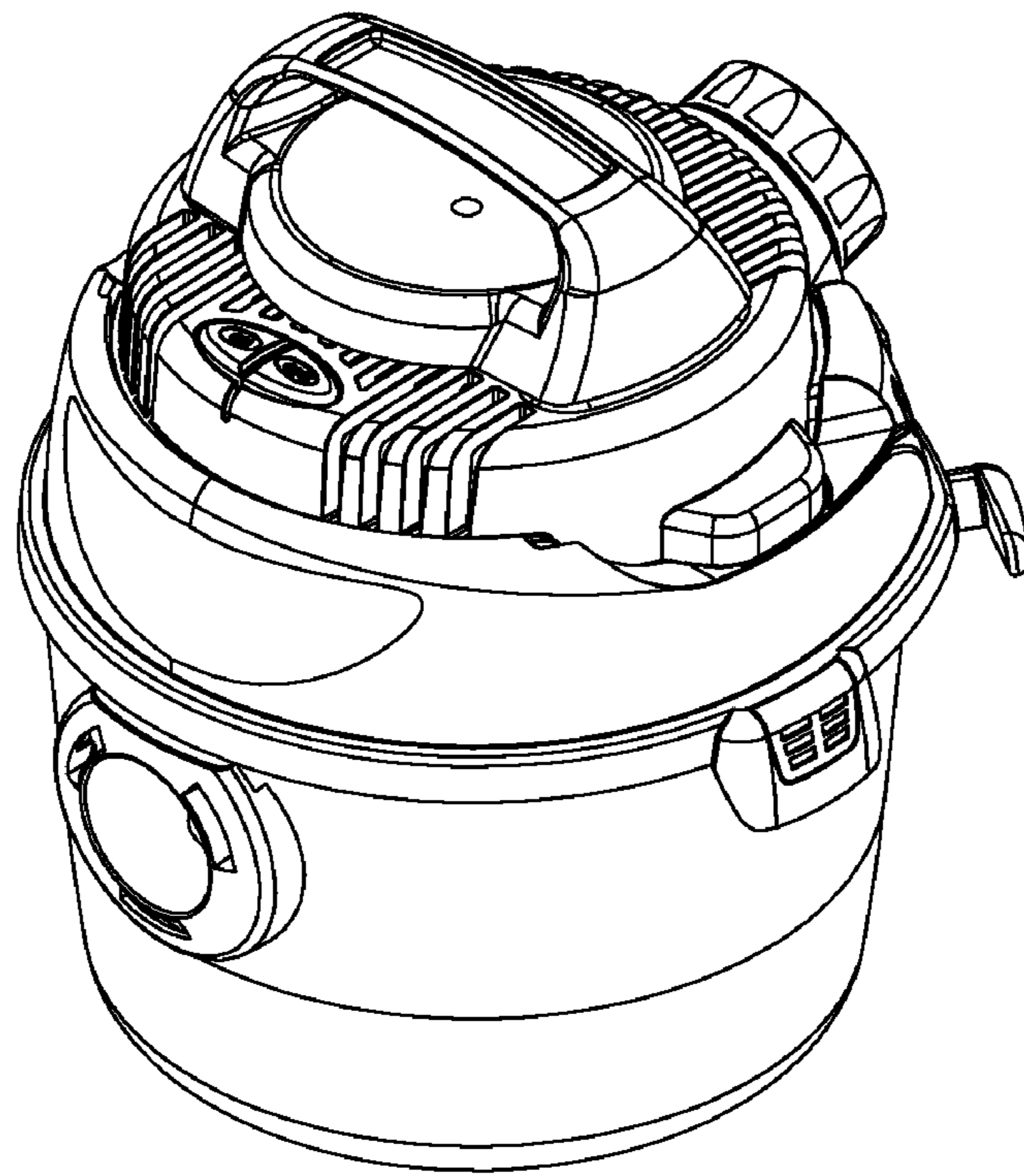

**FIG. 1**

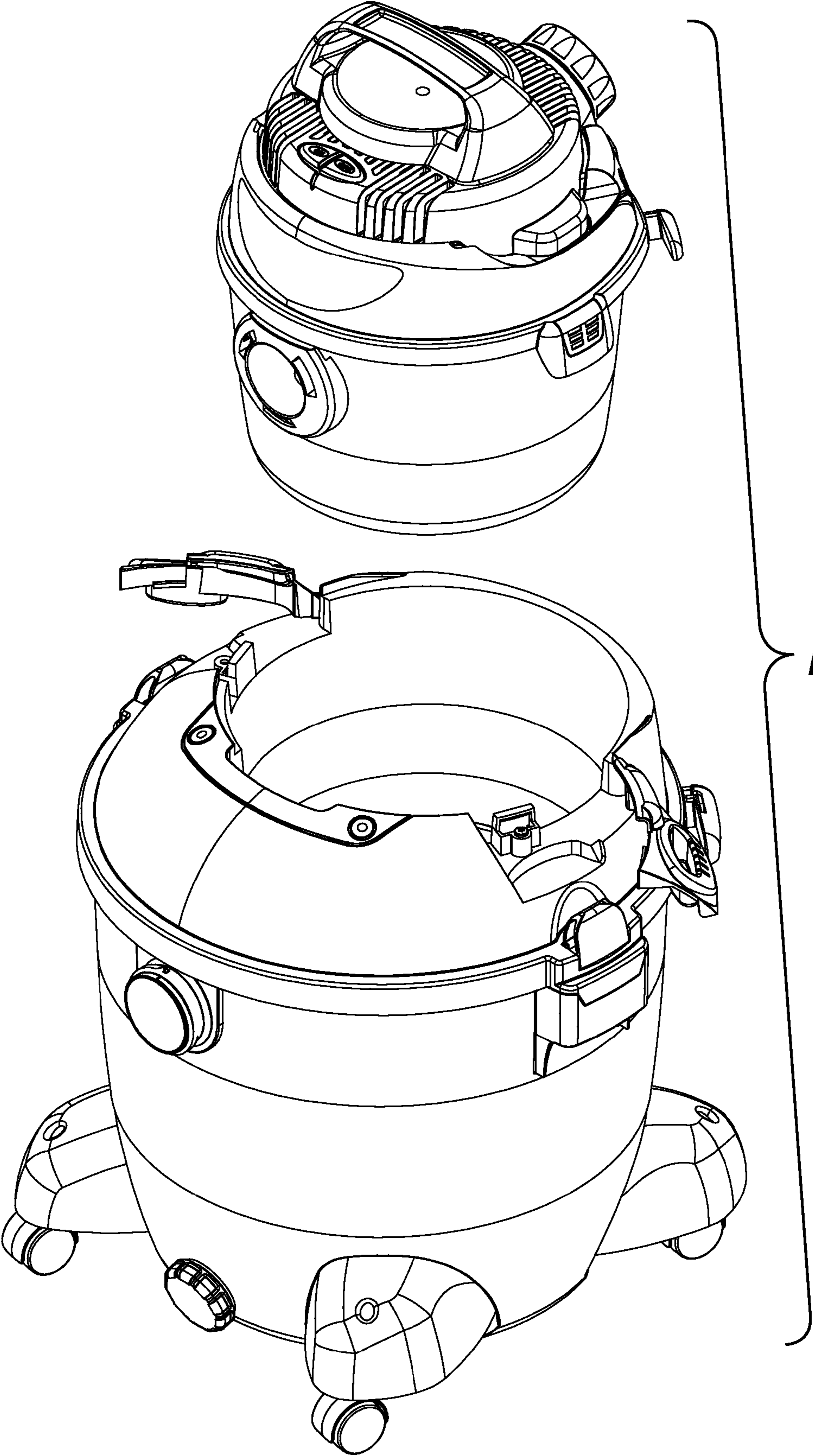

**FIG. 2**

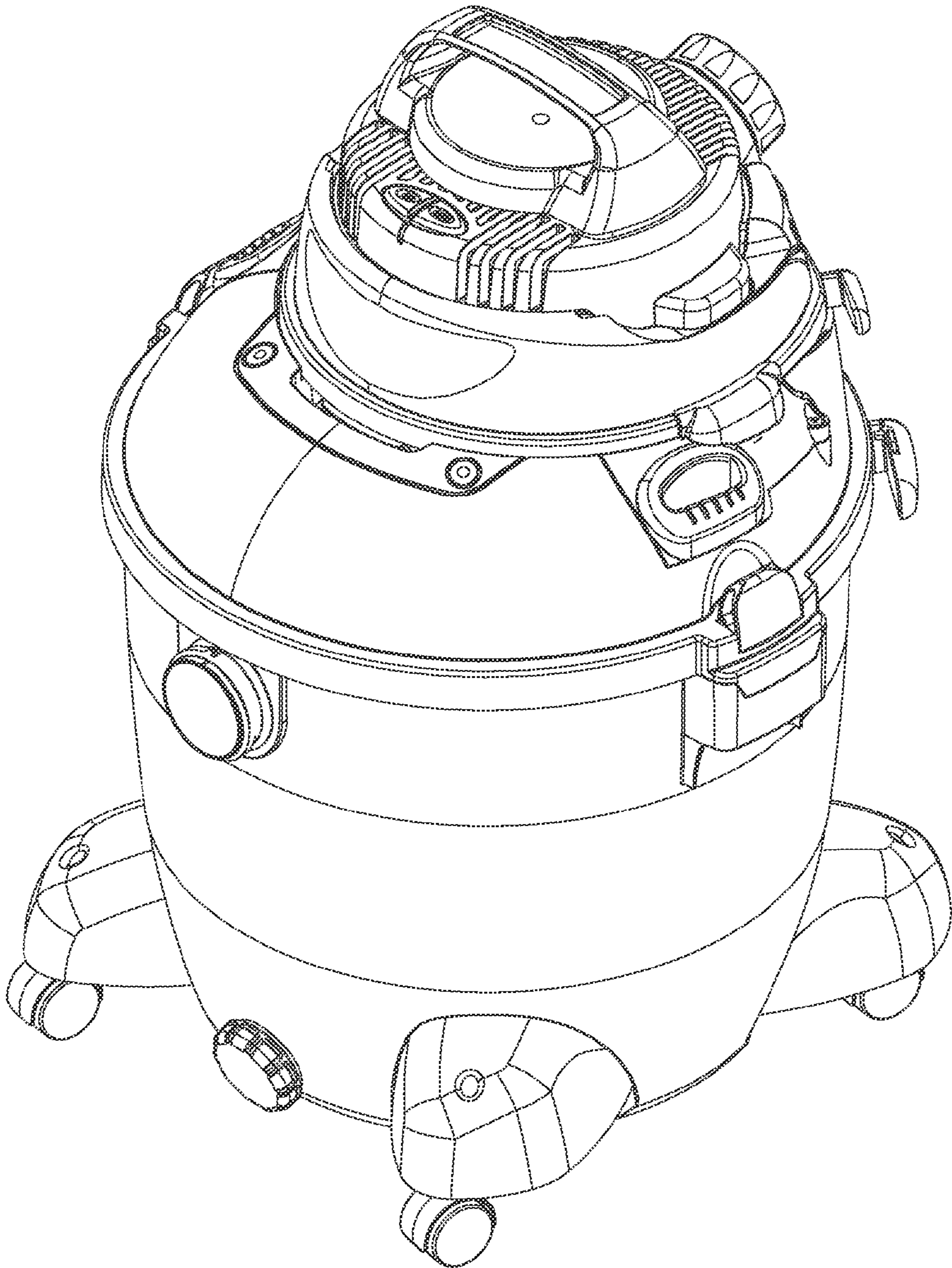
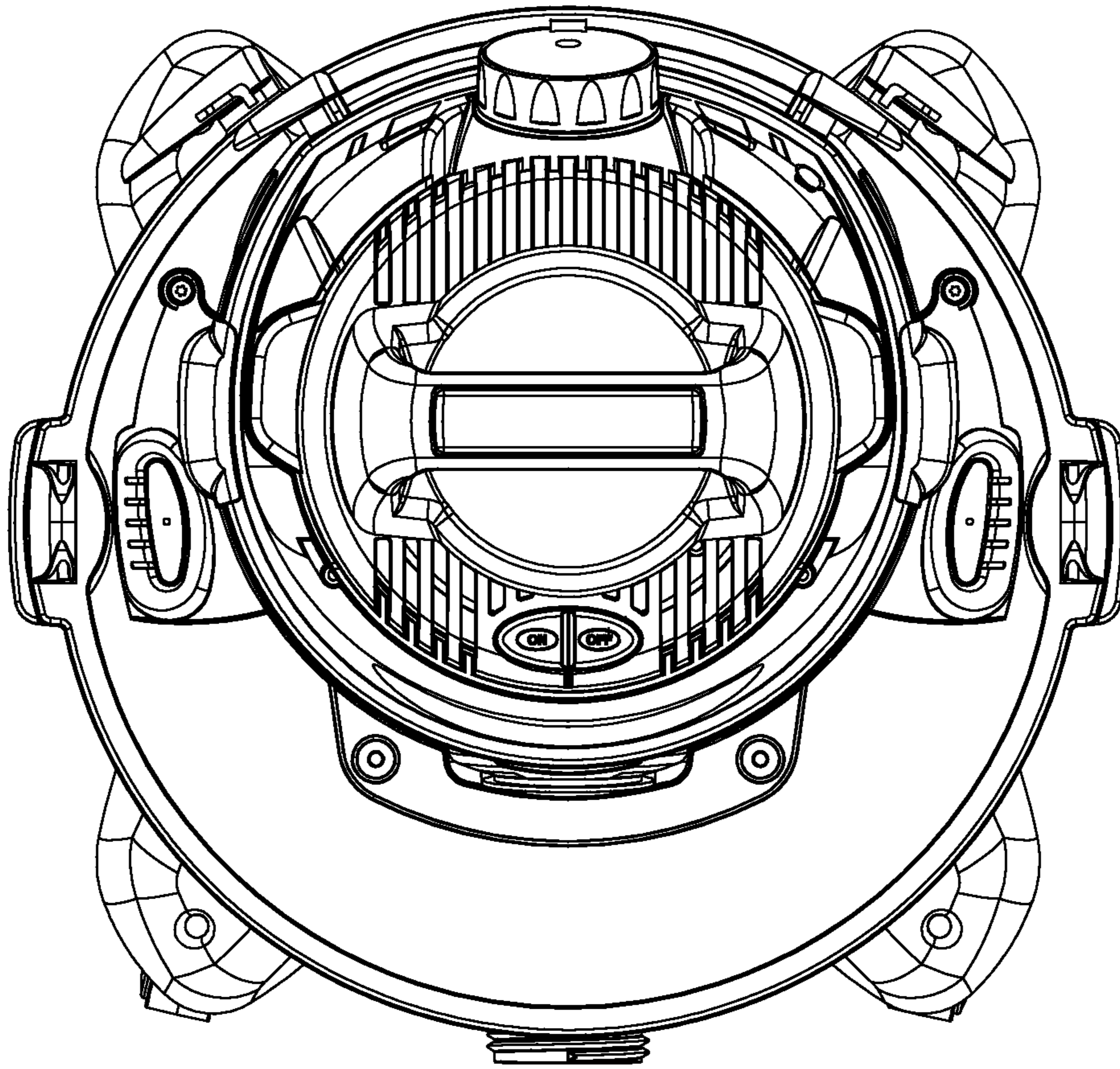
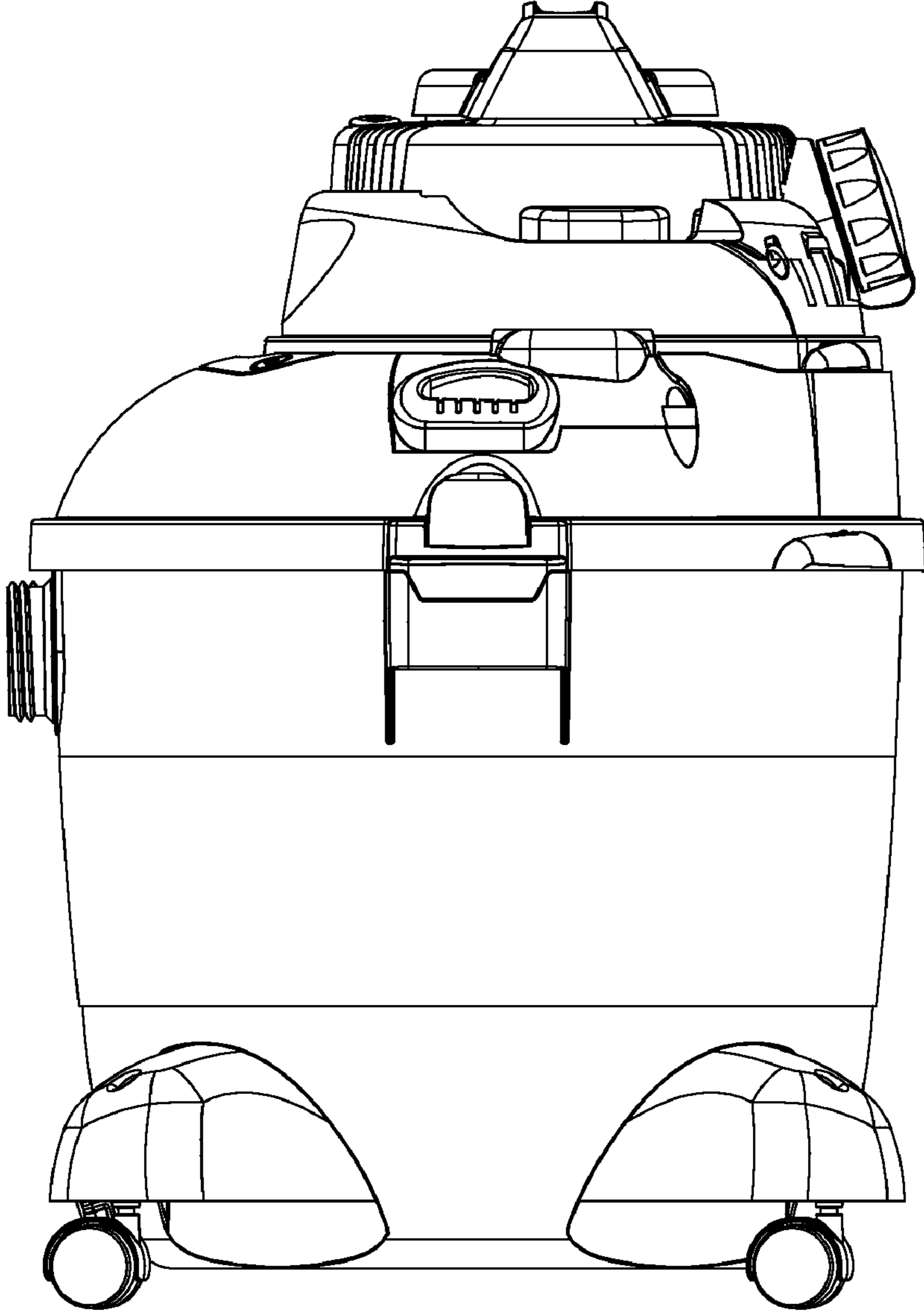

FIG. 3



**FIG. 4**



**FIG. 5**

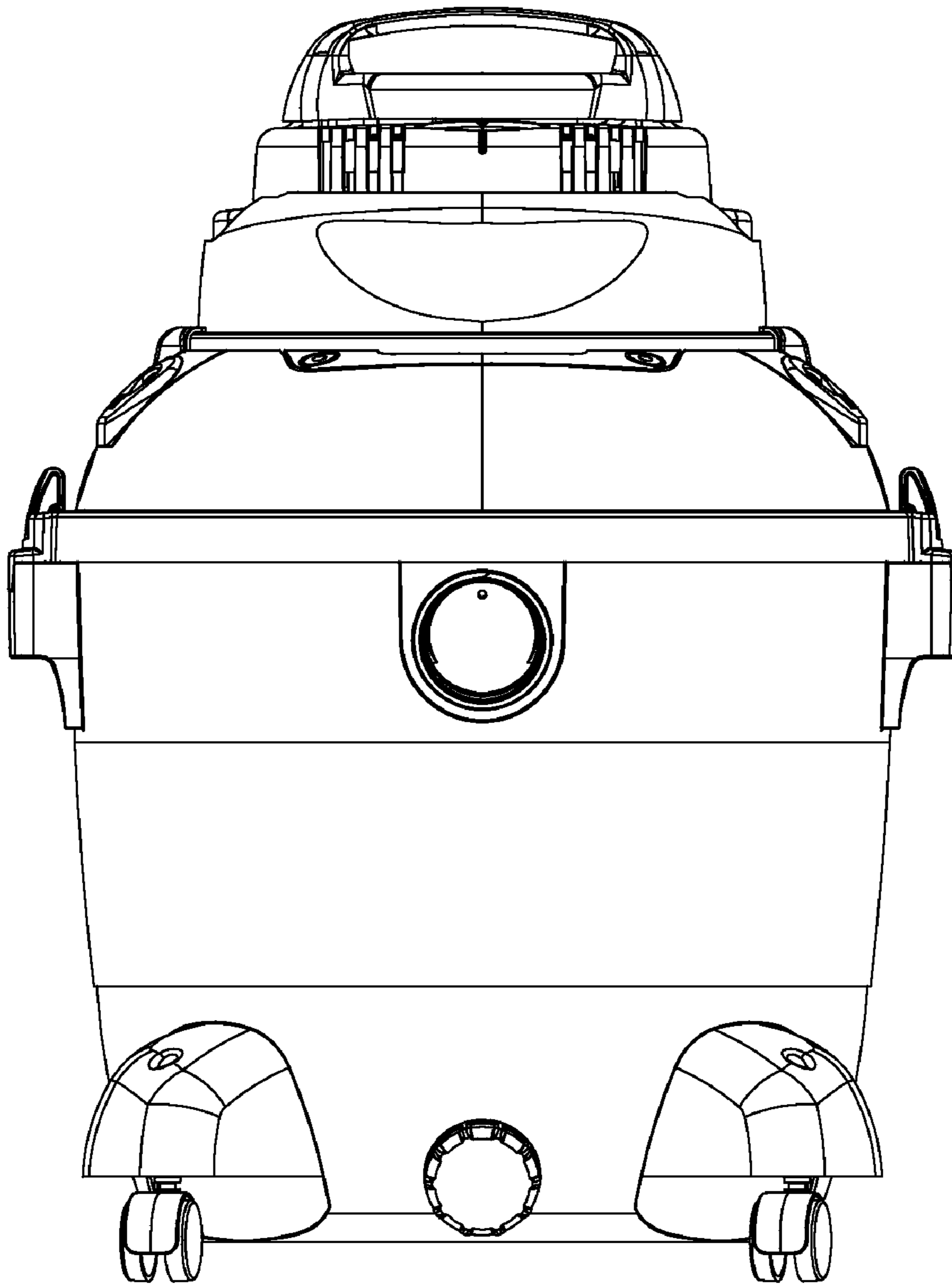

**FIG. 6**