

US00D631267S

(12) **United States Design Patent**
Puksta

(10) **Patent No.:** **US D631,267 S**
(45) **Date of Patent:** **** Jan. 25, 2011**

(54) **CABINET FRAME**

D486,338 S * 2/2004 Walker D6/559
D504,265 S * 4/2005 Walker D6/559

(75) Inventor: **Frederick P. Puksta**, Keene, NH (US)

* cited by examiner

(73) Assignee: **Crown Point Cabinetry Corp.**,
Claremont, NH (US)

Primary Examiner—Brian N Vinson

(74) *Attorney, Agent, or Firm*—Michael J. Weins; Jeffrey E. Semprebbon

(**) Term: **14 Years**

(21) Appl. No.: **29/365,665**

(57) **CLAIM**

(22) Filed: **Jul. 13, 2010**

The ornamental design for a cabinet frame, as shown and described.

Related U.S. Application Data

(62) Division of application No. 29/352,652, filed on Dec. 23, 2009, now Pat. No. Des. 621,643, which is a division of application No. 29/325,600, filed on Oct. 3, 2008, now Pat. No. Des. 609,508.

(51) **LOC (9) Cl.** **06-04**

(52) **U.S. Cl.** **D6/509**

(58) **Field of Classification Search** D6/509,
D6/559, 561, 300, 309, 32, 396, 432, 444–448,
D6/436–439; 312/209, 234, 224–225, 242,
312/245; 206/320, 823; D19/75–86
See application file for complete search history.

(56) **References Cited**

U.S. PATENT DOCUMENTS

D379,281 S * 5/1997 Palka D6/559
D436,481 S * 1/2001 Harwanko D6/559
D437,693 S * 2/2001 Harwanko D6/300

DESCRIPTION

FIG. 1 is a perspective view showing a new design for a cabinet frame, with the broken-line disclosure of portions of a mirror suitable for forming the front of a recessed medicine cabinet understood to form a part of the article in which the claimed design is embodied, but not part of the claimed design;

FIG. 2 is a front elevational view of the first embodiment, the rear elevational view not being visible when the mirror is in use and not forming a part of the claimed design;

FIG. 3 is a right side elevational view of the first embodiment, the left side being a mirror image of the right side;

FIG. 4 is a bottom plan view of the first embodiment, the top plan view not being visible when the mirror is in use and not forming a part of the claimed design; and,

FIG. 5 is a fragmentary horizontal cross-sectional view of the first embodiment, taken along line 5—5 of FIG. 2.

1 Claim, 2 Drawing Sheets

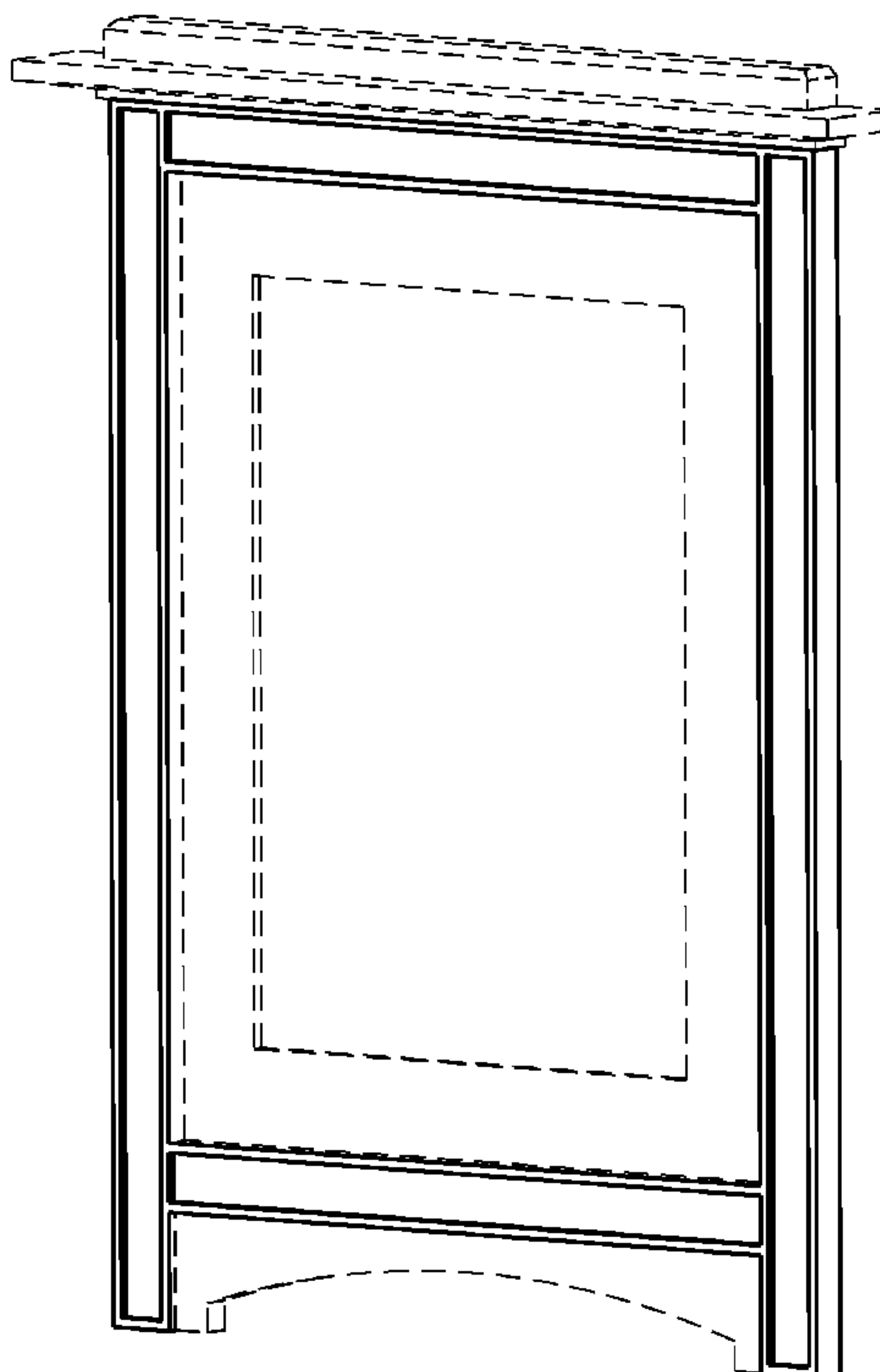

Figure 1

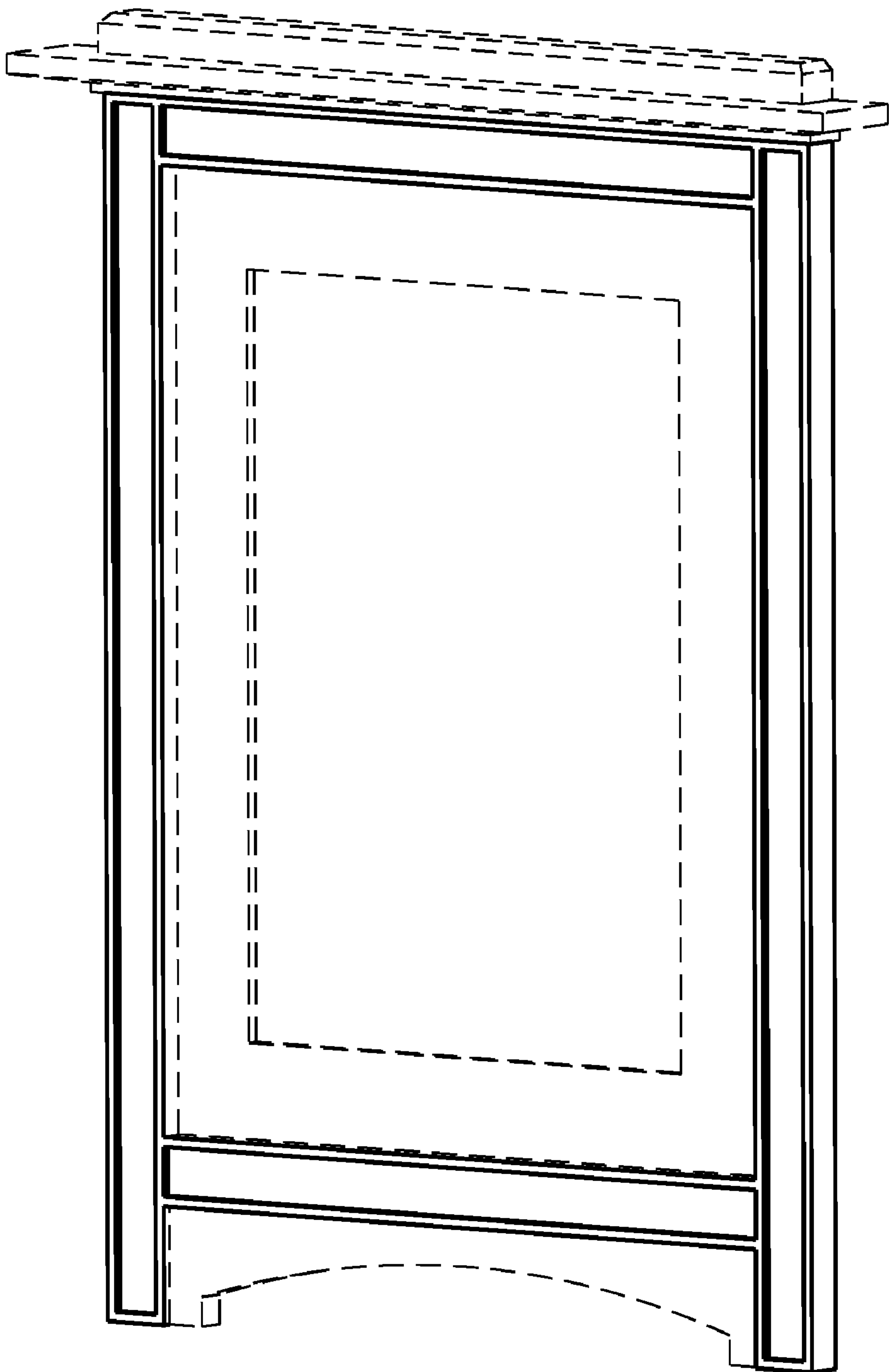

Figure 2

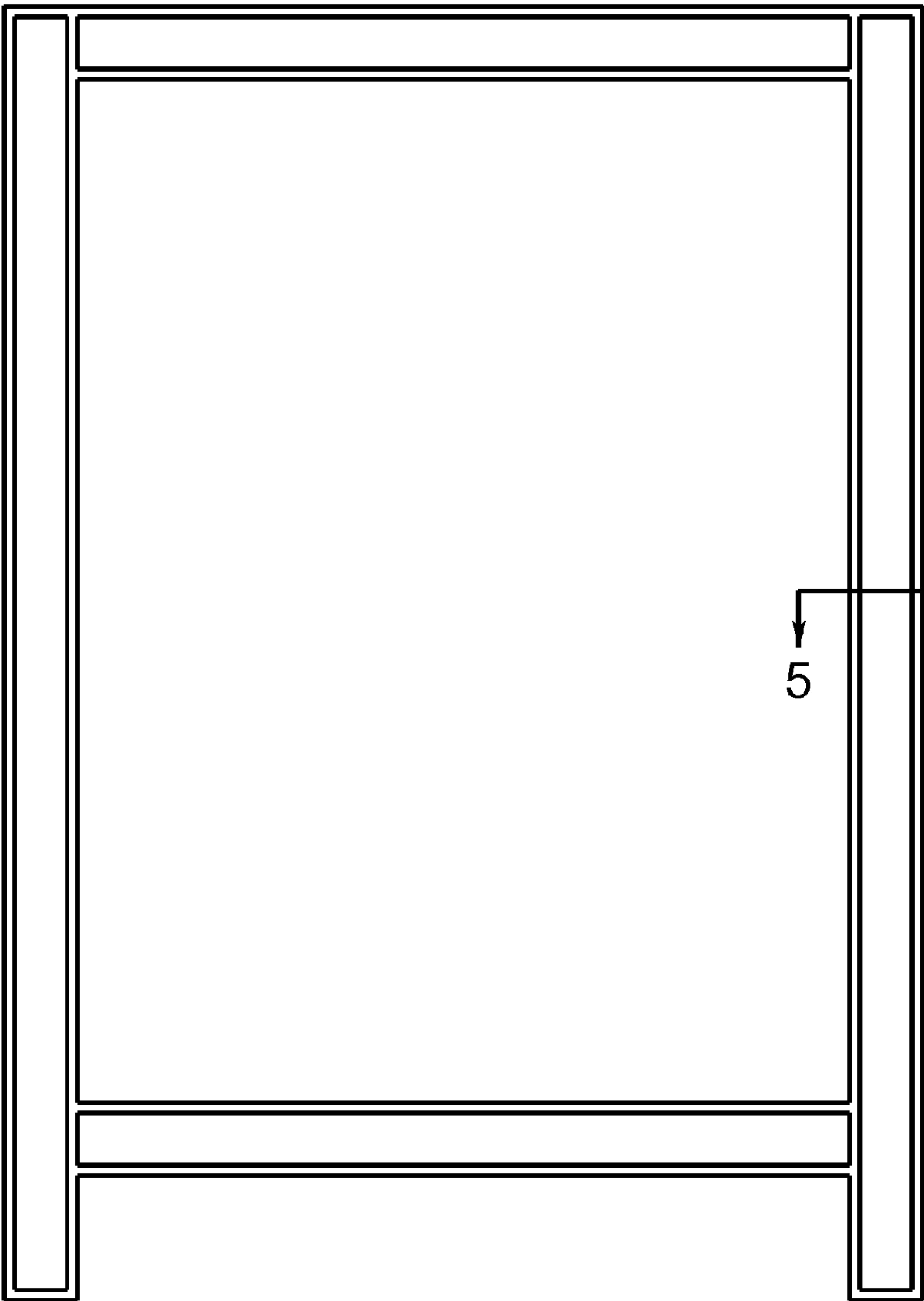

Figure 3



Figure 4



Figure 5

