



US00D631266S

(12) **United States Design Patent**  
**Puksta**

(10) **Patent No.:** **US D631,266 S**  
(45) **Date of Patent:** **\*\* Jan. 25, 2011**

(54) **CABINET FRAME**

(57) **CLAIM**

(75) Inventor: **Frederick P. Puksta**, Keene, NH (US)

The ornamental design for a cabinet frame, as shown and described.

(73) Assignee: **Crown Point Cabinetry Corp.**,  
Claremont, NH (US)

(\*\*) Term: **14 Years**

(21) Appl. No.: **29/365,661**

(22) Filed: **Jul. 13, 2010**

**Related U.S. Application Data**

(62) Division of application No. 29/352,650, filed on Dec. 23, 2009, now Pat. No. Des. 621,642, which is a division of application No. 29/325,599, filed on Oct. 3, 2008, now Pat. No. Des. 609,507.

(51) **LOC (9) Cl.** ..... **06-04**

(52) **U.S. Cl.** ..... **D6/509**

(58) **Field of Classification Search** ..... D6/509,  
D6/559, 561, 300, 309, 32, 396, 432, 444-448,  
D6/436-439; 312/209, 234, 224-225, 242,  
312/245; 206/320, 823; D19/75-86  
See application file for complete search history.

(56) **References Cited**

**U.S. PATENT DOCUMENTS**

D379,281 S *	5/1997	Palka	.....	D6/559
D436,481 S *	1/2001	Harwanko	.....	D6/559
D437,693 S *	2/2001	Harwanko	.....	D6/300
D486,338 S *	2/2004	Walker	.....	D6/559
D504,265 S *	4/2005	Walker	.....	D6/559

\* cited by examiner

*Primary Examiner*—Brian N Vinson

(74) *Attorney, Agent, or Firm*—Michael J. Weins; Jeffrey E. Sempredon

**DESCRIPTION**

FIG. 1 is a perspective view showing a first embodiment of my new design for a cabinet frame, with the broken-line disclosure of portions of a mirror suitable for forming the front of a recessed medicine cabinet understood to form a part of the article in which the claimed design is embodied, but not part of the claimed design;

FIG. 2 is a front elevational view of the first embodiment, the rear elevational view not being visible when the mirror is in use and not forming a part of the claimed design;

FIG. 3 is a right side elevational view of the first embodiment, the left side being a mirror image of the right side;

FIG. 4 is a bottom plan view of the first embodiment, the top plan view not being visible when the mirror is in use and not forming a part of the claimed design;

FIG. 5 is a fragmentary horizontal cross-sectional view of the first embodiment, taken along line 5—5 of FIG. 2;

FIG. 6 is a perspective view showing a second embodiment of my new design for a cabinet frame, with the broken-line disclosure of portions of a floor cabinet understood to form part of the article in which the claimed design is embodied, but not part of the claimed design;

FIG. 7 is a front elevation view of the second embodiment, the rear elevational view not being visible when the cabinet frame is in use and not forming a part of the claimed design.

FIG. 8 is a right side elevation view of the second embodiment, the left side being a mirror image of the right side;

FIG. 9 is a bottom plan view of the second embodiment, the top plan view not being visible when the cabinet frame is in use and not forming a part of the claimed design; and,

FIG. 10 is fragmentary horizontal cross-sectional view of the second embodiment, taken along line 10—10 of FIG. 7.

**1 Claim, 4 Drawing Sheets**

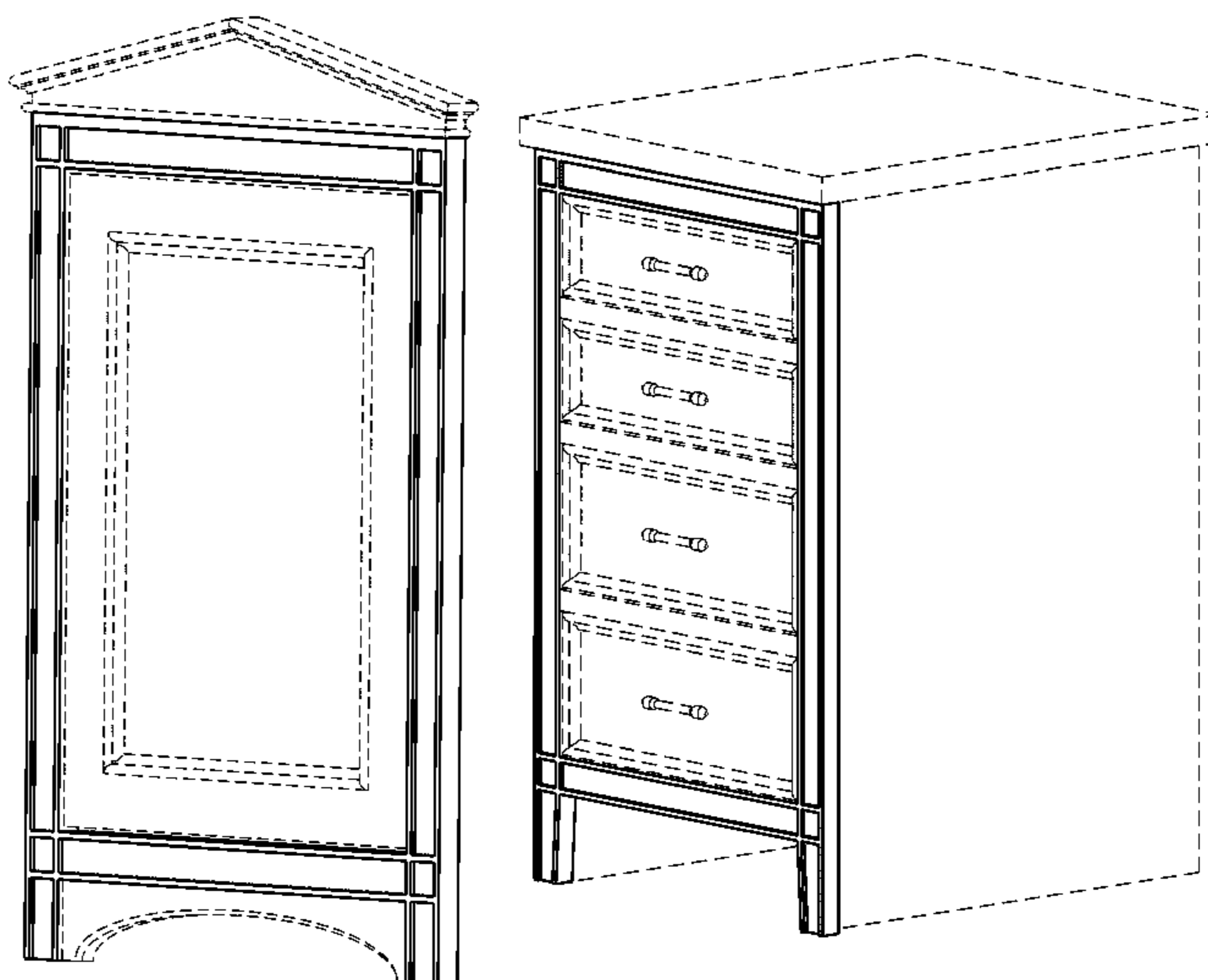

Figure 1

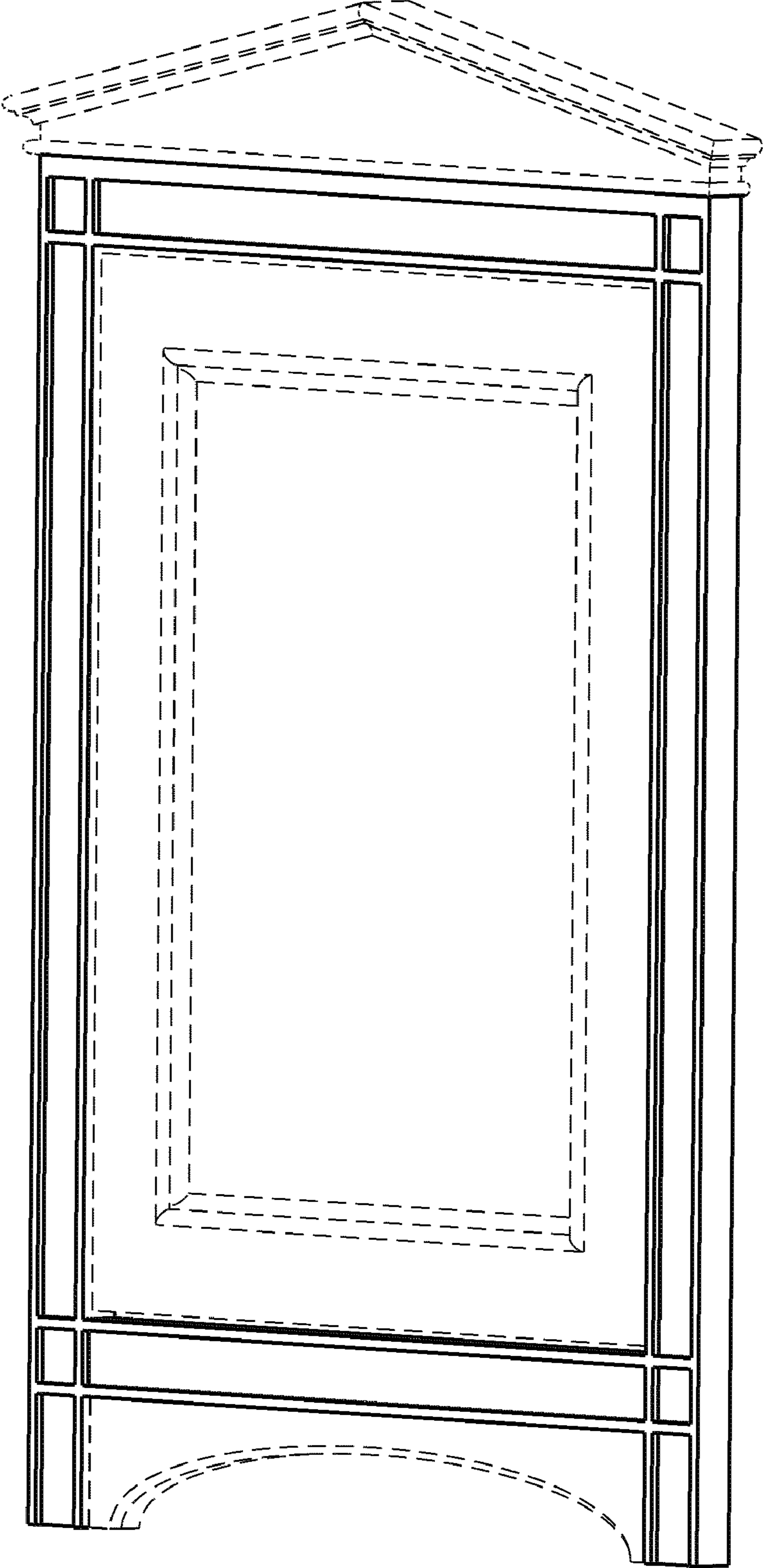

Figure 2

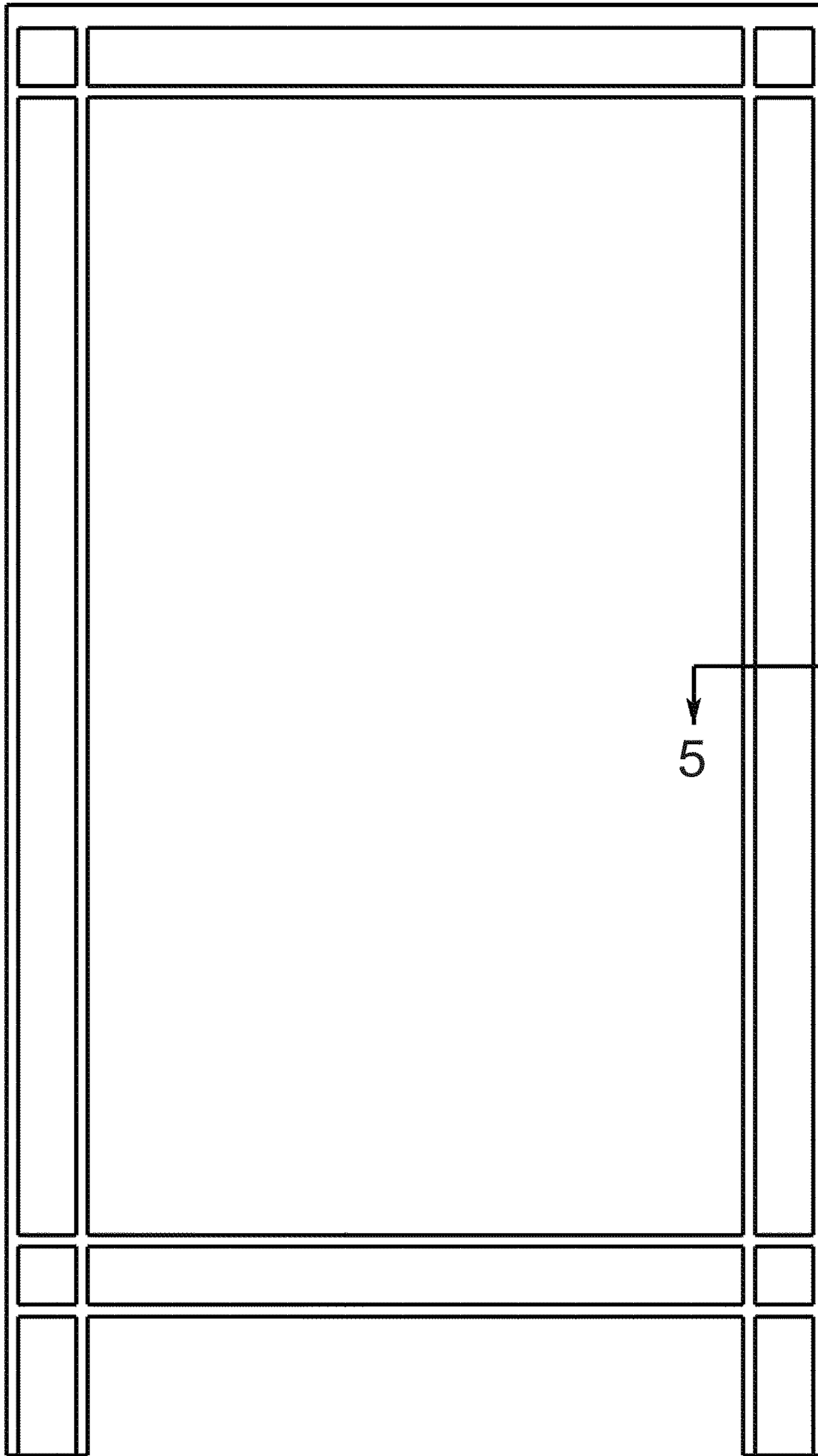

Figure 3



Figure 4



Figure 5

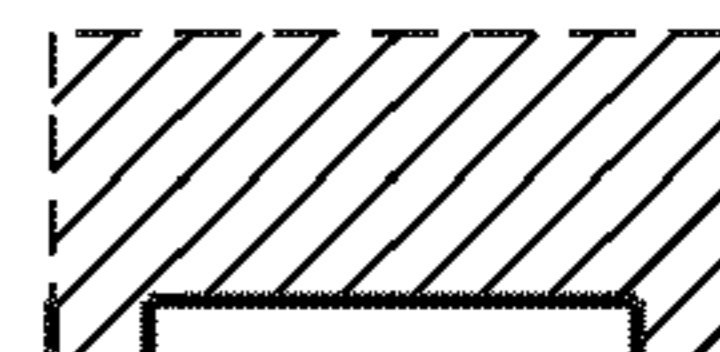

Figure 6

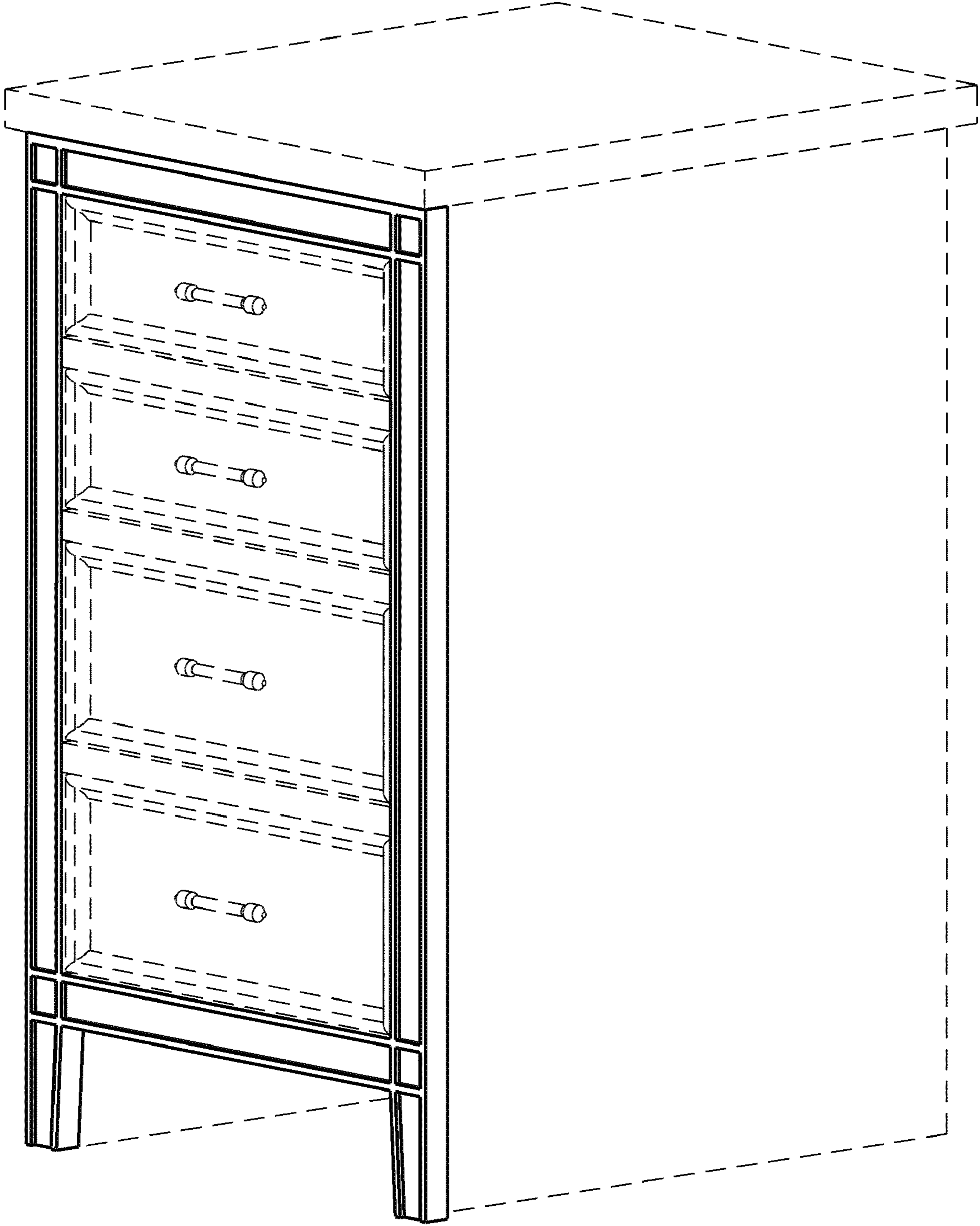

Figure 7

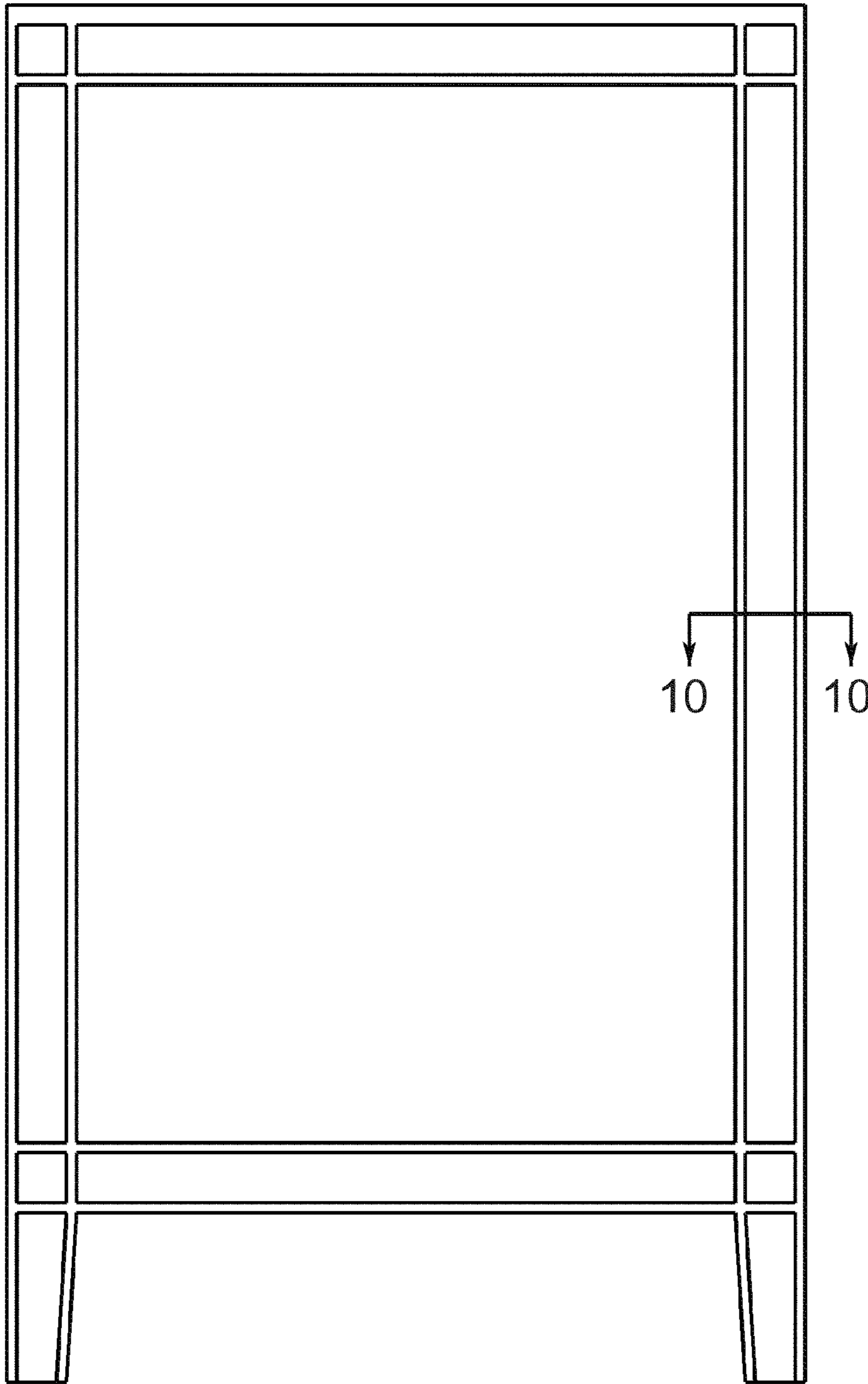

Figure 8



Figure 9



Figure 10

