



US00D629675S

(12) **United States Design Patent**
Goodman et al.

(10) **Patent No.:** **US D629,675 S**
(45) **Date of Patent:** **** Dec. 28, 2010**

(54) **KEY HOOK**

(75) Inventors: **Sheldon H. Goodman**, Solon, OH (US);
Omer I. Sazir, Cleveland, OH (US)

(73) Assignee: **Spectrum Diversified Designs, Inc.**,
Streetsboro, OH (US)

(**) Term: **14 Years**

(21) Appl. No.: **29/368,073**

(22) Filed: **Aug. 18, 2010**

(51) **LOC (9) Cl.** **08-05**

(52) **U.S. Cl.** **D8/367**

(58) **Field of Classification Search** D8/367,
D8/354, 349, 556, 358, 359, 370-372, 356;
174/135; 248/89, 215, 339, 489, 74; 385/135,
385/134, 60, 62; 52/220.1, 74.1; D13/156;
D6/313, 323, 500; D19/34; D3/273; 16/87.2,
16/87.8

See application file for complete search history.

(56) **References Cited**

U.S. PATENT DOCUMENTS

28,174	A	*	5/1860	Hochstrasser	248/215
D349,447	S	*	8/1994	Daniller	D8/367
D360,355	S	*	7/1995	Adams	D8/367
5,738,319	A	*	4/1998	Grassi	248/215
D423,914	S	*	5/2000	Klein et al.	D8/367
D465,724	S	*	11/2002	Goodman et al.	D8/367
6,659,414	B1	*	12/2003	Guilmette	248/303
D538,630	S	*	3/2007	Sergi	D8/354
D576,021	S	*	9/2008	Goodman et al.	D8/372

D584,939	S	*	1/2009	Snell	D8/367
D587,936	S	*	3/2009	Johnson	D6/467
7,578,492	B2	*	8/2009	Darre'	248/477
D605,489	S	*	12/2009	Aglassinger	D8/68
D605,498	S	*	12/2009	Carl	D8/367
D606,846	S	*	12/2009	Carl	D8/367
D607,310	S	*	1/2010	Williams	D8/367
D608,357	S	*	1/2010	Peyridieu	D14/253
D613,151	S	*	4/2010	Goodman et al.	D8/367
D613,589	S	*	4/2010	Goodman et al.	D8/367
D614,020	S	*	4/2010	Biagi et al.	D8/367

* cited by examiner

Primary Examiner—Cynthia Underwood

(74) *Attorney, Agent, or Firm*—Pearne & Gordon LLP

(57) **CLAIM**

The ornamental design for a key hook, as shown and described.

DESCRIPTION

FIG. 1 is a perspective view of a key hook showing our new design;

FIG. 2 is a top plan view thereof;

FIG. 3 is a left side elevational view thereof;

FIG. 4 is a front elevational view thereof;

FIG. 5 is a right side elevational view thereof;

FIG. 6 is a rear elevational view thereof; and,

FIG. 7 is a bottom plan view thereof.

The dotted-line showing in the drawings illustrates environmental matter and forms no part of the claimed design.

1 Claim, 2 Drawing Sheets

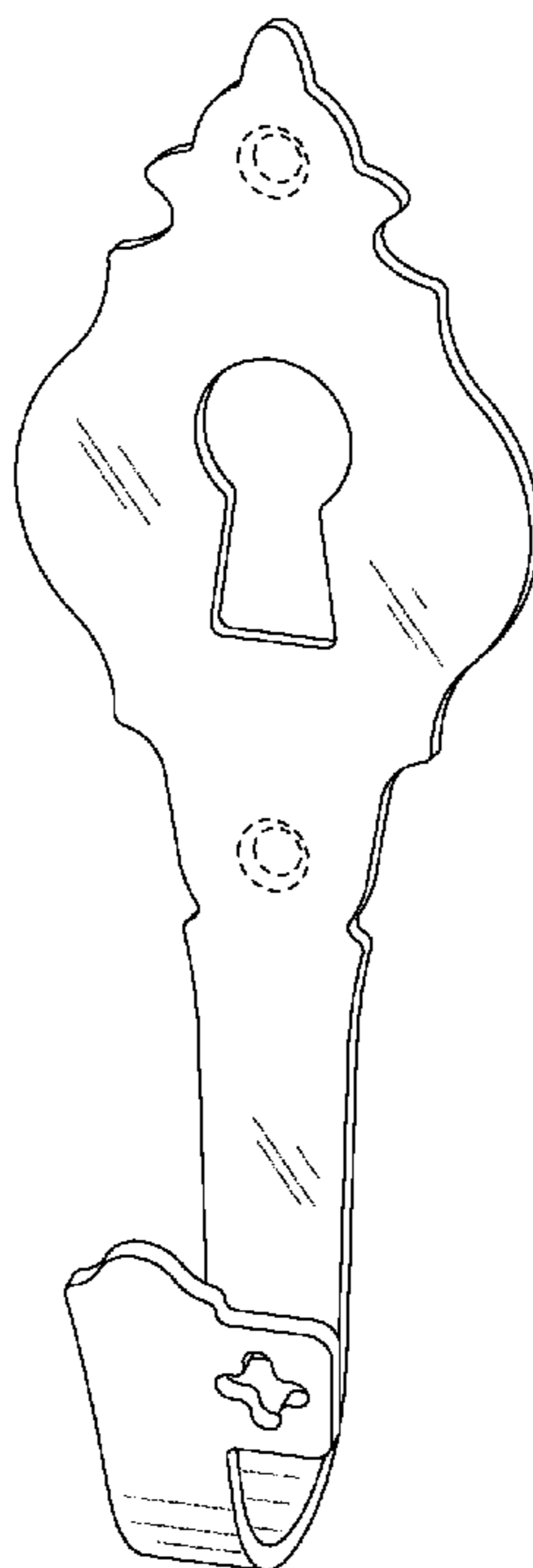

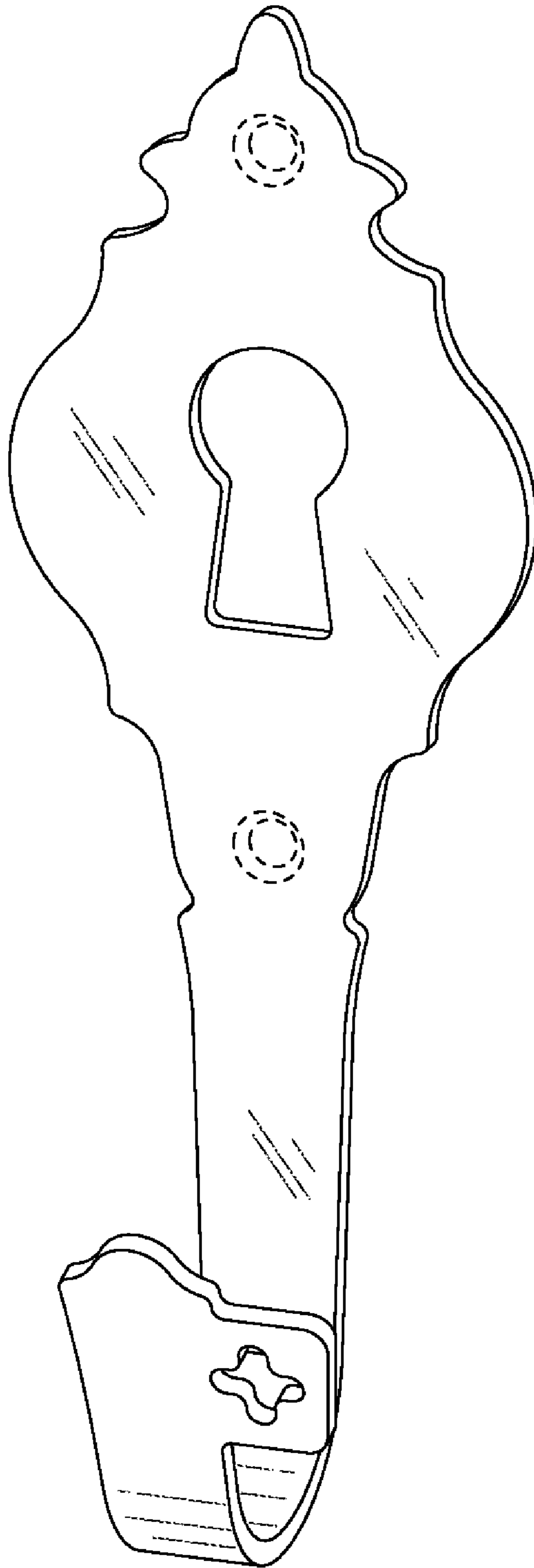

FIG. 1

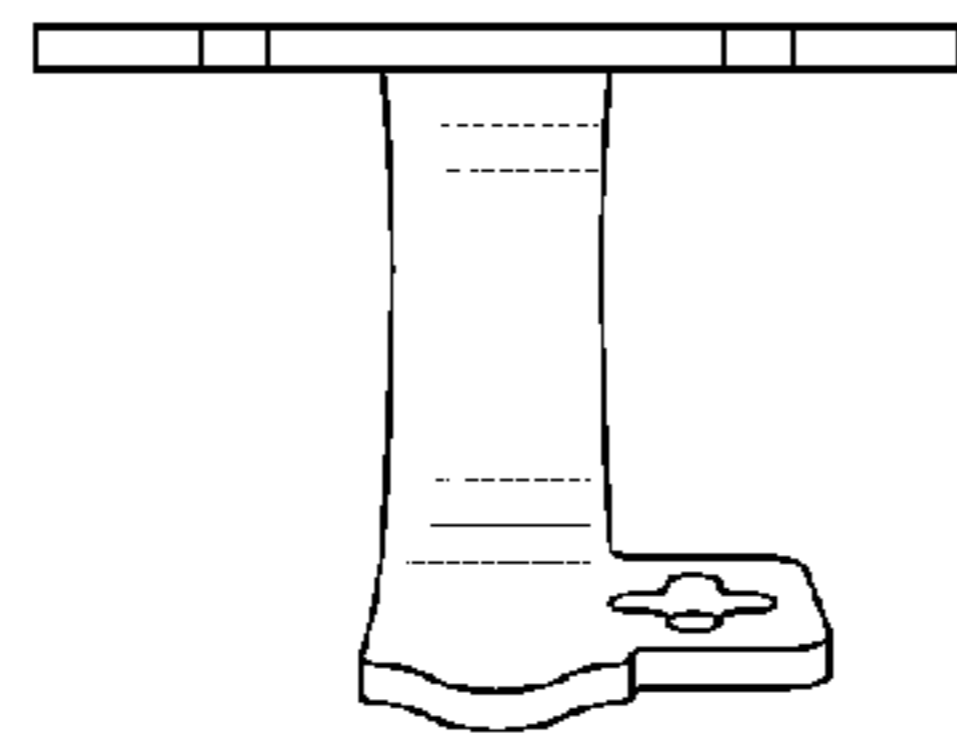

FIG. 2



FIG. 3

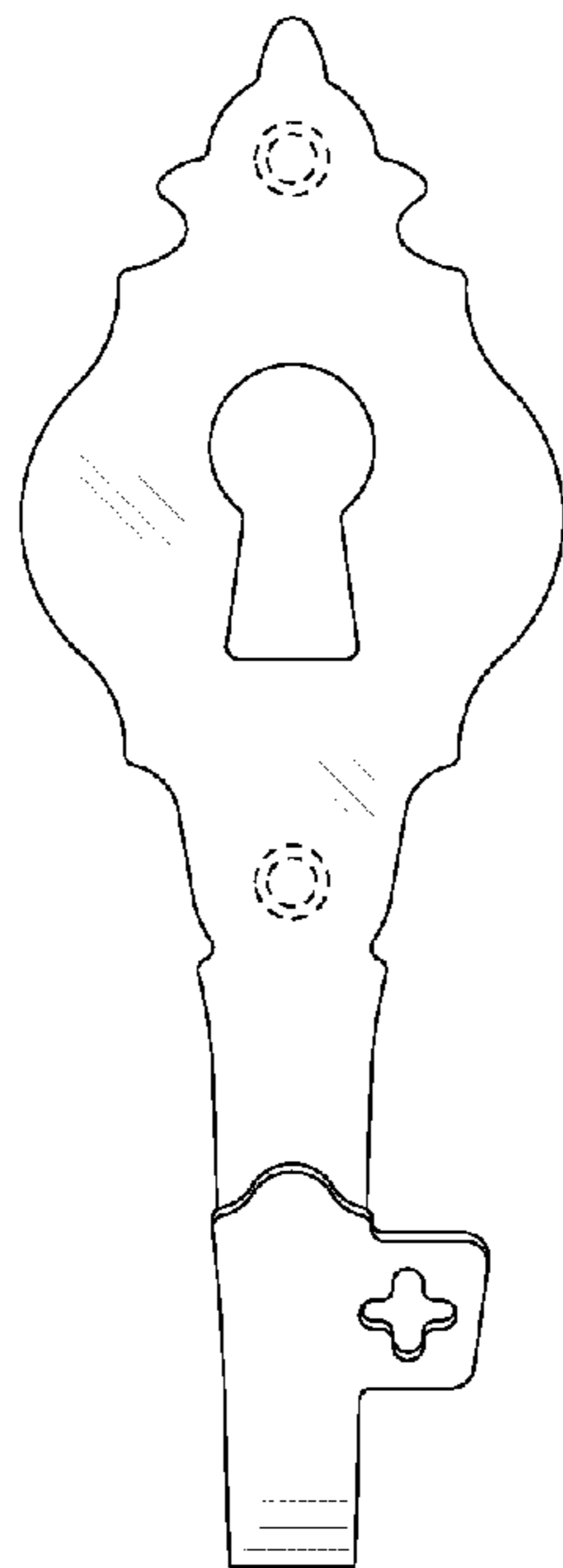

FIG. 4

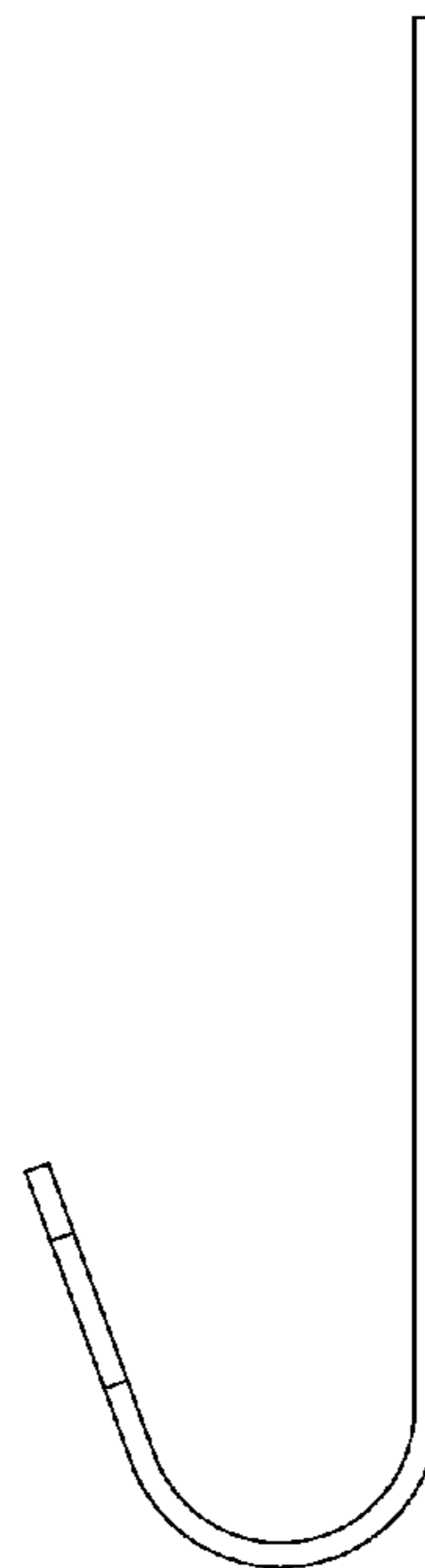

FIG. 5

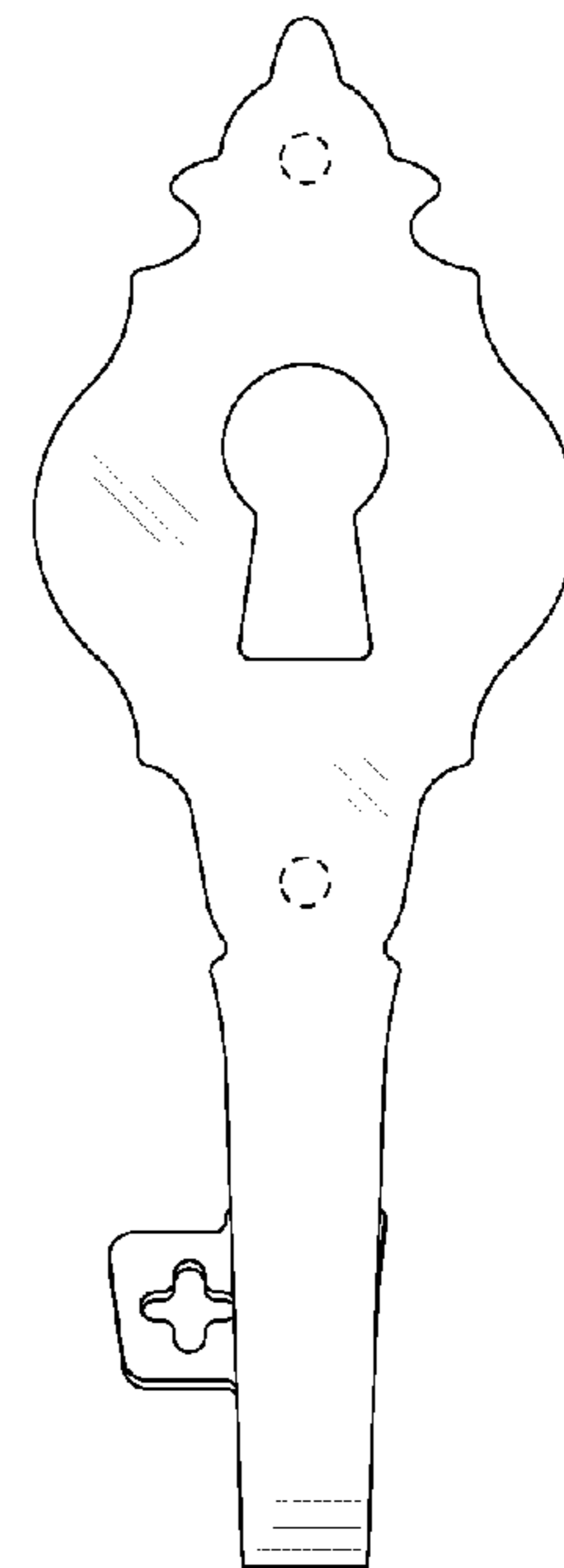

FIG. 6

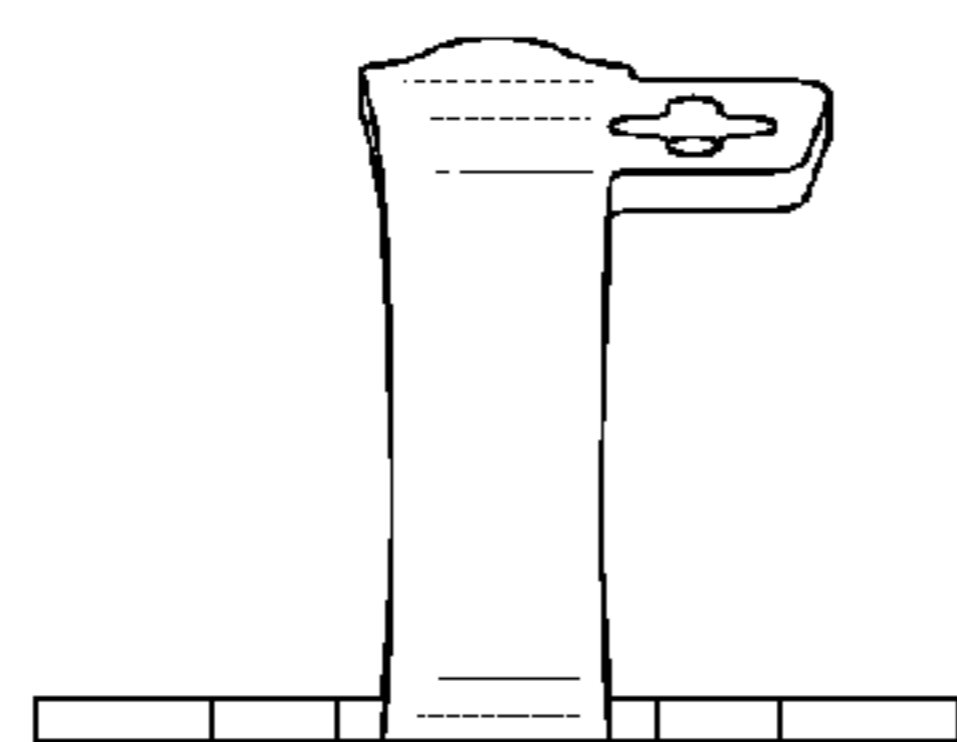

FIG. 7