



US00D629521S

(12) **United States Design Patent**
Lash et al.

(10) **Patent No.:** **US D629,521 S**

(45) **Date of Patent:** **** Dec. 21, 2010**

(54) **INTRAORAL OXIMETER SENSOR**

(75) Inventors: **Robert E. Lash**, Redwood City, CA
(US); **Larry C. Heaton, II**, Pleasanton,
CA (US)

(73) Assignee: **ViOptix, Inc.**, Fremont, CA (US)

(**) Term: **14 Years**

(21) Appl. No.: **29/361,913**

(22) Filed: **May 17, 2010**

(51) **LOC (9) Cl.** **24-01**

(52) **U.S. Cl.** **D24/168**

(58) **Field of Classification Search** D24/107,
D24/158, 161, 167-168, 176, 186; 433/37,
433/114; 378/39, 98.8, 168, 180, 184, 191,
378/170, 197

See application file for complete search history.

(56) **References Cited**

U.S. PATENT DOCUMENTS

4,295,050	A *	10/1981	Linden	378/170
D361,619	S	8/1995	Phleps et al.		
6,320,934	B1	11/2001	Carroll et al.		
6,520,676	B1	2/2003	Schmitz		
6,527,442	B2	3/2003	Carroll		
6,540,399	B1 *	4/2003	Eppinger et al.	378/170
6,652,141	B1	11/2003	Cianciosi		
6,811,312	B2 *	11/2004	Bratslavsky et al.	378/191
6,974,253	B2	12/2005	Ihalainen		
7,210,847	B2	5/2007	Hack		
7,226,208	B2	6/2007	Schmulenson		
D565,184	S	3/2008	Royzen		

7,425,095	B2 *	9/2008	Schmulenson et al.	378/170
7,525,647	B2 *	4/2009	Lash et al.	356/222
7,607,830	B2 *	10/2009	Schmulenson	378/168
7,607,831	B2 *	10/2009	Schmulenson et al.	378/170
D606,656	S	12/2009	Kobayashi et al.		
D618,803	S *	6/2010	Lash et al.	D24/168
2003/0152196	A1	8/2003	Bratslavsky et al.		
2008/0106792	A1	5/2008	Lash et al.		

* cited by examiner

Primary Examiner—Freda S Nunn

Assistant Examiner—Wan Laymon

(74) *Attorney, Agent, or Firm*—Aka Chan LLP

(57) **CLAIM**

The ornamental design for an intraoral oximeter sensor, as shown and described.

DESCRIPTION

FIG. 1 is a bottom perspective view of an intraoral oximeter sensor showing our design.

FIG. 2 is a bottom view thereof.

FIG. 3 is a top view thereof.

FIG. 4 is a right side view thereof.

FIG. 5 is a left side view thereof.

FIG. 6 is a front view thereof; and,

FIG. 7 is a rear view thereof.

The broken line showing portions of an intraoral oximeter sensor is included for the purpose of illustrating environmental structure and forms no part of the claimed design.

1 Claim, 6 Drawing Sheets

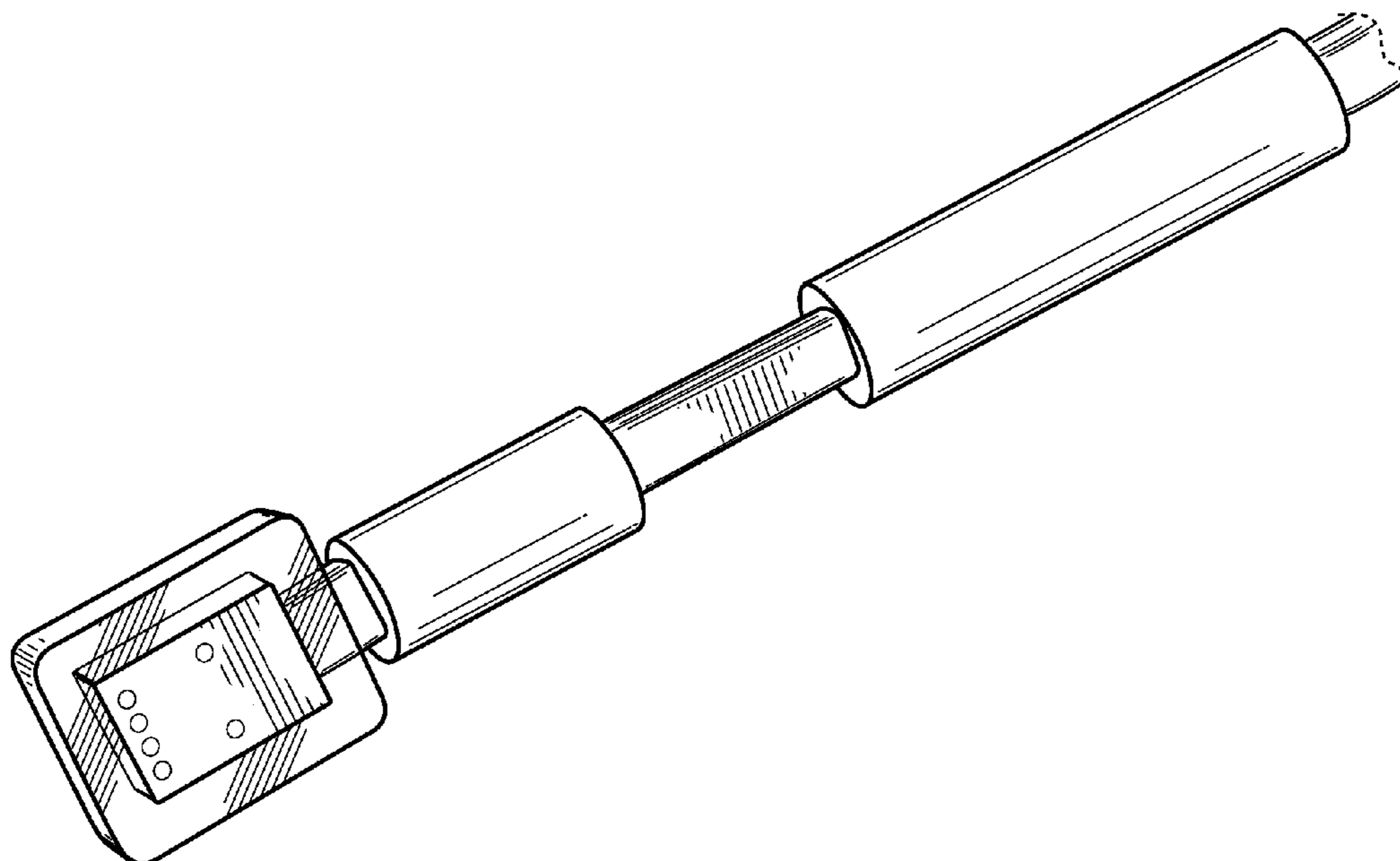

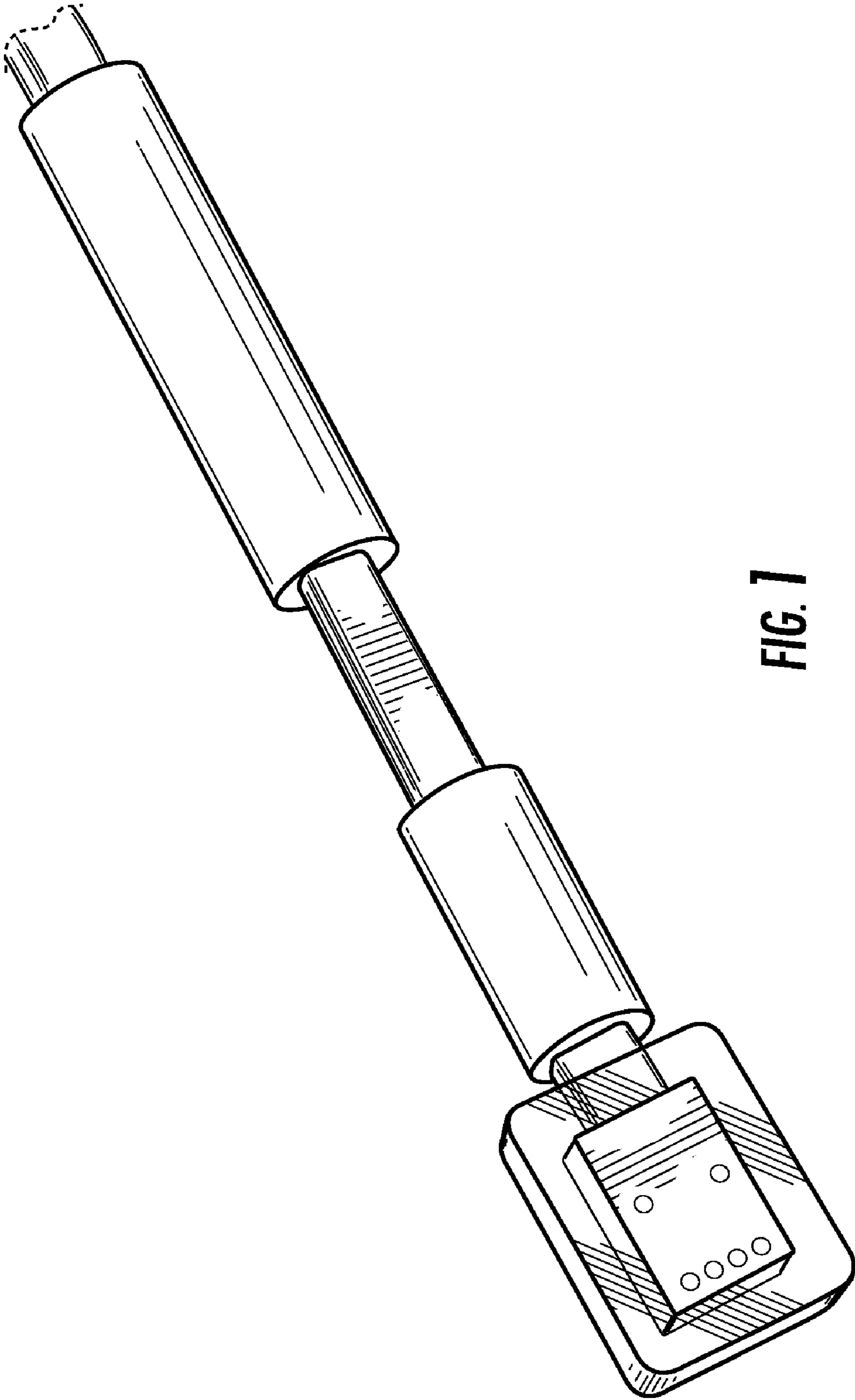

FIG. 1

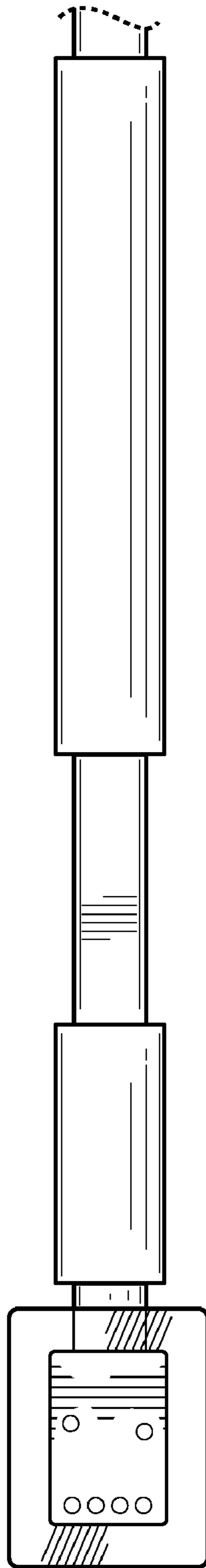

FIG. 2

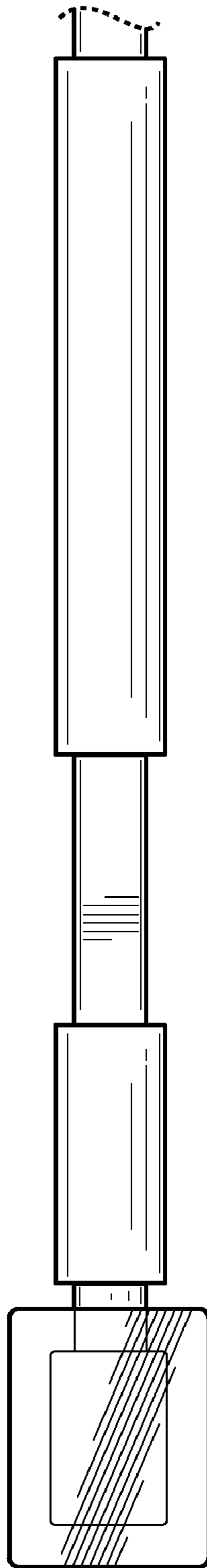

FIG. 3

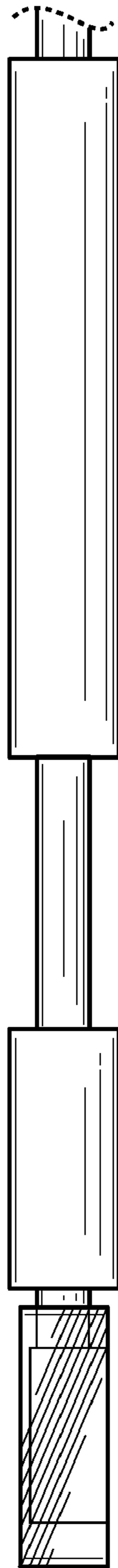

FIG. 4

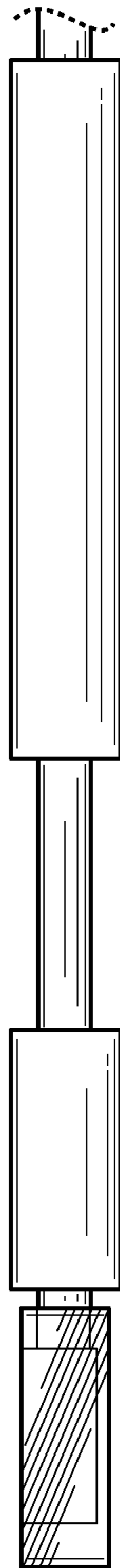

FIG. 5

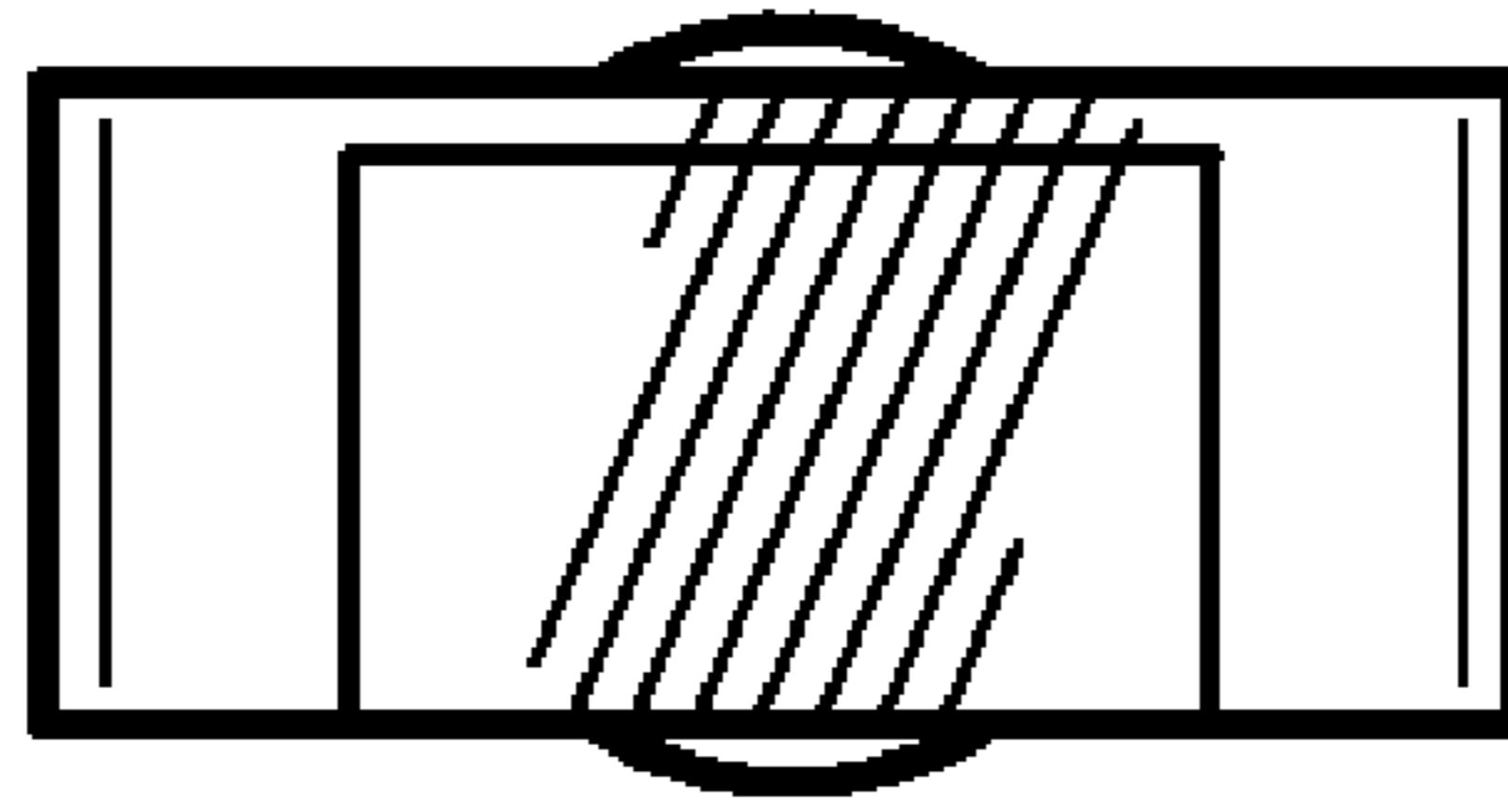

FIG. 6

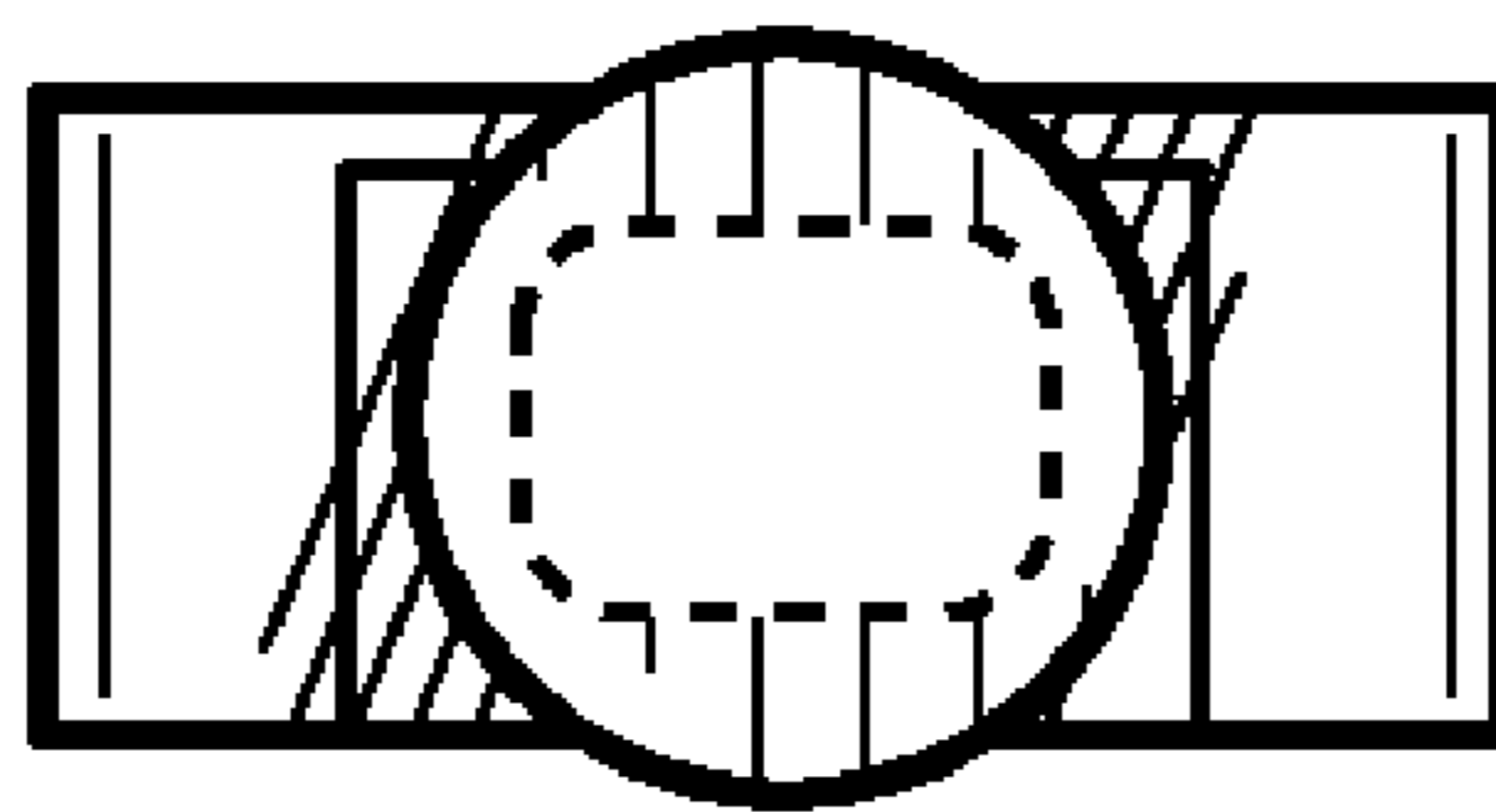

FIG. 7