

US00D629073S

(12) **United States Design Patent**
Madara et al.

(10) **Patent No.:** **US D629,073 S**
(45) **Date of Patent:** **** Dec. 14, 2010**

(54) **PIPE COUPLING SEGMENT**

(75) Inventors: **Scott D. Madara**, Nazareth, PA (US);
Amit R. Shah, Quakertown, PA (US);
Michael V. Porter, Easton, PA (US)

(73) Assignee: **Victaulic Company**, Easton, PA (US)

(**) Term: **14 Years**

(21) Appl. No.: **29/345,570**

(22) Filed: **Oct. 19, 2009**

(51) **LOC (9) Cl.** **23-01**

(52) **U.S. Cl.** **D23/262**

(58) **Field of Classification Search** D23/259–262;
239/428.5; 261/DIG. 22; D8/396; 285/1,
285/112, 179, 340, 367, 373, 404, 53, 915;
403/291, 300; 411/5, 10; 137/801

See application file for complete search history.

(56) **References Cited**

U.S. PATENT DOCUMENTS

| | | | | |
|-----------|-----|---------|---------------|---------|
| 1,027,694 | A | 5/1912 | Corbet | |
| 1,851,574 | A | 3/1932 | Fiederlein | |
| D168,928 | S * | 3/1953 | English | D23/265 |
| 2,752,173 | A | 6/1956 | Krooss | |
| 3,695,638 | A | 10/1972 | Blakeley | |
| 4,218,080 | A | 8/1980 | Kendrick | |
| 4,248,460 | A * | 2/1981 | Murray et al. | 285/363 |
| D287,532 | S * | 12/1986 | Jones et al. | D23/265 |
| 4,738,276 | A | 4/1988 | Adams | |
| 4,966,395 | A | 10/1990 | Hendrickson | |
| 5,058,931 | A * | 10/1991 | Bowsher | 285/112 |
| 5,620,314 | A | 4/1997 | Worton | |
| 6,076,861 | A | 6/2000 | Ikeda | |
| D463,537 | S | 9/2002 | Kozu et al. | |
| 6,547,159 | B1 | 4/2003 | Westby | |
| 6,626,466 | B1 | 9/2003 | Dole | |
| 6,991,268 | B2 | 1/2006 | Spears | |
| 7,086,131 | B2 | 8/2006 | Gibb et al. | |
| 7,090,259 | B2 | 8/2006 | Dole | |
| D558,307 | S | 12/2007 | Gibb et al. | |
| D560,764 | S | 1/2008 | Gibb et al. | |

| | | | | |
|----------|-----|---------|---------------|---------|
| D583,444 | S * | 12/2008 | Nagle et al. | D23/262 |
| D583,914 | S * | 12/2008 | Pierce et al. | D23/262 |
| D583,916 | S * | 12/2008 | Madara et al. | D23/265 |
| D595,813 | S | 7/2009 | Pierce et al. | |
| D595,814 | S | 7/2009 | Pierce et al. | |
| D595,815 | S * | 7/2009 | Pierce et al. | D23/262 |
| D621,916 | S * | 8/2010 | Porter et al. | D23/262 |
| D621,917 | S * | 8/2010 | Madara et al. | D23/262 |

(Continued)

OTHER PUBLICATIONS

Asian Sources Hardware (Apr. 2006), p. 187.

Primary Examiner—T. Chase Nelson

Assistant Examiner—Eric L Goodman

(74) *Attorney, Agent, or Firm*—Ballard Spahr LLP

(57) **CLAIM**

We claim the ornamental design for a pipe coupling segment, as shown and described.

DESCRIPTION

FIG. 1 is an isometric view of our design for a pipe coupling segment;

FIG. 2 is a from view of the design for a pipe coupling segment shown in FIG. 1, the rear view being identical;

FIG. 3 is a top view of the design for a pipe coupling segment shown in FIG. 1 ;

FIG. 4 is a bottom view of the design for a pipe coupling segment shown in FIG. 1; and,

FIG. 5 is a left side view of for the design for a pipe coupling segment shown in FIG. 1, the right side view being identical.

1 Claim, 2 Drawing Sheets

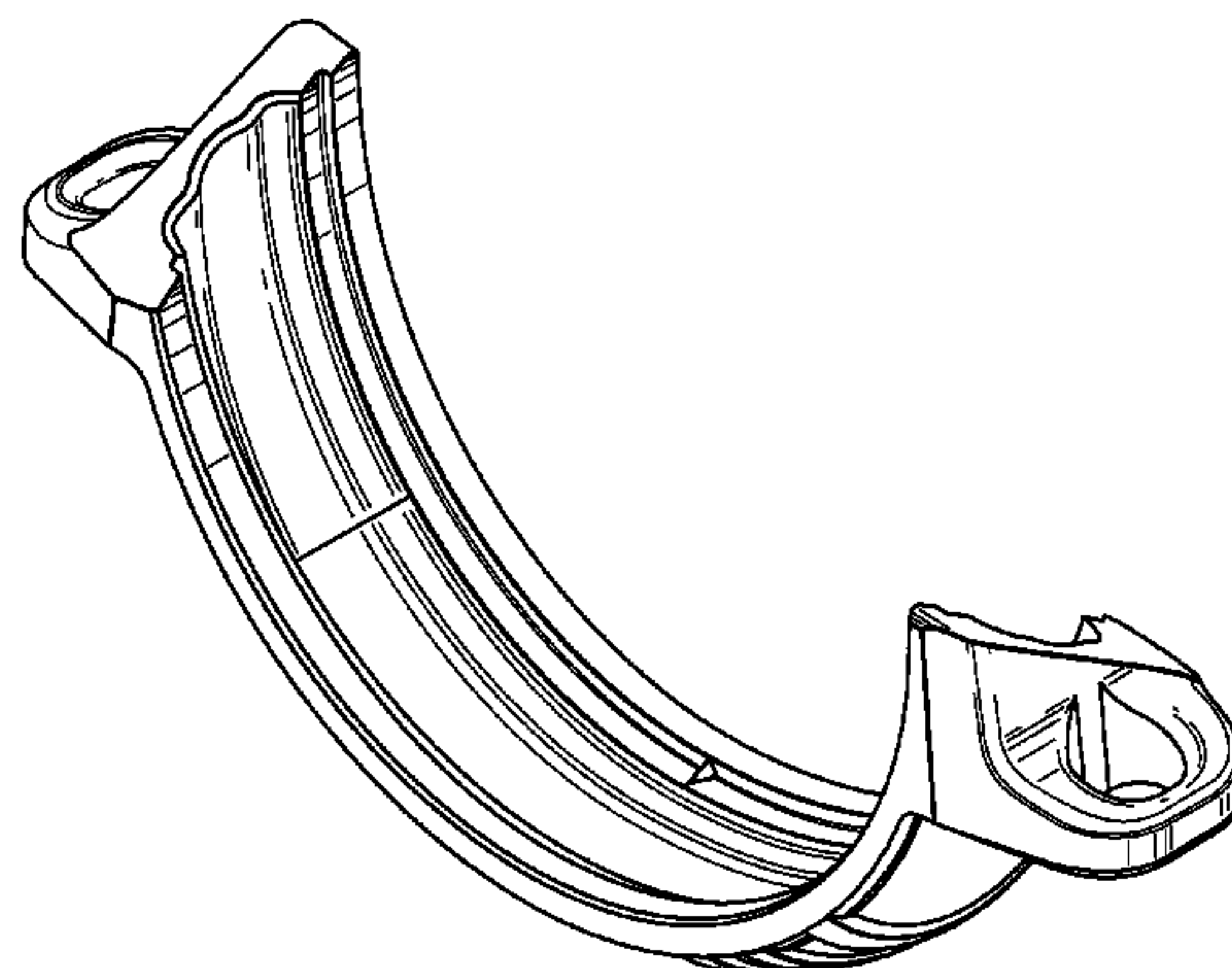

US D629,073 S

Page 2

U.S. PATENT DOCUMENTS

2002/0050718 A1 5/2002 Pyron
2004/0000337 A1 1/2004 Cooper

2008/0017589 A1 1/2008 Taylor
2008/0030026 A1 2/2008 Cho

* cited by examiner

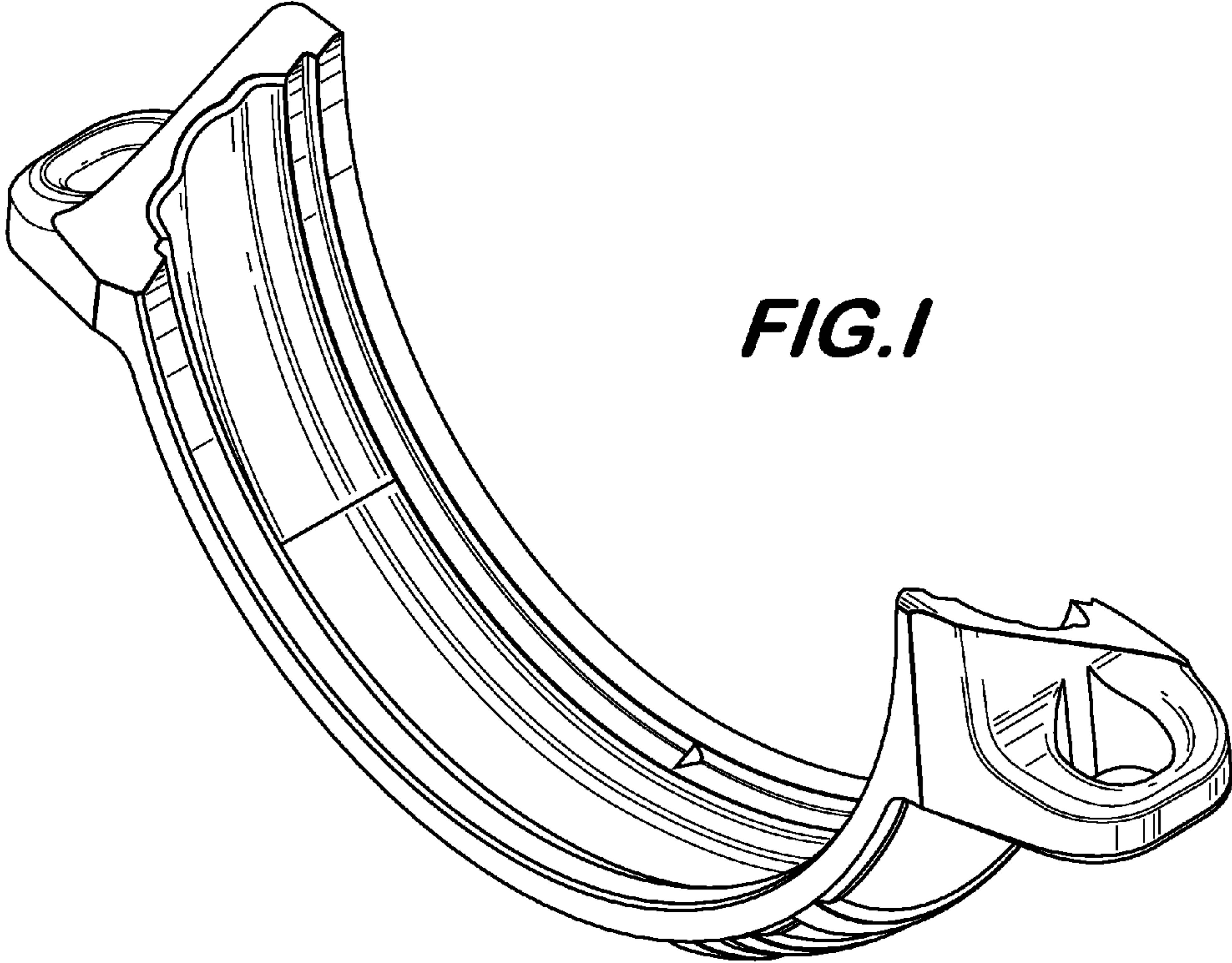

FIG. 1

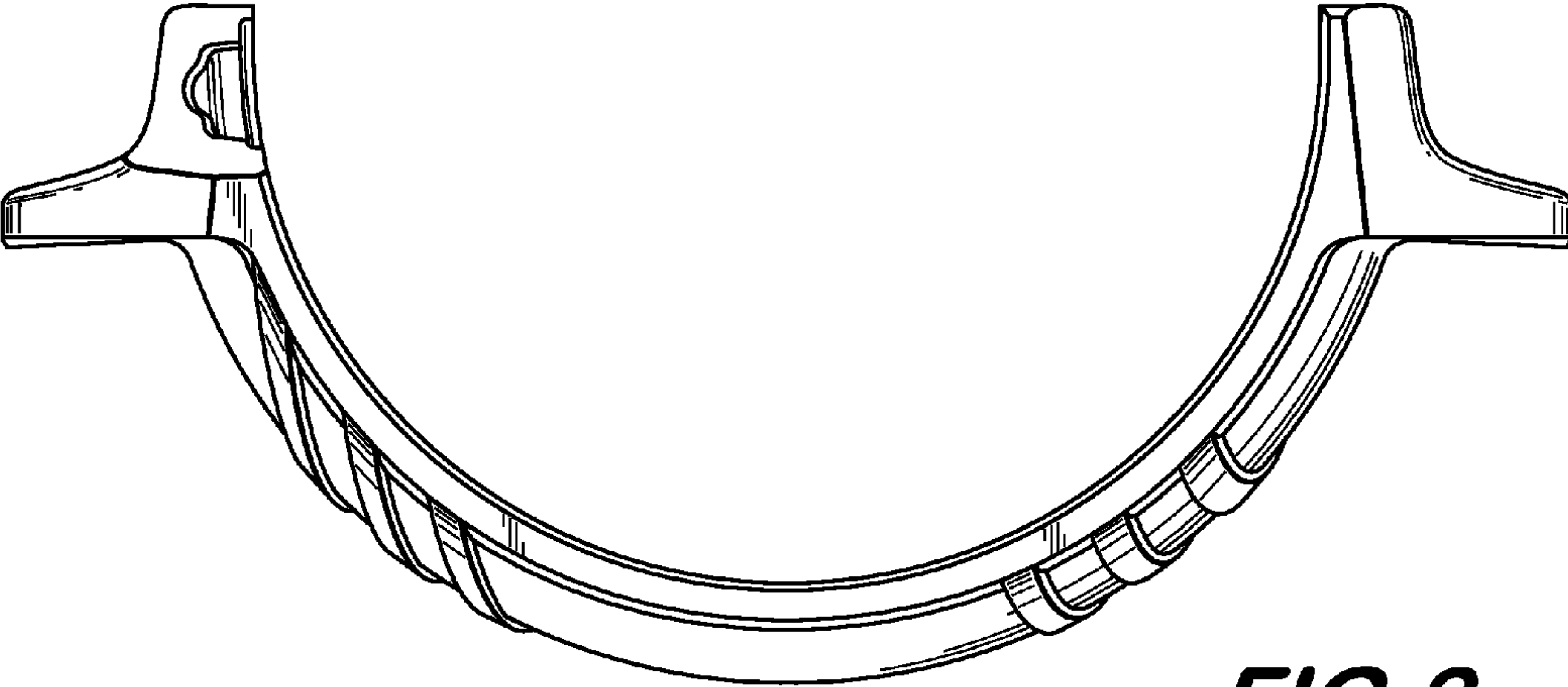

FIG. 2

FIG.3



FIG.4

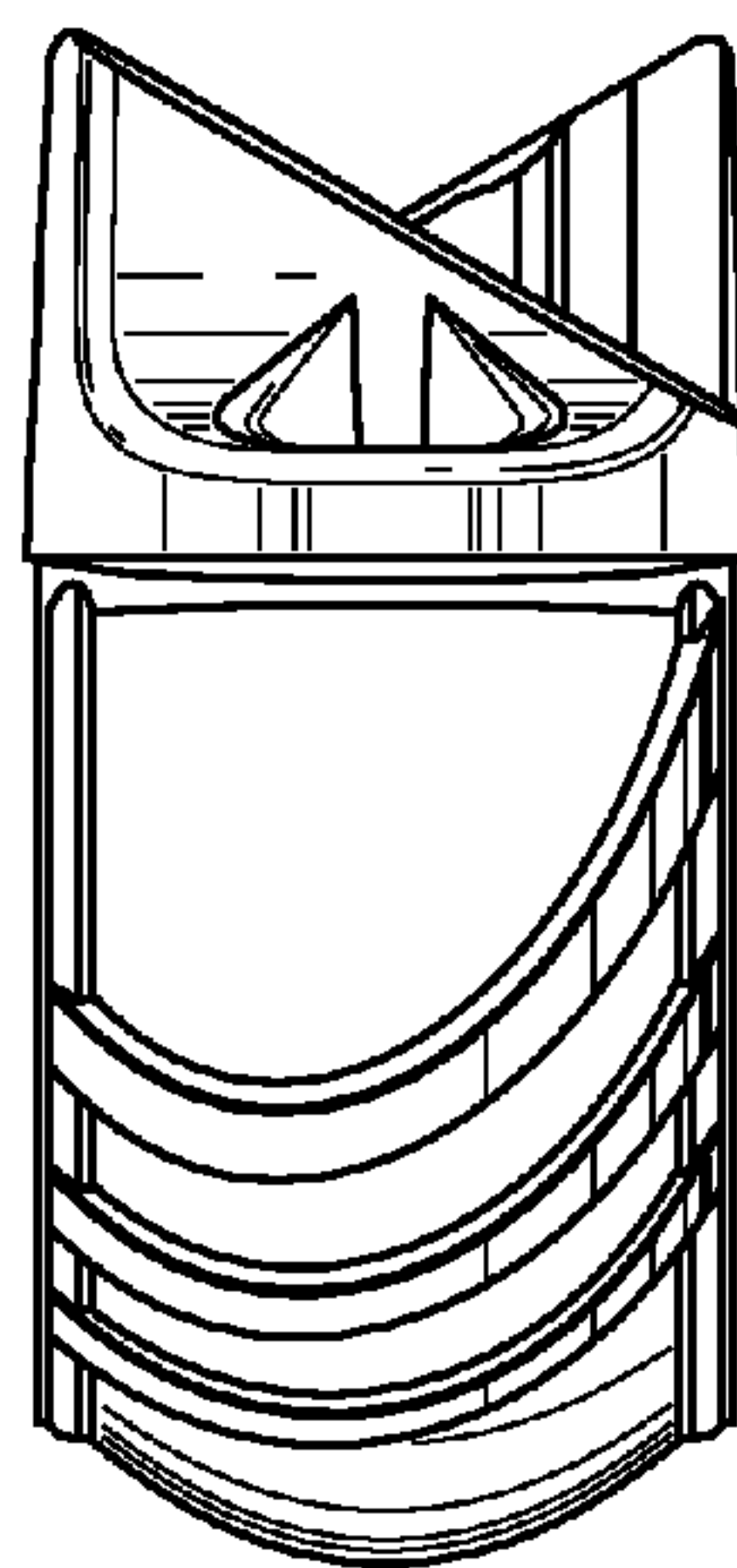
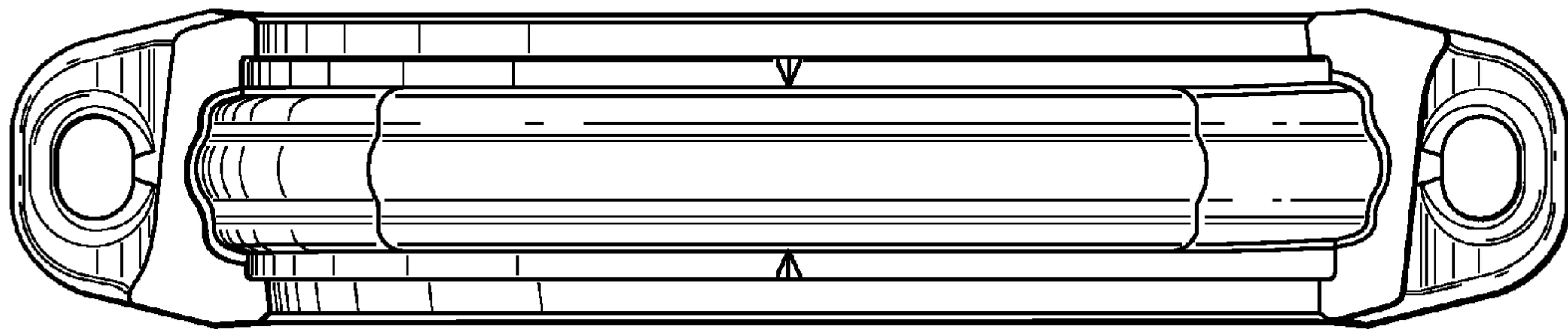

FIG.5