



US00D629014S

(12) **United States Design Patent**
Osumi

(10) **Patent No.:** **US D629,014 S**
(45) **Date of Patent:** **** Dec. 14, 2010**

(54) **INTERNAL-COMBUSTION ENGINE**

D583,829 S * 12/2008 Fan D15/1

(75) Inventor: **Masayuki Osumi**, Saitama (JP)

* cited by examiner

(73) Assignee: **Honda Motor Co., Ltd.**, Tokyo (JP)

Primary Examiner—T. Chase Nelson
Assistant Examiner—Ania K Dworzecka

(**) Term: **14 Years**

(74) *Attorney, Agent, or Firm*—Westerman, Hattori, Daniels & Adrian, LLP

(21) Appl. No.: **29/360,780**

(57) **CLAIM**

(22) Filed: **Apr. 30, 2010**

The ornamental design for, an internal-combustion engine, as shown and described.

(30) **Foreign Application Priority Data**

Oct. 30, 2009 (JP) 2009-025562

DESCRIPTION

(51) **LOC (9) Cl.** **15-01**

FIG. 1 is a first perspective view of an internal-combustion engine, showing our new design;

(52) **U.S. Cl.** **D15/1**

FIG. 2 is a second perspective view thereof;

(58) **Field of Classification Search** D15/1,
D15/2, 3, 5, 6, 14, 17, 149; 123/22, 41.34,
123/51 A, 606 R, 52.1, 50 A, 50 B, 54.1,
123/54.2, 54.4, 54.5, 65 R, 195 R, 195 HC,
123/657, 311

FIG. 3 is a third perspective view thereof;

FIG. 4 is a front elevation view thereof;

See application file for complete search history.

FIG. 5 is a rear elevation view thereof;

FIG. 6 is a top plan view thereof;

FIG. 7 is a bottom plan view thereof;

(56) **References Cited**

U.S. PATENT DOCUMENTS

D529,046 S * 9/2006 Maeda et al. D15/1
D536,004 S * 1/2007 Ryczek et al. D15/5
D576,638 S * 9/2008 Busschaert D15/1
D579,026 S * 10/2008 Busschaert D15/1
D581,431 S * 11/2008 Shimomura D15/5

FIG. 8 is a right side elevation view thereof; and,

FIG. 9 is a left side elevation view thereof.

The broken lines are for illustrative purposes only and form no part of the claimed design.

1 Claim, 9 Drawing Sheets

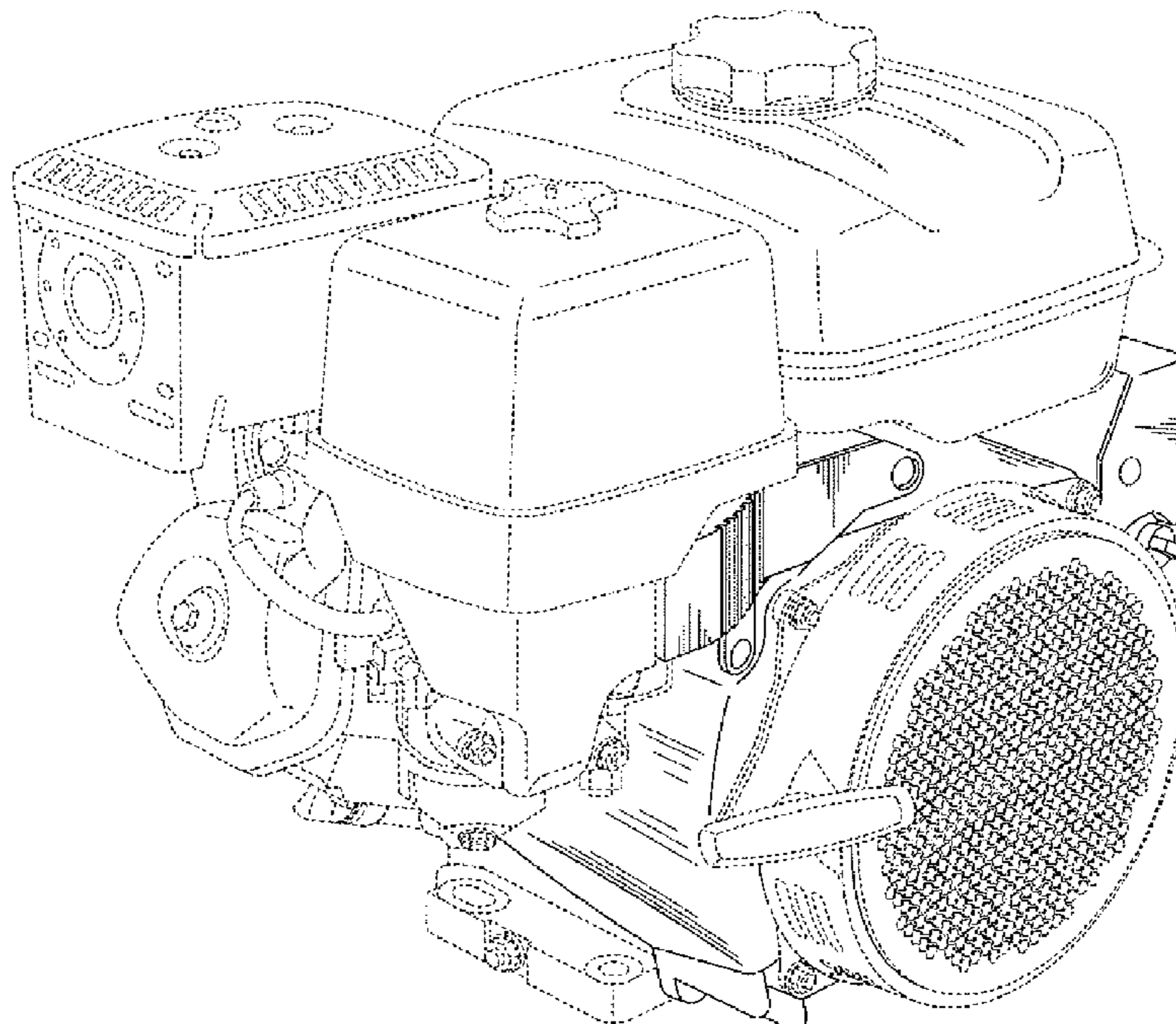

Fig. 1

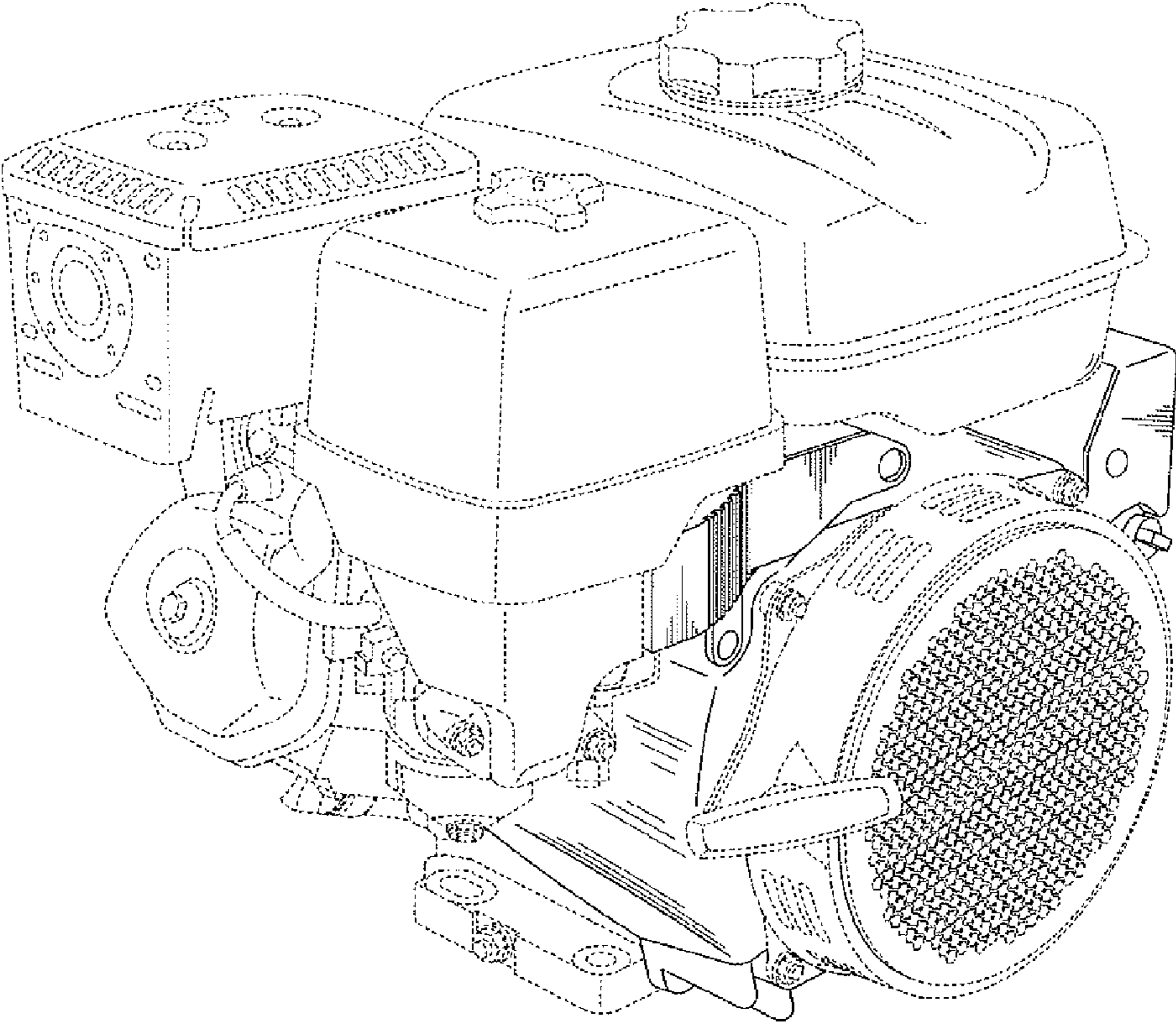

Fig. 2

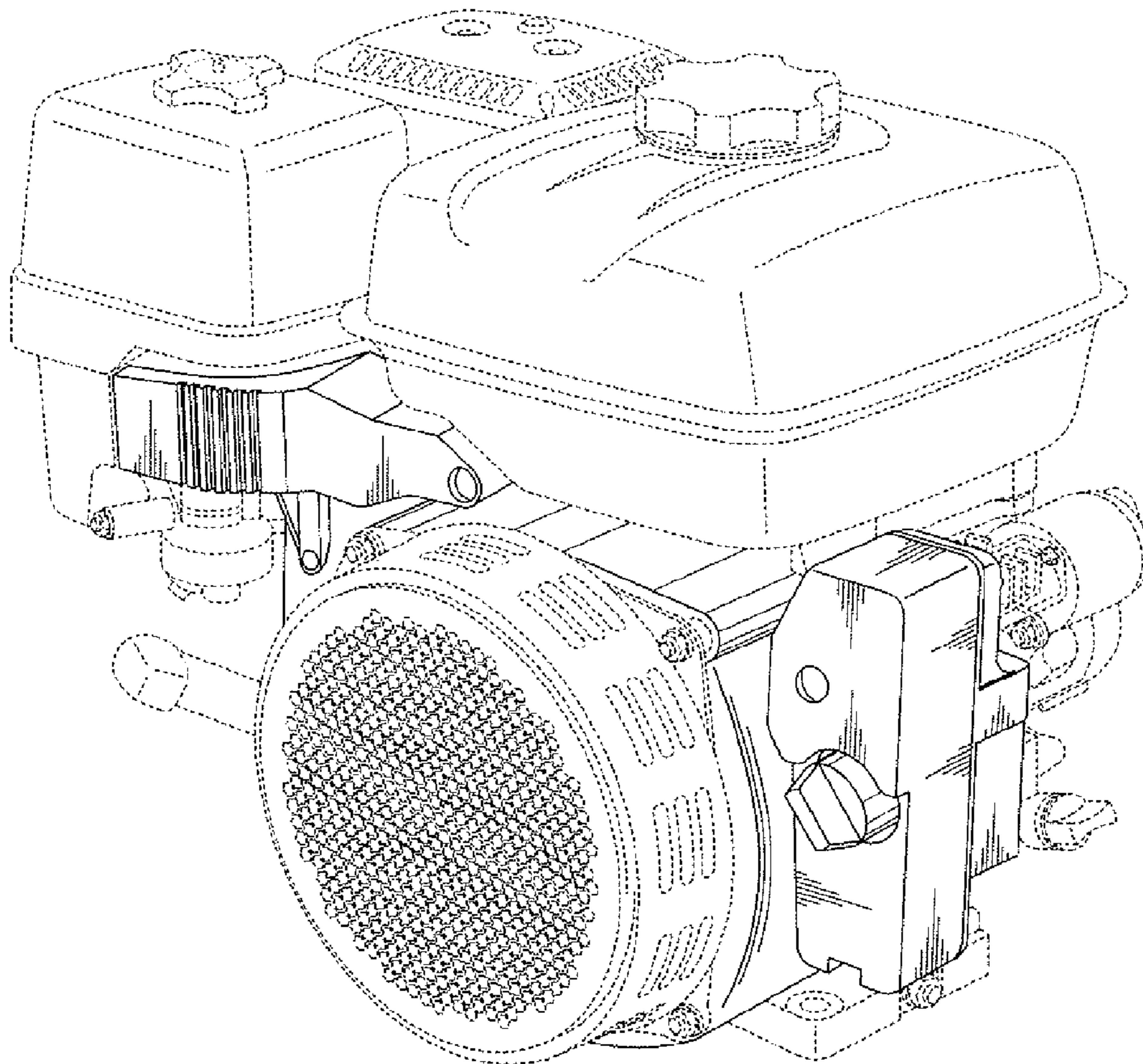

Fig. 3

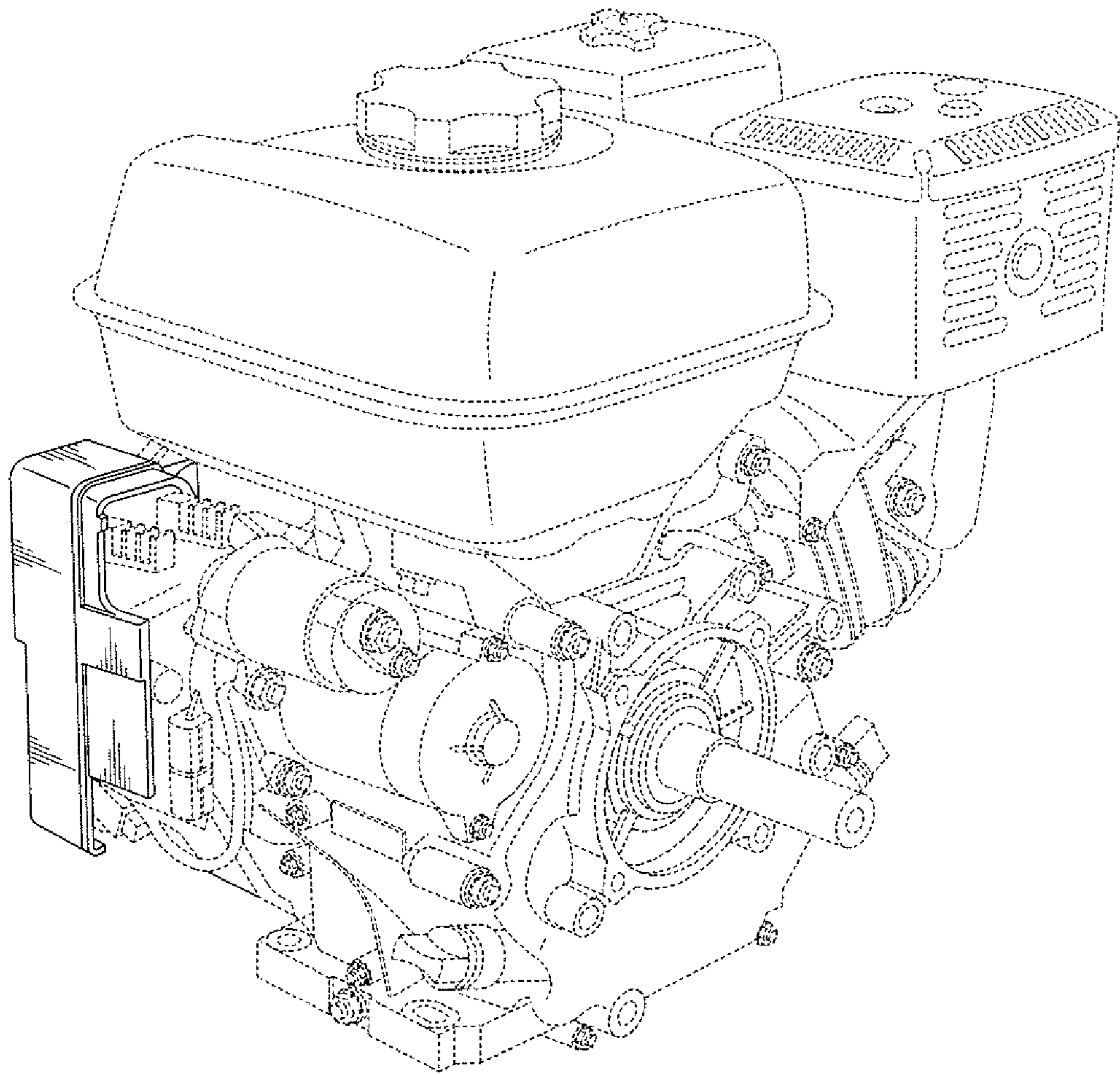

Fig. 4

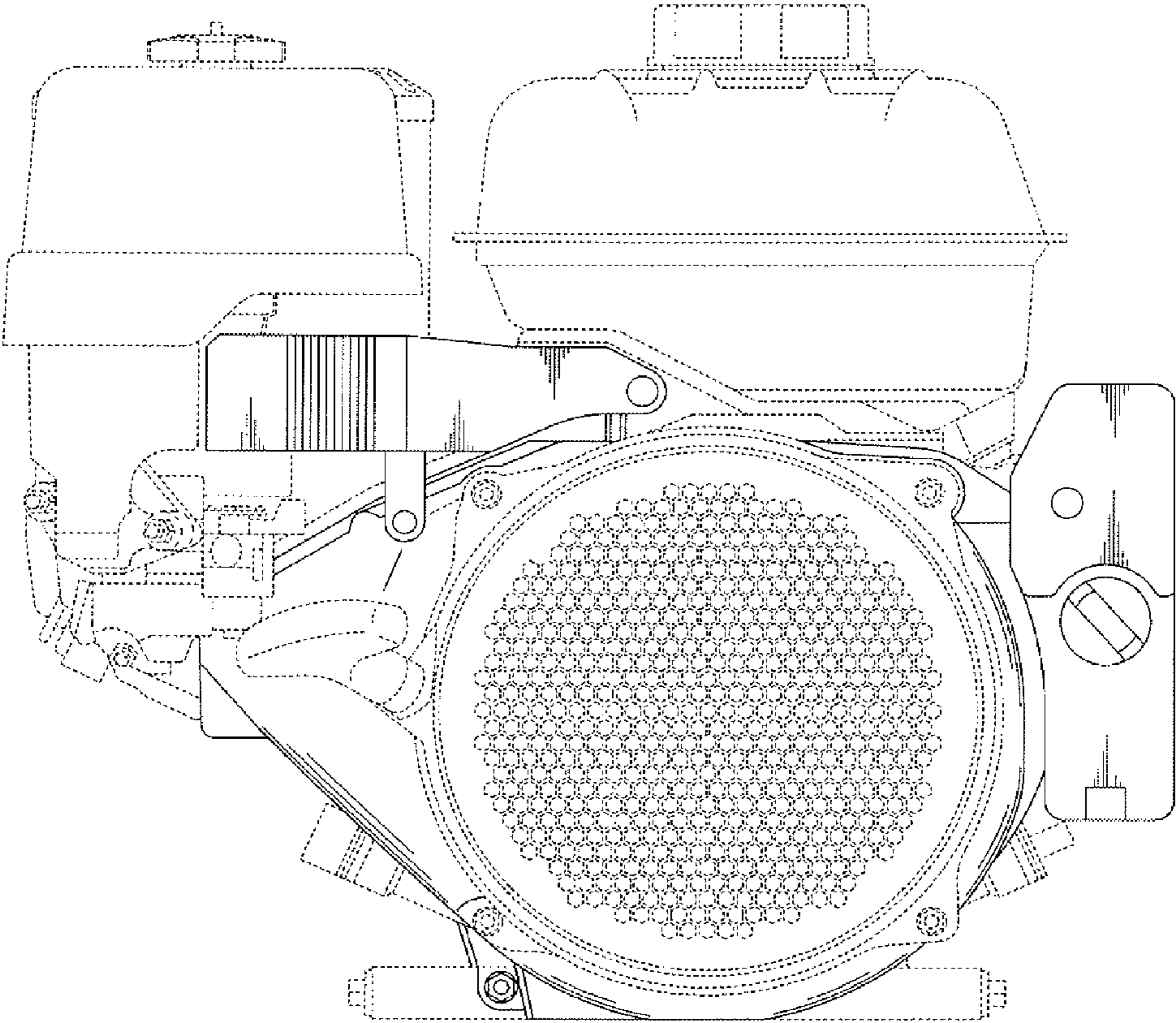

Fig. 5

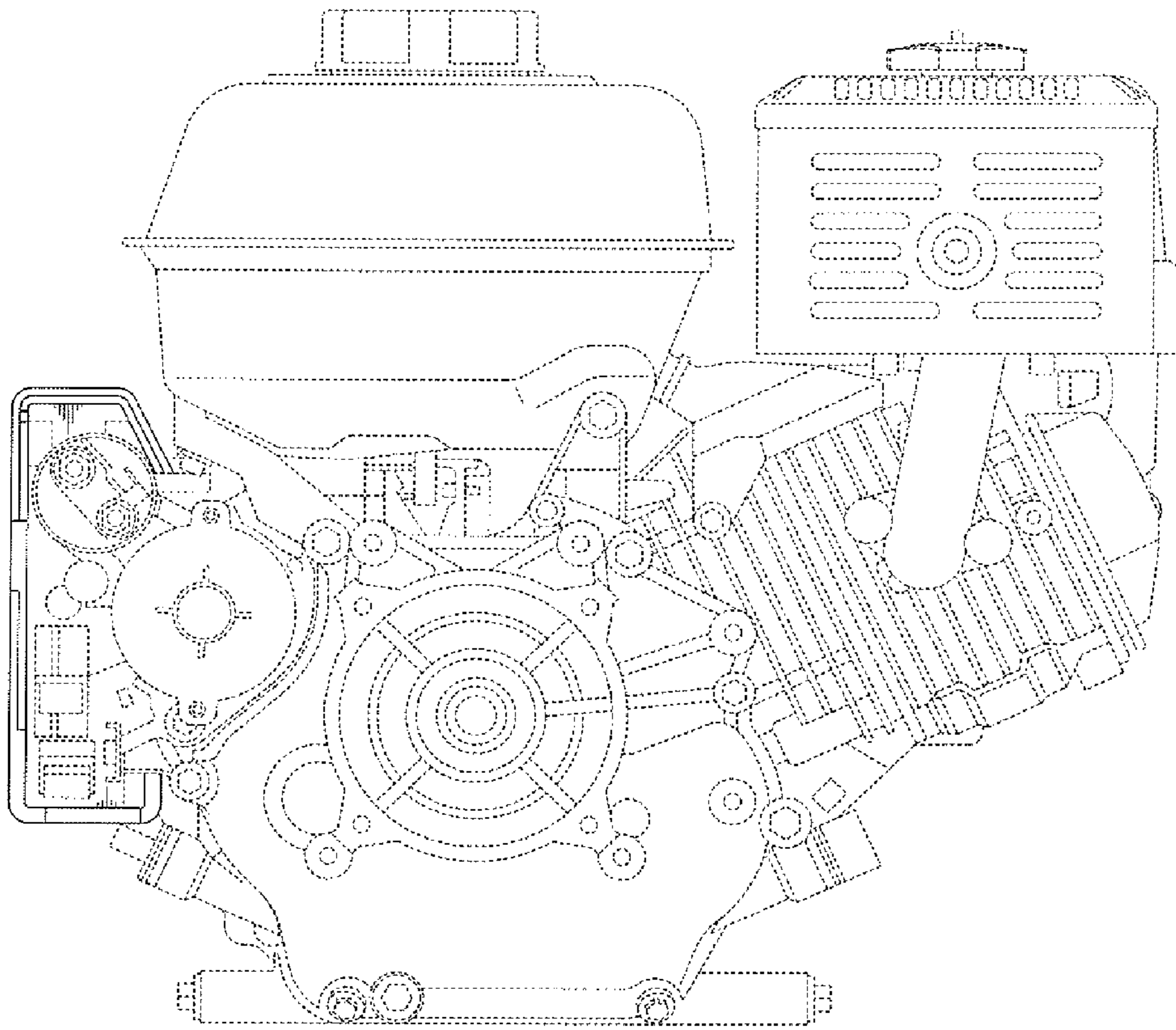

Fig. 6

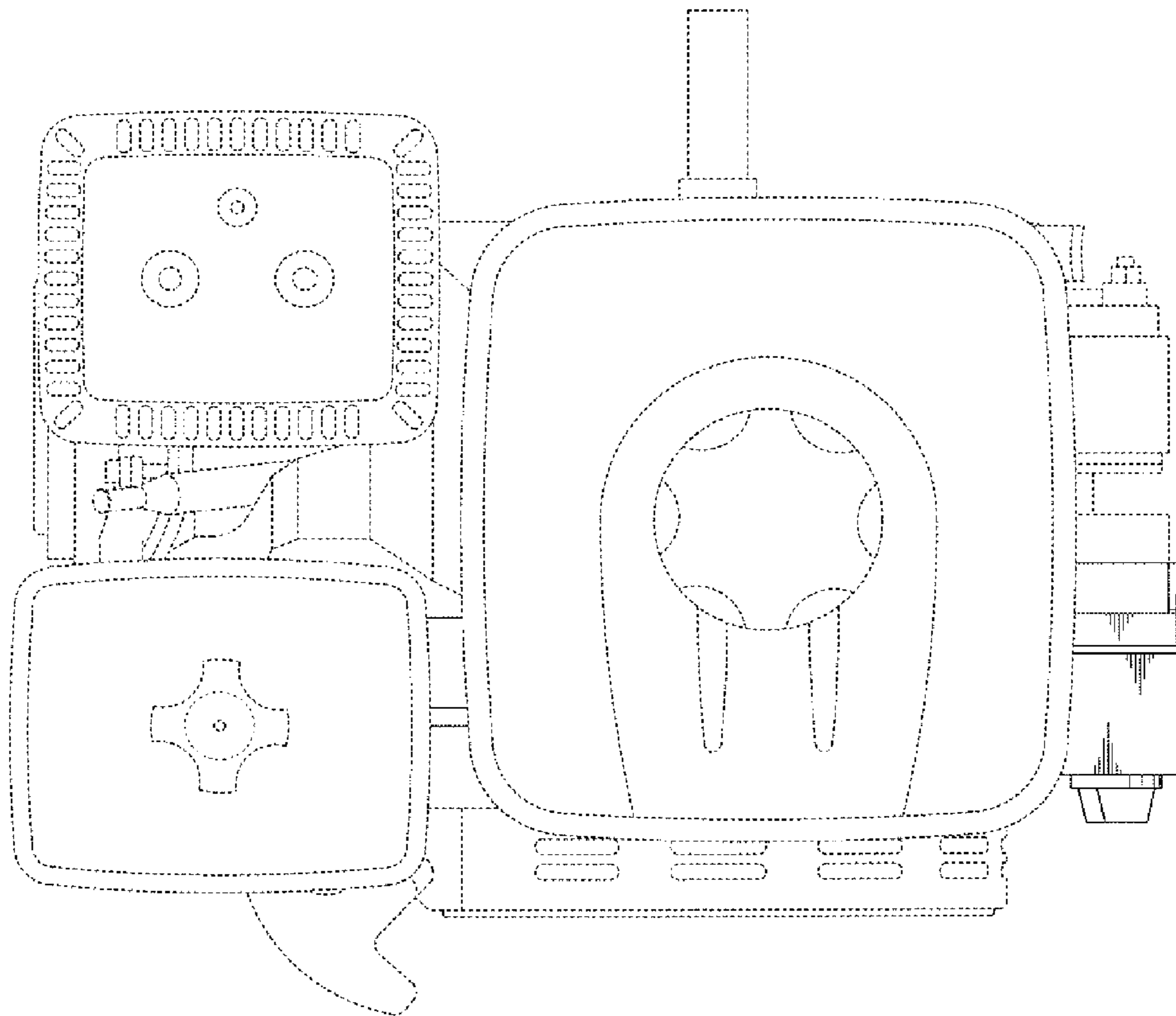

Fig. 7

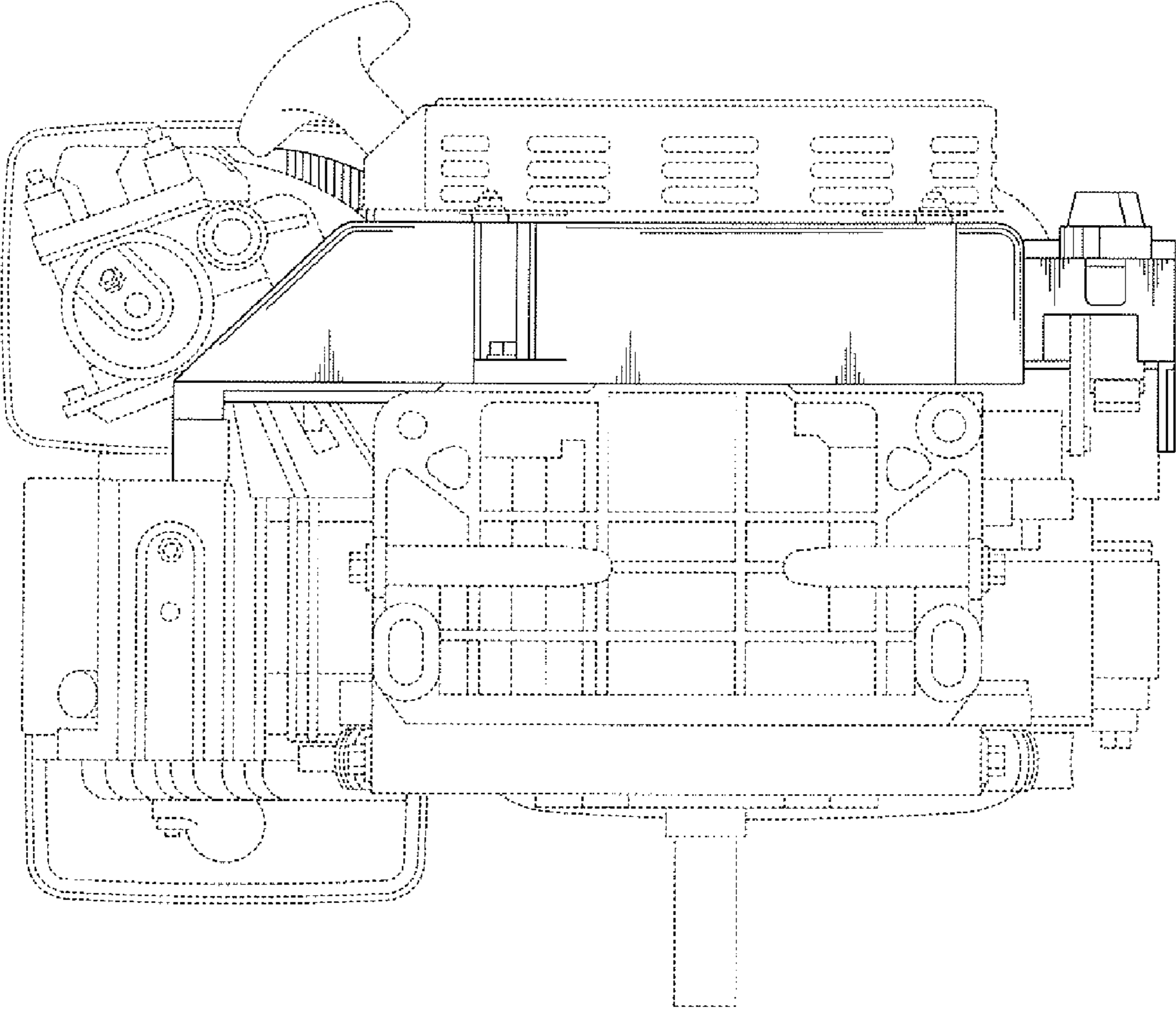

Fig. 8

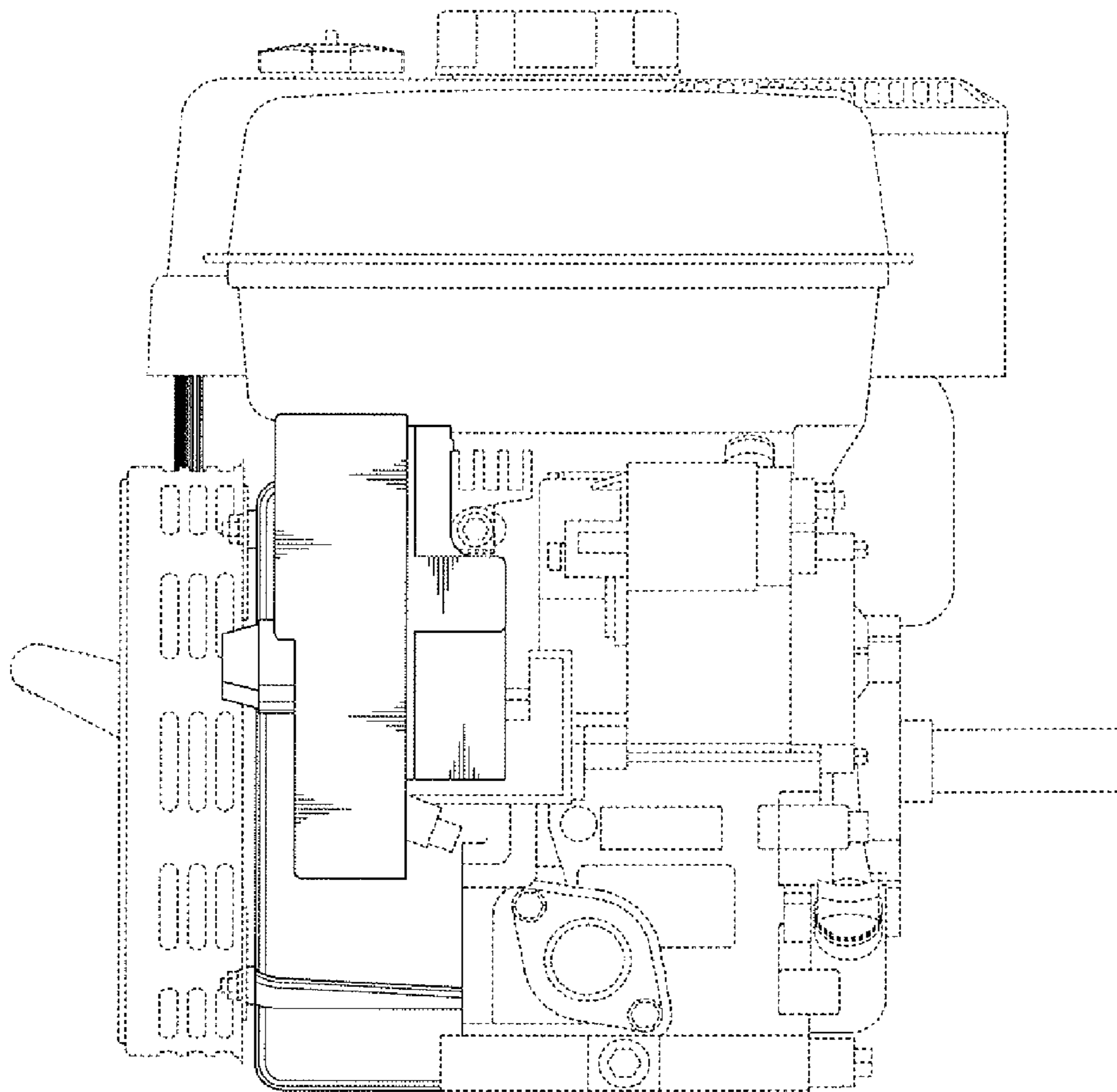

Fig. 9

