



US00D628601S

(12) **United States Design Patent**
Muraoka et al.

(10) **Patent No.:** **US D628,601 S**
(45) **Date of Patent:** **** Dec. 7, 2010**

(54) **ELECTRICAL CONTROL DEVICE**
(75) Inventors: **Hideyasu Muraoka**, Akashi (JP);
Hiroshi Itoh, Kobe (JP)
(73) Assignee: **Kabushiki Kaisha Kawasaki Precision Machinery**, Kobe-shi (JP)

D464,007 S * 10/2002 Ligneau D12/179
D481,658 S * 11/2003 Ryan et al. D12/179
D491,958 S * 6/2004 Holma D15/28
D498,188 S * 11/2004 Ligneau D12/179
D498,189 S * 11/2004 Ligneau D12/179
D499,121 S * 11/2004 Masalin D15/28

(**) Term: **14 Years**
(21) Appl. No.: **29/343,815**
(22) Filed: **Sep. 18, 2009**

(Continued)

Primary Examiner—Mark A Goodwin
(74) *Attorney, Agent, or Firm*—Alleman Hall McCoy Russell & Tuttle LLP

(30) **Foreign Application Priority Data**
Mar. 19, 2009 (JP) 2009-006197
Mar. 19, 2009 (JP) 2009-006198

(57) **CLAIM**

The ornamental design for an electrical control device, as shown and described.

(51) **LOC (9) Cl.** **15-03**
(52) **U.S. Cl.** **D15/28**
(58) **Field of Classification Search** D15/17,
D15/28; D12/179, 174; D8/8; D34/35;
D21/324, 328, 333; D14/412–416, 400,
D14/401; 74/491, 519, 523, 475, 489, 473.1,
74/471 XY; 56/13.3, 202; 273/148 B; 463/38,
463/46; 345/161

DESCRIPTION

FIG. 1 is a front view of an electrical control device showing our new design.
FIG. 2 is a top plan view thereof.
FIG. 3 is a bottom plan view thereof.
FIG. 4 is a left side view thereof.
FIG. 5 is a right side view thereof.
FIG. 6 is a right perspective view thereof.
FIG. 7 is a cross-sectional view thereof taken along line 7—7 of FIG. 1.
FIG. 8 is a cross-sectional view thereof taken along line 8—8 of FIG. 1.
FIG. 9 is a left perspective view thereof shown in use condition; and,
FIG. 10 is a reduced left side view shown in use condition.
The dashed lines in FIGS. 1-8 illustrate an electrical control device housing, and form no part of the claimed design. The dashed lines in FIG. 9 illustrate a joystick, and form no part of the claimed design. The dashed lines in FIG. 10 illustrate a joystick and chair, and form no part of the claimed design.

See application file for complete search history.

(56) **References Cited**
U.S. PATENT DOCUMENTS

D282,156 S * 1/1986 Le Vier D12/174
D320,589 S * 10/1991 Kelley et al. D12/179
D331,932 S * 12/1992 Lenski et al. D15/28
D334,415 S * 3/1993 Carter et al. D14/401
D362,330 S * 9/1995 Avitan et al. D34/35
D365,576 S * 12/1995 Butkovich et al. D15/29
D366,910 S * 2/1996 Hsieh D14/412
D382,865 S * 8/1997 Jensen D14/412
5,805,256 A * 9/1998 Miller 348/734
D418,097 S * 12/1999 Leschke et al. D12/179
D419,570 S * 1/2000 Blondeel et al. D15/29
D450,702 S * 11/2001 Sagawa et al. D14/412
D454,569 S * 3/2002 Osborn et al. D14/412
D463,457 S * 9/2002 Nagatsuka D15/28

1 Claim, 5 Drawing Sheets

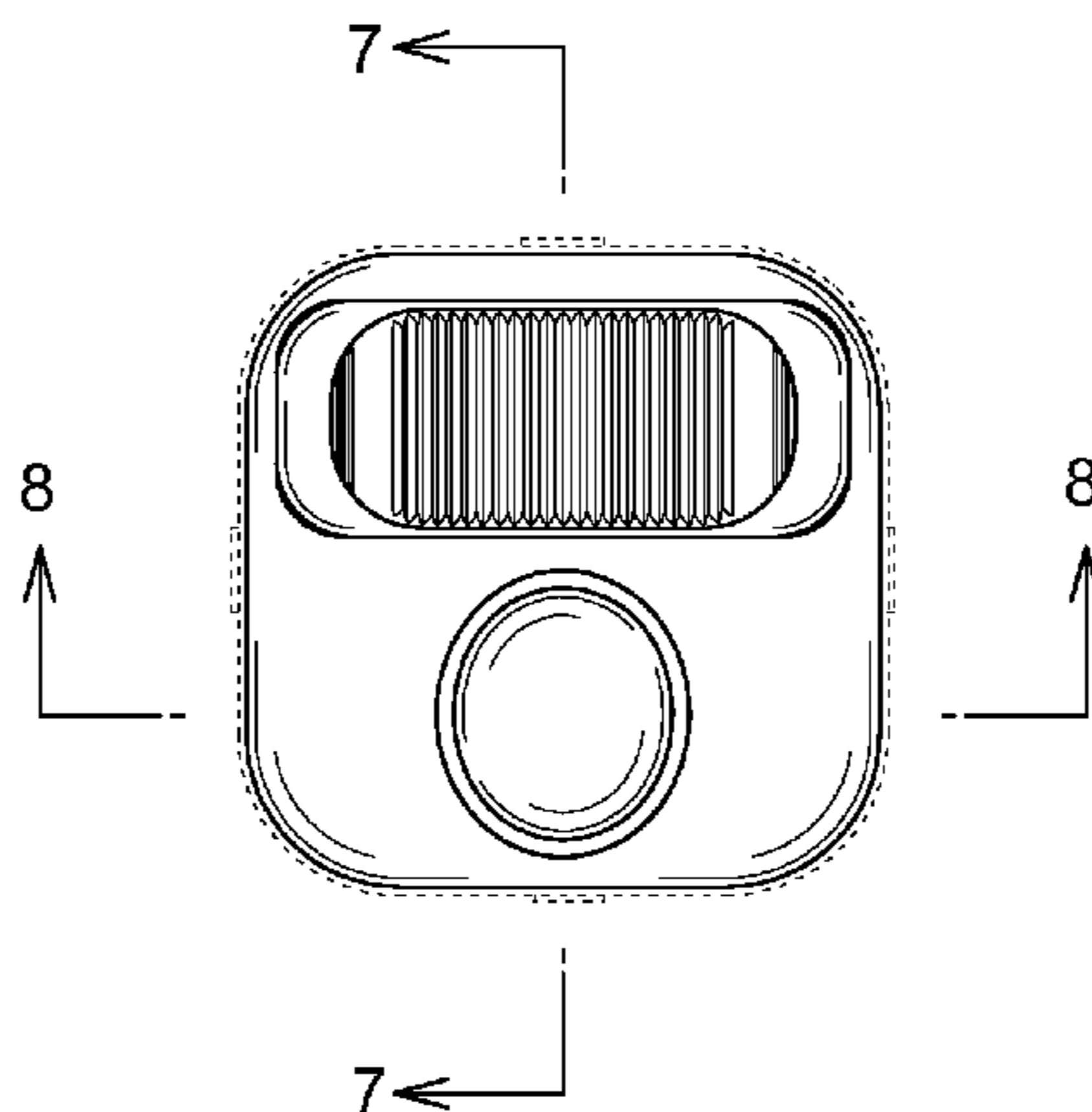

US D628,601 S

Page 2

U.S. PATENT DOCUMENTS

D516,096 S *	2/2006	Bergman et al.	D15/28	D566,132 S *	4/2008	Mack	D15/11
D531,942 S *	11/2006	Chanteloup	D12/179	D590,848 S *	4/2009	Umeda et al.	D15/28
D537,393 S *	2/2007	Chanteloup	D12/179	D595,744 S *	7/2009	Umeda et al.	D15/28
D537,394 S *	2/2007	Chanteloup	D12/179	D606,100 S *	12/2009	Kobayashi et al.	D15/28
D541,824 S *	5/2007	Yanagida et al.	D15/28	D606,566 S *	12/2009	Kobayashi et al.	D15/28
D559,749 S *	1/2008	Barbieri	D12/179	D606,567 S *	12/2009	Kobayashi et al.	D15/28

* cited by examiner

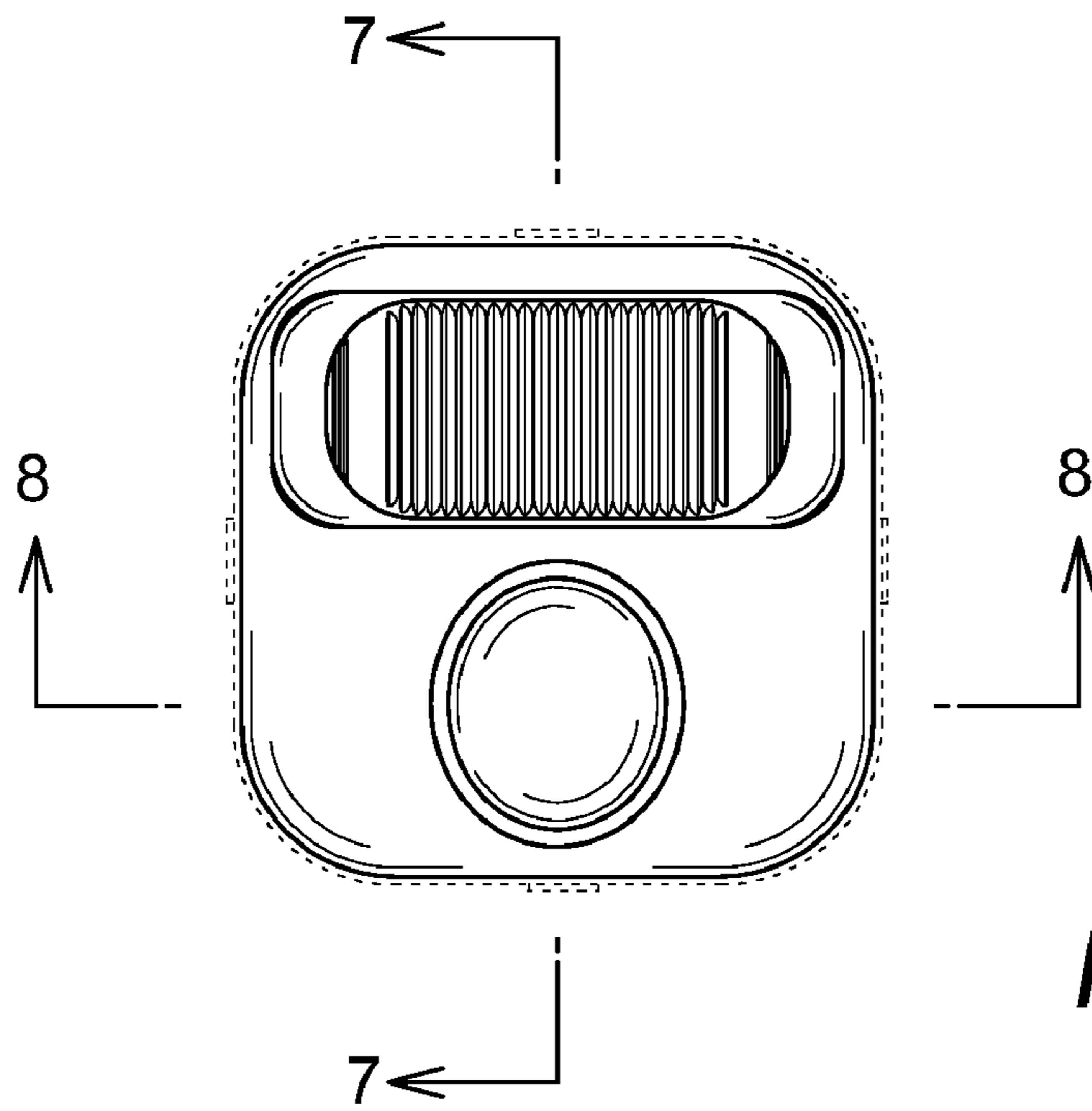

FIG. 1

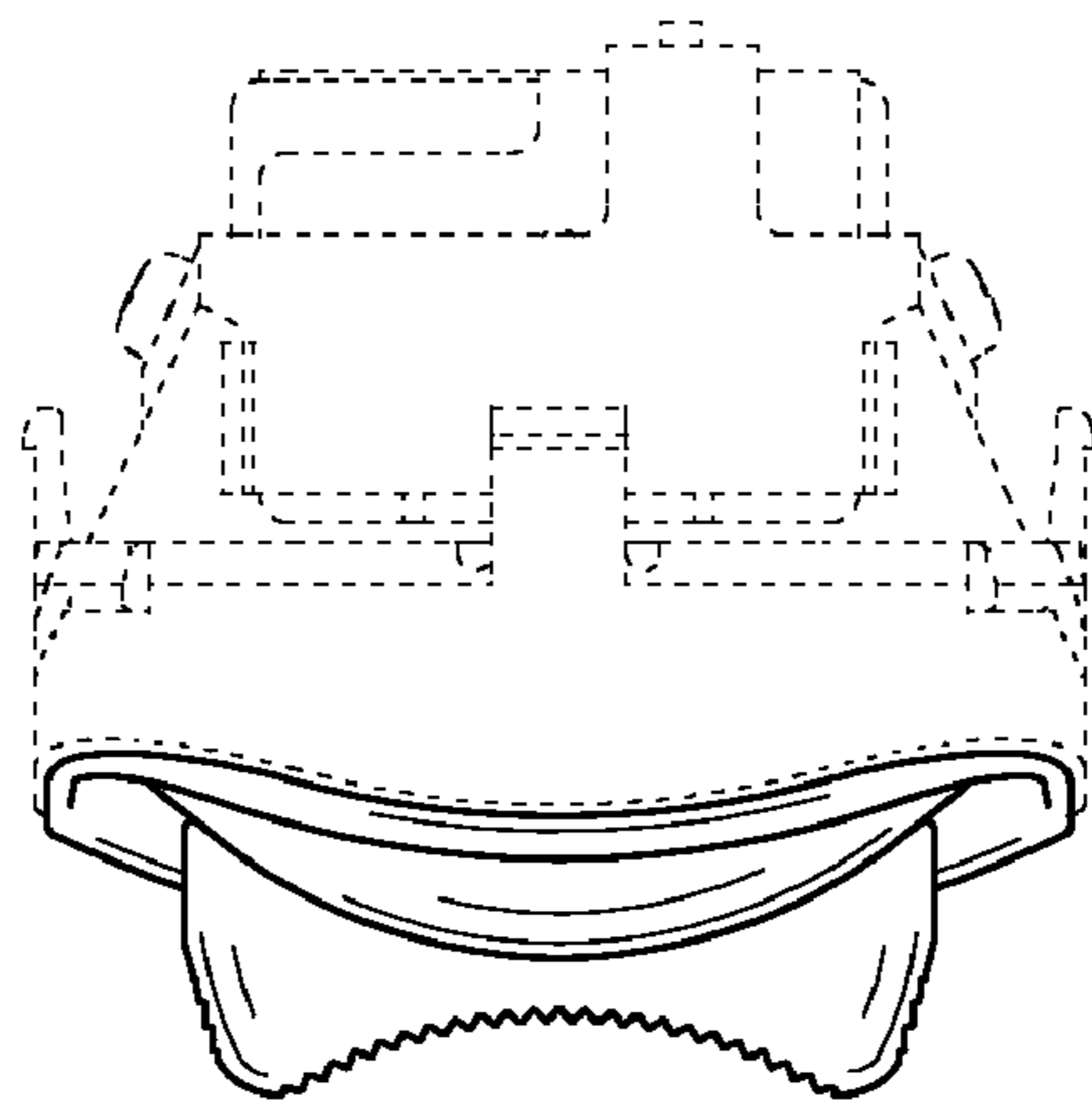

FIG. 2

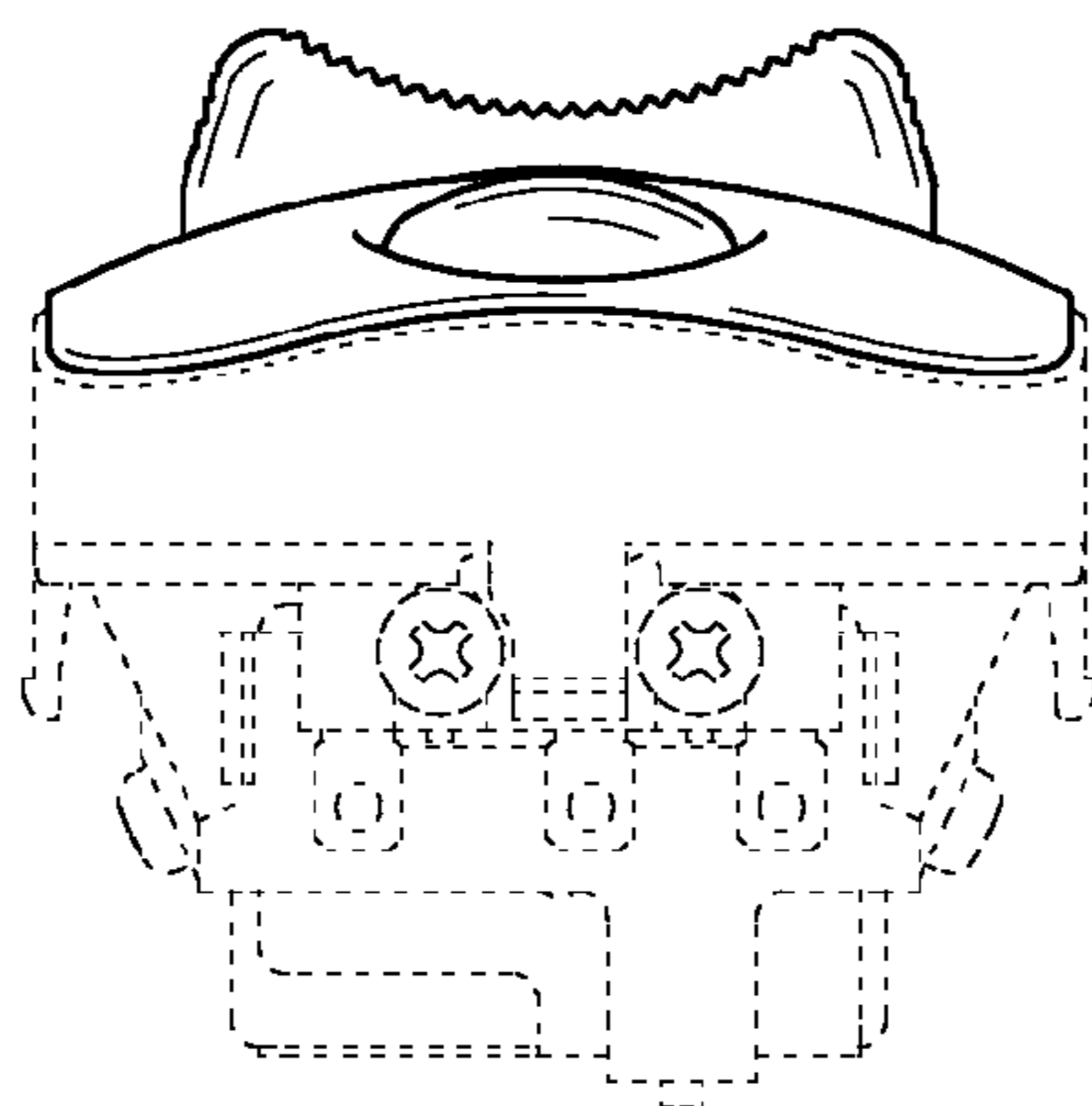

FIG. 3

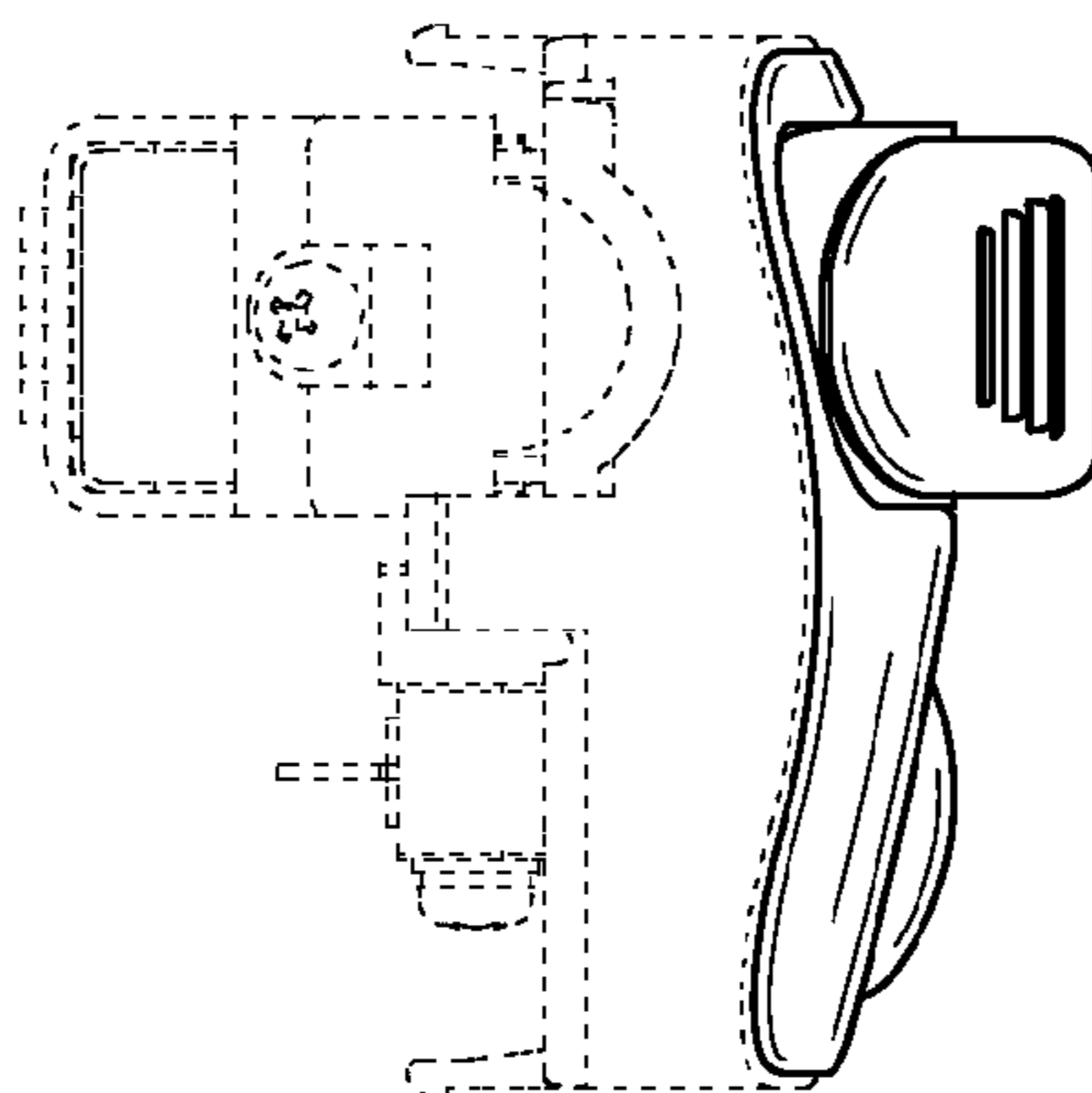

FIG. 4

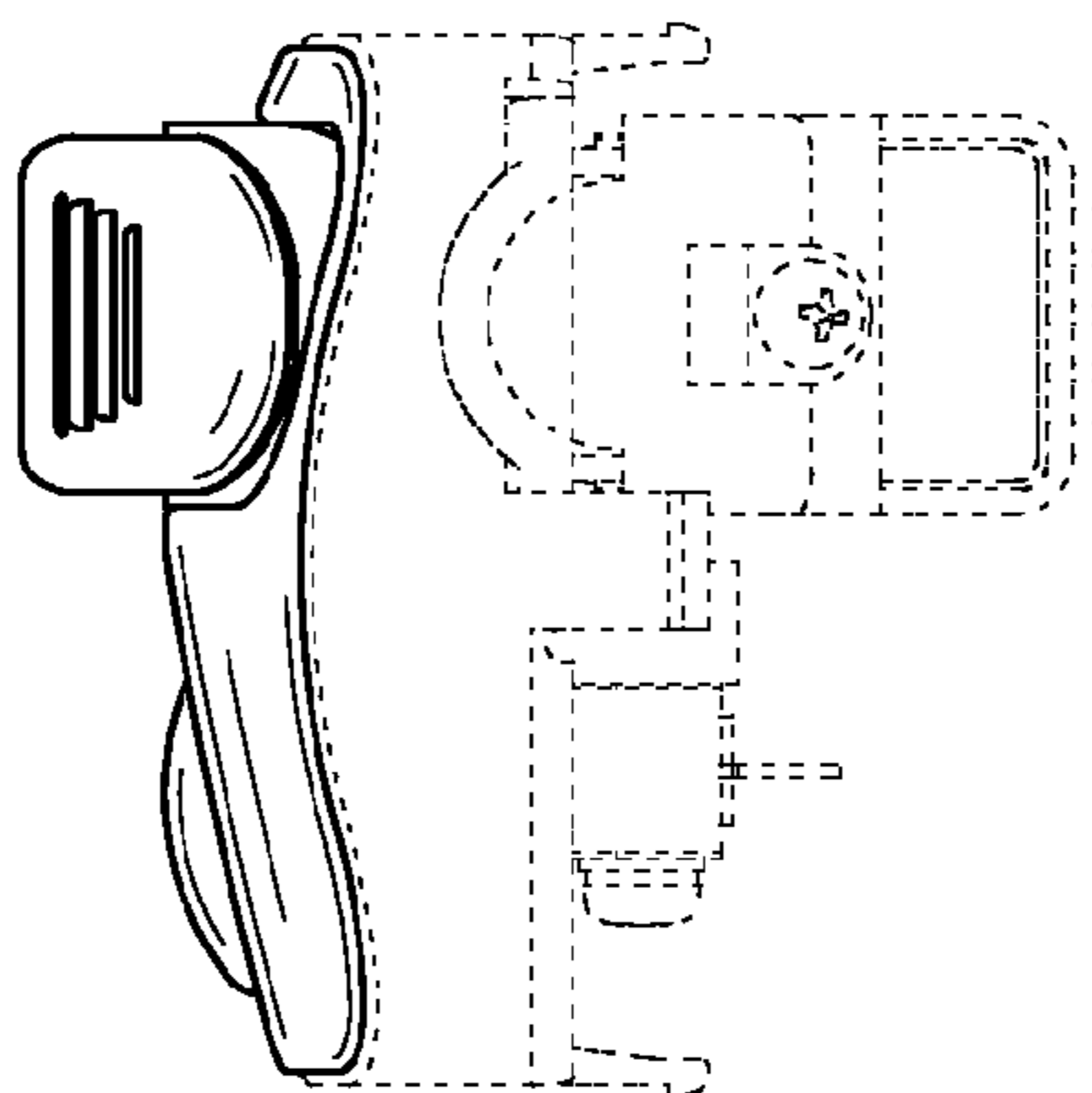

FIG. 5

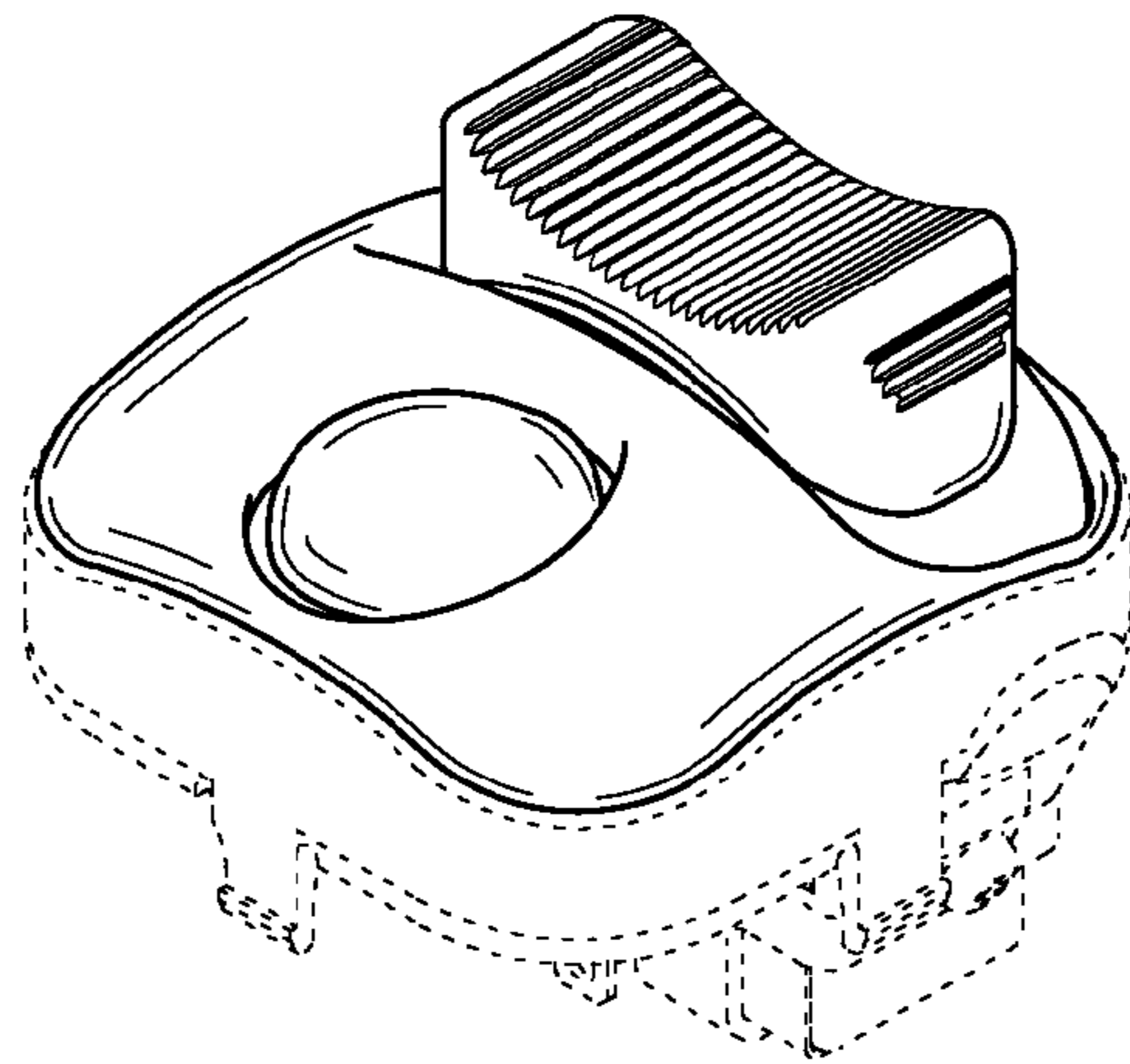

FIG. 6

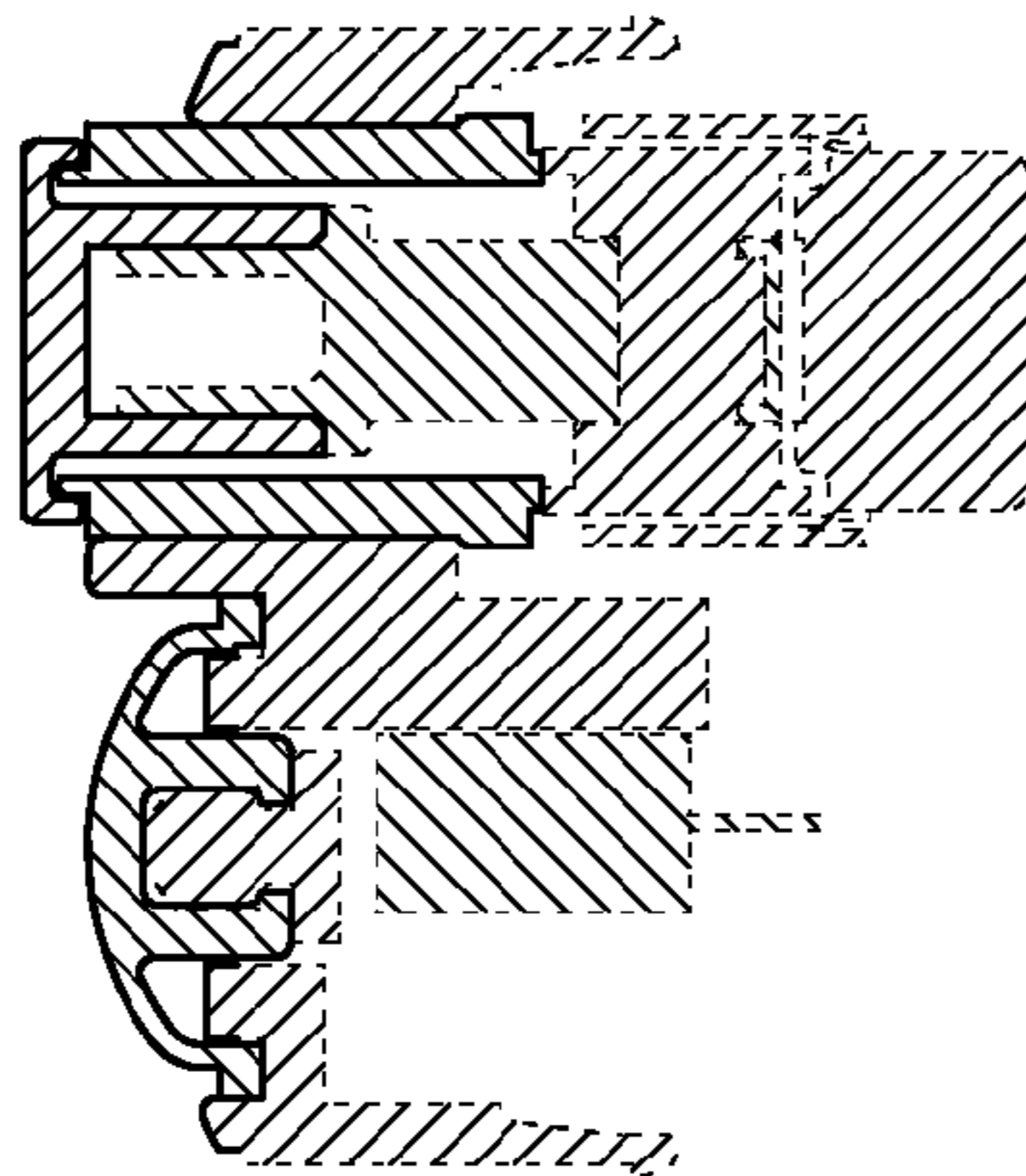

FIG. 7

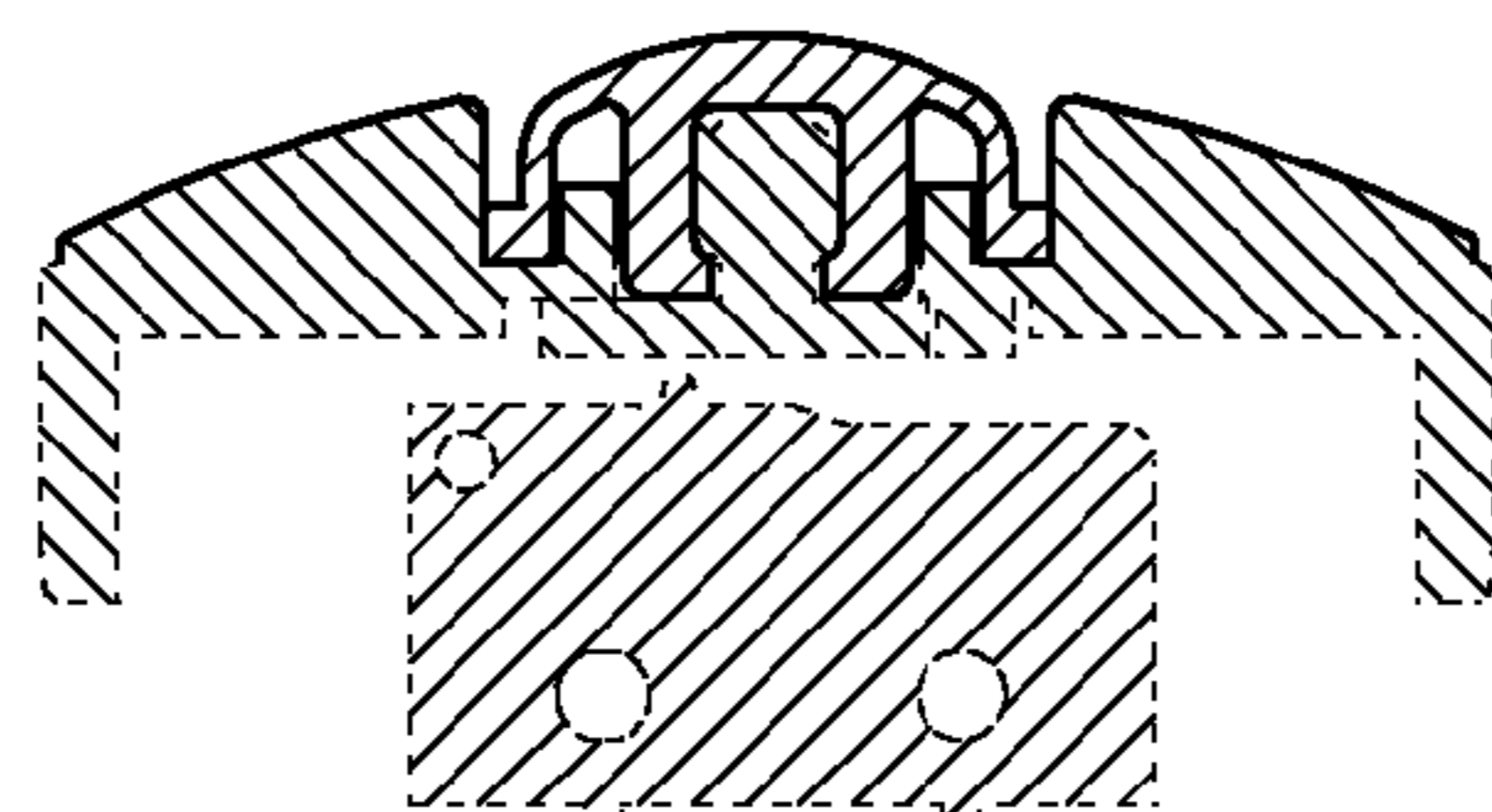

FIG. 8

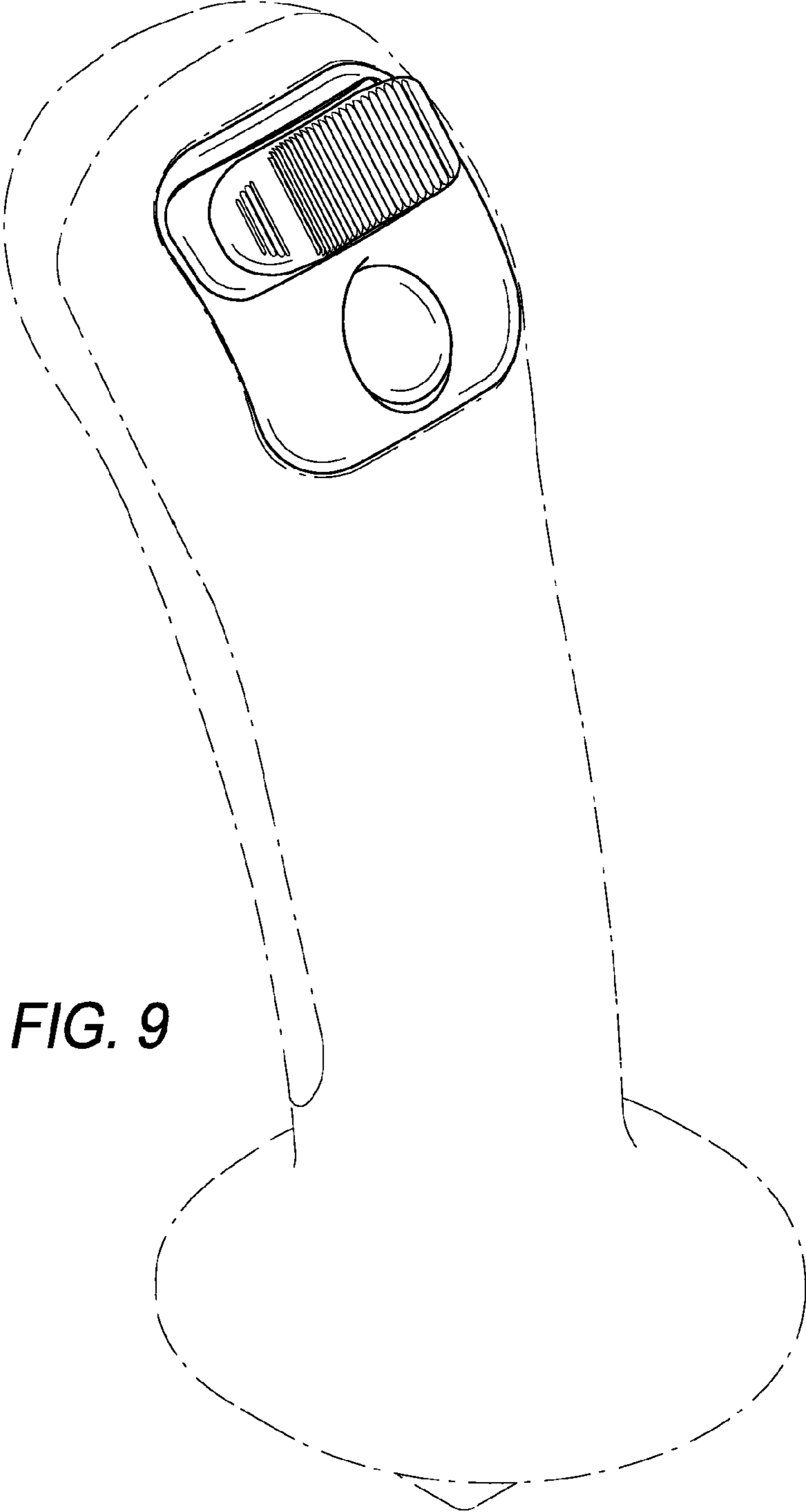

FIG. 9

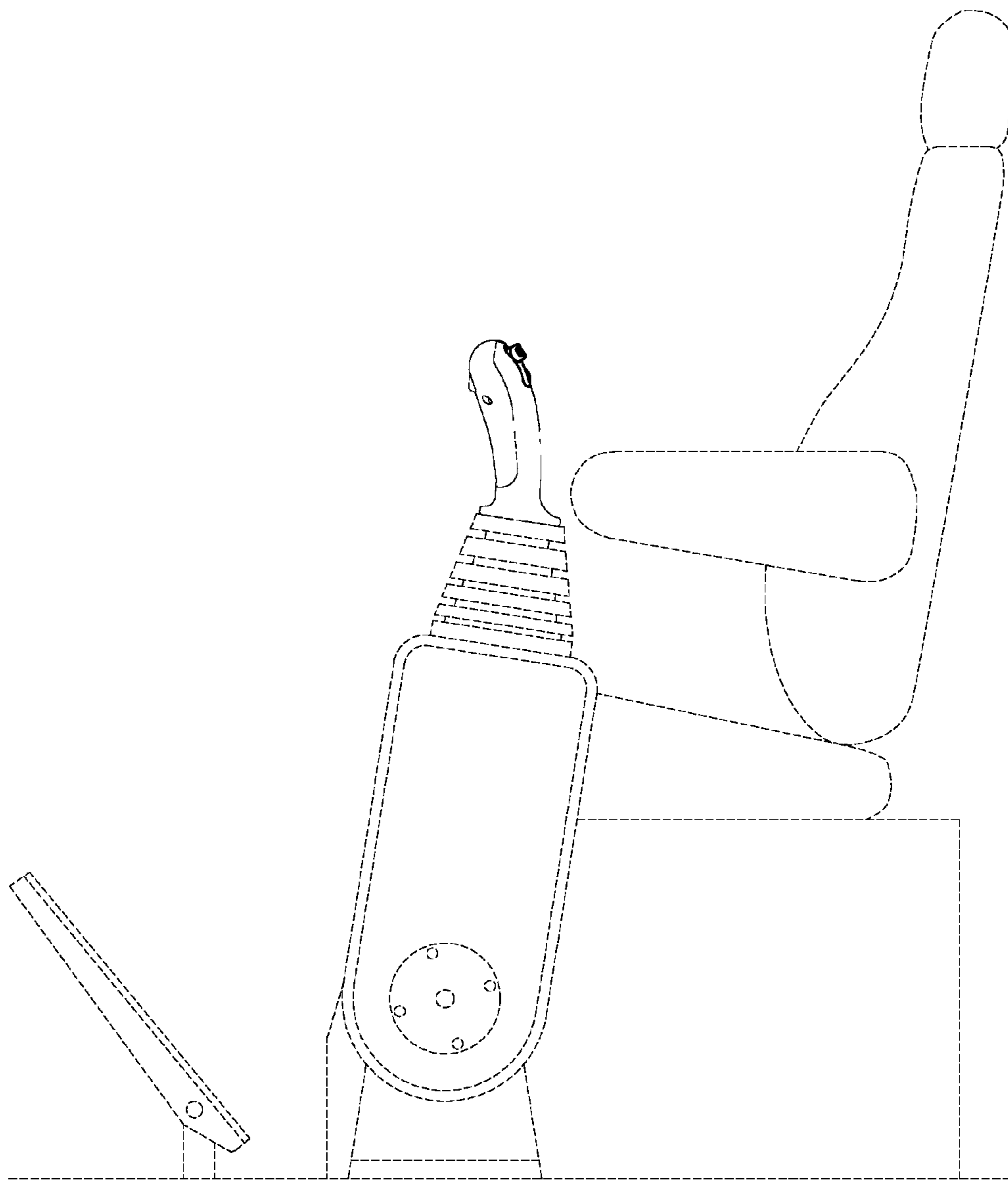

FIG. 10