



US00D627885S

(12) **United States Design Patent**
Brannon

(10) **Patent No.:** **US D627,885 S**

(45) **Date of Patent:** **** Nov. 23, 2010**

(54) **TREPHINE**

(76) **Inventor:** **James K. Brannon**, 11220 Meadow La.,
Leawood, KS (US) 66211

(**) **Term:** **14 Years**

(21) **Appl. No.:** **29/340,631**

(22) **Filed:** **Jul. 22, 2009**

(51) **LOC (9) Cl.** **24-02**

(52) **U.S. Cl.** **D24/146**

(58) **Field of Classification Search** D24/146,
D24/147; 606/80, 86, 99, 166, 167, 184,
606/185; 600/556-568; 623/17.11

See application file for complete search history.

(56) **References Cited**

U.S. PATENT DOCUMENTS

| | | | | |
|-----------|-----|---------|----------------|----------|
| 2,473,968 | A * | 6/1949 | Paton | 606/166 |
| 2,598,060 | A * | 5/1952 | Kadesky | 606/166 |
| 2,818,852 | A * | 1/1958 | Kugler | 600/568 |
| 2,919,692 | A * | 1/1960 | Ackermann | 600/567 |
| 3,732,858 | A * | 5/1973 | Banko | 600/566 |
| 4,319,575 | A * | 3/1982 | Bonte | 606/166 |
| 4,763,651 | A * | 8/1988 | Kaufman et al. | 606/166 |
| D323,556 | S * | 1/1992 | Miyaguchi | D24/147 |
| 5,084,059 | A * | 1/1992 | Metzger | 606/166 |
| 5,368,604 | A * | 11/1994 | Kilmer et al. | 606/166 |
| 5,395,385 | A * | 3/1995 | Kilmer et al. | 606/166 |
| 5,484,437 | A * | 1/1996 | Michelson | 606/86 A |
| 5,505,732 | A * | 4/1996 | Michelson | 606/86 A |
| 5,632,757 | A * | 5/1997 | Arnott | 606/166 |

| | | | | |
|-----------|------|---------|-----------------|-----------|
| D382,961 | S * | 8/1997 | Koros et al. | D24/146 |
| 5,755,732 | A * | 5/1998 | Green et al. | 606/170 |
| 6,024,706 | A * | 2/2000 | Hsiao | 600/556 |
| D484,595 | S * | 12/2003 | Ryan et al. | D24/146 |
| D491,268 | S * | 6/2004 | Hickingbotham | D24/147 |
| 6,770,074 | B2 * | 8/2004 | Michelson | 623/17.11 |
| 7,300,440 | B2 * | 11/2007 | Zdeblick et al. | 606/80 |

* cited by examiner

Primary Examiner—Freda S Nunn

(74) *Attorney, Agent, or Firm*—Intellectual Property Center,
LLC; Arthur K. Shaffer

(57) **CLAIM**

The ornamental design for a trephine, as shown and described.

DESCRIPTION

FIG. 1 is a perspective view of a trephine in accordance with the present invention;

FIG. 2 is a side elevation of the trephine of FIG. 1;

FIG. 3 is a top elevation of the trephine of FIG. 1;

FIG. 4 is a right elevation of the trephine of FIG. 1;

FIG. 5 is a bottom elevation of the trephine of FIG. 1;

FIG. 6 is a front view of the trephine of FIG. 1; and,

FIG. 7 is a rear view of the trephine of FIG. 1.

The broken lines in FIGS. 1, 2, 3, 4, 5, 6 and 7 are for illustrative purposes only and form no part of the claimed design.

1 Claim, 2 Drawing Sheets

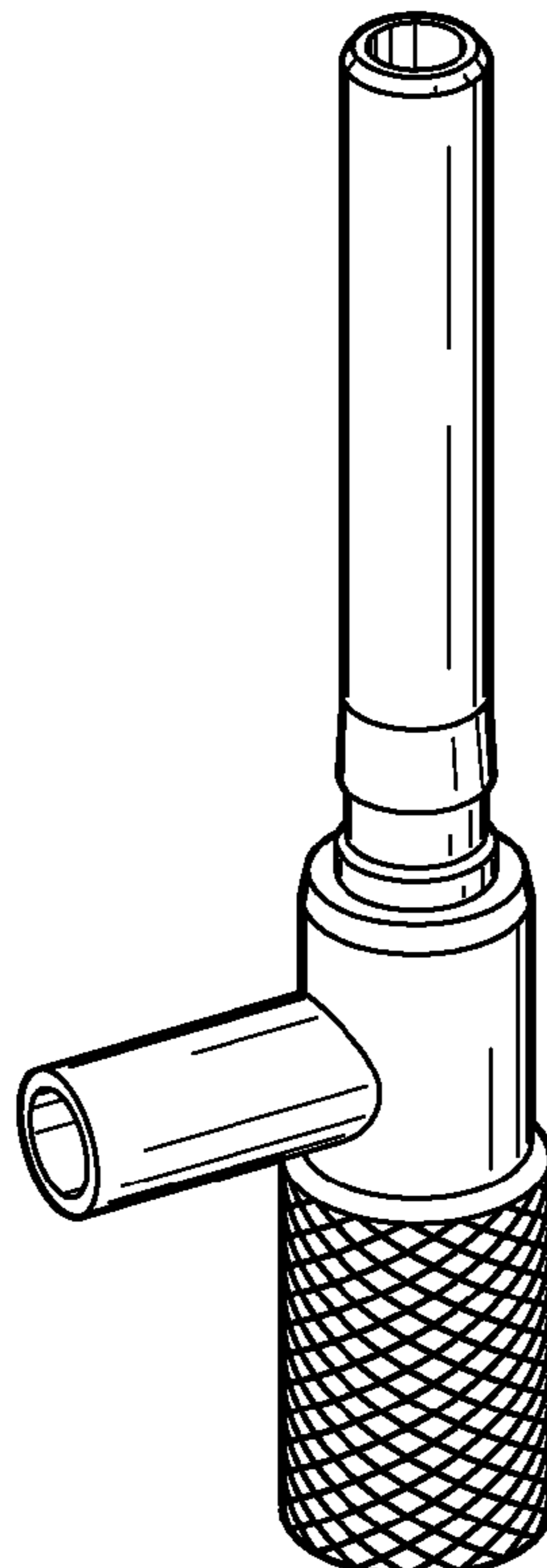

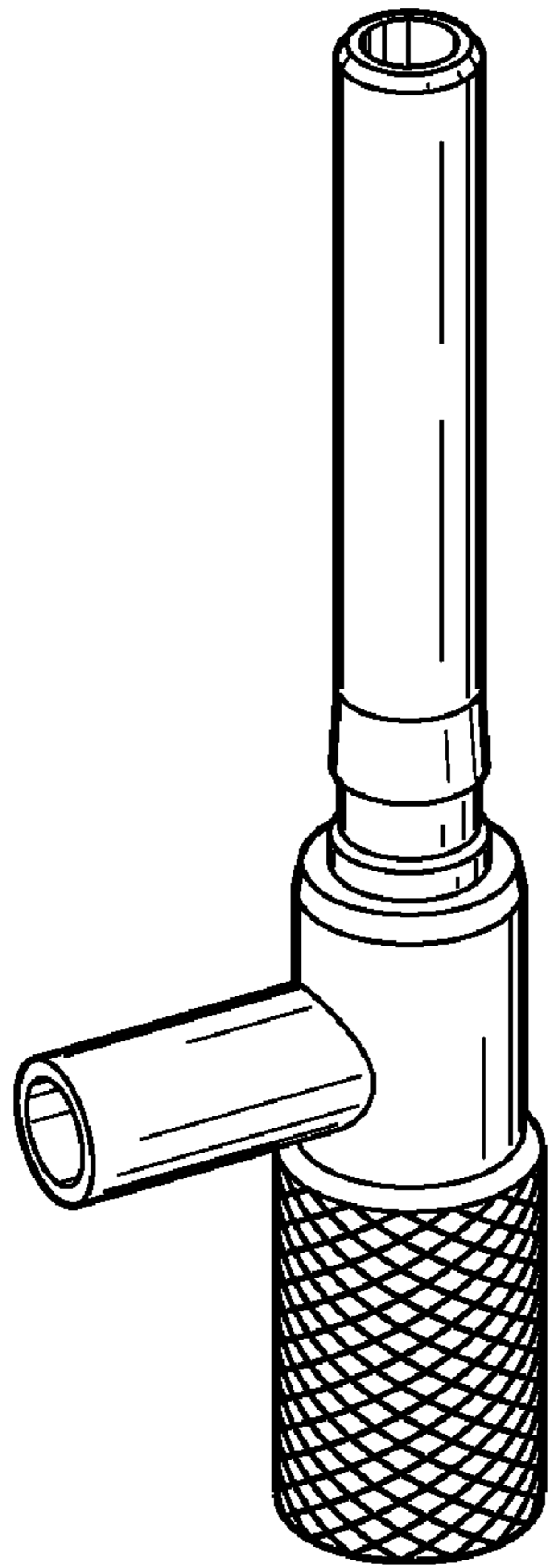

FIG.1

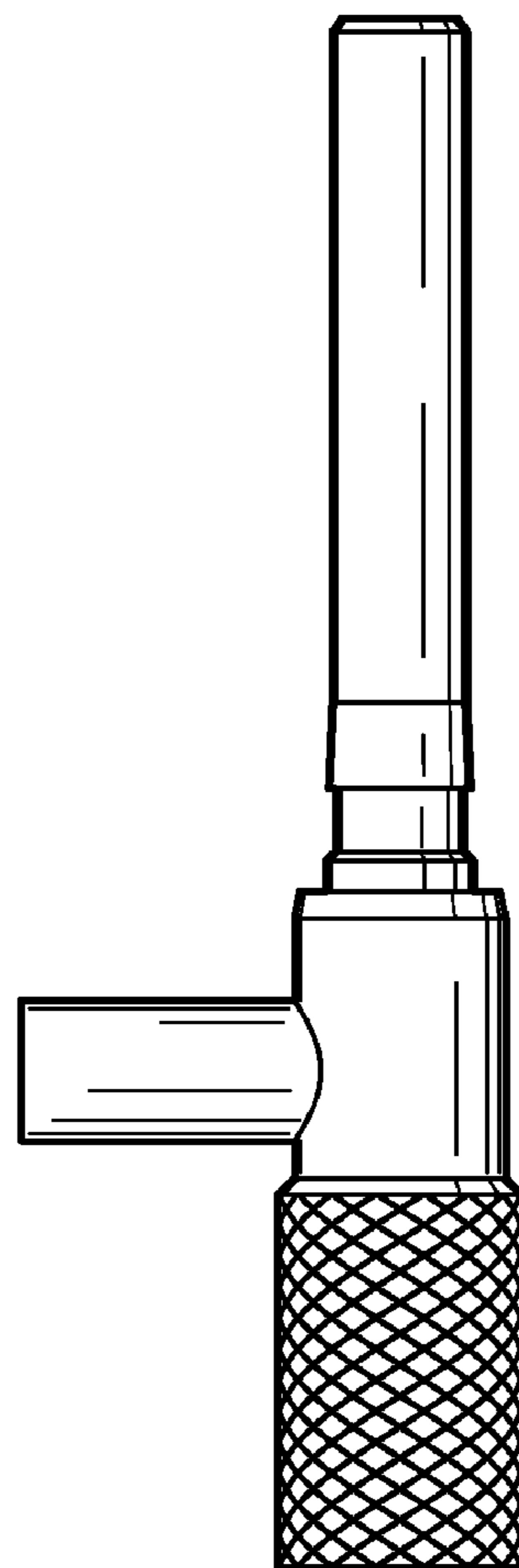

FIG.2

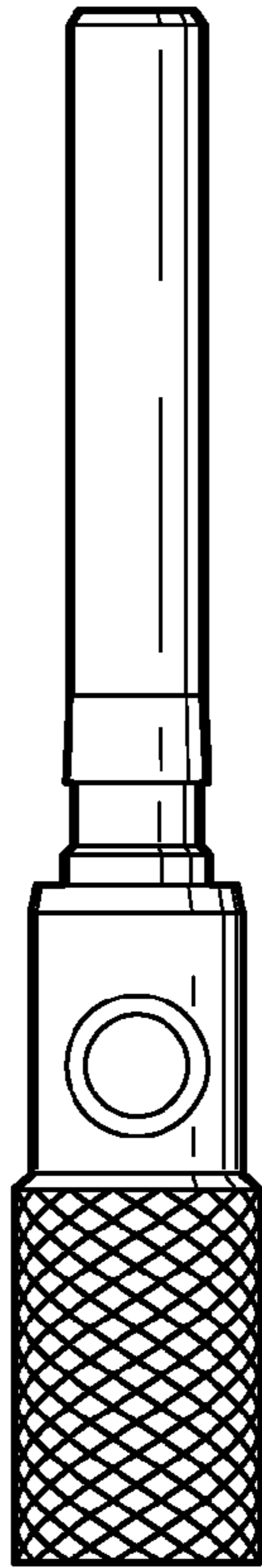

FIG. 3

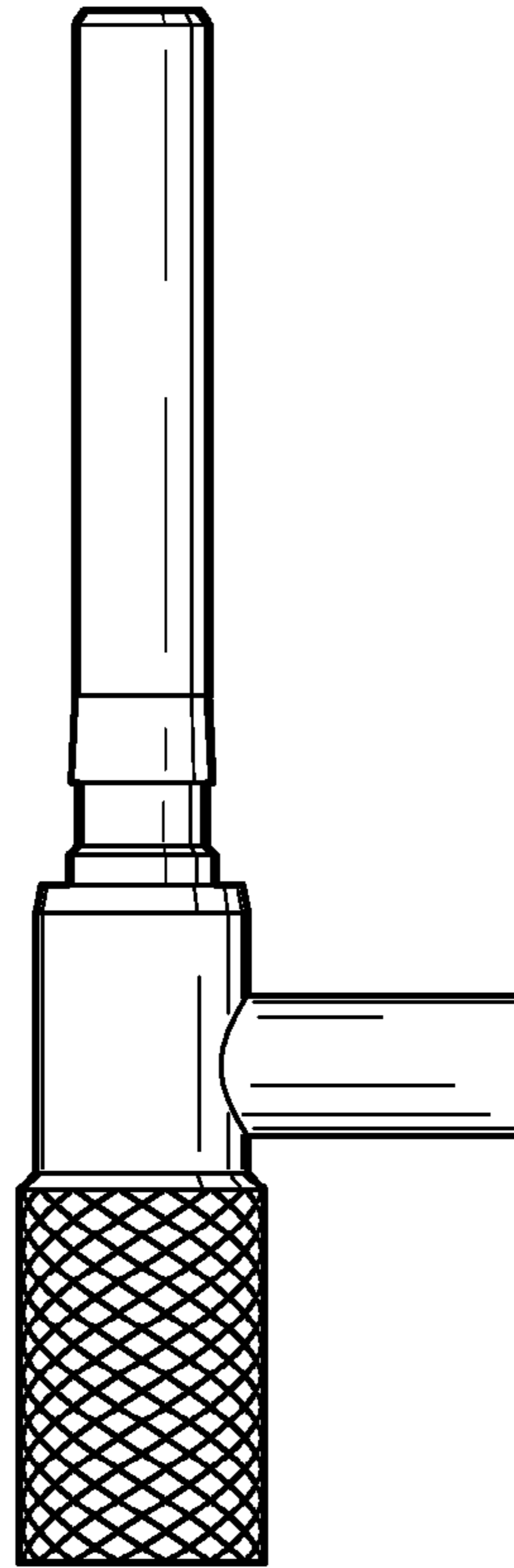

FIG. 4

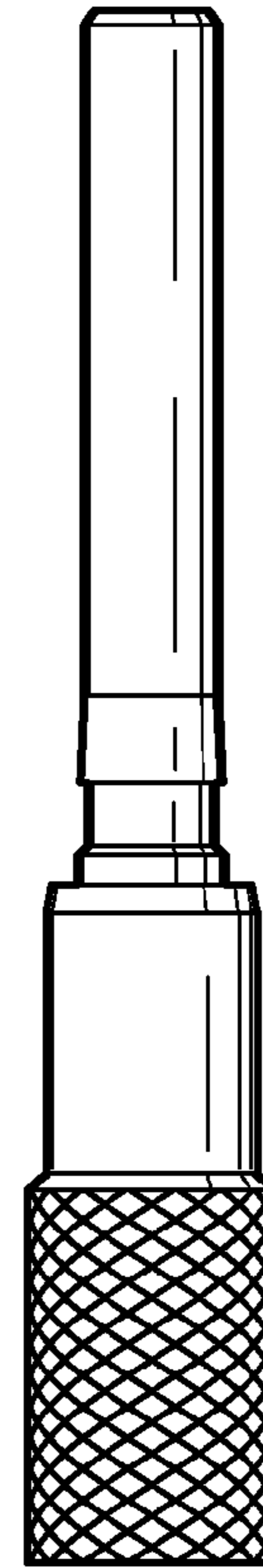

FIG. 5

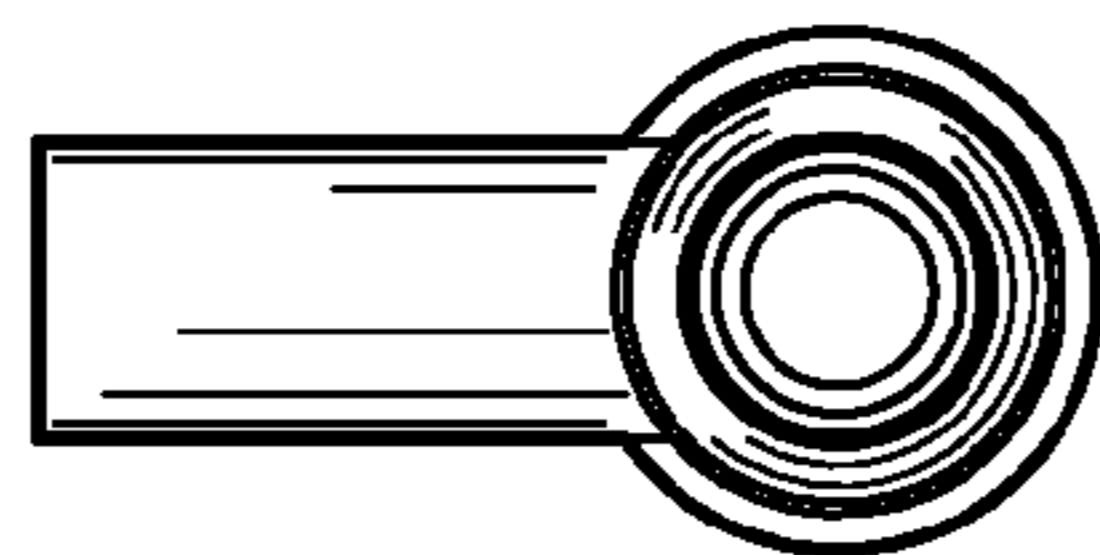

FIG. 6

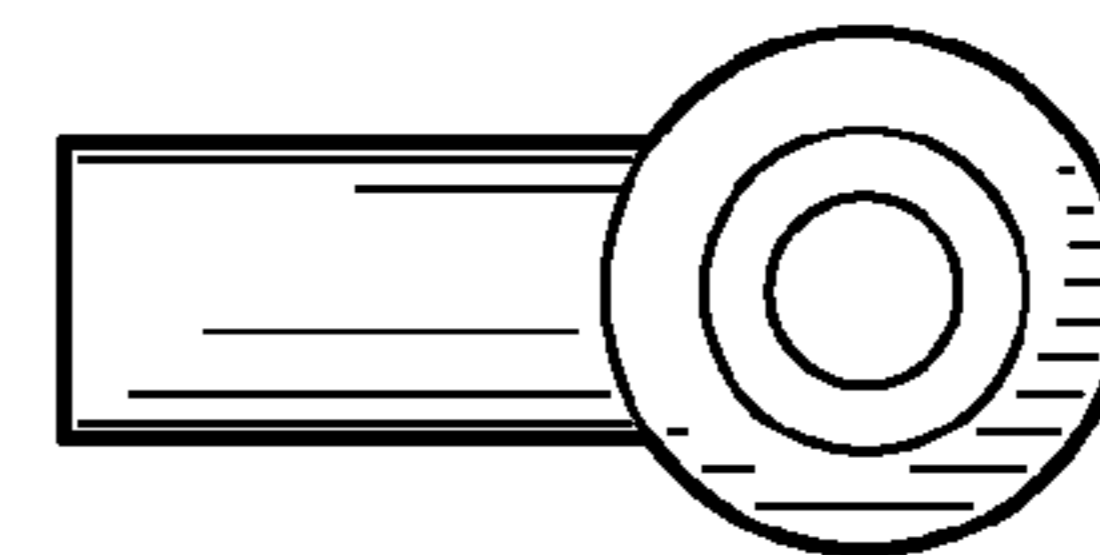

FIG. 7