



US00D627737S

(12) **United States Design Patent**
Qu et al.

(10) **Patent No.:** **US D627,737 S**

(45) **Date of Patent:** **** Nov. 23, 2010**

(54) **CARD CONNECTOR**

(75) Inventors: **Zhi-Cheng Qu**, Guang-Dong (CN);
Yun-Xiang Liu, Guang-Dong (CN);
Bing-Tao Yang, Guang-Dong (CN);
Yin-Lung Wu, Tu-Cheng (TW);
Ming-Chiang Chen, Tu-Cheng (TW)

(73) Assignee: **Cheng Uei Precision Industry Co., Ltd.**, Tu-Cheng, Taipei Hsien (TW)

(**) Term: **14 Years**

(21) Appl. No.: **29/352,245**

(22) Filed: **Dec. 17, 2009**

(51) **LOC (9) Cl.** **13-03**

(52) **U.S. Cl.** **D13/147**

(58) **Field of Classification Search** D13/120,
D13/133, 146-147, 154, 156, 184; 439/108,
439/354, 357, 358, 567, 607.01, 607.04,
439/607.05, 607.17, 607.25, 607.34, 607.41,
439/607.53, 676, 680

See application file for complete search history.

(56) **References Cited**

U.S. PATENT DOCUMENTS

D405,053 S * 2/1999 Tan et al. D13/147
D478,869 S * 8/2003 Zhang D13/147
D481,360 S * 10/2003 Kuroki et al. D13/147

D517,990 S * 3/2006 de Jonge et al. D13/147
D577,339 S * 9/2008 Gao et al. D13/147
D589,893 S * 4/2009 Gao et al. D13/147

* cited by examiner

Primary Examiner—Daniel D Bui

(74) *Attorney, Agent, or Firm*—Cheng-Ju Chiang

(57) **CLAIM**

The ornamental design for a card connector, as shown and described.

DESCRIPTION

FIG. 1 is a perspective view of a card connector showing our new design;

FIG. 2 is a front elevational view thereof;

FIG. 3 is a rear elevational view thereof;

FIG. 4 is a left side elevational view thereof;

FIG. 5 is a right side elevational view thereof;

FIG. 6 is a top plan view thereof;

FIG. 7 is a bottom plan view thereof; and,

FIG. 8 is another perspective view of a card connector showing our new design.

The broken line shown in the drawings is included for the purpose of illustrating environmental structure and forms no part of the claimed design.

1 Claim, 8 Drawing Sheets

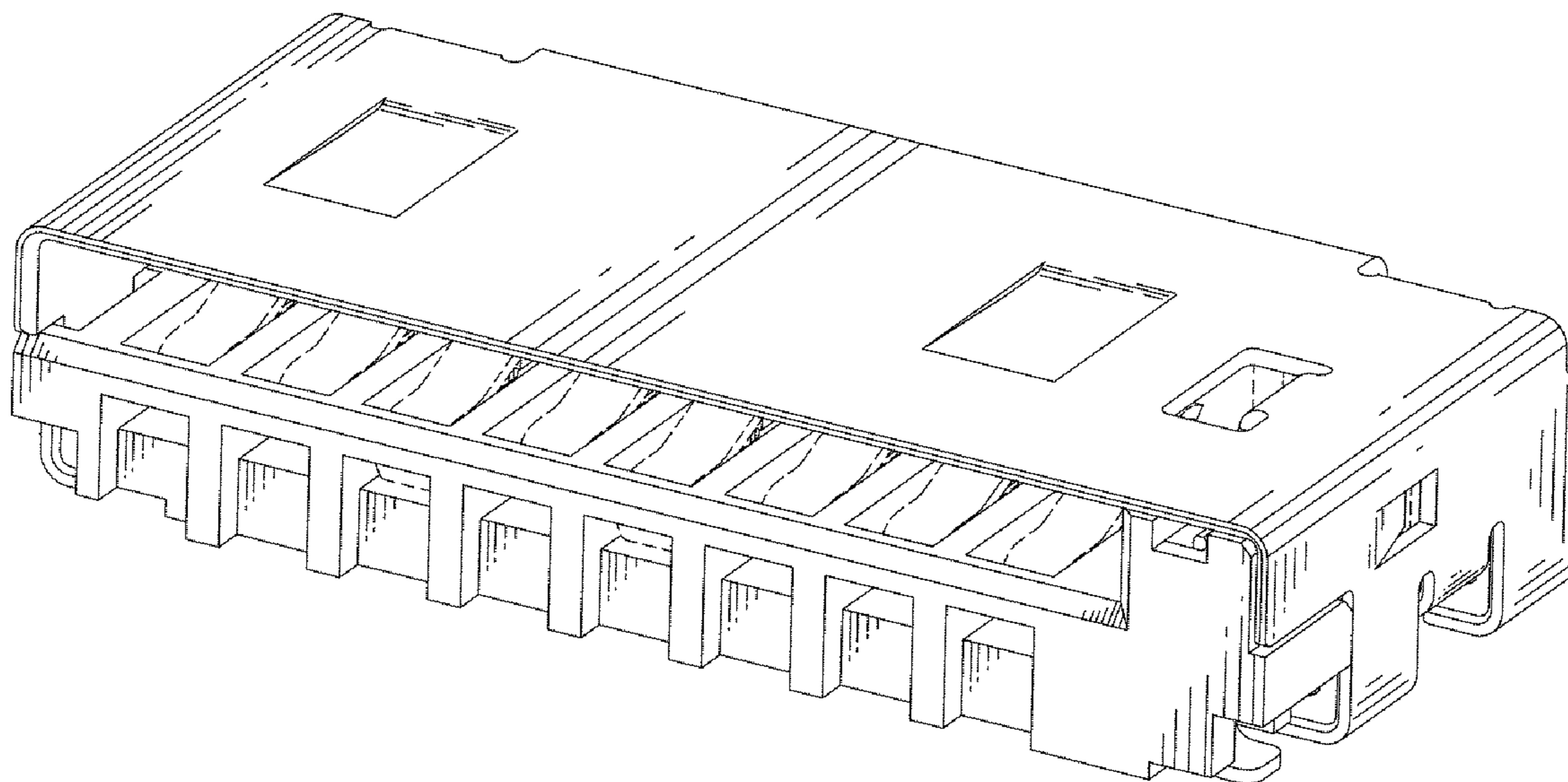

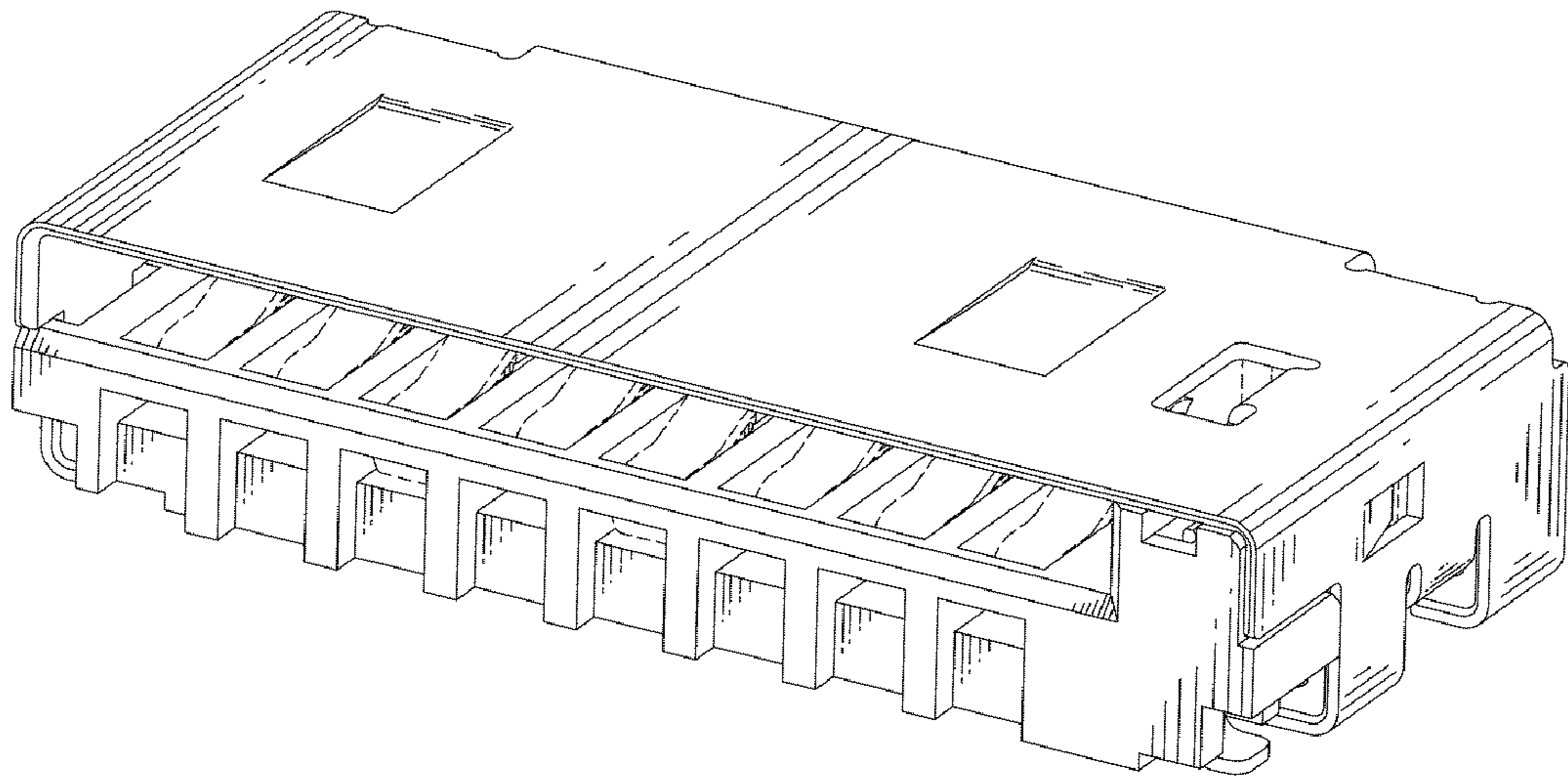

FIG. 1

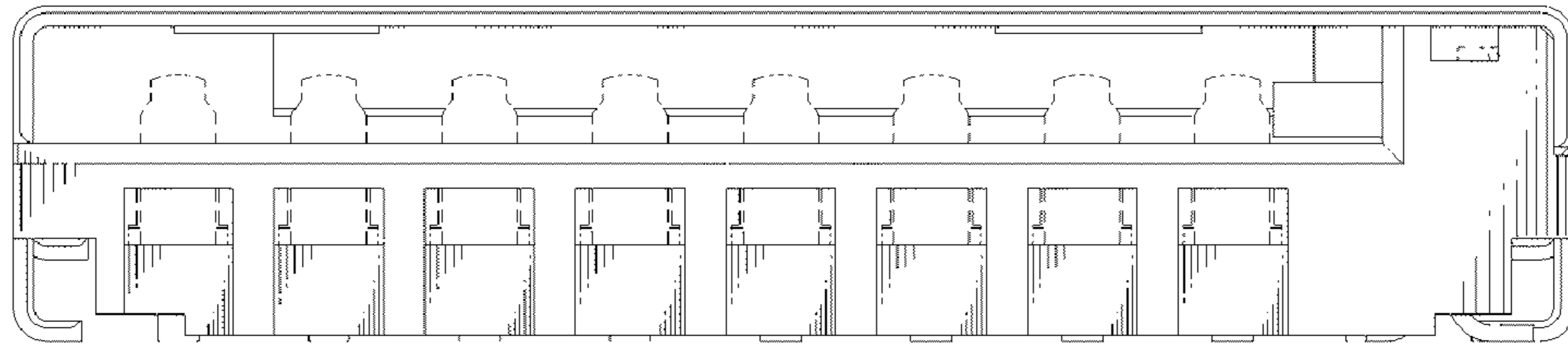

FIG. 2

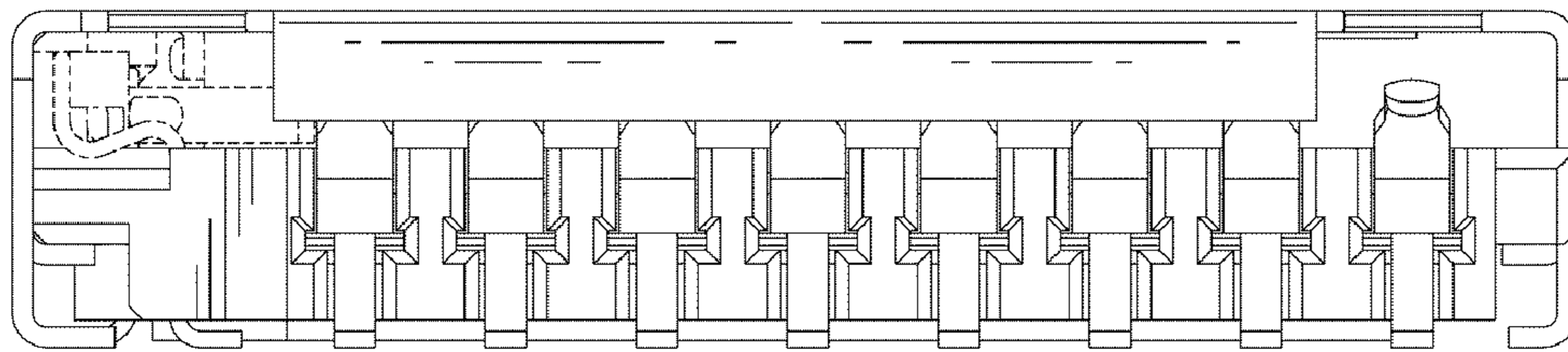

FIG. 3

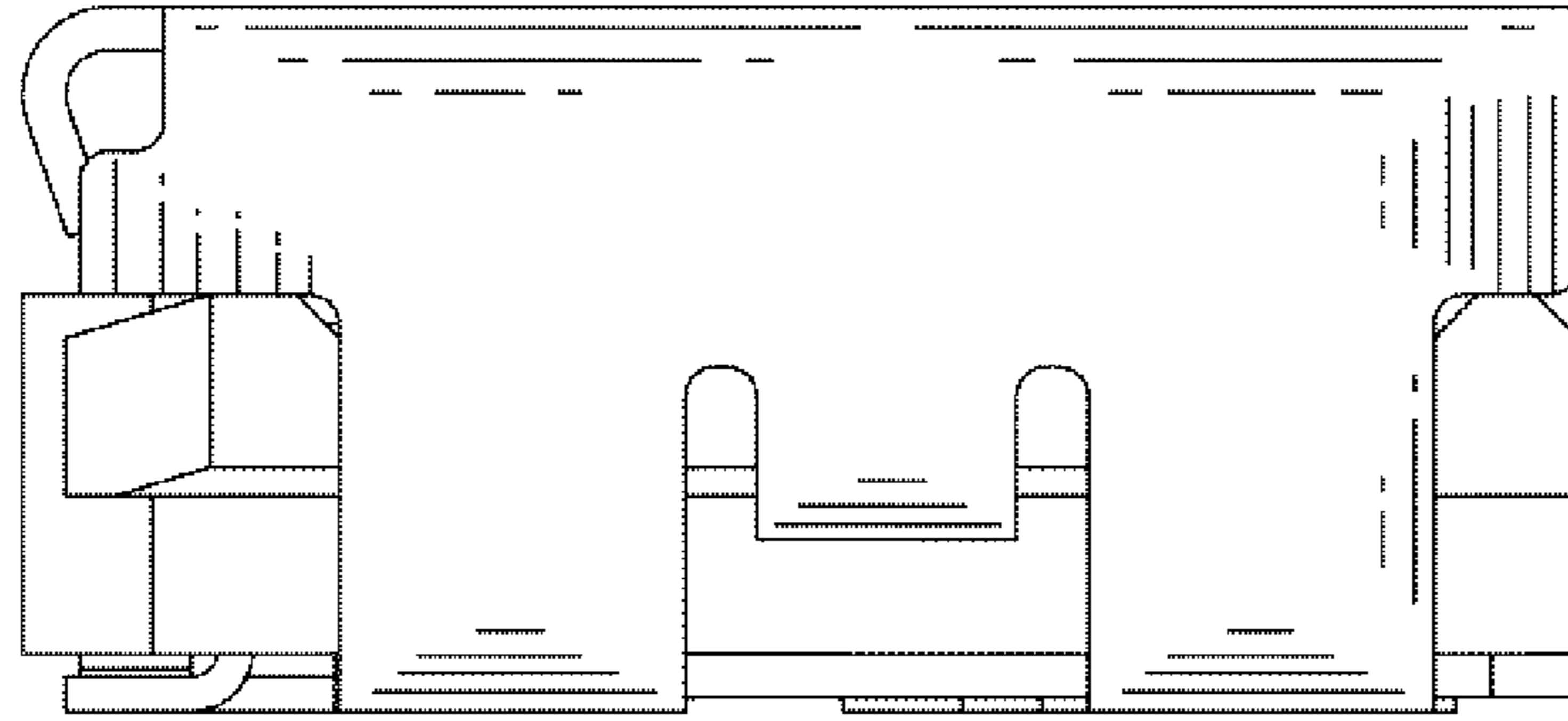

FIG. 4

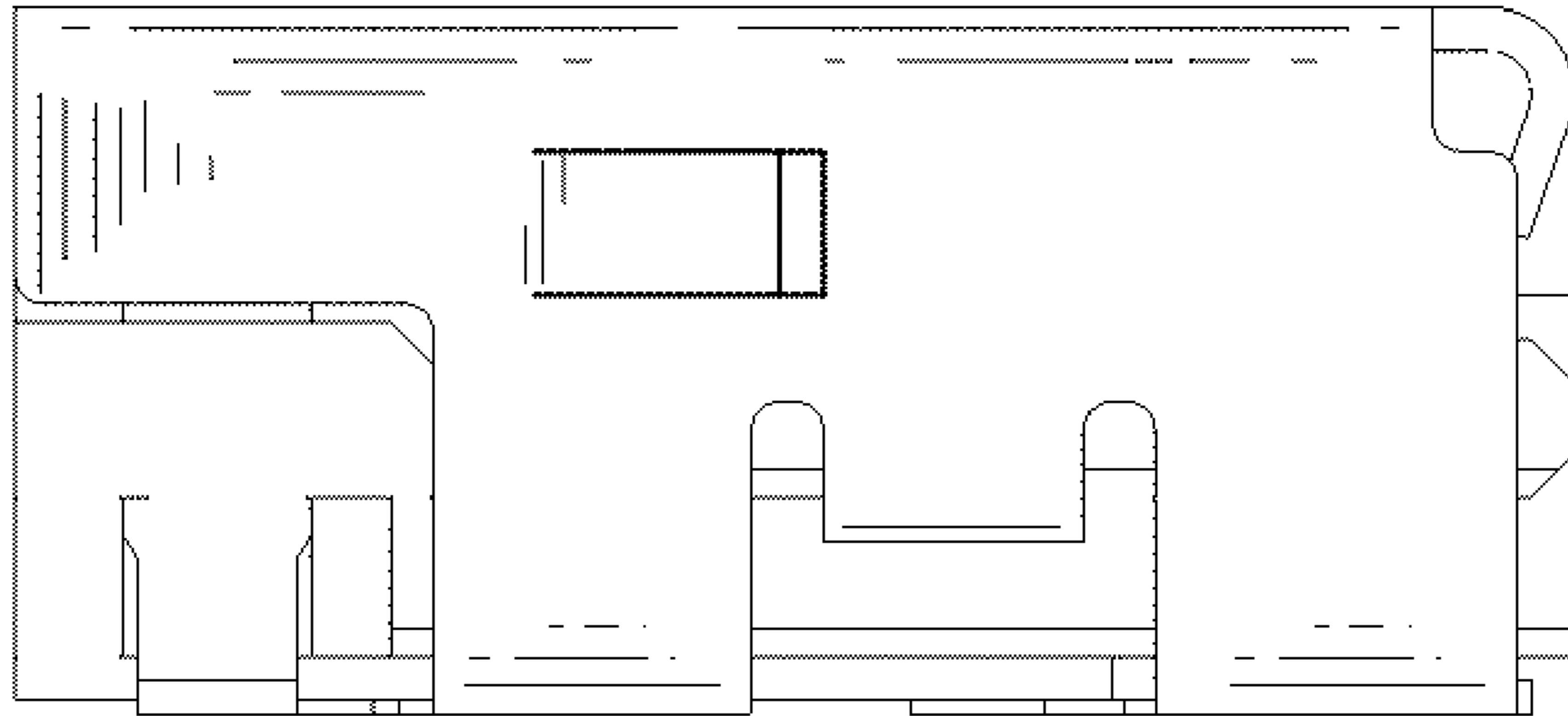

FIG. 5

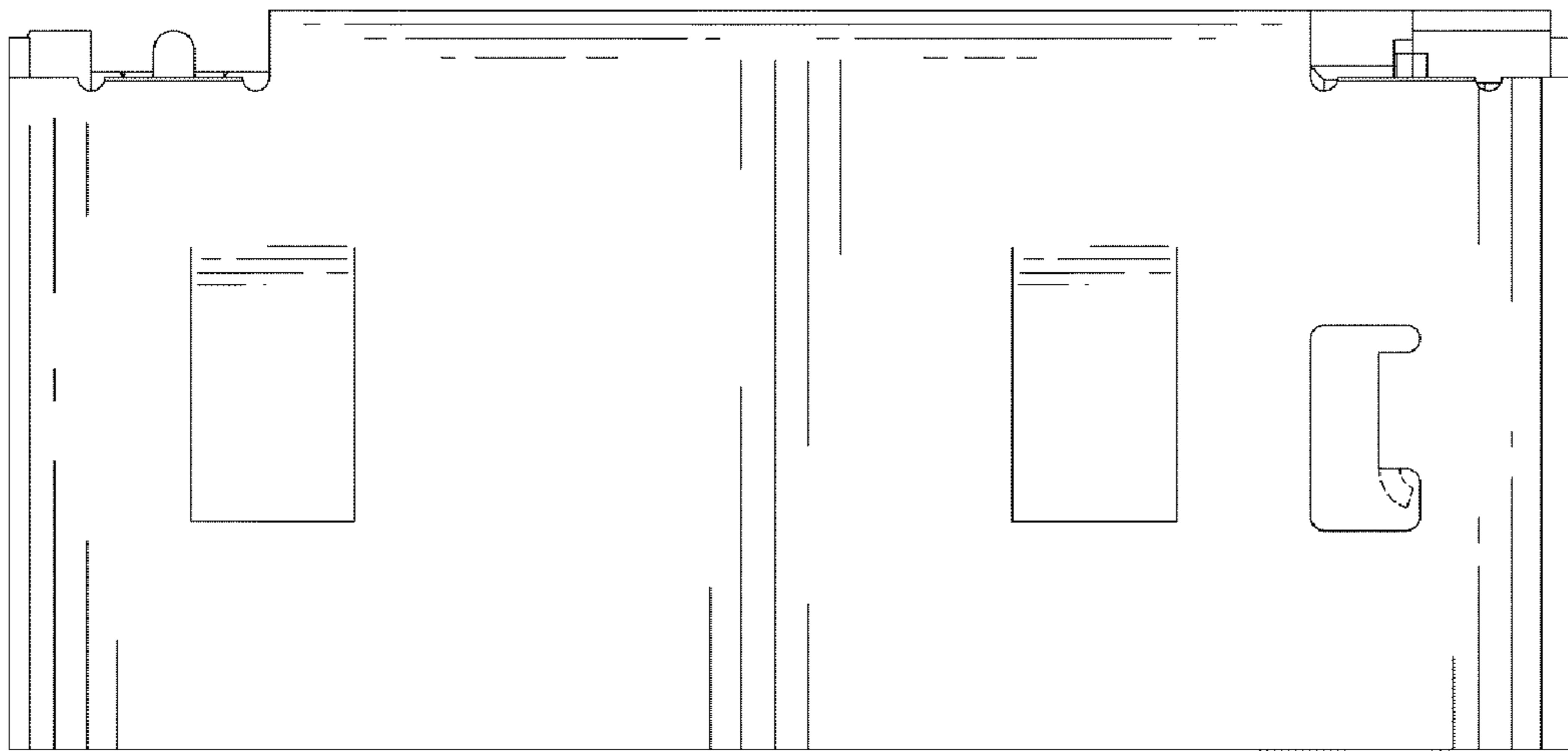

FIG. 6

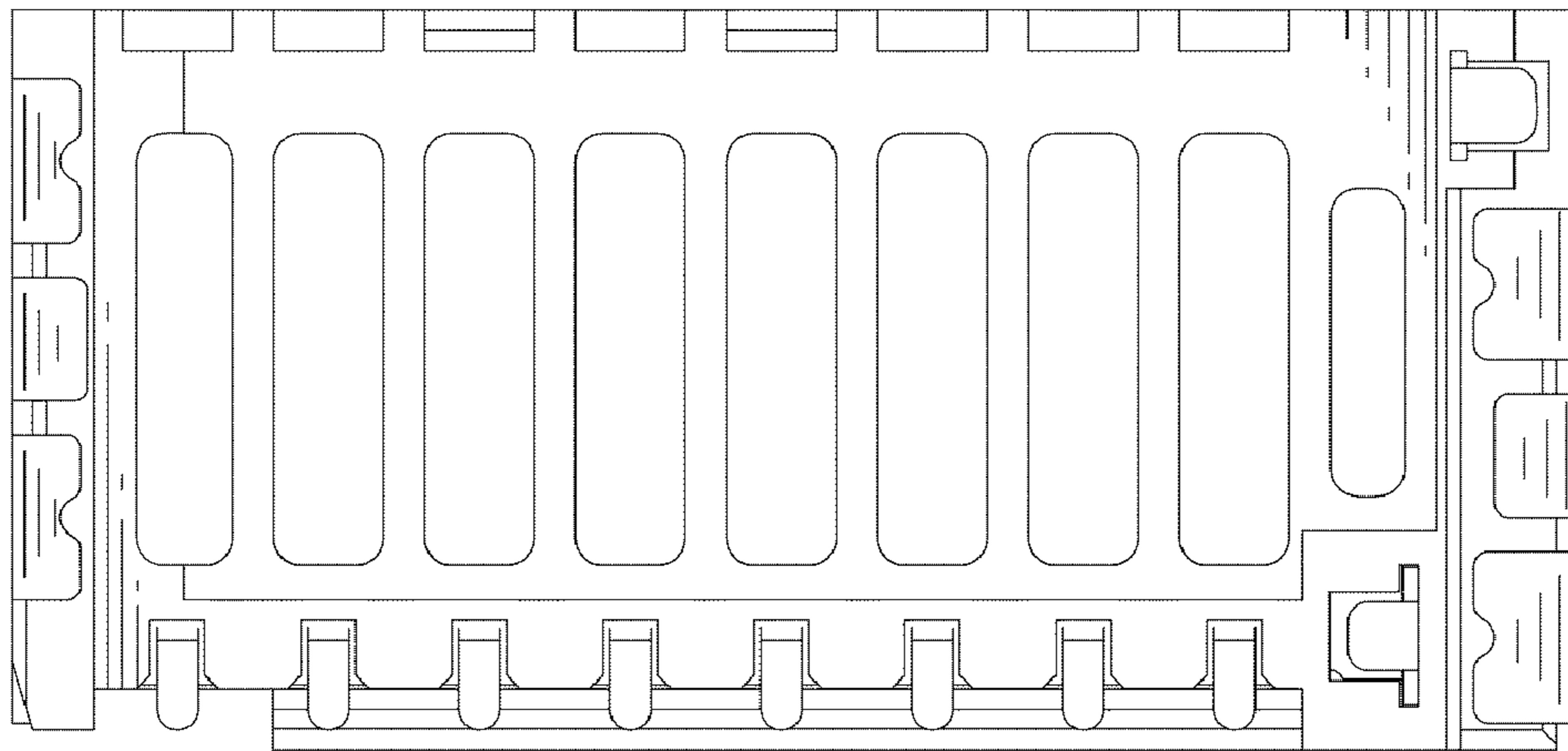

FIG. 7

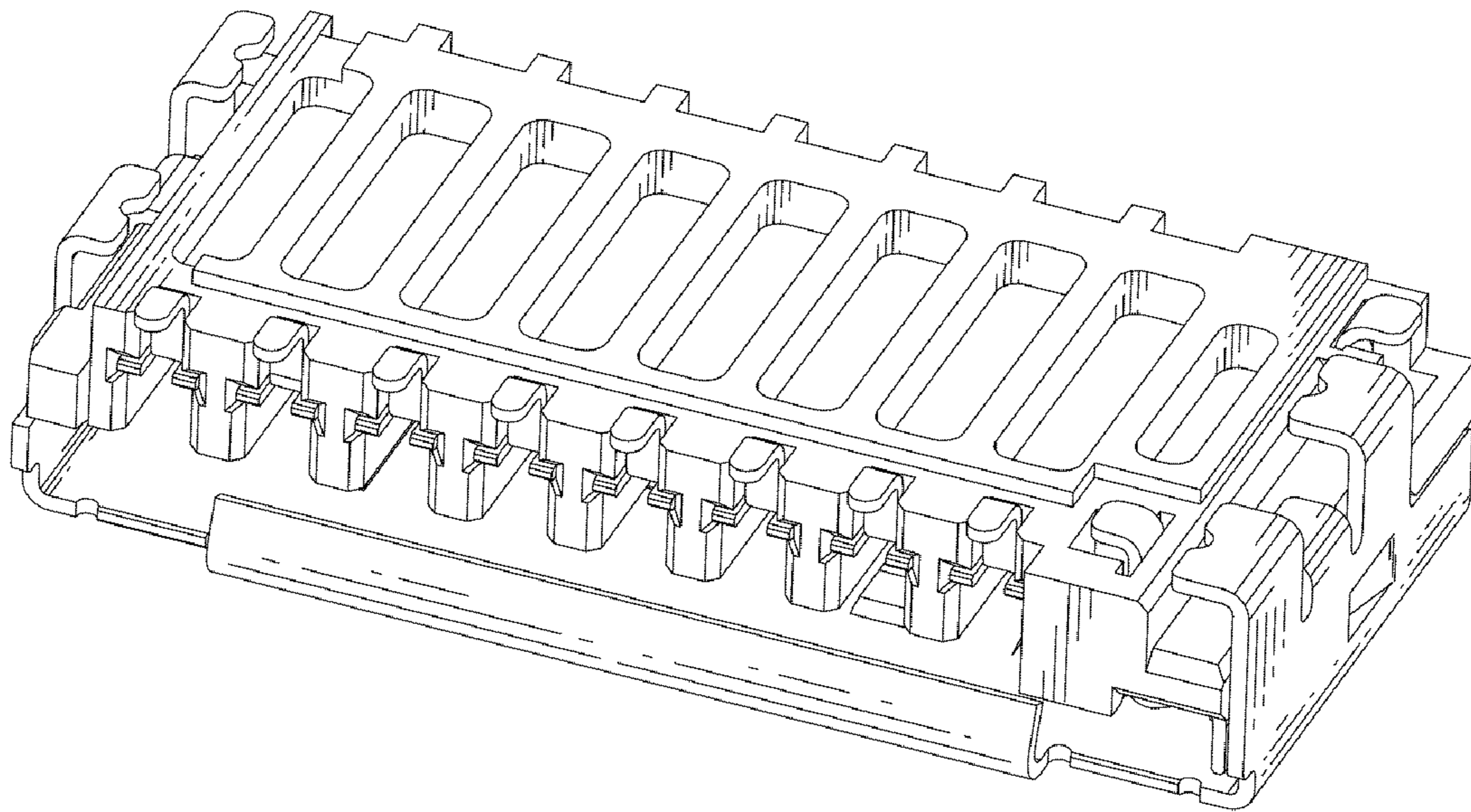

FIG. 8