



US00D627490S

(12) **United States Design Patent**  
**Janish et al.**

(10) **Patent No.:** **US D627,490 S**

(45) **Date of Patent:** **\*\* Nov. 16, 2010**

(54) **METAL INSERT FOR CARPENTRY**

(76) Inventors: **Joseph Janish**, 1314 Nicholson,  
Houston, TX (US) 77008; **Larry Janish**,  
6142 Queenswood La., Houston, TX  
(US) 77008

(\*\*) Term: **14 Years**

(21) Appl. No.: **29/334,742**

(22) Filed: **Mar. 31, 2009**

(51) **LOC (9) Cl.** ..... **25-99**

(52) **U.S. Cl.** ..... **D25/199; D8/382**

(58) **Field of Classification Search** ..... D25/199;  
D8/382, 387, 383, 384, 385, 393, 394; 411/349,  
411/340, 436, 180, 179

See application file for complete search history.

(56) **References Cited**

U.S. PATENT DOCUMENTS

3,074,292	A *	1/1963	Polmon	.....	74/553
D208,429	S *	8/1967	Holliday	.....	D8/397
D211,661	S *	7/1968	Holub	.....	D8/393
3,834,438	A *	9/1974	Ziaylek, Jr.	.....	411/113
4,138,921	A *	2/1979	McGauran et al.	.....	411/510
D289,374	S *	4/1987	Ziaylek, Jr.	.....	D8/385
D298,605	S *	11/1988	Colgan et al.	.....	D8/382
D347,381	S *	5/1994	Carruthers	.....	D8/382
D347,382	S *	5/1994	Carruthers	.....	D8/382
D347,383	S *	5/1994	Carruthers	.....	D8/382
D347,786	S *	6/1994	Carruthers	.....	D8/382
5,697,744	A *	12/1997	Medal	.....	411/82
5,800,109	A *	9/1998	Carruthers	.....	411/510

5,879,115	A *	3/1999	Medal	.....	411/82
D467,161	S *	12/2002	Klenck et al.	.....	D8/385
D577,109	S *	9/2008	Smith et al.	.....	D23/358
D619,449	S *	7/2010	Smith et al.	.....	D8/382
D622,582	S *	8/2010	Lottner et al.	.....	D8/387
2002/0104187	A1 *	8/2002	Kakamu et al.	.....	16/2.1

\* cited by examiner

*Primary Examiner*—T. Chase Nelson

*Assistant Examiner*—Ania K Dworzecka

(74) *Attorney, Agent, or Firm*—Egbert Law Offices PLLC

(57) **CLAIM**

The ornamental design for the metal insert for carpentry, as shown and described.

**DESCRIPTION**

FIG. 1 is an upper perspective view of the metal insert for carpentry showing my new design.

FIG. 2 is a top plan view thereof;

FIG. 3 is a bottom plan view thereof;

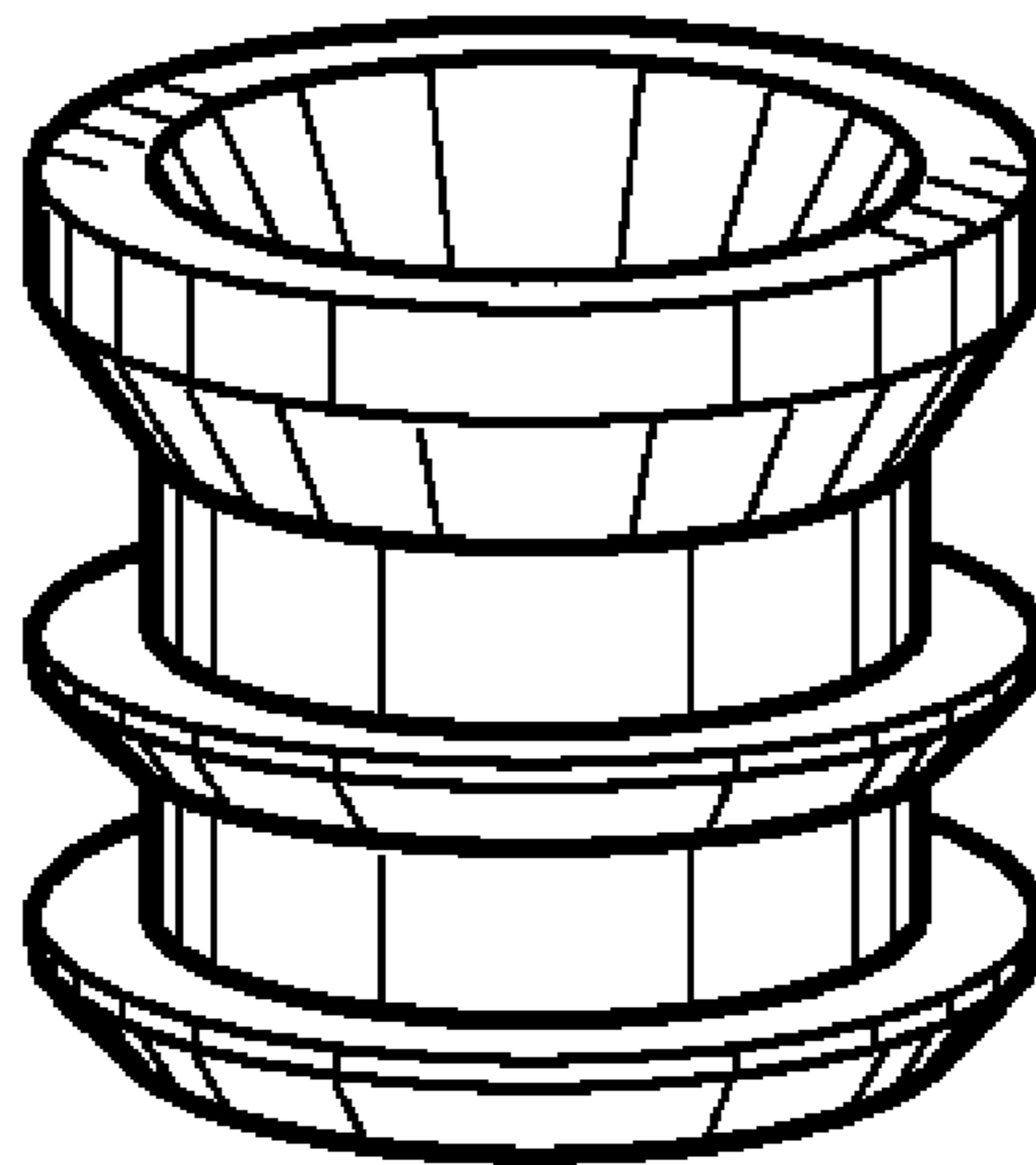
FIG. 4 is a side elevation view thereof, an opposite side elevation view, front view and back view being identical to FIG. 4;

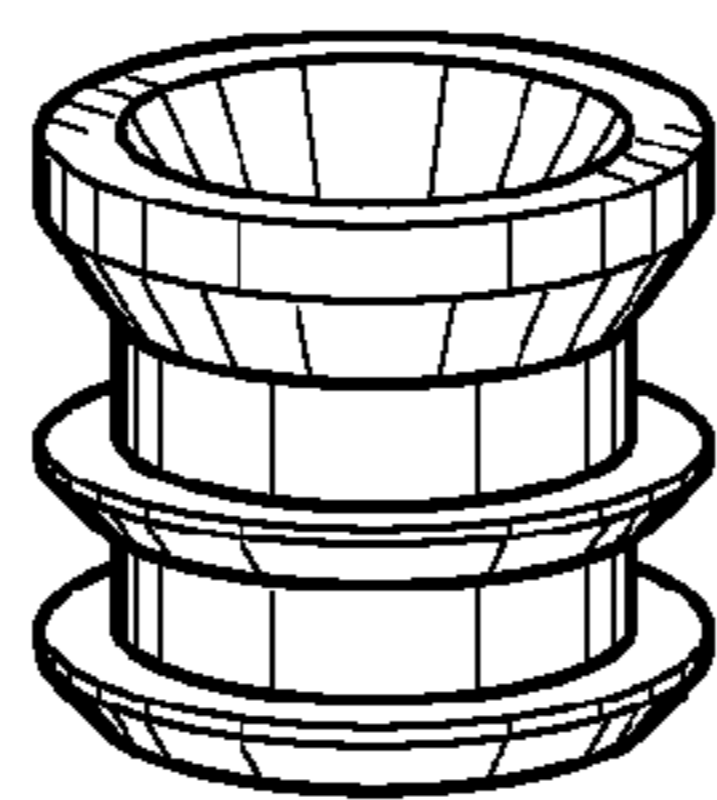
FIG. 5 is a side elevation view thereof, showing an alternative embodiment with length being the variable; and,

FIG. 6 is a perspective view, showing insertion into a plank.

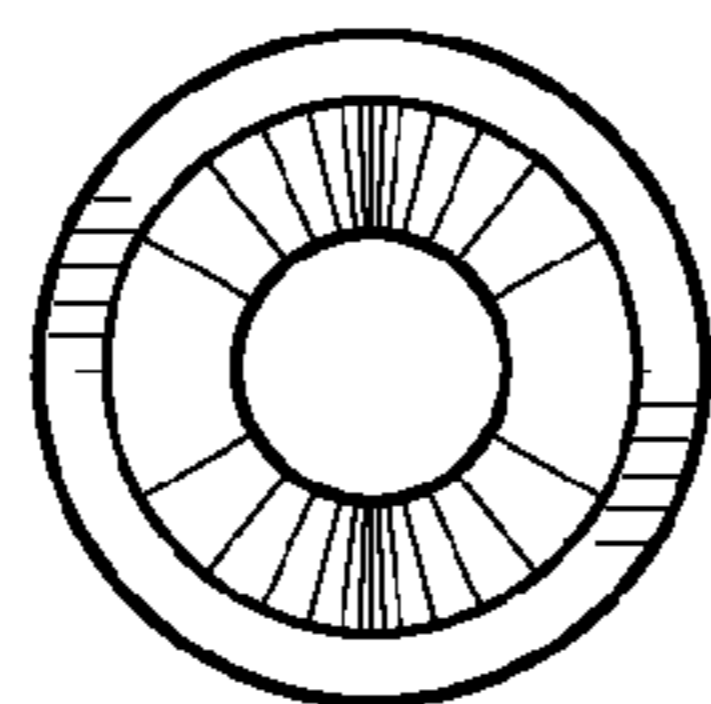
The metal insert for carpentry is used in construction. The broken lines in the drawings represent environmental subject matter and form no part of the claimed design.

**1 Claim, 1 Drawing Sheet**

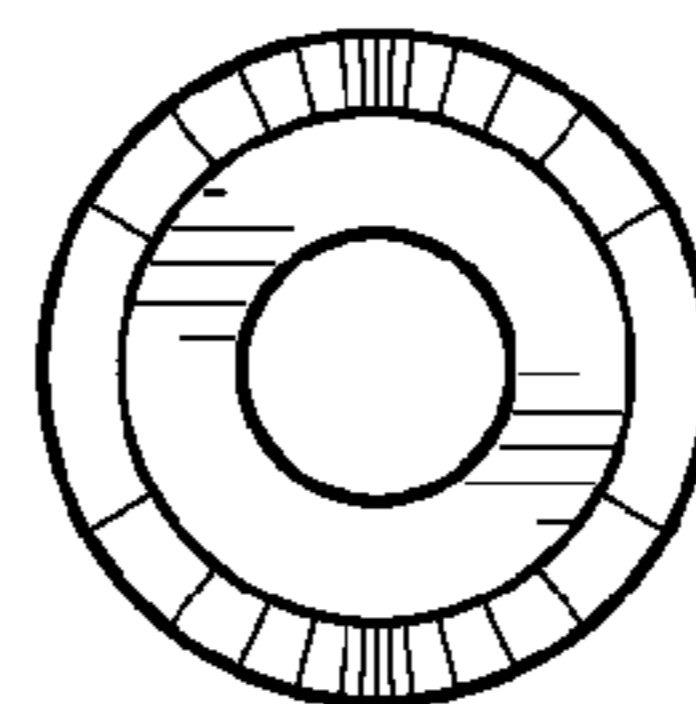




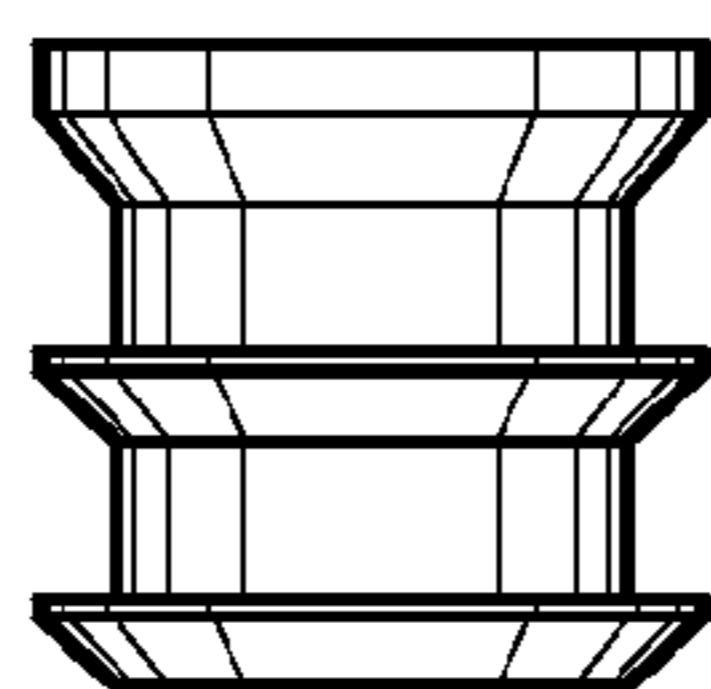
*FIG. 1*



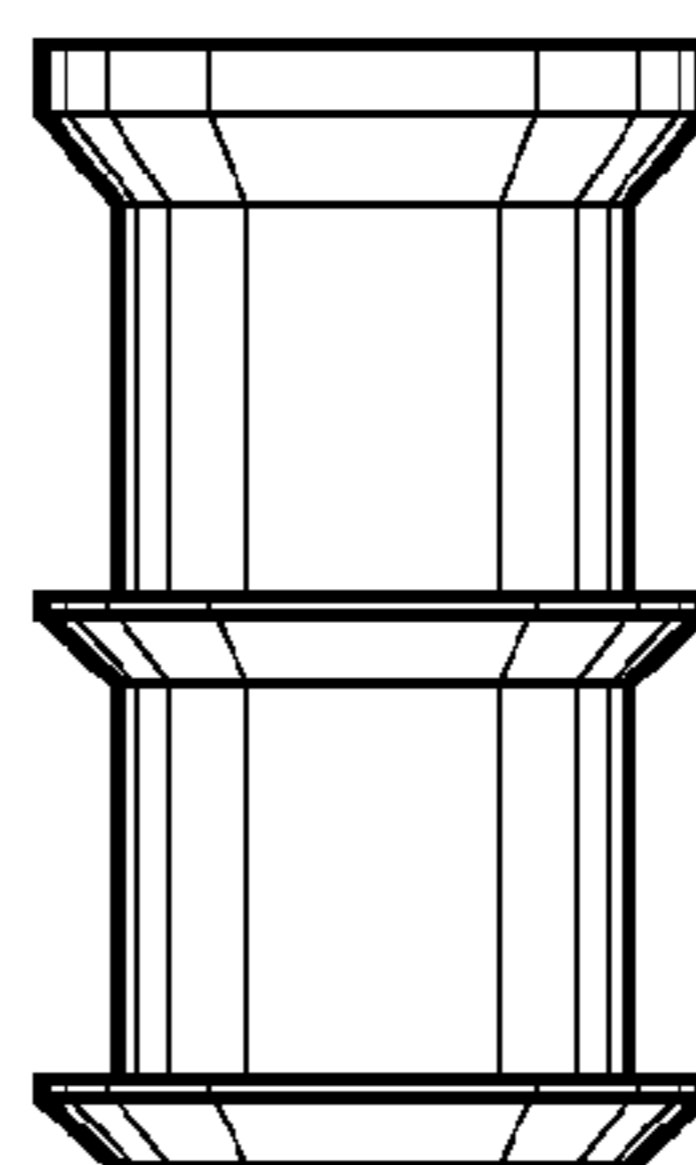
*FIG. 2*



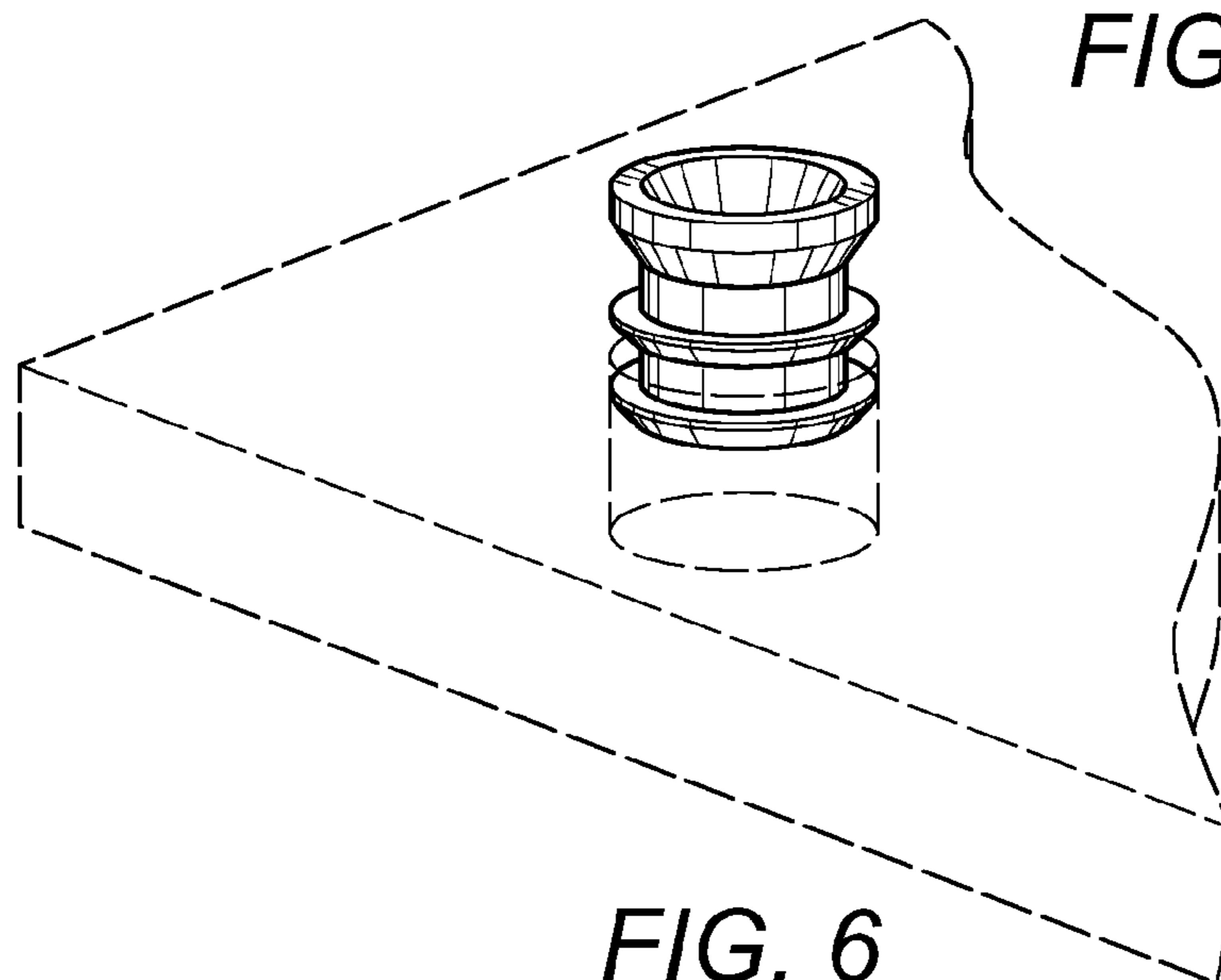
*FIG. 3*



*FIG. 4*



*FIG. 5*



*FIG. 6*