



US00D626507S

(12) **United States Design Patent**
Riede

(10) **Patent No.:** **US D626,507 S**

(45) **Date of Patent:** **** *Nov. 2, 2010**

(54) **VEHICLE POWER ADAPTER**

D592,598 S * 5/2009 Kettula D13/144
D595,223 S 6/2009 Yamamoto et al.
D604,699 S 11/2009 Yamamoto

(75) Inventor: **Steven J. Riede**, Long Beach, CA (US)

(73) Assignee: **Magnadyne Corporation**, Compton, CA (US)

(*) Notice: This patent is subject to a terminal disclaimer.

(**) Term: **14 Years**

(21) Appl. No.: **29/358,080**

(22) Filed: **Mar. 22, 2010**

(51) **LOC (9) Cl.** **13-03**

(52) **U.S. Cl.** **D13/144**

(58) **Field of Classification Search** D13/107,
D13/118, 119, 120, 133, 144, 154, 184; D14/155;
320/65, 107, 108, 109; 363/13, 146; 439/30,
439/620, 638, 668, 669, 675, 825
See application file for complete search history.

(56) **References Cited**

U.S. PATENT DOCUMENTS

D341,123 S * 11/1993 Hakanen et al. D13/108
D406,261 S * 3/1999 Kettula et al. D13/144
D481,355 S 10/2003 Lee
D506,455 S * 6/2005 Bey et al. D14/155
D573,578 S * 7/2008 Turksu et al. D14/155
D588,066 S * 3/2009 Kettula D13/144
D592,142 S * 5/2009 Kettula D13/144

OTHER PUBLICATIONS

Scosche, The Necessary Accessory, FMTD1 Digital TuneSHIFT, 2009, www.scosche.com/products.
Griffin Technology, iTrip Auto (2008), FM Transmitter and Car Charger for iPod & iPhone.

* cited by examiner

Primary Examiner—Daniel D Bui

(74) *Attorney, Agent, or Firm*—Brooks Kushman P.C.

(57) **CLAIM**

The ornamental design for a vehicle power adapter, as shown and described.

DESCRIPTION

FIG. 1 is a perspective view of the a vehicle power adapter showing my new design;

FIG. 2 is a front elevation view thereof;

FIG. 3 is a plan view thereof;

FIG. 4 is a side elevation view thereof; and,

FIG. 5 is a rear elevation view thereof.

The broken line shown in the drawings is included for the purpose of illustrating environmental structure and forms no part of the claimed design.

1 Claim, 2 Drawing Sheets

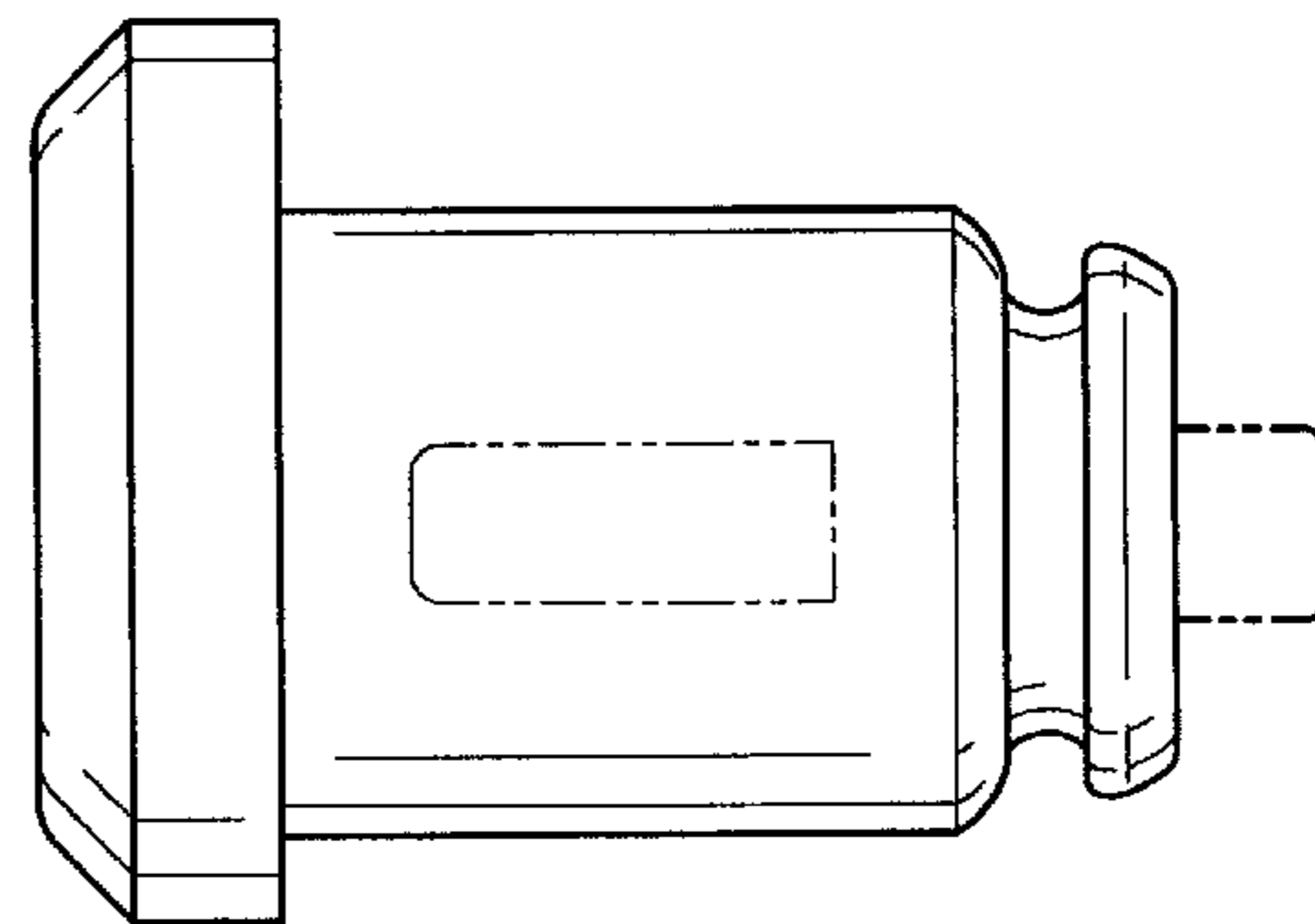
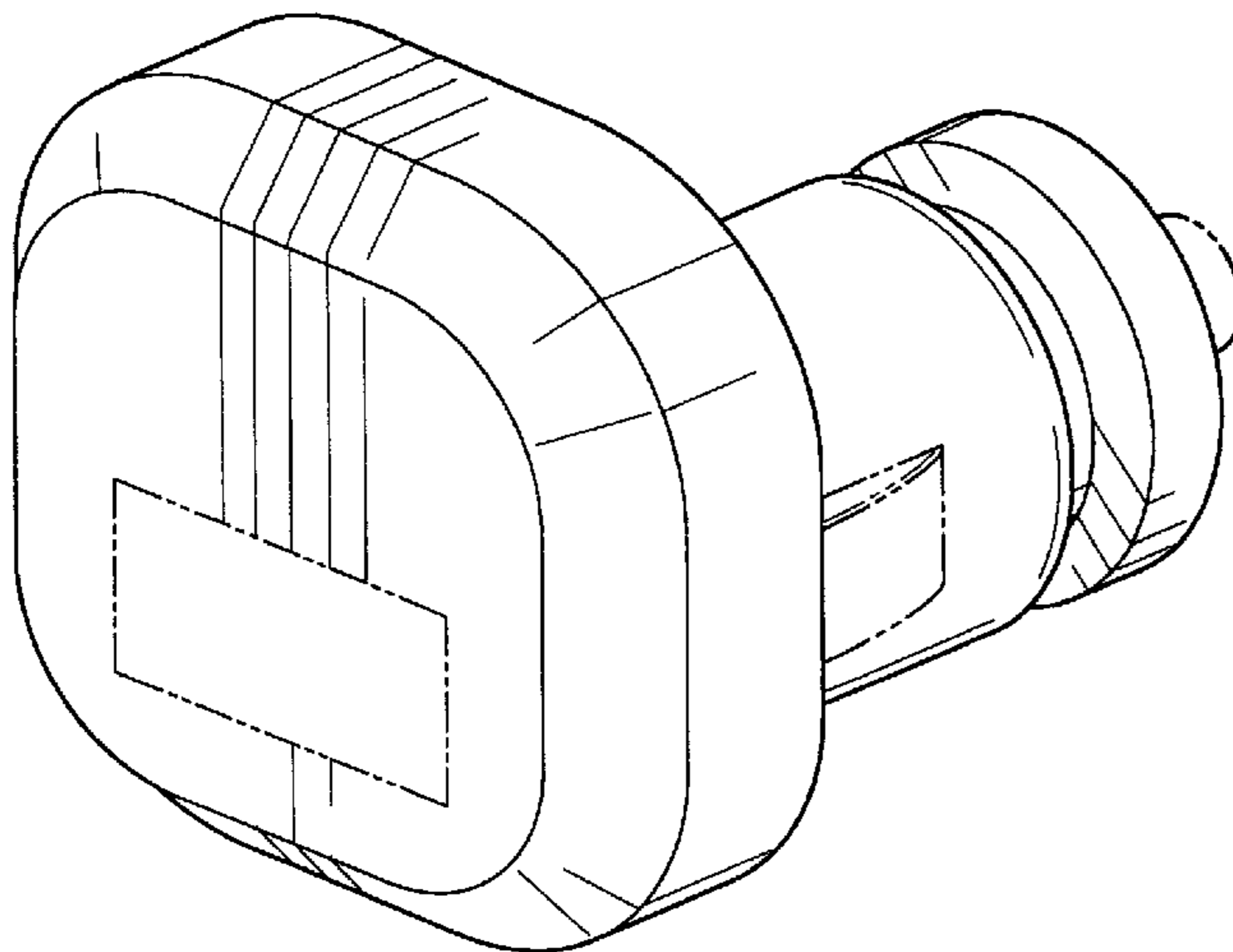

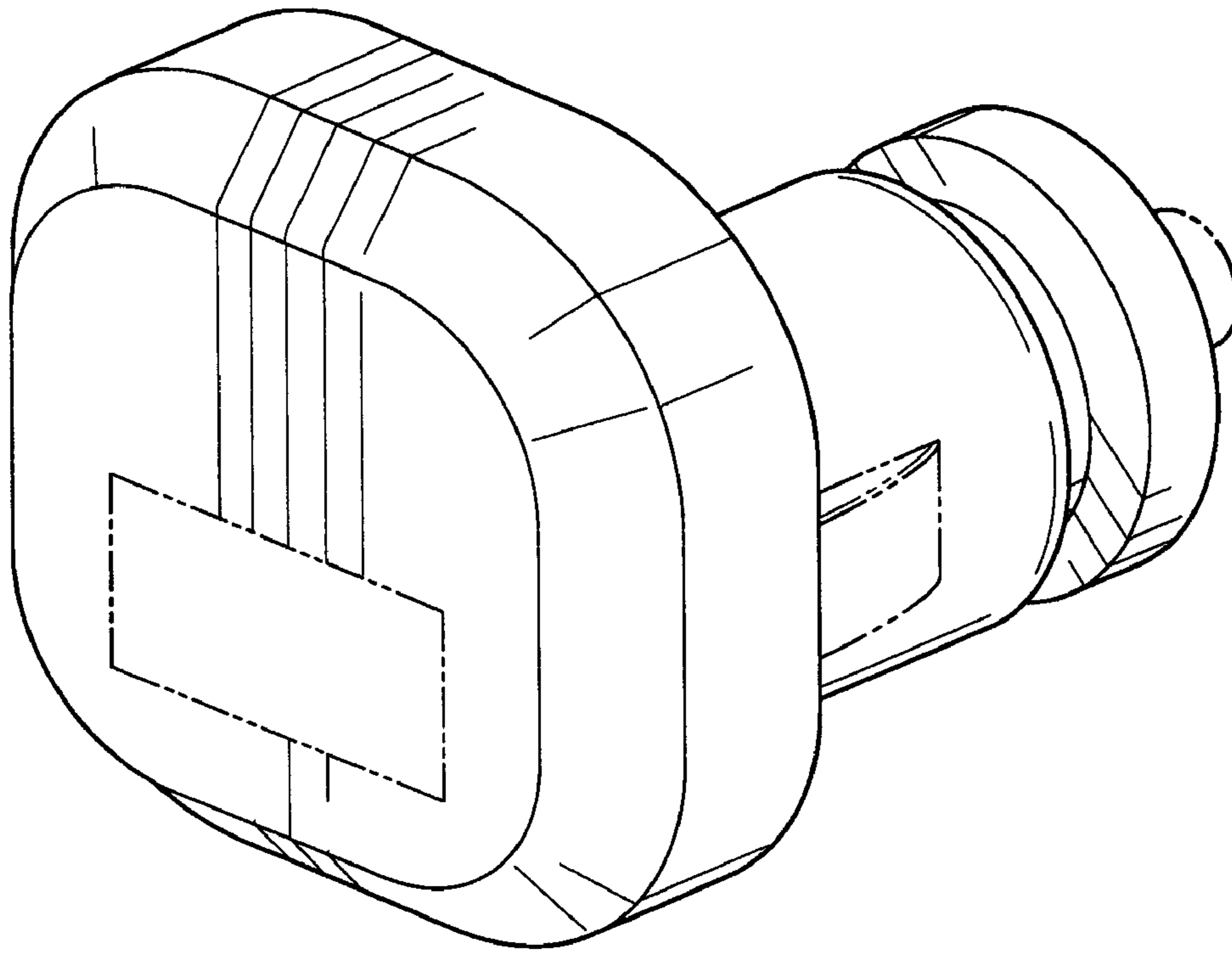

Fig-1

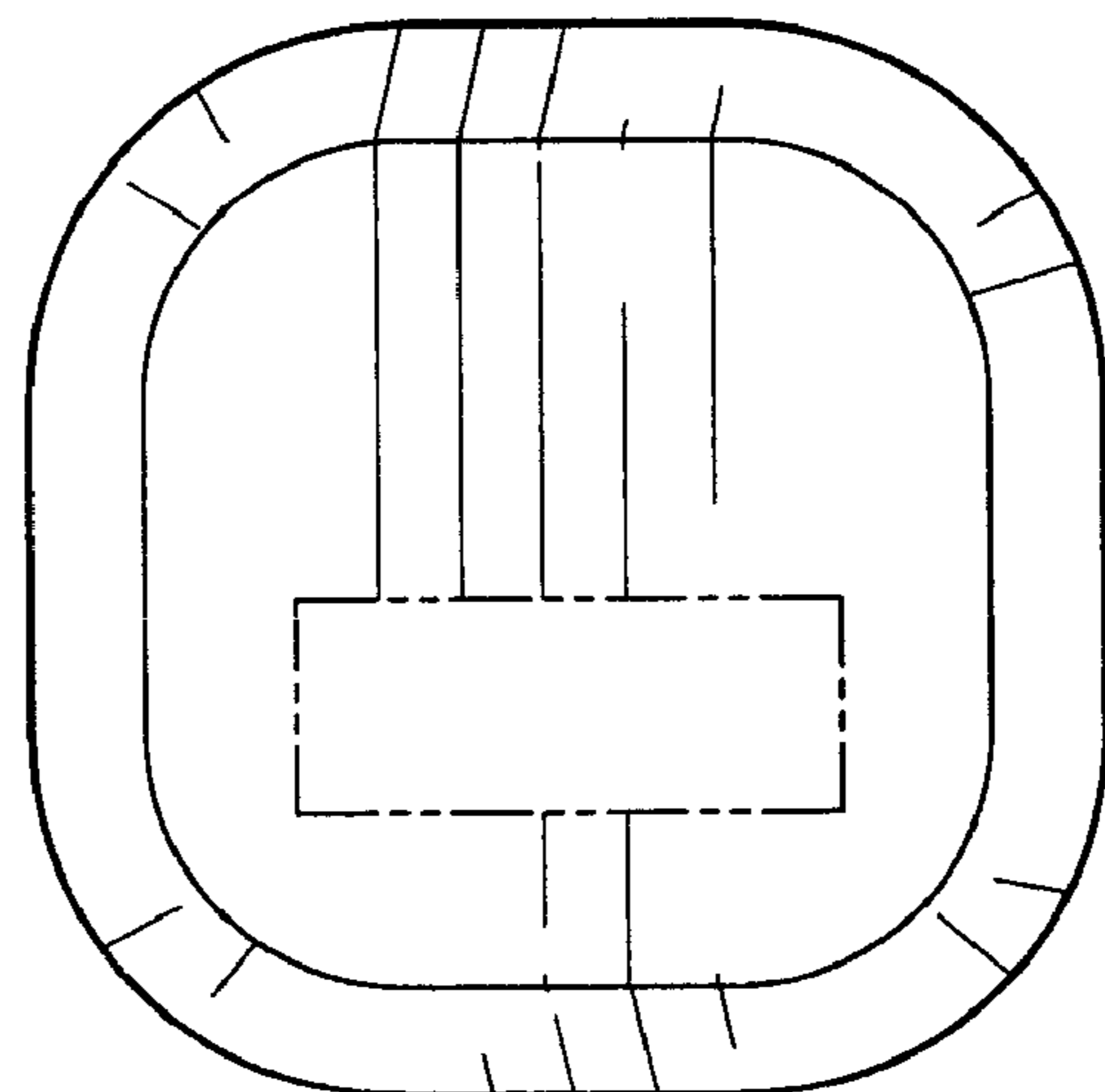

Fig-2

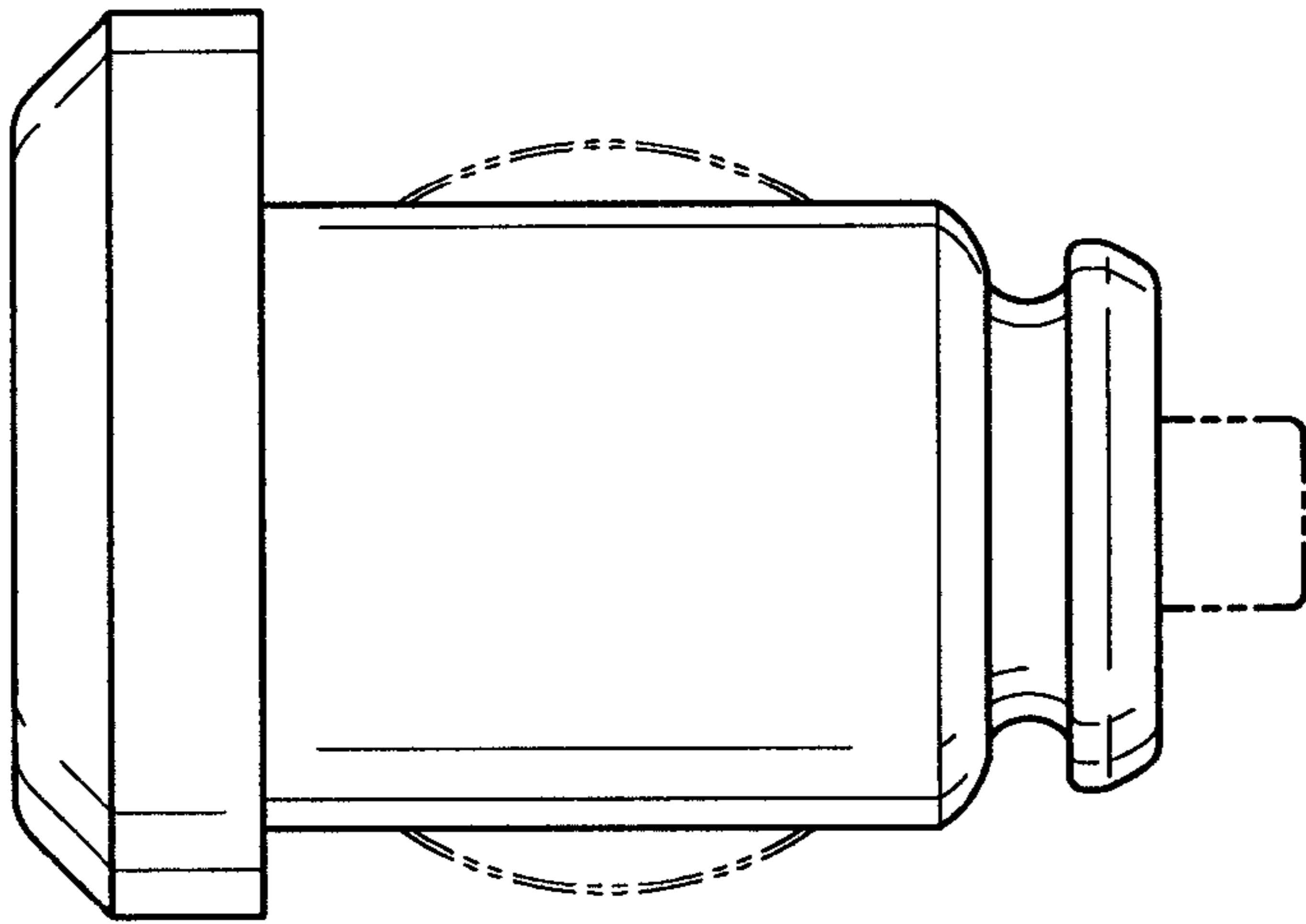

Fig-3

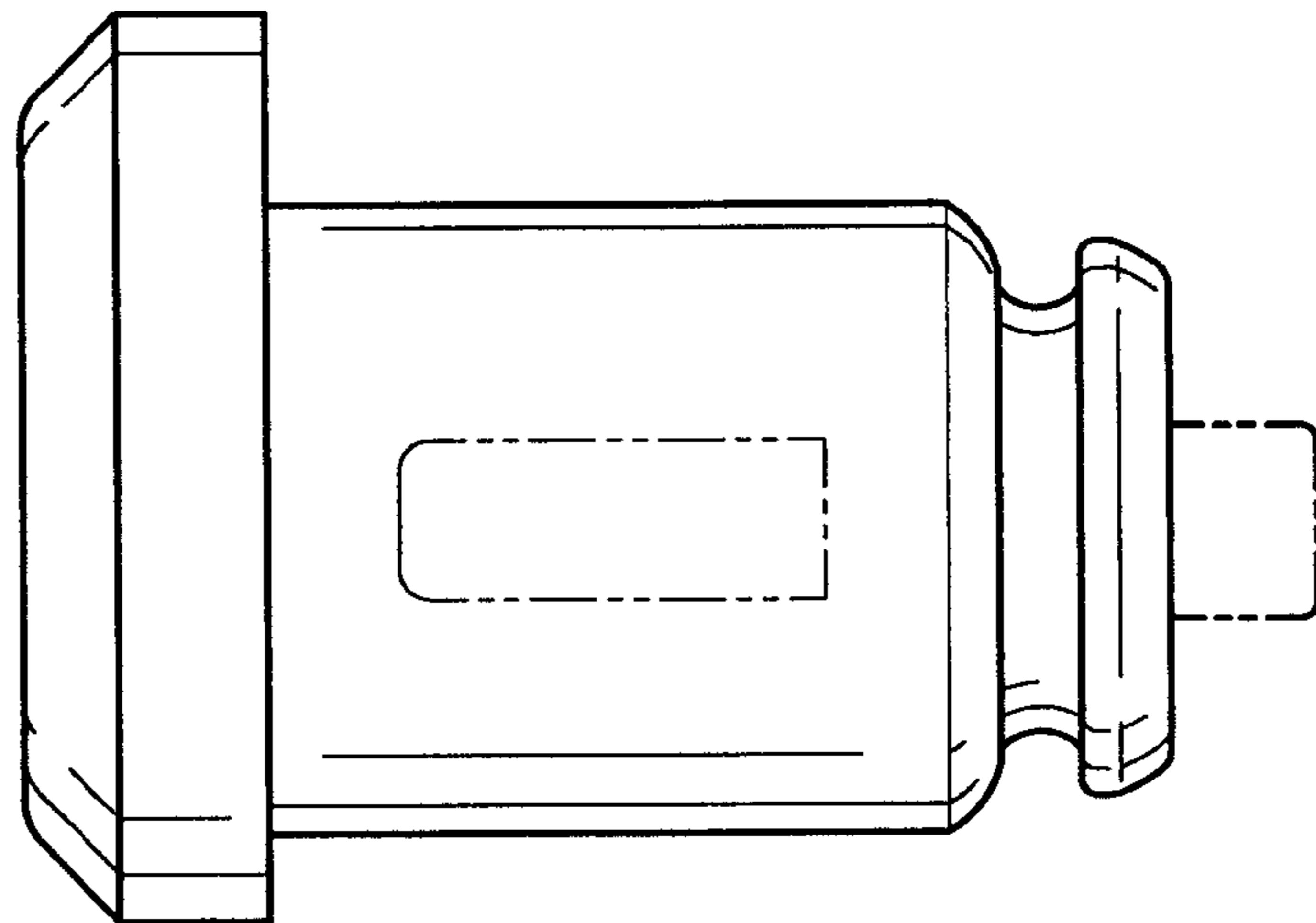

Fig-4

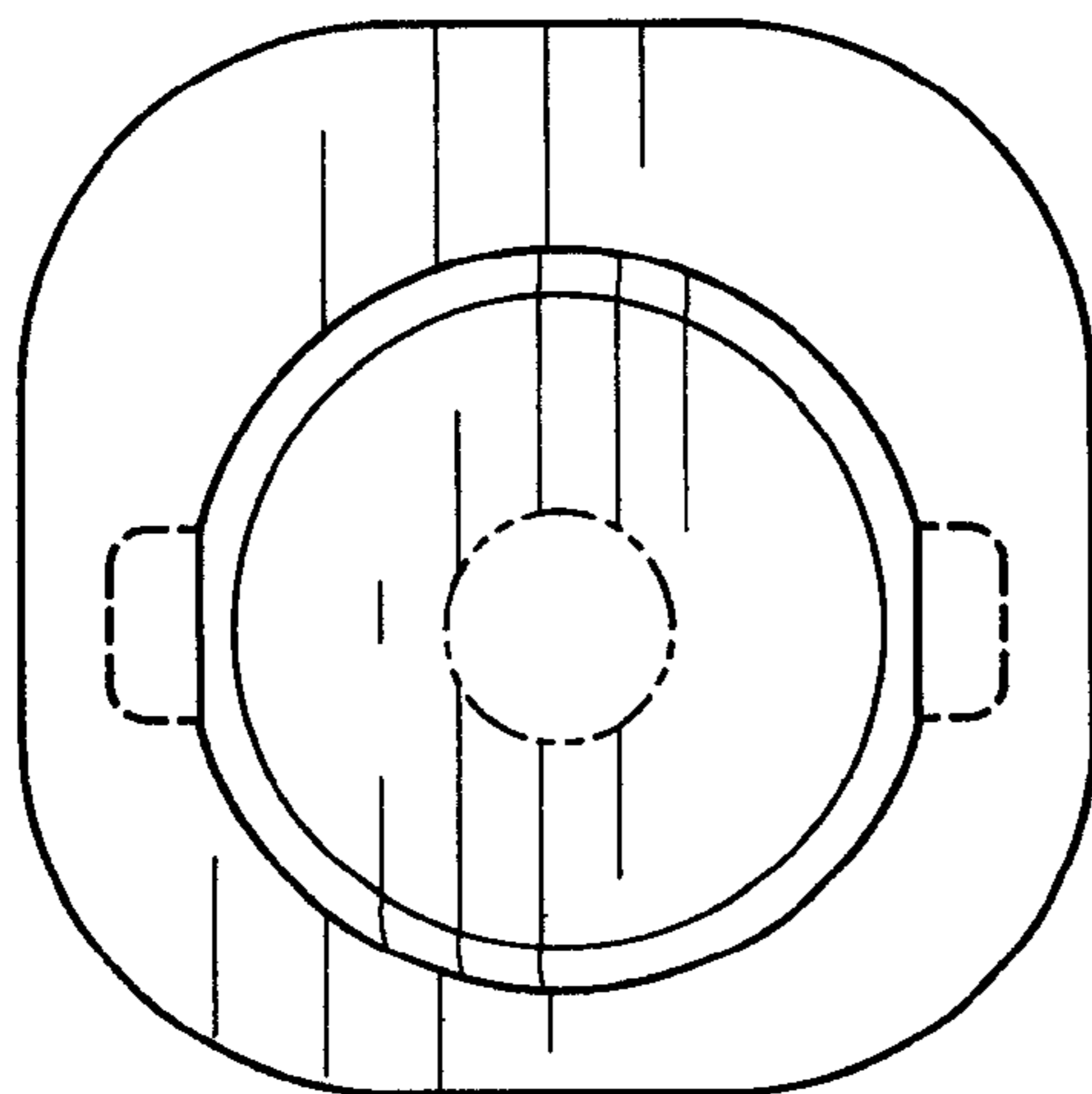

Fig-5