



US00D626399S

(12) **United States Design Patent**
Jou

(10) **Patent No.:** **US D626,399 S**
(45) **Date of Patent:** **** Nov. 2, 2010**

(54) **CABINET PULL**

(75) Inventor: **Benjamin S. Jou**, Taichung (TW)

(73) Assignee: **Century Hardware, Inc.** (TW)

(**) Term: **14 Years**

(21) Appl. No.: **29/350,753**

(22) Filed: **Nov. 23, 2009**

(51) **LOC (9) Cl.** **08-06**

(52) **U.S. Cl.** **D8/307**

(58) **Field of Classification Search** D8/300,
D8/305, 307, 308, 310, DIG. 1; 16/110.1,
16/417, 441; 292/336.3; D3/12; D7/393,
D7/395; D23/250, 252

See application file for complete search history.

(56) **References Cited**

U.S. PATENT DOCUMENTS

1,720,545	A	*	7/1929	Dickey	267/30
D138,870	S	*	9/1944	Drell	D11/222
D138,874	S	*	9/1944	Drell	D11/222
D206,521	S	*	12/1966	Bottom	D8/310
D217,965	S	*	7/1970	Korol	D23/252
D355,578	S	*	2/1995	Mark et al.	D8/308
D411,795	S	*	7/1999	O'Neil	D8/307

D445,016	S	*	7/2001	Dewald et al.	D8/307
D501,390	S	*	2/2005	Fields	D8/310
D568,139	S	*	5/2008	Hanes	D8/312
D587,555	S	*	3/2009	Krumpe et al.	D8/310

* cited by examiner

Primary Examiner—Paula Greene

(74) *Attorney, Agent, or Firm*—Price, Heneveld, Cooper, DeWitt & Litton LLP

(57) **CLAIM**

I claim the ornamental design for cabinet pull, as shown and described.

DESCRIPTION

FIG. 1 is a perspective view of a cabinet pull showing my new design;

FIG. 2 is a side view thereof;

FIG. 3 is a top view thereof;

FIG. 4 is a bottom view thereof;

FIG. 5 is a first end view thereof; and,

FIG. 6 is a second end view thereof.

The broken lines form no part of the claimed design.

1 Claim, 1 Drawing Sheet

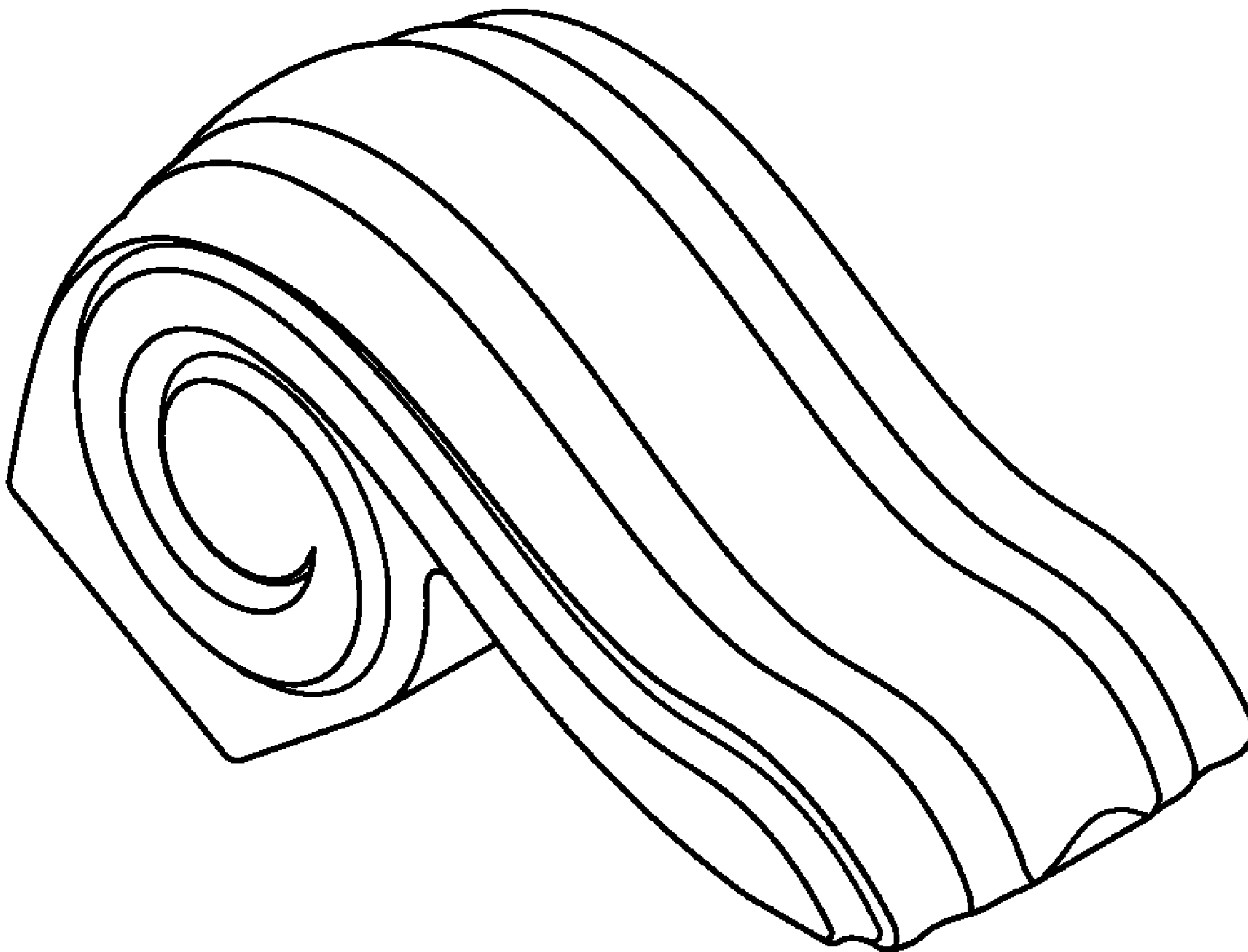

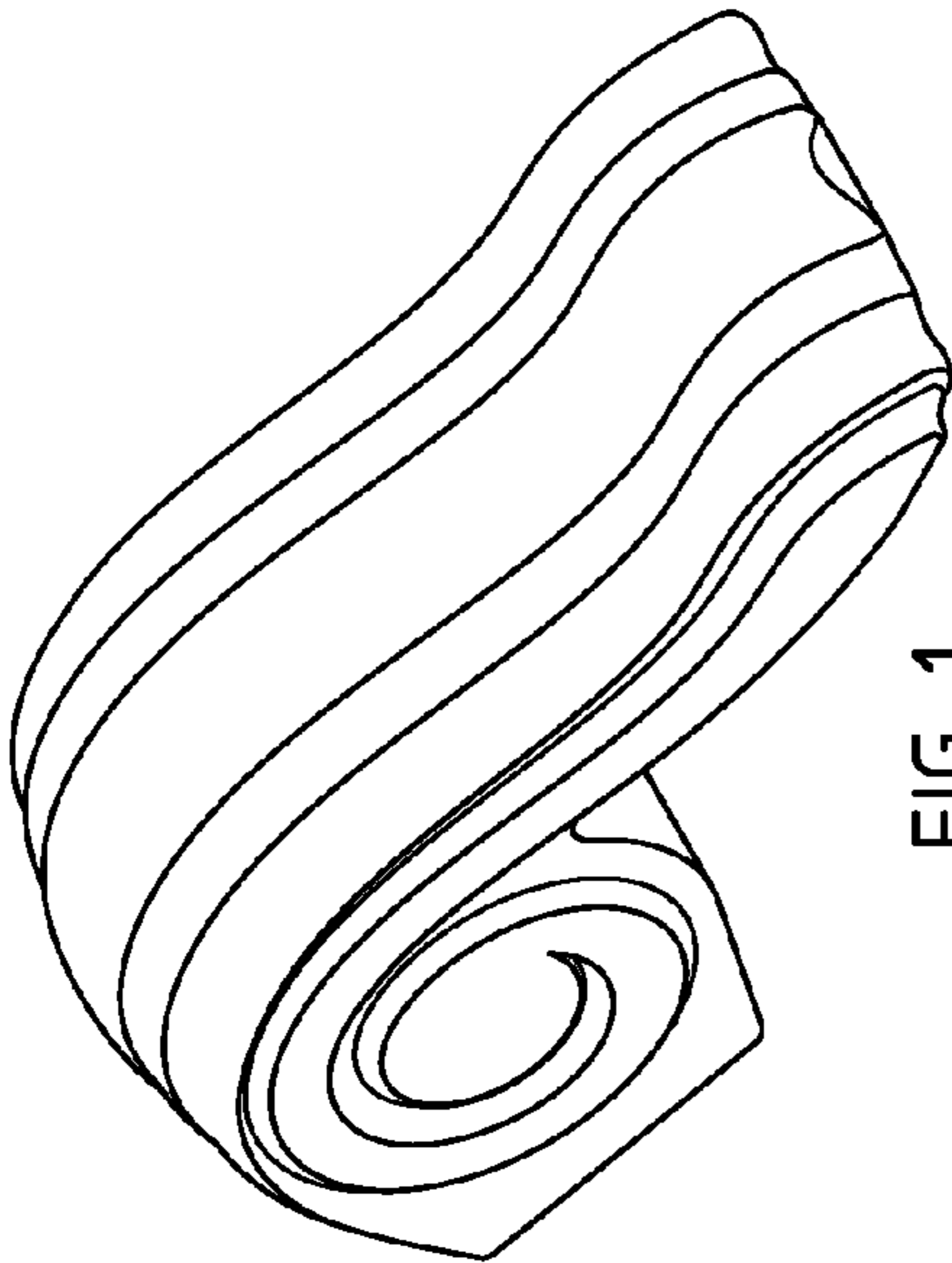

FIG. 1

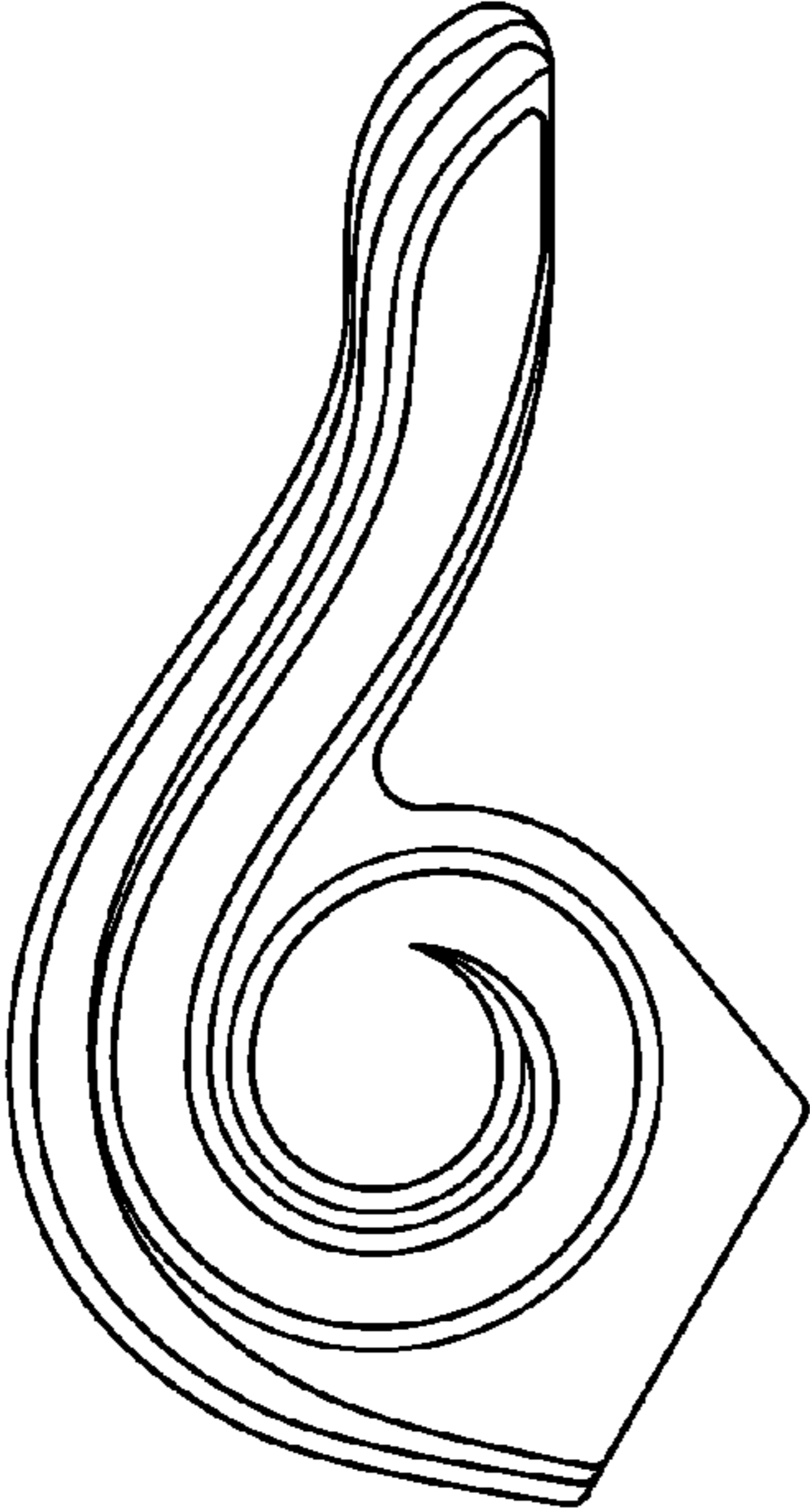

FIG. 2

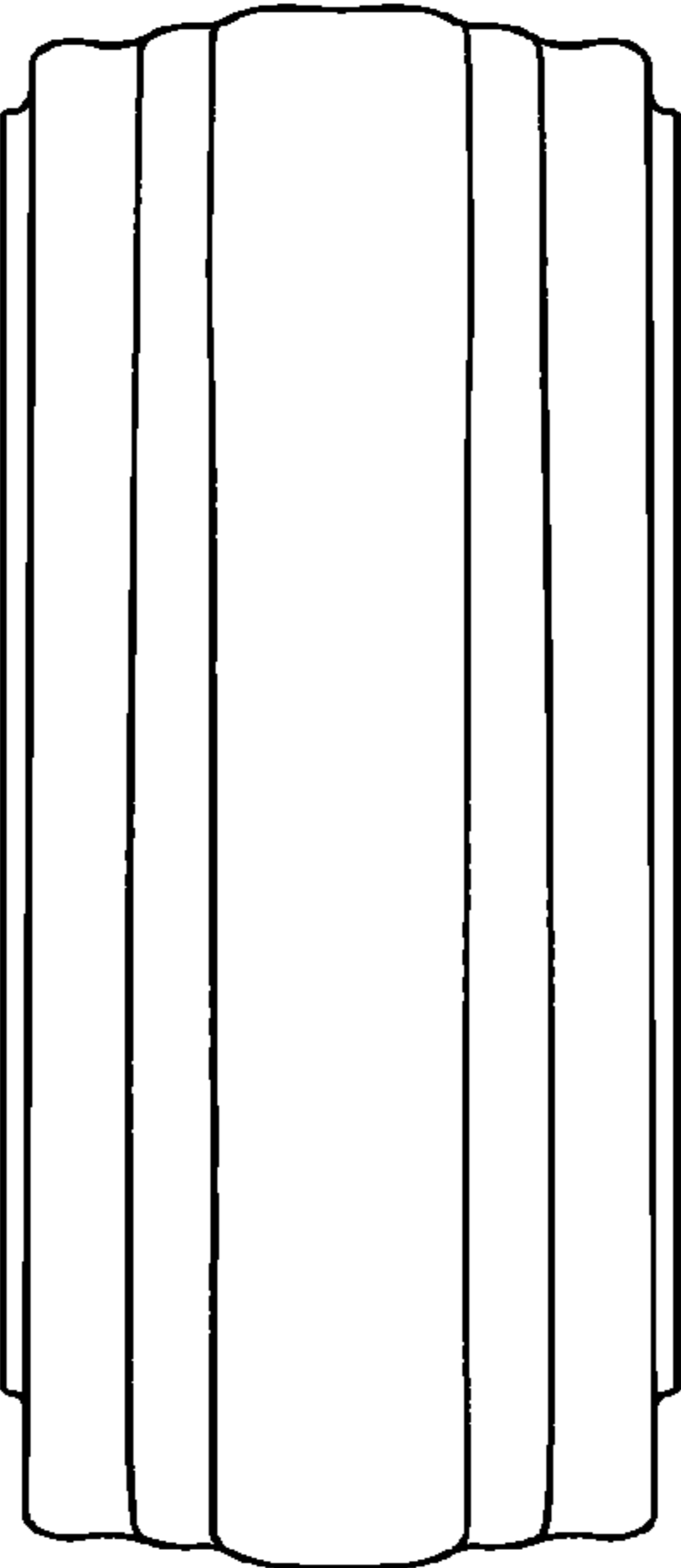

FIG. 3

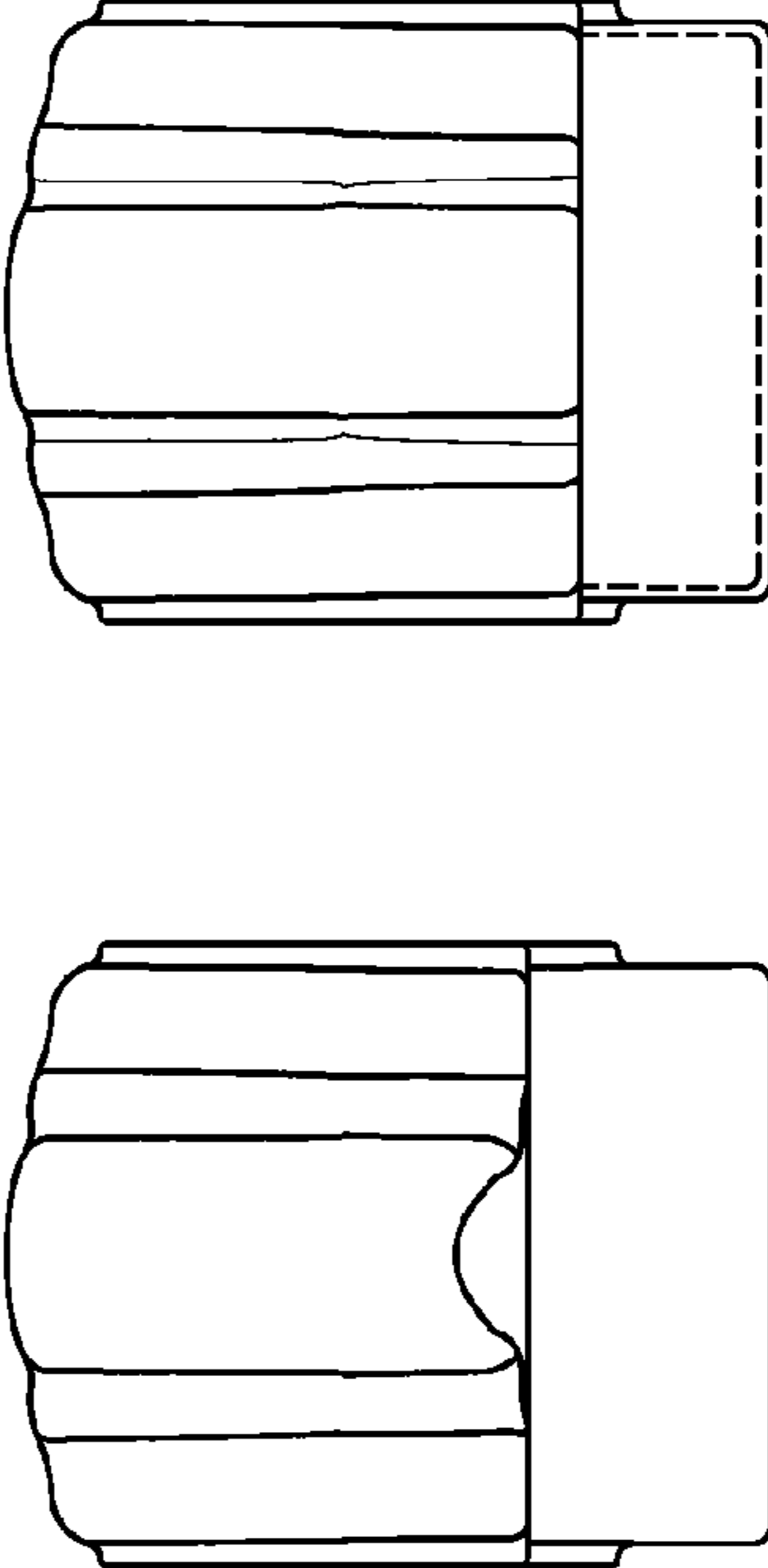

FIG. 5

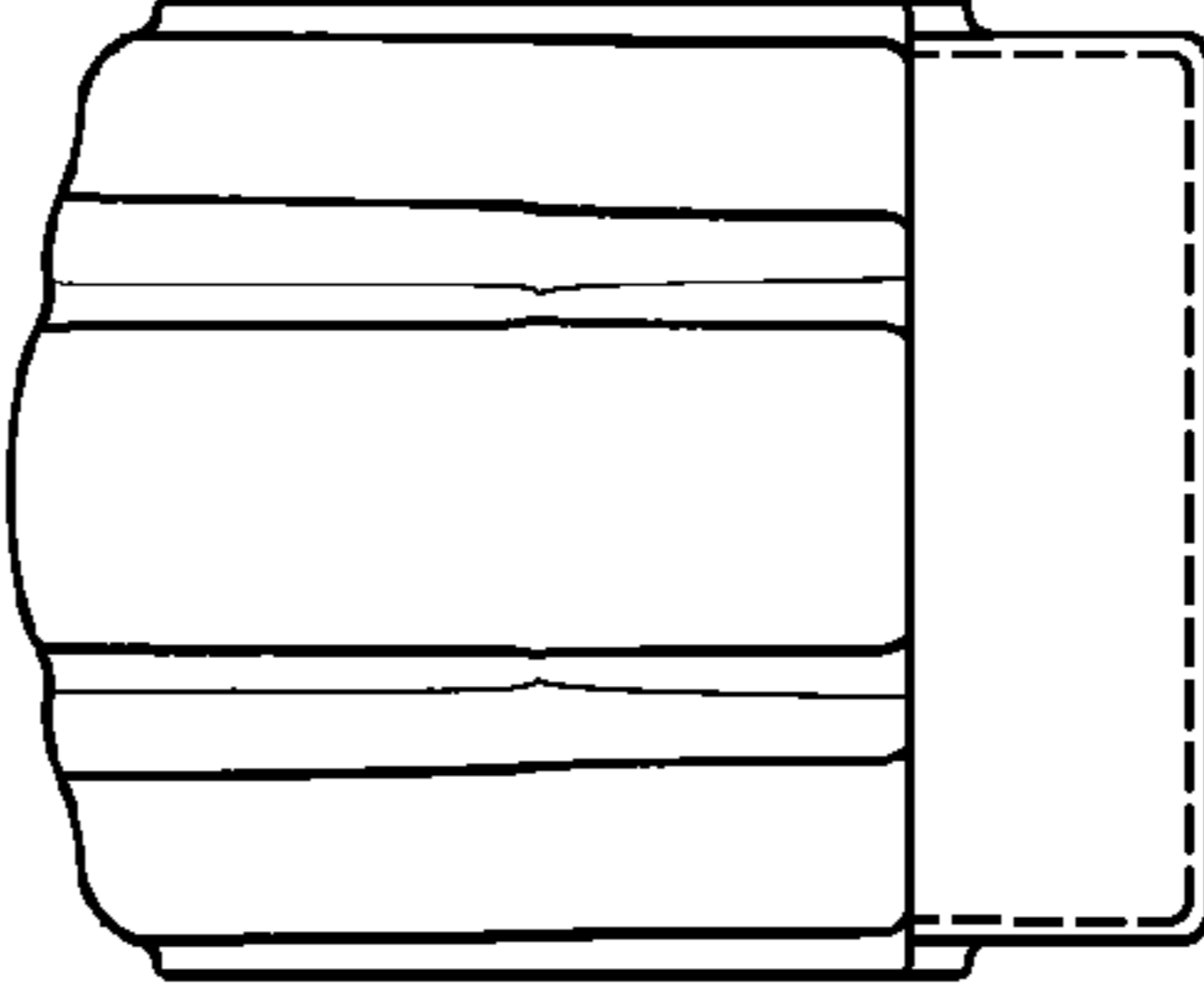

FIG. 6

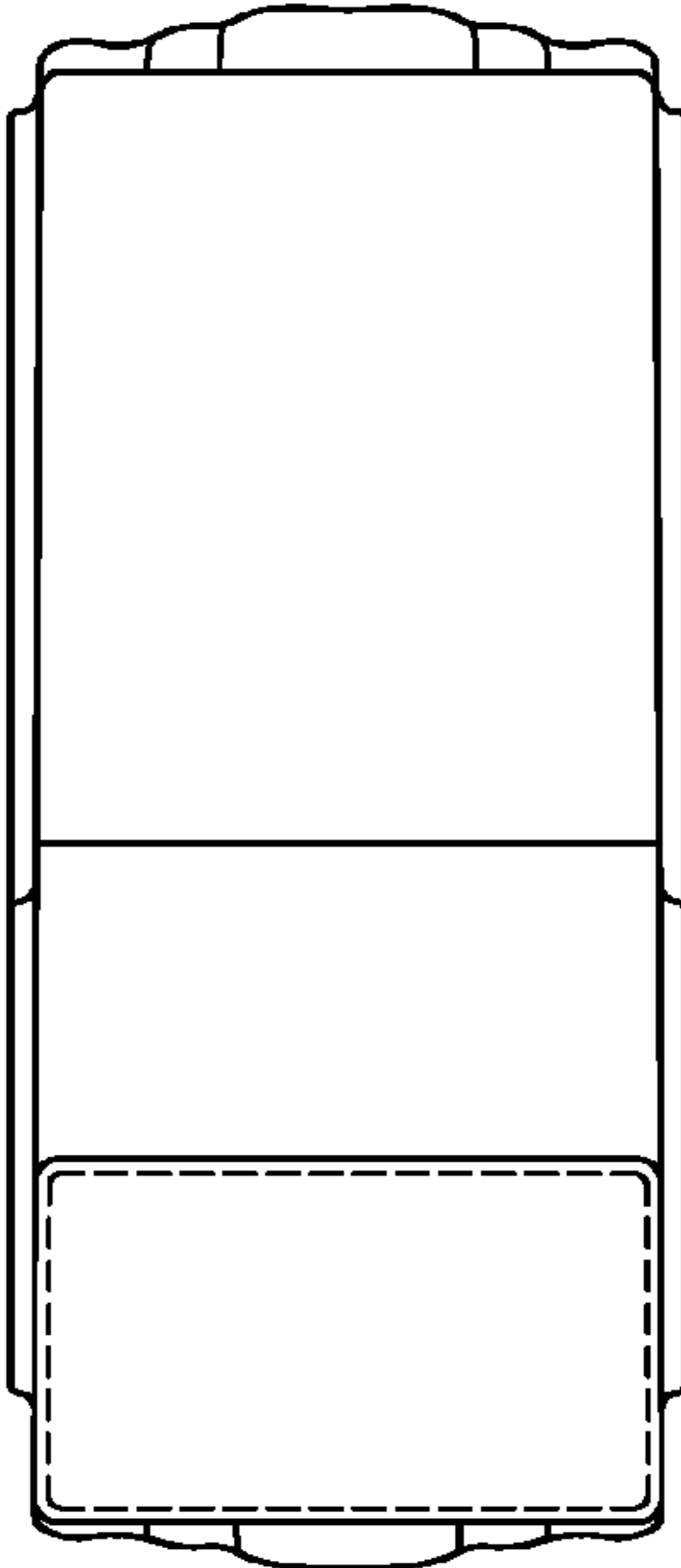

FIG. 4